



OUTGOING



PERMIT

ENVIRONMENTAL PROTECTION ACT 1990

WASTE MANAGEMENT LICENCE

**SUMMERLEAZE PET CREMATORIUM
INCINERATOR & TRANSFER STATION**

Licence No EAWML 30226



ASiantaeth YR
AMGYLCHEDD CYMRU
ENVIRONMENT
AGENCY WALES

ENVIRONMENT PROTECTION ACT 1990 WASTE MANAGEMENT LICENCE.

LICENCE REF No:- EAWML/30226

FACILITY TYPE:- **INCINERATOR &
TRANSFER STATION**

The Environment Agency, in pursuance of Part II of the Environmental Protection Act 1990, hereby grant a waste management licence authorising the disposal and keeping of controlled waste on the land specified in Schedule 1 to this licence to Debbie Suzanne Williams, Summerleaze Pet Crematorium, Greenstreet Farm, Greenstreet Lane, Redwick, Magor, Caldicot NP26 3DY that person being in occupation of the said land, the said licence being subject to the conditions specified in schedule 2 to this licence.

In this licence the words and expressions contained in schedule 2 shall have the meaning assigned to them therein.

SCHEDULE 1 – SPECIFIED LAND

The licence relates to the land at Debbie Suzanne Williams, Summerleaze Pet Crematorium, Greenstreet Farm, Greenstreet Lane, Redwick, Magor, Caldicot NP26 3DY (hereinafter called "the site") shown edged red on Drawing 814-3D dated 18/02/99 and attached to this licence.

Signed Nadia De Longhi
NADIA DE LONGHI
Team Leader - Waste Licensing

Dated: 24th October 2000

FOR ENVIRONMENT AGENCY OFFICIAL USE ONLY

YOUR ATTENTION IS DRAWN TO THE RIGHTS OF APPEAL DETAILED IN THE
NOTES OVERLEAF

Environment Agency Wales
South East Area Office
Abacus House
St Mellons Business Park
St Mellons
CARDIFF CF3 0LT
DX Address 121375
Tel 029 20 770088, Fax 029 20 362487, GTN 7-26 X 1000

Asiantaeth yr Amgylchedd
Ty Abacus
Parc Busnes Llaneirwg
Llaneirwg
CAERDYDD CF3 0LT
Cyfeiriad DX 121375
Ffon 029 20 770088, Ffacs 029 20 362487, GTN 7-26 X 1000



RIGHTS OF APPEAL

Section 43(1) of the Environmental Protection Act 1990 provides that:

Where, except in pursuance of a direction given by the Secretary of State,

- (a) an application for a licence or a modification of the conditions to the licence is rejected
- (b) a licence is granted subject to conditions,

the applicant may appeal from the decision to the Secretary of State

Therefore if you feel aggrieved by the decision or any of the conditions to the licence as granted you may obtain the appropriate form on which to give written notice of an appeal from:-

The Planning Inspectorate
Crown Buildings
Cathays Park
Cardiff
CF10 3NQ

Tel: 02920 823859

Fax: 02920 825150

This notice of appeal should be accompanied by the following information: a copy of the licence; a copy of any correspondence relevant to the appeal; a copy of any other document relevant to the appeal including, in particular, any relevant consent, determination, notice, planning permission, established use certificate or certificate of lawful use or development; and a statement indicating whether you wish the appeal to be in the form of a hearing or on the basis of written representations. You are also required to serve a copy of your notice of appeal, together with copies of any the above documents that have accompanied your notice of appeal, on the Environment Agency (at the address below). You should appeal within 6 months of the date that this notice takes effect but the Secretary of State may allow notice of appeal to be given after the expiry of this time period.

**Environment Agency Wales
South East Area Office
Abacus House
St Mellons Business Park
St Mellons
CARDIFF CF3 0LT**

PLEASE READ THE FOLLOWING INSTRUCTIONS VERY CAREFULLY & ENSURE THEY ARE IMPLEMENTED.

DO NOT SCALE.

All measurements & levels shown on subject to be checked on site by the contractor. Figure dimensions to take precedence over notes.

All working dimensions must be taken from, checked &/or verified by the main contractor on site prior to the commencement of all items & the planting of all work in hand.

Working dimensions must not be scaled from this drawing. In all cases of doubt or discrepancy please refer to the architect, contractor, supervising officer or consultant for instructions.

The main contractor must ensure that all appropriate curbsides, verges, separating officer, consultants &/or specialist drainage are read in conjunction with this drawing.

All work is to comply with the current building regulations, local authority bye-laws & specifications & requirements of statutory bodies.

Have all notices in the authorities concerned.

All work is to comply with the current editions of the British Standards building codes of practice.

All materials to comply with the current editions of the Building Standards building specifications.

Prior to commencing work, the contractor is required to communicate with the relevant authorities, bring them to site to be locate the positions and lines of all services (i.e. water, gas, electricity, telephone, television, sewer etc.) on, over, under & around the site which could in any way affect the positioning of the buildings. Copies of the correspondence & a full report of the findings must be forwarded to the architect, contractor, supervising officer or consultant before building work commences.

This drawing is copyright.

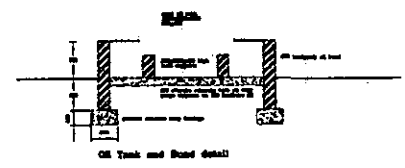

LANDSCAPING TREES

- Torus drive
 - Concrete drive and hardstanding
 - F/W drainage and cover pits
 - SW drainage
 - Urn Bin
 - Ball Stone
 - Security Lights
 - AR - Acer rubrum
 - AP - Acer capillipes
 - AB - Acer Aspidulum (Vig.)
- All trees to be planted on standards, 2.500 min height.

SHRUBS

- H - Hebe 'Auranti Glow'
- SH - Santalina neapolitana
- Hedging comprising Blackthorn, Hawthorn and Hazel

All planting to be completed during the nearest season PRIOR to completion of the site.

All planting to be maintained for one year with all dead or dying trees replaced General Contractor.

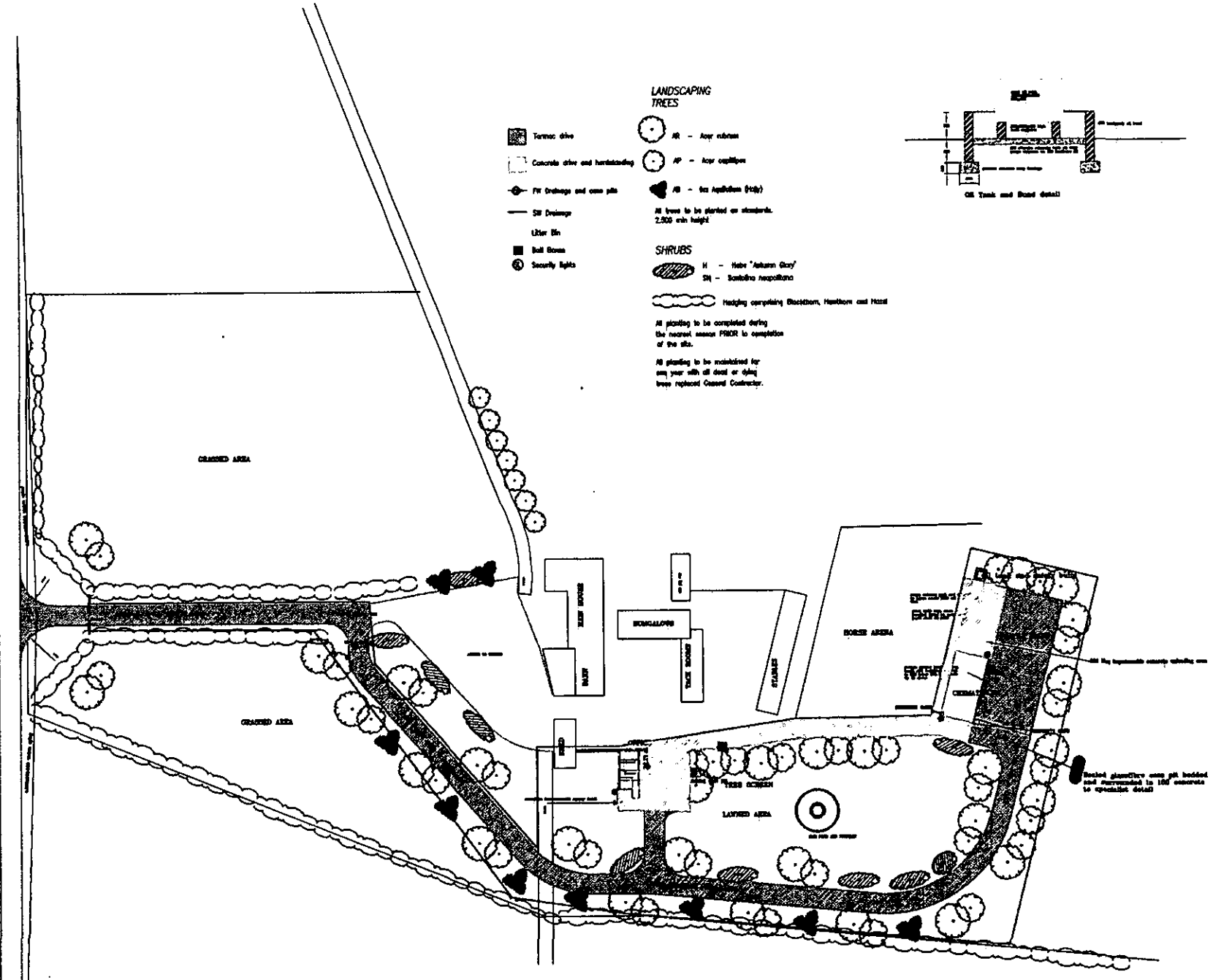

REVISIONS

| NO. | DATE | DESCRIPTION |
|-----|----------|--|
| 1 | 18/02/99 | Check annotations added |
| 2 | 18/02/99 | Take appropriate note out of book used |
| 3 | 18/02/99 | Check requirements added |
| 4 | 18/02/99 | Working returned to 01 |

M. John Crowther & Associates
 Architect, Surveyors
 Planning Consultants

Units 2, 666 Street, 40 Impact Road, Cranley, West Dorset
 01258 520000 Fax 01258 520001
 01258 520002 01258 520003 and 01258 520004
 01258 520005 and 01258 520006

Proposed Pet Crematorium at
 Green Street Farm,
 Redwick.

General Site Layout

| | | |
|-----------------|----------|-------------------|
| CONTRACT | | N.T.S |
| Date | 18/02/99 | CDP No. |
| Drawn | MJC | C:\CAD\814\814-3D |
| Checked | | Sheet No. |
| | | 814-3D |

General considerations

1.1 Specified waste management operations

- 1.1.1 No waste management operations shall be authorised by this licence unless:
- a specified in and undertaken in accordance with the limitations in the following table; or
 - b otherwise required by the conditions of this licence as being an integral part of those operations:

Table 1.1 Specified waste management operations

| Specified Waste Management Operation | Permitted Waste Types which may be subject to the Specified Operation | Limits on Specified Waste Management Operations |
|--------------------------------------|--|---|
| Disposal | | |
| D10: Incineration of waste on land. | Degradable household waste consisting of: Animal carcasses Animal bedding materials | The operation can only take place within an incinerator unit provided in accordance with condition 4.7 of this licence with a design capacity of less than 50 Kg/hour. |
| | Degradable commercial waste consisting of: Animal carcasses Paper documents | |
| Keeping | | |
| D15: Storage pending: | | |
| Incineration on site | Degradable household waste consisting of: Animal carcasses Paper documents | All animal carcasses shall be kept in the cold store as shown on Drawing 814-5E and shall be stored for a period no longer than 10 days without Agency consent. All paper documents shall be kept in the secure store as shown on Drawing 814-5E. |
| | Degradable commercial waste consisting of: Animal carcasses Paper documents | |
| Disposal off site | Degradable commercial waste consisting of: Empty glass bottles Feminine sanitary | All wastes except the empty glass bottles shall be kept in the cold store as shown on Drawing 814-5E and shall be stored for a period no longer than 10 days without Agency consent. All empty glass bottles shall be kept in the sealed bin as shown on Drawing 814-5E. |
| | Clinical waste consisting of: Infectious waste Tissue Dressings Sharps Healthcare excreta | |

Specified Waste Management Operations and Exempt Waste Management Operations

1.1.2 Where wastes are being brought onto the site for waste management operations which are exempt from licensing under the 1994 Regulations, then the wastes which are subject to the specified waste management operations shall be kept clearly segregated and identified from those wastes which are being kept on the site for the exempt waste management operations.

1.2 **Permitted wastes**

Permitted categories and types of wastes

1.2.1 No wastes other than those which are both categorised below in Table 1.2A and specified in detail in section 1.2 of the working shall be accepted at the site.

Permitted quantities of wastes

1.2.2 The quantities of wastes accepted shall not exceed those listed in Table 1.2A and specified in detail in section 1.2 of the working plan. Whilst complying with the maximum quantities specified for each type of waste, the total quantity of waste accepted at the site per year shall not exceed 1400 tonnes.

Table 1.2.A Permitted quantities of waste

| Permitted Waste Categories | Maximum Permitted Quantities (tonnes/year) |
|-----------------------------------|---|
| Special Wastes | Not permitted |
| Clinical waste: | |
| Infectious waste | } |
| Tissue | |
| Dressings | |
| Sharps | 50 |
| Healthcare excreta | 50 |
| Degradable Household Wastes: | |
| Animal carcasses | } |
| Animal bedding | |
| Degradable commercial wastes: | |
| Animal carcasses | 400 |
| Paper documents | 100 |
| Empty glass bottles | 500 |
| Feminine sanitary | 50 |
| Total | 1400 |

Exclusion of wastes with other specified characteristics

1.2.3 Notwithstanding the specification of permitted waste types under conditions 1.2.1 and 1.2.2 above, wastes shall not be accepted at the site which have any of the following characteristics:

Table 1.2B Excluded wastes of specified form and type

| Waste Characteristic | Type |
|----------------------|--------------------------------|
| Form and Type: | Sludges, Liquids or Wet wastes |

1.3 Staffing and understanding of requirements of licence conditions and working plan

Minimum staffing and supervision

1.3.1 Whenever the site is open to receive or despatch waste, or is carrying out any of the specified waste management treatment or disposal operations, it shall be supervised by at least one member of staff who is suitably trained and fully conversant with the requirements of the licence and the working plan regarding:

- waste acceptance and control procedures;
- operational controls and environmental monitoring;
- maintenance;
- record-keeping;
- emergency action plans;
- notifications to the Agency.

Availability of licence and working plan

1.3.2 A copy of this licence and the working plan shall be kept available on site for reference when required by all site staff carrying out work under the requirements of the licence.

Understanding of licence and working plan

1.3.3 All site staff shall be, or shall work under the direct supervision of a member of staff who is, fully conversant with those aspects of the licence conditions and working plan which are relevant to their specific duties.

1.4 Changes in technically competent persons

1.4.1 Any changes in the technically competent management of the site and the name of any incoming person together with evidence that such person has the required technical competence shall be submitted to the Agency in writing within 5 working days of the change in management. Technically competent management and technical competence shall be as defined under section 74 of the Environmental Protection Act 1990 and Regulations 4 and 5 of the 1994 Regulations.

1.5 **Relevant convictions**

Notification of relevant convictions

1.5.1 In the event of the Licence Holder and/or any relevant person being convicted of any relevant offence and which is in addition to any already notified to the Agency, then full details shall be provided to the Agency within 14 days following sentencing, whether or not the conviction or sentence is subsequently appealed. Such details shall include, in respect of each relevant person (as defined in section 74(7) of the Environmental Protection Act 1990 or any subsequent amendments to that section), the nature of the offence, the place and date of conviction, and any fine or other penalty imposed.

Notifications of appeals against convictions

1.5.2 In the event that the Licence Holder and/or any relevant person lodges an appeal against any such conviction or sentence, the Licence Holder shall notify the Agency of this within 14 days of the lodging. The Licence Holder shall notify the Agency of the results of that appeal, within 14 days of the appeal being decided.

1.6 **Maintenance of financial provision**

1.6.1 The financial provision for meeting the obligations under this Licence set out in the Agreement made between the Licence Holder and the Agency dated 24 October 2000 shall be maintained by the Licence Holder throughout the subsistence of this Licence and the Licence Holder shall produce evidence of such provision whenever required by the Agency.

1.7 **Amendments to working plan and supporting information**

Amendments to working plan requiring prior consent from the Agency

1.7.1 The Licence Holder shall give the Agency prior notice in writing of any proposed change to those sections of the working plan which are specified in Table 1.7 below, and to any appendices, drawings and figures which are referenced in those sections.

Table 1.7 Sections of working plan requiring prior consent for amendments

| Number and Heading of Working Plan Sections and Appendices | Sections, Subsections and Appendices requiring Prior Consent for Amendments |
|--|---|
| 1 General considerations | 1.2, 1.3 |
| 2 Site engineering for pollution prevention and control | 2.1.2, 2.1.3, 2.1.4 |
| 3 Site infrastructure | 3.1 |
| 4 Site operations | 4.1.1, 4.1.2, 4.2.4, 4.2.5, 4.3, 4.4.1, 4.4.2, 4.4.3, 4.4.4, 4.5, 4.6, 4.7 |
| 5 Pollution control, monitoring and reporting systems | 5.1 |
| 6 Amenity management | 6.1, 6.2, 6.3, 6.4, 6.5 |
| 7 Site records | 7.1 |
| Working Plan Drawing Nos. | 814-3C, 814-4E, 814-5E, 814-6, 814-7 |

1.7.2 The notice shall be accompanied by a copy of the proposed changes, and by a written assessment of the effect that implementing the proposed change to the working plan would have on the risk posed by the site to human health and the environment.

1.7.3 The Licence Holder shall provide up to 6 additional copies of the proposed change and supporting risk assessment to the Agency, when required by the Agency in writing.

1.7.4 The proposed change to the working plan shall not be implemented unless the Agency has given its written consent to it. Following consent, the Licence Holder shall give the Agency prior written notification of the implementation date of the change, and from that date the changed section shall be deemed to be incorporated in the working plan in replacement of the previous version of that section.

Amendments to the working plan requiring prior notification to the Agency

1.7.5 Except where it is specified under condition 1.7.1 of this licence that the amendment of specified sections of the working plan requires the prior written consent of the Agency, the Licence Holder shall give the Agency prior written notice of any change to the working plan. Changes to the working plan shall be deemed to be incorporated in the working plan and implemented on the date specified to the Agency in the amendment notification.

1.7.6 The notice shall be accompanied by a copy of the specified changes.

1.7.7 The Licence Holder shall provide up to 6 additional copies of the proposed change to the Agency, when required by the Agency in writing.

1.7.8 Such changes to the working plan shall be deemed to be incorporated in the working plan and implemented on the date specified to the Agency in the amendment notification.

1.8 **Notification of change of operator's or holder's details**

1.8.1 The following information shall be notified in writing within 5 working days to the Agency:

a where the Licence Holder is an individual or named individuals:

- i** where the Licence Holder consists of more than one named individual, the death of any of those individuals;
- ii** any change in the Licence Holder's name(s) or address(es);
- iii** any steps taken with a view to the Licence Holder, or any one of them, going into bankruptcy, entering into a composition or arrangement with creditors, or, in the case them being in a partnership, dissolving the partnership;
- iv** the operator at the time of issue of the licence and of any change in the operator or in the operator's trading name, address, registered name or registered office address (if different from the Licence Holder);

b where the Licence Holder is a registered company:

- i** any change in the Licence Holder's trading name, registered name or registered office address;
- ii** any steps taken with a view to the Licence Holder going into administration, entering into a company voluntary arrangement or being wound up;
- iii** the operator at the time of issue of the licence and of any change in the operator or in the operator's trading name, address, registered name or registered office address (if different from the Licence Holder);

c where the Licence Holder is a corporate body other than a registered company:

- i** any change in the Licence Holder's name or address;

-
- ii any steps taken with a view to the dissolution of the Licence Holder;
 - iii the operator at the time of issue of the licence and of any change in the operator or in the operator's trading name, address, registered name or registered office address (if different from the Licence Holder)

1.9 **Notification of preparatory works**

- 1.9.1 No preparatory works shall be undertaken until at least 7 days prior notice in writing has been given to the Agency of the intention to do so. The notification shall include details of what work is being done and when.

1.10 **Notification of commencement, cessation and recommencement of waste handling operations**

Specified waste management operations

- 1.10.1 No specified waste management operation shall be carried out until at least 7 days prior notice in writing has been given to the Agency of the intention to commence carrying out the specified waste management operation.

Cessation and recommencement of receiving wastes

- 1.10.2 In the event that the site ceases receiving wastes for longer than 1 month, the Licence Holder shall inform the Agency in writing of the date of cessation and of the planned date of recommencement. In the event that the site recommences receiving wastes sooner than the notified date then the Licence Holder shall give the Agency not less than 7 days prior notice in writing.

1.11 **Notifications and submissions to Agency**

- 1.11.1 Except where otherwise specified, all notifications and submissions to the Agency under the requirements of these licence conditions:

- a shall be made in writing to the address specified by the Agency in writing at the time of issue of this licence, or as subsequently specified by written notification to the Licence Holder;
- b shall quote the licence reference number and the name of the Licence Holder.

2

Site engineering for pollution prevention and control

2.1

Engineered site containment and drainage systems

Provision and maintenance of site containment and drainage systems

2.1.1

No waste or other potentially polluting materials, which are to be used in combination with those wastes in the specified waste management operations shall be deposited, stored, treated or otherwise handled in any area of the site until the engineered site containment and drainage system for that area has been constructed and completed in accordance with this condition and sections 2.1.2 and 2.1.3 of the working plan, and the Drawings numbered 814-3C and 814-6 showing the layout of areas of hard standing.

Construction quality assurance of new site containment and drainage systems

2.1.2

No wastes shall be deposited, stored, treated or otherwise handled in any area or in any fixed tank for which an engineered site containment and drainage system has been newly constructed to meet the requirements of this condition until:

- a** details of the identities, relevant experience and relevant qualifications of the personnel who will be providing Quality Assurance of the engineered site containment and drainage systems have been submitted in writing to the Agency and acknowledged in writing by the Agency;
- b** the engineered site containment and drainage system has been constructed in accordance with sections 2.1.2 and 2.1.3 of the working plan and the other requirements of this condition;
- c** the Validation Report on the construction of the engineered site containment and drainage system has been submitted in writing to the Agency and has been acknowledged in writing by the Agency.

Site infrastructure

3.1 Provision of site identification board

3.1.1 No wastes shall be received at the site until an identification board has been provided at or near the site entrance.

3.1.2 The identification board shall be inspected at least once per week. In the event of damage or defect, the board shall be repaired or replaced within 3 working days.

3.1.3 The board shall be easily readable from outside the site entrance in daylight hours, and shall display the following information:

- a Site name and address;
- b Licence Holder name (company name, not individual name unless justified as necessary);
- c Operator name (company name, not individual name unless justified as necessary);
- d Licence number;
- e Emergency contact name and telephone number (for security reasons, personal names and home phone numbers should not be used except where no alternative is practicable);
- f Statement that the site is licensed by the Environment Agency;
- g Agency national numbers: 0845 9333111 and 0800 807060; or as subsequently notified by the Agency
- h Days and hours site is open to receive waste.

The location of the noticeboard should be such that it is clear that it does not designate areas outside the licensed site and does not encourage illegal tipping.

3.2 Site security

3.2.1 Site security systems shall be provided at all times during the subsistence of this licence, the objective of which shall be to prevent access by humans and livestock which is not authorised either by the Licence Holder or under legal powers of entry. These shall be installed, operated and maintained, and shall be fully documented and recorded, in accordance with section 3.1 of the working plan.

4

Site operations

4.1

Control of mud and debris

Prevention of mud and debris on road

4.1.1

Whenever the site is receiving or despatching wastes, measures shall be provided, operated and maintained in accordance with section 4.1.1 of the working plan, with the objective of preventing the deposit or tracking of mud or debris arising from the site onto public areas outside the site, which shall include public highways and areas of public access outside the site.

4.1.2

All vehicles leaving areas of the site which are operational or upon which engineering works are being carried out shall, before leaving the site, be cleaned as necessary using the specified equipment and shall be checked to ensure that they are clear of loose waste and that their loads are secure.

Remediation of mud and debris on road

4.1.3

In the event that mud or debris arising from the site is deposited onto public areas outside the site, remedial measures shall be implemented immediately, in accordance with section 4.1.2 of the working plan.

4.2

Potentially polluting leaks and spillages of waste

Potentially polluting leaks and spillages from vehicles, plant and equipment

4.2.1

All vehicles used on the site by the operator, and all plant and all equipment used on the site in connection with specified waste management operations, shall be operated and maintained with the objective of preventing potentially polluting leaks and spillages of wastes or other potentially polluting materials which are to be used in combination with those wastes in the specified waste management operations.

Control and remediation of leaks and spillages

4.2.2

In the event of any potentially polluting leak or spillage occurring on site, documented control and remediation procedures shall be implemented immediately and recorded, in accordance with sections 4.2.4 and 4.2.5 of the working plan.

4.3

Fires on the site

Prohibition of unauthorised fires on site

4.3.1

No wastes shall be burned on the site other than through a specified waste management operation authorised under the other conditions of this licence.

Fire action plan

- 4.3.2 In the event of a fire on the site (except those which are specified waste management operations under these conditions), a fire action plan shall be implemented immediately and recorded, in accordance with section 4.3 of the working plan.

4.4 **Waste acceptance and control procedures**

Waste acceptance procedures

- 4.4.1 All wastes shall be received, inspected, accepted or rejected, and recorded in accordance with section 4.4.1 of the working plan and the standards specified in Table 4.4 below.

Waste control procedures

- 4.4.2 All wastes accepted at the site shall be handled, kept and recorded in accordance with section 4.4.2 of the working plan and the standards specified in Table 4.4 below.

Waste despatch procedures

- 4.4.3 All outgoing wastes shall be inspected, despatched and recorded in accordance with section 4.4.3 of the working plan.

Incompatible wastes

- 4.4.4 Incompatible wastes which are likely, in combination with each other or with other material at the facility, to give rise to pollution of the environment or harm to human health outside the site, shall be clearly identified and kept physically separate in designated areas, in accordance with section 4.4.4 of the working plan and the standards specified in Table 4.4 below.

Table 4.4 Standards for waste acceptance and control procedures

| Stage of Waste Handling | Specified standards |
|---|--|
| a) Waste inspection | All wastes received at the site: <ul style="list-style-type: none">i) shall be inspected on receipt to confirm their description and composition against the relevant waste transfer note and other accompanying documentation.ii) shall be kept separate from and shall not be covered by or mixed with other wastes until they have been confirmed and recorded for acceptance at the site. |
| b) Quarantine storage and rejection of wastes | <ul style="list-style-type: none">i) Any items of non-permitted waste which are detected after acceptance at the site of the wastes in which they were included, shall be placed immediately in a designated quarantine storage area within the secure store or cold store as shown on Drawing 814-5E, and, where these are or appear to be special wastes, the Agency shall be informed immediately;ii) In the quarantine area, wastes shall be kept segregated from other wastes which are or are likely to be incompatible;iii) Quarantined wastes shall be removed from site within 7 days;iv) A record shall be kept in the site diary of all rejected wastes. |
| c) Incompatible wastes | <ul style="list-style-type: none">i) Incompatible wastes which are likely, in combination with each other or with other material at the facility, to give rise to pollution of the environment or harm to human health outside the site, shall be clearly identified and kept physically separate within the secure store or cold store as shown on Drawing 814-5E.ii) Incompatible wastes shall be removed from site within 3 days. |

4.5 **Waste quantity measurement systems**

Means of measurement

4.5.1 All wastes accepted at and despatched from the site shall be measured in accordance with section 4.5 of the working plan

4.6 **Storage of specified wastes**

4.6.1 Wastes shall only be stored on the site in accordance with condition 1.1.1 of this licence and section 4.7.2 of the working plan.

4.6.2 Sharps shall only be accepted for storage and shall only be stored in secure labelled containers designed for sharps transport. Sealed bags and containers for onward transfer shall not be opened on site without the express permission of the Agency.

4.7 **Waste treatment process – process, plant and equipment and procedures**

Incineration of waste

4.7.1 The incineration of waste shall only be carried out on the site in accordance with section 4.6 of the working plan and the standards in table 4.7.1.

Table 4.7.1 Standards for Waste Incineration

| Process requirement | Specified standards |
|-------------------------|---|
| Testing | Testing shall be carried out in accordance with manufacturers/suppliers recommendations and section 4.6.4 of the Working Plan. A record of each testing exercise shall be retained on site and copies made available to the Agency on request. |
| Commissioning | Commissioning shall be carried out in accordance with manufacturers/suppliers recommendations and section 4.6.4 of the Working Plan. A record of each testing exercise shall be retained on site and copies made available to the Agency on request. |
| Operation | The incinerator shall be operated at all times to ensure that exhaust gasses are retained in the secondary combustion chamber for at least two seconds at a temperature in excess of 850°C and with an oxygen content of more than 6%. Visible smoke emissions are permitted only at the time of start-up. |
| Maintenance | The incinerator shall be maintained and repaired in accordance with section 4.6.5 of the working plan a note shall be made in the site diary whenever repair or maintenance work is carried out |
| Process Quality Control | Waste shall be incinerated at a rate of no more than 50Kg/hr The secondary combustion chamber shall be controlled in such a manner that exhaust gasses are i) maintained at a temperature of at least 850°C ; ii) with an oxygen content of more than 6%; and iii) with at least two seconds residence time. Process monitoring results shall be logged in accordance with section 5.1 of the working plan. The results shall be inspected and any instance when the above standards are not maintained shall be noted in the site diary and reported to the Agency along with the site returns. |

4.8 **Removal of residual wastes from site**

4.8.1 In the event that the specified waste management operations on the site cease and the Agency has reasonable grounds to believe that they will not be resumed within 6 months then, notwithstanding the operational limits on storage times of wastes specified in the other conditions of this licence, the licence holder shall ensure that all wastes remaining on the site shall be removed by the date specified by the Agency in writing. This shall include, where required by the Agency, decontamination of plant, equipment and engineered containment used in the specified waste management operations, but] shall not apply to any wastes which have been disposed of on the site in accordance with the other conditions of this licence or prior to the issue of this licence.

Pollution control, monitoring and reporting

Note: No conditions necessary under this section.

Amenity management monitoring and reporting

6.1 **Control, monitoring and reporting of dusts, fibres and particulates**

6.1.1 Measures shall be implemented and maintained throughout the operational life of the site to control and monitor emissions of dusts, fibres and particulates from the site, in accordance with this condition and section 6.1 of the working plan. The objective of these measures shall be to minimise the release of airborne dusts, fibres and particulates arising from the specified waste management operations onto public areas outside the site, which shall include public highways and areas of public access outside the site beyond the site boundary, and to prevent releases in such quantities or concentrations that are likely to cause pollution of the environment or harm to human health or serious detriment to the amenity of the locality.

6.1.2 All emissions to air from the specified waste management operations on the site shall be free from visible concentrations of dusts, fibres or particulates as are likely to cause pollution of the environment or harm to human health or serious detriment to the amenity of the locality outside the site boundary.

6.1.3 In the event that any dusts, fibres or particulates arising from the site are released or are likely to be released onto public areas outside the site boundary in such quantities or concentrations that they are likely to cause pollution of the environment or harm to human health or serious detriment to the amenity of the locality, the actions specified in section 6.1 of the working plan, shall be implemented immediately.

6.2 **Control of odours**

6.2.1 Measures shall be implemented and maintained throughout the operational life of the site to control and monitor emissions of odours from the site, in accordance with this condition and section 6.2 of the working plan.

6.2.2 All emissions to air from the specified waste management operations on the site shall be free from odours at levels as are likely to cause pollution of the environment or harm to human health or serious detriment to the amenity of the locality outside the site boundary, as perceived by an authorised officer of the Agency.

6.2.3 In the event that any odours arising from the site are released or are likely to be released onto public areas outside the site boundary at such levels that they are likely to cause pollution of the environment or harm to human health or serious detriment to the amenity of the locality, the actions specified in section 6.2.2 of the working plan shall be implemented immediately.

6.3 **Control of noise**

6.3.1 Measures shall be implemented and maintained throughout the operational life of the site, to control and minimise the levels of noise from operations on the site beyond the site boundary.

6.3.2 In the event that any noise arises from the site at such levels likely to cause harm to human health or serious detriment to the amenity of the locality outside the site boundary, as perceived by an authorised officer of the Agency, an action plan shall be produced and submitted to the Agency for agreement within 7 days of a request by the Agency.

6.4 **Control of pest infestations**

6.4.1 Measures shall be implemented and maintained throughout the operational life of the site to control and monitor the presence of pests on the site, in accordance with section 6.3 of the working plan.

6.5 **Control of scavenging birds and other scavengers**

6.5.1 Measures shall be implemented and maintained throughout the operational life of the site to control and monitor the presence of scavenging birds and other scavengers on the site, in accordance with section 6.4 of the working plan.

6.6 **Control of litter**

6.6.1 Measures shall be implemented and maintained throughout the operational life of the site to control and monitor the escape of litter from the confines of the site, in accordance with section 6.5 of the working plan.

6.6.2 In the event that litter does escape from the site, it shall be retrieved immediately.

7 Site records

7.1 Security and availability of records

Security of records

- 7.1.1 All records which are required to be made under the other conditions of this licence and the working plan shall be maintained and kept secure from loss, damage or deterioration, and shall be kept in accordance with section 7.1 of the working plan.

Availability of records

- 7.1.2 All records which are required to be made under the other conditions of this licence and the working plan shall be made available for inspection at the place where they are kept immediately when required by an authorised officer of the Agency.

7.2 Records of waste movements

Recording of wastes accepted and removed

- 7.2.1 A record shall be kept of all wastes received and of all materials (wastes and recovered materials) removed from the site. The records shall include the following for each vehicle load of waste/material:

for waste received:

- a** origin of waste
- b** date received
- c** quantities in tonnes received and waste type
- d** nature of the waste (solid, liquid or sludge)

for waste/material removed:

- e** date removed
- f** quantities in tonnes removed and waste and/or material type
- g** destination of waste and/or materials removed
- h** nature of the waste and/or materials (solid, liquid or sludge)

- 7.2.2 A summary of the information, including nil returns, shall be submitted to the Agency, in the format specified by the Agency in Annex 1, which forms part of this condition. Summaries shall be for each quarter of the financial year and shall be submitted to the Agency within one month of the end of each quarter.

7.3 Site diary

- 7.3.1 A site diary shall be kept secure and shall be available for inspection at the site when required by an authorised officer of the Agency. This shall include a record of the following events:

- a** construction work;
- b** maintenance;

-
- c** breakdowns;
 - d** emergencies;
 - e** problems with waste received and action taken;
 - f** site inspections carried out by the operator;
 - g** despatch of records to the Agency;
 - h** severe weather conditions;
 - i** environmental problems and remedial actions.
 - j** failure to meet specified standards
 - k** the times of attendance of the technically competent manager on site

Each record shall be completed within 24 hours of the relevant event.

Interpretation

In these conditions and their interpretation, unless the context otherwise requires, the following terms have the specified meanings:

“accepted”

for waste being delivered to the site, shall mean accepted as waste input to the site for storage and/or processing and/or disposal under the specified waste management operations;

“authorised officer of the Agency”

means any person(s) authorised in writing by the Agency pursuant to section 108(1) of the 1995 Act to exercise any of the powers specified in subsection (4) of that section;

“clinical waste”

has the meaning as defined in regulation 1(2) of the Controlled Waste Regulations 1992 or any statutory provisions amending or replacing them;

“consequences”

for **risk assessments** carried out within these conditions, means the adverse effects of harm as a result of realising a **hazard** which cause the quality of human health (other than health and safety of site staff or visitors to the site covered under the Health and Safety at Work Act 1974) or the environment to be impaired in the short or longer term;

“engineer”

for engineering works specified in these conditions, means a person who works in the relevant branch of engineering, as a qualified professional;

“engineered”

for works specified in these conditions, means carried out and completed using the relevant engineering process specified in these conditions;

“engineered site containment and drainage system”

means all elements relating to engineered containment of activities on the site, other than final disposal to land, and incorporating site surfacing, bunding and drainage systems, buildings and fixed tanks;

“engineering”

for engineering works specified in these conditions, means the relevant process of design, construction or installation, quality assurance or validation or commissioning specified in these conditions;

“environmental targets or receptors”

for **risk assessments** carried out within these conditions, shall mean identified human and environmental populations or components, as specified in these conditions or otherwise agreed by the Agency within these conditions;

“groundwater”

means any water contained in underground strata;

“hazard”

means a property or situation that in particular circumstances could lead to harm;

"immediately"

for carrying out of actions under the conditions, shall mean without delay and within a reasonable time, taking into account any more immediate direct action necessary to prevent or minimise risk to human health and the environment. For carrying out notifications to the Agency, shall also mean by the fastest effective means available (for example, telephone) and confirmed in writing within 1 working day (or such other time as may be agreed by the Agency within the conditions);

"maintenance"

for engineering maintenance specified in these conditions, means the process of inspection, testing, repair of the relevant engineering works specified in these conditions;

"preparatory works"

means engineering works required prior to the carrying out of the activities authorised by this licence;

"probability"

means the quantified expression of chance, denoted either as:

- the ratio or percentage of the occurrence of a particular event as one among a number of possible events;
- or as the frequency of occurrence of a particular event in a given period of time;

"received"

for waste being delivered to the site, shall mean delivered to the site and undergoing the waste acceptance procedures specified in the working plan, including storage of those wastes during those procedures prior to acceptance of the waste;

"release pathways"

for **risk assessments** carried out within these conditions, shall mean the routes by which defined **hazards** may potentially realise their **consequences**, defined in terms of releases or emissions from the site that go beyond the site containment or boundary via one or more of the following routes, either directly or indirectly: **Land; Groundwater; Surface water; Atmosphere;**

"relevant offences"

are offences within the meaning of regulation 3 of the Waste Management Licensing Regulations 1994 or any statutory provisions or regulations amending or replacing them;

"risk"

means a combination of the **probability** and **consequences** of occurrence of a defined **hazard**;

"risk assessment"

means the systematic identification, analysis, estimation and evaluation within a defined **scope** of the defined **risks** of a particular activity, operation, process or design, carried out and reported by suitably qualified or competent persons, using recognised quantified or semi-quantified methods and techniques.

Unless otherwise agreed by the Agency within these conditions, a risk assessment shall include and record the following:

- definition of the **hazards** associated with an activity, operation, process or design;
- assessment of the **probability** of those **hazards** occurring;
- determination of the potential **consequences** of those hazards for defined **environmental targets or receptors**, taking into account defined **release pathways** and defined protective measures;
- evaluation of the potential **magnitude** of those consequences and the **probability** of their occurrence;

"scope of risk assessment"

means the boundaries of the **risk assessment** and the **risks** to be assessed within those boundaries, as defined in the conditions or otherwise agreed by the Agency within the conditions;

"special waste"

has the meaning as defined by regulation 2 of the Special Waste Regulations 1996 or any statutory provisions or regulations amending or replacing them;

"specified waste management operations"

means the waste management operations authorised by condition 1.1 of this licence;

"the 1994 Regulations"

means the Waste Management Licensing Regulations 1994 and any statutory provisions or regulations amending or replacing them.

"the Agency"

means the Environment Agency;

"the Licence Holder"

means the Licence Holder specified in this licence or other person to whom the licence has been transferred in accordance with section 40 of the Environmental Protection Act 1990;

"the operator"

means a person who is in occupation of the site and has responsibility for carrying out day to day activities at the site;

"the site"

means the land, structures, plant and equipment to which this licence relates;

"time periods, e.g. annually, quarterly, monthly, per year, etc. "

Where periods are referred to in conditions, they shall be calculated in the following way:

- annually or per year: 1 April to 31 March;
- quarterly: 1 April to 30 June, 1 July to 30 September, 1 October to 31 December, 1 January to 31 March;
- monthly: calendar month;
- weekly: Monday to Sunday.

Where the issue of the licence does not coincide with the start of any of these periods, then any relevant limits for the first period shall apply pro rata;

"waste"

means controlled waste as defined in section 75(4) of the 1990 Act and the Controlled Waste Regulations 1992 or any statutory provisions or regulations amending or replacing them;

"working plan"

means the working plan identified in writing by the Agency at the time of issue of this licence and any subsequent amendments to it made in accordance with the conditions of this licence.

ANNEX 1

Instructions on the format for the summary waste record returns required in Licence condition 7.2

Introduction

Your waste management licence condition no. 7.2 requires you to provide to the Agency a summary of the records which you must keep of all wastes received and of all waste materials removed from the site. This set of instructions specifies the format of the summary which is required by the Agency. A standard form is provided (Ref. 00/IA) which you must use when completing summary returns to comply with the licence condition. Please retain it as a master and photocopy it each time you make a return. An electronic version is available on request.

Waste type and quantity

You are required to identify waste types according to the categories specified in the accompanying list (Ref.00/IB). This shows how particular waste streams fit in to the classification system. Most licensed sites will find that they are only dealing with a small number of categories of material and it is worth looking through the list carefully to identify the waste groups that you handle at your site.

Waste quantity needs to be provided in metric tonnes. A density conversion list is provided to allow bulk loads to be converted to tonnes on sites without weighing equipment.

District of Origin/Destination

You are required to identify the source and destination of the waste by local authority District. This information can be found from transfer notes, from the driver of the vehicle or maybe within your own record systems if you are operating vehicles yourself. A list of three letter codes for all the Unitary Authorities in Wales and adjacent English authorities is attached. The local authority Districts in your immediate area are entered on your site return form, as it is likely that these are the main sources of material entering the site. Use the code list to add in any extra areas required, or write in the District name in full.

Your Legal Responsibility

Your licence condition requires you to keep a record of each load of waste/material entering your site and each load of waste or reclaimed material leaving the site. A summary of this information has to be provided to the Agency on a quarterly basis (or on an annual basis for metal recycling facilities).

Daily site records

For waste/material entering the site you need to record

- the date and time of the movement;
- the district of origin;
- the type and quantity; and
- whether it is solid/liquid or sludge i.e. the physical state of the waste.

For all wastes/materials leaving the site (for either recovery or disposal) you must record

- the date and time of the movement;
- the destination district;
- the type and quantity; and
- whether it is solid/liquid or sludge.

You may be using a record sheet at present, or a ticketing system, and provided this allows you to record all of the information required by the licence condition, this will be an appropriate form. For

those who do not have a suitable system, we have enclosed an example daily record sheet for you to use.

Quarterly Returns

The standard quarterly return form allows small and large sites to describe the wastes and other materials entering and leaving their site.

Most sites handle a limited range of wastes and only need to complete a relatively small part of the return form. Inert landfill sites have been supplied with a reduced form that reflects the very limited types of waste they handle.

Although the Agency has asked for quarterly returns, it is advisable for this analysis to be done more frequently: perhaps weekly or monthly.

Metal Recycling Sites (MRS's) will only have to make returns on an annual basis at present. A separate form is supplied for this purpose.

General Information

The first part of the form is asking for general information to identify the site. It is also necessary to indicate whether materials are weighed in and out of the site, or whether weights are estimated.

It is advisable to complete most of this section, other than the quarter and year, prior to photocopying and use this as your master form.

Section 1: Waste/materials entering the site

Summarise the information on your daily record system to provide the total amount of waste in each category received from every different District of origin. Please note that the waste categories are exclusive (i.e. construction wastes should not be included in the category for general mixed industrial wastes).

An example of a completed section 1 is shown in the following pages.

Section 2 – Waste materials taken off site for disposal elsewhere

You may have a major transfer station producing a large range of sorted waste materials for disposal elsewhere; or an inert landfill site with an occasional load of contrary material that needs to leave the site for disposal elsewhere; or another type of facility where wastes leave your site for final disposal elsewhere.

Your licence requires you to keep a record of all loads of leaving the site for disposal elsewhere, stating waste type, quantity, state and District of destination. Use the code sheets to decide which category of waste each load falls into and the District of destination code.

An example Section 2 return is shown in the following pages. If you have no wastes leaving the site for disposal elsewhere this quarter, write NIL across the sheet. If you need more space to write in a larger number of waste groups, photocopy the Section 2 page to make a continuation sheet.

Section 3 – Materials taken off site for recycling

This section is completed in exactly the same way as Section 2, but is for wastes leaving the site for recycling.

Example 3 in the following pages shows the output of waste materials for recycling from a metal recycling site.

If you have no wastes leaving for recycling, write NIL across the sheet. If you need more space to write in a larger number of waste groups, photocopy the Section 3 page to make a continuation sheet.

IF YOU ARE A METAL RECYCLING SITE, PLEASE SKIP THE NEXT TWO PARAGRAPHS & GO TO THE HEADING 'FOR METAL RECYCLING SITES ONLY'

Section 4 – This section is optional and applies to landfill sites only. The information will be essential for the development of the future Waste Strategy for Wales and is required by planning authorities for future development planning for waste management facilities.

Section 5 – You **MUST** complete the declaration, and then send the return to your area office within one month following the end of the quarter. The address of the area office is provided at the end of this section of the quantity return sheet

FOR METAL RECYCLING SITES ONLY

Section 4 – For Metal Recycling Sites, you must return the form within one month of the end of the financial year. The address of the area office is provided at the end of this section of the quantity return sheet

Help

If you require any further information on any of these issues please call the Environment Agency general enquiry line on 0845 9333111.

Accompanying documents

The following accompanying documents should be used in association with this set of instructions:

- i) *Environment Agency North Wales/South East Wales/South West Wales/Upper Severn Area Section 35 EPA Quarterly return - Ref. 00/IA.* (you must complete this form when making your summary return to the Agency)
- ii) *Waste Categories for Wales - Ref. 00/IB* [on blue paper] (you must use these categories when completing the summary return form)
- iii) *Factors to Convert Waste Volume to Weight* [on green paper] (you can use these conversion factors when converting volume to weight)
- iv) *District Codes* [on pink paper] (you must use these codes when completing the summary return form)
- v) *Example Sheet for Recording Daily Loads In/Out* (this is not a mandatory form but you could use it to satisfy the Agency's requirements for daily input/output records)

EXAMPLE 1: RECEIPT OF MATERIALS ONTO SITE

SECTION 1 MATERIALS TAKEN INTO SITE

| Waste Type | State | District of Origin | | | | (Within Wales - see district code list) | | | | (Outside Wales - see attached list) | | | | Total Tonnes | |
|--|--------|--------------------|--------|----------|----------|---|--------|--------|--------|-------------------------------------|---|--------|--------|--------------|-------------------|
| | | ANG | CON | DEN | FLI | GWY | POW | WRE | | CHE | | | | | |
| 21A Inert Construction and Demolition waste | Solid | 567.40 | | 402.36 | 126.13 | | | | | | | | 89.65 | | 1185.54 |
| | | | | | | | | | | | | | | | |
| 22A Degradable Construction and Demolition waste | Solid | 703.50 | | | 908.53 | | 987.57 | | | | | | 203.79 | | 2,803.39 |
| | Sludge | | | | | 26.12 | | | 14.32 | | | | | | 40.44 |
| 22C Degradable Household | Solid | | 939.26 | 898.30 | 816.54 | | | | 789.32 | | | | | | 3443.42789. 32 |
| | | | | | | | | | | | | | | | |
| 22D Degradable Commercial | Solid | 169.34 | | 27.45 | 901.35 | | | | | | | | | | 1,098.14 |
| | Liquid | | | | | | | | 62.97 | | | | | | 62.97 |
| | Sludge | | 27.07 | | | | 45.87 | | | | | 903.70 | | | 976.64 |
| TOTAL | | | | | | | | | | | | | | | |
| Total For | Solid | 1440.24 | 939.26 | 1,328.11 | 2,752.55 | 0 | 987.57 | 789.32 | 0 | 0 | 0 | 0 | 293.44 | 0 | 8,530.49 |
| Each Area | Liquid | 0 | 0 | 0 | 0 | 0 | 0 | 62.97 | 0 | 0 | 0 | 0 | 0 | 0 | 62.97 |
| | Sludge | 0 | 27.07 | 0 | 0 | 26.12 | 45.87 | 14.32 | 0 | 0 | 0 | 0 | 903.70 | 0 | 1017.08 |

A variety of materials are received on site from the different areas. These materials are tallied both to provide the total amount of each waste type and the total waste for each area (both for each type and a grand total). Waste should be added by type, state and by district. Do not mix solid, liquid and sludge wastes.

EXAMPLE 2: DISPOSAL OF MATERIALS OFF SITE

SECTION 2 MATERIALS TAKEN OFF SITE FOR DISPOSAL ELSEWHERE

| Waste Type | State | Destination | | | | | | (Within Wales - see attached list) | | | | | | (Outside Wales - see attached list) | | | | | | Total Tonnes | | | | |
|---|--------|--------------|--------|-----|--------|--------|--------|------------------------------------|-----|-----|------|--------|--------|-------------------------------------|-----|-----|-----|-----|-----|--------------|-----|-----|--------|---------|
| | | ANG | CON | DEN | FLI | GWY | POW | WRE | ANG | CON | DEN | FLI | GWY | POW | WRE | ANG | CON | DEN | FLI | | GWY | POW | WRE | |
| 21A Inert Construction and Demolition waste | Solid | | 809.07 | | 574.93 | 982.71 | | | | | | | | | | | | | | | | | | 2366.71 |
| 22A Degradable Construction and Demolition waste | Solid | 703.50 | | | | | | | | | | 987.57 | | | | | | | | | | | 203.79 | 1894.86 |
| | Sludge | | 47.89 | | | 26.12 | | | | | | | | | | | | | | | | | | 74.01 |
| 22C Degradable Household | Solid | 997.65 | | | | | | | | | | | 789.32 | | | | | | | | | | 456.98 | 2243.95 |
| 25 Healthcare Risk Wastes | Solid | | | | | | | | | | 4.00 | | | | | | | | | | | | | 4.00 |
| | Liquid | | | | | | | | | | | | | | | | | | | | | | | |
| | Sludge | | | | | | | | | | | | | | | | | | | | | | | |
| Total For | Solid | 1701.15 | 809.07 | 0 | 578.93 | 982.71 | 987.57 | 789.32 | 0 | 0 | 0 | 0 | 0 | 0 | 0 | 0 | 0 | 0 | 0 | 0 | 0 | 0 | 660.77 | 6509.52 |
| Each Area | Liquid | 0 | 0 | 0 | 0 | 0 | 0 | 0 | 0 | 0 | 0 | 0 | 0 | 0 | 0 | 0 | 0 | 0 | 0 | 0 | 0 | 0 | 0 | 0 |
| | Sludge | 0 | 47.89 | 0 | 0 | 26.12 | 0 | 0 | 0 | 0 | 0 | 0 | 0 | 0 | 0 | 0 | 0 | 0 | 0 | 0 | 0 | 0 | 0 | 74.01 |
| | | TOTAL | | | | | | | | | | | | | | | | | | | | | | |

Please indicate the destination of all wastes. Do not include RECYCLED wastes. Additional waste types can be added in spare sections at the bottom of the section. Do not mix solid, liquid and sludge wastes in the totals.

EXAMPLE 3: OUTPUT OF MATERIALS FROM A METAL RECYCLING SITE

SECTION 3 MATERIALS TAKEN OFF SITE FOR RECYCLING

| Waste Type | State | (Outside Wales - see attached list) | | | | | | | | | | Total Tonnes | | | | | |
|---|--------|-------------------------------------|--------|--------|--------|--------|--------|--------|--|--|--|--------------|-----|--|-------|--|----------|
| | | ANG | CON | DEN | FLI | GWY | POW | WRE | | | | | CHE | | | | |
| Waste Type / Code | | | | | | | | | | | | | | | | | |
| 23A Metals and Discarded (Scrap) Composite Equip Special Waste | Solid | 87.61 | 547.04 | 876.12 | | 397.07 | | | | | | | | | 40.21 | | 2,437.42 |
| Waste Type / Code | | | | | | | | | | | | | | | | | |
| 23B Metals and Discarded (Scrap) Composite Equip Other Waste | Solid | | 407.67 | 87.35 | 706.15 | | 406.74 | | | | | | | | | | 1,607.91 |
| Waste Type / Code | | | | | | | | | | | | | | | | | |
| 29B Organic Chemicals Other | Solid | | | | | | | | | | | | | | | | |
| | Liquid | | | 27.03 | | | | | | | | | | | | | 27.03 |
| | Sludge | | | | | | | | | | | | | | | | |
| Waste Type / Code | | | | | | | | | | | | | | | | | |
| | Solid | | | | | | | | | | | | | | | | |
| | Liquid | | | | | | | | | | | | | | | | |
| | Sludge | | | | | | | | | | | | | | | | |
| Total For | Solid | 87.61 | 954.71 | 963.47 | 706.15 | 397.07 | 406.74 | 489.37 | | | | | | | 40.21 | | 4,045.33 |
| Each Area | Liquid | 0 | 0 | 27.03 | 0 | 0 | 0 | 0 | | | | | | | 0 | | 27.03 |
| | Sludge | 0 | 0 | 0 | 0 | 0 | 0 | 0 | | | | | | | 0 | | 0 |

Please indicate the destination of all wastes. Do not include waste that is taken off site for DISPOSAL.

Under **29B** Organic Chemicals, Other wastes such as oil can be entered and recorded as going to a recycling site. In this instance, 27.03 tonnes of oil has been sent for recycling. Additional waste types can be added in the spare sections at the bottom of the section. Do not mix solid, liquid and sludge wastes in the total.