



**Cyfoeth
Naturiol**
Cymru
**Natural
Resources**
Wales

Permit with introductory note

The Environmental Permitting (England & Wales) Regulations 2016

Cowbridge Compost Limited

The Lodge

Llwynhelig

Gibbotts Hill

Cowbridge

Vale of Glamorgan

CF71 7FF

Permit number

EPR/BP3095SR

The Lodge

Permit number EPR/BP3095SR

Introductory note

This introductory note does not form a part of the permit

The main features of the permit are as follows.

This is a Tier 3 bespoke permit for:

- Open Windrow Composting (A1)
- Waste Transfer Station (A2)

Treatment operations are limited to:

- A1- composting, maturation, manual separation, sorting, shredding, screening, and bagging for recovery purposes only; and
- A2- storing and bulking up for onwards transfer only, for recovery or disposal purposes.

Permitted waste types:

- A1- green and plant wastes
- A2- municipal waste

No hazardous waste is permitted to be accepted.

The maximum quantity of waste accepted and processed on site shall not exceed 35,000 tonnes per year.

The A1 activity is subject to Section 5.4 A (1)(b)(i) of the Environmental Permitting Regulations – biological treatment of non-hazardous waste for recovery (with a capacity exceeding 75 tonnes per day). Therefore, treatment limits have been included in Table S1.1 of this permit to reflect that the permit has been assessed on the basis that it is a waste facility, and to therefore prevent the site from operating over this threshold, and becoming an installation.

This permit does not allow any point source emission into surface waters or groundwater.

Liquids from the open windrow activity (A1) drain to a leachate storage tank and the leachate is spread to land in accordance with a suitable environmental permit, subsequent approved deployments and in accordance with the Department for Environment, Food and Rural Affairs (DEFRA) Code of Good Agricultural Practice.

Any liquids from the waste transfer station activity (A2) is collected via a sealed sump system and tankered off site to a suitably authorised facility.

Clean surface water from roofs, or from areas of the site that are not being used in connection with storing and treating waste, may be discharged directly to surface waters, or to groundwater by seepage through the soil via a soakaway.

All emissions from the activity which are not controlled via actual emission limits, are controlled through the 'emission of substances not controlled by emission limits condition' and any all relevant process requirements set out in Tables S1.1 and S1.2.

The burning of any wastes, either in the open, inside buildings or in any form of incinerator is not permitted.

The status log of the permit sets out the permitting history, including any changes to the permit reference number.

Status log of the permit		
Description	Date	Comments
Application EPR/BP3095SR/A001 determined	19/02/09	Permit Issued to Cowbridge Compost Limited for standard rules in-vessel composting facility.
Application EPR/BP3095SR/V002	25/07/11	Application to vary permit boundary received and returned.
Application EPR/BP3095SR/V003	20/09/11	Application to vary permit boundary received and returned.
Variation determined EPR/BP3095SR/V004	10/05/12	Variation to include open windrow composting, extend site boundary and increase throughput issued to Cowbridge Compost Limited.
Variation determined EPR/BP3095SR/V005	04/02/15	Varied and consolidated permit to include additional waste streams, change treatment processes, increase the amount of waste permitted within the open windrow system and increase permitted area to include leachate storage tank, issued to Cowbridge Compost Limited.
Variation application EPR/BP3095SR/V006	Duly Made 23/03/18	An operator led variation to: <ul style="list-style-type: none"> - add waste transfer station activity; - remove closed vessel composting activity; and - to update the permit into modern format (updating consolidation).
Additional information received in response to Schedule 5 notice	26/04/18	Consisting of: <ul style="list-style-type: none"> - Fire prevention and mitigation plan (updated) - Odour management plan (updated)
	30/04/18	Consisting of: <ul style="list-style-type: none"> - Information on decommissioning of closed vessel composting activity - Odour management plan (updated) - Fire prevention and mitigation plan (updated) - Environment management system (updated)
	08/05/18	Consisting of outlet for waste (Fire prevention and mitigation plan)
Variation issued EPR/BP3095SR	11/05/18	Varied and consolidated permit issued to Cowbridge Compost Limited.

End of introductory note

Permit

The Environmental Permitting (England and Wales) Regulations 2016

Permit number

EPR/BP3095SR

The Natural Resources Body for Wales (“Natural Resources Wales”) authorises, under regulation 13 of the Environmental Permitting (England and Wales) Regulations 2016

Cowbridge Compost Limited (“the operator”),

whose registered office is

The Lodge

Llwynhelig

Gibbotts Hill

Cowbridge

Vale of Glamorgan

CF71 7FF

company registration number **06240181**

to operate waste operations at

The Lodge

Llwynhelig

Gibbotts Hill

Cowbridge

Vale of Glamorgan

CF71 7FF

to the extent authorised by and subject to the conditions of this permit.

Name	Date
Huw Davies	11/05/2018

Authorised on behalf of Natural Resources Wales

Conditions

1 Management

1.1 General management

- 1.1.1 The operator shall manage and operate the activities:
- (a) in accordance with a written management system that identifies and minimises risks of pollution, including those arising from operations, maintenance, accidents, incidents, non-conformances, closure and those drawn to the attention of the operator as a result of complaints; and
 - (b) using sufficient competent persons and resources.
- 1.1.2 Records demonstrating compliance with condition 1.1.1 shall be maintained.
- 1.1.3 Any person having duties that are or may be affected by the matters set out in this permit shall have convenient access to a copy of it kept at or near the place where those duties are carried out.
- 1.1.4 The operator shall comply with the requirements of an approved competence scheme.

1.2 Avoidance, recovery and disposal of wastes produced by the activities

- 1.2.1 The operator shall take appropriate measures to ensure that:
- (a) the waste hierarchy referred to in Article 4 of the Waste Framework Directive is applied to the generation of waste by the activities; and
 - (b) any waste generated by the activities is treated in accordance with the waste hierarchy referred to in Article 4 of the Waste Framework Directive; and
 - (c) where disposal is necessary, this is undertaken in a manner which minimises its impact on the environment.
- 1.2.2 The operator shall review and record at least every four years whether changes to those measures should be made and take any further appropriate measures identified by a review.

2 Operations

2.1 Permitted activities

- 2.1.1 The operator is only authorised to carry out the activities specified in schedule 1 table S1.1 (the “activities”).

2.2 The site

- 2.2.1 The activities shall not extend beyond the site, being the land shown edged in green on the site plan at schedule 7 to this permit.

2.3 Operating techniques

- 2.3.1 (a) The activities shall, subject to the conditions of this permit, be operated using the techniques and in the manner described in the documentation specified in schedule 1, table S1.2, unless otherwise agreed in writing by Natural Resources Wales.
- (b) If notified by Natural Resources Wales that the activities are giving rise to pollution, the operator shall submit to Natural Resources Wales for approval within the period specified, a revision of any plan or other documentation ("plan") specified in schedule 1, table S1.2 or otherwise required under this permit which identifies and minimises the risks of pollution relevant to that plan, and shall implement the approved revised plan in place of the original from the date of approval, unless otherwise agreed in writing by Natural Resources Wales.
- 2.3.2 Waste shall only be accepted if:
- (a) it is of a type and quantity listed in schedule 2 table(s) S2.1 [, S2.2 etc.]; and
- (b) it conforms to the description in the documentation supplied by the producer and holder.

2.4 Improvement programme

- 2.4.1 The operator shall complete the improvements specified in schedule 1 table S1.3 by the date specified in that table unless otherwise agreed in writing by Natural Resources Wales.
- 2.4.2 Except in the case of an improvement which consists only of a submission to Natural Resources Wales, the operator shall notify Natural Resources Wales within 14 days of completion of each improvement.

3 Emissions and monitoring

3.1 Emissions to water, air or land

- 3.1.1 There shall be no point source emissions to water, air or land except from the sources and emission points listed in schedule 3 tables S3.1.
- 3.1.2 The limits given in schedule 3 shall not be exceeded.

3.2 Emissions of substances not controlled by emission limits

- 3.2.1 Emissions of substances not controlled by emission limits (excluding odour) shall not cause pollution. The operator shall not be taken to have breached this condition if appropriate measures, including, but not limited to, those specified in any approved emissions management plan, have been taken to prevent or where that is not practicable, to minimise, those emissions.
- 3.2.2 The operator shall:
- (a) if notified by Natural Resources Wales that the activities are giving rise to pollution, submit to Natural Resources Wales for approval within the period specified, an emissions management plan which identifies and minimises the risks of pollution from emissions of substances not controlled by emission limits;
- (b) implement the approved emissions management plan, from the date of approval, unless otherwise agreed in writing by Natural Resources Wales.

- 3.2.3 All liquids in containers, whose emission to water or land could cause pollution, shall be provided with secondary containment, unless the operator has used other appropriate measures to prevent or where that is not practicable, to minimise, leakage and spillage from the primary container.

3.3 Odour

- 3.3.1 Emissions from the activities shall be free from odour at levels likely to cause pollution outside the site, as perceived by an authorised officer of Natural Resources Wales, unless the operator has used appropriate measures, including, but not limited to, those specified in any approved odour management plan, to prevent or where that is not practicable to minimise the odour.

3.4 Noise and vibration

- 3.4.1 Emissions from the activities shall be free from noise and vibration at levels likely to cause pollution outside the site, as perceived by an authorised officer of Natural Resources Wales, unless the operator has used appropriate measures, including, but not limited to, those specified in any approved noise and vibration management plan to prevent or where that is not practicable to minimise the noise and vibration.
- 3.4.2 The operator shall:
- (a) if notified by Natural Resources Wales that the activities are giving rise to pollution outside the site due to noise and vibration, submit to Natural Resources Wales for approval within the period specified, a noise and vibration management plan which identifies and minimises the risks of pollution from noise and vibration;
 - (b) implement the approved noise and vibration management plan, from the date of approval, unless otherwise agreed in writing by Natural Resources Wales.

3.5 Pests

- 3.5.1 The activities shall not give rise to the presence of pests which are likely to cause pollution, hazard or annoyance outside the boundary of the site. The operator shall not be taken to have breached this condition if appropriate measures, including, but not limited to, those specified in any approved pests management plan, have been taken to prevent or where that is not practicable, to minimise the presence of pests on the site.
- 3.5.2 The operator shall:
- (a) if notified by Natural Resources Wales, submit to Natural Resources Wales for approval within the period specified, a pests management plan which identifies and minimises risks of pollution, hazard or annoyance from pests;
 - (b) implement the pests management plan, from the date of approval, unless otherwise agreed in writing by Natural resources Wales.

3.6 Fire

- 3.6.1 The operator shall manage and operate the activities in accordance with a written fire prevention plan using the current, relevant fire prevention plan guidance.
- 3.6.2 The operator shall:
- (a) if notified by Natural Resources Wales that the activities could cause a fire risk, submit to Natural Resources Wales a fire prevention plan which identifies and minimises the risks of fire;

- (b) Operate the activity in accordance with the fire prevention plan, from the date of submission, unless otherwise agreed in writing by Natural Resources Wales.

3.7 Monitoring

- 3.7.1 The operator shall, unless otherwise agreed in writing by Natural Resources Wales, undertake the monitoring specified in the following tables in schedule 3 to this permit:
 - (a) process monitoring specified in table S3.2 and S3.3;
 - (b) bioaerosol monitoring specified in table S3.4;
- 3.7.2 The operator shall maintain records of all monitoring required by this permit including records of the taking and analysis of samples, instrument measurements (periodic and continual), calibrations, examinations, tests and surveys and any assessment or evaluation made on the basis of such data.
- 3.7.3 Monitoring equipment, techniques, personnel and organisations employed for the emissions monitoring programme and the environmental or other monitoring specified in condition 3.3.1 shall have either MCERTS certification or MCERTS accreditation (as appropriate), where available, unless otherwise agreed in writing by Natural Resources Wales.
- 3.7.4 Permanent means of access shall be provided to enable sampling/monitoring to be carried out in relation to the emission points specified in schedule 3 tables S3.1, S3.2 [,S3.3 etc.] unless otherwise agreed in writing by Natural Resources Wales.

4 Information

4.1 Records

- 4.1.1 All records required to be made by this permit shall:
 - (a) be legible;
 - (b) be made as soon as reasonably practicable;
 - (c) if amended, be amended in such a way that the original and any subsequent amendments remain legible, or are capable of retrieval; and
 - (d) be retained, unless otherwise agreed in writing by Natural Resources Wales, for at least 6 years from the date when the records were made, or in the case of the following records until permit surrender:
 - (i) off-site environmental effects; and
 - (ii) matters which affect the condition of the land and groundwater.
- 4.1.2 The operator shall keep on site all records, plans and the management system required to be maintained by this permit, unless otherwise agreed in writing by Natural Resources Wales.

4.2 Reporting

- 4.2.1 The operator shall send all reports and notifications required by the permit to Natural Resources Wales using the contact details supplied in writing by Natural Resources Wales.

- 4.2.2 Within one month of the end of each quarter, the operator shall submit to Natural Resources Wales using the form made available for the purpose, the information specified on the form relating to the site and the waste accepted and removed from it during the previous quarter.
- 4.2.3 Within 28 days of the end of the reporting period the operator shall, unless otherwise agreed in writing by Natural Resources Wales, submit reports of the monitoring and assessment carried out in accordance with the conditions of this permit, as follows:
- (a) in respect of the parameters and emission points specified in schedule 4 table S4.1;
 - (b) for the reporting periods specified in schedule 4 table S4.1 and using the forms specified in schedule 4 table S4.2; and
 - (c) giving the information from such results and assessments as may be required by the forms specified in those tables.
- 4.2.4 The operator shall submit to Natural Resources Wales a bi-annual report of the efficiency of the biofilter in the first year of compost operations. This shall include but not be limited to, the assessment of the efficiency to reduce odours, the summary of maintenance and any recommissioning planned or conducted, assessment of back pressure, venting and cracking. Thereafter the operator shall submit the report within one month of the end of each year, unless otherwise agreed in writing by Natural Resources Wales.

4.3 Notifications

- 4.3.1 Natural Resources Wales shall be notified without delay following the detection of:
- (a) any malfunction, breakdown or failure of equipment or techniques, accident, or emission of a substance not controlled by an emission limit which has caused, is causing or may cause significant pollution;
 - (b) the breach of a limit specified in the permit; or
 - (c) any significant adverse environmental effects.
- 4.3.2 Any information provided under condition 4.3.1 shall be confirmed by sending the information listed in schedule 5 to this permit within the time period specified in that schedule.
- 4.3.3 Where Natural Resources Wales has requested in writing that it shall be notified when the operator is to undertake monitoring and/or spot sampling, the operator shall inform Natural Resources Wales when the relevant monitoring and/or spot sampling is to take place. The operator shall provide this information to Natural Resources Wales at least 14 days before the date the monitoring is to be undertaken.
- 4.3.4 Natural Resources Wales shall be notified within 14 days of the occurrence of the following matters, except where such disclosure is prohibited by Stock Exchange rules:

Where the operator is a registered company:

- (a) any change in the operator's trading name, registered name or registered office address; and
- (b) any steps taken with a view to the operator going into administration, entering into a company voluntary arrangement or being wound up.

Where the operator is a corporate body other than a registered company:

- (a) any change in the operator's name or address; and
- (b) any steps taken with a view to the dissolution of the operator.

In any other case:

- (a) the death of any of the named operators (where the operator consists of more than one named individual);
- (b) any change in the operator's name(s) or address(es); and
- (c) any steps taken with a view to the operator, or any one of them, going into bankruptcy, entering into a composition or arrangement with creditors, or, in the case of them being in a partnership, dissolving the partnership.

4.3.5 Where the operator proposes to make a change in the nature or functioning, or an extension of the activities, which may have consequences for the environment and the change is not otherwise the subject of an application for approval under the Regulations or this permit:

- (a) Natural Resources Wales shall be notified at least 14 days before making the change; and
- (b) the notification shall contain a description of the proposed change in operation.

4.4 Interpretation

4.4.1 In this permit the expressions listed in schedule 6 shall have the meaning given in that schedule.

4.4.2 In this permit references to reports and notifications mean written reports and notifications, except where reference is made to notification being made "without delay", in which case it may be provided by telephone.

Schedule 1 - Operations

Table S1.1 activities		
Activity reference	Description of activities for waste operations	Limits of activities
A1 Open Windrow Composting	R13: Storage of waste pending any of the operations numbered R1 to R12 (excluding temporary storage, pending collection, on the site where it is produced)	The storage and physical treatment of wastes shall take place on an impermeable surface with a sealed drainage system.
	R3: Recycling/ reclamation of organic substances which are not used as solvents	Physical treatment consisting only of: <ul style="list-style-type: none"> - composting - maturation - manual separation - sorting - shredding - screening - bagging of permitted waste for the purpose of recovery only. The total quantities of wastes undergoing biological treatment at the whole site shall not exceed 75 tonnes per day. The storage, physical treatment and composting of wastes under anaerobic conditions shall be prevented. Sanitised waste from closed vessel composting may be stabilised with sanitised green waste. Waste types as specified in Table S2.1.
A2 Waste Transfer Station	R13: Storage of waste pending any of the operations numbered R1 to R12 (excluding temporary storage, pending collection, on the site where it is produced) D15: Storage pending any of the operations numbered D1 to D14 (excluding temporary storage pending collection on the site where it is produced).	All waste shall be stored and treated within a building with a bio-filter on an impermeable surface with sealed drainage. The bio-filter shall be specifically designed to minimise the release of odour, bio aerosols and micro-organisms and be fit for purpose. Treatment operations shall be limited to bulking up for onwards transfer of permitted waste for the purpose of recovery and/or disposal. Waste types as specified in Table S2.2

Table S1.2 Operating techniques

Description	Parts	Date Received
Technical Guidance Document: 'How to comply with your environmental permit'	All relevant sections	N/A
Sector Guidance Note IPPC S5.06: Guidance for the Recovery and Disposal of Hazardous and Non Hazardous Waste	All relevant sections	N/A
The composting industry code of practice (Association for Organics Recycling) 2005	All relevant sections	N/A
Industry guide for prevention and control of odours at biowaste processing facilities (Association for Organics Recycling) 2007	All relevant sections	N/A
Quality Protocol for Compost (Waste and Resources Action Program/Environment Agency)	All relevant sections	N/A
Guidance on the evaluation of bioaerosol risk assessments for composting facilities (Environment Agency)	All relevant sections	N/A
Standardised protocol for the monitoring of bioaerosols at open composting facilities (Association for Organics Recycling) 2009	All relevant sections	N/A
Fire prevention and mitigation plan guidance - Waste	All relevant sections	N/A
Response to informal request for additional information sent on 17 December 2013.	Email confirmation that: <ul style="list-style-type: none"> - Windrows will have aisle space of approx. 2 metres. - The base of the windrow will be compost oversize to allow aeration through windrow. 	18/12/13
	Environmental risk assessment (Revision V1) dated 14 May 2014 (document reference CCL04). Sections: <ul style="list-style-type: none"> - All 	23/06/14

Table S1.2 Operating techniques

Description	Parts	Date Received
	Site specific bioaerosol risk assessment (revision V1) dated 25 April 2014 (document reference CCL05). Listed sections only: <ul style="list-style-type: none"> - 4.0 Site description and information (including Table 2a – Feedstock variation and management controls) - Open/closed windrow sanitisation - 5.6 Risks from shredding waste - 5.7 Risks from windrow formation - 5.8 Risks from turning waste - 5.9 Risks from screening waste - 5.10 Risks from product storage - 7.0 Risk mitigation measures - 7.1 Measures the site will take to reduce bioaerosol release and control emissions 	
	Drainage management plan (revision V1) dated 20 June 2014 (document reference CCL08). Listed sections only: <ul style="list-style-type: none"> - 3.3.3 New tank details - 3.3.4 Monitoring - 3.5 Disposal - 3.6 Maintenance 	
	Management system (Issue 01) dated 17 December 2014 (document reference CCL02). Listed sections only: <ul style="list-style-type: none"> - 2.5.1 Physical restrictions - 5.9 Current operations - 5.11 Open Windrow Composting (Stabilisation of food and green) - 5.13 Proposed Operations - 5.15 Open Windrow Composting (Sanitisation of green only) - 5.16 Open Windrow Composting (Stabilisation of food and green) - 5.18 Operations Employed 	17/12/14
Response to Schedule 5 Notice dated 19/04/18	Odour management plan ref CCL_ODOUR_MANAGEMENT_PLAN_RevisedDraftWTS04-18(003). Sections: <ul style="list-style-type: none"> - All 	30/04/18
	Fire prevention and mitigation plan- for the A2 Waste Transfer Station only <ul style="list-style-type: none"> - All relevant sections 	
	Fire prevention and mitigation plan- Outlets for waste (email)	08/05/18
Fire prevention and mitigation plan guidance - Waste	All relevant sections	N/A
Fire prevention and mitigation plan- for the A1 Open Windrow Composting activity only	All relevant sections	In line with IPC 1

Table S1.3 Improvement programme requirements

Reference	Requirement	Date
IPC 1	<p>The operator shall submit a written fire prevention and mitigation plan (for the A1 Open Windrow Composting activity only) to Natural Resources Wales for approval.</p> <p>The fire prevention and mitigation plan must be produced in line with the standards set out in Fire prevention and mitigation plan guidance – Waste.</p>	3 months after permit issue or otherwise agreed in writing with Natural Resources Wales

Schedule 2 - Waste types, raw materials and fuels

Table S2.1 Permitted waste types and quantities for open windrow composting	
Maximum quantity	The maximum quantity of waste to be accepted on site shall not exceed 35,000 tonnes per year.
Exclusions	<p>Notwithstanding the waste types set out in this table, wastes having any of the following characteristics shall not be accepted:</p> <ul style="list-style-type: none"> • Catering waste and other wastes containing animal by products covered by the Animal By-Products Regulations² (except waste code 02 01 06); • Wastes consisting solely or mainly of dusts (except sawdust), powders or loose fibres • Hazardous wastes • Wastes containing treated wood • Wastes containing wood-preserving agents or other biocides • Wastes containing persistent organic pollutants • Wastes containing or contaminated with Japanese Knotweed
Waste code	Description
02	WASTES FROM AGRICULTURE, HORTICULTURE, AQUACULTURE, FORESTRY, HUNTING AND FISHING, FOOD PREPARATION AND PROCESSING
02 01	wastes from agriculture, horticulture, aquaculture, forestry, hunting and fishing
02 01 03	plant-tissue waste
02 01 06	animal faeces, urine and manure (including spoiled straw), effluent, collected separately and treated off-site
02 01 07	wastes from forestry (consisting of biodegradable only)
02 03	wastes from fruit, vegetables, cereals, edible oils, cocoa, coffee, tea and tobacco preparation and processing; conserve production; yeast and yeast extract production, molasses preparation and fermentation
02 03 04	materials unsuitable for consumption or processing (consisting of biodegradable only and other than those containing dangerous substances)
03	WASTES FROM WOOD PROCESSING AND THE PRODUCTION OF PANELS AND FURNITURE, PULP, PAPER AND CARDBOARD
03 01	wastes from wood processing and the production of panels and furniture
03 01 01	waste bark and cork
03 01 05	sawdust, shavings, wood, particle board and veneer other than those mentioned in 03 01 04 (excluding veneers and/or preservatives)
03 03	wastes from pulp, paper and cardboard production and processing
03 03 01	waste bark and wood
15	WASTE PACKAGING; ABSORBENTS, WIPING CLOTHS, FILTER MATERIALS AND PROTECTIVE CLOTHING NOT OTHERWISE SPECIFIED
15 01	packaging (including separately collected municipal packaging waste) (not containing non-biodegradable veneers or plastics)
15 01 01	paper and cardboard packaging (not containing non-biodegradable veneers or plastics)
15 01 03	wooden packaging (consisting of untreated only)
17	CONSTRUCTION AND DEMOLITION WASTES (INCLUDING EXCAVATED SOIL FROM CONTAMINATED SITES)
17 02	wood, glass and plastic
17 02 01	wood (consisting of untreated only)

19	WASTES FROM WASTE MANAGEMENT FACILITIES, OFF-SITE WASTE WATER TREATMENT PLANTS AND PREPARATION OF WATER INTENDED FOR HUMAN CONSUMPTION/INDUSTRIAL USE
19 12	wastes from the mechanical treatment of waste (for example sorting, crushing, compacting, pelletising) not otherwise specified
19 12 01	paper and cardboard (excluding non-biodegradable veneers or plastics)
19 12 07	wood other than that mentioned in 19 12 06
20	MUNICIPAL WASTES (HOUSEHOLD WASTE AND SIMILAR COMMERCIAL, INDUSTRIAL AND INSTITUTIONAL WASTES) INCLUDING SEPARATELY COLLECTED FRACTIONS
20 02	garden and park wastes (including cemetery waste)
20 02 01	biodegradable waste (consisting of plant matter only)

Table S2.2 Permitted waste types and quantities for waste transfer station

Maximum quantity	The maximum quantity of waste to be accepted on site shall not exceed 35,000 tonnes per year.
Exclusions	Notwithstanding the waste types set out in this table, wastes having any of the following characteristics shall not be accepted: <ul style="list-style-type: none"> • consisting solely or mainly of dusts, powders or loose fibres • sludges • odorous or odour producing • hazardous waste
Waste code	Description
20	MUNICIPAL WASTES (HOUSEHOLD WASTE AND SIMILAR COMMERCIAL, INDUSTRIAL AND INSTITUTIONAL WASTES) INCLUDING SEPARATELY COLLECTED FRACTIONS
20 03	other municipal wastes
20 03 01	mixed municipal waste

Schedule 3 – Emissions and monitoring

Table S3.1 Point source emissions to air – emission limits and monitoring requirements

Emission point ref. & location	Parameter	Source	Limit (including unit)	Reference period	Monitoring frequency	Monitoring standard or method
Outlets from bio-filters and/or equivalent abatement systems, emitting treated air from closed systems	-	Treated air from closed systems	-	-	-	-

Table S3.2 Process monitoring requirements for open windrow composting (Activity A1)

Emission point reference or source or description of point of measurement	Parameter	Monitoring frequency	Monitoring standard or method	Other specifications
Internal for each windrow and for any sample of waste or compost	Temperature	None specified	Thermocouple probe	Monitoring equipment shall be available on-site and used as required to ensure compliance with this permit.
	Moisture	None specified	Moisture meter or moisture touch test	

Table S3.3 Process monitoring requirements for waste transfer station (Activity A2)

Emission point reference or source or description of point of measurement	Parameter	Monitoring frequency	Monitoring standard or method	Other specifications
Bio-filter	Temperature, moisture and thatching/compaction	As required	Thermocouple probe and moisture meter or touch test	Biofilters should be checked and maintained to ensure appropriate temperature and moisture content on a daily basis

Table S3.4 Bioaerosol monitoring requirements for open windrow composting (Activity A2)

Location or description of point of measurement	Parameter	Bioaerosol threshold limits CFU m ⁻³	Monitoring frequency	Monitoring standard or method	Other specifications
At a minimum of three separate locations, as described in the Industry Standard Protocol	Gram-negative bacteria	300	Quarterly	In accordance with the Industry Standard Protocol, and, for gram-negative bacteria, together with Environment Agency's "Guidance on the evaluation of bioaerosol risk assessments for composting facilities"	As described in the Industry Standard Protocol, including all the additional data requirements specified therein.
	Total bacteria	1000			
	Aspergillus Fumigatus	500			

Schedule 4 - Reporting

Parameters, for which reports shall be made, in accordance with conditions of this permit, are listed below.

Table S4.1 Reporting of monitoring data

Parameter	Reporting period	Period begins
Bioaerosol monitoring as required by condition 3.7.1(b)	Every 4 months or as agreed in writing by Natural Resources Wales	1 January, 1 May, 1 September

Table S4.2 Reporting forms

Media/parameter	Reporting format
Bioaerosol monitoring	As specified in the Industry Standard Protocol or other form as agreed in writing by Natural Resources Wales

Schedule 5 - Notification

These pages outline the information that the operator must provide.

Units of measurement used in information supplied under Part A and B requirements shall be appropriate to the circumstances of the emission. Where appropriate, a comparison should be made of actual emissions and authorised emission limits.

If any information is considered commercially confidential, it should be separated from non-confidential information, supplied on a separate sheet and accompanied by an application for commercial confidentiality under the provisions of the EP Regulations.

Part A

Permit Number	
Name of operator	
Location of Facility	
Time and date of the detection	

(a) Notification requirements for any malfunction, breakdown or failure of equipment or techniques, accident, or emission of a substance not controlled by an emission limit which has caused, is causing or may cause significant pollution

To be notified within 24 hours of detection

Date and time of the event	
Reference or description of the location of the event	
Description of where any release into the environment took place	
Substances(s) potentially released	
Best estimate of the quantity or rate of release of substances	
Measures taken, or intended to be taken, to stop any emission	
Description of the failure or accident.	

(b) Notification requirements for the breach of a limit

To be notified within 24 hours of detection unless otherwise specified below

Emission point reference/ source	
Parameter(s)	
Limit	
Measured value and uncertainty	
Date and time of monitoring	
Measures taken, or intended to be taken, to stop the emission	

Time periods for notification following detection of a breach of a limit	
Parameter	Notification period

(c) Notification requirements for the detection of any significant adverse environmental effect	
To be notified within 24 hours of detection	
Description of where the effect on the environment was detected	
Substances(s) detected	
Concentrations of substances detected	
Date of monitoring/sampling	

Part B - to be submitted as soon as practicable

Any more accurate information on the matters for notification under Part A.	
Measures taken, or intended to be taken, to prevent a recurrence of the incident	
Measures taken, or intended to be taken, to rectify, limit or prevent any pollution of the environment which has been or may be caused by the emission	
The dates of any unauthorised emissions from the facility in the preceding 24 months.	

Name*	
Post	
Signature	
Date	

* authorised to sign on behalf of the operator

Schedule 6 - Interpretation

“accident” means an accident that may result in pollution.

“Annex II” means Annex II to Directive 2008/98/EC of the European Parliament and of the Council on waste.

“application” means the application for this permit, together with any additional information supplied by the operator as part of the application and any response to a notice served under Schedule 5 to the EP Regulations.

“authorised officer” means any person authorised by Natural Resources Wales under section 108(1) of The Environment Act 1995 to exercise, in accordance with the terms of any such authorisation, any power specified in section 108(4) of that Act.

“bioaerosol threshold limits” means the maximum acceptable bioaerosol concentrations at the nearest sensitive receptor, or at an equivalent distance downwind of the composting operations, which are attributable to the composting operations. The maximum acceptable concentrations are respectively 1000 and 500 CFU m⁻³ for total bacteria and *Aspergillus fumigatus*.

“building” means a construction that has the objective of providing sheltering cover and minimising emissions of noise, particulate matter, odour and litter.

“compost” means solid particulate material that is the result of composting, which has been sanitised and stabilised, and which confers beneficial effects when added to soil, used as a component of growing media or used in another way in conjunction with plants.

“composting” means the biological decomposition of organic materials, under conditions that are predominantly aerobic and that allow the development of thermophilic temperatures as a result of biologically produced heat.

“D” means a disposal operation provided for in Annex I to Directive 2008/98/EC of the European Parliament and of the Council on waste.

“emissions of substances not controlled by emission limits” means emissions of substances to air, water or land from the activities, either from the emission points specified in schedule 3 or from other localised or diffuse sources, which are not controlled by an emission or background concentration limit.

“emissions to land” includes emissions to groundwater.

“EP Regulations” means The Environmental Permitting (England and Wales) Regulations SI 2016 No.1154 and words and expressions used in this permit which are also used in the Regulations have the same meanings as in those Regulations.

“groundwater” means all water, which is below the surface of the ground in the saturation zone and in direct contact with the ground or subsoil.

“groundwater protection zones 1 and 2” have the meaning given in the document titled Groundwater Protection: Policy and Practice" published by the Environment Agency in 2006.

“hazardous property” has the meaning in Annex III of the Waste Framework Directive.

“hazardous substance” means a substance classified as hazardous as a consequence of fulfilling the criteria laid down in parts 2 to 5 of Annex I to Regulation (EC) No 1272/2008.

“hazardous waste” has the meaning given in the Hazardous Waste (Wales) Regulations 2005 (as amended).

“impermeable surface” means a surface or pavement constructed and maintained to a standard

sufficient to prevent the transmission of liquids beyond the surface.

“Industry Standard Protocol” means “A standardised protocol for the monitoring of bioaerosols at open composting facilities” published by the Association for Organics Recycling and developed in conjunction with the Environment Agency

“maturation” means a stage when by agitating and turning the compost it no longer results in reheating and the monitored temperature falls to ambient without the compost being too dry or anaerobic. Phytotoxins that are formed during the 'active' composting phase are metabolised by micro-organisms, which will result in the final material not being harmful to plants. This usually coincides with drop in pH toward neutral, and the conversion of ammonia into nitrates and recolonisation of beneficial micro-organisms. The maturation phase may need active management by turning to prevent the material becoming anaerobic.

“MCERTS” means the Environment Agency’s Monitoring Certification Scheme.

“nearest sensitive receptor” means the nearest place to the permitted activities where people are likely to be for prolonged periods. This term would therefore apply to dwellings (including any associated gardens) and to many types of workplace. We would not normally regard a place where people are likely to be present for less than 6 hours at one time as being a sensitive receptor. The term does not apply to those controlling the permitted facility, their staff when they are at work or to visitors to the facility as their health is covered by Health and Safety at Work legislation. NB The term would apply to dwellings occupied by the family of those controlling the permitted facility

“Pests” means Birds, Vermin and Insects.

“quarter” means a calendar year quarter commencing on 1 January, 1 April, 1 July or 1 October.

“R” means a recovery operation provided for in Annex II to Directive 2008/98/EC of the European Parliament and of the Council on waste.

“Waste code” means the six digit code referable to a type of waste in accordance with the list of wastes established by Commission Decision 2000/532/EC as amended from time to time (the ‘List of Wastes Decision’) and in relation to hazardous waste, includes the asterisk.

“Waste Framework Directive” or “WFD” means Waste Framework Directive 2008/98/EC of the European Parliament and of the Council on waste.

“year” means calendar year ending 31 December.

Schedule 7 - Site plan

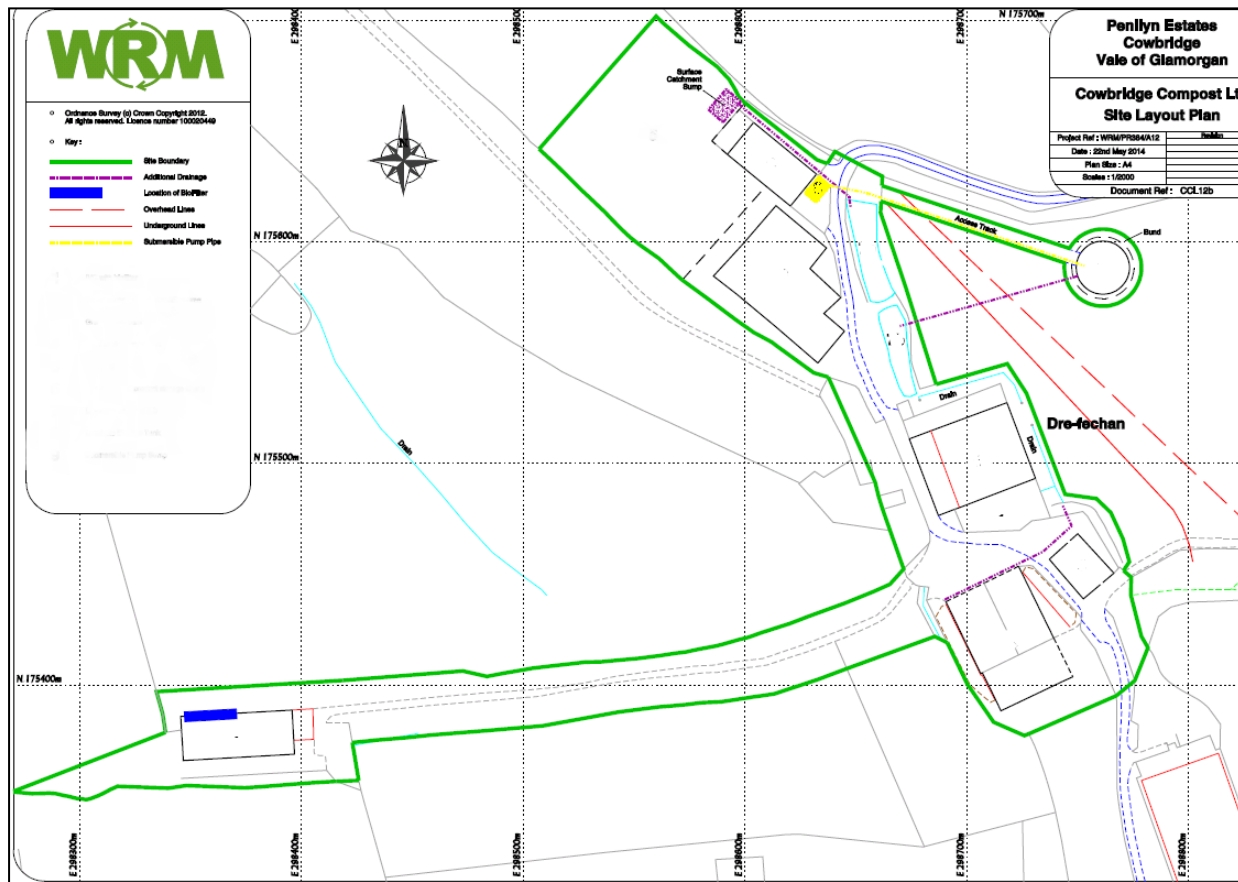

END OF PERMIT