



**Cyfoeth  
Naturiol**  
Cymru  
**Natural  
Resources**  
Wales

## **Permit with introductory note**

The Environmental Permitting (England & Wales) Regulations 2010

---

S L Recycling Limited

S L Recycling Ltd  
Unit 9  
Penallta Industrial Estate  
Hengoed  
CF82 7SU

Permit number  
EPR/ZB3593HH

# **S L Recycling Ltd**

## **Permit number EPR/ZB3593HH**

### **Introductory note**

#### **This introductory note does not form a part of the permit**

The main features of the permit are as follows.

This is a Tier 3 bespoke permit for a hazardous and non-hazardous mixed metal waste treatment site and a vehicle depollution and dismantling facility. Relevant storage and treatment capacity thresholds have been included in the permit to reflect the legal waste facility operational limits; above which, the site would be operating as an installation. (See Table S1.1).

This permit authorises:

#### Metal recycling activity:

Treatment operations shall be limited to sorting, separation, grading, shearing, baling, compacting, granulating of cables, and cutting using hand-held equipment only, of ferrous and non-ferrous metals into different components for recovery only. No hazardous waste shall be treated.

#### Vehicle depollution and dismantling (authorised treatment) activity:

Treatment operations shall be limited to depollution of waste motor vehicles by “manual” means only in line with the interpretation of physio chemical treatment of hazardous waste for the purpose of the Industrial Emissions Directive. Other treatment methods permitted by mechanical or manual methods are sorting, separation, baling, compacting or cutting, of waste into different components for recovery only. No hazardous waste shall be treated.

The maximum quantity of waste accepted and processed on site as a whole shall not exceed 6,000 tonnes per year.

This permit does not allow any point source emissions into surface waters or groundwater except:

- clean, rainfall dependant drainage from areas of the site not used in connection with the storage and/or treatment of waste, and
- integral discharge(s) from the permitted activity (areas of the site used in connection with the storage and/or treatment of waste) to surface water via an interceptor.

Emissions from the activity which are not controlled via emission limits are controlled through the emission of substances not controlled by emission limits condition and any other relevant requirements set out in Table S1.1.

The burning of any wastes, either in the open, inside buildings or in any form of incinerator is not permitted.

The status log of the permit sets out the permitting history, including any changes to the permit reference number.

<b>Status log of the permit</b>		
<b>Description</b>	<b>Date</b>	<b>Comments</b>
Application EPR/ZB3593HH/A001	Duly made 24/11/14	Application for an authorised vehicle depollution and mixed metal recycling facility.
Additional information received in response to an informal request for information sent on 6/01/15	08/01/15	Site condition report and confirmation of treatment methods.
		Amended environmental risk assessment.
Additional information received in response to informal for information sent on 11/01/15	7/02/15	Confirmation of treatment methods and the total annual throughput information.
Additional information received in response to informal for information sent on 6/01/15	10/03/15	Amended site plan.
Permit determined EPR/ZB3593HH	12/03/15	Tier 3 bespoke permit issued to S L Recycling Limited.

End of introductory note

# Permit

The Environmental Permitting (England and Wales) Regulations 2010

**Permit number**  
**EPR/ZB3593HH**

The Natural Resources Body for Wales (“Natural Resources Wales”) authorises,  
under regulation 13 of the Environmental Permitting (England and Wales)  
Regulations 2010

**S L Recycling Limited** (“the operator”),  
whose registered office is

**S L Recycling Limited**  
**Unit 9**  
**Penallta Industrial Estate**  
**Hengoed**  
**Mid Glamorgan**  
**CF82 7SU**

company registration number **08864255**  
to operate waste operations at

**S L Recycling Ltd**  
**Unit 9**  
**Penallta Industrial Estate**  
**Hengoed**  
**CF82 7SU**

to the extent authorised by and subject to the conditions of this permit.

Name	Date
<b>Holly Noble</b>	<b>12/03/2015</b>

Authorised on behalf of Natural Resources Wales

# Conditions

## 1 Management

### 1.1 General management

- 1.1.1 The operator shall manage and operate the activities:
- (a) in accordance with a written management system that identifies and minimises risks of pollution, including those arising from operations, maintenance, accidents, incidents, non-conformances, closure and those drawn to the attention of the operator as a result of complaints; and
  - (b) using sufficient competent persons and resources.
- 1.1.2 Records demonstrating compliance with condition 1.1.1 shall be maintained.
- 1.1.3 Any person having duties that are or may be affected by the matters set out in this permit shall have convenient access to a copy of it kept at or near the place where those duties are carried out.
- 1.1.4 The operator shall comply with the requirements of an approved competence scheme.

### 1.2 Avoidance, recovery and disposal of wastes produced by the activities

- 1.2.1 The operator shall take appropriate measures to ensure that:
- (a) the waste hierarchy referred to in Article 4 of the Waste Framework Directive is applied to the generation of waste by the activities; and
  - (b) any waste generated by the activities is treated in accordance with the waste hierarchy referred to in Article 4 of the Waste Framework Directive; and
  - (c) where disposal is necessary, this is undertaken in a manner which minimises its impact on the environment.
- 1.2.2 The operator shall review and record at least every four years whether changes to those measures should be made and take any further appropriate measures identified by a review.

## 2 Operations

### 2.1 Permitted activities

- 2.1.1 The operator is only authorised to carry out the activities specified in schedule 1 table S1.1 (the “activities”).

### 2.2 The site

- 2.2.1 The activities shall not extend beyond the site, being the land shown edged in green on the site plan at schedule 7 to this permit.

## **2.3 Operating techniques**

- 2.3.1 (a) The activities shall, subject to the conditions of this permit, be operated using the techniques and in the manner described in the documentation specified in schedule 1, table S1.2, unless otherwise agreed in writing by Natural Resources Wales.
- (b) If notified by Natural Resources Wales that the activities are giving rise to pollution, the operator shall submit to Natural Resources Wales for approval within the period specified, a revision of any plan or other documentation ("plan") specified in schedule 1, table S1.2 or otherwise required under this permit which identifies and minimises the risks of pollution relevant to that plan, and shall implement the approved revised plan in place of the original from the date of approval, unless otherwise agreed in writing by Natural Resources Wales.
- 2.3.2 Waste shall only be accepted if:
- (a) it is of a type and quantity listed in schedule 2 table(s) S2.1 [S2.2 etc]; and
- (b) it conforms to the description in the documentation supplied by the producer and holder.

## **2.4 Technical requirements**

### **Vehicle depollution and dismantling**

- 2.4.1 The storage (including temporary storage) and treatment of waste motor vehicles shall meet the requirements of article 6(1) of the End-of-Life Vehicles Directive.

### **Hazardous waste storage and treatment**

- 2.4.2 Hazardous waste shall not be mixed, either with a different category of hazardous waste or with other waste, substances or materials, unless it is authorised by schedule 1 table S1.1 and appropriate measures are taken.

## **3 Emissions and monitoring**

### **3.1 Emissions of substances not controlled by emission limits**

- 3.1.1 Emissions of substances not controlled by emission limits (excluding odour) shall not cause pollution. The operator shall not be taken to have breached this condition if appropriate measures, including, but not limited to, those specified in any approved emissions management plan, have been taken to prevent or where that is not practicable, to minimise, those emissions.
- 3.1.2 The operator shall:
- (a) if notified by Natural Resources Wales that the activities are giving rise to pollution, submit to Natural Resources Wales for approval within the period specified, an emissions management plan which identifies and minimises the risks of pollution from emissions of substances not controlled by emission limits;

- (b) implement the approved emissions management plan, from the date of approval, unless otherwise agreed in writing by Natural Resources Wales.
- 3.1.3 All liquids in containers, whose emission to water or land could cause pollution, shall be provided with secondary containment, unless the operator has used other appropriate measures to prevent or where that is not practicable, to minimise, leakage and spillage from the primary container.

## **3.2 Odour**

- 3.2.1 Emissions from the activities shall be free from odour at levels likely to cause pollution outside the site, as perceived by an authorised officer of Natural Resources Wales, unless the operator has used appropriate measures, including, but not limited to, those specified in any approved odour management plan, to prevent or where that is not practicable to minimise the odour.
- 3.2.2 The operator shall:
  - (a) if notified by Natural Resources Wales that the activities are giving rise to pollution outside the site due to odour, submit to Natural Resources Wales for approval within the period specified, an odour management plan which identifies and minimises the risks of pollution from odour;
  - (b) implement the approved odour management plan, from the date of approval, unless otherwise agreed in writing by Natural Resources Wales.

## **3.3 Noise and vibration**

- 3.3.1 Emissions from the activities shall be free from noise and vibration at levels likely to cause pollution outside the site, as perceived by an authorised officer of Natural Resources Wales, unless the operator has used appropriate measures, including, but not limited to, those specified in any approved noise and vibration management plan to prevent or where that is not practicable to minimise the noise and vibration.
- 3.3.2 The operator shall:
  - (a) if notified by Natural Resources Wales that the activities are giving rise to pollution outside the site due to noise and vibration, submit to Natural Resources Wales for approval within the period specified, a noise and vibration management plan which identifies and minimises the risks of pollution from noise and vibration;
  - (b) implement the approved noise and vibration management plan, from the date of approval, unless otherwise agreed in writing by Natural Resources Wales.

## **3.4 Pests**

- 3.4.1 The activities shall not give rise to the presence of pests which are likely to cause pollution, hazard or annoyance outside the boundary of the site. The operator shall not be taken to have breached this condition if appropriate measures, including, but not limited to, those specified in any approved pests management plan, have been taken to prevent or where that is not practicable, to minimise the presence of pests on the site.
- 3.4.2 The operator shall:
  - (a) if notified by Natural Resources Wales, submit to Natural Resources Wales for approval within the period specified, a pests management plan which identifies and minimises risks of pollution, hazard or annoyance from pests;
  - (b) implement the pests management plan, from the date of approval, unless otherwise agreed in writing by Natural resources Wales.

## **4 Information**

### **4.1 Records**

4.1.1 All records required to be made by this permit shall:

- (a) be legible;
- (b) be made as soon as reasonably practicable;
- (c) if amended, be amended in such a way that the original and any subsequent amendments remain legible, or are capable of retrieval; and
- (d) be retained, unless otherwise agreed in writing by Natural Resources Wales, for at least 6 years from the date when the records were made, or in the case of the following records until permit surrender:
  - (i) off-site environmental effects; and
  - (ii) matters which affect the condition of the land and groundwater.

4.1.2 The operator shall keep on site all records, plans and the management system required to be maintained by this permit, unless otherwise agreed in writing by Natural Resources Wales.

### **4.2 Reporting**

4.2.1 The operator shall send all reports and notifications required by the permit to Natural Resources Wales using the contact details supplied in writing by Natural Resources Wales.

4.2.2 Within one month of the end of each year, the operator shall submit to Natural Resources Wales using the form made available for the purpose, the information specified on the form relating to the site and the waste accepted and removed from it during the previous quarter.

### **4.3 Notifications**

4.3.1 Natural Resources Wales shall be notified without delay following the detection of:

- (a) any malfunction, breakdown or failure of equipment or techniques, accident, or emission of a substance not controlled by an emission limit which has caused, is causing or may cause significant pollution;
- (b) the breach of a limit specified in the permit; or
- (c) any significant adverse environmental effects.

4.3.2 Any information provided under condition 4.3.1 shall be confirmed by sending the information listed in schedule 5 to this permit within the time period specified in that schedule.

4.3.4 Natural Resources Wales shall be notified within 14 days of the occurrence of the following matters, except where such disclosure is prohibited by Stock Exchange rules:

Where the operator is a registered company:



- (a) any change in the operator's trading name, registered name or registered office address; and
- (b) any steps taken with a view to the operator going into administration, entering into a company voluntary arrangement or being wound up.

Where the operator is a corporate body other than a registered company:

- (a) any change in the operator's name or address; and
- (b) any steps taken with a view to the dissolution of the operator.

In any other case:

- (c) the death of any of the named operators (where the operator consists of more than one named individual);
- (d) any change in the operator's name(s) or address (es); and
- (e) any steps taken with a view to the operator, or any one of them, going into bankruptcy, entering into a composition or arrangement with creditors, or, in the case of them being in a partnership, dissolving the partnership.

4.3.5 Where the operator proposes to make a change in the nature or functioning, or an extension of the activities, which may have consequences for the environment and the change is not otherwise the subject of an application for approval under the Regulations or this permit:

- (a) Natural Resources Wales shall be notified at least 14 days before making the change; and
- (b) the notification shall contain a description of the proposed change in operation.

## **4.4 Interpretation**

4.4.1 In this permit the expressions listed in schedule 6 shall have the meaning given in that schedule.

4.4.2 In this permit references to reports and notifications mean written reports and notifications, except where reference is made to notification being made "without delay", in which case it may be provided by telephone.

# Schedule 1 - Operations

**Table S1.1 activities**

	Description of activities for waste operations	Limits of activities
<b>A1- Mixed metal recycling activity</b>	<b>R13:</b> Storage of waste pending any of the operations numbered R1 to R12 (excluding temporary storage, pending collection, on the site where it is produced)	<p>All wastes shall be stored and treated on an impermeable surface with sealed drainage.</p> <p>Treatment operations shall be limited to:</p> <ul style="list-style-type: none"> <li>-manual sorting</li> <li>-mechanical sorting</li> <li>-separation</li> <li>-grading</li> <li>-shearing</li> <li>-baling</li> <li>-screening</li> <li>-compaction granulating of cables</li> <li>-crushing</li> <li>-cutting</li> <li>-using hand-held (manual) equipment only</li> <li>of ferrous metals or alloys and non-ferrous metals into different components for recovery.</li> </ul>
	<b>R4:</b> Recycling/reclamation of metals and metal compounds	<p>There shall be no treatment of waste batteries and/or accumulators.</p> <p>Metal filings and turnings shall be stored in containers with an impermeable base and a cover to prevent the ingress of water. No more than 50 tonnes of metal filing and/or turnings shall be stored at any one time.</p> <p>Lead acid batteries shall be stored in containers with an impermeable, acid resistant base and a cover to prevent ingress of water.</p> <p>The maximum quantity of hazardous waste that can be stored at the site (excluding un-depolluted end of life vehicles pending submission to manual de-pollution or), for recovery or disposal, shall not exceed 50 tonnes in total at any one time.</p> <p>Waste types as specified in Table 2.1</p>

**Table S1.1 activities**

<b>A2- Vehicle depollution and dismantling activity</b>	<b>R13:</b> Storage of waste pending any of the operations numbered R1 to R12 (excluding temporary storage, pending collection, on the site where it is produced)	<p>All wastes shall be stored and treated on an impermeable surface with sealed drainage.</p> <p>Treatment operations shall be limited to:</p> <ul style="list-style-type: none"> <li>-manual depollution</li> <li>-baling</li> <li>-screening</li> <li>-crushing</li> <li>-sorting of waste for recovery only</li> </ul> <p>Treatments unless specified can be carried out manually or mechanically.</p> <p>The maximum quantity of hazardous waste that can be stored at the site (excluding un-depolluted end of life vehicles pending submission to manual de-pollution pending submission to manual repair, refurbishment or depollution), for recovery or disposal shall not exceed 50 tonnes in total at any one time.</p> <p>No more than 50 tonnes of intact waste vehicle tyres (waste code 16 01 03) shall be stored at the site.</p> <p>There shall be no treatment of asbestos waste.</p> <p>Uncontaminated plastic and glass arising from the treatment of end-of-life vehicles, uncontaminated ferrous metal wastes or alloys and uncontaminated non-ferrous metal wastes may be stored on hard standing or an impermeable surface with sealed drainage system.</p>
	<b>R4:</b> Recycling/reclamation of metals and metal compounds	
	<b>R5:</b> Recycling/reclamation of other inorganic compounds	
		Waste types as specified in Table 2.2
	Discharge of integral site drainage (process effluent) from the emission (discharge) points indicated on the plan as discharge point (NGR. ST 13859 96490) in Schedule 7 of this permit .	<p>Drainage consisting solely of:</p> <ul style="list-style-type: none"> <li>- clean, rainfall dependant drainage from areas of the site not used in connection with the storage and/or treatment of waste</li> <li>- run-off from the impermeable surface from all areas of the site used to store and/or treat waste via suitable well maintained Class 1 interceptor to surface water.</li> </ul> <p>No visible oil or grease shall be present in the discharge.</p>

**Table S1.2 Operating techniques**

<b>Description</b>	<b>Parts</b>	<b>Date Received</b>
Guidance Note EPR 1 How to Comply With Your Environmental Permit	All	N/A

**Table S1.2 Operating techniques**

<b>Description</b>	<b>Parts</b>	<b>Date Received</b>
Sector Guidance Note IPPC S5.06: Guidance for the Recovery and Disposal of Hazardous and Non Hazardous Waste	All	N/A
Pollution Prevention Guidelines- PPG 3- Use and Design of oil separators in surface water drainage systems	All	N/A
Industrial Emissions Directive (IED) Interpretation information	All	N/A
Response to an informal information request dated 14 <sup>th</sup> January 2015	Stacey Environmental risk assessment Sections: - runoff of groundwater from site entering drains or watercourse - fires	16/01/15

## Schedule 2 - Waste types, raw materials and fuels

**Table S2.1 Permitted waste types and quantities for mixed metal recycling facility**

Maximum quantity	Total quantity of waste accepted at the whole site shall not exceed 6000 tonnes per year.
Exclusions	<p>Wastes having any of the following characteristics shall not be accepted:</p> <ul style="list-style-type: none"> <li>Consisting solely or mainly of dusts, powders or loose fibres</li> <li>Wastes that are in a form which is either sludge or liquid</li> </ul>
<b>Description</b>	
<b>02</b>	<b>WASTES FROM AGRICULTURE, HORTICULTURE, AQUACULTURE, FORESTRY, HUNTING AND FISHING, FOOD PREPARATION AND PROCESSING</b>
02 01	wastes from agriculture, horticulture, aquaculture, forestry, hunting and fishing
02 01 10	waste metal
<b>12</b>	<b>WASTES FROM SHAPING AND PHYSICAL AND MECHANICAL SURFACE TREATMENT OF METALS AND PLASTICS</b>
12 01	wastes from shaping and physical and mechanical surface treatment of metals and plastics
12 01 01	ferrous metal filings and turnings
12 01 03	non-ferrous metal filings and turnings
<b>15</b>	<b>WASTE PACKAGING; ABSORBENTS, WIPING CLOTHS, FILTER MATERIALS AND PROTECTIVE CLOTHING NOT OTHERWISE SPECIFIED</b>
15 01	packaging (including separately collected municipal packaging waste)
15 01 04	metallic packaging
<b>16</b>	<b>WASTES NOT OTHERWISE SPECIFIED IN THE LIST</b>
16 01	end-of-life vehicles from different means of transport (including off-road machinery) and wastes from dismantling of end-of-life vehicles and vehicle maintenance (except 13, 14, 16 06 and 16 08)
16 01 17	ferrous metal
16 01 18	non-ferrous metal
16 01 22	components not otherwise specified
16 06	batteries and accumulators
16 06 01*	lead batteries
16 06 05	other batteries and accumulators
<b>17</b>	<b>CONSTRUCTION AND DEMOLITION WASTES (INCLUDING EXCAVATED SOIL FROM CONTAMINATED SITES)</b>
17 04	metals (including their alloys)
17 04 01	copper, bronze, brass
17 04 02	aluminium
17 04 03	Lead
17 04 04	Zinc
17 04 05	Iron and steel
17 04 06	Tin
17 04 07	Mixed metals
17 04 11	cables other than those mentioned in 17 04 10
<b>19</b>	<b>WASTES FROM WASTE MANAGEMENT FACILITIES, OFF-SITE WASTE WATER TREATMENT PLANTS AND THE PREPARATION OF WATER INTENDED FOR HUMAN CONSUMPTION AND WATER FOR INDUSTRIAL USE</b>
19 01	wastes from incineration or pyrolysis of waste
19 01 02	ferrous materials removed from bottom ash

**Table S2.1 Permitted waste types and quantities for mixed metal recycling facility**

Maximum quantity	Total quantity of waste accepted at the whole site shall not exceed 6000 tonnes per year.
Exclusions	Wastes having any of the following characteristics shall not be accepted: <ul style="list-style-type: none"> <li>• Consisting solely or mainly of dusts, powders or loose fibres</li> <li>• Wastes that are in a form which is either sludge or liquid</li> </ul>
<b>Description</b>	
19 10	wastes from shredding of metal-containing wastes
19 10 01	iron and steel waste
19 10 02	non-ferrous waste
19 12	wastes from the mechanical treatment of waste (for example sorting, crushing, compacting, pelletising) not otherwise specified
19 12 02	ferrous metal
19 12 03	non-ferrous metal
20	<b>MUNICIPAL WASTES (HOUSEHOLD WASTE AND SIMILAR COMMERCIAL, INDUSTRIAL AND INSTITUTIONAL WASTES) INCLUDING SEPARATELY COLLECTED FRACTIONS</b>
20 01	separately collected fractions (except 15 01)
20 01 33*	batteries and accumulators included in 16 06 01, 16 06 02 or 16 06 03 and unsorted batteries and accumulators containing these batteries
20 01 40	metals

**Table S2.2 Permitted waste types and quantities for vehicle depollution facility**

Maximum quantity	Total quantity of waste accepted at the whole site shall not exceed 6,000 tonnes per year.
Exclusions	Wastes having any of the following characteristics shall not be accepted: <ul style="list-style-type: none"> <li>• Consisting solely or mainly of dusts, powders or loose fibres</li> </ul>
<b>Description</b>	
16	<b>WASTES NOT OTHERWISE SPECIFIED IN THE LIST</b>
16 01	end-of-life vehicles from different means of transport (including off-road machinery) and wastes from dismantling of end-of-life vehicles and vehicle maintenance (except 13, 14, 16 06 and 16 08)
16 01 03	end-of-life tyres
16 01 04*	end-of-life vehicles*
16 01 06	end-of-life vehicles, containing neither liquids nor other hazardous components
16 01 07*	oil filters
16 01 11*	brake pads containing asbestos
16 01 12	brake pads other than those mentioned in 16 01 11
16 06	batteries and accumulators
16 06 01*	lead batteries
16 06 05	other batteries and accumulators

## **Schedule 3 – Emissions and monitoring**

There are no emission limits or associated monitoring requirements.

## **Schedule 4 - Reporting**

There is no reporting under this schedule.



# Schedule 5 - Notification

These pages outline the information that the operator must provide.

Units of measurement used in information supplied under Part A and B requirements shall be appropriate to the circumstances of the emission. Where appropriate, a comparison should be made of actual emissions and authorised emission limits.

If any information is considered commercially confidential, it should be separated from non-confidential information, supplied on a separate sheet and accompanied by an application for commercial confidentiality under the provisions of the EP Regulations.

## Part A

Permit Number	<b>EPR/ZB3593HH</b>
Name of operator	<b>S L Recycling Limited</b>
Location of Facility	
Time and date of the detection	

<b>(a) Notification requirements for any malfunction, breakdown or failure of equipment or techniques, accident, or emission of a substance not controlled by an emission limit which has caused, is causing or may cause significant pollution</b>	
<b>To be notified within 24 hours of detection</b>	
Date and time of the event	
Reference or description of the location of the event	
Description of where any release into the environment took place	
Substances(s) potentially released	
Best estimate of the quantity or rate of release of substances	
Measures taken, or intended to be taken, to stop any emission	
Description of the failure or accident.	

<b>(b) Notification requirements for the breach of a limit</b>	
<b>To be notified within 24 hours of detection unless otherwise specified below</b>	
Emission point reference/ source	
Parameter(s)	
Limit	
Measured value and uncertainty	
Date and time of monitoring	
Measures taken, or intended to be taken, to stop the emission	

Time periods for notification following detection of a breach of a limit	
Parameter	Notification period

(c) Notification requirements for the detection of any significant adverse environmental effect	
To be notified within 24 hours of detection	
Description of where the effect on the environment was detected	
Substances(s) detected	
Concentrations of substances detected	
Date of monitoring/sampling	

## Part B - to be submitted as soon as practicable

Any more accurate information on the matters for notification under Part A.	
Measures taken, or intended to be taken, to prevent a recurrence of the incident	
Measures taken, or intended to be taken, to rectify, limit or prevent any pollution of the environment which has been or may be caused by the emission	
The dates of any unauthorised emissions from the facility in the preceding 24 months.	

<b>Name*</b>	
<b>Post</b>	
<b>Signature</b>	
<b>Date</b>	

\* authorised to sign on behalf of the operator

## Schedule 6 – Interpretation

*“accident”* means an accident that may result in pollution.

*“application”* means the application for this permit, together with any additional information supplied by the operator as part of the application and any response to a notice served under Schedule 5 to the EP Regulations.

*“authorised officer”* means any person authorised by Natural Resources Wales under section 108(1) of The Environment Act 1995 to exercise, in accordance with the terms of any such authorisation, any power specified in section 108(4) of that Act.

*“best available treatment, recovery and recycling techniques”* shall have the meaning given to it in the document published jointly by the Department for Environment, Food and Rural Affairs, the Welsh Assembly Government and the Scottish Executive on 27th November 2006, entitled “Guidance on Best Available Treatment, Recovery and Recycling Techniques (BATRRRT) and Treatment of Waste Electrical and Electronic Equipment (WEEE);

*“building”* means a construction that has the objective of providing sheltering cover and minimising emissions of noise, particulate matter, odour and litter.

*“D”* means a disposal operation provided for in Annex I to Directive 2008/98/EC of the European Parliament and of the Council on waste.

*“End-of-Life Vehicles Directive”* means Directive 2000/53/EC of the European Parliament and Council of 18 September 2000 on end-of-life vehicles.

*“emissions to land”* includes emissions to groundwater.

*“EP Regulations”* means The Environmental Permitting (England and Wales) Regulations SI 2010 No.675 and words and expressions used in this permit which are also used in the Regulations have the same meanings as in those Regulations.

*“emissions of substances not controlled by emission limits”* means emissions of substances to air, water or land from the activities, either from the emission points specified in schedule 3 or from other localised or diffuse sources, which are not controlled by an emission or background concentration limit.

*“groundwater”* means all water, which is below the surface of the ground in the saturation zone and in direct contact with the ground or subsoil.

*“groundwater protection zones 1 and 2”* have the meaning given in the document titled "Groundwater Protection: Policy and Practice" published by the Environment Agency in 2006.

*“hazardous waste”* has the meaning given in the Hazardous Waste (England and Wales) Regulations 2005 No.894, the Hazardous Waste (Wales) Regulations 2005 No. 1806 (W.138), the List of Wastes (England) Regulations 2005 No.895 and the List of Wastes (Wales) Regulations 2005 No. 1820 (W.148).

*“nearest sensitive receptors”* means the nearest place to the composting operations where people are likely to be for prolonged or frequent periods. This term would therefore apply to dwellings (including any associated gardens) and to workplaces where workers would frequently be present. It does not apply to the operators of composting facilities or their staff while carrying out the composting operation as their health is covered by Health and Safety legislation.

*“Pests”* means Birds, Vermin and Insects.

*“quarter”* means a calendar year quarter commencing on 1 January, 1 April, 1 July or 1 October.

*“R”* means a recovery operation provided for in Annex II to Directive 2008/98/EC of the European Parliament and of the Council on waste.

*“Waste code”* means the six digit code referable to a type of waste in accordance with the List of Wastes (England) Regulations 2005, or List of Wastes (Wales) Regulations 2005, as appropriate, and in relation to hazardous waste, includes the asterisk.

*“Waste Framework Directive”* or *“WFD”* means Waste Framework Directive 2008/98/EC of the European Parliament and of the Council on waste.

*“year”* means calendar year ending 31 December.



# Schedule 7 - Site plan

This is the site plan this permit refers to.

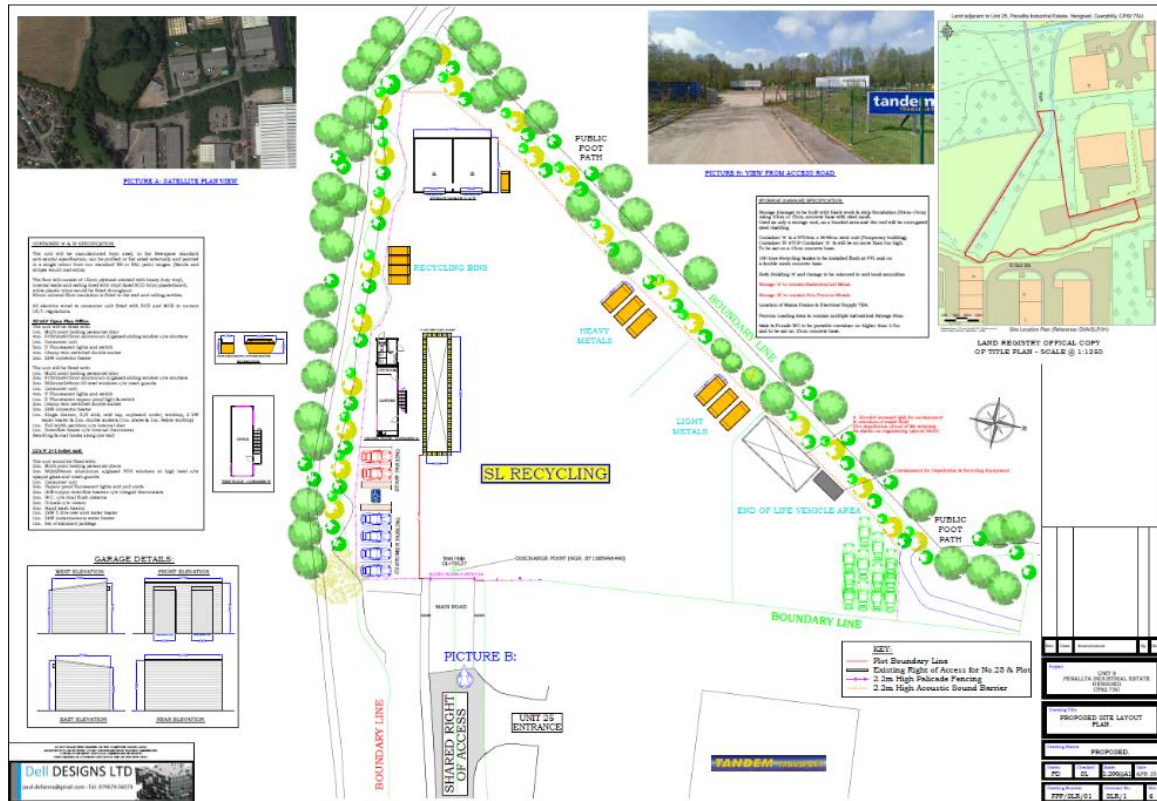

© Crown Copyright and database right [2015]. Ordnance Survey licence number 100019741.

END OF PERMIT