



**Cyfoeth
Naturiol**
Cymru
**Natural
Resources**
Wales

Permit with introductory note

The Environmental Permitting (England & Wales) Regulations 2010

Intertissue Limited

Intertissue Neath
Brunel Way
Baglan Energy Park
Briton Ferry
Neath
United Kingdom
SA11 2HZ

Permit number

EPR/BU2489IT

Intertissue Neath

Permit number EPR/BU2489IT

Introductory note

This introductory note does not form a part of the permit

The main features of the permit are as follows.

The main purpose of the activities at the installation is to produce paper tissue from imported wood pulp. The paper tissue is formed into a variety of products including toilet paper and kitchen rolls.

Pre-formed virgin wood pulp is imported in the form of bales. Water is added and then the diluted wood pulp is spread and dried to form tissue paper, which is then converted into the final products. The water removed during the drying process is recycled via the on-site primary wastewater treatment plant.

The water used in the process is taken from the Tennant Canal. The site's electricity is supplied by Baglan Operations Limited at the Baglan Energy Park. A stand-alone natural gas fired boiler produces the steam used in the process on-site.

The main air emissions from the site are oxides of nitrogen from the gas-fired boiler with the primary emissions to Swansea Bay are suspended solids, COD, phosphorous and nitrogen.

Emissions to water are treated by on-site secondary water treatment plant before being discharged. The effluent plant consists of a bioreactor and a Dissolved Air Flotation Unit. The treated water is discharged into the Welsh Water outfall and then via a series of diffusers into Swansea Bay.

There are a number of SSSI in the area, which include Crymlyn Bog, Crymlyn Burrows, Pant-y-Sais and the Earlswood Road Cutting and Ferryboat Inn Quarries.

The status log of the permit sets out the permitting history, including any changes to the permit reference number.

Status log of the permit		
Description	Date	Comments
Application BU2489 received (EPR/BU2489IT/A001)	31/03/03	-
Response to request for information	1 st Schedule 4 notice, Dated 19/05/03	Response received 03/07/03
	2 nd Schedule 4 notice, Dated 24/07/03	Response received 08/09/03

Request by Environment Agency to extend determination from 30/10/03 to 30/12/03	Request dated 10/09/03	Request accepted 22/09/03
Permit determined BU2489	30/01/04	-
Variation application received (EPR/BU2489IT/V002)	18/7/2006	Determined 13/9/2006
Variation Initiated by the Environment Agency (EPR/BU2489IT/V003)	8/8/2007	Determined 22/8/2007
Regulation 16 Application (EPR/BU2489IT/V004)	28/3/2008	-
Variation Initiated by the Environment Agency GP3636XZ (EPR/BU2489IT/V005)	29/3/08	Determined 8/5/2008
Variation application EPR/BU2489IT/V006	08/02/10	Determined 22/02/10
Environment Agency Paper and Pulp Sector Review 2011 Variation determined EPR/BU2489IT/V007	09/01/12	Varied and consolidated permit issued in modern condition format
Regulation 60 Notice	19/11/14	Request for Operator to demonstrate compliance with revised technical standards detailed in revised BREF Note.
Regulation 60 response	30/03/15	Operator response providing information to demonstrate that relevant BAT conclusions are met for the production of paper, pulp and board
Natural Resources Wales Variation Application EPR/BU2489IT/V008 (Variation and Consolidation)	31/03/16	Natural Resources Wales Variation and consolidation following the implementation of the Industrial Emissions Directive

End of introductory note

Permit

The Environmental Permitting (England and Wales) Regulations 2010

Permit number
EPR/BU2489IT

This is the consolidated permit referred to in the variation and consolidation notice for application EPR/BU2489IT/V008 authorising,

Intertissue Limited (“the operator”),

whose registered office

**Brunel Way
Baglan Energy Park
Briton Ferry
Neath
United Kingdom
SA11 2HZ**

company registration number 4537324

to operate an installation

**Intertissue Neath
Brunel Way
Baglan Energy Park
Briton Ferry
Neath
United Kingdom
SA11 2HZ**

to the extent authorised by and subject to the conditions of this permit.

Name

Date

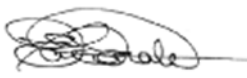
	31/03/2016
---	-------------------

Eirian Macdonald

Authorised on behalf of Natural Resources Wales

Conditions

1 Management

1.1 General management

- 1.1.1 The operator shall manage and operate the activities:
- (a) in accordance with a written management system that identifies and minimises risks of pollution, including those arising from operations, maintenance, accidents, incidents, non-conformances ,closure and those drawn to the attention of the operator as a result of complaints; and
 - (b) using sufficient competent persons and resources.
- 1.1.2 Records demonstrating compliance with condition 1.1.1 shall be maintained.
- 1.1.3 Any person having duties that are or may be affected by the matters set out in this permit shall have convenient access to a copy of it kept at or near the place where those duties are carried out.

1.2 Energy efficiency

- 1.2.1 The operator shall:
- (a) take appropriate measures to ensure that energy is used efficiently in the activities;
 - (b) review and record at least every four years whether there are suitable opportunities to improve the energy efficiency of the activities; and
 - (c) take any further appropriate measures identified by a review.

1.3 Efficient use of raw materials

- 1.3.1 The operator shall:
- (a) take appropriate measures to ensure that raw materials and water are used efficiently in the activities;
 - (b) maintain records of raw materials and water used in the activities;
 - (c) review and record at least every four years whether there are suitable alternative materials that could reduce environmental impact or opportunities to improve the efficiency of raw material and water use; and
 - (d) take any further appropriate measures identified by a review.

1.4 Avoidance, recovery and disposal of wastes produced by the activities

- 1.4.1 The operator shall take appropriate measures to ensure that:
- (a) the waste hierarchy referred to in Article 4 of the Waste Framework Directive is applied to the generation of waste by the activities; and

- (b) any waste generated by the activities is treated in accordance with the waste hierarchy referred to in Article 4 of the Waste Framework Directive; and
 - (c) where disposal is necessary, this is undertaken in a manner which minimises its impact on the environment.
- 1.4.2 The operator shall review and record at least every four years whether changes to those measures should be made and take any further appropriate measures identified by a review.

2 Operations

2.1 Permitted activities

- 2.1.1 The operator is only authorised to carry out the activities specified in schedule 1 table S1.1 (the “activities”).
- 2.1.2 Waste authorised by this permit shall be clearly distinguished from any other waste on the site.

2.2 The site

- 2.2.1 The activities shall not extend beyond the site, being the land shown edged in green on the site plan at schedule 7 to this permit.

2.3 Operating techniques

- 2.3.1
 - (a) The activities shall, subject to the conditions of this permit, be operated using the techniques and in the manner described in the documentation specified in schedule 1, table S1.2, unless otherwise agreed in writing by Natural Resources Wales.
 - (b) If notified by Natural Resources Wales that the activities are giving rise to pollution, the operator shall submit to Natural Resources Wales for approval within the period specified, a revision of any plan or other documentation (“plan”) specified in schedule 1, table S1.2 or otherwise required under this permit which identifies and minimises the risks of pollution relevant to that plan, and shall implement the approved revised plan in place of the original from the date of approval, unless otherwise agreed in writing by Natural Resources Wales.
- 2.3.2 Any raw materials or fuels listed in schedule 2 table S2.1 shall conform to the specifications set out in that table.
- 2.3.3 The operator shall ensure that where waste produced by the activities is sent to a relevant waste operation, that operation is provided with the following information, prior to the receipt of the waste:
 - (a) the nature of the process producing the waste;
 - (b) the composition of the waste;

- (c) the handling requirements of the waste;
 - (d) the hazardous property associated with the waste, if applicable; and
 - (e) the waste code of the waste.
- 2.3.4 The operator shall ensure that where waste produced by the activities is sent to a landfill site, it meets the waste acceptance criteria for that landfill.

2.4 Improvement programme

- 2.4.1 The operator shall complete the improvements specified in schedule 1 table S1.3 by the date specified in that table unless otherwise agreed in writing by Natural Resources Wales.
- 2.4.2 Except in the case of an improvement which consists only of a submission to Natural Resources Wales, the operator shall notify Natural Resources Wales within 14 days of completion of each improvement.

3 Emissions and monitoring

3.1 Emissions to water, air or land

- 3.1.1 There shall be no point source emissions to water, air or land except from the sources and emission points listed in schedule 3 tables S3.1 and S3.2.
- 3.1.2 The limits given in schedule 3 shall not be exceeded.
- 3.1.3 Periodic monitoring shall be carried out at least once every 5 years for groundwater and 10 years for soil, unless such monitoring is based on a systematic appraisal of the risk of contamination.

3.2 Emissions of substances not controlled by emission limits

- 3.2.1 Emissions of substances not controlled by emission limits (excluding odour) shall not cause pollution. The operator shall not be taken to have breached this condition if appropriate measures, including, but not limited to, those specified in any approved emissions management plan, have been taken to prevent or where that is not practicable, to minimise, those emissions.
- 3.2.2 The operator shall:
- (a) if notified by Natural Resources Wales that the activities are giving rise to pollution, submit to Natural Resources Wales for approval within the period specified, an emissions management plan which identifies and minimises the risks of pollution from emissions of substances not controlled by emission limits;
 - (b) implement the approved emissions management plan, from the date of approval, unless otherwise agreed in writing by Natural Resources Wales.
- 3.2.3 All liquids in containers, whose emission to water or land could cause pollution, shall be provided with secondary containment, unless the operator has used other appropriate measures to prevent or where that is not practicable, to minimise, leakage and spillage from the primary container.

3.3 Monitoring

- 3.3.1 The operator shall, unless otherwise agreed in writing by Natural Resources Wales, undertake the monitoring specified in the following tables in schedule 3 to this permit:
- (a) point source emissions specified in tables S3.1 and S3.2;
- 3.3.2 The operator shall maintain records of all monitoring required by this permit including records of the taking and analysis of samples, instrument measurements (periodic and continual), calibrations, examinations, tests and surveys and any assessment or evaluation made on the basis of such data.
- 3.3.3 Monitoring equipment, techniques, personnel and organisations employed for the emissions monitoring programme and the environmental or other monitoring specified in condition 3.3.1 shall have either MCERTS certification or MCERTS accreditation (as appropriate), where available, unless otherwise agreed in writing by Natural Resources Wales.
- 3.3.4 Permanent means of access shall be provided to enable sampling/monitoring to be carried out in relation to the emission points specified in schedule 3 tables S3.1 and S3.2 unless otherwise agreed in writing by Natural Resources Wales.

3.4 Odour

- 3.4.1 Emissions from the activities shall be free from odour at levels likely to cause pollution outside the site, as perceived by an authorised officer of Natural Resources Wales, unless the operator has used appropriate measures, including, but not limited to, those specified in any approved odour management plan, to prevent or where that is not practicable to minimise the odour.
- 3.4.2 The operator shall:
- (a) if notified by Natural Resources Wales that the activities are giving rise to pollution outside the site due to odour, submit to Natural Resources Wales for approval within the period specified, an odour management plan which identifies and minimises the risks of pollution from odour;
 - (b) implement the approved odour management plan, from the date of approval, unless otherwise agreed in writing by Natural Resources Wales.

3.5 Noise and vibration

- 3.5.1 Emissions from the activities shall be free from noise and vibration at levels likely to cause pollution outside the site, as perceived by an authorised officer of Natural Resources Wales, unless the operator has used appropriate measures, including, but not limited to, those specified in any approved noise and vibration management plan to prevent or where that is not practicable to minimise the noise and vibration.
- 3.5.2 The operator shall:

- (a) if notified by Natural Resources Wales that the activities are giving rise to pollution outside the site due to noise and vibration, submit to Natural Resources Wales for approval within the period specified, a noise and vibration management plan which identifies and minimises the risks of pollution from noise and vibration;
- (b) implement the approved noise and vibration management plan, from the date of approval, unless otherwise agreed in writing by Natural Resources Wales.

4 Information

4.1 Records

4.1.1 All records required to be made by this permit shall:

- (a) be legible;
- (b) be made as soon as reasonably practicable;
- (c) if amended, be amended in such a way that the original and any subsequent amendments remain legible, or are capable of retrieval; and
- (d) be retained, unless otherwise agreed in writing by Natural Resources Wales, for at least 6 years from the date when the records were made, or in the case of the following records until permit surrender:
 - (i) off-site environmental effects; and
 - (ii) matters which affect the condition of the land and groundwater.

4.1.2 The operator shall keep on site all records, plans and the management system required to be maintained by this permit, unless otherwise agreed in writing by Natural Resources Wales.

4.2 Reporting

4.2.1 The operator shall send all reports and notifications required by the permit to Natural Resources Wales using the contact details supplied in writing by Natural Resources Wales.

4.2.2 A report or reports on the performance of the activities over the previous year shall be submitted to Natural Resources Wales by 31 January (or other date agreed in writing by Natural Resources Wales) each year. The report(s) shall include as a minimum:

- (a) a review of the results of the monitoring and assessment carried out in accordance with the permit including an interpretive review of that data;
- (b) the annual production /treatment data set out in schedule 4 table S4.2; and
- (c) the performance parameters set out in schedule 4 table S4.3 using the forms specified in table S4.4 of that schedule.

4.2.3 Within 28 days of the end of the reporting period the operator shall, unless otherwise agreed in writing by Natural Resources Wales, submit reports of the monitoring and assessment carried out in accordance with the conditions of this permit, as follows:

- (a) in respect of the parameters and emission points specified in schedule 4 table

S4.1;

- (b) for the reporting periods specified in schedule 4 table S4.1 and using the forms specified in schedule 4 table S4.4 ; and
- (c) giving the information from such results and assessments as may be required by the forms specified in those tables.

4.2.4 The operator shall, unless notice under this condition has been served within the preceding four years, submit to Natural Resources Wales, within six months of receipt of a written notice, a report assessing whether there are other appropriate measures that could be taken to prevent, or where that is not practicable, to minimise pollution.

4.2.5

4.3 Notifications

- 4.3.1 (a) In the event that the operation of the activities gives rise to an incident or accident which significantly affects or may significantly affect the environment, the operator must immediately—
- (i) inform Natural Resources Wales,
 - (ii) take the measures necessary to limit the environmental consequences of such an incident or accident, and
 - (iii) take the measures necessary to prevent further possible incidents or accidents;
- (b) in the event of a breach of any permit condition the operator must immediately—
- (i) inform Natural Resources Wales, and
 - (ii) take the measures necessary to ensure that compliance is restored within the shortest possible time;
- (c) in the event of a breach of permit condition which poses an immediate danger to human health or threatens to cause an immediate significant adverse effect on the environment, the operator must immediately suspend the operation of the activities or the relevant part of it until compliance with the permit conditions has been restored.
- 4.3.2 Any information provided under condition 4.3.1 where the information relates to the breach of a limit specified in the permit, shall be confirmed by sending the information listed in schedule 5 to this permit within the time period specified in that schedule.
- 4.3.3 Where Natural Resources Wales has requested in writing that it shall be notified when the operator is to undertake monitoring and/or spot sampling, the operator shall inform Natural Resources Wales when the relevant monitoring and/or spot sampling is to take place. The operator shall provide this information to Natural Resources Wales at least 14 days before the date the monitoring is to be undertaken.
- 4.3.4 Natural Resources Wales shall be notified within 14 days of the occurrence of the following matters, except where such disclosure is prohibited by Stock Exchange rules:
- Where the operator is a registered company:
- (a) any change in the operator's trading name, registered name or registered office address; and
 - (b) any steps taken with a view to the operator going into administration, entering into a company voluntary arrangement or being wound up.

Where the operator is a corporate body other than a registered company:

- (a) any change in the operator's name or address; and
- (b) any steps taken with a view to the dissolution of the operator.

In any other case:

- (a) the death of any of the named operators (where the operator consists of more than one named individual);
- (b) any change in the operator's name(s) or address(es); and
- (c) any steps taken with a view to the operator, or any one of them, going into bankruptcy, entering into a composition or arrangement with creditors, or, in the case of them being in a partnership, dissolving the partnership.

4.3.5 Where the operator proposes to make a change in the nature or functioning, or an extension of the activities, which may have consequences for the environment and the change is not otherwise the subject of an application for approval under the Regulations or this permit:

- (a) Natural Resources Wales shall be notified at least 14 days before making the change; and
- (b) the notification shall contain a description of the proposed change in operation.

4.3.6 Natural Resources Wales shall be given at least 14 days notice before implementation of any part of the site closure plan.

4.3.7 Where the operator has entered into a climate change agreement with the Government, Natural Resources Wales shall be notified within one month of:

- (a) a decision by the Secretary of State not to re-certify the agreement;
- (b) a decision by either the operator or the Secretary of State to terminate the agreement; and
- (c) any subsequent decision by the Secretary of State to re-certify such an agreement.

4.4 Interpretation

4.4.1 In this permit the expressions listed in schedule 6 shall have the meaning given in that schedule.

4.4.2 In this permit references to reports and notifications mean written reports and notifications, except where reference is made to notification being made "immediately", in which case it may be provided by telephone.

Schedule 1 - Operations

Table S1.1 activities

Activity reference	Activity listed in Schedule 1 of the EP Regulations	Description of specified activity and WFD Annex I and II operations	Limits of specified activity and waste types
A1	S6.1 A1 (b)	Producing, in industrial plant, paper and board where the plant has a production capacity of more than 20 tonnes per day. Production of paper tissue in one paper machine.	Receipt of paper pulp and other raw materials to dispatch of finished goods
A2	S5.4 A1 (a) (ii)	Physico-chemical treatment	Effluent from paper mill and on-site power generation facility only
Directly Associated Activity			
A4	Combustion Plant	Provision of steam for use in the process by burning of natural gas in one boiler with a 10.5 MW thermal input, and a 12.6 MW gas-fired paper drier.	Combustion of fuel to release of combustion gases to atmosphere

Table S1.2 Operating techniques

Description	Parts	Date Received
Application	The responses to questions B2.1, B2.2, B2.3, B2.4, B2.5, B2.6, B2.7.1, B2.7.2, B2.7.3, B2.8, B2.9, B2.10, B2.11 and B3.1 given in Sections 2.1, 2.2, 2.3, 2.4, 2.5, 2.6, 2.7.0, 2.7.1, 2.7.2, 2.7.3, 2.8, 2.9, 2.10, 2.11 and Part 3 of the application	31 March 2003
Response to 1 st Schedule 4 notice	All responses	03 July 2003
Response to 2 nd Schedule 4 notice	All responses	08 September 2003
Variation Application	All	17 July 2006
Regulation 16 Application	All	28 March 2008
Report on monitoring standards for discharges to surface waters received in response to IC1 issued 9 th January 2012	Full report	03 April 2012
Regulation 60 Notice response	All parts including supporting documents	30 March 2015

Table S1.3 Improvement programme requirements

Reference	Requirement	Date
IC1	<p>If storing Priority Hazardous Substances on site, the Operator must carry out the following assessments with reference to the Environment Agency's guidance "<i>How to carry out a risk assessment if you're applying for a bespoke permit that includes discharging hazardous pollutants to surface water</i>",</p> <ul style="list-style-type: none"> Phase 1 Part A screening tests for mercury, cadmium, nickel, lead, benzene, polyaromatic hydrocarbons and any other relevant substances. Phase 1 Part B screening tests for mercury, cadmium, polyaromatic hydrocarbons and any other relevant priority hazardous substances. For any substance which is not screened out by the Phase 1 Part A or Part B screening tests the Operator will also need to carry out Phase 2 modelling, as described in "<i>How to carry out a risk assessment if you're applying for a bespoke permit that includes discharging hazardous pollutants to surface water</i>". <p>The Operator must provide Natural Resources Wales with the results of the emissions monitoring, the results from the screening tests and the results from any Phase 2 modelling. The Operator may use the Environment Agency's H1 electronic screening tool to present the emissions data and to carry out the Phase 1 screening tests.</p> <p>Note: With regard to the Phase 1 Part A screening - a full list of relevant substances is provided in the Environment Agency guidance "<i>How to carry out a risk assessment if you're applying for a bespoke permit that includes discharging hazardous pollutants to surface water</i>" under the section entitled "<i>Screening test: priority hazardous pollutants</i>". The Operator must review the list and carry out the screening for any substances, in addition to those specified above, that may be present in the installations discharges to surface water. With regard to the Phase 1 Part B screening for priority hazardous pollutants, the section entitled "<i>Screening test: priority hazardous pollutants</i>" provides a full list of relevant priority hazardous substances and their associated annual significant loads.</p>	30 th September 2016
IC2	<p>The Operator shall submit a report on the baseline conditions of soil and groundwater at the installation. The report shall contain the information necessary to determine the state of soil and groundwater contamination so as to make a quantified comparison with the state upon definitive cessation of activities provided for in Article 22(3) of the IED. The report shall contain information, supplementary to that already provided in the application Site Condition Report, needed to meet the information requirements of Article 22(2) of the IED.</p>	31 st March 2017

Schedule 2 - Waste types, raw materials and fuels

Schedule 3 (a) – Emissions and monitoring

Emissions until 29/09/2018

Table S3.1 Point source emissions to air – emission limits and monitoring requirements

Emission point ref. & location	Parameter	Source	Limit (including unit)	Reference period	Monitoring frequency	Monitoring standard or method
A2 [Point B on site plan]	Particulate	Paper machine dust removal.	10 mg/m ³	Spot	Six Monthly	BS EN 13284
A3 [Point C on site plan]	Particulate	Exhaust to reel system	10 mg/m ³	Spot	Six Monthly	BS EN 13284
A4 [Point D on site plan]	No parameters set	Gas hood exhaust	No limit set	-	-	-
A5 [Point E on site plan]	No parameters set	Boiler exhaust	No limit set	-	-	-

Table S3.2 Point Source emissions to water (other than sewer) and land – emission limits and monitoring requirements

Emission point ref. & location	Parameter	Source	Limit (incl. unit)	Reference Period	Monitoring frequency	Monitoring standard or method [Note 1]
W1 [SS 72540 91890]	Volume discharged	On-site biological effluent treatment plant	850m ³ / day [Note 2]	24 hours	Continuous	MCERTS self-monitoring of effluent flow scheme
W1 [SS 72540 91890]	Flow rate	On-site biological effluent treatment plant	30 l/s	Instantaneous	Continuous	MCERTS self-monitoring of effluent flow scheme
W1 [SS 72540 91890]	Temperature	On-site biological effluent treatment plant	40°C	Instantaneous	Continuous	Standard temperature sensor
W1 [SS 72540 91890]	pH maximum	On-site biological effluent treatment plant	9	Instantaneous	Continuous	MCERTS self-monitoring of effluent flow scheme
W1 [SS 72540 91890]	pH minimum	On-site biological effluent treatment plant	6	Instantaneous	Continuous	MCERTS self-monitoring of effluent flow scheme
W1 [SS 72540 91890]	Suspended solids	On-site biological effluent treatment plant	100mg/l	Spot sample	Daily	BS EN 872:2005

Table S3.2 Point Source emissions to water (other than sewer) and land – emission limits and monitoring requirements

Emission point ref. & location	Parameter	Source	Limit (incl. unit)	Reference Period	Monitoring frequency	Monitoring standard or method [Note 1]
W1 [SS 72540 91890]	Chemical Oxygen Demand (COD)	On-site biological effluent treatment plant	No limit set	Spot sample	Daily	MCERTS - Performance Standards and Test Procedures for Continuous Water Monitoring Equipment
W1 [SS 72540 91890]	Total Nitrogen	On-site biological effluent treatment plant	No limit set	24-hour flow proportional composite sample	Weekly	MCERTS - Performance Standards and Test Procedures for Continuous Water Monitoring Equipment
W1 [SS 72540 91890]	Total Phosphorous	On-site biological effluent treatment plant	No limit set	24-hour flow proportional composite sample	Weekly	MCERTS - Performance Standards and Test Procedures for Continuous Water Monitoring Equipment
W1 [SS 72540 91890]	Biological Oxygen Demand (BOD)	On-site biological effluent treatment plant	25mg/l	24-hour flow proportional composite sample	Monthly	MCERTS - Performance Standards and Test Procedures for Continuous Water Monitoring Equipment
W1 [SS 72540 91890]	AOx	On-site biological effluent treatment plant	No limit set	24-hour flow proportional composite sample	Quarterly	MCERTS - Performance Standards and Test Procedures for Continuous Water Monitoring Equipment
W1 [SS 72540 91890]	Total cadmium and its compounds	On-site biological effluent treatment plant	No limit set	24-hour flow proportional composite sample	Quarterly	BS EN ISO 5961:1995

Table S3.2 Point Source emissions to water (other than sewer) and land – emission limits and monitoring requirements

Emission point ref. & location	Parameter	Source	Limit (incl. unit)	Reference Period	Monitoring frequency	Monitoring standard or method [Note 1]
W1 [SS 72540 91890]	Individual concentrations of the following total metals and their compounds: Fe, Pb, Zn, As, Cu, Cr, Ni	On-site biological effluent treatment plant	No limit set	24-hour flow proportional composite sample	Quarterly	BS EN ISO 15586:2003
W1 [SS 72540 91890]	Total mercury and its compounds	On-site biological effluent treatment plant	No limit set	24-hour flow proportional composite sample	Quarterly	BS EN 1483:2007
W1 [SS 72540 91890]	Priority Hazardous Substances Screen	On-site biological effluent treatment plant	No limit set	24-hour flow proportional composite sample	Annually	GC/MS analysis to be carried out by UKAS accredited laboratory
W2 (SS 73061, 93116) [Note 3]	-	Uncontaminated surface water	No limit set	-	-	-
W3 (SS 73083, 93137) [Note 3]	-	Uncontaminated surface water	No limit set	-	-	-

Note 1: Where in-house analysis is used for compliance assessment purposes, a duplicate sample shall be sent for external analysis (UKAS/ ISO17025) at a six monthly frequency.

Note 2: Limit does not apply to start up or shut down periods.

Note 3: The receiving waters are the River Neath via an oil interceptor.

Schedule 3 (b) – Emissions and monitoring

Emissions from 30/09/2018

Table S3.1 Point source emissions to air – emission limits and monitoring requirements

Emission point ref. & location	Parameter	Source	Limit (including unit)	Reference period	Monitoring frequency	Monitoring standard or method
A2 [Point B on site plan]	Particulate	Paper machine dust removal.	10 mg/m ³	Spot	Six Monthly	Unless otherwise agreed in writing with Natural Resources Wales, Monitoring methods used shall be in accordance with Environment Agency document “ <i>Technical Guidance Note M2 Monitoring of stack emissions to air</i> ”.
A3 [Point C on site plan]	Particulate	Exhaust to reel system	10 mg/m ³	Spot	Six Monthly	Unless otherwise agreed in writing with Natural Resources Wales, Monitoring methods used shall be in accordance with Environment Agency document “ <i>Technical Guidance Note M2 Monitoring of stack emissions to air</i> ”.
A4 [Point D on site plan]	No parameters set	Gas hood exhaust	No limit set	-	-	-
A5 [Point E on site plan]	No parameters set	Boiler exhaust	No limit set	-	-	-

Table S3.2 Point Source emissions to water (other than sewer) and land – emission limits and monitoring requirements

Emission point ref. & location	Parameter	Source	Limit (incl. unit)	Reference Period	Monitoring frequency	Monitoring standard or method [Note 1]
W1 [SS 72540 91890]	Maximum Daily Flow	On-site biological effluent treatment plant	850m ³ /day [Note 2]	24 hours	Continuous	MCERTS self-monitoring of effluent flow scheme
W1 [SS 72540 91890]	Mean Daily Flow	On-site biological effluent treatment plant	-	24 hours	Daily	MCERTS self-monitoring of effluent flow scheme
W1 [SS 72540 91890]	Flow rate	On-site biological effluent treatment plant	30 l/s	Instantaneous	Continuous	MCERTS self-monitoring of effluent flow scheme

Table S3.2 Point Source emissions to water (other than sewer) and land – emission limits and monitoring requirements

Emission point ref. & location	Parameter	Source	Limit (incl. unit)	Reference Period	Monitoring frequency	Monitoring standard or method [Note 1]
W1 [SS 72540 91890]	Temperature	On-site biological effluent treatment plant	40°C	Instantaneous	Continuous	Standard temperature sensor
W1 [SS 72540 91890]	pH maximum	On-site biological effluent treatment plant	9	Instantaneous	Continuous	MCERTS self-monitoring of effluent flow scheme
W1 [SS 72540 91890]	pH minimum	On-site biological effluent treatment plant	6	Instantaneous	Continuous	MCERTS self-monitoring of effluent flow scheme
W1 [SS 72540 91890]	Suspended solids	On-site biological effluent treatment plant	100mg/l	Spot sample	Daily	BS EN 872:2005
W1 [SS 72540 91890]	Chemical Oxygen Demand (COD)	On-site biological effluent treatment plant	No limit set	Spot sample	Daily	MCERTS - Performance Standards and Test Procedures for Continuous Water Monitoring Equipment
W1 [SS 72540 91890]	Total Nitrogen	On-site biological effluent treatment plant	No limit set	24-hour flow proportional composite sample	Weekly	MCERTS - Performance Standards and Test Procedures for Continuous Water Monitoring Equipment
W1 [SS 72540 91890]	Total Phosphorous	On-site biological effluent treatment plant	No limit set	24-hour flow proportional composite sample	Weekly	MCERTS - Performance Standards and Test Procedures for Continuous Water Monitoring Equipment
W1 [SS 72540 91890]	Biological Oxygen Demand (BOD)	On-site biological effluent treatment plant	25mg/l	24-hour flow proportional composite sample	Weekly	MCERTS - Performance Standards and Test Procedures for Continuous Water Monitoring Equipment

Table S3.2 Point Source emissions to water (other than sewer) and land – emission limits and monitoring requirements

Emission point ref. & location	Parameter	Source	Limit (incl. unit)	Reference Period	Monitoring frequency	Monitoring standard or method [Note 1]
W1 [SS 72540 91890]	AOx	On-site biological effluent treatment plant	No limit set	24-hour flow proportional composite sample	Every two months	BS EN ISO 9562 or other method as agreed in writing with Natural Resources Wales
W1 [SS 72540 91890]	Total cadmium and its compounds	On-site biological effluent treatment plant	No limit set	24-hour flow proportional composite sample	Quarterly	BS EN ISO 5961:1995
W1 [SS 72540 91890]	Individual concentrations of the following total and dissolved metals and their compounds: Fe, Pb, Zn, As, Cu, Cr, Ni and Cd	On-site biological effluent treatment plant	No limit set	24-hour flow proportional composite sample	Annually	BS EN ISO 15586:2003
W1 [SS 72540 91890]	Total mercury and its compounds	On-site biological effluent treatment plant	No limit set	24-hour flow proportional composite sample	Quarterly	BS EN 1483:2007
W1 [SS 72540 91890]	Priority Hazardous Substances Screen	On-site biological effluent treatment plant	No limit set	24-hour flow proportional composite sample	Annually	GC/MS analysis to be carried out by UKAS accredited laboratory
W2 (SS 73061, 93116) [Note 3]	-	Uncontaminated surface water	No limit set	-	-	-
W3 (SS 73083, 93137) [Note 3]	-	Uncontaminated surface water	No limit set	-	-	-

Note 1: Where in-house analysis is used for compliance assessment purposes, a duplicate sample shall be sent for external analysis (UKAS/ ISO17025) at a six monthly frequency.

Note 2: Limit does not apply to start up or shut down periods.

Note 3: The receiving waters are the River Neath via an oil interceptor.

Table S3.3 Annual limits

Substance	Medium	Limit (including unit)
Chemical Oxygen Demand (COD)	Water	1.5 kg/t
Total suspended solids (TSS)	Water	0.35 Kg/t
Total nitrogen	Water	0.15 kg/t
Total phosphorus	Water	0.012 kg/t
Adsorbable organically bound halogens (AOX)	Water	0.05 kg/t

Schedule 4 (a) – Reporting

Reporting until 29/09/2018

Parameters, for which reports shall be made, in accordance with conditions of this permit, are listed below.

Table S4.1 Reporting of monitoring data

Parameter	Emission or monitoring point/reference	Reporting period	Period begins
Emissions to air Parameters as required by condition 3.5.1.	A2, A3	Every 6 months	01/01/2012
Emissions to water Parameters as required by condition 3.5.1	W1	Every 6 months	01/01/2012

Table S4.2 Performance parameters

Parameter	Frequency of assessment	Units
Total Energy Used	Annually	MWh
Effluent discharged	Quarterly	m ³
Water usage	Annually	Tonnes
Chemical Oxygen Demand	Annually	kg/t
Total Suspended Solids	Annually	kg/t
Total Nitrogen	Annually	kg/t
Total Phosphorus	Annually	kg/t
Adsorbable organically bound halides (AOX)	Annually	kg/t

Table S4.3 Reporting forms

Media/parameter	Reporting format	Date of form
Air	Form air 1 or other form as agreed in writing by Natural Resources Wales	09/01/12
Water	Form water 1 or other form as agreed in writing by Natural Resources Wales	09/01/12
Other performance indicators	Form performance 1 or other form as agreed in writing by Natural Resources Wales	09/01/12
Resource Efficiency	Form Performance 2 or other form as agreed in writing by Natural Resources Wales	31/03/16

Schedule 4 (b) – Reporting

Reporting from 30/09/2018

Parameters, for which reports shall be made, in accordance with conditions of this permit, are listed below.

Table S4.1 Reporting of monitoring data

Parameter	Emission or monitoring point/reference	Reporting period	Period begins
Emissions to air Parameters as required by condition 3.5.1.	A2, A3	Every 6 months	30/09/2018
Emissions to water Parameters as required by condition 3.5.1	W1	Every 12 months	30/09/2018

Table S4.2 Performance parameters

Parameter	Frequency of assessment	Units
Total Energy Used	Annually	MWh
Effluent discharged	Quarterly	m ³
Water usage	Annually	Tonnes
Chemical Oxygen Demand	Annually	kg/t
Total Suspended Solids	Annually	kg/t
Total Nitrogen	Annually	kg/t
Total Phosphorus	Annually	kg/t
Adsorbable organically bound halides (AOX)	Annually	kg/t

Table S4.3 Reporting forms

Media/parameter	Reporting format	Date of form
Air	Form air 1 or other form as agreed in writing by Natural Resources Wales	30/09/18
Water	Form water 1 or other form as agreed in writing by Natural Resources Wales	30/09/18
Other performance indicators	Form performance 1 or other form as agreed in writing by Natural Resources Wales	30/09/18
Resource Efficiency	Form Performance 2 or other form as agreed in writing by Natural Resources Wales	30/09/18

Schedule 5 - Notification

These pages outline the information that the operator must provide.

Units of measurement used in information supplied under Part A and B requirements shall be appropriate to the circumstances of the emission. Where appropriate, a comparison should be made of actual emissions and authorised emission limits.

If any information is considered commercially confidential, it should be separated from non-confidential information, supplied on a separate sheet and accompanied by an application for commercial confidentiality under the provisions of the EP Regulations.

Part A

Permit Number	
Name of operator	
Location of Facility	
Time and date of the detection	

(a) Notification requirements for any activity that gives rise to an incident or accident which significantly affects or may significantly affect the environment	
To be notified Immediately	
Date and time of the event	
Reference or description of the location of the event	
Description of where any release into the environment took place	
Substances(s) potentially released	
Best estimate of the quantity or rate of release of substances	
Measures taken, or intended to be taken, to stop any emission	
Description of the failure or accident.	

(b) Notification requirements for the breach of a permit condition	
To be notified immediately	
Emission point reference/ source	
Parameter(s)	
Limit	
Measured value and uncertainty	
Date and time of monitoring	
Measures taken, or intended to be taken, to stop the emission	

Time periods for notification following detection of a breach of a limit	
Parameter	Notification period

(c) In the event of a breach of permit condition which poses an immediate danger to human health or threatens to cause an immediate significant adverse effect on the environment:

To be notified immediately	
Description of where the effect on the environment was detected	
Substances(s) detected	
Concentrations of substances detected	
Date of monitoring/sampling	

Part B - to be submitted as soon as practicable

Any more accurate information on the matters for notification under Part A.	
Measures taken, or intended to be taken, to prevent a recurrence of the incident	
Measures taken, or intended to be taken, to rectify, limit or prevent any pollution of the environment which has been or may be caused by the emission	
The dates of any unauthorised emissions from the facility in the preceding 24 months.	

Name*	
Post	
Signature	
Date	

* authorised to sign on behalf of the operator

Schedule 6 - Interpretation

“accident” means an accident that may result in pollution. AOX is adsorbable organic halides measured according to the EN ISO:9562 standard method for waste waters.

“application” means the application for this permit, together with any additional information supplied by the operator as part of the application and any response to a notice served under Schedule 5 to the EP Regulations.

“authorised officer” means any person authorised by Natural Resources Wales under section 108(1) of The Environment Act 1995 to exercise, in accordance with the terms of any such authorisation, any power specified in section 108(4) of that Act.

“disposal” means any of the operations provided for in Annex IIA to Directive 2006/12/EC of the European Parliament and of the Council of 5 April 2006 on Waste.

“EP Regulations” means The Environmental Permitting (England and Wales) Regulations SI 2010 No.675 and words and expressions used in this permit which are also used in the Regulations have the same meanings as in those Regulations.

“emissions of substances not controlled by emission limits” means emissions of substances to air, water or land from the activities, either from the emission points specified in schedule 3 or from other localised or diffuse sources, which are not controlled by an emission limit..

“groundwater” means all water, which is below the surface of the ground in the saturation zone and in direct contact with the ground or subsoil.

“hazardous property” has the meaning given in Schedule 3 of the Hazardous Waste (England and Wales) Regulations 2005 No.894 and the Hazardous Waste (Wales) Regulations 2005 No. 1806 (W.138).

“Industrial Emissions Directive” means DIRECTIVE 2010/75/EU OF THE EUROPEAN PARLIAMENT AND OF THE COUNCIL of 24 November 2010 on industrial emissions

“MCERTS” means the Environment Agency’s Monitoring Certification Scheme.

Pests” means Birds, Vermin and Insects.

“quarter” means a calendar year quarter commencing on 1 January, 1 April, 1 July or 1 October.

Water Framework Directive Priority Hazardous Substances are Anthracene, Brominated diphenyl ether, Cadmium, C10-13 Chloroalkanes, Endosulphan, Hexachlorobenzene, Hexachlorobutadiene, Hexachloro-cyclohexane, Mercury and its compounds, Nonylphenol (4-Nonylphenol), Pentachlorobenzene, Polycyclic aromatic Hydrocarbons (PAHs), Tributyltin compounds (Tributyltin-cation) “year” means calendar year ending 31 December.

Where a minimum limit is set for any emission parameter, for example pH, reference to exceeding the limit shall mean that the parameter shall not be less than that limit.

Unless otherwise stated, any references in this permit to concentrations of substances in emissions into air means:

in relation to emissions from combustion processes, the concentration in dry air at a temperature of 273K, at a pressure of 101.3 kPa and with an oxygen content of 3% dry for liquid and gaseous fuels, 6% dry for solid fuels; and/or

in relation to emissions from non-combustion sources, the concentration at a temperature of 273K and at a pressure of 101.3 kPa, with no correction for water vapour content

‘The calculation for converting mg/m³ to kg/t can be found in Annex 1 of the Manufacture of Paper, Pulp and Board Best Available Techniques Reference document (BRef) published on 26 September 2014.’

Schedule 7 - Site plan

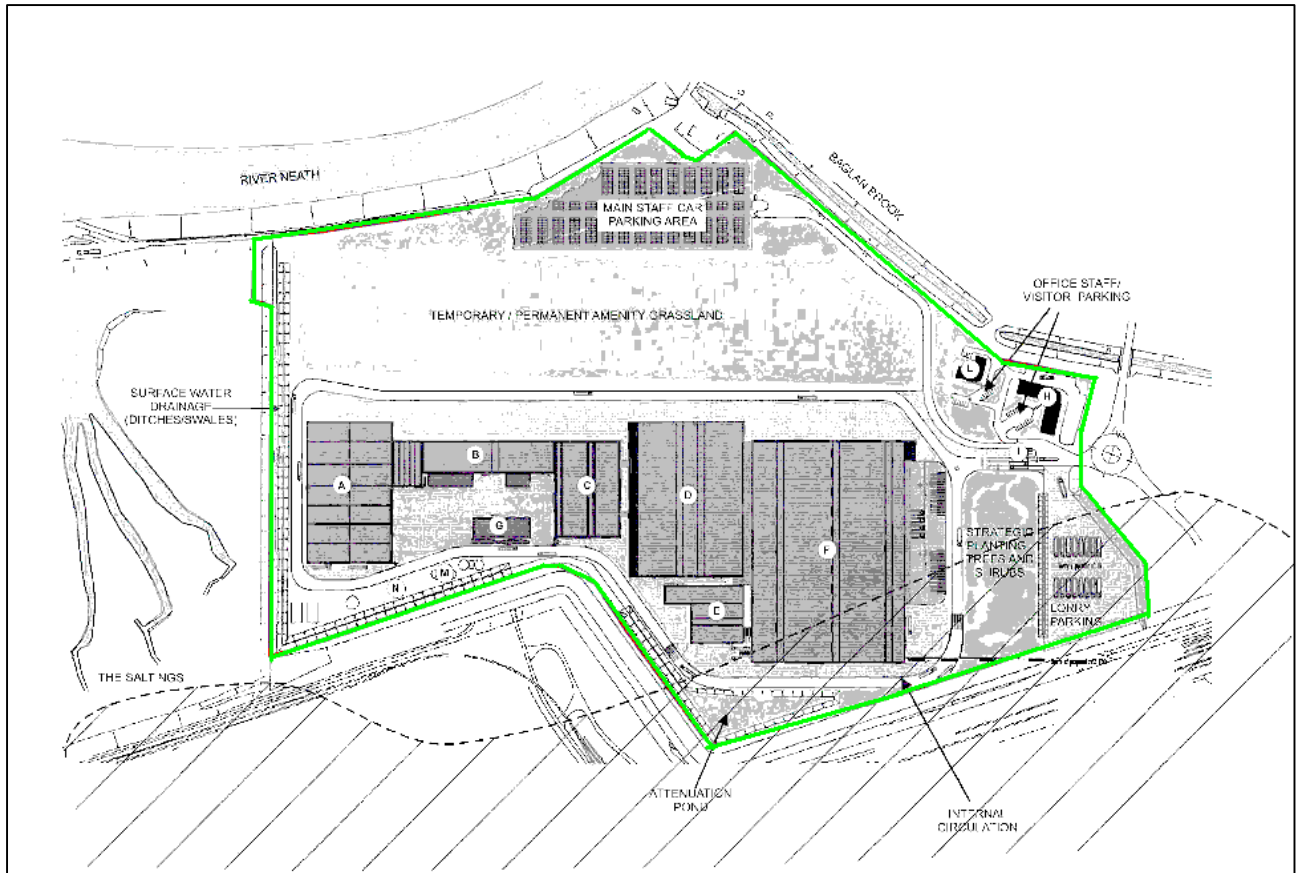

© Crown Copyright and database right 2015. Ordnance Survey licence number 100019741.

END OF PERMIT