

Variation notice with introductory note

Environmental Permitting (England & Wales) Regulations 2007

Nantycaws Landfill Site

CWM Environmental Ltd
Llanddorag Road
Nantycaws
Carmarthen
Carmarthenshire
SA32 8BG

Variation notice number
EPR/CP3735PB/V004

Permit number
EPR/CP3735PB

Nantycaws Landfill Site

Permit Number EPR/CP3735PB

Introductory note

This introductory note does not form a part of the permit

The following notice, which is issued pursuant to regulation 20 and Part 1 of Schedule 5 of the Environmental Permitting (England and Wales) Regulations S.I.2007 No. 3538 (the Regulations), gives notice of the variation of an environmental permit to operate a regulated facility.

The effect of the variation is to increase the height of the pre-settlement contours across the site, to amend leachate quality trigger levels and to increase the installation boundary.

Schedule 1 of this notice lists any deleted conditions, Schedule 2 lists any amended conditions and Schedule 3 lists any conditions that have been added.

Status Log of the permit		
Detail	Date	Response Date
Application CP3735PB (EPR Reference: EPR/CP3735PB/A001)	Received 03/05/2004	
Permit CP3735PB determined (EPR Reference: EPR/CP3735PB)	02/08/2005	
Variation application DP3934LP	Received 24/03/2006	
Variation application DP3636LJ	Received 02/06/2006	
Variation DP3934LP determined (EPR Reference: EPR/CP3735PB/V002)	01/12/2006	
Variation DP3636LJ determined (EPR Reference: EPR/CP3735PB/V003)	28/02/2008	
Variation application EPR/CP3735PB/V004	Received 24/07/2008	Duly made 24/07/2008
Variation EPR/CP3735PB/V004 determined	23/09/2009	

Other Part A installation permits relating to this installation		
Operator	Permit Number	Date of Issue
Novera Energy Generation No.2 Ltd	LP3038SU (EPR reference: EPR/LP3038SU)	28/04/2005

End of Introductory Note

Notice of variation

**Environmental Permitting
(England and Wales) Regulations 2007**

Permit number

EPR/CP3735PB

Variation number

EPR/CP3735PB/V004

The Environment Agency in exercise of its powers under Regulation 20 of the Environmental Permitting (England and Wales) Regulations 2007 (SI 2000 No 3538) varies the permit as set out below.

CWM Environmental Ltd (“the operator”),

whose registered office is

Cillefwr Industrial Estate

Alltynap Road

Johnstown

Carmarthen

Carmarthenshire

SA31 3RA

company registration number **02640102**

holds a permit to operate part of a regulated facility at

Nantycaws Landfill Site

Llanddarog Road

Nantycaws

Carmarthen

Carmarthenshire

SA32 8BG

and that permit is varied to the extent set out in Schedules 1 to 3 of this notice.

The notice shall take effect from 23 September 2009.

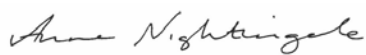
Name	Date
	23 September 2009

Anne Nightingale

Authorised to sign on behalf of the Agency

Schedule 1 – conditions to be deleted

1. The following conditions are deleted:

4.3.9 (b)

Schedule 2 – conditions to be amended

2. The following conditions are amended:

Conditions 2.2.1 and 2.8.6 are amended by deleting the previous conditions and replacing them with the following new conditions:

2.2.1 The activities shall not extend beyond the site, being the land shown edged in orange on the site plan at schedule 2 to this permit, which is within the area edged in green on the site plan that represents the extent of the installation covered by this permit and that of the other operator of the installation.

2.8.6 The total quantity of waste that shall be deposited in the landfill shall be limited by the pre-settlement levels shown on drawing number 001 dated March 2009 (Appendix G of the response dated 20 March 2009 to the schedule 5 notice).

Schedule 1 table S1.2 as referenced by condition 2.3.1 is amended by adding the following rows:

Table S1.2 Operating techniques		
Description	Parts	Date Received
Compliance with improvement programme requirement reference 1.4.1.22: Nantycaws Landfill, Carmarthen, Odour Management Plan, reference 407.0610.00011 dated January 2008	All	January 2008
Variation application	Response to questions 2a and 2b in Part C of the application form excluding sections 1.3.1, 1.3.3 and 1.3.4 of the Supporting Statement reference 407-0610-00011/SS	24/07/2008
Response to schedule 5 notice dated 10/02/2009	Response to questions 4 and 5 and Appendix F (Surface Water Management Plan)	20/03/2009
Response to schedule 5 notice dated 09/07/2009	Penultimate paragraph (relating to flow monitoring)	21/07/2009

replaced with the following drawing:

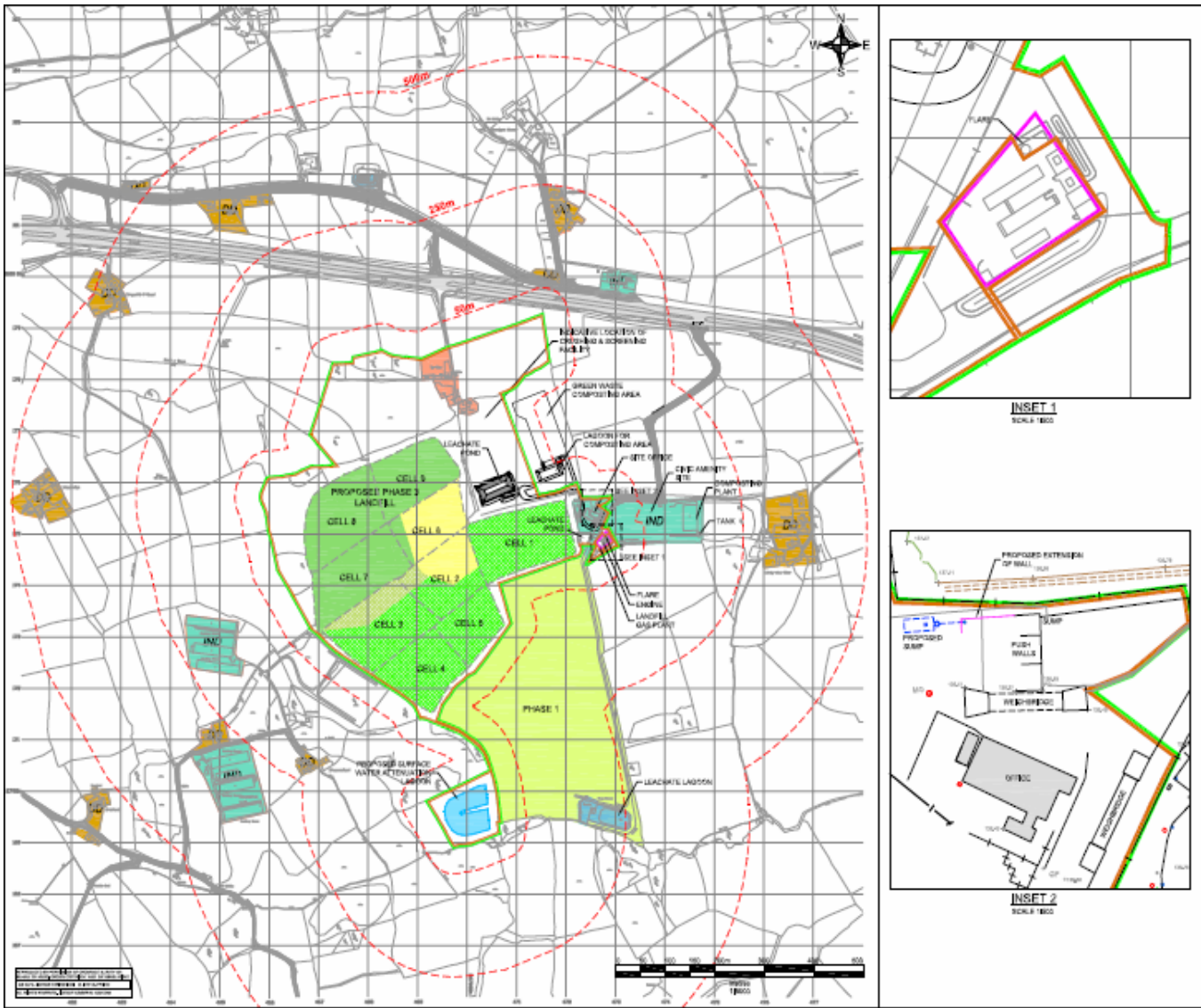

Not to scale

From drawing reference ESID 2, dated May 2009

Schedule 4 table S4.9 is amended by changing the text of point 2 in the “Other specifications” columns to:

Table S4.9 Leachate – other monitoring requirements				
Emission point reference or source or description of point of measurement	Parameter	Monitoring frequency	Monitoring standard or method	Other specifications
a) All leachate monitoring wells	Leachate Level	Monthly	Unless otherwise agreed in writing with the Agency, monitoring methods used shall be in accordance with Environment Agency document ‘Guidance on monitoring of landfill leachate, groundwater and surface water’ (LFTGN02)	1. The operator shall supply in writing details of List I substances to be analysed one month prior to undertaking annual monitoring. This shall include all parameters used in the Hydrogeological Risk Assessment.
	Monitoring point base	Annually		
b) Cell 1 & 2 Sump	Leachate Level	Monthly	2. In the event that the trigger levels detailed in Table HRA9 of the hydrogeological risk assessment (SLR Ref: 407-0610-00011/HRA) dated May 2006 and section 3.1 of Appendix SS3 (SLR Ref: 407.0610.00011 dated June 2008) to the variation application received on 24/07/2008 are exceeded, the Agency shall be notified in writing within seven days of the result being received by the operator.	
c) Cell 4 Sump	Electrical	Monthly		
d) Cell 5 Sump	Conductivity	Monthly		
e) Leachate pond as identified on plan ESID2 dated May 2004.	Chloride	Monthly		
	Ammoniacal Nitrogen	Monthly		
	Total Alkalinity	Quarterly		
f) Leachate holding lagoon as identified on plan HRA1 dated July 2006.	Magnesium	Quarterly		
	Potassium	Quarterly		
	Total Sulphate	Quarterly		
	Calcium	Quarterly		
g) Sumps 3-1, 3-2, 3-3, 3-4 as identified on Drawing number 7 dated May 2006.	Sodium	Quarterly		
	Biochemical Oxygen Demand	Quarterly		
	Chemical Oxygen Demand	Quarterly		
	Total Organic Carbon	Quarterly		
	Total Oxidised Nitrogen	Quarterly		
	Manganese	Quarterly		
	Iron	Quarterly		
	Chromium	Quarterly		
	Copper	Quarterly		
	Lead	Quarterly		
	Zinc	Quarterly		
	Nickel	Quarterly		
	Mecoprop	Quarterly		
	Diethylphthalate	Quarterly		
	Dichloromethane, 4-Methylphenol	Quarterly		
	Monitoring point base	Annually		
	List 1 screen	Annually		

Schedule 3 – conditions to be added

3. The following conditions are added to the permit:

The following requirements are added to table S1.3 in Schedule 1 as referenced by condition 2.5:

Table S1.3 Improvement programme requirements		
Reference	Requirement	Date
1.4.1.25	<p>The operator shall submit a leachate management plan in writing to the Agency that includes:</p> <ul style="list-style-type: none">• as built drawings of all leachate monitoring points and extraction wells;• a plan showing the locations of all leachate monitoring points and extraction wells, including details of the survey to Ordnance Datum for each point and well;• a plan showing the spatial distribution of the extraction wells;• details of the zone of influence of each extraction well;• details of the leachate pumping regime together with justification; and• details of a contingency action plan.	31/01/2010
1.4.1.26	<p>The operator shall provide a written report to the Agency that details the following information:</p> <ul style="list-style-type: none">• how leachate levels are monitored in all monitoring wells at the site;• that all monitoring and extraction wells are of sufficient depth to allow measurement of leachate depth above the base of the liner;• the leachate level profile within each cell at the site;• analysis of data to determine whether the leachate levels comply with the limits as detailed in table S4.1 of Schedule 4 to the permit.	31/01/2010

The following requirement is added to table S1.4B in Schedule 1 as referenced by condition 2.6:

Table S1.4B Pre-operational Measures for Future Development

Reference	Operation	Pre-operational Measures
5	Discharge from the attenuation lagoons	<p>The operator shall submit written proposals to the Agency for approval regarding the emission of surface water from the attenuation lagoons at the new emission point SW205 as shown on drawing reference ESID13 dated June 2008, revision 2. The proposals shall include:</p> <ul style="list-style-type: none">• emission limits for specified parameters;• discharge rate and volume of discharge based on the area of the catchment and average rainfall over a number of years together with the design parameters of the lagoons;• an assessment of the impact of the discharge using the Agency's H1 methodology for the parameters proposed above; and• details of the monitoring to be undertaken, including frequency, parameters and methodology.