

# Permit with introductory note

The Environmental Permitting (England & Wales) Regulations 2016

---

**Princes Limited**

**Soft Drinks Site – Cardiff  
Portmanmoor Road  
East Moors  
Cardiff  
CF24 5HB**

Permit number  
**EPR/BX8289IW**

# Soft Drinks Site– Cardiff

## Permit number EPR/BX8289IW

### Introductory note

#### **This introductory note does not form a part of the permit**

The main features of the permit are as follows.

The installation is within an industrial estate in Cardiff and produces fruit juices and fruit juice drinks in cartons and bottles from concentrated juices and mains water. The juices are pasteurised in steam-heated units and then chilled before packing. Effluent from the process is either discharged to sewer under a trade effluent consent or stored on site in a 30,000 litre tank and subsequently taken off site for anaerobic digestion.

The site has two gas-fired boiler plant each with a thermal input of 4.02 MWth. One of the boilers was commissioned after 19 December 2018 and is therefore subject to the medium combustion plant directive (MCPD).

The other point sources of emissions to air are from the condenser units (points A3-A9) and emissions of hydrogen peroxide from the sterilisation line (A10-A16).

The site has an Environmental Management System accredited to ISO 14001. There is a climate levy agreement in place.

The status log of the permit sets out the permitting history, including any changes to the permit reference number.

Status log of the permit		
Description	Date	Comments
Application	Received 24/02/05	
Response to request for information	Request dated 28/02/05	Response dated 17/03/05
Permit determined	05/05/05	
Application DP3132LM	Received 15/05/06	
Application DP3132LM	Duly made 19/05/06	
Variation notice DP3132LM issued	21/06/06	
Application EPR/BX8289IW/V003 (PASas ref EP3936TX)	Duly made 23/06/10	
Request for information	Request dated 29/06/10	Response dated 30/06/10
Variation notice EPR/BX8289IW/V003	16/07/2010	

Status log of the permit		
Description	Date	Comments
Regulation 61 Notice sent to the Operator	28/04/20	Issue of a Notice under Regulation 61(1) of the EPR. Natural Resources Wales initiated review and variation to vary the permit following the publication of the revised Best Available Techniques (BAT) Reference Document (BRef) for Food, Drink and Milk.
Regulation 61 Notice response	11/11/20	Response received from the operator.
Variation application EPR/BX8289IW/V004	Duly made 26/10/21	Variation to install additional gas-fired boiler plant with associated emission point (A2) and additional emission points for condensate from each filler line (A3 to A9) and hydrogen peroxide from packaging sterilisation (A10 to A16). A 30,000 litre storage tank is to be installed to enable a proportion of the effluent to be stored and removed from site for anaerobic digestion. The foul sewer emission point (S1) and associated sampling point are to be relocated which requires an expansion of the Environmental Permit boundary.
Request for further information Schedule 5 Notice dated 22/12/21	Received 01/02/22	Additional information regarding odour management plan
Request for further information Schedule 5 Notice dated 21/03/22	28/03/22	Ammended air dispersion modelling report.
Variation determined EPR/BX8289IW/V004	DD/MM/YY	Substantial variation and incorporating changes from the statutory sector review following the publication of the revised Best Available Techniques (BAT) Reference Document (BRef) for the Food, Drink and Milk Industries issued to Princes Limited.

End of introductory note

# Permit

The Environmental Permitting (England and Wales) Regulations 2016

Permit number

**EPR/BX8289IW**

This is the consolidated permit referred to in the variation and consolidation notice for application EPR/BX8289IW/V004 authorising

**Princes Limited** (“the operator”),

whose registered office is

**Royal Liver Building**

**Pier Head**

**Liverpool**

**L3 1NX**

company registration number **02328824**

to operate an installation at

**Soft Drinks Site– Cardiff**

**Portmanmoor Road**

**East Moors**

**Cardiff**

**CF24 5HB**

to the extent authorised by and subject to the conditions of this permit.

Signed

Date

<i><b>[name of authorised person]</b></i>	<i><b>[DD/MM/YYYY]</b></i>
---	----------------------------

Authorised on behalf of Natural Resources Wales

# Conditions

## 1 Management

### 1.1 General management

1.1.1 The operator shall manage and operate the activities:

- (a) in accordance with a written management system that identifies and minimises risks of pollution, including those arising from operations, maintenance, accidents, incidents, non-conformances, closure and those drawn to the attention of the operator as a result of complaints; and
- (b) using sufficient competent persons and resources.

1.1.2 Records demonstrating compliance with condition 1.1.1 shall be maintained.

1.1.3 Any person having duties that are or may be affected by the matters set out in this permit shall have convenient access to a copy of it kept at or near the place where those duties are carried out.

### 1.2 Energy efficiency

1.2.1 The operator shall:

- (a) take appropriate measures to ensure that energy is used efficiently in the activities;
- (b) review and record at least every four years whether there are suitable opportunities to improve the energy efficiency of the activities; and
- (c) take any further appropriate measures identified by a review.

### 1.3 Efficient use of raw materials

1.3.1 The operator shall:

- (a) take appropriate measures to ensure that raw materials and water are used efficiently in the activities;
- (b) maintain records of raw materials and water used in the activities;
- (c) review and record at least every four years whether there are suitable alternative materials that could reduce environmental impact or opportunities to improve the efficiency of raw material and water use; and
- (d) take any further appropriate measures identified by a review.

### 1.4 Avoidance, recovery and disposal of wastes produced by the activities

1.4.1 The operator shall take appropriate measures to ensure that:

- (a) the waste hierarchy referred to in Article 4 of the Waste Framework Directive is applied to the generation of waste by the activities; and
- (b) any waste generated by the activities is treated in accordance with the waste hierarchy referred to in Article 4 of the Waste Framework Directive; and
- (c) where disposal is necessary, this is undertaken in a manner which minimises its impact on the environment.

- 1.4.2 The operator shall review and record at least every four years whether changes to those measures should be made and take any further appropriate measures identified by a review.

## **2 Operations**

### **2.1 Permitted activities**

- 2.1.1 The operator is only authorised to carry out the activities specified in schedule 1 table S1.1 (the “activities”).

### **2.2 The site**

- 2.2.1 The activities shall not extend beyond the site, being the land shown edged in green on the site plan at schedule 7 to this permit.
- 2.2.2 For the following activities referenced in schedule 1, table S1.1, AR7, no MCP shall be operated beyond the site of the grid reference specified for it in schedule 1, table S1.1 of the permit

### **2.3 Operating techniques**

- 2.3.1 (a) The activities shall, subject to the conditions of this permit, be operated using the techniques and in the manner described in the documentation specified in schedule 1, table S1.2, unless otherwise agreed in writing by Natural Resources Wales.
- (b) If notified by Natural Resources Wales that the activities are giving rise to pollution, the operator shall submit to Natural Resources Wales for approval within the period specified, a revision of any plan or other documentation (“plan”) specified in schedule 1, table S1.2 or otherwise required under this permit which identifies and minimises the risks of pollution relevant to that plan, and shall implement the approved revised plan in place of the original from the date of approval, unless otherwise agreed in writing by Natural Resources Wales.
- 2.3.2 Any raw materials or fuels listed in schedule 2 table S2.1 shall conform to the specifications set out in that table.
- 2.3.3 The operator shall ensure that where waste produced by the activities is sent to a relevant waste operation, that operation is provided with the following information, prior to the receipt of the waste:
- (a) the nature of the process producing the waste;
- (b) the composition of the waste;
- (c) the handling requirements of the waste;
- (d) the hazardous property associated with the waste, if applicable; and
- (e) the waste code of the waste.
- 2.3.4 The operator shall ensure that where waste produced by the activities is sent to a landfill site, it meets the waste acceptance criteria for that landfill.
- 2.3.5 For the following activities referenced in schedule 1, table S1.1 AR7 the activities shall be operated using the techniques and, in the manner, described in schedule 1, table S1.2A

### **2.4 Improvement programme**

- 2.4.1 The operator shall complete the improvements specified in schedule 1 table S1.3 by the date specified in that table unless otherwise agreed in writing by Natural Resources Wales.

- 2.4.2 Except in the case of an improvement which consists only of a submission to Natural Resources Wales, the operator shall notify Natural Resources Wales within 14 days of completion of each improvement.

## **3 Emissions and monitoring**

### **3.1 Emissions to water, air or land**

- 3.1.1 There shall be no point source emissions to water, air or land except from the sources and emission points listed in schedule 3 tables S3.1, S3.2 and S3.3
- 3.1.2 The limits given in schedule 3 shall not be exceeded.
- 3.1.3 Total annual emissions from the emission point(s) set out in tables schedule 3 S3.2 of a substance listed in schedule 3 table S3.4 shall not exceed the relevant limit in table S3.4.
- 3.1.4 Periodic monitoring shall be carried out at least once every 5 years for groundwater and 10 years for soil, unless such monitoring is based on a systematic appraisal of the risk of contamination.

### **3.2 Emissions of substances not controlled by emission limits**

- 3.2.1 Emissions of substances not controlled by emission limits (excluding odour) shall not cause pollution. The operator shall not be taken to have breached this condition if appropriate measures, including, but not limited to, those specified in any approved emissions management plan, have been taken to prevent or where that is not practicable, to minimise, those emissions.
- 3.2.2 The operator shall:
- (a) if notified by Natural Resources Wales that the activities are giving rise to pollution, submit to Natural Resources Wales for approval within the period specified, an emissions management plan which identifies and minimises the risks of pollution from emissions of substances not controlled by emission limits;
  - (b) implement the approved emissions management plan, from the date of approval, unless otherwise agreed in writing by Natural Resources Wales.
- 3.2.3 All liquids in containers, whose emission to water or land could cause pollution, shall be provided with secondary containment, unless the operator has used other appropriate measures to prevent or where that is not practicable, to minimise, leakage and spillage from the primary container.

### **3.3 Odour**

- 3.3.1 Emissions from the activities shall be free from odour at levels likely to cause pollution outside the site, as perceived by an authorised officer of Natural Resources Wales, unless the operator has used appropriate measures, including, but not limited to, those specified in any approved odour management plan, to prevent or where that is not practicable to minimise the odour.
- 3.3.2 The operator shall:
- (a) if notified by Natural Resources Wales that the activities are giving rise to pollution outside the site due to odour, submit to Natural Resources Wales for approval within the period specified, an odour management plan which identifies and minimises the risks of pollution from odour;
  - (b) implement the approved odour management plan, from the date of approval, unless otherwise agreed in writing by Natural Resources Wales.

### 3.4 Noise and vibration

- 3.4.1 Emissions from the activities shall be free from noise and vibration at levels likely to cause pollution outside the site, as perceived by an authorised officer of Natural Resources Wales, unless the operator has used appropriate measures, including, but not limited to, those specified in any approved noise and vibration management plan to prevent or where that is not practicable to minimise the noise and vibration.
- 3.4.2 The operator shall:
- (a) if notified by Natural Resources Wales that the activities are giving rise to pollution outside the site due to noise and vibration, submit to Natural Resources Wales for approval within the period specified, a noise and vibration management plan which identifies and minimises the risks of pollution from noise and vibration;
  - (b) implement the approved noise and vibration management plan, from the date of approval, unless otherwise agreed in writing by Natural Resources Wales.

### 3.5 Monitoring

- 3.5.1 The operator shall, unless otherwise agreed in writing by Natural Resources Wales, undertake the monitoring specified in the following tables in schedule 3 to this permit:
- (a) point source emissions specified in tables S3.1, S3.2 and S3.3.
- 3.5.2 The operator shall maintain records of all monitoring required by this permit including records of the taking and analysis of samples, instrument measurements (periodic and continual), calibrations, examinations, tests and surveys and any assessment or evaluation made on the basis of such data.
- 3.5.3 Monitoring equipment, techniques, personnel and organisations employed for the emissions monitoring programme and the environmental or other monitoring specified in condition 3.5.1 shall have either MCERTS certification or MCERTS accreditation (as appropriate), where available, unless otherwise agreed in writing by Natural Resources Wales.
- 3.5.4 Permanent means of access shall be provided to enable sampling/monitoring to be carried out in relation to the emission points specified in schedule 3 tables S3.1, S3.2, S3.3 unless otherwise agreed in writing by Natural Resources Wales.
- 3.5.5 For the following activities referenced in schedule 1, table S1.1, AR7, Monitoring shall not take place during periods of start up or shut down.
- 3.5.6 For the following activities referenced in schedule 1, table S1.1, AR7, the first monitoring measurements shall be carried out within four months of the issue date of the permit or the date when the MCP is first put into operation, whichever is later.

### 3.6 Pests

- 3.6.1 The activities shall not give rise to the presence of pests which are likely to cause pollution, hazard or annoyance outside the boundary of the site. The operator shall not be taken to have breached this condition if appropriate measures, including, but not limited to, those specified in any approved pests management plan, have been taken to prevent or where that is not practicable, to minimise the presence of pests on the site.
- 3.6.2 The operator shall:
- (a) if notified by Natural Resources Wales, submit to Natural Resources Wales for approval within the period specified, a pests management plan which identifies and minimises risks of pollution, hazard or annoyance from pests;
  - (b) implement the pests management plan, from the date of approval, unless otherwise agreed in writing by Natural Resources Wales.

## 4 Information

### 4.1 Records

4.1.1 All records required to be made by this permit shall:

- (a) be legible;
- (b) be made as soon as reasonably practicable;
- (c) if amended, be amended in such a way that the original and any subsequent amendments remain legible, or are capable of retrieval; and
- (d) be retained, unless otherwise agreed in writing by Natural Resources Wales, for at least 6 years from the date when the records were made, or in the case of the following records until permit surrender:
  - (i) off-site environmental effects; and
  - (ii) matters which affect the condition of the land and groundwater.

4.1.2 The operator shall keep on site all records, plans and the management system required to be maintained by this permit, unless otherwise agreed in writing by Natural Resources Wales.

### 4.2 Reporting

4.2.1 The operator shall send all reports and notifications required by the permit to Natural Resources Wales using the contact details supplied in writing by Natural Resources Wales.

4.2.2 A report or reports on the performance of the activities over the previous year shall be submitted to Natural Resources Wales by 31 January (or other date agreed in writing by Natural Resources Wales) each year. The report(s) shall include as a minimum:

- (a) a review of the results of the monitoring and assessment carried out in accordance with the permit including an interpretive review of that data;
- (b) the annual production / treatment data set out in schedule 4 table S4.2; and
- (c) the performance parameters set out in schedule 4 table S4.3 using the forms specified in table S4.4 of that schedule.

4.2.3 Within 28 days of the end of the reporting period the operator shall, unless otherwise agreed in writing by Natural Resources Wales, submit reports of the monitoring and assessment carried out in accordance with the conditions of this permit, as follows:

- (a) in respect of the parameters and emission points specified in schedule 4 table S4.1;
- (b) for the reporting periods specified in schedule 4 table S4.1 and using the forms specified in schedule 4 table S4.4 ; and
- (c) giving the information from such results and assessments as may be required by the forms specified in those tables.

4.2.4 The operator shall, unless notice under this condition has been served within the preceding four years, submit to Natural Resources Wales, within six months of receipt of a written notice, a report assessing whether there are other appropriate measures that could be taken to prevent, or where that is not practicable, to minimise pollution.

### 4.3 Notifications

- 4.3.1 (a) In the event that the operation of the activities gives rise to an incident or accident which significantly affects or may significantly affect the environment, the operator must immediately—
- (i) inform Natural Resources Wales,
  - (ii) take the measures necessary to limit the environmental consequences of such an incident or accident, and
  - (iii) take the measures necessary to prevent further possible incidents or accidents;
- (b) in the event of a breach of any permit condition the operator must immediately—
- (i) inform Natural Resources Wales, and
  - (ii) take the measures necessary to ensure that compliance is restored within the shortest possible time;
- (c) in the event of a breach of permit condition which poses an immediate danger to human health or threatens to cause an immediate significant adverse effect on the environment, the operator must immediately suspend the operation of the activities or the relevant part of it until compliance with the permit conditions has been restored.
- 4.3.2 Any information provided under condition 4.3.1 (a)(i), or 4.3.1 (b)(i) where the information relates to the breach of a limit specified in the permit, shall be confirmed by sending the information listed in schedule 5 to this permit within the time period specified in that schedule.
- 4.3.3 Where Natural Resources Wales has requested in writing that it shall be notified when the operator is to undertake monitoring and/or spot sampling, the operator shall inform Natural Resources Wales when the relevant monitoring and/or spot sampling is to take place. The operator shall provide this information to Natural Resources Wales at least 14 days before the date the monitoring is to be undertaken.
- 4.3.4 Natural Resources Wales shall be notified within 14 days of the occurrence of the following matters, except where such disclosure is prohibited by Stock Exchange rules:

Where the operator is a registered company:

- (a) any change in the operator's trading name, registered name or registered office address; and
- (b) any steps taken with a view to the operator going into administration, entering into a company voluntary arrangement or being wound up.

Where the operator is a corporate body other than a registered company:

- (a) any change in the operator's name or address; and
- (b) any steps taken with a view to the dissolution of the operator.

In any other case:

- (a) the death of any of the named operators (where the operator consists of more than one named individual);
- (b) any change in the operator's name(s) or address(es); and
- (c) any steps taken with a view to the operator, or any one of them, going into bankruptcy, entering into a composition or arrangement with creditors, or, in the case of them being in a partnership, dissolving the partnership.

- 4.3.5 Where the operator proposes to make a change in the nature or functioning, or an extension of the activities, which may have consequences for the environment and the change is not otherwise the subject of an application for approval under the Regulations or this permit:
- (a) Natural Resources Wales shall be notified at least 14 days before making the change; and
  - (b) the notification shall contain a description of the proposed change in operation.
- 4.3.6 Natural Resources Wales shall be given at least 14 days notice before implementation of any part of the site closure plan.
- 4.3.7 Where the operator has entered into a climate change agreement with the Government, Natural Resources Wales shall be notified within one month of:
- (a) a decision by the Secretary of State not to re-certify the agreement;
  - (b) a decision by either the operator or the Secretary of State to terminate the agreement; and
  - (c) any subsequent decision by the Secretary of State to re-certify such an agreement.

## **4.4 Interpretation**

- 4.4.1 In this permit the expressions listed in schedule 6 shall have the meaning given in that schedule.
- 4.4.2 In this permit references to reports and notifications mean written reports and notifications, except where reference is made to notification being made “immediately” or “without delay” in which case it may be provided by telephone.

# Schedule 1 - Operations

**Table S1.1 activities**

Activity reference	Activity listed in Schedule 1 of the EP Regulations	Description of specified activity	Limits of specified activity
AR1	S6.8 A1(d)(ii) – Treatment and processing, other than exclusively packaging of the following raw materials, whether previously processed or unprocessed, intended for the production of food or feed (where the weight of the finished product excludes packaging) – only vegetable raw materials with a finished product production capacity greater than 300 tonnes per day	Blending, pasteurisation and packing of fruit juices.	Receipt of raw materials to dispatch finished product.  Maximum capacity limited to 3,094 tonnes per day.
<b>Directly Associated Activity</b>			
AR2	Steam generation	Production of steam in 1x 4.02 MWth input boiler fuelled by low Sulphur natural gas – existing MCP	Receipt of low Sulphur natural gas for the generation of heat and steam
AR3	Wastes storage and handling	Storage and handling of wastes	Generation of waste to dispatch
AR4	Process effluent collection and discharge	Collection and discharge of process effluent to sewer	Production of effluent to discharge
AR5	Surface water drainage	Collection and discharge of uncontaminated surface water	Collection to discharge to sewer
AR6	Process effluent collection and storage	Storage of process effluent in a 30,000 litre storage tank	Production of effluent to dispatch
<b>Medium Combustion Plant</b>			
AR7 NGR ST 20489 75704	Schedule 25A – Medium Combustion Plant as detailed in Schedule 8 of the permit	1x 4.02 MWth input boiler fuelled on natural gas – new MCP	Receipt of low Sulphur natural gas for the generation of heat and steam

**Table S1.2 Operating techniques**

Description	Parts	Date Received
Application	The response to questions B2.2.6 and B2.2.44 to B2.2.57 inclusive. Also including technical summary excluding 'B2.2 Emissions control and abatement, point source emissions to air'.	24/02/05
Variation application	Appendix 4, Appendix 5 para.1 only, Appendix 6	15/05/06

**Table S1.2 Operating techniques**

Description	Parts	Date Received
Response to regulation 61(1) Notice – request for information dated 28/04/2020 detailing how the Operator will comply with the BAT conclusions for the Food, Drink and Milk Industries, under Directive 2010/75/EU of the European Parliament and of the Council	BATC returns summary	11/11/20
Variation Application EPR/BX8289IW/V004	<ul style="list-style-type: none"> <li>All responses to questions of Form C2 and Form C3 including all supporting documentation</li> <li>Environmental permitting techniques requirements document, Section 2-6, 8-10</li> </ul>	03/02/21
Response to Schedule 5 Notice dated 22/12/21	<ul style="list-style-type: none"> <li>Response document reference ECL Ref: PRIN.01.01/S5R <ul style="list-style-type: none"> <li>Part 1-4 and Appendix 1</li> </ul> </li> <li>Revised Environmental risk assessment</li> </ul>	01/02/22

**Table S1.2A Operating techniques for Medium Combustion Plant as detailed in Schedule 8**

Description
Each MCP must be operated in accordance with the manufacturer's instructions and records must be made and retained to demonstrate this
The operator must keep periods of start-up and shut-down of each MCP as short as possible
There must be no persistent emission of 'dark smoke' as defined in section 3(1) of the Clean Air Act 1993

**Table S1.3 Improvement programme requirements**

Reference	Requirement	Date
IP1	The operator shall bund or remove the caustic transi-tank	01/08/05
IP2	The operator shall carry out a water efficiency audit of the installation. The audit shall have regard to the agency guidance note IPPC S6.10, August 2003, section 2.4.3, and shall provide a breakdown of significant water use by department or activity and shall establish the current installation performance (for example litres water / litres product) and waste efficiency objectives for the installation. A summary of the audit shall be sent to the agency.	01/08/05
IP3	The Operator shall carry out a waste minimisation audit of the installation. The assessment shall have regard to the Agency Guidance Note S6.10, August 2003, Section 2.4.2. The audit report shall provide information on any lines and operations identified as causing a process loss, specifying for each the amount lost (tonnes/year) and the percentage recovered in process or recycled. A summary of the audit shall be sent to the Agency in writing together with a timetable to implement any necessary changes identified.	01/08/05

**Table S1.3 Improvement programme requirements**

Reference	Requirement	Date
IP4	The Operator shall bund the glycol header tank such that any spillage is contained and may be fully recovered. The Operator shall inform the Agency in writing of the measures undertaken.	01/02/06
IP5	The Operator shall undertake an assessment of subsurface structures and their potential to cause fugitive emissions to surface water and groundwater. The assessment shall take account the requirements of Section 2.2.5 of the Agency Guidance Note IPPC S6.11, July 2003. A written report summarising the findings shall be submitted to the Agency. A timetable for the implementation of any improvements shall be agreed with the Agency.	01/02/06 01/01/07
IP6	The Operator shall provide a report in writing to the Agency detailing the current monitoring method used to determine effluent flow at SI, having regard to EN, ISO and BS standards. The monitoring method shall be agreed in writing with the Agency.	01/01/07
IP7	The Operator shall assess the current method for effluent flow monitoring as agreed in IP6 with the requirements given in the Mcerts standard 'Minimum requirements for the self-monitoring of effluent flow' version 2, August 2004. A written report shall be provided to the Agency detailing how this standard is to be achieved and shall include timescales for implementation.	01/01/07

# Schedule 2 - Waste types, raw materials and fuels

Table S2.1 Raw materials and fuels	
Raw materials and fuel description	Specification
-	-

DRAFT

## Schedule 3 – Emissions and monitoring

**Table S3.1 Point source emissions to air – emission limits and monitoring requirements**

Emission point ref. & location	Source	Parameter	Limit (including unit)	Reference period	Monitoring frequency	Monitoring standard or method
A1 [point A1 on site plan in Schedule 7]	No. 1 boiler – 4.02 MWth input natural gas fuelled boiler	No parameters set	No limit set	--	--	--
A2 [point A2 on site plan in Schedule 7]	No. 2 boiler – 4.02 MWth input natural gas fuelled boiler	Oxides of nitrogen (NO and NO <sub>2</sub> expressed as NO <sub>2</sub> )	100 mg/Nm <sup>3</sup> <sup>Note 1</sup>	Periodic (average over one hour)	Every 3 years <sup>Note 2</sup>	BS EN 14792
		Carbon monoxide	No limit set <sup>Note 1</sup>	Periodic (average over one hour)		BS EN 15058
A3 [Point A3 on site plan in schedule 7]	Condensation from Filler lines	No parameters set	No limit set	--	--	--
A4 Point A4 on site plan in schedule 7]	Condensation from Filler lines	No parameters set	No limit set	--	--	--
A5 [Point A5 on site plan in schedule 7]	Condensation from Filler lines	No parameters set	No limit set	--	--	--
A6 [Point A6 on site plan in schedule 7]	Condensation from Filler lines	No parameters set	No limit set	--	--	--
A7 [Point A7 on site plan in schedule 7]	Condensation from Filler lines	No parameters set	No limit set	--	--	--
A8 [Point A8 on site plan in schedule 7]	Condensation from Filler lines	No parameters set	No limit set	--	--	--
A9 [Point A9 on site plan in schedule 7]	Condensation from Filler lines	No parameters set	No limit set	--	--	--

**Table S3.1 Point source emissions to air – emission limits and monitoring requirements**

<b>Emission point ref. &amp; location</b>	<b>Source</b>	<b>Parameter</b>	<b>Limit (including unit)</b>	<b>Reference period</b>	<b>Monitoring frequency</b>	<b>Monitoring standard or method</b>
A10 [Point A10 on site plan in schedule 7]	SIG (Sterilisation)	Hydrogen Peroxide	No limit set	--	--	--
A11 [Point A11 on site plan in schedule 7]	SIG (Sterilisation)	Hydrogen Peroxide	No limit set	--	--	--
A12 [Point A12 on site plan in schedule 7]	SIG (Sterilisation)	Hydrogen Peroxide	No limit set	--	--	--
A13 [Point A13 on site plan in schedule 7]	SIG (Sterilisation)	Hydrogen Peroxide	No limit set	--	--	--
A14 [Point A14 on site plan in schedule 7]	SIG (Sterilisation)	Hydrogen Peroxide	No limit set	--	--	--
A15 [Point A15 on site plan in schedule 7]	SIG (Sterilisation)	Hydrogen Peroxide	No limit set	--	--	--
A16 [Point A16 on site plan in schedule 7]	SIG (Sterilisation)	Hydrogen Peroxide	No limit set	--	--	--

Note 1: Monitoring requirements are defined at a temperature of 273.15 K, a pressure of 101.3 kPa and after correction for the water vapour content of the waste gases at a standardised O<sub>2</sub> content of 6 % for solid fuels, 15 % for engines and gas turbines and 3 % all other MCPs

Note 2: As per condition 3.5.6, the first monitoring measurements will be carried out within four months of the issue date of the permit variation or the date when the MCP is first put into operation whichever is later

**Table S3.2 Point source emissions to sewer, effluent treatment plant or other transfers off-site– emission limits and monitoring requirements**

Emission point ref. & location	Source	Parameter	Limit (incl. Unit)	Reference period	Monitoring frequency	Monitoring standard or method
S1 [Point S1 on site plan in Schedule 7]	Process effluent	Effluent flow	No limit set	Instantaneous (continuous)	Continuous	See IP6 and IP7 Reported as daily average over 1 month
		pH	No limit set	Spot Sample	Monthly	BS60682.50, ISO 10523
		Suspended solids	No limit set	Spot Sample	Monthly	BS EN 872, BS6068-2.54
		Chemical oxygen demand	No limit set	Spot Sample	Monthly	BS6068-2.34
		Mercury and its compounds as Hg	0.01795 µg/l	Spot Sample	Annual	Compliance based on mass balance calculation
		Cadmium and its compounds as Cd	0.0051 mg/l	Spot Sample	Annual	Compliance based on mass balance calculation

**Table S3.3 Point Source emissions to water (other than sewer) and land – emission limits and monitoring requirements**

Emission point ref. & location	Source	Parameter	Limit (including unit)	Reference Period	Monitoring frequency	Compliance statistic	Monitoring standard or method
W1 [Point W1 in site plan schedule 7]	Uncontaminated surface run off	--	--	--	--	--	--

**Table S3.4 Annual limits**

Substance	Medium	Limit (including unit)
Total Mercury & its compounds	Water	7.86 g in a year
Total Cadmium & its compounds	Water	2.25 g in a year

## Schedule 4 – Reporting

Parameters, for which reports shall be made, in accordance with conditions of this permit, are listed below.

**Table S4.1 Reporting of monitoring data**

Parameter	Emission or monitoring point/reference	Reporting period	Period begins
Emissions to air Parameters as required by condition 3.5.1	A2	Within 4 months of the issue date of the permit or when the MCP is first put into operation whichever is later, then every 3 years thereafter	1 January
Emissions to sewer Parameters as required by condition 3.5.1	S1	Every 3 months	1 January, 1 April, 1 July 1 October

**Table S4.2 Annual production/treatment**

Parameter	Units
Total fruit juice production	tonnes

**Table S4.3 Performance parameters**

Parameter	Frequency of assessment	Units
Water usage	Annually	m <sup>3</sup>
Energy usage	Annually	MWh
Waste disposal and/or recovery	Annually	tonnes

**Table S4.4 Reporting forms**

Media/parameter	Reporting format	Date of form
Air	Form air 1 or other form as agreed in writing by Natural Resources Wales	DD/MM/YYYY
Sewer	Form sewer 1 or other form as agreed in writing by Natural Resources Wales	DD/MM/YY
Energy	Form energy 1 or other form as agreed in writing by Natural Resources Wales	DD/MM/YY
Water usage	Form water usage 1 or other form as agreed in writing by Natural Resources Wales	DD/MM/YY
Performance indicators	Form performance 1 or other form as agreed in writing by Natural Resources Wales	DD/MM/YY
Waste Return	Form R1 or other form as agreed in writing by Natural Resources Wales	17/03/2005

## Schedule 5 - Notification

These pages outline the information that the operator must provide.

Units of measurement used in information supplied under Part A and B requirements shall be appropriate to the circumstances of the emission. Where appropriate, a comparison should be made of actual emissions and authorised emission limits.

If any information is considered commercially confidential, it should be separated from non-confidential information, supplied on a separate sheet and accompanied by an application for commercial confidentiality under the provisions of the EP Regulations.

### Part A

Permit Number	EPR/BX8289IW
Name of operator	
Location of Facility	
Time and date of the detection	

<b>(a) Notification requirements for any activity that gives rise to an incident or accident which significantly affects or may significantly affect the environment</b>	
<b>To be notified within 24 hours of detection</b>	
Date and time of the event	
Reference or description of the location of the event	
Description of where any release into the environment took place	
Substances(s) potentially released	
Best estimate of the quantity or rate of release of substances	
Measures taken, or intended to be taken, to stop any emission	
Description of the failure or accident.	

<b>(b) Notification requirements for the breach of a permit condition</b>	
<b>To be notified within 24 hours of detection unless otherwise specified below</b>	
Emission point reference/ source	
Parameter(s)	
Limit	
Measured value and uncertainty	
Date and time of monitoring	
Measures taken, or intended to be taken, to stop the emission	

Time periods for notification following detection of a breach of a limit	
Parameter	Notification period

<b>(c) In the event of a breach of permit condition which poses an immediate danger to human health or threatens to cause an immediate significant adverse effect on the environment:</b>	
<b>To be notified within 24 hours of detection</b>	
Description of where the effect on the environment was detected	
Substances(s) detected	
Concentrations of substances detected	
Date of monitoring/sampling	

### Part B - to be submitted as soon as practicable

Any more accurate information on the matters for notification under Part A.	
Measures taken, or intended to be taken, to prevent a recurrence of the incident	
Measures taken, or intended to be taken, to rectify, limit or prevent any pollution of the environment which has been or may be caused by the emission	
The dates of any unauthorised emissions from the facility in the preceding 24 months.	

<b>Name*</b>	
<b>Post</b>	
<b>Signature</b>	
<b>Date</b>	

\* authorised to sign on behalf of the operator

## Schedule 6 - Interpretation

*“accident”* means an accident that may result in pollution.

*“Annex I”* means Annex I to Directive 2008/98/EC of the European Parliament and of the Council on waste.

*“Annex II”* means Annex II to Directive 2008/98/EC of the European Parliament and of the Council on waste.

*“application”* means the application for this permit, together with any additional information supplied by the operator as part of the application and any response to a notice served under Schedule 5 to the EP Regulations.

*“authorised officer”* means any person authorised by Natural Resources Wales under section 108(1) of The Environment Act 1995 to exercise, in accordance with the terms of any such authorisation, any power specified in section 108(4) of that Act.

*“background concentration”* means such concentration of that substance as is present in:

- for emissions to surface water, the surface water quality up-gradient of the site; or
- for emissions to sewer, the surface water quality up-gradient of the sewage treatment works discharge.

*“building”* means a construction that has the objective of providing sheltering cover and minimising emissions of noise, particulate matter, odour and litter.

*“combined heat and power” or “CHP” or “Cogeneration”* means the simultaneous generation in one process of thermal energy and electrical or mechanical energy

*“disposal” or “D”* means any of the operations provided for in Annex I to Directive 2008/98/EC of the European Parliament and of the Council on waste.

*“emissions to land”* includes emissions to groundwater.

*“EP Regulations”* means The Environmental Permitting (England and Wales) Regulations SI 2016 No.1154 and words and expressions used in this permit which are also used in the Regulations have the same meanings as in those Regulations.

*“emissions of substances not controlled by emission limits”* means emissions of substances to air, water or land from the activities, either from the emission points specified in schedule 3 or from other localised or diffuse sources, which are not controlled by an emission or background concentration limit.

*“first put into operation”* means that the plant must have been fired with its design fuel up to its full load. This can be, but does not have to be, during commissioning.

*“groundwater”* means all water, which is below the surface of the ground in the saturation zone and in direct contact with the ground or subsoil.

*“hazardous property”* has the meaning in Annex III of the Waste Framework Directive

*“hazardous waste”* has the meaning given in the Hazardous Waste (Wales) Regulations 2005 (as amended)

*“hazardous substance”* means a substance classified as hazardous as a consequence of fulfilling the criteria laid down in parts 2 to 5 of Annex I to Regulation (EC) No 1272/2008

*“impermeable surface”* means a surface or pavement constructed and maintained to a standard sufficient to prevent the transmission of liquids beyond the pavement surface

*“Industrial Emissions Directive”* means DIRECTIVE 2010/75/EU OF THE EUROPEAN PARLIAMENT AND OF THE COUNCIL of 24 November 2010 on industrial emissions

*“limited operating hours MCP”* means an MCP that meets the requirements of paragraph 8 of Part 2 of Schedule 25A of the EP Regulations

*“MCERTS”* means the Environment Agency’s Monitoring Certification Scheme.

*“Medium Combustion Plant”* or *“MCP”* means a combustion plant with a rated thermal input equal to or greater than 1 MW but less than 50 MW.

*“Medium Combustion Plant Directive”* or *“MCPD”* means Directive 2015/2193/EU of the European Parliament and of the Council of the limitation of emissions of certain pollutants into the air from medium combustion plants.

*“Natural gas”* means naturally occurring methane with no more than 20 % by volume of inert or other constituents

*“operating hours”* means the time, expressed in hours, during which a combustion plant is operating and discharging emissions into the air, excluding start-up and shut-down periods

*“Pests”* means Birds, Vermin and Insects.

*“quarter”* means a calendar year quarter commencing on 1 January, 1 April, 1 July or 1 October.

*“recovery”* or *“R”* means any of the operations provided for in Annex II to Directive 2008/98/EC of the European Parliament and of the Council on waste.

*“residue”* means the solid waste generated by the waste treatment activity and is not directly related to the type of waste treated in the plant

*“sealed drainage system”* in relation to an impermeable surface, means a drainage system with impermeable components which does not leak and which will ensure that:

- no liquids will run off the surface otherwise than via the system
- all liquids entering the system are collected in a sealed sump, except where liquids may be lawfully discharged

*“specified generator”* or *“SG”* means has the meaning given in paragraph 2(1) of Schedule 25B of the EP Regulations

*“Waste code”* means the six digit code referable to a type of waste in accordance with the list of wastes established by Commission Decision 2000/532/EC as amended from time to time (the ‘List of Wastes Decision’) and in relation to hazardous waste, includes the asterisk.

*“Waste Framework Directive”* or *“WFD”* means Waste Framework Directive 2008/98/EC of the European Parliament and of the Council on waste

*“Waste Treatment BAT Conclusions”* means the BAT Conclusions for the Waste Treatment sector published as a Commission Implementing Decision EU 2018/1447 in the Official Journal of the EU on 17 August 2018

*“year”* means calendar year ending 31 December.

Where a minimum limit is set for any emission parameter, for example pH, reference to exceeding the limit shall mean that the parameter shall not be less than that limit.

Unless otherwise stated, any references in this permit to concentrations of substances in emissions into air means:

- (a) in relation to emissions from combustion processes, the concentration in dry air at a temperature of 273 K, at a pressure of 101.3 kPa and with an oxygen content of:  
3 % for all other processes
- (b) in relation to emissions from non-combustion sources, the concentration at a temperature of 273 K and at a pressure of 101.3 kPa, with no correction for water vapour content

Schedule 7 - Site plan

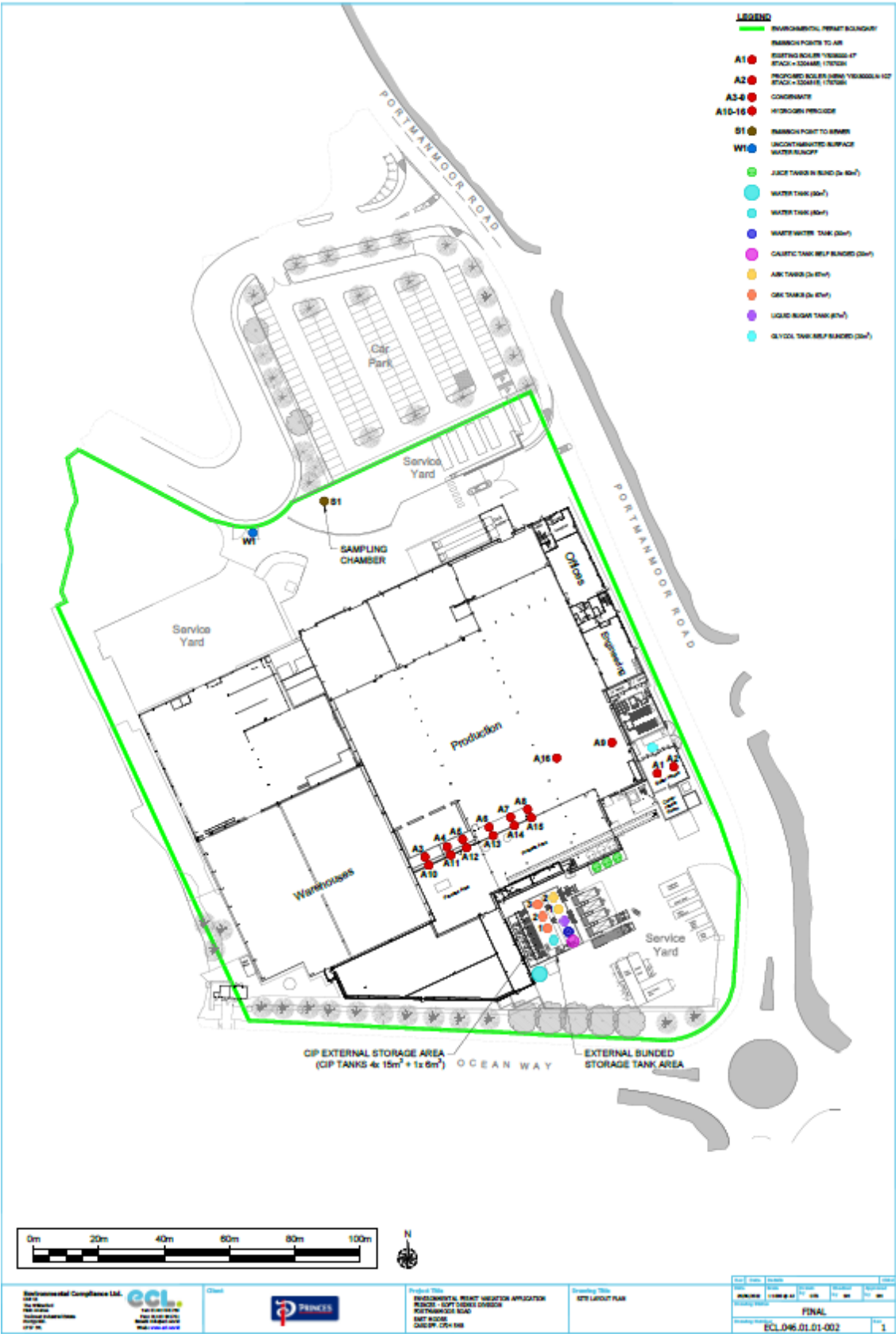

## Schedule 8 -Annex 1 of MCP

1. Rated thermal input (MW) of the medium combustion plant.	4.02 MWth
2. Type of the medium combustion plant (diesel engine, gas turbine, dual fuel engine, other engine or other medium combustion plant).	Gas Turbine
3. Type and share of fuels used according to the fuel categories laid down in Annex II.	Natural Gas (100 %)
4. Date of the start of the operation of the medium combustion plant or, where the exact date of the start of the operation is unknown, proof of the fact that the operation started before 20 December 2018.	DD/MM/YYYY
5. Sector of activity of the medium combustion plant or the facility in which it is applied (NACE code.	C10.3.2
6. Expected number of annual operating hours of the medium combustion plant and average load in use.	8064 Hours Average load in use (12.7%)
7. Where the option of exemption under Article 6(3) or Article 6(8) is used, a declaration signed by the operator that the medium combustion plant will not be operated more than the number of hours referred to in those paragraphs.	N/A
8. Name and registered office of the operator and, in the case of stationary medium combustion plants, the address where the plant is located.	Registered Office Royal Liver Building Pier Head Liverpool L3 INX  MCP address Soft Drinks Site – Cardiff Portmanmoor Road East Moors Cardiff CF24 5HB

END OF PERMIT