

**SECTION 1-1  
LONGITUDINAL SECTION**

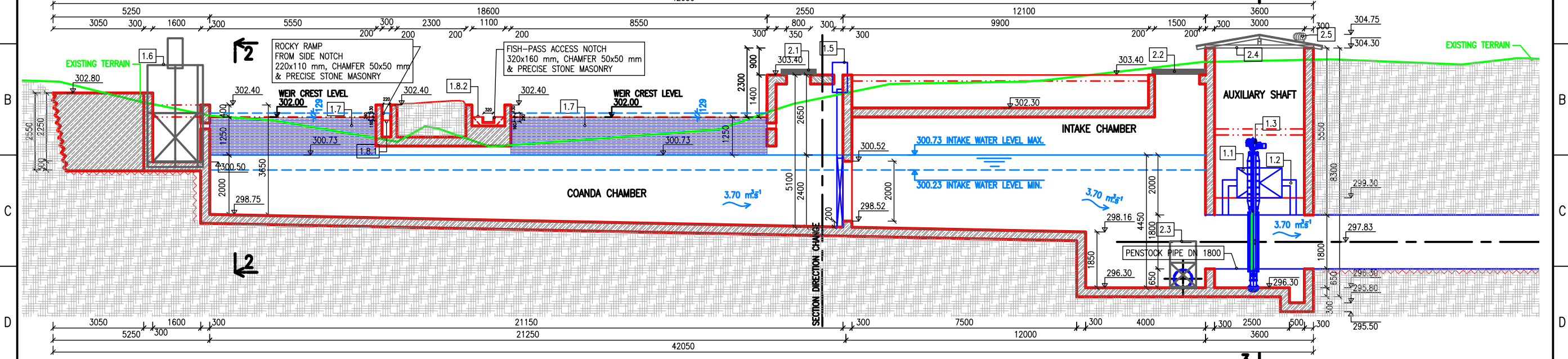

**SECTION 3-3  
AUXILIARY SHAFT**

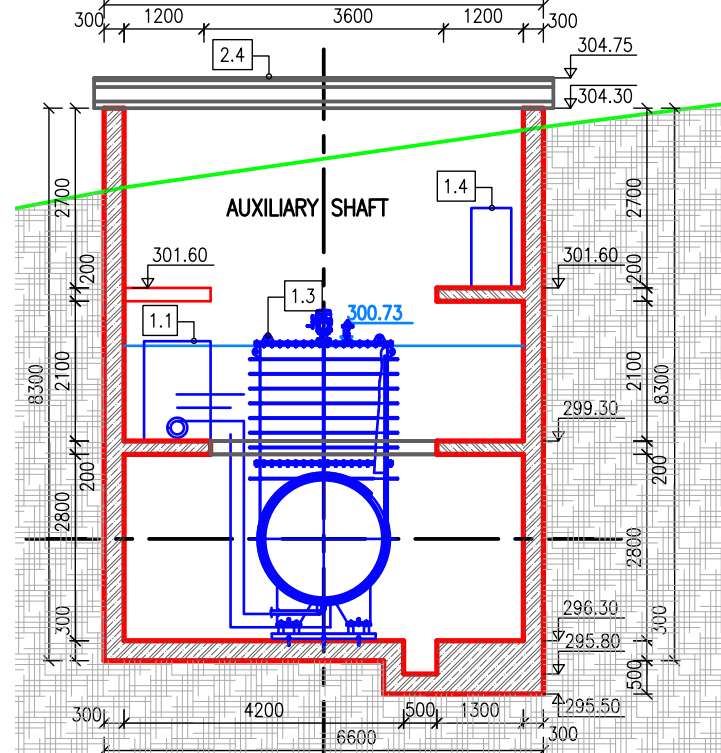

**SECTION 2-2  
WEIR SECTION**

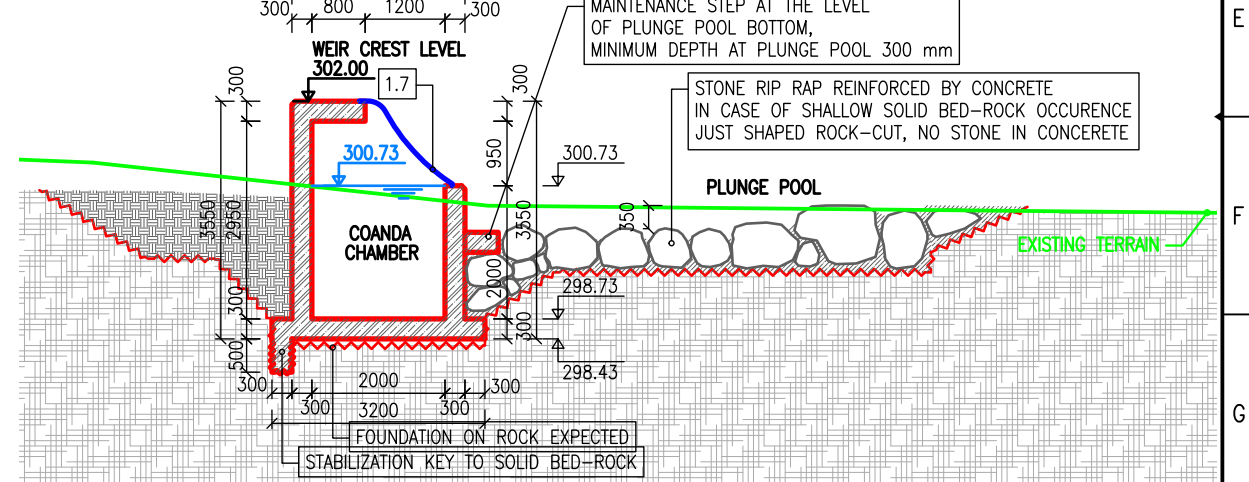

**LEGED:**

- REINFORCED CONCRETE
- STONE RIP-RAP
- EXISTING GROUND
- BACKFILL MATERIAL
- CIVIL STRUCTURE
- MECHANICAL EQUIPMENT
- CIVIL EQUIPMENT
- WATER LEVEL
- EXISTING TERRAIN

**KEY:**

**MECHANICAL EQUIPMENT**

- 1.1 PRIMING PUMP
- 1.2 PRIMING PIPE PIPING
- 1.3 MAIN INLET VALVE
- 1.4 HYDRAULIC AGGREGATE
- 1.5 INTAKE STOP LOG GATE 3000 x 2000 mm
- 1.6 FLUSHING GATE
- 1.7 COANDA SCREEN 2 mm SCREEN APERTURE
- 1.8.1. NOTCH FOR ROCKY RAMP, MINOR NOTCH
- 1.8.2. NOTCH FOR FISH PASS, MAIN NOTCH

**CIVIL EQUIPMENT**

- 2.1 MANHOLE COVER 800 x 800 mm
- 2.2 MANHOLE COVER 1500 x 1500 mm
- 2.3 FLUSHING GATE 600 x 600 mm
- 2.4 REMOVABLE AUXILIARY SHAFT COVER WITH MANHOLE ACCESS
- 2.5 ACTIVE VENTILATION

**! ALL EDGES ON THE NOTCH OF THE BYWASH AND FISHPASS (VERTICAL & HORIZONTAL) ARE CHAMFERED. !**

REVISION	MODIFICATION DESCRIPTION	
A	MAINTENANCE STEP, ROCKY RAMPS FOR FISH PASSAGE	
B	FISH PASS CONSTRUCTION	
C	FISH PASS & ROCKY RAMP CORRECTION	
D	ROCKY RAMP VARIATION TO BYWASH	
DRAWN BY	T. GOMBOŠ	PROJECT MANAGER
CHECKED BY	M. ŠTRONER	SITE
APPROVED BY	M. ŠTRONER	CLAERWEN
CLIENT	...	COUNTRY
		UK, WALES
		ALTITUDE SYSTEM
PROJECT	SHP P CLAERWEN	
PART	CONCEPTUAL DESIGN	
DRAWING NAME	INTAKE - GROUND PLAN & SECTION, PART 2	
	DATE	07/2018
	SHEETS	A3
	SCALE	1:100, 1:75
	ARCHIVE No.	2140003D-2



HYDROPOL Project & Management a.s.  
Všehrdova 560/2, 118 00 PRAHA  
CZECH REPUBLIC  
www.hydropol.cz

