

- KEY:
- 1 6800 LITRE CAPACITY UNDERGROUND TANK
 - 2 6800 LITRE CAPACITY UNDERGROUND TANK
 - 3 KEE01 HR RBCSEWGAE TREATMENT PLANT
 - 4 OUTFALL TO WATERCOURSE (SH76113 01697)

- PROPERTIES:
- 3 X 2 BED HOUSES (6)
 - 22 X 2 BED HOLIDAY CHALETs (44)

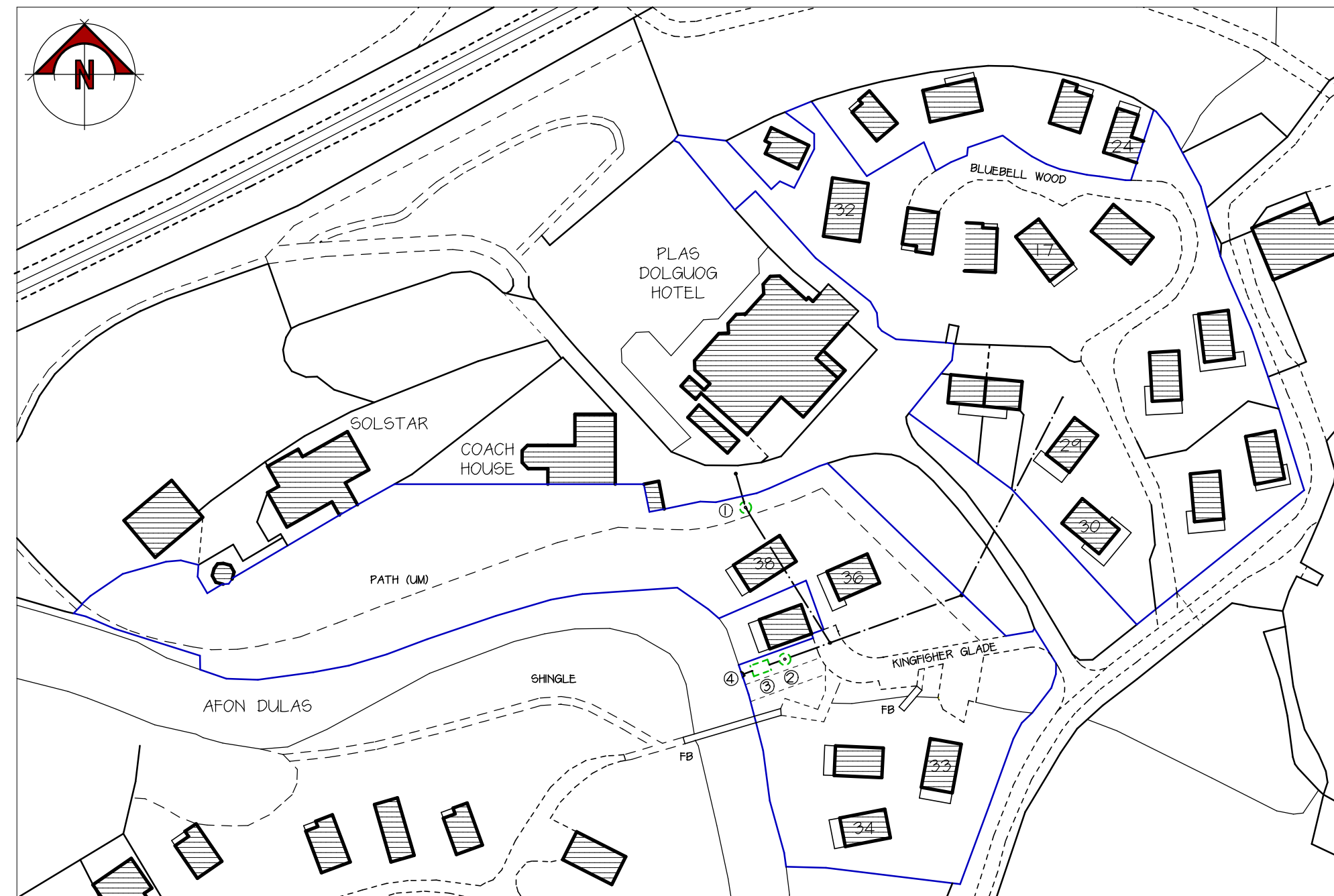

EXISTING SITE PLAN

PLAS DOLGUOG HOTEL, FELINGERRIG, MACHYNLLETH, POWYS, SY20 8UJ

1 / 1000

All dimensions on site to be checked prior to commencement of work or ordering of materials and components. Any discrepancies should be reported immediately. any surveyed information incorporated within this drawing cannot be guaranteed as accurate unless confirmed by a fixed dimension. All materials and workmanship to comply with relevant British Standards and Codes of Practice with all works to conform to Building Regulations and NHBC Standards (where applicable). COPYRIGHT This drawing and any design thereon is copyright and it must not be reproduced or disclosed to third parties without our prior permission.		
Date	Ref	Revision
24.08.22	A	SEWAGE TREATMENT PLANT
Project		
PLAS DOLGUOG HOTEL FELINGERRIG MACHYNLLETH POWYS SY20 8UJ		
Subject		Client
EXISTING SITE PLAN		PLAS DOLGUOG HOTEL
Date	Drawn	Scale/s (A3)
AUG 21	MJE	REFERENCE
Project Number	Drawing Number	Amendment
21/086/P	20	A