



NOTES

1. DRAWING IS BASED ON PERCY THOMAS DRAWINGS REF: PECO-CAP-PW-XX-DR-A-051100 REV C01 (27.01.22), PECO-CAP-PW-XX-DR-A-050002 REV T03 (28.01.22) AND PECO-CAP-PW-00-DR-A-910101 REV C03 (10.03.23)

- LEGEND
-  ENVIRONMENTAL PERMIT BOUNDARY
  -  WASTE RECYCLING CENTRE (WRC)
  -  WASTE TRANSFER STATION (WTS)



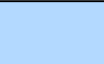

3RD FLOOR  
THE BREW HOUSE  
JACOB STREET  
BRISTOL, BS2 0EQ  
T: 01179 064280  
www.slrconsulting.com

PEMBROKESHIRE COUNTY COUNCIL  
ECO PARK

ENVIRONMENTAL PERMIT  
APPLICATION

**SITE LAYOUT AND ENVIRONMENTAL  
PERMIT BOUNDARY - OVERVIEW**

**DRAWING 003**

Scale 1:1250 @ A2

Date APRIL 2023

4:16.V00798.00039.13.003-004-005.1\_SITE\_LAYOUT&ENV\_PERM\_BDY.dwg



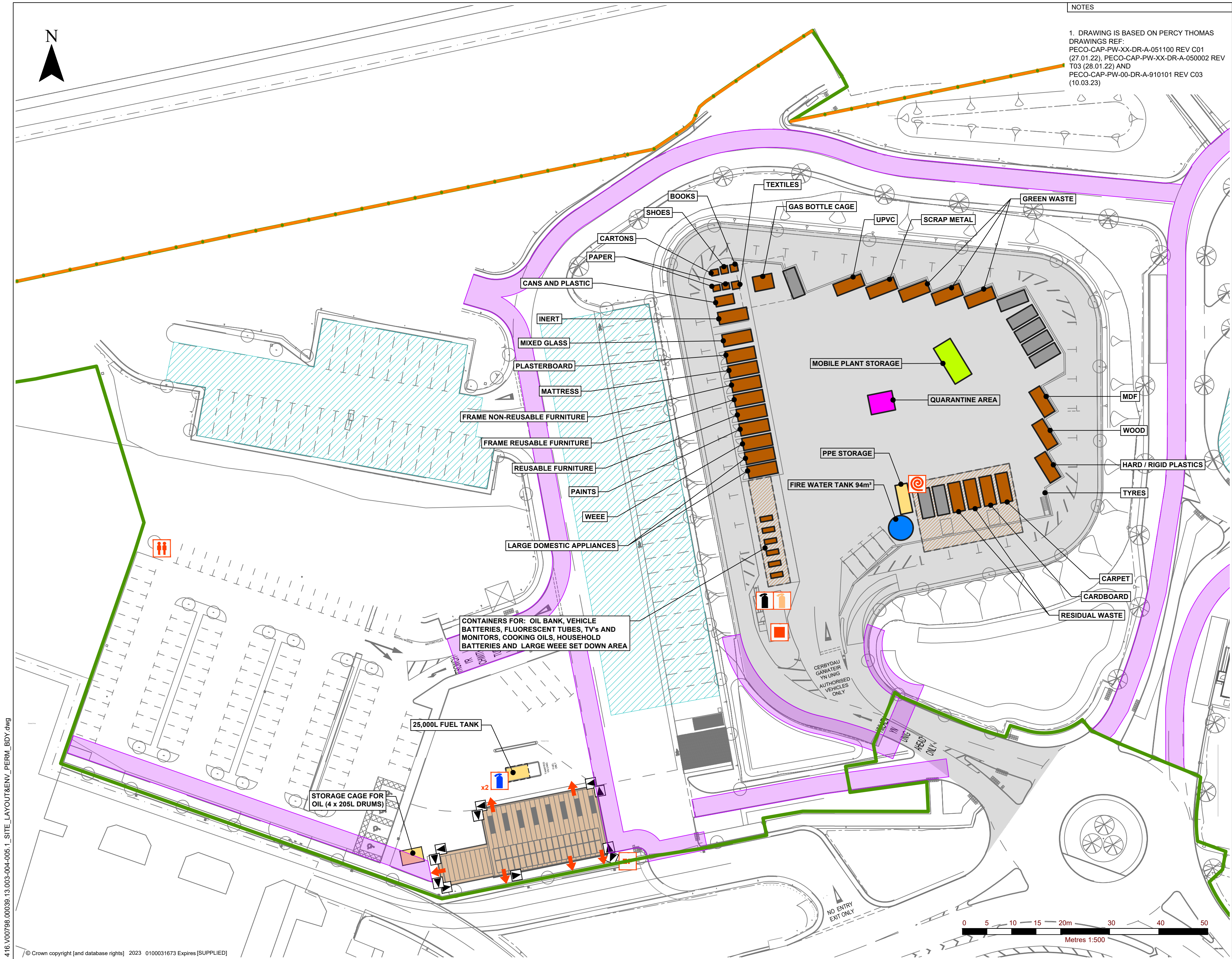

NOTES

1. DRAWING IS BASED ON PERCY THOMAS DRAWINGS REF: PECO-CAP-PW-XX-DR-A-051100 REV C01 (27.01.22), PECO-CAP-PW-XX-DR-A-050002 REV T03 (28.01.22) AND PECO-CAP-PW-00-DR-A-910101 REV C03 (10.03.23)

| LEGEND                             |   |
|------------------------------------|---|
|                                    | ENVIRONMENTAL PERMIT BOUNDARY           |
|                                    | IMPERMEABLE SURFACE                     |
|                                    | PERMEABLE SURFACE                       |
|                                    | BUILDING (IMPERMEABLE SURFACE)          |
|                                    | EXTERNAL COVERED BAYS                   |
|                                    | WASTE STORAGE BAY                       |
|                                    | SPARE STORAGE BAY                       |
|                                    | FIRE WATER STORAGE TANK                 |
|                                    | QUARANTINE AREA                         |
|                                    | MOBILE PLANT STORAGE                    |
| NOTE: ALL STORAGE BAYS ARE 4m HIGH |   |
|                                    | FIRE HOSE                               |
|                                    | MANUAL CALL POINT                       |
|                                    | FIRE BLANKET                            |
|                                    | EMERGENCY PACK                          |
|                                    | PPE STORAGE                             |
|                                    | FIRE ASSEMBLY POINT                     |
|                                    | FIRE EXIT                               |
|                                    | CO² FIRE EXTINGUISHER                   |
|                                    | FOAM FIRE EXTINGUISHER                  |
|                                    | POWDER FIRE EXTINGUISHER                |
|                                    | WATER FIRE EXTINGUISHER                 |
|                                    | CCTV CAMERA                             |
|                                    | 3m HIGH ACOUSTIC BARRIER                |
|                                    | CLEAR AREA AROUND PERIMETER OF THE SITE |

3RD FLOOR  
THE BREW HOUSE  
JACOB STREET  
BRISTOL, BS2 0EQ  
T: 01179 064280  
www.slrconsulting.com

PEMBROKESHIRE COUNTY COUNCIL  
ECO PARK

ENVIRONMENTAL PERMIT  
APPLICATION

SITE LAYOUT AND ENVIRONMENTAL  
PERMIT BOUNDARY -  
WASTE RECYCLING CENTRE

**DRAWING 004**

Scale 1:500 @ A2

Date APRIL 2023

416.V00798.00039.13.003-004-005.1\_SITE\_LAYOUT&ENV\_PERM\_BDY.dwg



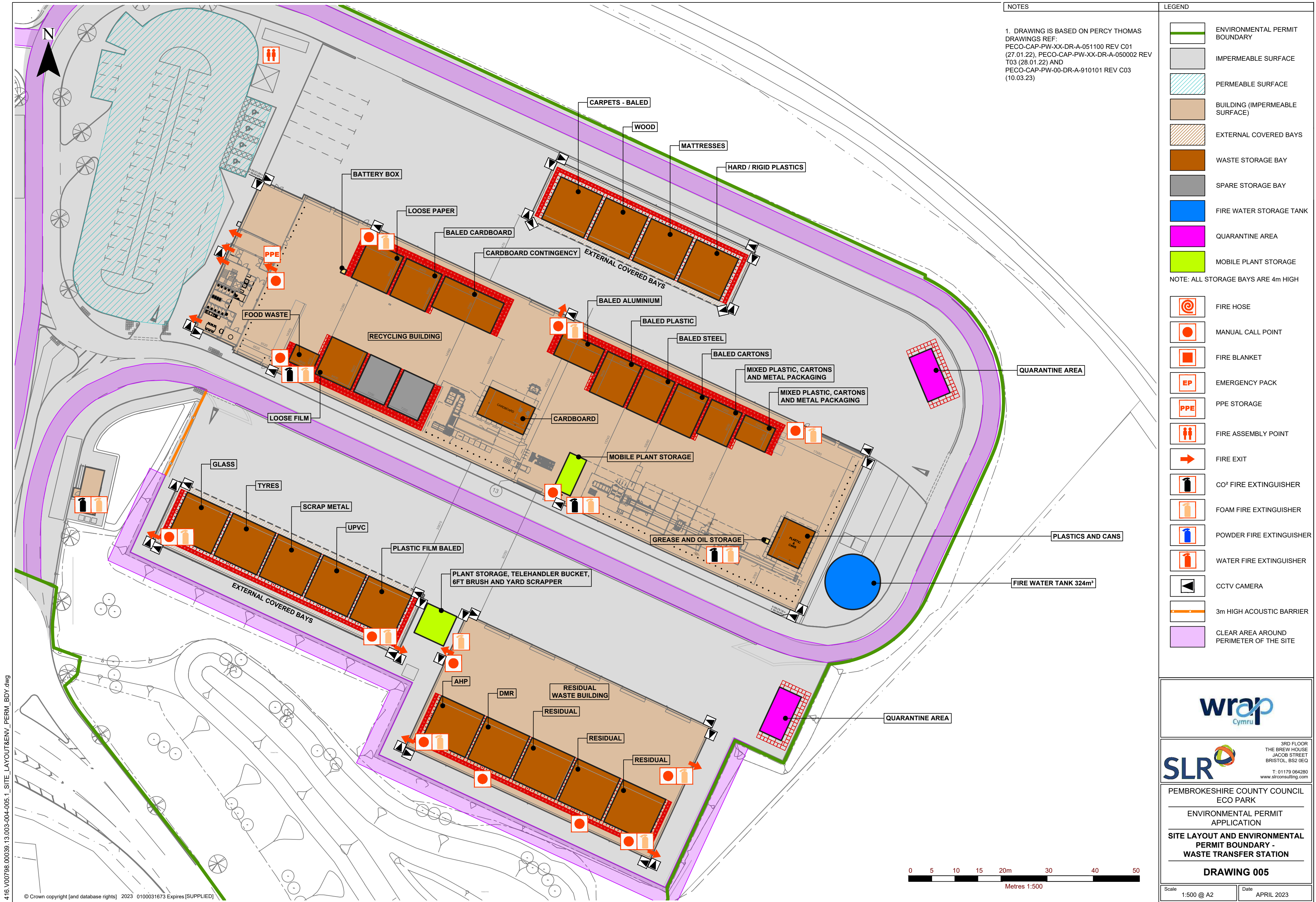

NOTES

1. DRAWING IS BASED ON PERCY THOMAS DRAWINGS REF: PECO-CAP-PW-XX-DR-A-051100 REV C01 (27.01.22), PECO-CAP-PW-XX-DR-A-050002 REV T03 (28.01.22) AND PECO-CAP-PW-00-DR-A-910101 REV C03 (10.03.23)

- LEGEND
- ENVIRONMENTAL PERMIT BOUNDARY
  - IMPERMEABLE SURFACE
  - PERMEABLE SURFACE
  - BUILDING (IMPERMEABLE SURFACE)
  - EXTERNAL COVERED BAYS
  - WASTE STORAGE BAY
  - SPARE STORAGE BAY
  - FIRE WATER STORAGE TANK
  - QUARANTINE AREA
  - MOBILE PLANT STORAGE
- NOTE: ALL STORAGE BAYS ARE 4m HIGH

- FIRE HOSE
- MANUAL CALL POINT
- FIRE BLANKET
- EMERGENCY PACK
- PPE STORAGE
- FIRE ASSEMBLY POINT
- FIRE EXIT
- CO² FIRE EXTINGUISHER
- FOAM FIRE EXTINGUISHER
- POWDER FIRE EXTINGUISHER
- WATER FIRE EXTINGUISHER
- CCTV CAMERA
- 3m HIGH ACOUSTIC BARRIER
- CLEAR AREA AROUND PERIMETER OF THE SITE

**wrap**  
Cymru

**SLR**  
3RD FLOOR  
THE BREW HOUSE  
JACOB STREET  
BRISTOL, BS2 0EQ  
T: 01179 064280  
www.slrconsulting.com

PEMBROKESHIRE COUNTY COUNCIL  
ECO PARK

ENVIRONMENTAL PERMIT  
APPLICATION

SITE LAYOUT AND ENVIRONMENTAL  
PERMIT BOUNDARY -  
WASTE TRANSFER STATION

**DRAWING 005**

Scale: 1:500 @ A2 Date: APRIL 2023

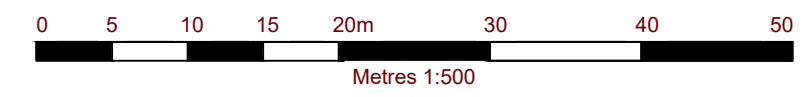

4:16.V00798.00039.13.003-004-005.1\_SITE\_LAYOUT&ENV\_PERM\_BDY.dwg