

## Historical Aerial Photography

Published 1947

Source map scale - 1:10,560

The Historical Aerial Photos were produced by the Ordnance Survey at a scale of 1:1,250 and 1:10,560 from Air Force photography. They were produced between 1944 and 1951 as an interim measure, pending preparation of conventional mapping, due to post war resource shortages. New security measures in the 1950's meant that every photograph was re-checked for potentially unsafe information with security sites replaced by fake fields or clouds. The original editions were withdrawn and only later made available after a period of fifty years although due to the accuracy of the editing, without viewing both revisions it is not easy to spot the edits. Where available Landmark have included both revisions.

© Landmark Information Group and/or Data Suppliers 2010.

### Map Name(s) and Date(s)

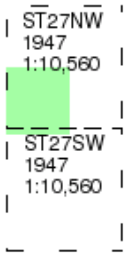

### Historical Aerial Photography - Slice A

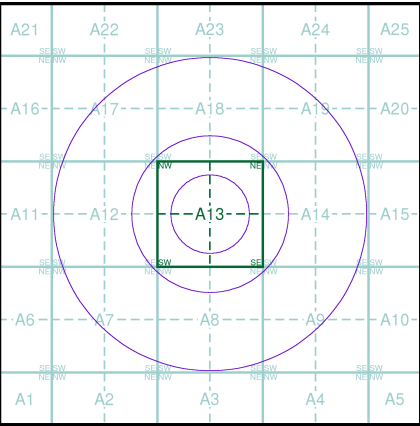

LIBRARY  
HSILIRB

### Order Details

Order Number: 50481054\_1\_1  
Customer Ref: 10652  
National Grid Reference: 321350, 176110  
Slice: A  
Site Area (Ha): 0.01  
Search Buffer (m): 1000

### Site Details

Site at 321350, 176100



Tel: 0844 844 9952  
Fax: 0844 844 9951  
Web: www.envirocheck.co.uk





© Crown copyright and Landmark Information Group Limited 2013. All Rights Reserved.

0 400 m

## Ordnance Survey Plan

### Published 1964 - 1965

### Source map scale - 1:10,000

The historical maps shown were reproduced from maps predominantly held at the scale adopted for England, Wales and Scotland in the 1840's. In 1854 the 1:2,500 scale was adopted for mapping urban areas; these maps were used to update the 1:10,560 maps. The published date given therefore is often some years later than the surveyed date. Before 1938, all OS maps were based on the Cassini Projection, with independent surveys of a single county or group of counties, giving rise to significant inaccuracies in outlying areas. In the late 1940's, a Provisional Edition was produced, which updated the 1:10,560 mapping from a number of sources. The maps appear unfinished - with all military camps and other strategic sites removed. These maps were initially overprinted with the National Grid. In 1970, the first 1:10,000 maps were produced using the Transverse Mercator Projection. The revision process continued until recently, with new editions appearing every 10 years or so for urban areas.

### Map Name(s) and Date(s)

ST27NW	1965
1:10,560	
ST27SW	1964
1:10,560	

### Historical Map - Slice A

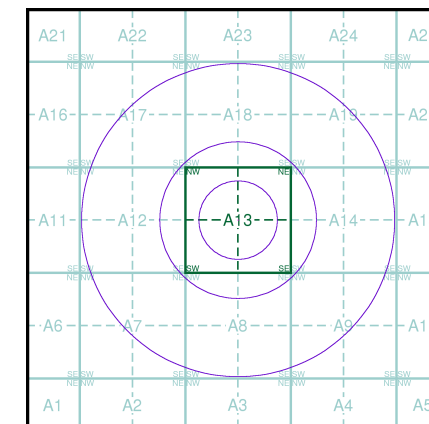

### Order Details

Order Number: 50481054\_1\_1  
Customer Ref: 10652  
National Grid Reference: 321350, 176110  
Slice: A  
Site Area (Ha): 0.01  
Search Buffer (m): 1000

### Site Details

Site at 321350, 176100



Tel: 0844 844 9952  
Fax: 0844 844 9951  
Web: www.envirocheck.co.uk





## Ordnance Survey Plan

Published 1970 - 1975

Source map scale - 1:10,000

The historical maps shown were reproduced from maps predominantly held at the scale adopted for England, Wales and Scotland in the 1840's. In 1854 the 1:2,500 scale was adopted for mapping urban areas; these maps were used to update the 1:10,560 maps. The published date given therefore is often some years later than the surveyed date. Before 1938, all OS maps were based on the Cassini Projection, with independent surveys of a single county or group of counties, giving rise to significant inaccuracies in outlying areas. In the late 1940's, a Provisional Edition was produced, which updated the 1:10,560 mapping from a number of sources. The maps appear unfinished - with all military camps and other strategic sites removed. These maps were initially overprinted with the National Grid. In 1970, the first 1:10,000 maps were produced using the Transverse Mercator Projection. The revision process continued until recently, with new editions appearing every 10 years or so for urban areas.

### Map Name(s) and Date(s)

ST27NW	1975
1:10,000	
ST27SW	1970
1:10,000	

### Historical Map - Slice A

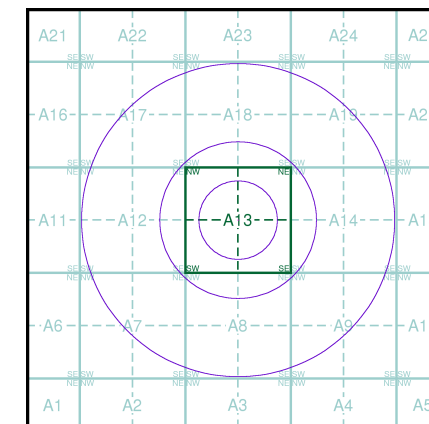

### Order Details

Order Number: 50481054\_1\_1  
Customer Ref: 10652  
National Grid Reference: 321350, 176110  
Slice: A  
Site Area (Ha): 0.01  
Search Buffer (m): 1000

### Site Details

Site at 321350, 176100



Tel: 0844 844 9952  
Fax: 0844 844 9951  
Web: www.envirocheck.co.uk



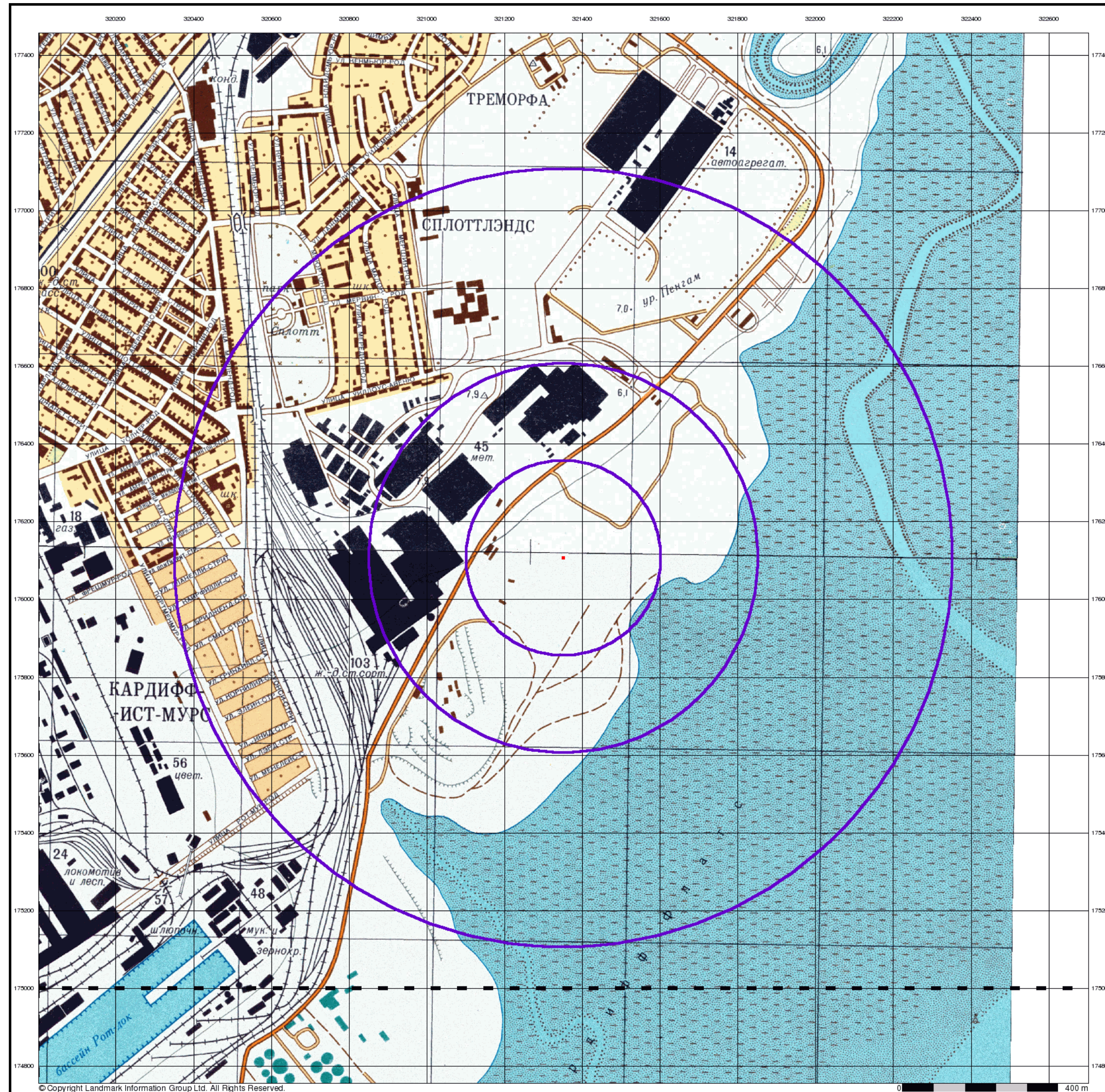

## Cardiff

Published 1982

Source map scale - 1:10,000

These maps were produced by the Russian military during the Cold War between 1950 and 1997, and cover 103 towns and cities throughout the U.K. The maps are produced at 1:25,000, 1:10,000 and 1:5,000 scale, and show detailed land use, with colour-coded areas for development, green areas, and non-developed areas. Buildings are coloured black and important building uses (such as hospitals, post offices, factories etc.) are numbered, with a numbered key describing their use.

They were produced by the Russians for the benefit of navigation, as well as strategic military sites and transport hubs, for use if they were to have invaded the U.K. The detailed information provided indicates that the areas were surveyed using land-based personnel, on the ground, in the cities that are mapped.

## Map Name(s) and Date(s)

ST27NW  
1982  
1:10,000  
ST27SW  
1982  
1:10,000

## Russian Map - Slice A

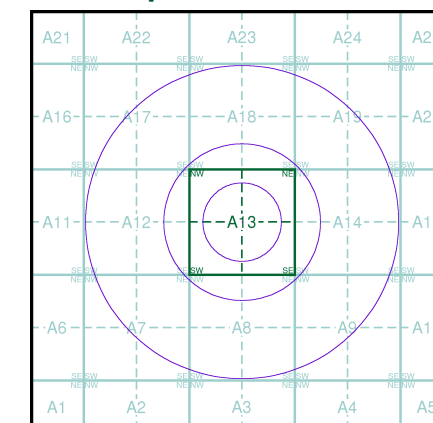

## Order Details

Order Number: 50481054\_1\_1  
Customer Ref: 10652  
National Grid Reference: 321350, 176110  
Slice: A  
Site Area (Ha): 0.01  
Search Buffer (m): 1000

## Site Details

Site at 321350, 176100



Tel: 0844 844 9952  
Fax: 0844 844 9951  
Web: www.envirocheck.co.uk



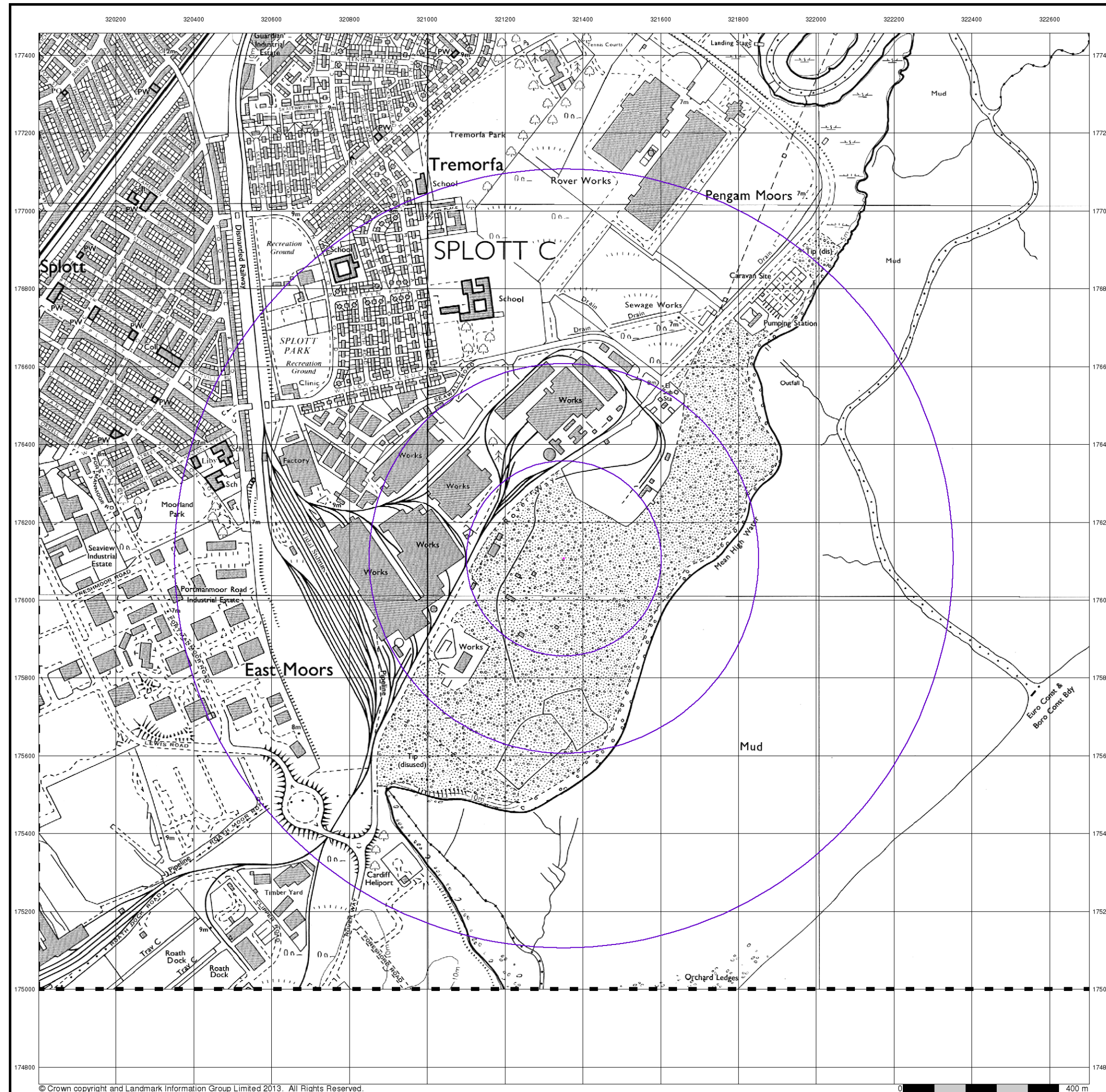

## Ordnance Survey Plan

Published 1989

Source map scale - 1:10,000

The historical maps shown were reproduced from maps predominantly held at the scale adopted for England, Wales and Scotland in the 1840's. In 1854 the 1:2,500 scale was adopted for mapping urban areas; these maps were used to update the 1:10,560 maps. The published date given therefore is often some years later than the surveyed date. Before 1938, all OS maps were based on the Cassini Projection, with independent surveys of a single county or group of counties, giving rise to significant inaccuracies in outlying areas. In the late 1940's, a Provisional Edition was produced, which updated the 1:10,560 mapping from a number of sources. The maps appear unfinished - with all military camps and other strategic sites removed. These maps were initially overprinted with the National Grid. In 1970, the first 1:10,000 maps were produced using the Transverse Mercator Projection. The revision process continued until recently, with new editions appearing every 10 years or so for urban areas.

## Map Name(s) and Date(s)

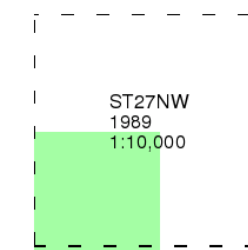

## Historical Map - Slice A

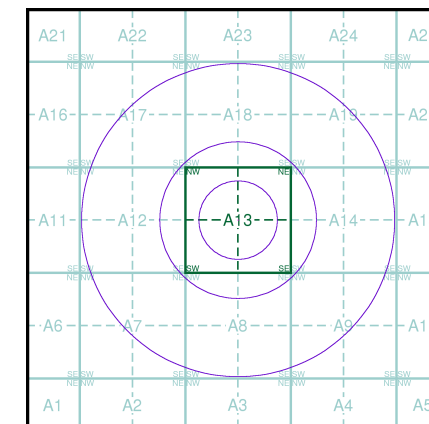

## Order Details

Order Number: 50481054\_1\_1  
Customer Ref: 10652  
National Grid Reference: 321350, 176110  
Slice: A  
Site Area (Ha): 0.01  
Search Buffer (m): 1000

## Site Details

Site at 321350, 176100



Tel: 0844 844 9952  
Fax: 0844 844 9951  
Web: www.envirocheck.co.uk



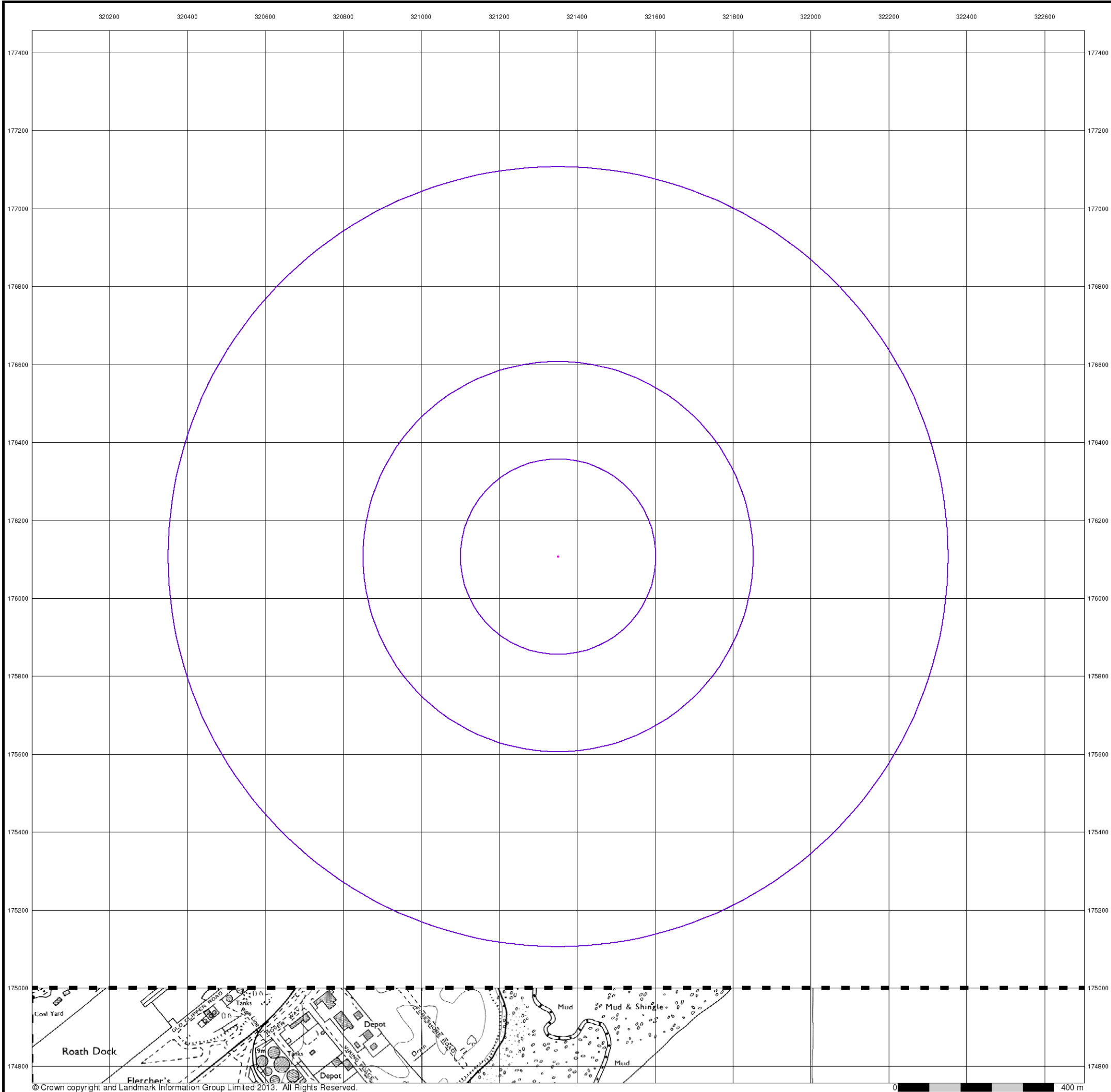

**Ordnance Survey Plan**  
**Published 1993**  
**Source map scale - 1:10,000**

The historical maps shown were reproduced from maps predominantly held at the scale adopted for England, Wales and Scotland in the 1840's. In 1854 the 1:2,500 scale was adopted for mapping urban areas; these maps were used to update the 1:10,560 maps. The published date given therefore is often some years later than the surveyed date. Before 1938, all OS maps were based on the Cassini Projection, with independent surveys of a single county or group of counties, giving rise to significant inaccuracies in outlying areas. In the late 1940's, a Provisional Edition was produced, which updated the 1:10,560 mapping from a number of sources. The maps appear unfinished - with all military camps and other strategic sites removed. These maps were initially overprinted with the National Grid. In 1970, the first 1:10,000 maps were produced using the Transverse Mercator Projection. The revision process continued until recently, with new editions appearing every 10 years or so for urban areas.

**Map Name(s) and Date(s)**

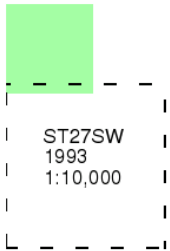

**Historical Map - Slice A**

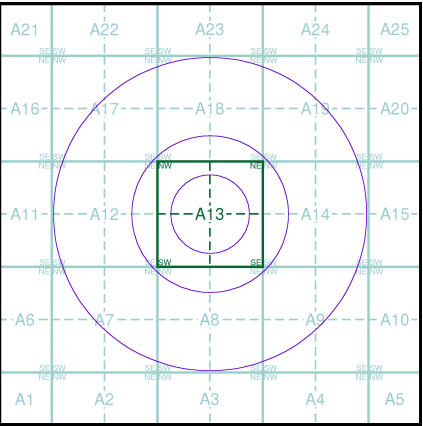

**Order Details**  
Order Number: 50481054\_1\_1  
Customer Ref: 10652  
National Grid Reference: 321350, 176110  
Slice: A  
Site Area (Ha): 0.01  
Search Buffer (m): 1000

**Site Details**  
Site at 321350, 176100