

NEED TO CHECK.

~~COMPLETE~~

Check against

GW SW - or.

Database.

+ file.

AUTHORISATION NO.

GWSW1616



ASiantaeth Yr
AMGYLCHEDD CYMRU
ENVIRONMENT
AGENCY WALES

GROUNDWATER REGULATIONS 1998

REGULATION 18(3)(a)

AUTHORISATION OF DISPOSAL OR TIPPING FOR THE PURPOSE OF DISPOSAL

TO: E.E.J. Humphreys
Crachty-Uchaf
Llanfynydd,
SA32 7DD.

The ENVIRONMENT AGENCY ("The Agency") in pursuance of its powers under the Groundwater Regulations 1998 and in accordance with Regulation 18(3)(a) of those Regulations, hereby **AUTHORISES** the making of a disposal of **sheep dip** as follows:

Spreading onto land

FROM: A sheep dip

AT: Maesifan, Llanfynydd.

TO : land

SUBJECT TO: the conditions set out in the following Schedule :

Spreading onto land

Schedule no GWSW1616

The Agency will review this Authorisation at least every 4 years and may vary or revoke the Authorisation in writing at any time.

Dated this 4th day of November 1999.

Signed.....H. J. Williams.....

Team Leader Water Quality Consents

Asiantaeth yr Amgylchedd
Glan Tawe, 154 Fford Sant Helen, Abertawe, SA1 4DF. Ffon 01792 645300, Ffacs 01792 648652.

Environment Agency
Glan Tawe, 154 St Helens Road, Swansea, SA1 4DF. Tel: 01792 645300, Fax: 01792 648652.



AUTHORISATION NO.	GWSW1616
SCHEDULE NO.	GWSW1616
DATE ISSUED	4th November '99



**ASiantaeth Yr
Amgylchedd Cymru
Environment
Agency Wales**

CONDITIONS OF AUTHORISATION OF DISPOSAL

Spreading onto land ("the disposal")

FROM : Maesifan, Llanfynydd.

GENERAL

1. The disposal shall consist only of spent sheep dip, derived from use at Maesifan, Llanfynydd of sheep dip used in accordance with appropriate licensed use conditions issued by the Veterinary Medicines Directorate, Ministry of Agriculture Fisheries and Food (MAFF).
2. The disposal shall be undertaken at the location specified in condition 3 below so that:
 - (a) There shall be no direct discharge of List 1 substances as set out in Annex 1 to this notice to groundwater or surface waters;
 - (b) Groundwater's (as defined by the Groundwater Regulations 1998) are not polluted;
 - (c) The disposal shall not cause any adverse effects on sources of water for public or private potable supply;
 - (d) Disposal of List 1 and List 2 substances (set out in Annex 1 to this notice) shall only be made in accordance with the conditions of this Authorisation.
 - (e) Provided that the disposal hereby authorised is made in accordance with all of the conditions of this Authorisation, such disposal shall not be taken to be in breach of condition (a), (b) or (c) above because it contains substances or has properties identified in and controlled by conditions (a), (b) or (c);
 - (f) The Authorisation holder shall take all practicable measures to minimise adverse environmental impact of the disposal.
3. The disposal shall be made by application onto an area of land centered at:

National Grid Reference SN 5750 3000

As shown marked "Disposal area" on the attached Authorisation plan GWSW1616.



AUTHORISATION NO.	GWSW1616
SCHEDULE NO.	GWSW1616



**ASiantaeth Yr
Amgylchedd Cymru
Environment
Agency Wales**

4. The disposal shall be made by application onto an area of land with an established vegetation cover of minimal wildlife value. The area of land shall not include hedgerows, woodlands or wildflower meadows, or land that is bare as part of a crop rotation. The disposal of spent sheep dip shall not be made to land on which crops are currently being grown for human consumption.
5. No part of the disposal area shall lie within:
 - (a) 10 metres of the nearest watercourse (which includes ditches that may be dry for part of the year), or 30 metres of a river designated as a Site of Special Scientific Interest (SSSI) or Special Area of Conservation (SAC),
 - (b) 50 metres of any well, spring, or borehole, irrespective of its current use,
 - (c) 500 metres of any well, spring, or borehole used for potable water supply.
6. No disposal shall be to field boundaries or to a strip at least 2 metres wide adjacent to any boundary.
7. No disposal of spent sheep dip shall take place on land which:
 - (a) is under drained or that has been mole drained within 12 months prior to any disposal operation or is cracked down to the drain or any backfill;
 - (b) has a slope greater than 11 degrees;
 - (c) is frozen hard or snow covered;
 - (d) is liable to flooding;
 - (e) is severely compacted or waterlogged.
8. Disposal equipment and / or methods shall be designed and operated such that the requirements of Conditions 9 and 10 are met.



AUTHORISATION NO.	GWSW1616
SCHEDULE NO.	GWSW1616



**ASiantaeth Yr
Amgylchedd Cymru
Environment
Agency Wales**

VOLUME

9. The maximum volume of spent sheep dip (of working strength), before any dilution to assist safe spreading, shall not exceed 2 cubic metres per day and 4 cubic metres per annum disposed of to the land identified in Condition 3 above.
10. The maximum daily application rate of spent sheep dip to the same area of land (before dilution to assist safe spreading) shall not exceed 5 cubic meters per hectare or 20 cubic metres per hectare after dilution for safe spreading.

DISPOSAL PERIOD.

11. The minimum interval between each disposal to the same area of land shall be at least 28 days.

MONITORING / REPORTING

12. Records shall be kept on a form provided by the Agency and made available for inspection on request by the Agency, for at least four years. They shall include:
 - (a) daily volume of undiluted spent sheep dip disposed of;
 - (b) rates of disposal;
 - (c) location and area of disposal;
 - (d) nature of used dip (licensed brand name will suffice);
 - (e) any materials added to dilute or treat the spent sheep dip including water or slurry

EXPIRY DATE

13. The Authorisation shall cease to have effect on 30th November 2011



Disposal Area marked with red pen

at Maesifan, Llanyfynydd

SN 5630-5730.

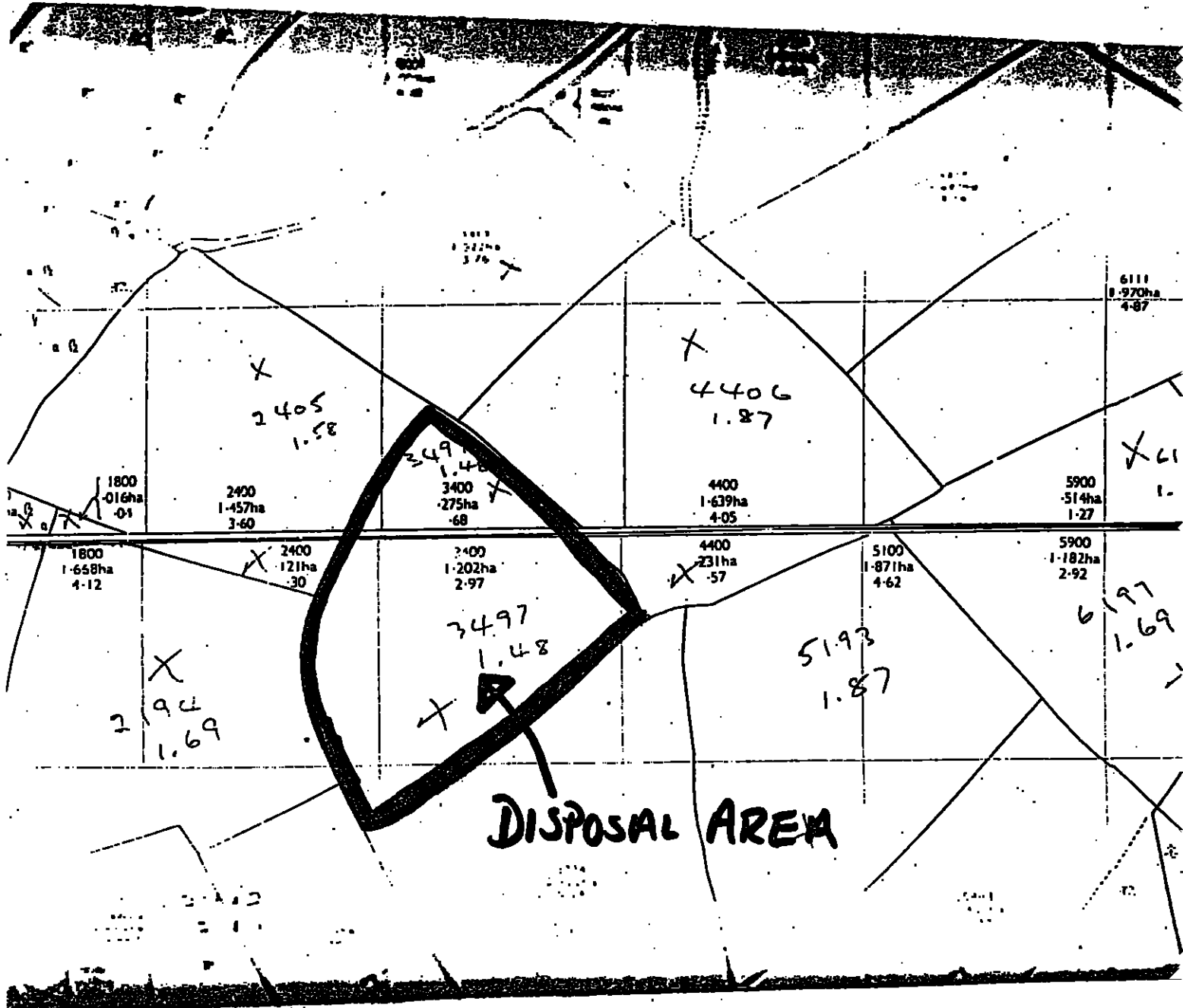

SN 5629-5729.

AUTHORISATION PLAN RWSW 1616



ANNEX 1.

Summary listing of the substances to be controlled under the Groundwater Regulations 1998.

List One. "List One" substances are the most toxic and must be prevented from entering groundwater. They include pesticides, sheep dip and solvents.

- Organohalogen compounds and substances which may form such compounds in the aquatic environment
- Organophosphorus (OP) compounds
- Organotin compounds
- Substances which possess carcinogenic, mutagenic, or teratogenic properties in or via the aquatic environment (including substances which may have those properties which would otherwise be in list two)
- Mercury and its compounds
- Cadmium and its compounds
- Mineral oils and hydrocarbons
- Cyanides

List Two "List Two" substances are less dangerous but, if disposed of in large amounts, could be harmful to groundwater. Entry of these substances into groundwater must be restricted.

- The following metals and metalloids and their compounds

Zinc	Antimony	Uranium
Copper	Molybdenum	Vanadium
Nickel	Titanium	Cobalt
Chromium	Tin	Thallium
Lead	Barium	Tellurium
Selenium	Beryllium	Silver
Arsenic	Boron	

- Biocides (including pesticides) and their derivatives not appearing in list one
- Substances which have a deleterious effect on the taste or odour of groundwater, and compounds liable to cause the formation of such substances in such water and to render it unfit for human consumption.
- Toxic or persistent organic compounds of silicon, and substances which may cause the formation of such compounds in water, excluding those which are biologically harmless or are rapidly converted in water into harmless substances.
- Inorganic compounds of phosphorus and elemental phosphorus
- Fluorides
- Ammonia and nitrites



**ENVIRONMENT
AGENCY**

Water quality

Application for groundwater authorisation

Groundwater Regulations 1998 (Regulation 23 - Transitional Provisions)

Please read the guidance notes and the form carefully before you complete it.

You must apply before 1 April 1999 if you wish to continue a disposal activity you have carried out before.

If you apply after 31 March 1999 you will have to wait for an authorisation to be granted before you can resume disposal.

If you make a disposal without an authorisation we may prosecute you.

Return your completed form to the nearest office from the list on the back cover of this form.

Disclosure

The law says that we must place your application on the public register unless you provide good reasons why it should stay confidential. If you want your application to stay confidential, write to us when you send us the form, giving your reasons in full.

Data protection

The information that you provide will be processed by the Environment Agency to fulfil its regulatory and monitoring functions. It will be placed on the relevant public registers. Completion of this form is compulsory if you wish us to process your application. You have a right of access to the information supplied to the Environment Agency and the right to apply to court for rectification of that information in accordance with data protection legislation.

For Environment Agency Use only

District/Area reference:

Application number:

Date received:

Fee received:

1 Where the disposal site is located

1.1 Name, address and location of disposal site

If the area of land forms part of a farm, give the address of the farm. Describe where the site is if the address is not clear.

E. E. J. HUMPHREYS.

Address

MAESIFAN.

LLANFYNYDD.

CARMARTHENSHIRE

Postcode

2 Authorised contact

2.1 Please give us details of the person we can phone or write to with questions about this application.

This can be someone acting as an 'agent' for the applicant.

Full name

E. E. J. HUMPHREYS.

Position

Owner.

Business address

CRACHTY-UCHAF,

LLANFYNYDD

CARMARTHENSHIRE

Postcode SA32 7DD

Phone

01558 668810

Fax

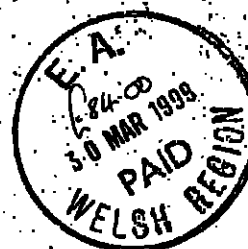

3 The applicant

3.1 Is the applicant an individual, a group of individuals (or partnership) or a company/corporate body?

Please discuss this with us if you are not sure.

- ☒ Individual (sole trader) go to question 3.2
☐ Group of individuals or partnership go to question 3.3
☐ Company or corporate body go to question 3.5

Individuals

3.2 Please give us the following details.

Full name

E. E. J. HUMPHREYS.

Trading or business name (if there is one)

As above.

Business address

CRACH TY-UCHAF,

LLANFYNYDD,

CARMARTHENSHIRE

Postcode SA32 7DD

Contact numbers (optional)

Phone

01558 668810

Fax

Now go to question 3.6

Groups of individuals or partnerships

3.3 Who is applying for the authorisation?

We can only issue an authorisation to named individuals. We need details of each person applying to be an authorisation holder.

Continue on separate sheets if you need to.

Individual or partner

Full name

Business address

Postcode

Individual or partner

Full name

Business address

Postcode

Individual or partner

Full name

Business address

Postcode

3 The applicant continued

3.4 Please give us details about the group of individuals or partnership.

For applications from partnerships please provide written evidence, such as a deed of partnership.

Trading or business name of partnership (if there is one)

Business address

Postcode

Contact numbers (optional)

Phone

Fax

Now go to question 3.6

Companies or other corporate applicants

3.5 Please give us the following details.

For applications from companies please provide written evidence of registration.

- ☐ Registered company
☐ Other please give details

Full name of company or corporate body

Trading/business name (if different)

Registered office address

Postcode

Main office address (if different)

Postcode

Contact name and numbers (optional)

Name

Phone

Fax

Company registration number

Now go to question 3.6

3. The applicant continued

3.6 Billing address

If different from application address

Full name
Position
Trading name
Business address
Postcode

4 Existing licences

4.1 Have you previously made a similar disposal at this site?

Tick 'Yes' to apply for a 'deemed authorisation'. This allows you to continue a disposal which is substantially the same as one you or your predecessor carried on. 'Similar disposal' means approximately the same volumes of the same types of materials on the same land.

No ☒ If you are starting a new disposal on or after 1 April 1999 you will need to receive written authorisation before any disposal takes place.

Yes ☐ Date of last disposal

4.2 Do you know of any existing environmental permits in force for this site? For example discharge consents, abstraction licences or waste management licences.

No ☒

Yes ☐ please give details

4.3 Do you know of any nature conservation designations or land management agreements in or adjoining the site?

No ☐

Yes ☒ please give details

TIR CYMEN
<input type="checkbox"/> I would like details of the land management agreement to remain confidential.

5 About disposals on the site

These are general questions. You must also fill in

- a copy of Section 7 for each disposal area
- a copy of Section 8 for each substance type to be disposed of.

Spent sheep dip disposal

5.1 Will you dispose of spent sheep dip?

No ☐

Yes ☒ What type(s)?

☐ OP

☒ SP

☐ Bloom dip

Dilute pesticide disposal

5.2 Will you dispose of any of the following?

Please tick all that apply.

☐ Insecticide

☐ Fungicide

☐ Growth regulator

☐ Herbicide

5.3 Are all of your pesticide disposals part of agricultural activity?

No ☐ Please tell us about any non-agricultural activity which leads to the pesticide disposal onto or into land (for example, road verge or car park spraying).

Yes ☒ Please tell us what you use these pesticides for, for example, crop type, bulb dipping, horticulture

Other disposals

5.4 Are you disposing of any other listed substances onto or into land?

No ☒

Yes ☐ Please use this box to describe any other disposal activities which are not already noted. Describe the process(es) that produce(s) the material for disposal and state the types of substance.

Rate of disposal

5.5 Do you ever make disposals at a rate of more than 5m³/day in total, or more than six times each year?

We want to know about the total of all the substances on this application. 1m³=220 gallons

No ☒

Yes ☐ We will call you if we need further information.

6 About water quality on the site

6.1 Is there any existing monitoring of groundwater on or adjoining the disposal areas?

No ☒

Yes ☐ please give details of monitored wells, springs, catchpits or boreholes, and who monitors them.

--

6.2 Are there any wells, springs or boreholes on or adjoining the disposal areas where monitoring could take place?

No ☒

Yes ☐ please give details. If there are more than five, please attach separate details

Location. Grid ref., BGS number or licence number
Owner/occupier. 'Self' or contact details
Type. Borehole, well, catchpit, spring, etc.
Use. Domestic, agricultural, disused, etc.
Depth to rest water level in metres (give date)

Location. Grid ref., BGS number or licence number
Owner/occupier. 'Self' or contact details
Type. Borehole, well, catchpit, spring, etc.
Use. Domestic, agricultural, disused, etc.
Depth to rest water level in metres (give date)

6 About water quality on the site continued

Location. Grid ref., BGS number or licence number
Owner/occupier. 'Self' or contact details
Type. Borehole, well, catchpit, spring, etc.
Use. Domestic, agricultural, disused, etc.
Depth to rest water level in metres (give date)

Location. Grid ref., BGS number or licence number
Owner/occupier. 'Self' or contact details
Type. Borehole, well, catchpit, spring, etc.
Use. Domestic, agricultural, disused, etc.
Depth to rest water level in metres (give date)

Location. Grid ref., BGS number or licence number
Owner/occupier. 'Self' or contact details
Type. Borehole, well, catchpit, spring, etc.
Use. Domestic, agricultural, disused, etc.
Depth to rest water level in metres (give date)

6.3 Do you have details of any investigations of ground or groundwater conditions on or adjoining the disposal areas?

No ☐

Yes ☐ please attach details [what attached?]

7 About the land at one disposal area

One site may have several disposal areas. You must complete one of these sections for each disposal area. Please photocopy this page if necessary.

We need to be able to locate the site easily. Please send a map

- showing the National Ordnance grid reference
- which is at least A4 size

7.1 What is the National Ordnance grid reference for the disposal area?

You can find this on a National Ordnance Survey map. If the map you send us shows Ordnance Survey grid lines, you do not need to answer this question.

National Ordnance grid reference for example, ST 1234 5678

SN 5600 3000 5750 3000 ⁴⁶

7.2 How big is the disposal area?

Dimension is, for example 25x25 metres, or area in hectares

Soil

7.3 What is the depth of topsoil?

20cm is 8 inches, 30cm is 1 foot.

- ☐ shallow (0-20cm)
- ☐ moderate (20-30cm)
- ☐ deep (more than 30cm)

7.4 What is the texture of the soil?

Tick as many boxes as you think are appropriate

- ☒ stony
- ☒ sandy
- ☐ silty
- ☐ clay
- ☐ loam
- ☐ chalky
- ☐ friable
- ☐ cohesive
- ☐ plastic
- ☐ fine-grained
- ☒ medium-grained
- ☐ coarse-grained

7.5 What is the organic content of the soils?

If you do not know the organic content of the soil we will assume that it is minimal when we assess your application.

- ☐ organic Less than about 20 per cent organic content
- ☐ peaty More than about 20 per cent organic content
- ☒ not known

7.6 What are the drainage characteristics of the soils?

- ☒ free draining. Rainfall drains almost immediately.
- ☐ moderate. Rainfall drains more slowly but does not pond
- ☐ poor drainage. Rainfall ponds on surface. Often waterlogged.

7 About the land and one disposal area continued

7.7 Is this area underdrained?

- No ☒
- Yes ☐ please mark on your disposal area plan.

7.8 Describe the subsoils and underlying strata

Any information which you can give will help us to consider your application. Information on subsoils is particularly important where topsoil depth is less than 30 cm. Underlying strata may be, for example, gravels, sandstone, chalk, clay, limestone, or hard rock such as granite.

Rock.

7.9 Does the site plan include contour lines?

- No ☐ please give details of steepness and direction of slope and mark on relevant maps and plans.
- 4° is a 1:25 slope
- 7° is a 1:14 slope
- 11° is a 1:9 slope
- ☒ gentle (0-4°)
- ☐ moderate (5-7°)
- ☐ steep (8-11°)
- ☐ very steep (more than 11°)

Yes ☐

Vegetation

The nature of the vegetation can affect the absorption and breakdown of material. You should note what the cover is likely to be at the time of disposal and any changes e.g. cropping regime.

7.10 Describe the vegetation cover.

For example, 'rough grazing'

Good Pasture.

8 About the substance for disposal

You must complete one section 8 for each substance that you want to dispose of. *Please photocopy this page if necessary.*

8.1 What is the substance you want to dispose of?

Tick one box only.

- ☒ Spent sheep dip
☐ Dilute pesticide. Give examples of typical substances you are using

- ☐ Other please say what it is

Treatment and dilution

8.2 Is the substance treated before disposal?

For example, in a treatment plant

- No ☒
Yes ☐ please give details

8.3 Is the substance diluted before disposal?

- No ☐
Yes ☒ How much and with what? For example, slurry, wash water.

parts substance to parts

8.4 Is the substance stored before disposal?

For example as a normal part of your procedures or in case of adverse weather conditions

- No ☒
Yes ☐ please describe the storage arrangements, including method or type and location. Mark the location of storage facilities on the plan requested in section 10 Checklist, and on site maps and plans.

9 When and how the substance will be disposed of

9.1 Will the disposal take place only at particular times of the year?

- No ☐
Yes ☒ please give details

JULY / AUGUST.

9.2 How often will the discharge be made?

- ☐ every day
☐ most days
☐ at least once a week
☐ more than six times a year
☒ up to six times a year
☐ other say how often or under what circumstances

9.3 What will be the maximum daily disposal volume?

$1\text{m}^3 = 220 \text{ gallons}$

<input type="text"/>	cubic metres a day	before dilution
2	cubic metres a day	after dilution

9.4 How will you dispose of this substance?

Give a clear description of how the material is taken to the disposal site and how disposal is carried out. State the equipment used e.g. sprayer, soil injection, vacuum tanker. Mark any permanent pipes or other structures on the plan requested in section 10 Checklist, site maps and plans.

VACUUM TANKER.

10 Checklist

Site maps and plans

- ☒ a map showing the location of the site. Mark all disposal areas on the map.

The purpose of this map is to show the site in relation to the surrounding countryside and to allow it to be found. A scale of 1:25,000 or 1:10,000 is recommended, but it is more important to use a scale that will help the Agency to assess your application.

Disposal area plans

Please provide as much information as you can on the disposal area plans.

- ☐ An accurate plan of each disposal area (or point) which can be related to the site map which you are enclosing. Each plan should show:
- ☐ the area of each field used for each disposal, with an indication of how each is used (e.g. in rotation, at different times of the year).
- ☐ all watercourses within 200 metres of each disposal area, including those which dry out at times of the year. For surface watercourses, culverted watercourses, ditches, canals, lakes, ponds or swallow holes.
- ☐ boreholes, wells, springs or catchpits within 500 metres of any part of a disposal area.
- If any of these are used by neighbours give their names and addresses.*

Mark all features that you know of on the plan. Then talk to any neighbours with land within 500 metres of the disposal area to find out if they have any groundwater uses. Record details at Question 6.2.

- ☐ any areas that are under-drained or mole drained, including drainage direction. Mark the discharge points of the drainage system on the plan. If you have estimated them, please say so on the plan.

Other information

- ☐ Other information about the material for disposal or the site that may be relevant. List other information which you have attached here:

MAP SN 5630 - 5730

MAP SN 5629 - 5729

FIELD NO. ~~3497~~
3497 - 1.48 ha.

11 Declaration

If you fail without reasonable excuse to provide information requested in writing by the Agency you are

- committing an offence under Section 71 of the Environmental Protection Act 1990
- liable to a fine or imprisonment (or both).

For applications from more than one person all applicants should sign. For applications from a company or other corporate body an authorised person should sign.

I/we certify that the information in this application is correct.

I/we hereby apply under the Groundwater Regulations 1998 (under Regulation 23, Transitional Provisions) for authorisation to dispose of substances, as described in this application and its attachments.

I enclose the required application fee, payable to the Environment Agency.

I enclose 3 copies of the plan(s) and location maps with all relevant information clearly marked.

I confirm that I/we will provide additional information as requested by the Environment Agency where this is essential for the determination of the application.

I confirm that I/we will pay required advertising costs should advertising be necessary (following notification by the Environment Agency).

I confirm that I/we will notify the Environment Agency of any changes in the information in this application which might be material to the continuation of the authorisation.

Signature

Name **E.E.J. HUMPHREYS**

Position **Owner**

Date **24-3-99**

Are you

- ☒ the applicant
☐ their agent

12 What happens next

Please check that you have filled in all the relevant parts of the form, then send it back to us.

If we need any more information about your application, we will get in touch by phone or letter

Once we have processed your application, we will send you a letter, either authorising or refusing the application. This will set out the conditions we expect you to keep to when you make a disposal at the site.

If you are not happy with any of the conditions attached to your authorisation, you can appeal to the Secretary of State.

If there are any changes to the information you gave on your application, you must let us know straight away. You can phone us on 0645 333 111.

Now please send this form back to the nearest Regional office, using the list of addresses on the back cover of this form.

OK C/L

Disposal Area marked with red pen.

At Maesifan, Llanfynydd.

SN 5630-5730.

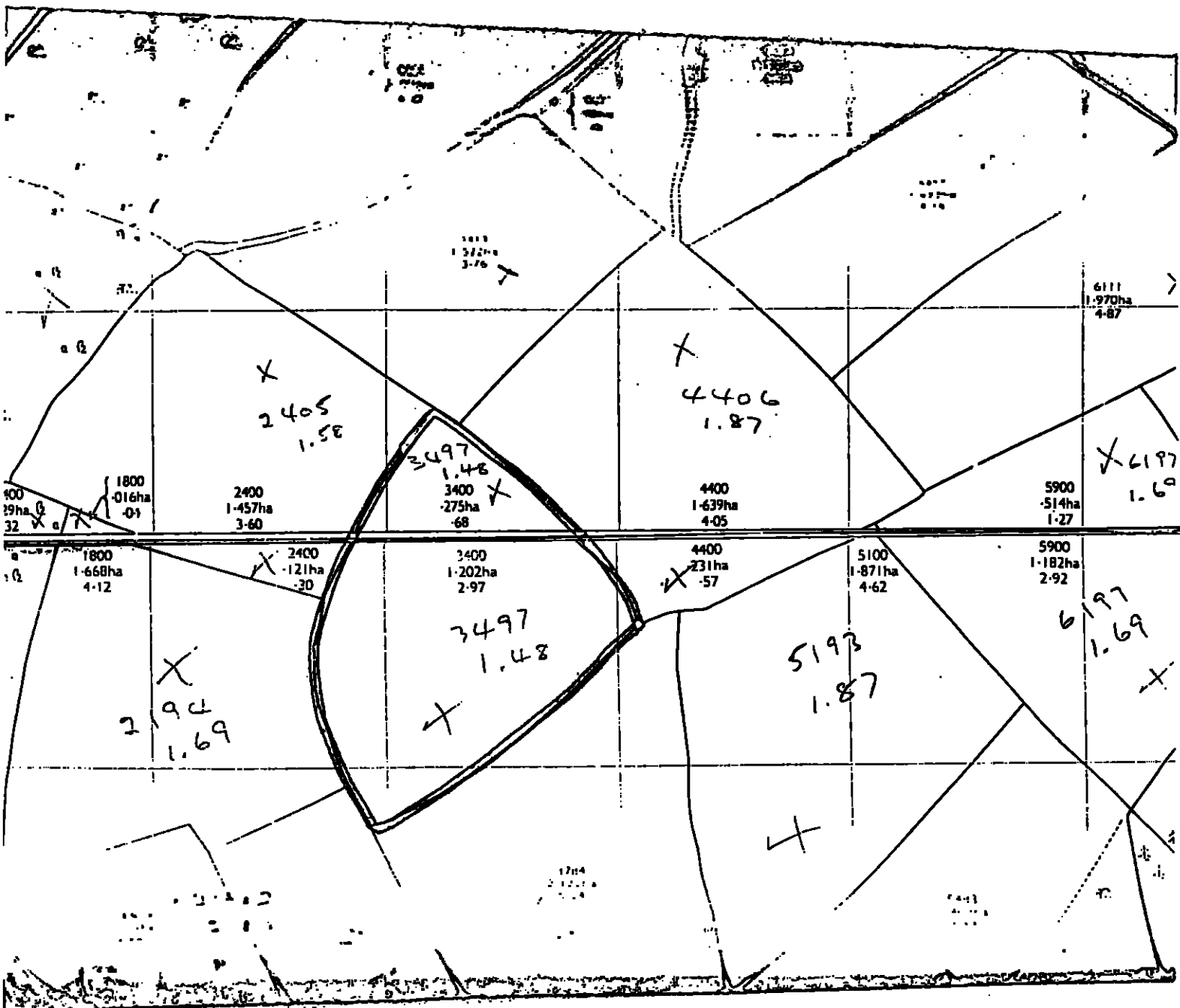

SN 5629-5729.

Summary scoring spreadsheet - land spreading of sheep dip
(see notes below - to be used in conjunction with the procedures outlined in TGN5)

Site : Maesifan, Llanfynydd, Carmarthenshire

Assessment Ref:

gws1616

Scoring Factor	Relevant questions/answers	Key parameters	Parameter value	Factor Score
Hydraulic loading	7.2	disposal area (hectares) =	1.48	0
	9.3	maximum daily disposal (m3/d, after dilution) = calculated hydraulic loading (m3/ha)	2 1.351351351	
Chemical loading	8.2, 8.3, 9.2	source material score (TGN5, table 1) = number of applications =	6 2	12
	7.1, 7.3-7.6	soil type: shallow (s), high (h), intermediate (in) or low (l) =	h	
Unsaturated Zone	6.1-6.3 (+Agency records)	substantial (>5m) non-aquifer cover: yes(y), no(n) = worst reasonable or assumed zone thickness (m) =	n 10	10
	7.1, 7.8, site/disposal plans/maps	aquifer type: karst (k), major (ma), minor (mi) or non (n) =	mi	
Land Use	7.1	land use type: bare (b), vegetated (v) or pasture (p) =	p	0
	5.1	sheep dip type: SP, OP or Bloom (B) =	sp	
Proximity	6.1-6.3, 7.1, site/disposal plans/maps	distance to nearest surface water receptor (m) = distance to nearest groundwater receptor (m) = groundwater protection zonation: 1, 2 or non (n) =	220 501 n	0 0
	TOTAL APPLICATION SCORE :			
INITIAL ASSESSMENT :			FURTHER CONSIDERATION AND/OR INVESTIGATION REQUIRED	

NOTES

- 1) One form should be used for each distinct combination of disposal area and substance, with a unique reference code (e.g. A1S2) entered into the box in the top right hand corner of the form.
- 2) The technical assessor should enter the necessary values in all the highlighted cells, seeking advice from TGN5 and its annex as appropriate.

Technical Trail

Site Name:

Crachty-Uchaf, Llanfynydd

Ref:

GWSW 1616

Description of Activi Disposal of sheep dip SP -spread to land

Assumptions:

A small fraction of the disposal area is wooded. No disposal can take place in this area.
Un saturated zone thickness assumed over 5m using rule of thumb.
Disposal area approx 30m from surface water, but a wooded area inbetween may act as a buffer.

CONSULTEES

Internal:

Conservation (OPM 14 Days) NAC

Regional Hydrogeology (OPM 21 days) Return by:

External:

Advertising require Y

Specific notes on authorisation conditions

All standard conditions apply etc

Operational Issues (review visits etc)

Determining officer

Mathew Griffiths

Date

Nov 2nd 1999.

SECTION 1: AUTHORISATION DETAILS (If more than one disposal site, please complete this section for each site)



ENVIRONMENT
AGENCY

Site Inspection Report
for Authorised Disposal of Spent
Sheep Dip
Groundwater Regulations 1998

AUTHORISATION REF.: GWSW 1616
NAME OF OFFICER(S): M BOWEN

GRID REF SN 5750 3000

DATE: 14/6/02

TIME IN 1000 OUT

FARM NAME CROCHTY UCHAF
ADDRESS LLANFYNNYD
TOWN
COUNTY CARM
POSTCODE SA32 7DD
TEL: 01558 668810
FAX:
E-MAIL

REGION: A ☐ NE ☐ NW ☐ M ☐ S ☐ T ☐ SW ☐ W ☒
AREA LLANFYNNYD
CATCHMENT Tyni

BUSINESS STRUCTURE:

SOLE TRADER ☐ PARTNERSHIP ☒ COMPANY ☐

MAP AVAILABLE

NONE ☐ FARM ☒ DISPOSAL SITE ☒

AUTHORISATION HOLDER DETAILS same as farm ☒

NAME
ADDRESS
TOWN
COUNTY
POSTCODE
TEL:
FAX:
E-MAIL

OWNER DETAILS

same as authorisation holder ☒

NAME
ADDRESS
TOWN
COUNTY
POSTCODE
TEL:
FAX:
E-MAIL

LICENSEE ☐ FARM MANAGER ☐ OWNER/OCCUPIER ☒ TENANT ☐ SHARE FARMER ☐

FARM TYPE: SHEEP ☐ MIXED ☒ OTHER (please specify):
SHEEP, ARLEY, BEEP

OVERALL ASSESSMENT/ACTIONS

- OWNER occupier of CROCHTY UCHAF.
1. HOME ADDRESS CROCHTY UCHAF AT SN 576 270.
 2. LOCATION OF SPREADING FIELD = MAESIRAN SN 5750 3000 ON RENT.
 3. LOCATION OF DIP TANK = MAEJYR HAIDD SN 5677 3006

COMPLIANT WITH AUTHORISATION: YES ☒ NO ☐

CONFIRMED RISK ASSESSMENT: HIGH ☐ LOW ☒

Officer's signature Merion Bowen

Authorisation holder's signature E E Humphreys

SECTION 2: PRE-INSPECTION CHECKLIST			
1. HEALTH AND SAFETY			
LONE WORKER PROCEDURES	PRE VISIT <input checked="" type="checkbox"/>	POST VISIT <input type="checkbox"/>	
RISK ASSESSMENT - REMOTE SITE	YES <input type="checkbox"/>	NO <input checked="" type="checkbox"/>	
- DOUBLE MANNING	YES <input type="checkbox"/>	NO <input checked="" type="checkbox"/>	
- APPOINTMENT MADE	YES <input checked="" type="checkbox"/>	NO <input type="checkbox"/>	
DATE <u>17</u> / <u>6</u> / <u>02</u>	TIME <u>10</u> / <u>00</u>	CONTACT:	
TEL NO. (inc STD code):			
2. (a) COPY OF AUTHORISATION	YES <input checked="" type="checkbox"/>	NO <input type="checkbox"/>	
	NOT AUTHORISED		<input type="checkbox"/>
2. (b) GROUNDWATER VULNERABILITY SCORE			
3. RELATED POLLUTION INCIDENTS	YES <input type="checkbox"/>	NO <input checked="" type="checkbox"/>	
DETAILS:			
4. CHEMICAL DATA REVIEW COMPLETED	YES <input type="checkbox"/>	NO <input checked="" type="checkbox"/>	
DETAILS:			
5. BIOLOGICAL DATA REVIEW COMPLETED	YES <input type="checkbox"/>	NO <input checked="" type="checkbox"/>	
DETAILS:			
6. POTABLE SUPPLIES INFORMATION (Local authority)	YES <input type="checkbox"/>	NO <input checked="" type="checkbox"/>	
DETAILS:			
7. CONSERVATION ISSUES	YES <input type="checkbox"/>	NO <input checked="" type="checkbox"/>	
DETAILS:			
8. SPREADING RECORDS FOR SITE	YES <input checked="" type="checkbox"/>	NO <input type="checkbox"/>	
DETAILS:			
9. RIVER CATCHMENT	SUB CATCHMENT		
<u>T.Y.W.I</u>			

Are there any services (water mains, gas pipes, electricity cables) running underneath the sheep dip disposal site?

Soil testing H₂S. When was the last time you disposed of sheep dip at the site?

SECTION 3 : ACTIVITIES WHICH MAY GIVE RISE TO AN UNINTENTIONAL RELEASE OF LISTED SUBSTANCES

1. SHEEP DIP INFRASTRUCTURE

2. DIP LOCATION (NGR) (8 Figs)

SW : 5677 3006

3. DIP TYPE

Permanent (Static) ☒

Mobile ☐

4. PERMANENT DIP SITE DETAILS

Structure Material

Block ☒ Brick ☐ Concrete ☒ Grp ☒ Plastic ☐ Steel ☐ Other ☐

Roof Over Dip ?

YES ☒ NO ☐

Does structure appear in good state of repair ?

YES ☒ NO ☐

Presence of Drain Hole ?

YES ☐ NO ☒

Drain Directed to : Soakaway ☐ Stream ☐ Slurry Lagoon ☐ Collection Tank ☐ Unknown ☐

Collecting / Drain off Areas

Permeable Floor ☒ Impermeable Floor ☐

Draining Apron Diversion when not in use:

YES ☐ NO ☒

Details :

Drain off returned to Dip ?

YES ☒ NO ☐

Capacity of Drain Off Pen ? (No. of sheep)

100

Drain off Period (minutes)

300

Risk of Leaching by Splashing ?

YES ☐ NO ☒

Age of Permanent Dip Tank (years)

12

Used by > 1 farmer ?

YES ☒ NO ☒

Details :

1 farmer

5. MOBILE DIP UNITS

Type of Unit

N/A

Dip ☒ Jetter ☐ Shower ☐

Dedicated Area ?

YES ☐ NO ☐

On Permeable Base ?

YES ☐ NO ☐

Distance from watercourse ?

(metres)

Distance from surface water drain ?

(metres)

Could dip enter surface water system ?

YES ☐ NO ☐

Need to relocate dip ?

YES ☐ NO ☐

Details :

Contractor Details :

Name :

Address :

Tel No : (incl STD code)

On EA list of Contractors

YES ☐ NO ☐

6. PESTICIDE USAGE

Type of Dip

O/P ☐ S/P ☒ O/P + S/P ☐ Other ☐

Product Names :

YOUNG'S ROBUST

(Refer to VMD Listing for Active Ingredient)

On Current VMD Listing ?

YES ☐ NO ☐

Details if No :

Within Manufacturer's "Best Before" Date for Usage ?

YES ☐ NO ☐

SECTION 3 : ACTIVITIES WHICH MAY GIVE RISE TO AN UNINTENTIONAL RELEASE OF LISTED SUBSTANCES (contd.)

7. PESTICIDE STORAGE

Quantity Used per Annum

10 Litres

Volume Stored ?

0 Litres

Locked Store ☒ Unlocked Store ☐

Operator Awareness of Pollution Risk ?

YES ☒ NO ☐

Details :

8. DISPOSAL OF PESTICIDE CONCENTRATE/CONTAINERS

Pesticide Concentrate : Return to Supplier ☐ Waste Disposal Contractor ☐

If waste disposal contractor, please specify:

N/A

Pesticide Containers: Return to Supplier ☐ Buried on Premises ☐ Waste Disposal Contractor ☐ *CC*
(Please specify contractor.)

If Buried on Premises: Triple Rinsed ☐ Punctured ☐ Min. Risk of SW/GW Pollution ☐

*WASHED OUT - RUGBY
CONCRETE CCC*

Secure Storage Facilities Prior to Disposal ? Please specify

9. SHEEP ACCESS TO PASTURE AFTER DIPPING

Direct from Holding Area ?

YES ☐ NO ☒

Does Access cross Watercourse ?

YES ☐ NO ☒

Drinking Water Supply - from stream ?

YES ☒ NO ☐

- from trough ?

YES ☐ NO ☒

Time held in Pasture prior to Release ?

3 Hours

Details :

10. CONTINGENCY PLANS IN THE EVENT OF SPILLAGE

Documented Emergency Plan for Spillages or other Emergencies: YES ☐ NO ☒

Includes : Site Plan ☐ Drainage System & Water Supply Plan ☐

Location of Pollution Control Equipment Procedures to Protect SW/GW ☐

Contact Details of Emergency Services & Environment Agency ☐

*SAND AVAILABLE
TO ABJ29*

Procedures copied to Emergency Services and Environment Agency? YES ☐ NO ☐

CONCENTRATE

Training Programme for Staff in Procedures? YES ☐ NO ☐

SECTION 4: ASSESSMENT OF COMPLIANCE WITH AUTHORISATION

4.1 DIP DISPOSAL

Disposal Records Kept ?

YES ☒ NO ☐

*KEPT ON DISK
MORE DETAILS REQUIRED*

Disposal Records Inspected ?

Details :

No
FMD precautions. Has the sheep dip been treated with lime? farm given

On-Farm Disposal ?

YES ☒ NO ☐

Off-Farm Disposal ?

YES ☒ NO ☐

Typical Volume Spent Dip

300 Litres / Gallons

Is Dip Diluted Pre-Disposal ?

YES ☒ NO ☐

Volume after Dilution

600 Litres / Gallons

Dip Diluted with :

WATER

Drain to Slurry Lagoon/

YES ☐ NO ☒

Drain to Tank ?

YES ☐ NO ☒

Interim Storage details :

Spread on land ?

YES ☒ NO ☐

Removed by Waste Contractor ?

YES ☐ NO ☒

Removed by Mobile Dipping Contractor ?

YES ☐ NO ☒

Treatment Prior to Spreading ?

YES ☐ NO ☒

Specify Treatment Method :

Application Rate

200 m³ / Ha or Galls / Acre

Method of Disposal

Tanker / Spreader ☐ LRI ☐ Other ☐

Specify if other :

Area Available for Spreading

3 Hectares / Acres

Is a Farm Waste Management Plan (FWMP) available ?

YES ☐ NO ☒

DISPOSAL OF UNUSED DIP

Returned to Supplier ?

YES ☐ NO ☒

Returned to Manufacturer ?

YES ☐ NO ☒

Stored for Future Use ?

YES ☐ NO ☒

Dilute in Bath & Spread ?

YES ☐ NO ☒

NUMBER OF DIPPING OPERATIONS

Number of Operations / Year (average)

1 Per annum

Maximum Number of Operations / Year

1 Per annum

Flock Size

1800 ewes / lambs

4.2 DISPOSAL SITE ASSESSMENT - PHYSICAL FEATURES

1. TOPOGRAPHY

(4° = 1:25 slope, 7° = 1:14 slope, 11° = 1:9 slope)

Gentle (0 - 4°) ☐ Moderate (5 - 7°) ☒ Steep (8 - 11°) ☐ V Steep (> 11°) ☐

2. SOIL DEPTH

(20 cm is 8 inches, 30 cm is 1 foot)

NOTE Soil investigation was limited to 30cm depth maximum. Refer to map for location of soil test.

Shallow (0 - 20 cm) ☒ Moderate (20 cm - 30 cm) ☐ Deep (>30 cm) ☐

4.2 DISPOSAL SITE ASSESSMENT - PHYSICAL FEATURES (contd.)

3. SOIL TEXTURE

Stony ☐ Silty ☐ Loam ☒ Sandy ☐ Clay ☐

Friable (easily crumbled) ☒

Cohesive (stick together) ☐

Plastic (mouldable) ☐

Fine Grained ☐

Medium Grained ☒

Coarse Grained ☐

4. DRAINAGE CHARACTERISTICS

Free Draining ☒ Moderate Draining ☐ Poor Drainage ☐

Is the Area Underdrained ? YES ☐ NO ☒ Not Known ☐

Are Drainage Plans Available ? *n/a* YES ☐ NO ☐

5. VEGETATION COVER

Rough Grazing ☐ Permanent Pasture ☒ Arable ☐ Fallow ☐ Set Aside ☐

6. IN CROP ROTATION SYSTEM ? YES ☐ NO ☒

Details :

7. "WHOLE FARM" DISPOSAL ? YES ☐ NO ☒

Details of Area Inspected :

8. DISTANCE TO DISPOSAL SITE (S) 1.5 ~~Meters~~ / Kilometres

9. ROUTE TO DISPOSAL SITE : POTENTIAL RISKS? YES ☐ NO ☒

Details :

10. EVIDENCE OF IMPACT ? YES ☐ NO ☒

Visible signs of : - Ponding YES ☐ NO ☒

- Scorching YES ☐ NO ☒

- Other Impact YES ☐ NO ☒

Details :

11. SURVEILLANCE OF GROUNDWATER

Has any sampling of groundwater been undertaken ? YES ☐ NO ☒

Details :

12. RISK TO GROUNDWATER FEATURES ? YES ☐ NO ☒

Details :

13. RISK TO SURFACE WATER FEATURES ? YES ☐ NO ☒

Details :

Is farm a Tur Gofal scheme?

5.0 COMMENTS AND RECOMMENDATION

1. ANY ASPECTS OF APPLICATION FORM YES ☐ INCORRECT? NO ☒

Details :

2. DETAILS OF AMENDMENTS TO APPLICATION FORM REQUIRED. YES

3. ANY BREACH OF AUTHORISATION? YES ☐ NO ☒

Details :

4. DETAILS OF AMENDMENTS TO AUTHORISATION REQUIRED

5. ARE ANY REMEDIAL WORKS REQUIRED? YES ☐ NO ☒

Works Required

Agreed Timescale for Completion

6. OVERALL RISK ASSESSMENT Higher Risk ☐ Lower Risk ☒

Justification :

7. CONTACT WITH LOCAL AUTHORITY REQUIRED?

Details :

Follow Up Required YES ☐ NO ☐

Letter Required YES ☐ NO ☐

Date Sent : ____ / ____ / ____ Response : ____ / ____ / ____

Works Notice Required YES ☐ NO ☐

Date Sent : ____ / ____ / ____ Response : ____ / ____ / ____

GWR Works Notice Required YES ☐ NO ☐

Date Sent : ____ / ____ / ____ Response : ____ / ____ / ____

Site Inspected by (Print) M Bower

Form Checked by (Print) _____

(Signed) Neil Bower

(Date) 14 / 6 / 02

(Fin ver.10/1/2001)

**Ground Penetration Risk Assessment Check List
GWSW**

	Yes	No
1. Is ground penetration necessary		
2. Have you asked site owners (or those that are familiar with the site) and the utility companies whether there are cables, pipes or other services present and at what depth these are likely to be?		
Are the Following Present?		
3. Utility marker posts		
4. Surface disturbance indicating trenches (topsoil discolouration or inclusions of foreign material e.g. bricks, rubble etc).		
5. Manhole covers		
6. Overhead Cables		
Are you in close proximity (100m or less) to		
7. Adjacent buildings (preferably choose a location >100m away)		
8. Proximity to Sub-Stations (choose a location >100m away)		
9. Proximity to roads and track ways (preferably choose a location >100m away)		
10. Do any of the above indicate an unacceptable risk of buried services being present? Please specify below:		

If the answers to any of the above questions are marked in the shaded boxes, you must consider ways to reduce the risk.

e.g. if the answer to Question 7 or 9 is Yes, it may be that information from the landowner assures you that there are no underground services a certain distance away from the building or roadway. This information should be recorded here.

Ein cyf/Our ref. CC/14/GWSW1616/MJB

Dyddiad/Date: 26 June 2002



ASiantaeth YR
AMGYLCHEDD CYMRU
ENVIRONMENT
AGENCY WALES

E E J Humphreys
Crachdy Uchaf
Llanfynydd
Carmarthen
Carmarthenshire
SA32 7DD

Dear Mr Humphreys

**THE GROUNDWATER REGULATIONS 1998
SITE INSPECTION AT CRACHDY UCHAF FARM, LLANFYNYDD**

AUTHORISATION REF: GWSW1616

Further to our meeting on 14th June 2002, I write to confirm the following points:

1. The use, in accordance with the conditions of your authorisation, of an area of land centred at National Grid Reference SN5750 3000 at Maesifan for the disposal of spent sheep dip should not pose a significant risk of pollution to controlled waters (surface and ground waters).
2. It is imperative that records of spent sheep dip disposal are kept on sheets provided with the Authorisation when sheep dip is disposed of at the site. A copy of the record sheet was enclosed with your Authorisation, and I gave you an additional sheet during my visit.
3. As regards to the sheep dip infrastructure at Maesyrrhaidd SN 5677 3006 dipping operations would pose minimal risk to surface waters provided treated sheep are allowed to dry thoroughly in the first stage drying area, which drains back into the sheep dip bath.

Thank you for assisting me with the site inspection work.

If there are any points you wish to discuss, then please do not hesitate to contact me at this office on extension 3613.

Yours sincerely,

Meirion Bowen
MEIRION BOWEN
Environment Protection Officer

Asiantaeth yr Amgylchedd Cymru
Plas Gwendraeth, Heol Parc Mawr, Parc Business Cross Hands, Cross Hands, Llanelli, Sir Gaerfyrddin. SA14 6RE
Ffôn (01269) 841523, Ffacs (01269) 831704

Environment Agency Wales
Plas Gwendraeth, Heol Parc Mawr, Cross Hands Business Park, Cross Hands, Llanelli, Carmarthenshire. SA14 6RE
Tel (01269) 841523, Fax (01269) 831704



Customer details

the item is addressed to

E.E.J. HUMPHREYS

CRACHTY UCHAF

LLANFYNMODD

CARM S

Postcode SA32 7DD

Barcode number

RT7739
200856B

date of posting

5.11.99

Post Office from which the item was sent

Post office

Delivery details

☐ it was delivered to/called for by

name

E.M. HUMPHREYS

signature

E.M. Humphreys

☐ it couldn't be delivered

because

on (date)

6/11/99

Officer's signature

date stamp

06-11-1999



Royal Mail

111

Postal
Service

this card is to be posted back to this address

R Cadiwalladr

Environment Agency

154 St Helens Rd

Swansea Postcode SA1 4DF

AD

Our Ref: MG/GWSW1616
Your Ref:



ASiantaeth YR
AMGYLCHEDD CYMRU
ENVIRONMENT
AGENCY WALES

Date: As postmark

E. E. J. Humphreys,
Crachty-Uchaf,
Llanfynydd,
Carmarthenshire
SA32 7DD.

Dear Sir/Madam

GROUNDWATER REGULATIONS 1998

GROUNDWATER AUTHORISATION NO.
ISSUED TO:
FOR THE SITE AT:

GWSW1616
E.E.J. Humphreys
Maesifan, Llanfynydd.

I am writing to inform you that your application for a Groundwater Authorisation has now been approved. You have been given Authorisation Number GWSW1616 and I would be very grateful if you would quote this reference in any future communications.

Please find a copy of your Authorisation enclosed. This is a legal document so please ensure that you store it away safely.

Your Authorisation now allows you to dispose of **spent sheep dip** at **Maesifan, Llanfynydd** provided that you do so without breaching any of the conditions of your Authorisation. If you do not understand any of the conditions or need an explanation, please contact me without delay at the address below.

In future, your circumstances may change, and we both may have concerns, which may need to be sorted out. I have therefore explained below what may happen in relation to your Authorisation.

- Your Authorisation will end on the 30th November 2011. It is your responsibility to ensure that you contact us a reasonable time prior to the end date of your Authorisation if you wish to continue to dispose of spent sheep dip at Maesifan, Llanfynydd. We will need to reassess your Authorisation at that time to ensure that any risk to the environment is still adequately controlled. Provided that there is no reason to cancel the permission, an extension to the Authorisation will be issued at no additional cost.

Asiantaeth yr Amgylchedd Cymru
Glan Tawe, 154 Ford Sant Helen, Abertawe SA1 4DF. Tel: 01792 645300, Ffacs: 01792 648652.

Environment Agency Wales
Glan Tawe, 154 St. Helens Road, Swansea SA1 4DF. Tel: 01792 648652, Fax: 01792 648652





**ASiantaeth Yr
Amgylchedd Cymru
Environment
Agency Wales**

- Your Authorisation applies only to the named holder making a disposal onto the area of land specified in the Authorisation. Therefore, if you move, you can not take your Authorisation with you and continue to dispose at another location. However, the holder of an Authorisation may transfer the Authorisation to another named person for use of the **same disposal area of land for the same purpose**. This must be done prior to any disposal by the new occupier, and the current holder must inform the Agency of the transfer to the new holder.
- Please be aware that there is an Annual Charge payable for your Authorisation. The current Charge is £107.33. You will have been billed for this amount by our finance department. The Annual Charge may be changed at the beginning of any financial year from the 1 April.
- In the future, you may find that you do not need to dispose of spent sheep dip. In this case, please write and ask for your Authorisation to be withdrawn. After we have received your written request and we have confirmed that no Authorisation is required, we will instruct our finance department to stop billing you. Please note that we can not refund charges for parts of a year.

You can apply to us at any time to review the conditions of your Authorisation if, for example, you wish to increase the annual quantities disposed of. You must complete another application to do this and pay a fee.

The Authorisation will be reviewed at intervals of up to 4 years to take account of changes in circumstances. We may also change the conditions of your Authorisation if we think it is necessary to do this in order to prevent pollution of the environment. We will try to ensure that any such changes do not cause an unreasonable cost on your part.

You should be aware that the Agency has the power to revoke (i.e. cancel) your Authorisation at any time if this is considered to be justified. In such cases, a Notice will be given to you telling you of our reasons for the revocation. You have a right of Appeal against the decision.

If we revoke or amend your Authorisation, or if you think that any of the conditions of your Authorisation are unreasonable, you may appeal to the National Assembly for Wales. A copy of the form on which you may appeal is available from the National Assembly for Wales, Cathays Park, Cardiff, CF10 3NQ.





ASiantaeth Yr
AMGYLCHEDD CYMRU
ENVIRONMENT
AGENCY WALES

It is important that you pay our Annual Charge promptly. Bills will be sent to you each year for as long as your Authorisation remains in existence. If you do not pay your bill promptly, we may take measures to remove your right to continue to dispose of spent sheep dip. **Please note that if your Authorisation is revoked because of non-payment and you continue to dispose of spent sheep dip, you may be committing an offence for which you could be prosecuted.**

I hope that this letter gives you enough information about the legal requirements of disposing spent sheep dip to land. However, if you are unclear on any of the above matters or need some further help or advice, please contact me on extension 3528 at the address below.

Yours faithfully

Richard Cadwalladr
Water Quality Consents Officer

Encl.: Groundwater Authorisation, GWSW1616.
Record of sheep dip disposal activity form.



AUTHORISATION NO.

GWSW1616



ASiantaeth YR
AMGYLCHEDD CYMRU
ENVIRONMENT
AGENCY WALES

GROUNDWATER REGULATIONS 1998**REGULATION 18(3)(a)****AUTHORISATION OF DISPOSAL
OR TIPPING FOR THE PURPOSE OF DISPOSAL**

TO: E.E.J. Humphrey
Crachty-Uchaf
Llanfynydd,
SA32 7DD.

The **ENVIRONMENT AGENCY** ("The Agency") in pursuance of its powers under the Groundwater Regulations 1998 and in accordance with Regulation 18(3)(a) of those Regulations, hereby **AUTHORISES** the making of a disposal of **sheep dip** as follows:

Spreading onto land

FROM: A sheep dip

AT: Maesifan, Llanfynydd.

TO : land

SUBJECT TO: the conditions set out in the following Schedule :

Spreading onto land

Schedule no GWSW1616

The Agency will review this Authorisation at least every 4 years and may vary or revoke the Authorisation in writing at any time.

Dated this 4th day of November 1999.

Signed.....H.J. Williams.....

Team Leader Water Quality Consents

Asiantaeth yr Amgylchedd

Glan Tawe, 154 Fford Sant Helen, Abertawe, SA1 4DF. Ffon 01792 645300, Ffacs 01792 648652.

Environment Agency

Glan Tawe, 154 St Helens Road, Swansea, SA1 4DF. Tel: 01792 645300, Fax: 01792 648652.



AUTHORISATION NO.	GWSW1616
SCHEDULE NO.	GWSW1616
DATE ISSUED	4th November '99



**ASiantaeth Yr
Amgylchedd Cymru
Environment
Agency Wales**

CONDITIONS OF AUTHORISATION OF DISPOSAL

Spreading onto land ("the disposal")

FROM : Maesifan, Llanfynydd.

GENERAL

1. The disposal shall consist only of spent sheep dip, derived from use at Maesifan, Llanfynydd of sheep dip used in accordance with appropriate licensed use conditions issued by the Veterinary Medicines Directorate, Ministry of Agriculture Fisheries and Food (MAFF).
2. The disposal shall be undertaken at the location specified in condition 3 below so that:
 - (a) There shall be no direct discharge of List 1 substances as set out in Annex 1 to this notice to groundwater or surface waters;
 - (b) Groundwater's (as defined by the Groundwater Regulations 1998) are not polluted;
 - (c) The disposal shall not cause any adverse effects on sources of water for public or private potable supply;
 - (d) Disposal of List 1 and List 2 substances (set out in Annex 1 to this notice) shall only be made in accordance with the conditions of this Authorisation.
 - (e) Provided that the disposal hereby authorised is made in accordance with all of the conditions of this Authorisation, such disposal shall not be taken to be in breach of condition (a), (b) or (c) above because it contains substances or has properties identified in and controlled by conditions (a), (b) or (c);
 - (f) The Authorisation holder shall take all practicable measures to minimise adverse environmental impact of the disposal.
3. The disposal shall be made by application onto an area of land centered at:

National Grid Reference SN 5750 3000

As shown marked "Disposal area " on the attached Authorisation plan GWSW1616.



AUTHORISATION NO.	GWSW1616
SCHEDULE NO.	GWSW1616



**ASiantaeth Yr
Amgylchedd Cymru
Environment
Agency Wales**

4. The disposal shall be made by application onto an area of land with an established vegetation cover of minimal wildlife value. The area of land shall not include hedgerows, woodlands or wildflower meadows, or land that is bare as part of a crop rotation. The disposal of spent sheep dip shall not be made to land on which crops are currently being grown for human consumption.
5. No part of the disposal area shall lie within:
 - (a) 10 metres of the nearest watercourse (which includes ditches that may be dry for part of the year), or 30 metres of a river designated as a Site of Special Scientific Interest (SSSI) or Special Area of Conservation (SAC),
 - (b) 50 metres of any well, spring, or borehole, irrespective of its current use,
 - (c) 500 metres of any well, spring, or borehole used for potable water supply.
6. No disposal shall be to field boundaries or to a strip at least 2 metres wide adjacent to any boundary.
7. No disposal of spent sheep dip shall take place on land which:
 - (a) is under drained or that has been mole drained within 12 months prior to any disposal operation or is cracked down to the drain or any backfill;
 - (b) has a slope greater than 11 degrees;
 - (c) is frozen hard or snow covered;
 - (d) is liable to flooding;
 - (e) is severely compacted or waterlogged.
8. Disposal equipment and / or methods shall be designed and operated such that the requirements of Conditions 9 and 10 are met.





AUTHORISATION NO.	GWSW1616
SCHEDULE NO.	GWSW1616

VOLUME

9. The maximum volume of spent sheep dip (of working strength), before any dilution to assist safe spreading, shall not exceed 2 cubic metres per day and 4 cubic metres per annum disposed of to the land identified in Condition 3 above.
10. The maximum daily application rate of spent sheep dip to the same area of land (before dilution to assist safe spreading) shall not exceed 5 cubic meters per hectare or 20 cubic metres per hectare after dilution for safe spreading.

DISPOSAL PERIOD.

11. The minimum interval between each disposal to the same area of land shall be at least 28 days.

MONITORING / REPORTING

12. Records shall be kept on a form provided by the Agency and made available for inspection on request by the Agency, for at least four years. They shall include:
 - (a) daily volume of undiluted spent sheep dip disposed of;
 - (b) rates of disposal;
 - (c) location and area of disposal;
 - (d) nature of used dip (licensed brand name will suffice);
 - (e) any materials added to dilute or treat the spent sheep dip including water or slurry

EXPIRY DATE

13. The Authorisation shall cease to have effect on 30th November 2011



GROUNDWATER REGULATIONS 1998

Record of Sheep Dip Disposal Activities at Maesifan, Llanfynydd permitted by Authorisation Number GWSW1616

Required Records	Disposal date	Disposal date	Disposal date	Disposal date	Disposal date
Licensed brand name or Chemical composition of dip.					
Details of any disposal other than used dip made up to stipulated initial dilution rates.					
Volume of spent dip (litres)					
Spreading equipment used.					
Rate of disposal in m^3/ha (gallons/acre)					
Location of disposal area – either indicate field numbers and if whole fields or not, or provide separate map.					
Quantity and nature of material used to further dilute the spent dip to help safe spreading eg slurry or water.					
Dilution ratio of slurry/water : dip					
Materials used to reduce toxicity of spent dip and confirmation or otherwise if these are used in accordance with manufacturers recommendations					

Disposal Area marked with red pen

at Maesifan, Llanyfynydd

SN 5630-5730.

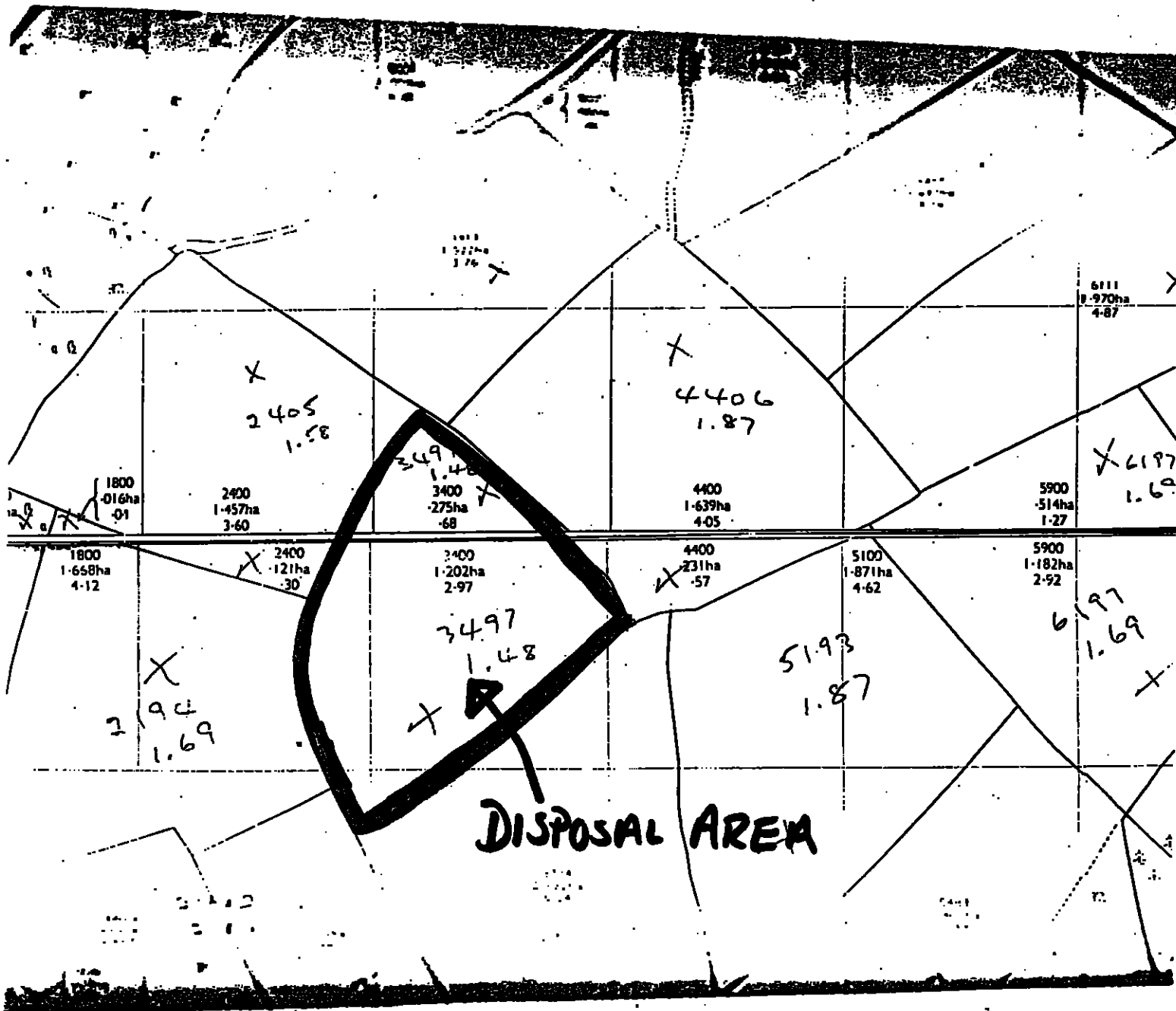

SN 5629-5729.

AUTHORISATION PLAN RWSW 1616



ANNEX 1.

Summary listing of the substances to be controlled under the Groundwater Regulations 1998.

List One. "List One" substances are the most toxic and must be prevented from entering groundwater. They include pesticides; sheep dip and solvents.

- Organohalogen compounds and substances which may form such compounds in the aquatic environment
- Organophosphorus (OP) compounds
- Organotin compounds
- Substances which possess carcinogenic, mutagenic, or teratogenic properties in or via the aquatic environment (including substances which may have those properties which would otherwise be in list two)
- Mercury and its compounds
- Cadmium and its compounds
- Mineral oils and hydrocarbons
- Cyanides

List Two "List Two" substances are less dangerous but, if disposed of in large amounts, could be harmful to groundwater. Entry of these substances into groundwater must be restricted.

- The following metals and metalloids and their compounds

Zinc	Antimony	Uranium
Copper	Molybdenum	Vanadium
Nickel	Titanium	Cobalt
Chromium	Tin	Thallium
Lead	Barium	Tellurium
Selenium	Beryllium	Silver
Arsenic	Boron	

- Biocides (including pesticides) and their derivatives not appearing in list one
- Substances which have a deleterious effect on the taste or odour of groundwater, and compounds liable to cause the formation of such substances in such water and to render it unfit for human consumption.
- Toxic or persistent organic compounds of silicon, and substances which may cause the formation of such compounds in water, excluding those which are biologically harmless or are rapidly converted in water into harmless substances.
- Inorganic compounds of phosphorus and elemental phosphorus
- Fluorides
- Ammonia and nitrites

**ENVIRONMENT
AGENCY**

 156
Water quality
Application for groundwater authorisation

Groundwater Regulations 1998 (Regulation 23 - Transitional Provisions)

Please read the guidance notes and the form carefully before you complete it.

You must apply before 1 April 1999 if you wish to continue a disposal activity you have carried out before.

If you apply after 31 March 1999 you will have to wait for an authorisation to be granted before you can resume disposal.

If you make a disposal without an authorisation we may prosecute you.

Return your completed form to the nearest office from the list on the back cover of this form.

Disclosure

The law says that we must place your application on the public register unless you provide good reasons why it should stay confidential. If you want your application to stay confidential, write to us when you send us the form, giving your reasons in full.

Data protection

The information that you provide will be processed by the Environment Agency to fulfil its regulatory and monitoring functions. It will be placed on the relevant public registers. Completion of this form is compulsory if you wish us to process your application. You have a right of access to the information supplied to the Environment Agency and the right to apply to court for rectification of that information in accordance with data protection legislation.

For Environment Agency Use only

District/Area reference:

Application number:

 1416

Date received:

Fee received:

ACK 30/6/99

1 Where the disposal site is located
1.1 Name, address and location of disposal site

If the area of land forms part of a farm, give the address of the farm. Describe where the site is if the address is not clear.

E. E. J. HUMPHREYS.

Address

MAESIFAN.

LLANFYNYDD.

CARMARTHENSHIRE

Postcode

2 Authorised contact
2.1 Please give us details of the person we can phone or write to with questions about this application.

This can be someone acting as an 'agent' for the applicant.

Full name

E. E. J. HUMPHREYS.

Position

Owner.

Business address

CRACHTY-UCHAF,

LLANFYNYDD

CARMARTHENSHIRE

Postcode

SA32 7DD

Phone

01558 668810

Fax



3 The applicant

3.1 Is the applicant an individual, a group of individuals (or partnership) or a company/corporate body?

Please discuss this with us if you are not sure.

- ☒ Individual (sole trader) go to question 3.2
☐ Group of individuals or partnership go to question 3.3
☐ Company or corporate body go to question 3.5

Individuals

3.2 Please give us the following details.

Full name

E. G. J. HUMPHREYS.

Trading or business name (if there is one)

Go above.

Business address

CRACHTY-UCHAF.

LLANFYNYDD.

CARMARTHENSHIRE

Postcode SA 32 7DD.

Contact numbers (optional)

Phone 01558 668810.

Fax

Now go to question 3.6

Groups of individuals or partnerships

3.3 Who is applying for the authorisation?

We can only issue an authorisation to named individuals. We need details of each person applying to be an authorisation holder.

Continue on separate sheets if you need to.

Individual or partner

Full name

Business address

Postcode

Individual or partner

Full name

Business address

Postcode

Individual or partner

Full name

Business address

Postcode

3 The applicant continued

3.4 Please give us details about the group of individuals or partnership.

For applications from partnerships please provide written evidence, such as a deed of partnership.

Trading or business name of partnership (if there is one)

Business address

Postcode

Contact numbers (optional)

Phone

Fax

Now go to question 3.6

Companies or other corporate applicants

3.5 Please give us the following details.

For applications from companies please provide written evidence of registration.

- ☐ Registered company
☐ Other please give details

Full name of company or corporate body

Trading/business name (if different)

Registered office address

Postcode

Main office address (if different)

Postcode

Contact name and numbers (optional)

Name

Phone

Fax

Company registration number

Now go to question 3.6

3 The applicant continued

3.6 Billing address

If different from application address

Full name
Position
Trading name
Business address
Postcode

4 Existing licences

4.1 Have you previously made a similar disposal at this site?

Tick 'Yes' to apply for a 'deemed authorisation'. This allows you to continue a disposal which is substantially the same as one you or your predecessor carried on. 'Similar disposal' means approximately the same volumes of the same types of materials on the same land.

No ☒ If you are starting a new disposal on or after 1 April 1999 you will need to receive written authorisation before any disposal takes place.

Yes ☐ Date of last disposal

--

4.2 Do you know of any existing environmental permits in force for this site? For example discharge consents, abstraction licences or waste management licences.

No ☒

Yes ☐ please give details

--

4.3 Do you know of any nature conservation designations or land management agreements in or adjoining the site?

No ☐

Yes ☒ please give details

TIR CYMEN.
<input type="checkbox"/> I would like details of the land management agreement to remain confidential.

5 About disposals on the site

These are general questions. You must also fill in

- a copy of Section 7 for each disposal area
- a copy of Section 8 for each substance type to be disposed of.

Spent sheep dip disposal

5.1 Will you dispose of spent sheep dip?

No ☐

Yes ☒ What type(s)?

☐ OP

☒ SP

☐ Bloom dip

Dilute pesticide disposal

5.2 Will you dispose of any of the following?

Please tick all that apply.

☐ Insecticide

☐ Fungicide

☐ Growth regulator

☐ Herbicide

5.3 Are all of your pesticide disposals part of agricultural activity?

No ☐ Please tell us about any non-agricultural activity which leads to the pesticide disposal onto or into land (for example, road verge or car park spraying).

--

Yes ☒ Please tell us what you use these pesticides for, for example, crop type, bulb dipping, horticulture

--

Other disposals

5.4 Are you disposing of any other listed substances onto or into land?

No ☒

Yes ☐ Please use this box to describe any other disposal activities which are not already noted. Describe the process(es) that produce(s) the material for disposal and state the types of substance.

--

Rate of disposal

5.5 Do you ever make disposals at a rate of more than 5m³/day in total, or more than six times each year?

We want to know about the total of all the substances on this application. 1 m³=220 gallons

No ☒

Yes ☐ We will call you if we need further information.

6 About water quality on the site

6.1 Is there any existing monitoring of groundwater on or adjoining the disposal areas?

No ☒

Yes ☐ *please give details of monitored wells, springs, catchpits or boreholes, and who monitors them.*

--

6.2 Are there any wells, springs or boreholes on or adjoining the disposal areas where monitoring could take place?

No ☒

Yes ☐ *please give details. If there are more than five, please attach separate details*

Location. Grid ref., BGS number or licence number
Owner/occupier. 'Self' or contact details
Type. Borehole, well, catchpit, spring, etc.
Use. Domestic, agricultural, disused, etc.
Depth to rest water level in metres (give date)

Location. Grid ref., BGS number or licence number
Owner/occupier. 'Self' or contact details
Type. Borehole, well, catchpit, spring, etc.
Use. Domestic, agricultural, disused, etc.
Depth to rest water level in metres (give date)

6 About water quality on the site continued

Location. Grid ref., BGS number or licence number
Owner/occupier. 'Self' or contact details
Type. Borehole, well, catchpit, spring, etc.
Use. Domestic, agricultural, disused, etc.
Depth to rest water level in metres (give date)

Location. Grid ref., BGS number or licence number
Owner/occupier. 'Self' or contact details
Type. Borehole, well, catchpit, spring, etc.
Use. Domestic, agricultural, disused, etc.
Depth to rest water level in metres (give date)

Location. Grid ref., BGS number or licence number
Owner/occupier. 'Self' or contact details
Type. Borehole, well, catchpit, spring, etc.
Use. Domestic, agricultural, disused, etc.
Depth to rest water level in metres (give date)

6.3 Do you have details of any investigations of ground or groundwater conditions on or adjoining the disposal areas?

No ☐

Yes ☐ *please attach details [what attached?]*

7 About the land at one disposal area

One site may have several disposal areas. You must complete one of these sections for each disposal area. *Please photocopy this page if necessary.*

We need to be able to locate the site easily. Please send a map

- showing the National Ordnance grid reference
- which is at least A4 size

7.1 What is the National Ordnance grid reference for the disposal area?

You can find this on a National Ordnance Survey map. If the map you send us shows Ordnance Survey grid lines, you do not need to answer this question.

National Ordnance grid reference for example, ST 1234 5678

SN 5600 3000 S750 3000₄₆

7.2 How big is the disposal area?

Dimensions, for example 25x25 metres, or area in hectares

Soil

7.3 What is the depth of topsoil?

20cm is 8 inches, 30cm is 1 foot.

- ☐ shallow (0–20cm)
- ☐ moderate (20–30cm)
- ☐ deep (more than 30cm)

7.4 What is the texture of the soil?

Tick as many boxes as you think are appropriate

- ☒ stony
- ☒ sandy
- ☐ silty
- ☐ clay
- ☐ loam
- ☐ chalky
- ☐ friable
- ☐ cohesive
- ☐ plastic
- ☐ fine-grained
- ☒ medium-grained
- ☐ coarse-grained

7.5 What is the organic content of the soils?

If you do not know the organic content of the soil we will assume that it is minimal when we assess your application.

- ☐ organic Less than about 20 per cent organic content
- ☐ peaty More than about 20 per cent organic content
- ☒ not known

7.6 What are the drainage characteristics of the soils?

- ☒ free draining. Rainfall drains almost immediately
- ☐ moderate. Rainfall drains more slowly but does not pond
- ☐ poor drainage. Rainfall ponds on surface. Often waterlogged.

7 About the land and one disposal area continued

7.7 Is this area underdrained?

No ☒

Yes ☐ *please mark on your disposal area plan.*

7.8 Describe the subsoils and underlying strata.

Any information which you can give will help us to consider your application. Information on subsoils is particularly important where topsoil depth is less than 30 cm. Underlying strata may be, for example, gravels, sandstone, chalk, clay, limestone, or hard rock such as granite.

Rock.

7.9 Does the site plan include contour lines?

No ☐ *please give details of steepness and direction of slope and mark on relevant maps and plans.*

4° is a 1:25 slope

7° is a 1:14 slope

11° is a 1:9 slope

☒ gentle (0–4°)

☐ moderate (5–7°)

☐ steep (8–11°)

☐ very steep (more than 11°)

Yes ☐

Vegetation

The nature of the vegetation can affect the absorption and breakdown of material. You should note what the cover is likely to be at the time of disposal and any changes e.g. cropping regime.

7.10 Describe the vegetation cover.

For example, 'rough grazing'

Good Pasture

8 About the substance for disposal

You must complete one section 8 for each substance that you want to dispose of. *Please photocopy this page if necessary.*

8.1 What is the substance you want to dispose of?

Tick one box only.

- ☒ Spent sheep dip
☐ Dilute pesticide. Give examples of typical substances you are using

- ☐ Other please say what it is

Treatment and dilution

8.2 Is the substance treated before disposal?

For example, in a treatment plant

No ☒

Yes ☐ please give details

8.3 Is the substance diluted before disposal?

No ☐

Yes ☒ How much and with what? For example, slurry, wash water

parts substance to

parts

8.4 Is the substance stored before disposal?

For example as a normal part of your procedures or in case of adverse weather conditions

No ☒

Yes ☐ please describe the storage arrangements, including method or type and location. Mark the location of storage facilities on the plan requested in section 10 Checklist, and on site maps and plans.

9 When and how the substance will be disposed of

9.1 Will the disposal take place only at particular times of the year?

No ☐

Yes ☒ please give details

JULY / AUGUST.

9.2 How often will the discharge be made?

- ☐ every day
☐ most days
☐ at least once a week
☐ more than six times a year
☒ up to six times a year
☐ other say how often or under what circumstances

9.3 What will be the maximum daily disposal volume?

$1\text{m}^3 = 220 \text{ gallons}$

<div></div> cubic metres a day	before dilution
<div>2</div> cubic metres a day	after dilution

9.4 How will you dispose of this substance?

Give a clear description of how the material is taken to the disposal site and how disposal is carried out. State the equipment used e.g. sprayer, soil injection, vacuum tanker. Mark any permanent pipes or other structures on the plan requested in section 10 Checklist, site maps and plans.

VACUUM TANKER.

10 Checklist

Site maps and plans

- ☒ a map showing the location of the site. Mark all disposal areas on the map.

The purpose of this map is to show the site in relation to the surrounding countryside and to allow it to be found. A scale of 1:25,000 or 1:10,000 is recommended, but it is more important to use a scale that will help the Agency to assess your application.

Disposal area plans

Please provide as much information as you can on the disposal area plans.

- ☐ An accurate plan of each disposal area (or point) which can be related to the site map which you are enclosing. Each plan should show:
- ☐ the area of each field used for each disposal, with an indication of how each is used (e.g. in rotation, at different times of the year).
- ☐ all watercourses within 200 metres of each disposal area, including those which dry out at times of the year. For surface watercourses, culverted watercourses, ditches, canals, lakes, ponds or swallow holes
- ☐ boreholes, wells, springs or catchpits within 500 metres of any part of a disposal area.

If any of these are used by neighbours give their names and addresses.

Mark all features that you know of on the plan. Then talk to any neighbours with land within 500 metres of the disposal area to find out if they have any groundwater uses. Record details at Question 6.2.

- ☐ any areas that are under-drained or mole drained, including drainage direction. Mark the discharge points of the drainage system on the plan. If you have estimated them, please say so on the plan.

Other information

- ☐ Other information about the material for disposal or the site that may be relevant. List other information which you have attached here:

MAP SN 5630 - 5730

MAP SN 5629 - 5729

FIELD NO. ~~24~~
3497 - 1.48 ha.

11 Declaration

If you fail without reasonable excuse to provide information requested in writing by the Agency you are

- committing an offence under Section 71 of the Environmental Protection Act 1990
- liable to a fine or imprisonment (or both).

For applications from more than one person all applicants should sign. For applications from a company or other corporate body an authorised person should sign.

I/we certify that the information in this application is correct.

I/we hereby apply under the Groundwater Regulations 1998 (under Regulation 23, Transitional Provisions) for authorisation to dispose of substances, as described in this application and its attachments.

I enclose the required application fee, payable to the Environment Agency.

I enclose 3 copies of the plan(s) and location maps with all relevant information clearly marked.

I confirm that I/we will provide additional information as requested by the Environment Agency where this is essential for the determination of the application.

I confirm that I/we will pay required advertising costs should advertising be necessary (following notification by the Environment Agency).

I confirm that I/we will notify the Environment Agency of any changes in the information in this application which might be material to the continuation of the authorisation.

Signature

Name **E.E.J. HUMPHREYS**

Position **Owner**

Date **24-3-99**

Are you

- ☒ the applicant
- ☐ their agent

12 What happens next

Please check that you have filled in all the relevant parts of the form, then send it back to us.

If we need any more information about your application, we will get in touch by phone or letter

Once we have processed your application, we will send you a letter, either authorising or refusing the application. This will set out the conditions we expect you to keep to when you make a disposal at the site.

If you are not happy with any of the conditions attached to your authorisation, you can appeal to the Secretary of State.

If there are any changes to the information you gave on your application, you must let us know straight away. You can phone us on 0645 333 111.

Now please send this form back to the nearest Regional office, using the list of addresses on the back cover of this form.

MANAGEMENT AND CONTACTS:

The Environment Agency delivers a service to its customers, with the emphasis on authority and accountability at the most local level possible. It aims to be cost-effective and efficient and to offer the best service and value for money.

Head Office is responsible for overall policy and relationships with national bodies including Government.

Rio House, Waterside Drive, Aztec West, Almondsbury, Bristol BS32 4UD

Tel: 01454 624 400 Fax: 01454 624 409

Internet World Wide Web www.environment-agency.gov.uk

ENVIRONMENT AGENCY REGIONAL OFFICES

ANGLIAN

Kingfisher House
Goldhay Way
Orton Goldhay
Peterborough PE2 5ZR
Tel: 01733 371 811
Fax: 01733 231 840

SOUTHERN

Guildbourne House
Chatsworth Road
Worthing
West Sussex BN11 1LD
Tel: 01903 832 000
Fax: 01903 821 832

MIDLANDS

Sapphire East
550 Streetsbrook Road
Solihull B91 1QT
Tel: 0121 711 2324
Fax: 0121 711 5824

SOUTH WEST

Manley House
Kestrel Way
Exeter EX2 7LQ
Tel: 01392 444 000
Fax: 01392 444 238

NORTH EAST

Rivers House
21 Park Square South
Leeds LS1 2QG
Tel: 0113 244 0191
Fax: 0113 246 1889

THAMES

Kings Meadow House
Kings Meadow Road
Reading RG1 8DQ
Tel: 0118 953 5000
Fax: 0118 950 0388

NORTH WEST

Richard Fairclough House
Knutsford Road
Warrington WA4 1HG
Tel: 01925 653 999
Fax: 01925 415 961

WELSH

Rivers House/Plas-yr-Afon
St Mellons Business Park
St Mellons
Cardiff CF3 0LT
Tel: 01222 770 088
Fax: 01222 798 555

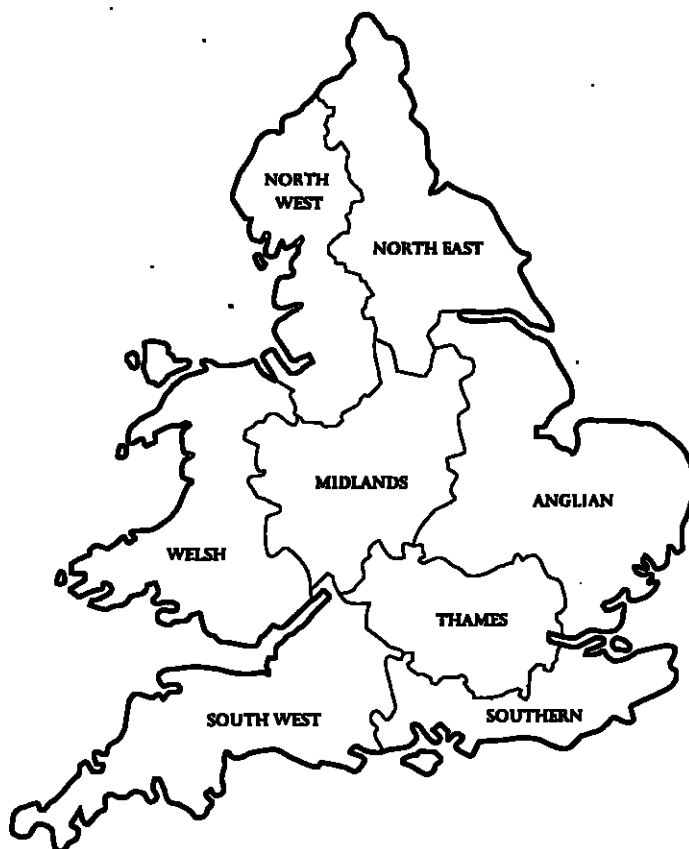

For general enquiries please call your local Environment Agency office. If you are unsure who to contact, or which is your local office, please call our general enquiry line.

ENVIRONMENT AGENCY GENERAL ENQUIRY LINE

0645 333111

The 24-hour emergency hotline number for reporting all environmental incidents relating to air, land and water.

ENVIRONMENT AGENCY EMERGENCY HOTLINE

0800 80 70 60



**ENVIRONMENT
AGENCY**

Our ref: APP/WLS/1616

Your ref:

Date 30/06/1999

**Mr. E. HUMPHREYS
E.E.J. HUMPHREYS
CRACHTY-UCHAF
LLANFYNYDD
CARMS
SA32 7DD**

Dear Mr. HUMPHREYS,

GROUNDWATER REGULATIONS 1998

I acknowledge receipt of your application for an authorisation under these regulations, together with your application fee of £84. The Agency will in due course assess and then positively determine your application. In the meantime, your application is deemed to have been authorised from 1st April 1999 and annual subsistence charges will apply from this time, currently £107 a year. You may therefore, unless otherwise advised by the Agency, continue your existing activity, providing it is substantially the same as detailed in your application.

Will you please note that before the Agency can positively determine the application, the regulations require that a specific "prior investigation" is undertaken. Questions to deal with this requirement were included in the application forms, but do not appear to have been fully completed. We will attempt to derive this information ourselves, but if this is not possible, we will need to request further information and will write to you accordingly. You do not need to take further action at this stage. This letter should be retained as proof of your deemed authorisation and if a contractor carries out the disposal operation, he will need to see this letter.

In the meantime if you have any questions, do not hesitate to contact me Chris Rowlands or this office quoting reference number shown above.

Yours sincerely

Mr. C. Rowlands

OK C/L

Disposal Area marked with red pen.

at Maesifan, Llanyfynydd.

SN 5630-5730.

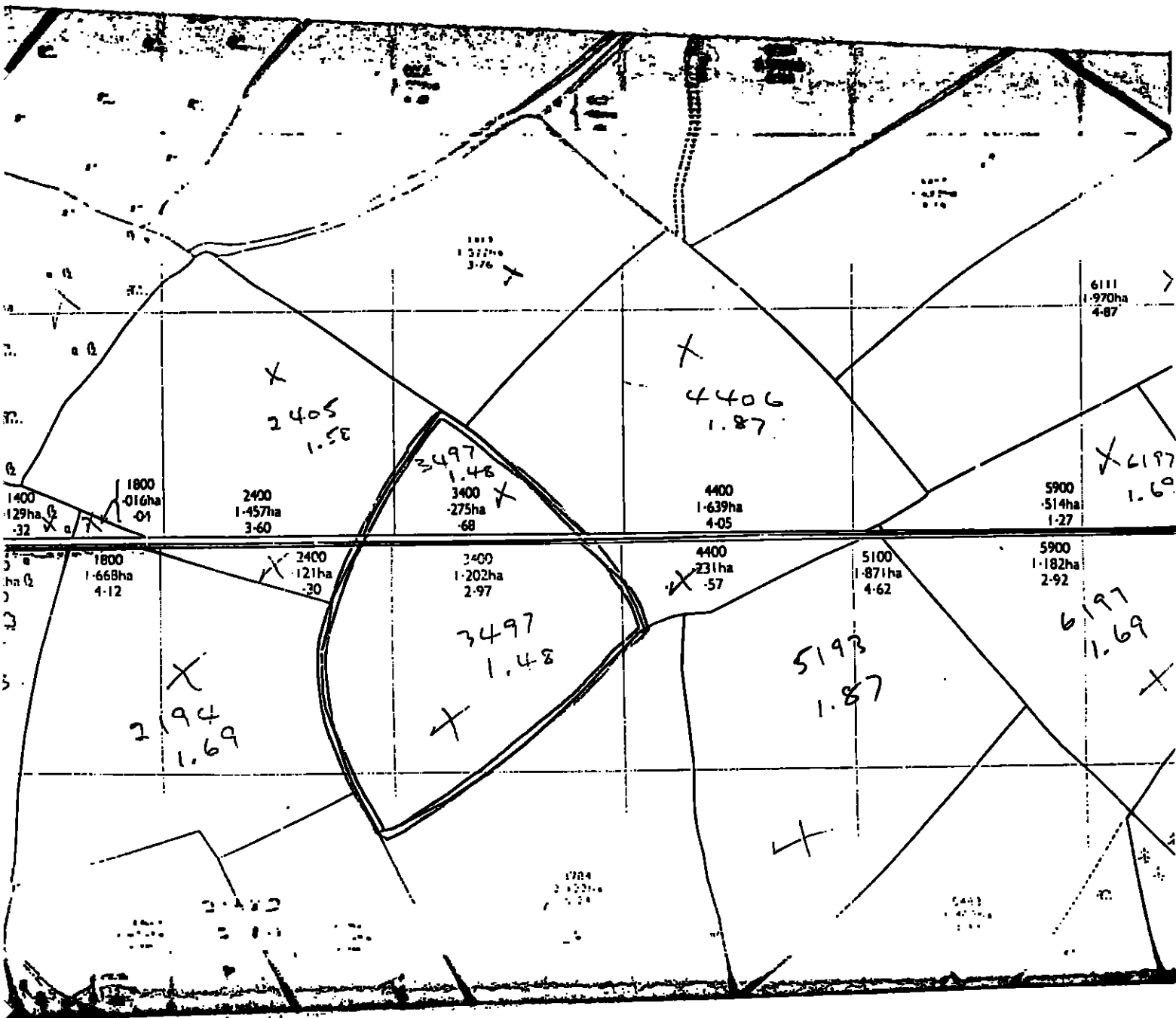

SN 5629-5729.

Disposal Area marked with red pen.

At Maesifan, Manfynydd.

SN 5630-5730.

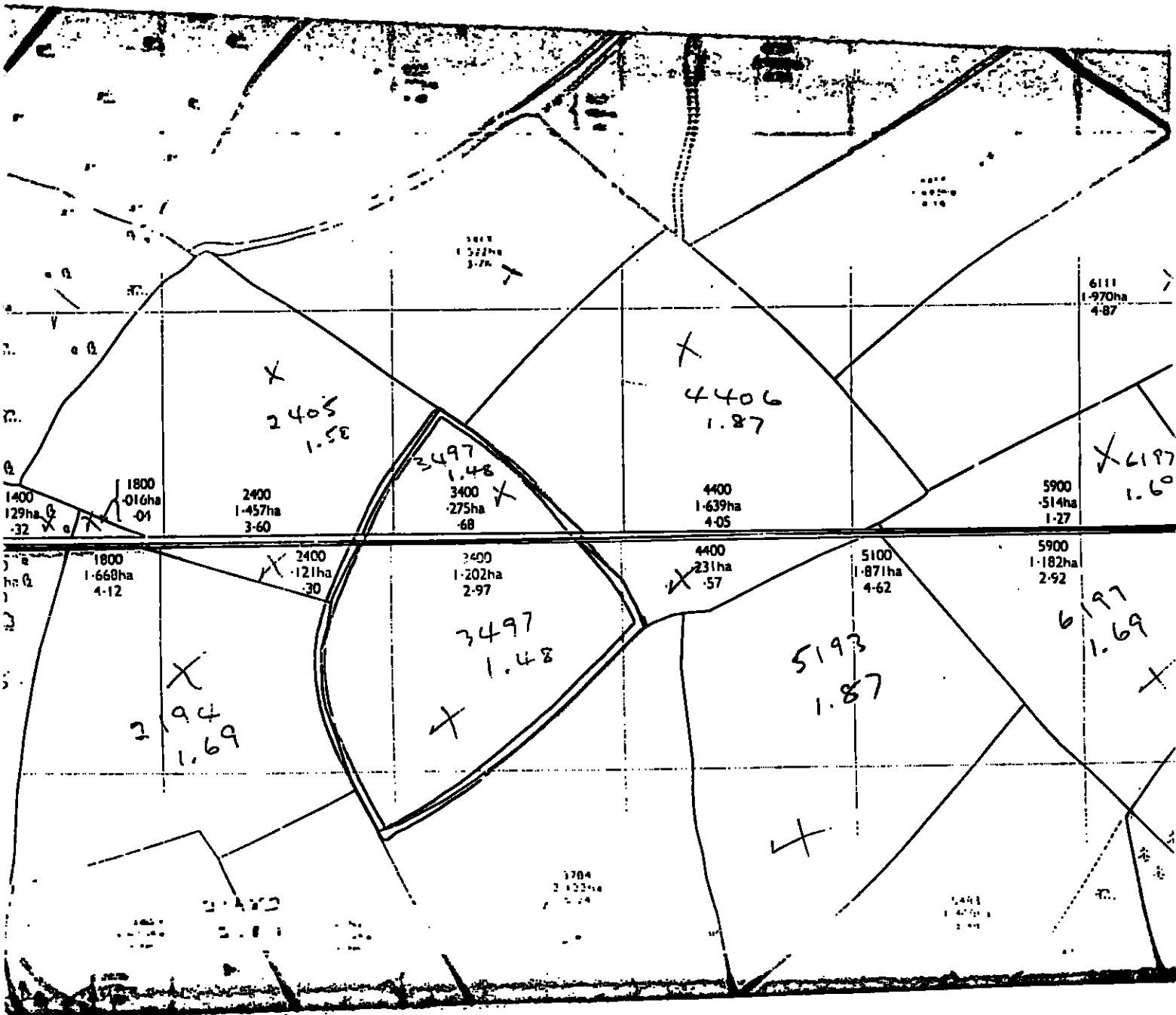

SN 5629-5729.

Disposal Area marked with red pen .

at Macisfan, Banfyngad

SN 5630-5730,

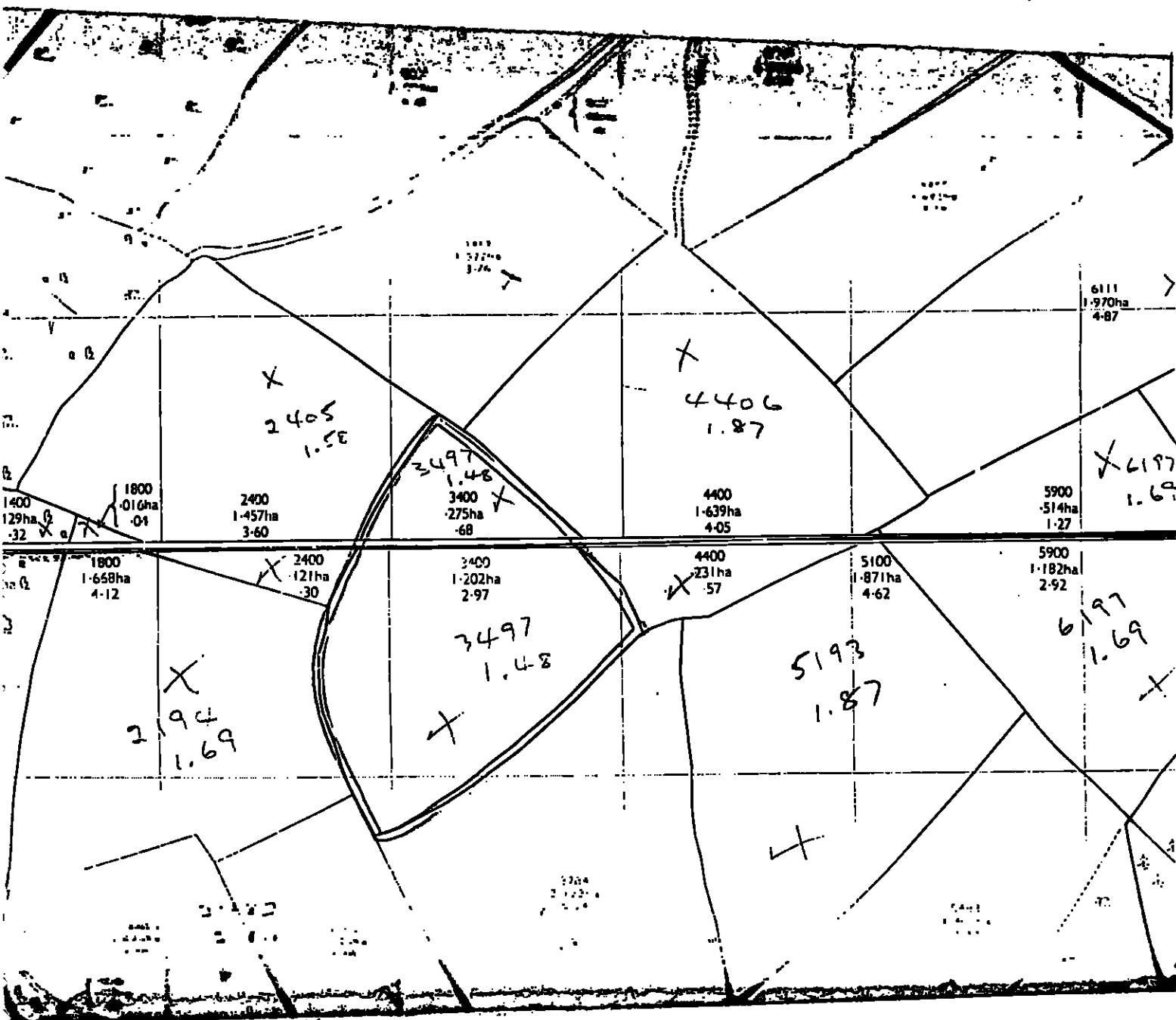

SN 5629-5729,

Summary scoring spreadsheet - land spreading of sheep dip
(see notes below - to be used in conjunction with the procedures outlined in TGN5)

Site : Maesifan, Llanfynydd, Carmarthenshire

Assessment Ref:

gws1616

Scoring Factor	Relevant questions/answers	Key parameters	Parameter value	Factor Score
Hydraulic loading	7.2 9.3	disposal area (hectares) = maximum daily disposal (m3/d, after dilution) = calculated hydraulic loading (m3/ha)	1.48 2 1.351351351	0
Chemical loading	8.2, 8.3, 9.2	source material score (TGN5, table 1) = number of applications =	6 2	12
Soil type	7.1, 7.3-7.6	soil type: shallow (s), high (h), intermediate (in) or low (l) =	h	15
Unsaturated Zone	6.1-6.3 (+Agency records)	substantial (>5m) non-aquifer cover: yes(y), no(n) = worst reasonable or assumed zone thickness (m) =	n 10	10
Aquifer	7.1, 7.8, site/disposal plans/maps	aquifer type: karst (k), major (ma), minor (ml) or non (n) =	mi	5
Land Use	7.1	land use type: bare (b), vegetated (v) or pasture (p) =	p	0
Chemical Properties	5.1	sheep dip type: SP, OP or Bloom (B) =	sp	15
Proximity	6.1-6.3, 7.1, site/disposal plans/maps	distance to nearest surface water receptor (m) = distance to nearest groundwater receptor (m) = groundwater protection zonation: 1, 2 or non (n) =	220 501 n	0 0
TOTAL APPLICATION SCORE :				57
INITIAL ASSESSMENT :				FURTHER CONSIDERATION AND/OR INVESTIGATION REQUIRED

NOTES

- 1) One form should be used for each distinct combination of disposal area and substance, with a unique reference code (e.g. A1S2) entered into the box in the top right hand corner of the form.
- 2) The technical assessor should enter the necessary values in all the highlighted cells, seeking advice from TGN5 and its annex as appropriate.

Technical Trail

Site Name: Crachty-Uchaf, Llanfynydd

Ref: GWSW 1616

Description of Activi Disposal of sheep dip SP -spread to land

Assumptions:

A small fraction of the disposal area is wooded. No disposal can take place in this area.

Un saturated zone thickness assumed over 5m using rule of thumb.

Disposal area approx 30m from surface water, but a wooded area inbetween may act as a buffer.

CONSULTEES

Internal: Conservation (OPM 14 Days) NAC

Regional Hydrogeology (OPM 21 days) Return by:

External:

Advertising require Y

Specific notes on authorisation conditions

All standard conditions apply etc.

Operational Issues (review visits etc)

Determining officer Mathew Griffiths

Date Nov 2nd 1999.

**GROUNDWATER AUTHORIZATION
DISCHARGE CONSENT PROGRESS FORM**

Application / Consent Number	GWSW 1616	Is Consent Under Appeal?	YES <input checked="" type="radio"/> NO
---------------------------------	-----------	--------------------------	---

		DATE	INITIALS
Application for New Consent Received		30 th March 1999	M. G.
Result of Lapsed Consent?	No. _____	_____	_____
Variation initiated by Discharger Received		_____	_____
Further Info Required? Schedule 10 notice to be sent	YES / NO (if Y, see advert form)	_____	_____
Modification initiated by Environment Agency		_____	_____
Revocation (result of Authorisation? Yes/No)		_____	_____
Determination Period start date (only if S. 10 not to be sent)		_____	_____
Statutory Consultees Notified (Give Date):	Sea Fish _____ CEFAS _____ Welsh Office _____ Harbour Auth. _____		
Passed to Area Consents Team			

Agent's Address (*)

N/A	* If an Agent's name is supplied it will be assumed that they are acting fully on behalf of the applicant and all correspondence will be addressed to them
-----	--

Area Consents Team

Received by Area Consents Team		30/6/99	M. G.
Further Info. Req'd?	YES/NO (see advert form for any unidentified information)		
CCOW advised on advertising / consultation		_____	_____
Schedule 10 Notice sent (confirmed by CCOW)		_____	_____
Schedule 10 Info Rec'd Enter new Relevant date or confirm		_____	_____
Confirmation by CCOW of placing of advert		_____	_____
SSSI Affected	Yes/No	EN/CCW and/or NP Contacted	
Basic Details Conveyed to EPM		_____	_____
Internal Consultee date responses rec'd	WR <input checked="" type="checkbox"/> EAT <input checked="" type="checkbox"/> FD <input checked="" type="checkbox"/> CRN <input checked="" type="checkbox"/> FM <input checked="" type="checkbox"/> E Prot <input checked="" type="checkbox"/> Other <input checked="" type="checkbox"/>		
External Consultee date responses rec'd	Sea Fish <input checked="" type="checkbox"/> CEFAS <input checked="" type="checkbox"/> WO <input checked="" type="checkbox"/> H. Auth. <input checked="" type="checkbox"/> CCW/EN <input checked="" type="checkbox"/> NP <input checked="" type="checkbox"/> Other <input checked="" type="checkbox"/>		
Determination to be extended?	YES <input checked="" type="radio"/> NO	Date extended to:	_____
REASON FOR EXTENSION:			

Please enter Environment Protection Team Code WEP 3

Location of discharge	England		Wales	<input checked="" type="checkbox"/>
Sample Point Amendment Required	Yes/No			
No of Samples / Inspections required by policy	<u> </u>			
No of Samples / Inspections planned to be taken	<u> </u>			
Discharge from a septic tank	<u>Yes/No</u>			
UOS & Cost Benefit Forms completed	<u> </u>			
Dangerous Substance present in Discharge	<u>Yes/No</u>			
Charging Bands: Volume <u> </u> Content <u> </u> Rec. Water <u> </u>	<u>107.33 p/unn</u>		<u>ML</u>	
Effective Credit Date <u>Start</u> <u>of</u> <u>R.W.A</u>				

QA / Referral under NFSoD

QA Process initiated (either in HO Wales or in Area)	<u> </u>	
Please give Reasons:		
File, draft, UOS & Cost Benefit Forms sent to HO Wales	<u> </u>	
Response to QA received by Area Consents Team		
Consent referred to HOW Consents under NFSoD		
NFSoD Consultation complete - NFSoD1 received by Area		

Environment Planning Manager

Consent signed by EPIM or officer specified under NFSoD		
---	--	--

Area Customer Contact Team

Signed Consent Received by ACCT		
Consent posted (NB. 1st class on date consent signed)		
Copy of Consent placed on Public Register		
PCF & copy of consent sent to CCOW		

Head Office Wales Consents

Received		
Logged on <u> </u> (New Access Database)		
If tidal, copied to Statutory Consultees		
If advertised, Representatives advised of determination		
Consent input to DISCHARGE Database / WIMS		
Consent checked on DISCHARGE Database / WIMS		
Input to CFD Database Date <u> </u> Checked on CPR Date <u> </u>		
CFD Preview Date		Preview Number

Groundwater Authorisation

Name(s) of Applicant(s)		Rate ID	
E. E. J. Hughes.		1616	
Address of Applicant		Date Received	Date Issued
Crachty - uclaf Llanfynydd Carmarthenshire SA32 7DP. 01558 668810		30/3/99	1/4/99
Substance(s)		Maximum Discharge per Day	
		S.P. 2m ³ .	
Billing Address (if different)		Discharge Site	
as above.		field n° 3400	
Grid Reference		Priority	
		SN 56 - 29.	
Actions		Tick as appropriate	
<input checked="" type="checkbox"/> Cheque Received <input type="checkbox"/> Map Received <input type="checkbox"/> Missing Information		<input type="checkbox"/> High <input type="checkbox"/> Medium <input type="checkbox"/> Low	
Comments		Other Information	
Score			

16/6

Form 1 : Key response checklist for sheep dip applications (transitional provisions)

Question number	Why response required	Is response provided? Y/N
2.1	Contact for further information	✓
4.3	Nature conservation assessment and consultation	✓
5.1 (repeated at 8.1)	Inclusion on authorisation Chemical Properties Scoring	✓
7.1 (one per disposal area)	Inclusion on authorisation Soil Type Scoring Aquifer Scoring Proximity Scoring	✓
7.2 (one per disposal area)	Hydraulic Loading Scoring	✓
7.3 (one per disposal area)	Soil Type Scoring	✓
7.4 (one per disposal area)	Soil Type Scoring	✓
7.5 (one per disposal area)	Soil Type Scoring	✓
7.6 (one per disposal area)	Soil Type Scoring	✓
7.9	Topography assessment (flowchart)	✓
7.10	Land Use Scoring	✓
8.2 (one per substance)	Chemical Loading Scoring	✓
8.3 (one per substance)	Chemical Loading Scoring	✓
9.2	Chemical Loading Scoring	✓
9.3	Hydraulic Loading Scoring	✓
10 (site map)	Inclusion on authorisation Aquifer Scoring Topography assessment Proximity Scoring	✓
10 (disposal area plans, one per disposal area)	Inclusion on authorisation Aquifer Scoring Topography Scoring Proximity Scoring	✓

Note: Responses are obligatory for the shaded questions. For all the other listed questions a response the applicant is not absolutely essential, though the Environment Agency may be forced to make conservative assumptions that might result in the application being refused or upgraded to a higher level assessment.