

LEGEND

DENOTES CELSA SITE OWNERSHIP
AREA = 150,669m² (15.07ha)

AREA OF WORKS

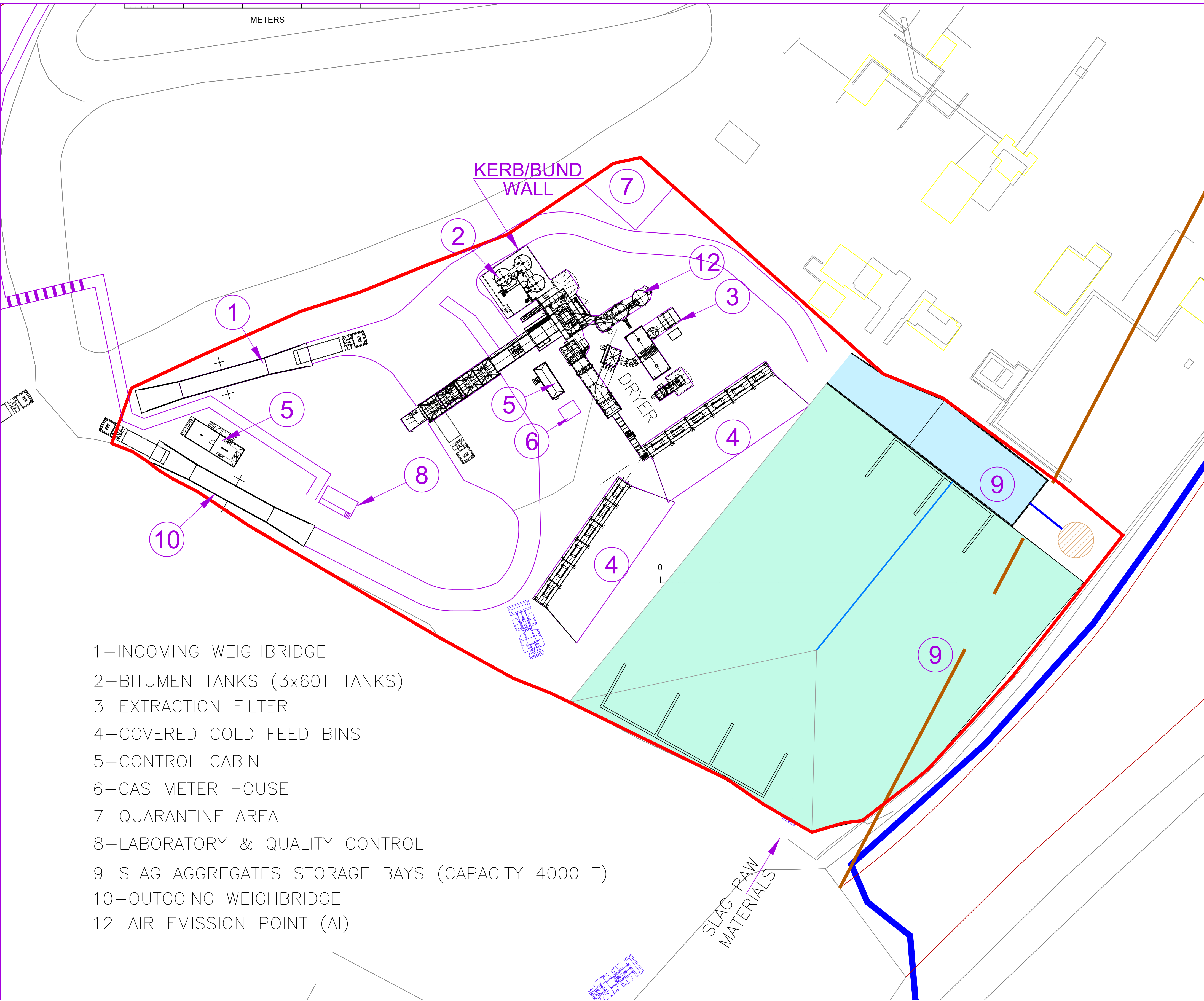
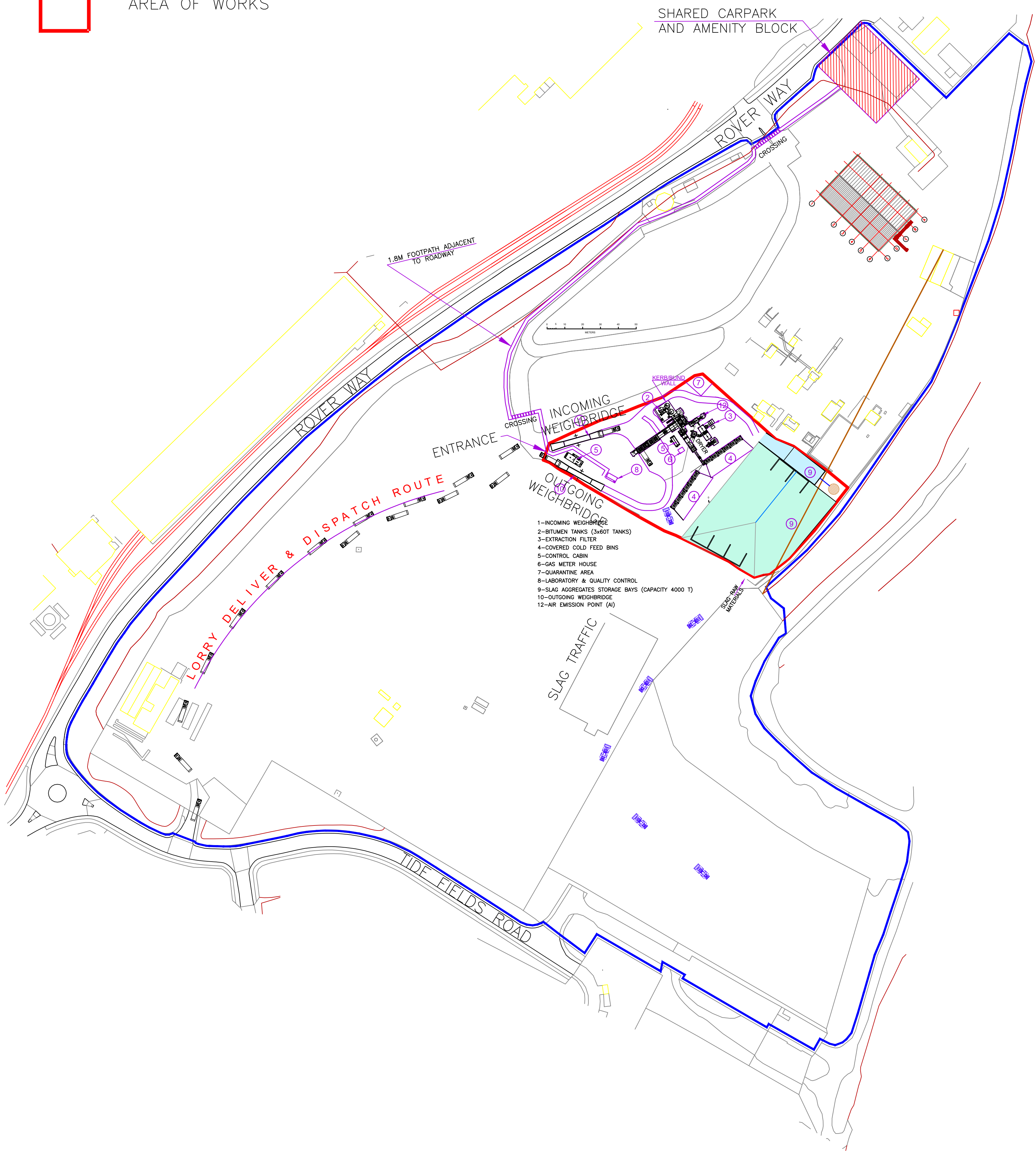

- 1—INCOMING WEIGHBRIDGE
- 2—BITUMEN TANKS (3x60T TANKS)
- 3—EXTRACTION FILTER
- 4—COVERED COLD FEED BINS
- 5—CONTROL CABIN
- 6—GAS METER HOUSE
- 7—QUARANTINE AREA
- 8—LABORATORY & QUALITY CONTROL
- 9—SLAG AGGREGATES STORAGE BAYS (CAPACITY 4000 T)
- 10—OUTGOING WEIGHBRIDGE
- 12—AIR EMISSION POINT (AI)

ASPHALT PLANT AREA
(CIRCA 10,022 M²)
SCALE 1:500 ON A0

NOTES

- 1. Do not scale from this drawing
- 2. Dimensions are for reference only
- 3. Plants' components and their locations are preliminary and may change during design stage
- 4. This drawing is prepared, in part, based on information provided by others. While this information is believed to be reliable, HarSCO Metals assume no responsibility for inaccuracies, errors or omissions that might have been incorporated into this drawing as a result of incorrect information provided to us
- 5. This drawing is for planning purposes only. Not to be used for construction

1	STREET NAMES ADDED		01/10/2018	AI	
0	RELEASED FOR DISCUSSION		26.09.2018	AI	
RevNo	Revision note		Date	Signature	Checked
OWNER:			<div>HARSCO</div> METALS&MINERALS ENGINEERING DEPT. HARSCO HOUSE, Bradmarsh Business Park, The Point, Bradmarsh Way Rotherham, S60 1BW, UK. TELEPHONE +44(0)1709 536850, FAX +44(0)1709 536805		
VENDOR/CONSULTANT:					
PROJECT: ASPHALT PRODUCTION AT CELSA CARDIFF					
PROJECT No. : O1994			TITLE:- NEW ASPHALT PLANT AT CELSA CARDIFF. LOCATION PLAN OPTION 7.5		SCALE 1:1250
ENGR	AI	25.09.18			
DRAWN	AI	26.09.18			
CHKD					
APPD					
DRG. NO. O1994-00-01-07.05			SIZE REV		A0 0
RELEASED FOR					
<input checked="" type="checkbox"/> PRELIMINARY <input type="checkbox"/> INFORMATION <input type="checkbox"/> APPROVAL <input type="checkbox"/> FABRICATION <input type="checkbox"/> CONSTRUCTION					