

M:\RCA Job Files\217 Job\21758 - Llyncam, Llanfihangel Bryn Pabuan, Builth Wells, Powys LD2 3SE\F - RCA Civil Drawings\21758.dwg 19/07/2023 12:07:52

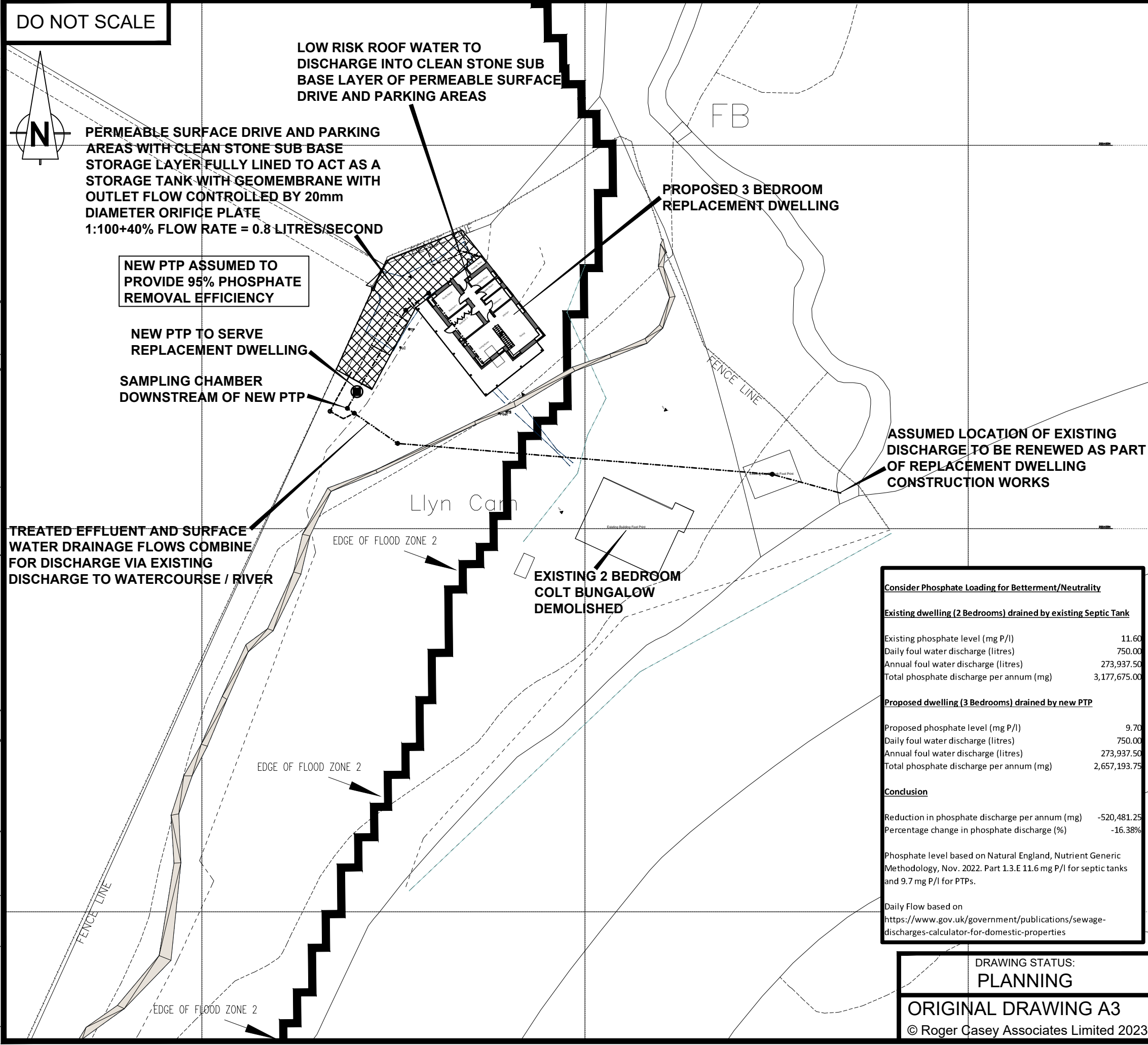

NOTES:

THE PROPERTY OF THIS DRAWING AND DESIGN IS VESTED IN ROGER CASEY ASSOCIATES AND MUST NOT BE COPIED OR REPRODUCED IN ANY WAY WITHOUT THE WRITTEN CONSENT OF ROGER CASEY ASSOCIATES.

THE CONTRACTOR IS TO CHECK ALL LEVELS AND DIMENSIONS BEFORE WORK COMMENCES, AND ANY DISCREPANCIES TO BE REPORTED IMMEDIATELY TO THE CONSULTANTS.

WORK TO FIGURED DIMENSIONS IN PREFERENCE TO SCALING.

THIS DRAWING IS TO BE READ IN CONJUNCTION WITH ALL OTHER ROGER CASEY ASSOCIATES DRAWINGS AND SPECIFICATIONS AND ALL OTHER CONSULTANTS DRAWINGS AND SPECIFICATIONS RELATING TO THIS PROJECT.

REV.	DESCRIPTION	DRAWN	CHECK	DATE

Ty Mansel, 6 Mansel Street,
Carmarthen,
Carmarthenshire SA31 1PX

T: 01267 222 646

Units 10 & 11, Merlin's Court,
Winch Lane, Haverfordwest,
Pembrokeshire SA61 1SB

T: 01437 762 795

E: office@rca-eng.co.uk

W: www.rca-eng.co.uk

Roger Casey Associates

Consulting Civil & Structural Engineers

CLIENT:

WYESIDE CONSULTING

ARCHITECTURAL CONSULTANT:

GREG WOTTON

PROJECT:

REPLACEMENT DWELLING AT
Llyncam, Llanfihangel Bryn Pabuan,
BUILTH WELLS, POWYS LD2 3SE

DRAWING TITLE:

PROPOSED FW & SW DRAINAGE
SITE PLAN

DRAWN BY:	DESIGN BY:	CHECKED BY:	DATE:
PWJL	PWJL	RSC	19/07/23
SCALES:	DRAWING No.:	REVISION:	
1:500	21758/SK2	-	

DRAWING STATUS:

PLANNING

ORIGINAL DRAWING A3

© Roger Casey Associates Limited 2023