

DO NOT SCALE (A1)

NOTES

FOUNDATION NOTES

- ALL CONCRETE (inc. BLINDING AND MASS FILL) TO BE GRADE C28/35 USING 20mm AGGREGATE.
Min. CEMENT CONTENT = 340 kg/m³
Max. WATER/CEMENT RATIO = 0.5
CEMENT TYPE = CEM 1
MIX CLASS = CLASS DC-2
- CONCRETE COVER TO REINFORCEMENT TO BE 50mm (SEE NOTE 3).
- WHERE FOUNDATIONS ARE CAST DIRECTLY AGAINST THE SIDE OF AN EXCAVATION, COVER TO REINFORCEMENT TO BE INCREASED TO 75mm.
- ALL BOLT TUBES TO BE REMOVED AFTER THE INITIAL SET OF CONCRETE. BOLTS ARE TO BE FREE TO MOVE 75mm AT TOP OF NUTS. THREADS TO HAVE ADEQUATE PROTECTION AND BE FREE RUNNING.
- BOLT BOXES/STEELWORK BASE PLATES TO BE GROUTED UP ON COMPLETION OF LINE AND LEVELLING USING NON SHRINK GROUT.
- ALL STRUCTURAL STEELWORK TO BE PROVIDED WITH A Min. 100mm CONCRETE SURROUND OR 100 MASONRY PLUS 50mm CONCRETE CASING BELOW GROUND LEVEL TO SUIT ARCHITECTS DETAILS.
- BLOCKS BELOW GROUND TO BE 10.5 N/mm² (SOLID) AND BE CLASSED AS SUITABLE FOR USE BELOW GROUND, AND BE RESISTANT TO CLASS 2 CONDITIONS. NO BLOCK IS TO EXCEED A WEIGHT OF 20kg. REFER TO RELEVANT HSE DOCUMENTATION FOR GUIDANCE.
- MORTAR TO BLOCKS BELOW GROUND TO BE 1:3 (CEM 1 : SAND).
- FOUNDATION BEARINGS**
ALL FOUNDATION BEARINGS SHALL BE SMOOTH AND LEVEL, FREE FROM IRREGULARITY (i.e BUCKET MARKS), WHERE PRACTICAL FOUNDATION BEARINGS SHALL BE FINISHED OFF BY HAND, OR OTHERWISE BY SMOOTH BUCKET.
- FOUNDATION TOP SURFACE**
TOPS OF ALL FOUNDATIONS ARE TO BE TROWELLED LEVEL, AND SPRAY CURED WITH 'SIKA PROSEAL W' CURING AGENT TO BE APPLIED IN ACCORDANCE WITH MANUFACTURERS RECOMMENDATIONS.
- FOUNDATION CONSTRUCTION JOINTS**
ALL CONSTRUCTION JOINTS (STOP ENDS) SHALL BE SCABBLED BACK TO CLEAN FACE FREE OF SURFACE LATENCE AND SHALL BE WETTED IMMEDIATELY PRIOR TO PLACING CONCRETE.

NOTE:
SETTING OUT, DIMENSIONS AND LEVELS TO BE CONFIRMED BY THE ARCHITECTS.

NOTE:
ALL FOUNDATION SIZES SUBJECT TO FINAL LOADS TBC BY THE STEELWORK SUB-CONTRACTOR.

NOTE:
ALL FOUNDATIONS TO BE CENTRAL TO COLUMN LOCATION U.N.O. FOR SETTING OUT OF COLUMNS REFER TO JPG DRAWING No. S-2301.

FOUNDATION TOF LEGEND:

	TOP OF FOUNDATION = F.F.L. - 450mm
	TOP OF FOUNDATION = F.F.L. - 450mm
	TOP OF FOUNDATION = F.F.L. - 375mm
	TOP OF FOUNDATION = F.F.L. - 675mm
	TOP OF FOUNDATION = F.F.L. - 900mm
	TOP OF FOUNDATION = F.F.L. - 1325mm
	TOP OF FOUNDATION = F.F.L. - 1260mm
	TOP OF FOUNDATION = F.F.L. - 1560mm
	TOP OF FOUNDATION = F.F.L. - 1760mm
	TOP OF FOUNDATION = F.F.L. - 1860mm

ALL PAD FOOTINGS AND GROUND BEAMS TO BE -450mm FROM F.F.L. U.N.O.

SCHEDULE - PAD FOUNDATIONS

REF.	LENGTH	WIDTH	DEPTH	No.	VOLUME
A	4200	4200	1600	86	28.22 m ³
B	2000	2000	1000	85	4.00 m ³
C	3200	3200	1500	15	15.36 m ³
D	2000	2000	1600	2	6.40 m ³
E	2600	2600	1100	28	7.44 m ³
F	3500	3500	1500	8	18.38 m ³
G	900	900	500	39	0.41 m ³
H	2650	2950	300	1	2.34 m ³
J	1400	600	300	2	0.25 m ³

SCHEDULE - GROUND BEAM

REF.	H (mm)	W (mm)	REINFORCEMENT
GB 1	300	600	
GB 2	300	450	

REV	DESCRIPTION	DATE	CHK	BY
-----	-------------	------	-----	----

Project
PLOT B
THE AIRFIELDS, DEESIDE
M&J Groundwater Comments
14/3/23

Drawing Title
GENERAL ARRANGEMENT OF FOUNDATIONS TO TRANSPORT OFFICE NORTH

TENDER



www.jpg.group
E admin@jpg.group | T +44 (0)13 263 1155

4671-JPG-PB-FN-DR-S-2105 S4 P01

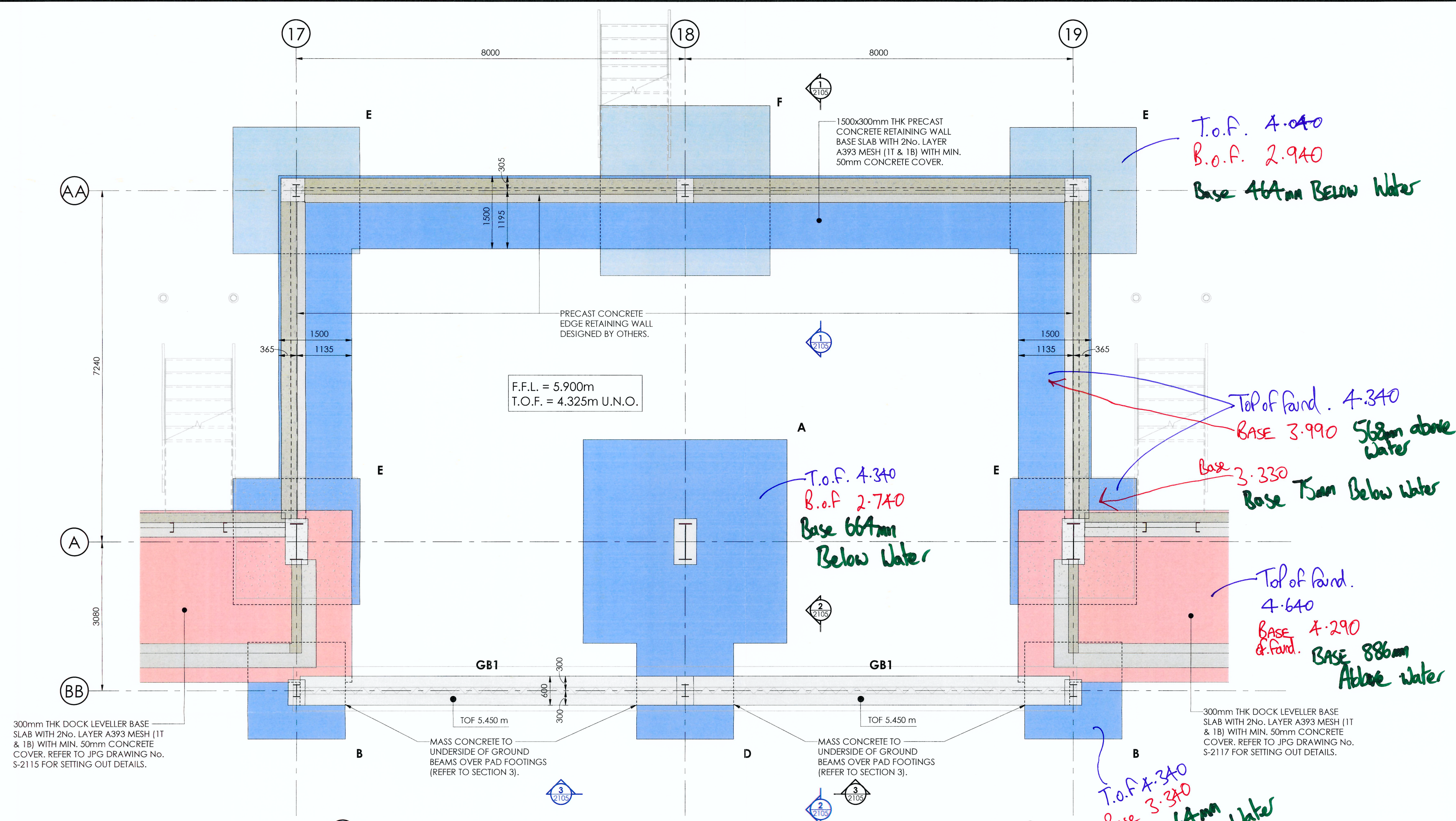

NORTH TRANSPORT AMENITY FOUNDATION LAYOUT

SCALE 1 : 50

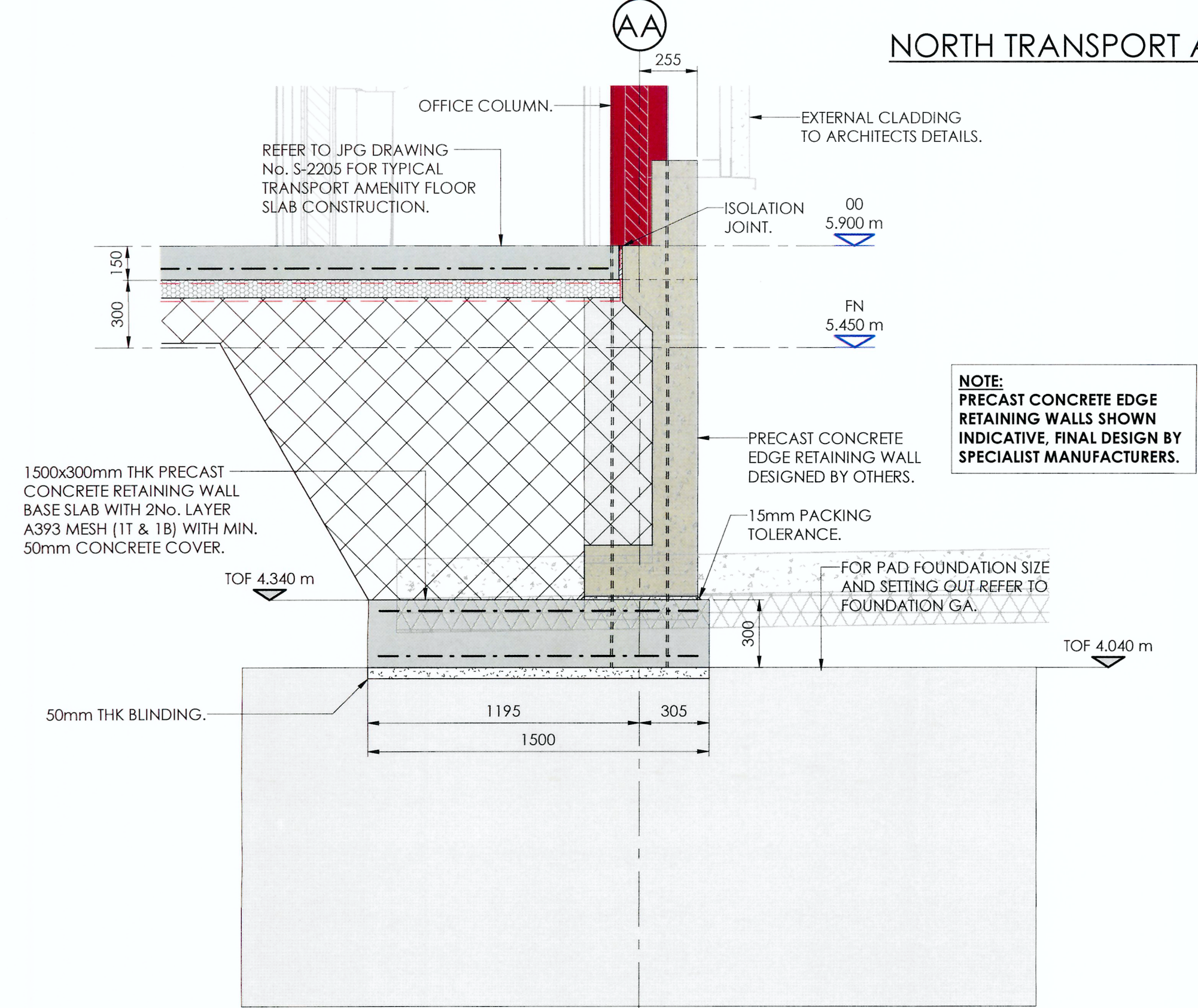

SECTION 1 - TYPICAL PERIMETER SECTION

SCALE 1 : 20

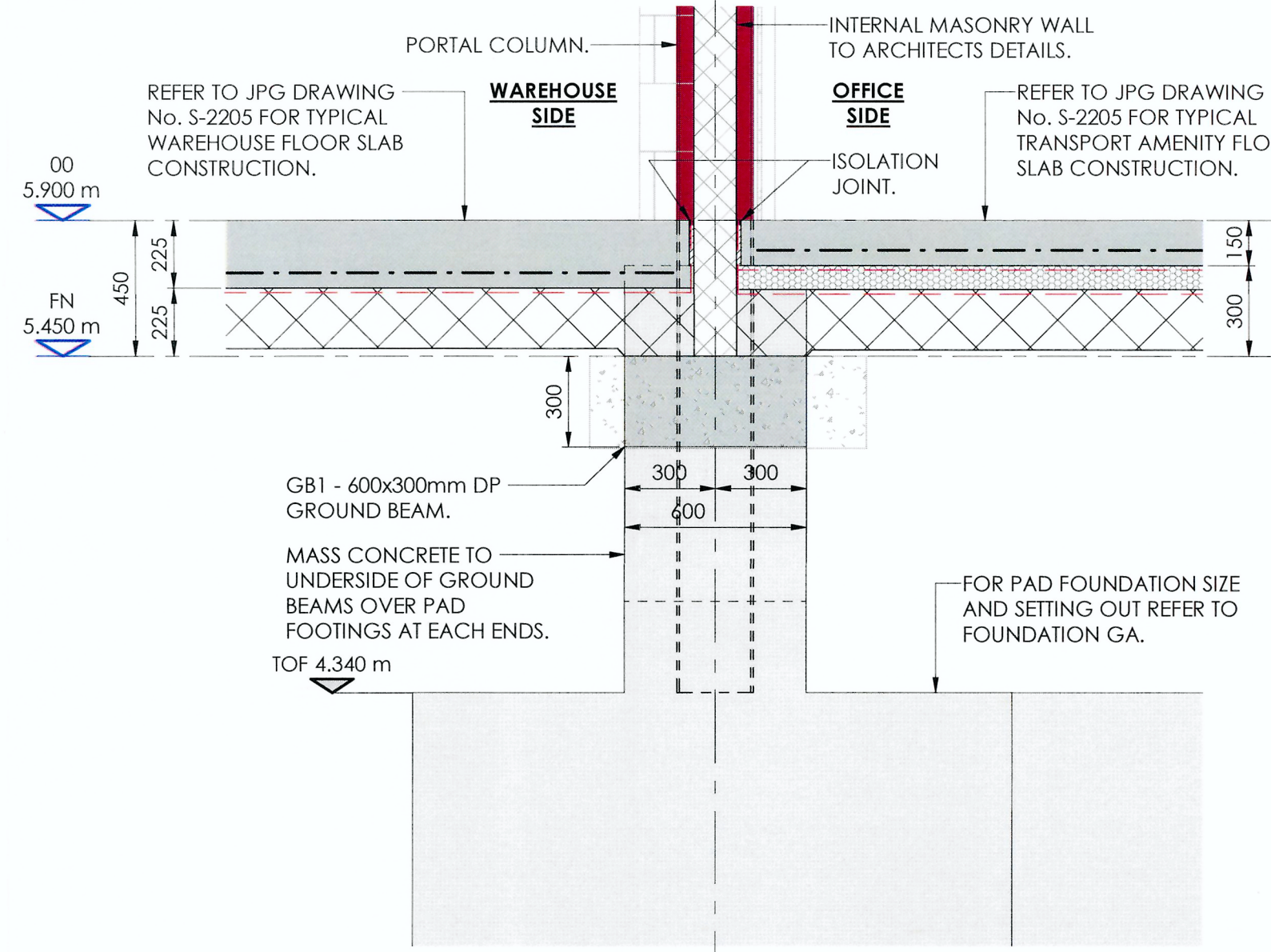

SECTION 2 - TYPICAL SECTION BETWEEN WAREHOUSE AND TRANSPORT OFFICE

SCALE 1 : 20

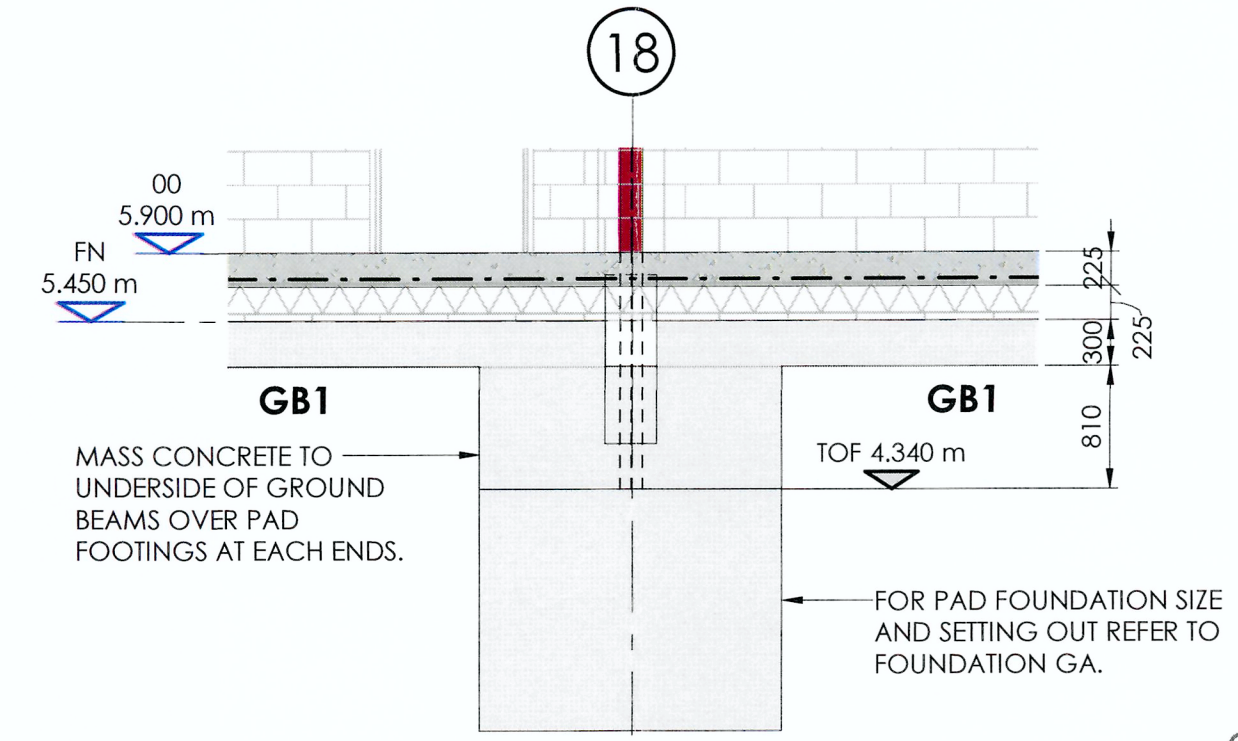

SECTION 3 - TYPICAL GROUND BEAM STEP DETAIL

SCALE 1 : 50