

GENERAL NOTES:

1. THIS DRAWING IS COPYRIGHT AND THE PROPERTY OF VEOLIA AND IS NOT TO BE COPIED IN WHOLE OR IN PART EXCEPT UNDER A WRITTEN AGREEMENT.
2. DETAILS SHOWN ON DRAWINGS ARE FOR REFERENCE PURPOSES ONLY.
3. THIS IS A CONCEPTUAL DRAWING SUBJECT TO DETAILED DESIGN BY A DESIGN & BUILD CONTRACTOR.
4. IN CASE OF ANY DISCREPANCY BETWEEN THE DRAWING AND THE WORKS INFORMATION, THE WORKS INFORMATION WILL TAKE PRECEDENCE AND THE CONTRACTOR WILL BE DEEMED TO HAVE INTENDED TO COMPLY WITH THE WORKS INFORMATION AND SHALL DO SO.
5. ALL DIMENSIONS AND LEVELS ARE TO BE CHECKED ON SITE BY THE CONTRACTOR PRIOR TO PREPARING ANY WORKING DRAWINGS OR COMMENCING ON SITE.
6. PLEASE ENSURE DRAWING LICENCE DATE IS STILL VALID. ALL LICENCES ARE 12 MONTH UNLESS OTHERWISE STATED.

SITE LOCATION PLAN

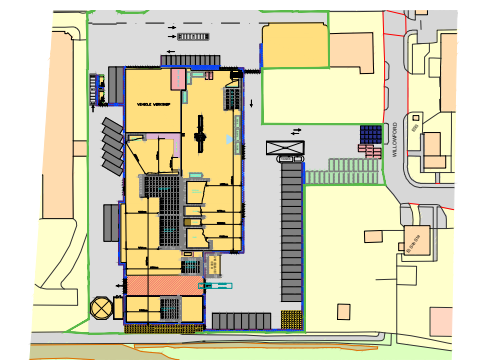

EXTENT
OF VEOLIA OPERATION

ARMCO BARRIER

PEDESTRIAN WALKWAYS

BALE STORAGE

Rev	Description of revision	Drawn	Chkd	App	Date



Technical Direction,
8th Floor, 210 Pentonville Road, London. N1 9JY
Tel: 0207 812 5185

Project **CARDIFF - TREFOREST WTS**

Title

PROPOSED WTS LAYOUT
WITH WASTE DISTANCES

	Initials	Date	Scale	Sheet size
Drawn	RB	02.05.24	1:250	A1
Checked				
Approved			© Copyright Reserved	
Job No.	TREF			

Drawing No.	Revision
VES TD TREF 200 008	A

PLANNING