

Project:
Contract Ref:

WEPA
DB3624

Boiler Output
Burner Net Heat Input:
Gas Pressure (after any booster)
Louvers in

27500 Kg/Hr
18460 KW
250 mbar
More than one wall

Lower Louvre

to be within 1m of the floor for nat. gas, 0.25m for LPG

Below 70 KW requires an area of 60 cm²
above 70 KW allow 4cm² per KW of burner input

Percentage of time Boiler is operating 1-50% 50-75% 75-100%

Free air space required m²: **7.390** **9.230** **11.080**

Upper louvre

to be within 15% of room height from ceiling

Below 70 KW requires an area of 30 cm²
above 70 KW allow 2cm² per KW of burner input

Percentage of time Boiler operating 1-50% 50-75% 75-100%

Free air space required m²: **3.695** **4.615** **5.540**

Provisional Louver Dimensions and Position*:

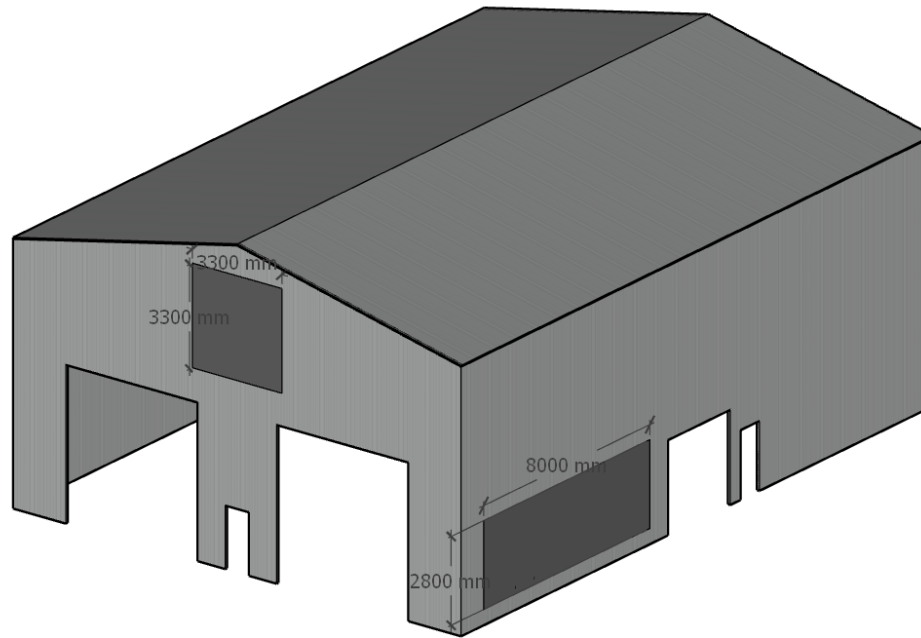

Upper Louver: 3300 x 3300mm

Lower Louver: 8000 x 2800mm

*Final design subject to change but overall area should remain.

*Assumes 50% free area of louver.