

EMISSION POINT	DESCRIPTION	TYPE	EMISSION TYPE
1	SUGAR SILO 1 EXHAUST	FABRIC FILTER	FOOD DUST
2	SUGAR SILO 2 EXHAUST	FABRIC FILTER	FOOD DUST
5	PROCESS 2 – SILO EXHAUST	FABRIC FILTER	FOOD DUST
6	4TH PROCESS – SCALES EXHAUST	FABRIC FILTER	FOOD DUST
8	PROCESS 4 – DUST EXTRACTION FROM SCRUBBER ROOM	FABRIC FILTER	FOOD DUST
10	DUST EXTRACTION FROM OLD SILO SCALES	FABRIC FILTER	FOOD DUST
11	SILOS 26, 27, 28 EXHAUST	FABRIC FILTER	FOOD DUST
12	DUST EXTRACTION FROM OLD SILOS	FABRIC FILTER	FOOD DUST
13	DUST COLLECTION LINKED TO ANIMAL FEED SYSTEM	FABRIC FILTER	FOOD DUST
14	FLAVOUR – SALT SCALE RECEIVER	FABRIC FILTER	FOOD DUST
15	FLAVOUR – SUGAR SCALE RECEIVER	FABRIC FILTER	FOOD DUST
16	PROCESS 2 – MINOR INGREDIENT SCALE	FABRIC FILTER	FOOD DUST
18	PROCESS 2 – FLOUR SILO SCALE RECEIVER	FABRIC FILTER	FOOD DUST
19	PROCESS 2 – SILO SCALE RECEIVER	FABRIC FILTER	FOOD DUST
20	PROCESS 2 – SILO SCALE RECEIVER	FABRIC FILTER	FOOD DUST
25 (A32)	FLAVOUR PLANT – MALT DUST FILTER	FABRIC FILTER	FOOD DUST
26 (A33)	FLAVOUR PLANT – CORN ALPINE MILL	FABRIC FILTER	FOOD DUST
27 (A34)	FLAVOUR PLANT – MALT KEK MILL	FABRIC FILTER	FOOD DUST
32	PROCESS 2 – PELLET DRYER	CYCLONE	FOOD DUST
35	PROCESS 2 – ANIMAL FEED DUST COLLECTION SYSTEM	CYCLONE	FOOD DUST
36	PROCESS 2 – JETZONE & FLAKING MILLS DUST EXTRACTION	CYCLONE	FOOD DUST
38	PROCESS 3 – ANIMAL FEED DUST COLLECTION SYSTEM	CYCLONE	FOOD DUST
39	PROCESS 2 – FLAKING MILL DUST EXTRACTION	CYCLONE	FOOD DUST
40	PROCESS 2 – FLAKING MILL OVERS RETURN	CYCLONE	FOOD DUST
41	PROCESS 2 – FOOD RECEIVER FROM TEMPERING BIN	CYCLONE	FOOD DUST
43	BRANFLAKES MILL EXTRACTION	CYCLONE	FOOD DUST
44	PROCESS 2 – LARGE SURGE BIN RETURN	CYCLONE	FOOD DUST
45	PROCESS 2 – LARGE SURGE BIN INFED	CYCLONE	FOOD DUST
55 (A9)	PROCESS 2 – JETZONE EXTRACTION	CYCLONE	FOOD DUST & COMBUSTION
56 (A10)	PROCESS 2 – JETZONE BLEED	CYCLONE	FOOD DUST & COMBUSTION
57 (A11)	PROCESS 3 – JETZONE EXTRACTION	CYCLONE	FOOD DUST & COMBUSTION
58 (A12)	PROCESS 3 – JETZONE BLEED	CYCLONE	FOOD DUST & COMBUSTION
59	PROCESS 4 – PACKING LINES	WET DE-DUSTER	FOOD DUST
60 (A13)	PROCESS 3 – JETZONE BLEED	CYCLONE	FOOD DUST & COMBUSTION
65	PROCESS 2/3 – FINISHED FOOD DUST COLLECTION	FABRIC FILTER	FOOD DUST
66	PROCESS 1 – TANKFLOOR DUST EXTRACTION	FABRIC FILTER	FOOD DUST
67	PROCESS 2 – COATING PLAN DUST EXTRACTION	CYCLONE	FOOD DUST
68	PROCESS 2 – DUST EXTRACTION FROM VARIOUS EQUIPMENT	FABRIC FILTER	FOOD DUST
69	PROCESS 2 – VIT ADD	FABRIC FILTER	FOOD DUST
72	PROCESS 2 – PACKING LINE	FABRIC FILTER	FOOD DUST
73 (A29)	PROCESS 1 – PACKING LINES	FABRIC FILTER	FOOD DUST
74	TAYBAG AREA	FABRIC FILTER	FOOD DUST
82	PROCESS 4 – PACKING & TANKFLOOR	FABRIC FILTER	FOOD DUST
83	PROCESS 4 – PACKING LINE 8	FABRIC FILTER	FOOD DUST
85	PROCESS 4 – PACKING & TANKFLOOR	FABRIC FILTER	FOOD DUST
86	PROCESS 4 – TANKFLOOR CONVEYOR DUST EXTRACTION	FABRIC FILTER	FOOD DUST
87	PROCESS 4 – DSU DUST COLLECTION	FABRIC FILTER	FOOD DUST
89	PROCESS 4 – ANIMAL FEED DUST COLLECTION	FABRIC FILTER	FOOD DUST
90	PROCESS 4 – ANIMAL FEED FINES DUST COLLECTION	FABRIC FILTER	FOOD DUST
91	PROCESS 4 – ANIMAL FEED DUST COLLECTION	FABRIC FILTER	FOOD DUST
92 (A14)	PROCESS 4 – COOLING FLIGHT EXHAUST	CYCLONE	FOOD DUST
93a (A15)	PROCESS 4 – JETZONE BLEED OVEN 1 ZONE 1	CYCLONE	FOOD DUST & COMBUSTION
93b (A15)	PROCESS 4 – JETZONE BLEED OVEN 1 ZONE 2	CYCLONE	FOOD DUST & COMBUSTION
94 (A16)	PROCESS 4 – JETZONE BLEED OVEN 2 ZONES 1 & 2	CYCLONE	FOOD DUST & COMBUSTION
95	PROCESS 4 – FLAKING MILLS	FABRIC FILTER	FOOD DUST
96	PROCESS 4 – PELLET STATION	CYCLONE	FOOD DUST
97	PROCESS 4 – VIT ADD	CYCLONE	FOOD DUST
98	PROCESS 4 – FINISHED FOOD REJECT RECEIVER 2	FABRIC FILTER	FOOD DUST
99	PROCESS 4 – FINISHED FOOD REJECT RECEIVER 1	CYCLONE	FOOD DUST
100	PROCESS 4 – WET SCRUBBER	WET DE-DUSTER	FOOD DUST
104	PROCESS 4 – SILO SUCTION	FABRIC FILTER	FOOD DUST
106 (A1,A2,A3)	BOILER 1, 2, 3 EMISSIONS	BOILER 1,2 & 3	COMBUSTION
107 (A4)	BOILER 4 EMISSIONS	BOILER 4	COMBUSTION
108	W1-EAST	BALANCING POND	TSS,COD,BOD
109	W1-WEST	BALANCING POND	TSS,COD,BOD
110	S1	WASTE WATER PLANT	WWTP,TSS,COD,FLOW
111 (A23)	PROCESS 4 – ROTOCLONE COATING & COOLING	WET DE-DUSTER	FOOD DUST & COMBUSTION
112	PROCESS 4 – ROTOCLONE COATING & COOLING	WET DE-DUSTER	FOOD DUST & COMBUSTION
116	CENTRALISED VACUUM SYSTEM FOR PLANT CLEANING	BAG FILTER	FOOD DUST
117	CENTRALISED VACUUM SYSTEM FOR PLANT CLEANING	BAG FILTER	FOOD DUST
118 (A24)	PROCESS 2 – AREA EXTRACTION	DRYER EXTRACT	FOOD DUST
120 (A26)	PROCESS 1 – DRY DUST COLLECTOR FROM EXTRUDERS & CONVEYORS	FABRIC FILTER	FOOD DUST
121 (A27)	PROCESS 1 – WET DUST COLLECTION SYSTEM FROM COOLING DRYERS	WET DE-DUSTER	FOOD DUST
122 (A28)	PROCESS 1 – WET DUST COLLECTION SYSTEM FROM BASE DRYER & CONVEYORS	WET DE-DUSTER	FOOD DUST & COMBUSTION
123 (A30)	PROCESS 2 – DRYER HEAT EXTRACTION	WET DE-DUSTER	FOOD DUST
124 (A31)	SEVEN SISTERS ANIMAL FEED EXTRACTION SYSTEM	FABRIC FILTER	FOOD DUST
125 (A35)	PROCESS 5 – WET DUST COLLECTION SYSTEM SERVING PROCESS & PACKING	WET DE-DUSTER	FOOD DUST & COMBUSTION
126 (A36)	PROCESS 3 – WET DUST COLLECTION SYSTEM SERVING COOKERS	WET DE-DUSTER	FOOD DUST

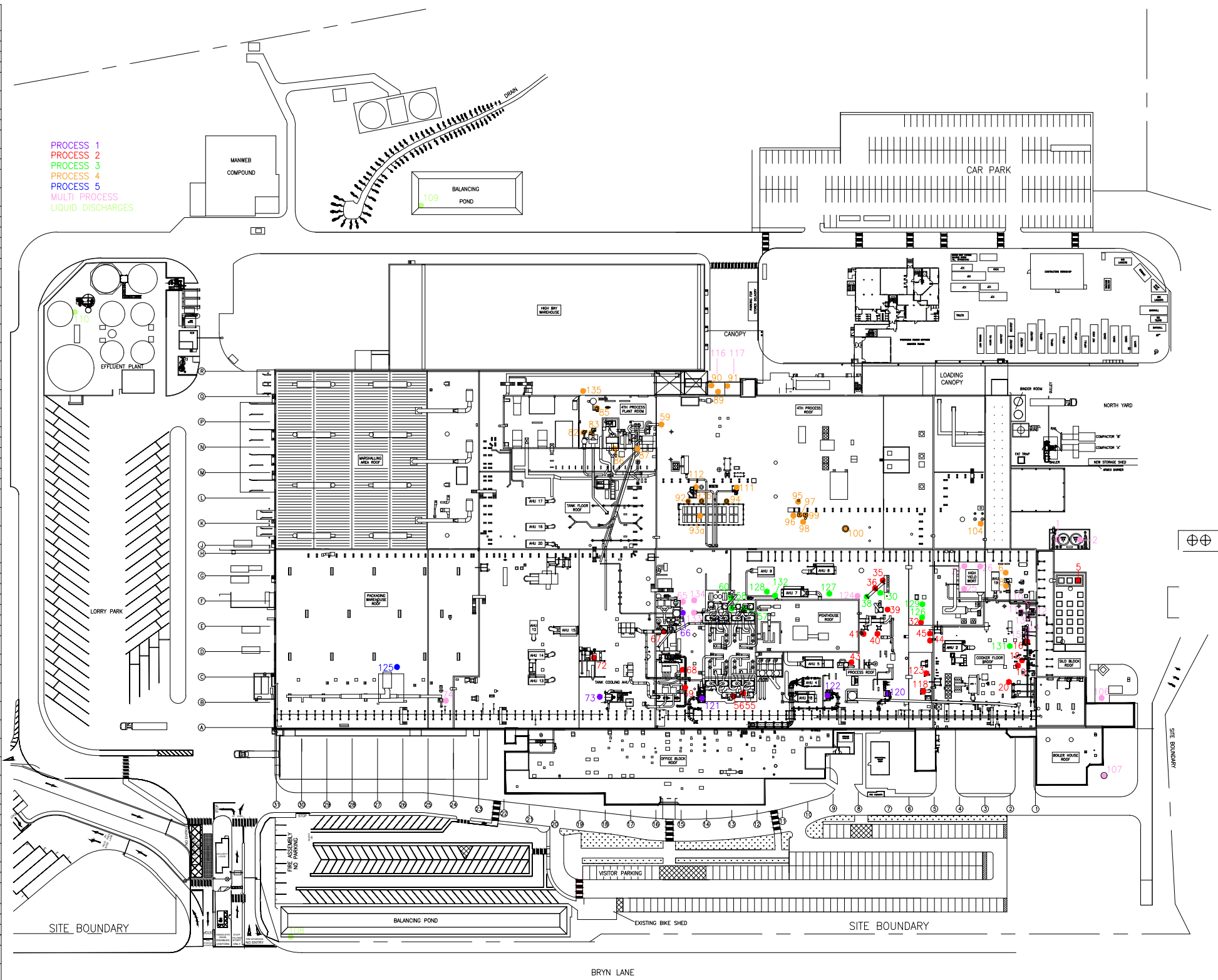

127 (A37)	PROCESS 3 – WET DUST COLLECTION SYSTEM SERVING COATING DRYER	WET DE-DUSTER	FOOD DUST & COMBUSTION
128 (A38)	PROCESS 3 – INFED SYSTEM JETZONE	WET DE-DUSTER	FOOD DUST
129 (A38)	PROCESS 3 – DRY DUST COLLECTOR SERVING BIG BAG AREA	BAG FILTER	FOOD DUST
130 (A40)	PROCESS 3 – DRY DUST COLLECTOR SERVING FLOUR TRANSPORT	BAG FILTER	FOOD DUST
131 (A41)	PROCESS 3 – DRY DUST COLLECTOR SERVING SALT & FLOUR RECEIVERS	BAG FILTER	FOOD DUST
132 (A42)	PROCESS 3 – CYCLONE SERVING TOASTER COOLER	CYCLONE	FOOD DUST
133 (A43)	SYRUP CENTRE No. 1	BAG FILTER	FOOD DUST
134 (A44)	SYRUP CENTRE No. 2	BAG FILTER	FOOD DUST
135 (A45)	PROCESS 4 – COATED PRODUCTS	WET DE-DUSTER	FOOD DUST

NOTICE:
THIS DRAWING AND ALL DESIGNS, DETAILS, INVENTIONS OR DEVELOPMENTS COVERED THEREBY ARE CONFIDENTIAL AND THE EXCLUSIVE PROPERTY OF KELLOGG COMPANY WHICH RESERVES ALL PATENT AND OTHER RIGHTS. IT MUST BE RETURNED WHEN REQUESTED AND USED SUBJECT TO ABOVE CONDITIONS ONLY ON AUTHORISED COMPANY WORK.
USE FIGURED DIMENSIONS: SCALING OF DRAWINGS IS AT CONTRACTORS OWN RISK.
FRACTIONAL DIMENSIONAL TOLERANCE $\pm 0.010"$ WHEN DIMENSIONED IN METRIC TOLERANCE $\pm 0.25mm$.

TITLE LAYOUT OF FACTORY EMISSIONS WREXHAM PLANT – OCTOBER 2024				20	DRAWING UPDATED OCT. 24	MPL	14.10.24
				19	UPDATED TO REFLECT CHANGES AS A RESULT OF AURORA	MPL	11.10.24
				18	EQUIPMENT UPDATED	MPL	26.1.22
				17	UPDATED	MPL	16.12.21
SCALE 1:750	DRAWN D.S.	CHECKED	RELEASED	NO.	REVISION	SIG.	DATE
A1	DATE 13.10.04	DATE	DATE	DRG. No. W-BL-303r20			