



DUNELM DRILLING CO.

BOREHOLE RECORD

Contract No. C2365 Client ESSO PETROLEUM CO LTD
Ground Level Location SWIFTS - HOLYHEAD
Date MAY 1983 BOREHOLE Nos 1 + 2

Depth	Thick- ness	Legend	Description of Strata	Type of Sample	C kN/m ³	M °	D	Density Kg m ⁻³	N
0.30	0.30		TARMAC + SUBBASE						
0.80	0.50		MIXED CLAY, SAND & STONE FILL	P ₈₀	For 0.05" Penetration				70
1.25	0.45		Very HARD GREEN SCHIST.						
CHISELING 1½ HRS. <u>DRY</u>									
BH 2									
0.30	0.30		TARMAC + SUBBASE						
0.90	0.60		MIXED CLAY, SAND & STONE FILL	P ₉₀	For 0.05" Penetration				66
2.00	1.10		Very HARD DENSE GREEN SCHIST.	P _{2.00}	No Penetration				40
CHISELING 3 HRS. WATER AT 0.70 - COULD BE FROM ADJACENT TAP STRONG DIESEL SMOEL FROM GROUND. BH CLOSE TO DISUSED FUEL TANK.									

Water Struck at

Standing Water Level

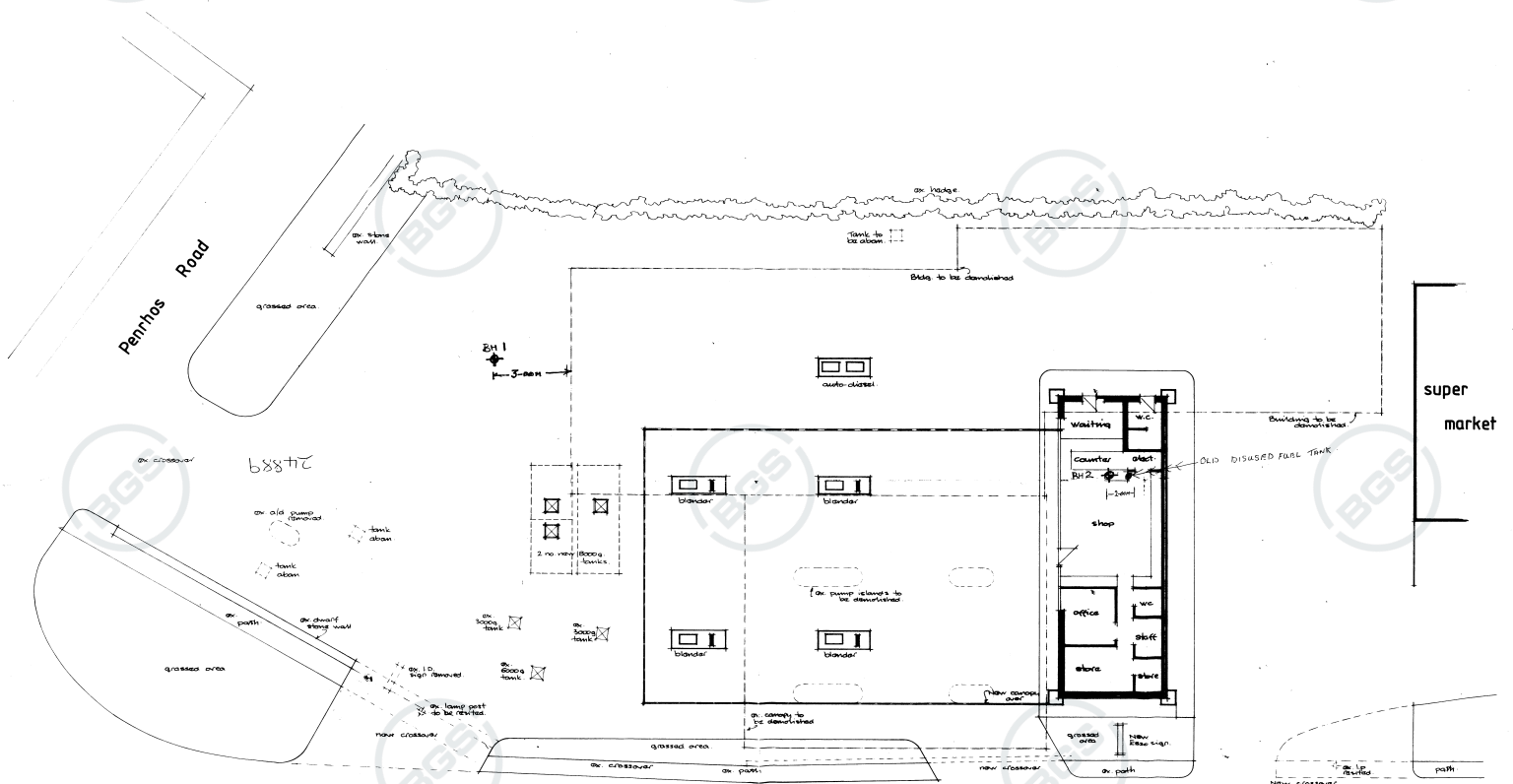

Rallt Newydd A5

INFORMATION FROM THE GARAGE
OWNER, IS THAT THE GROUND HAD
TO BE BLENDED, TO EXCAVATE
FOR THE FUEL TANKS.

