

Schedule 6.

Land Registry
Official copy of
title plan

Title number CYM643845
Ordnance Survey map reference SH6147DE
Scale 1:2500 enlarged from 1:10000
Administrative area Gwynedd

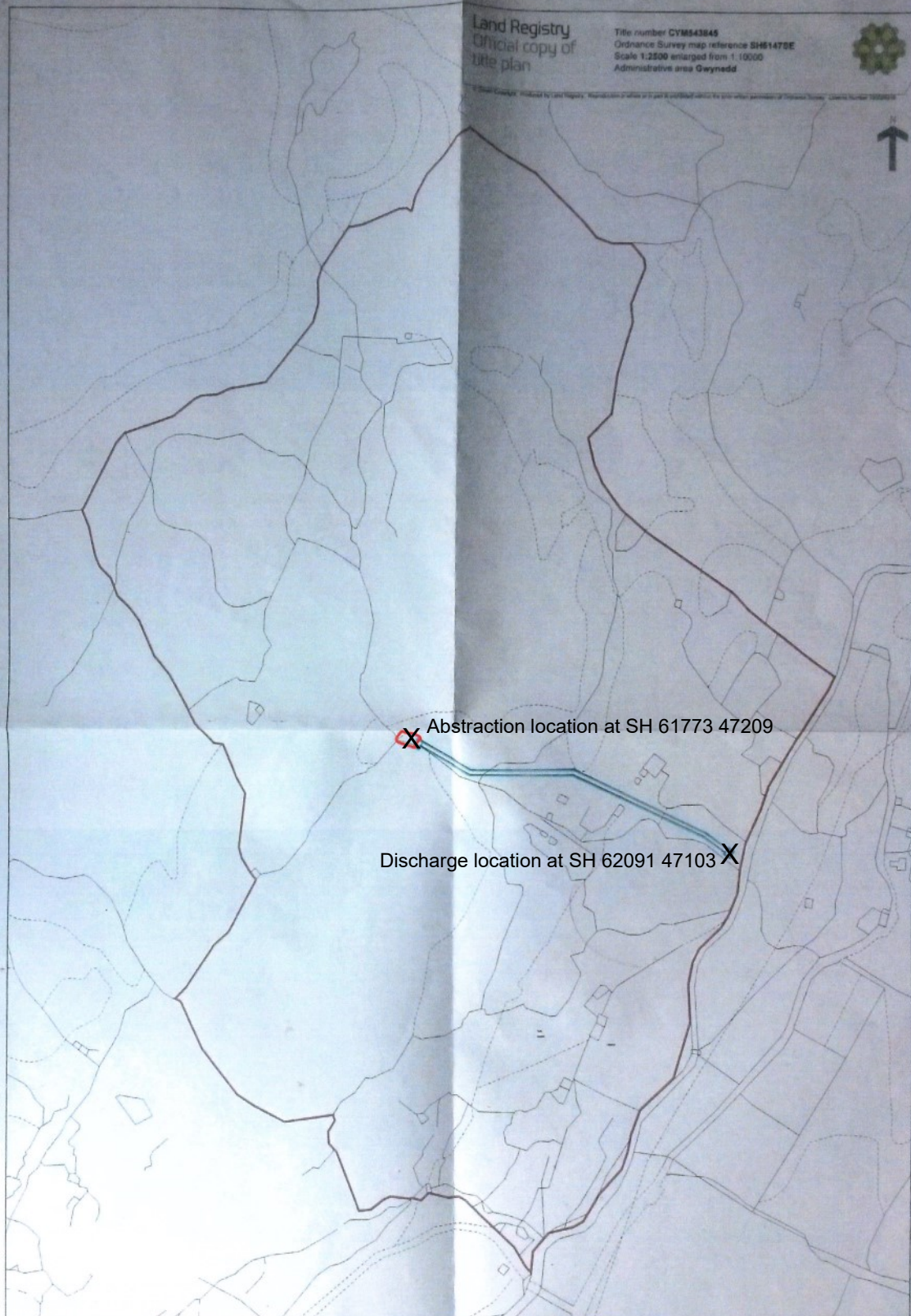

This official copy issued on 13 July 2016 shows the state of this title plan on 13 July 2016 at 11:51:58. It is admissible in evidence to the same extent as the original (s 67 Land Registration Act 2002).
This title plan shows the general position, not the exact line, of the boundaries. It may be subject to distortions in scale. Measurements scaled from this plan may not match measurements between the same points on the ground.
This title is dealt with by Land Registry, Durham Office.

Update: 14/11/2025 I confirm agreement that the rights of access under this agreement extend to include the area shown in red. Signature of Landowner:
J. Orkney-Work

Name of Landlord : JOHN PIERS ORKNEY-WORK
Signature of Landlord: *J Orkney-Work*
Date : 1st August 2016

JOHN ORKNEY-WORK - 18/11/2025.