

ALUN GRIFFITHS (CONTRACTORS) LIMITED

PROJECT: Menai Ville

METHOD STATEMENT NO. AGMS 001

SUBJECT: DCWW Sewer Remedial Works

Originated by: Reuben Smith Date: 10/03/2026	Construction Approval: Date:	Environmental Approval: Date:	General Foreman Approval: Date:						
P.M. Acceptance: Date:		Work to commence Approval: Date:							
Revision	Date	Change	Revision	Date	Change				
0	10.03.26	First Issue							
	AGCL		Clients (Representative)		Other				
Distribution:	Project Manager	Site Agent	General Foreman	Site Copy	Project Manager.	Supervisor	H & S File		

Contract Name:	Menai Ville	Sheet No.	2
Contract Number:	100511	Date:	10/03/2026

1.0 Introduction

This document provides the procedure and methodology that is to be followed whilst carrying out any works associated with the remedial works to the DCWW sewer in Menai Bridge as part of the Treborth scheme

2.0 Responsibilities

Project Team Member			Method Statement [MS] Responsibilities
Name	Role	Mobile	
Owain Thomas	Regional Director (AGCL)	07966318184	Allocation of appropriate resources Appointment of suitable Subcontractors Delegation of supervision Monitoring progress and KPI
Simon Parkinson	Senior Project Manager (AGCL)	07824470687	Allocation of appropriate resources Appointment of suitable Subcontractors Delegation of supervision Monitoring progress and KPI
Sion Jones	Senior Design Manager (AGCL)	07811718621	Develop and manage the design programme and schedule. Coordinate design activities from concept stage to final design. Ensure that design work aligns with project goals, scope, and timelines. Allocate design tasks to team members.
Reuben Smith	Site Agent (AGCL)	07795099628	Procurement of materials. Supervision of works, including Safety, Quality, CEMP & management of subcontractors Site inductions
TBC	Foreman (AGCL)		Planning & use of resources Allocation and overall supervision of works Issue Work Permits Monitor safety & other aspects of the project IMP
Rowan Connolly	Senior Engineer (AGCL)	07989412582	Setting out Assisting Site Agent Compilation of all records ITP/ QA
Iain Whitelock	Head of SHEQ (AGCL)	07966534820	Review Methods of Work & give advice Audit works: safety, quality & CEMP

Contract Name:	Menai Ville	Sheet No.	3
Contract Number:	100511	Date:	10/03/2026

3.0 Method/Procedure.

Prior to commencing the works:

- Site induction of all personnel associated with the works.
- Carry out a briefing to all employees associated with the work.
- AGC engineer to mark out extent of works area.
- AGC to carry out topographic survey of area prior to excavating.
- CAT scan area of excavation. Clearly marking out all existing services, (above and below ground) providing protection as necessary. **HS.F.33 Permit to Dig** where identified.
- Carry out trial holes to identify all existing underground services in area of excavation.
- AGCL engineer to issue permit to excavate/proceed clearly explaining locations of all services present.
- Ensure all plant/equipment to be used, uses bio-fuels and that daily plant/equipment checks are complete and that any defects on plant to be used is reported to a supervisor immediately to ensure repair/replacement prior to works commencing.
- Carry out method explanation to all employees associated with the work.
- These RAMS

Construction Methodology:

MH1 (located in garden) to MH2 prep work

- Accessed via driveway, manhole cover slab to be raised
- Over pumping to be set up in garden with bunded fuel cube
- Outfall over pumping hose to be placed along shoreline directly from MH1 to MH2
- MH1-MH2 375mm drainage run to be surveyed using CCTV camera unit and any blockages within drainage line to be addressed using jet vac working from MH2 up to MH1, sucking any debris being washed down the DCWW line
- Any defects identified by the CCTV survey to be patch lined

MH2 – MH3 prep work

- Cover slab for MH2 and MH3 to be temporarily removed using an 8tn excavator working on the causeway's concrete road. Cover slab/rings to be delivered on back of pickup along causeway.
- 1m high manhole ring to be temporarily installed over both manholes to increase protection from high tides and cover slab to be placed back on top
- Short drainage run to be over pumped between MH2 and MH3, and CCTV surveyed (and jetted if required) using same methodology as above, all from causeway
- Short run to be patch lined

MH3-MH4 prep work

- MH4 accessed via upper shoreline off causeway
- Cover slab for MH4 to be temporarily removed using an 8tn excavator. Cover slab/rings to be delivered on back of pickup along causeway.
- 1.5m high manhole ring to be temporarily installed over manhole to increase protection from high tides and cover slab to be placed back on top
- Over pumping to be set up from MH3 into MH4 using methodology as outlined above

Contract Name:	Menai Ville	Sheet No.	4
Contract Number:	100511	Date:	10/03/2026

- MH3-MH4 600mm drainage run to be surveyed using CCTV camera unit and any blockages within drainage line to be addressed using jet vac working from MH4 up to MH3, sucking any debris being washed down the DCWW line
- Any defects identified by the CCTV survey to be patch lined

MH4 – pumping station prep work

- Short drainage run to be over pumped between MH4 and pumping station, and CCTV surveyed (and jetted if required) using same methodology as above, all from causeway
- Short run to be patch lined

Lining work:

These RAMS are to be adhered to in conjunction with the RAMS provided by the pipe lining contractor (SSOW 004.1)

MH1-MH2

- Temporary scaffold tower to be erected over MH1
- 7.5tn mobile crane to be parked in driveway/garden
- Trailer delivering/feeding liner to be parked in driveway/garden
- Lining works to commence as per attached indicative method statement

MH3-MH4

- Temporary scaffold tower to be erected over MH3 and MH4
- 7.5tn mobile crane to be parked on causeway
- Trailer delivering/feeding liner to be parked in on causeway
- Lining works to commence as per attached indicative method statement

Reinstatement work:

- Temporary manhole rings to be removed from MH2, MH3 and MH4 using 8tn excavator
- Cover slab to be reinstated and new sealed/bolted manhole cover slabs to be installed

Plan of drainage run to be surveyed and lined, inc manhole references:

Contract Name:	Menai Ville	Sheet No.	5
Contract Number:	100511	Date:	10/03/2026

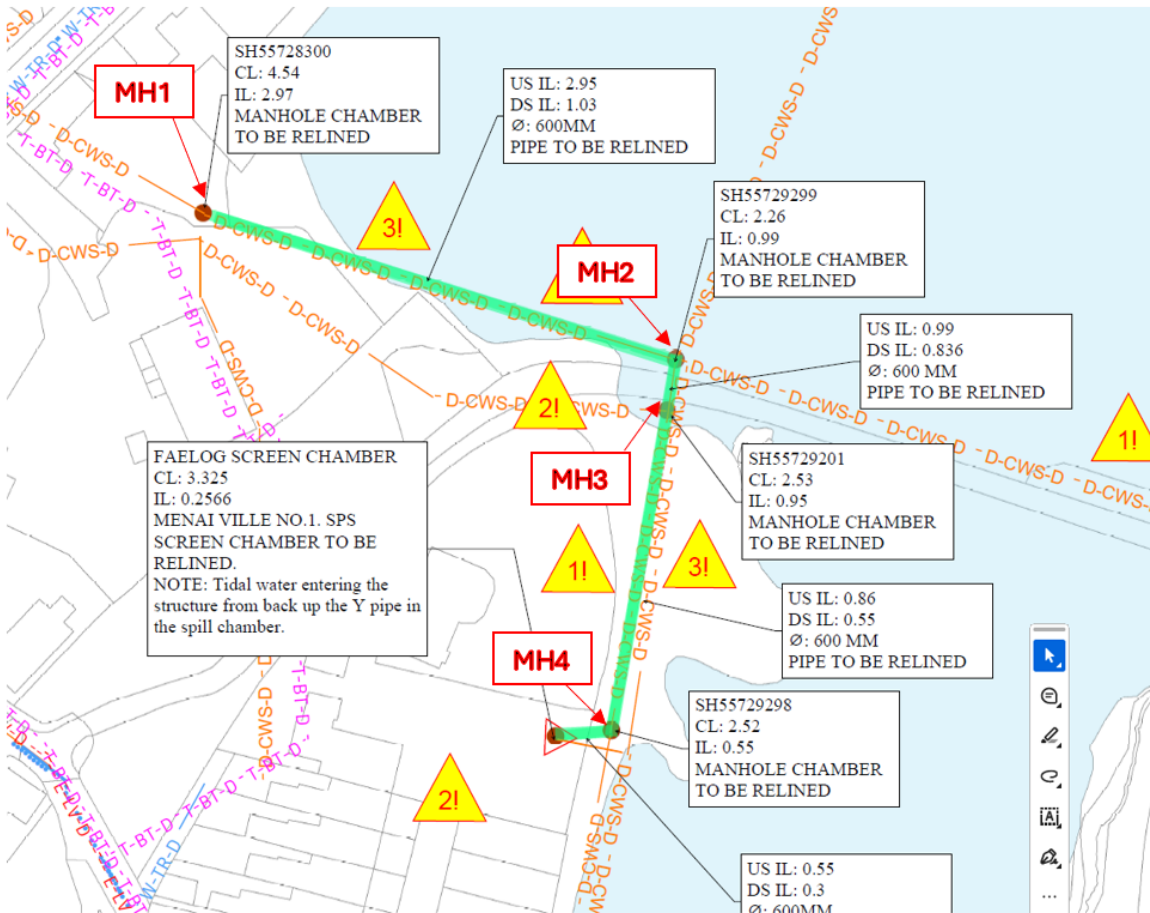

Measures taken to protect environment:

- Works to be planned around weather and tide times
- Residents to be informed and parking on causeway to be coordinated with residents
- Excavator to operate on bio oil and have spill kit/nappy, and only in marine environment for duration of works
- All plant/materials to be stored off-site
- Bauer connections or flanged connections for over pumping line to be placed outside tidal range where possible and plant nappy/spill decks to be placed between joints to mitigate risk of any water from line being leaked into environment when operating/disconnected.
- Liner to be prepared off-site
- SSOW and permit to work system
- DCWW coordination

5.0 Equipment

A list of required plant is listed below, other plant and equipment may become apparent as the scheme progresses.

Contract Name:	Menai Ville	Sheet No.	6
Contract Number:	100511	Date:	10/03/2026

- CAT and Genny
- Insulated hand tools
- Compound welfare units COSHH and stores facility,
- Emergency response items (i.e., spill kits, plant nappies, first aid kits, fire stations and extinguishers etc.).
- Heras fencing and all associated clips and feet etc.
- Wheeled Excavator
- Forward Tipping Dumper
- Whacker Plate
- Stihl Saw

6.0 COSHH

- Diesel/Petrol & oil
- Concrete
- Spray Paint

7.0 ENVIRONMENTAL

- All excavated material to be stored in the main site compound away from the work area
- Disposal of Surplus Materials and waste to be in conformance to the Site Waste Management Plan Noise levels shall be minimized where possible and all works will be within the site daytime working hours
- Refueling of plant to be carried out in accordance with the most recent approved procedures and 30m away from any water course.
- Spill kits will be positioned on site and an incident response plan put in place.
- All fuel will be stored in a secure, double bunded container (110% capacity) and all equipment containing fuel shall be stored on a plant nappy.
- Any spills will be reported immediately by the works supervisor to the Environment Advisor in line with the site environmental incident response plan
- Waste management will be conducted in accordance with the Site Waste Management Plan.
- Works to be planned around weather and tide times
- Residents to be informed and parking on causeway to be coordinated with residents
- Excavator to operate on bio oil and have spill kit/nappy, and only in marine environment for duration of works
- All plant/materials to be stored off-site
- Bauer connections or flanged connections for over pumping line to be placed outside tidal range where possible and plant nappy/spill decks to be placed between joints to mitigate risk of any water from line being leaked into environment when operating/disconnected.
- Liner to be prepared off-site
- SSOW and permit to work system

Contract Name:	Menai Ville	Sheet No.	7
Contract Number:	100511	Date:	10/03/2026

8.0 PPE Requirements

Mandatory PPE Requirements		
<input checked="" type="checkbox"/> Safety Helmet: (Mandatory) EN397 or EN12492.	<input checked="" type="checkbox"/> Safety Footwear: (Mandatory) EN345.	<input checked="" type="checkbox"/> Hi Visibility Clothing – long sleeve shirt/jacket & trousers (Mandatory) EN471:2003 Class 2 & GO/RT 3279, EN471:2003 Class 1.
<input checked="" type="checkbox"/> Safety Glasses: (Mandatory) EN 166:2001.	<input checked="" type="checkbox"/> Work Gloves: (Mandatory) EN388.	
Task Specific PPE Requirements		
<input checked="" type="checkbox"/> Hearing Protection: Task: working near plant	<input checked="" type="checkbox"/> Harness: Full Body Harness with a D Buckle Task: Working in Confined Space	<input type="checkbox"/> Fire retardant overalls: Task: Breaking ground
<input checked="" type="checkbox"/> Respiratory Protection/Masks: Escape Sets, Gas Monitors Task: Working in Confined Space	Lighting: Head Torch	

9.0 Emergency Procedures

Refer to Rescue Plan HS.F.115

Any accidents or near misses must be reported to the Site Supervisor. Emergency contact numbers are listed above. Site address - St George's Road, Menai Bridge at post code LL59 5ES

In the event of a serious incident, site staff shall contact emergency services on 999 and provide location information as outlined above.

Nearest A & E - Ysbyty Gwynedd, Penrhosgarnedd, Bangor LL57 2PW

10.0 Appendices

- Appendix A: Risk Assessment.
- Appendix B: Exclusion Zones
- Appendix C: Method Statement Briefing
- Appendix D: Relining contractor Ssow

Contract Name:	Menai Ville	Sheet No.	8
Contract Number:	100511	Date:	10/03/2026

APPENDIX A

RISK ASSESSMENT

Contract Name:	Menai Ville	Sheet No.	9
Contract Number:	100511	Date:	10/03/2026

Assessment Details			
Site Name & No.	Menai Ville – 100511	Assessor Name	Reuben Smith
Reference	RAMS 001	Assessment Team Members	TBC
Is this Confidential	No	Assessment Date	10/03/2026
Activity Description	Remedial works to DCWW sewer network		
Activity / Task		Number of People Exposed	4
Project	Menai Ville	List those at Risk	Operatives
Description		Is this an Acceptable Risk?	Yes
Precise Location		Review Date	
Date Record Created	10/03/26	Reviewed By	

15 +	Red Risk	Unacceptable level of Risk works do not commence. Employ stringent controls and reassess risk until reduced to an acceptable level.
5 - 12	Amber Risk	Risk must be mitigated with controls. Works are permitted to commence if stringent controls are in place.
1 - 4	Green Risk	Acceptable level of Risk for work to commence, however still investigate to employ further controls when reasonably practicable.

Severity Rating	Likelihood Rating				
	1	2	3	4	5
5	5	10	15	20	25
4	4	8	12	16	20
3	3	6	9	12	15
2	2	4	6	8	10
1	1	2	3	4	5

Hazard Identification	Who is at Risk	Initial potential for harm			Action Required (Y/N)	Control Measures	Residual potential for harm		
		L	S	R			L	S	R
Slips, Trips and Falls	Employees	3	2	6	Y	<ul style="list-style-type: none"> Ensure all walkways and work areas are free from trip hazards. All personnel to wear laced safety footwear No walking on batters, use designated access routes. Keep access routes clear. Good housekeeping to be maintained at all times Park vehicles at suitable location to welfare facility. Provide suitable fencing, signing and guarding to the working area as necessary. Use designated/ proper access to enter and exit plant. Provide edge protection to vertical sides when working at height above or below ground. Work area to demarcated and appropriately signed Attend Daily Briefing POWRA to be carried out 	1	2	2
Use of substances hazardous to health causing dermatitis, environmental incident or respiratory issues	Employees	3	3	9	Y	<ul style="list-style-type: none"> COSHH briefings to be carried out accordingly and control measures within adhered to. Spill kit to be available – near the work area. Operatives to be trained to use spill kit. Disposal of COSHH related waste in accordance with manufacturer's guidance and site procedures Wash hands with clean water and soap before eating. Waterproof gloves for concrete 	1	3	3
Manual Handling Injuries	Employees	3	3	9	Y	<ul style="list-style-type: none"> Use a mechanical aid where possible 	1	3	3

Contract Name:	Menai Ville	Sheet No.	11
Contract Number:	100511	Date:	10/03/2026

						<ul style="list-style-type: none"> If using mechanical aid, ensure that a HAVS assessment has been completed and usage is logged Split/share loads where possible Only lift what is comfortable for you as an individual Employ manual handling practices and wearing of gloves Do not place limbs/digits on crush/pinch zones/line of fire 			
Use of hand tools causing: Cuts or piercing the skin	Employees	4	3	12	Y	<ul style="list-style-type: none"> Follow manufacturer's instructions Apply task specific PPE as required (Level 5 Cut Rated Gloves) Do not use damaged/faulty equipment Keep hands clear of sharp/moving components 	1	3	3
Contaminating water course/marine environment/ soil Emission of noxious gases Emission of sediment plumes Emission of noise Use of fossil fuels Increased noise, traffic, dust, mud, light, working hours Any risk to nearby habitats / species. Any impact on birds, marine mammals, and nearby shellfish/mussel areas in the area of works Potential for INNS	Public. Employees. Environmental.					<ul style="list-style-type: none"> Careful excavation in good weather / low tide conditions Consider where digging is done in rock revetment area and refer to GI information Soil sampling and testing to be conducted Frequent Vehicle and plant maintenance and cleaning regime Noise mitigation methods employed as required. Noise monitoring Cleaning down and jet washing Armour stone prior to installation. Regular Inspection to ensure clean and absence of any INNS. Consideration of use of silt curtains / bubble curtains in marine / water side of stone to prevent water pollution of marine environment Refuel at least 30m away from watercourse All fuel bowsers to carry adequate spill kit and granules, and funnels. Biofuels to be used in all pieces of plan/equipment Refuelling only to be carried out by designated person. 	1	4	4

Contract Name:	Menai Ville	Sheet No.	12
Contract Number:	100511	Date:	10/03/2026

						<ul style="list-style-type: none"> Observe Traffic Management Plan, Dust management, observe agreed working hours Establish any exclusion zones / mitigation from shadow Habitat regulations assessment findings conducted by ecologist Application of any controls featured in Water Framework Directive Assessment findings 			
Movement of Heavy Plant/Machinery resulting in: <ul style="list-style-type: none"> Plant Collision Crush of personnel 	Employees	3	5	12	Y	<ul style="list-style-type: none"> All plant only to be operated by trained and competent personnel (CPSC/NPORS card required) Full PPE to be worn including high visibility full sleeve and trousers. All plant to hold all necessary test certificates (check on arrival to site). All plant to be fitted with and use warning lights on top of their vehicle. All plant to be fitted with and use audible reversing alarm. Seat belts to be worn at all times. Ganger/ Supervisor will agree position for the operation during the activity. Personnel to remain in 'line of sight' of the plant operator at all times. Plant operator must stop immediately when he is not visible at the Safety Zone. Pre use inspection completed by operative. Do not use plant if broken or faulty. Use designated haul roads. Establish exclusion zone and place pedestrian barriers around zone. Site speed limit of 5mph adhered to at all times Banksman/Slinger to remain in eye contact with driver at all times. 	1	5	5
Transportation of materials/equipment resulting in:	Employees	4	5	20	Y	<ul style="list-style-type: none"> All plant to be operated by trained and competent personnel only (CPCS/NPORS) 	1	5	5

Contract Name:	Menai Ville	Sheet No.	13
Contract Number:	100511	Date:	10/03/2026

<ul style="list-style-type: none"> • Overturning of plant • Dust Pollution 					<ul style="list-style-type: none"> • All plant to be checked on arrival to site and to hold all necessary test certificates. • Always travel with skip in horizontal position. • Seat belt to be worn at all times. • All plant to be fitted with warning lights on top of their vehicle. • Dust suppression to be used during periods of dry weather. • Site speed limit of 5mph to be adopted • Suitable well maintained haul roads to be constructed between each working area. • Designated route to be used during transportation of material. • Plant to be used within their capabilities when travelling / working on uneven or steep ground. 			
--	--	--	--	--	--	--	--	--

PERSONAL PROTECTIVE EQUIPMENT

The following PPE will be required for the work activities stated. Ensure that the correct type of PPE is selected.

Head Protection	X	Eye Protection	X	Hi-visibility clothing	X	Fall Arrest		Full Body Harness	
Foot Protection	X	Eyewear	X	Gloves	X	High Visibility clothing	X		

Contract Name:	Menai Ville	Sheet No.	14
Contract Number:	100511	Date:	10/03/2026

PERSONAL PROTECTIVE EQUIPMENT

The following PPE will be required for the work activities stated. Ensure that the correct type of PPE is selected.

Review and Monitoring

This assessment will be reviewed in the light of further information becoming available or a change in conditions and/or circumstances to render it no longer relevant. In any event this assessment will be reviewed after 12 months to ensure that it remains valid.

Information to be Provided to Employees

1. Information contained in this assessment.

The following persons have received and understand the information contained in this assessment.

Name	Signature	Date	Name	Signature	Date

Contract Name:	Menai Ville	Sheet No.	15
Contract Number:	100511	Date:	10/03/2026

Appendix B

Exclusion Zones

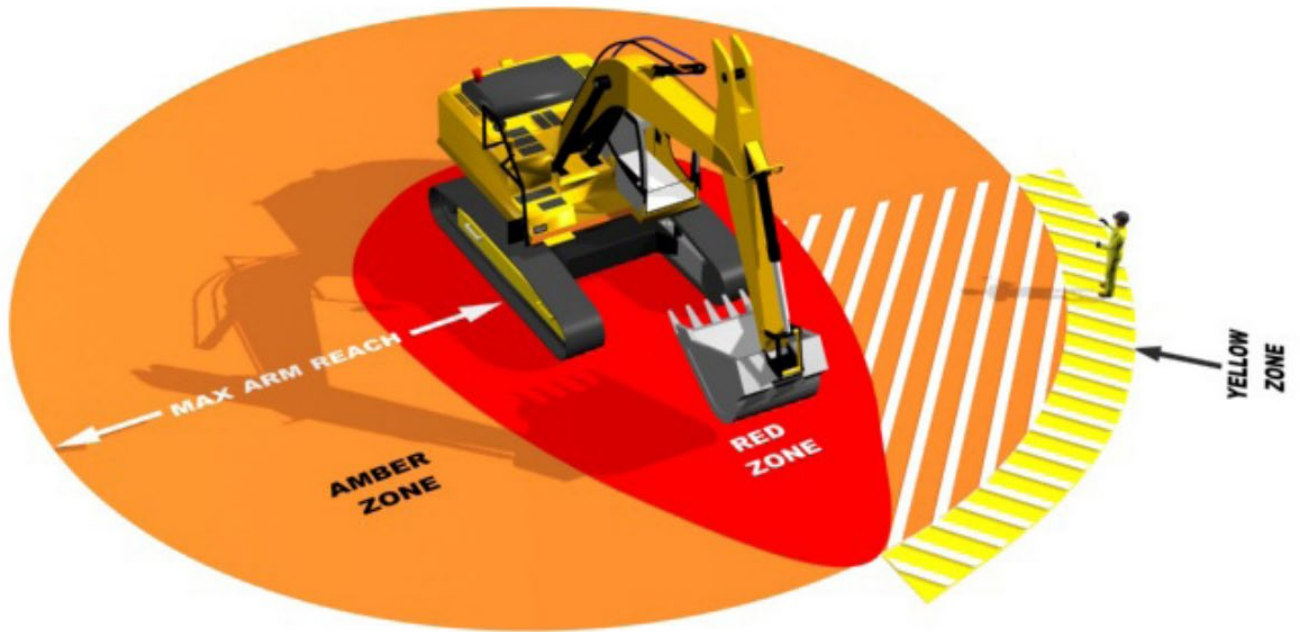

Contract Name:	Menai Ville	Sheet No.	16
Contract Number:	100511	Date:	10/03/2026

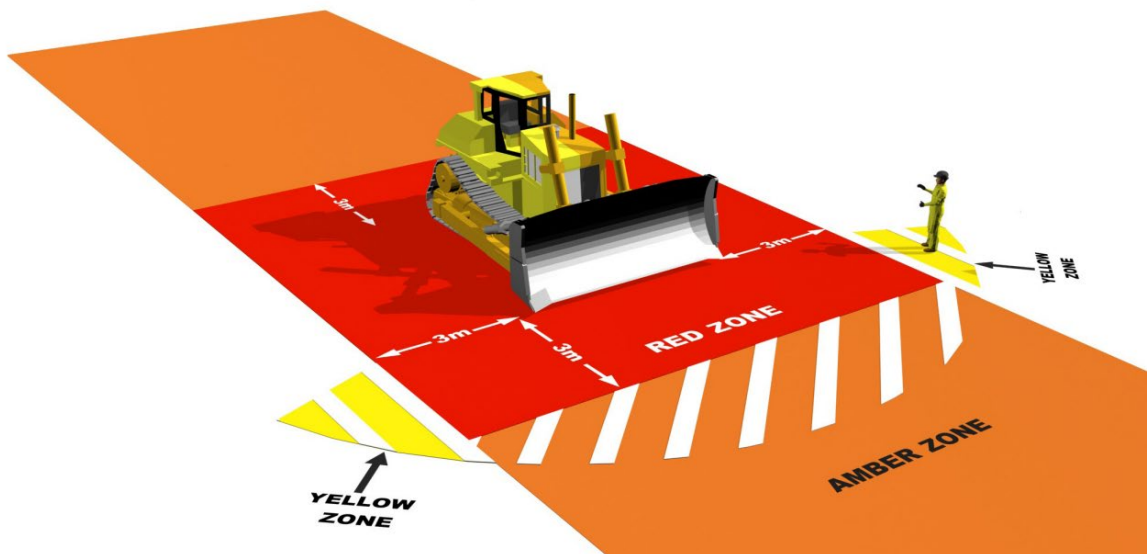
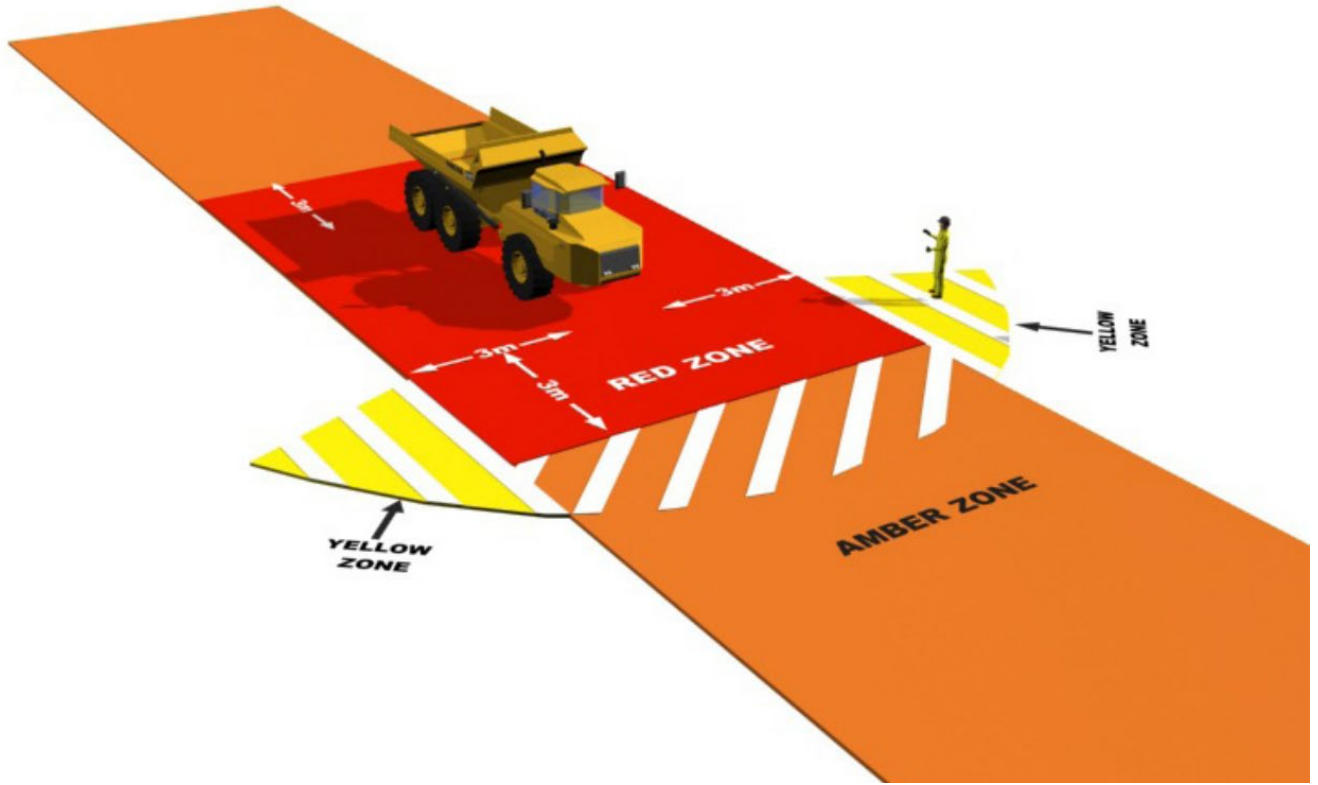

Contract Name:	Menai Ville	Sheet No.	17
Contract Number:	100511	Date:	10/03/2026

Vehicles, Vans and Lorries

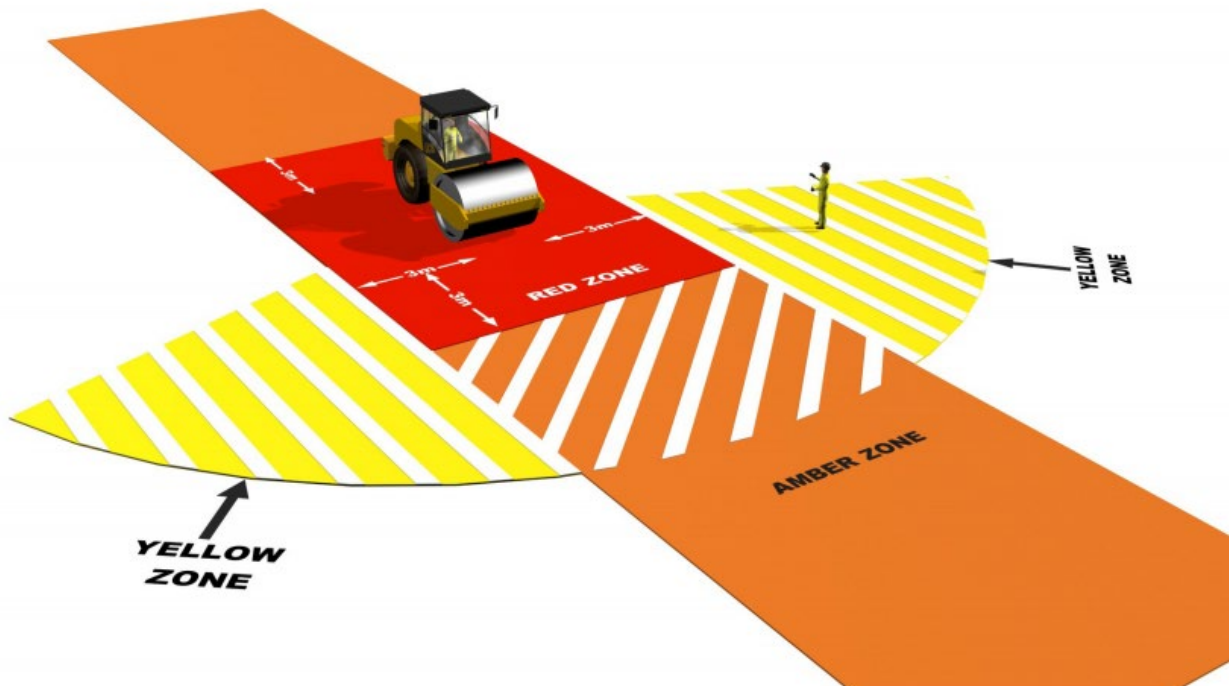
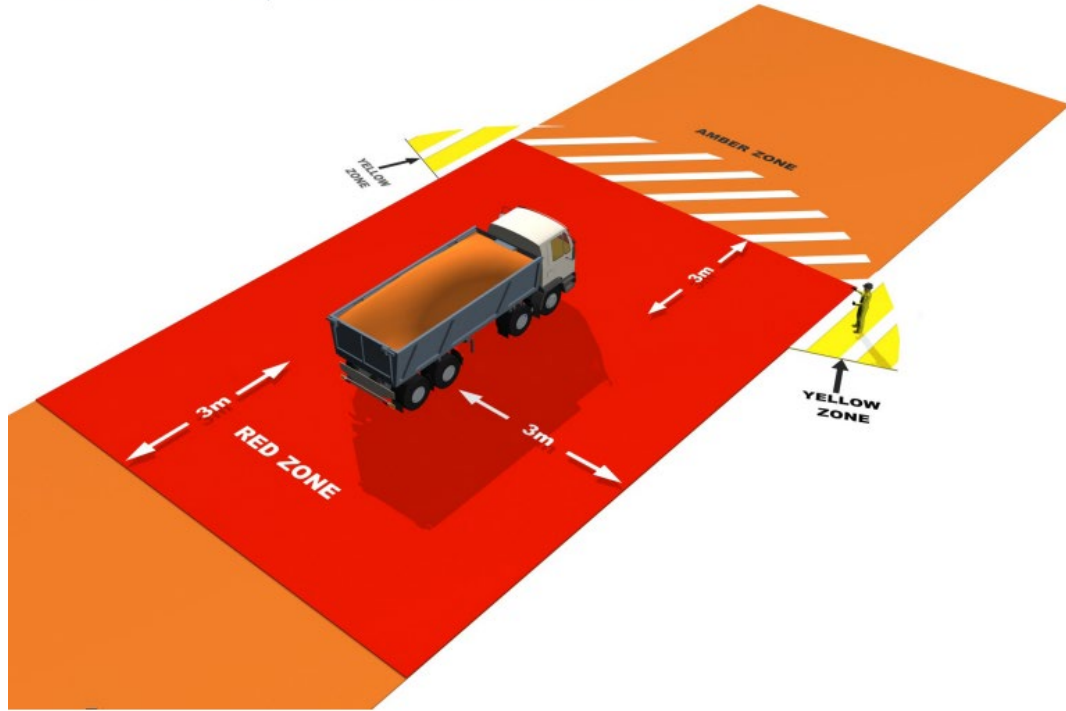

Contract Name:	Menai Ville	Sheet No.	18
Contract Number:	100511	Date:	10/03/2026

Plant Interface Zones

Yellow Zone

All personnel involved with the plant operation must remain within this zone to maintain visual contact with the plant operator.

Amber Zone

Entry prohibited until positive visual contact is made with the plant operator and the machine is immobilised.

Red Zone

Entry prohibited unless the machine is completely isolated with the machine immobilised and the engine switched off.

Hatched Zones

Denotes typical sight lines of the plant operator

APPENDIX C

Contract Name:	Menai Ville	Sheet No.	19
Contract Number:	100511	Date:	10/03/2026

METHOD STATEMENT BRIEFING RECORD

METHOD STATEMENT EXPLANATION FORM

Method statement	DCWW Sewer Remedial Works
Method Statement No.	AGMS 001
Date of explanation	
Explanation given by	
Topics covered:	Method statement explanation including toolbox talks on:

No.	Attendee	Signature	No.	Attendee	Signature
1			14		
2			15		
3			16		
4			17		
5			18		
6			19		
7			20		
8			21		
9			22		
10			23		
11			24		
12			25		
13			26		

Signature of person giving explanation:

Signature of attendee confirms understanding of explanation given

APPENDIX D

SSOW 004.1 (Attached as separate document)

Contract Name:	Menai Ville	Sheet No.	20
Contract Number:	100511	Date:	10/03/2026