

Site Location Plan [1:5000]

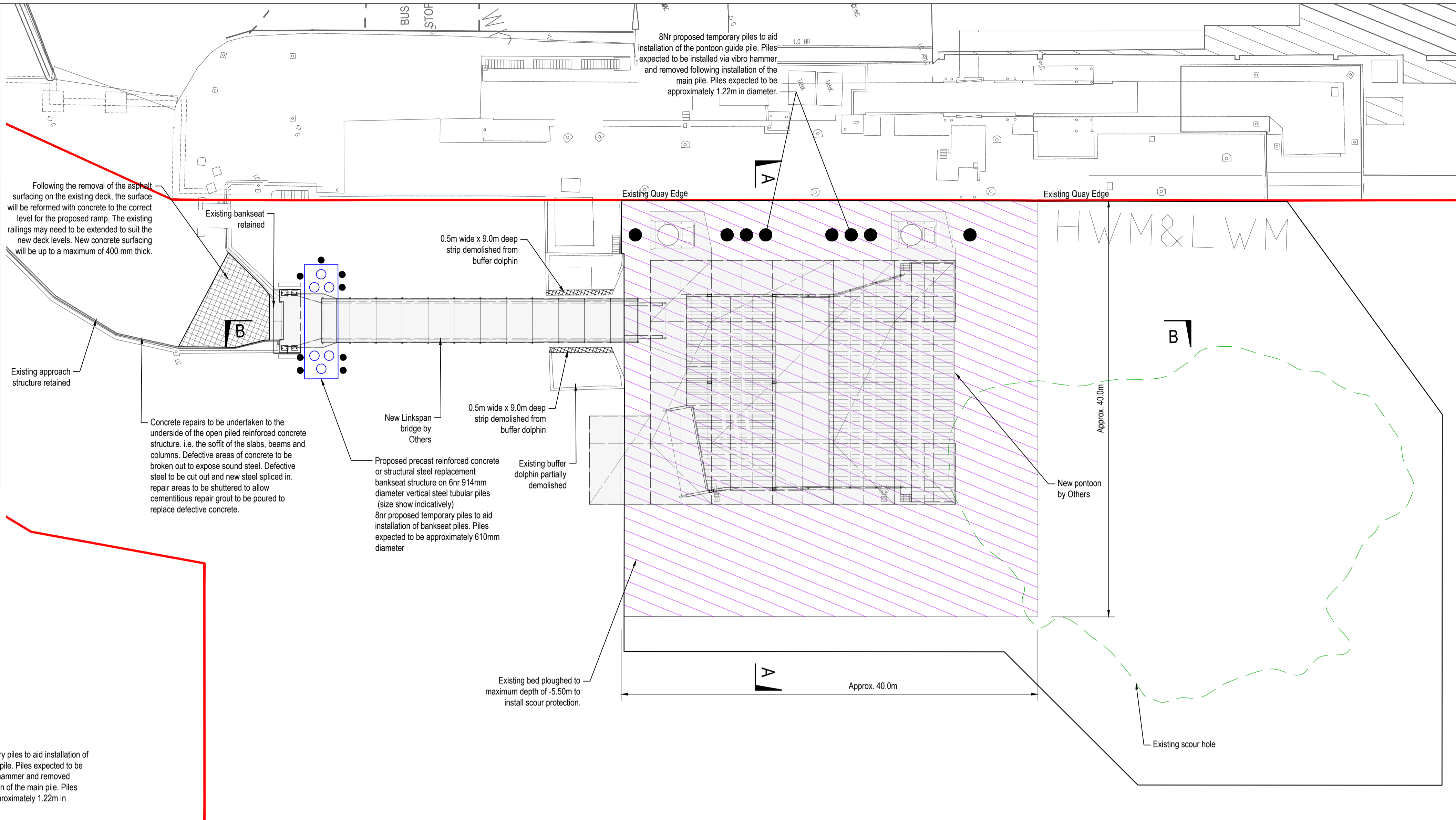

Marine Licence: Proposed Layout [1:250]

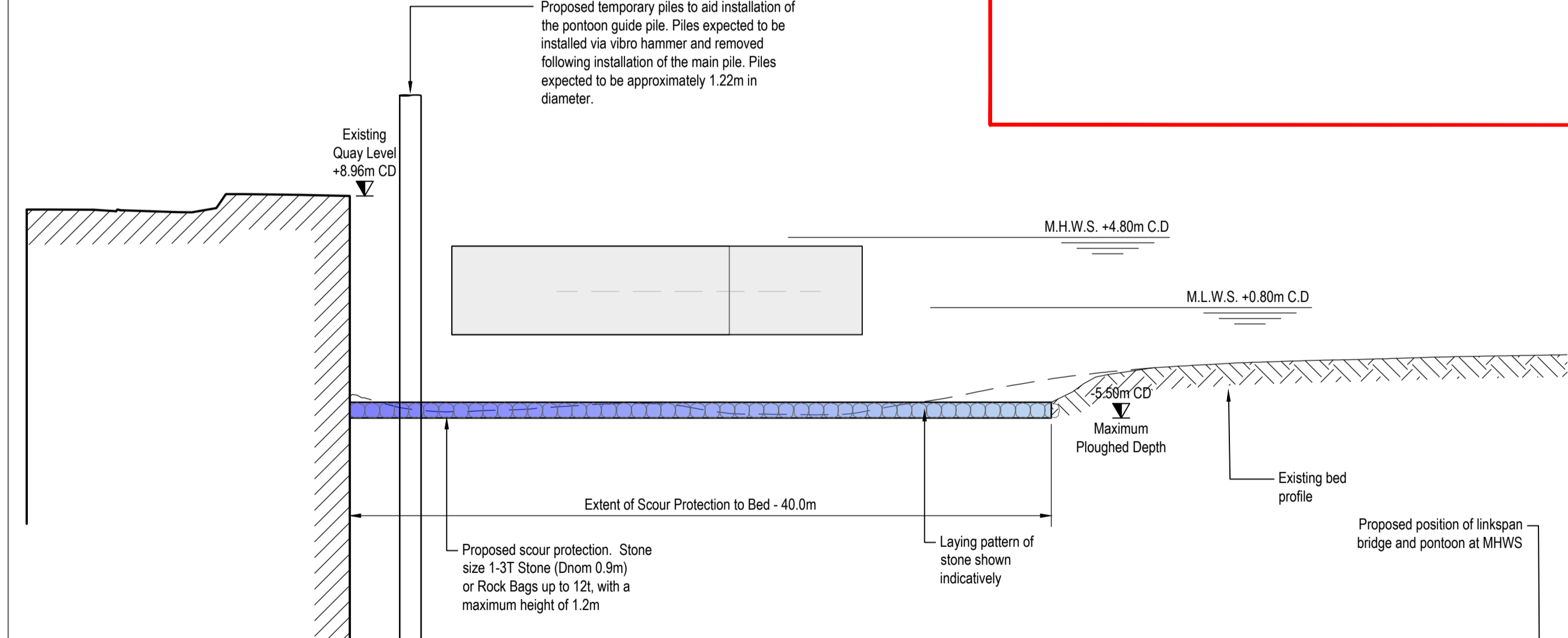

Section A-A [1:250]

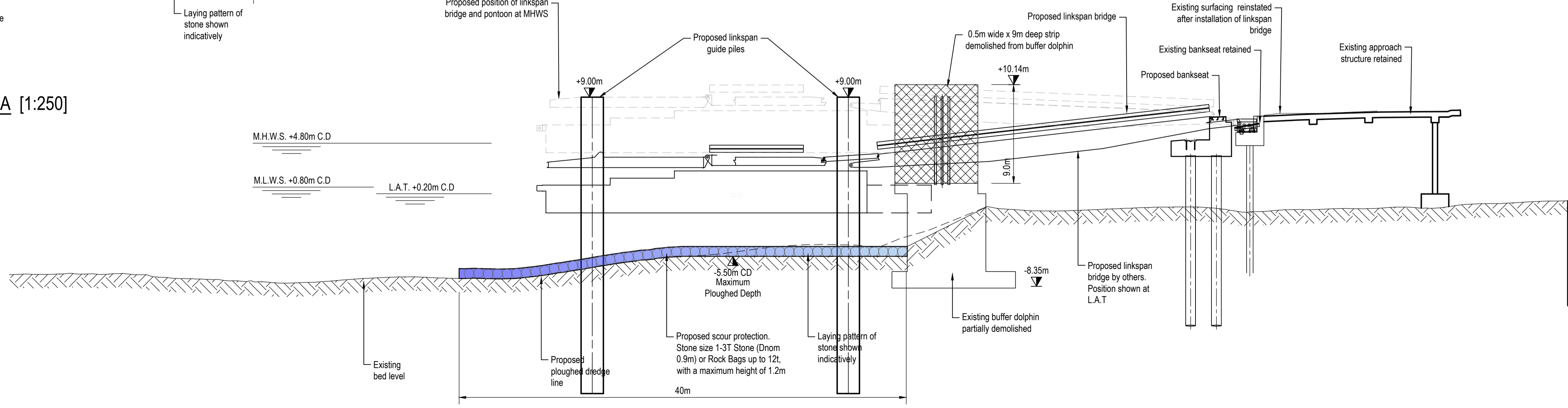

Section B-B [1:250]

- NOTES**
- Verifying Dimensions. The contractor shall verify dimensions against such other drawings or site conditions as pertain to this part of the work.
 - Existing Services. Any information concerning the location of existing services indicated on this drawing is intended for general guidance only. It shall be the responsibility of the contractor to determine and verify the exact horizontal and vertical alignment of all cables, pipes, etc. (both underground and overhead) before work commences.
 - Issue of Drawings. Hard copies, dwf and pdf will form a controlled issue of the drawing. All other formats (dwg, dxf etc.) are deemed to be an uncontrolled issue and any work carried out based on these files is at the recipient's own risk. RPS will not accept any responsibility for any errors arising from the use of these files, either by human error by the recipient, listing of un-dimensioned measurements, compatibility issues with the recipient's software, and any errors arising when these files are used to aid the recipient's drawing production, or setting out on site.
 - Datum. Chart Datum (C.D.)
 - The concrete repairs are included within the Marine Licence scope as they may be carried out concurrently with the works under this project. Concrete repairs to the existing structure are deemed to fall under Article 2 of The Marine Licensing (Exempted Activities) (Wales) Order 2011 covering Harbour Maintenance Works
- Marine Licence Boundary (9899.31 sq metres)
 - Proposed Scour Protection
 - Proposed New Linkspan and Pontoon by Others
 - Indicative Temporary Pile Location
 - Proposed Scour Protection
 - Extent of area covered shown on Marine Licence: Proposed Layout [1:250]

| | | | |
|-----|---|-------|------------|
| C02 | Marine Licence Boundary and area updated. Issue for application submission (Status A1) | E.M. | 11/05/2026 |
| C01 | Status changed to A1 suitable for statutory application. Issue for application submission | E.M. | 14/04/2026 |
| rev | amendments | check | date |

TETRA TECH

Elmwood House
74 Boucher Road
Belfast
BT12 6RZ

T +44 (0) 28 90 667914
F +44 (0) 28 90 668286
W www.tetrattech.com/europe

Client
Stena Line

Project
Fishguard Linkspan

Title
Marine Licence Proposed Layout

| | | |
|----------------------------|------------------|------------------------|
| Project Number POR00886 | Sheet Size A1 | Drawing Scale 1:250 |
|----------------------------|------------------|------------------------|

Drawing Number
POR00886-TT-ML-XX-DR-C-0252

| | | |
|--------------------|---------------------|--------------------|
| Drawn By M.H. | Status A1 | Revision C02 |
| Checked By E.M. | Approved By E.M. | Date 20/01/2026 |