

100
0 10
Millimetres

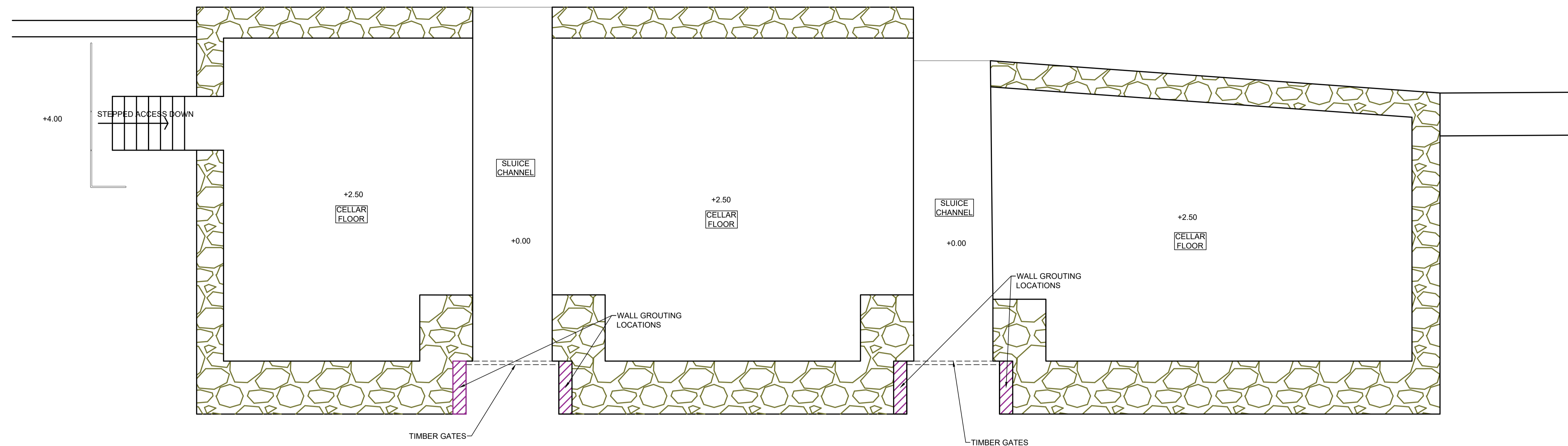

GROUTING LOCATIONS PLAN

1:50

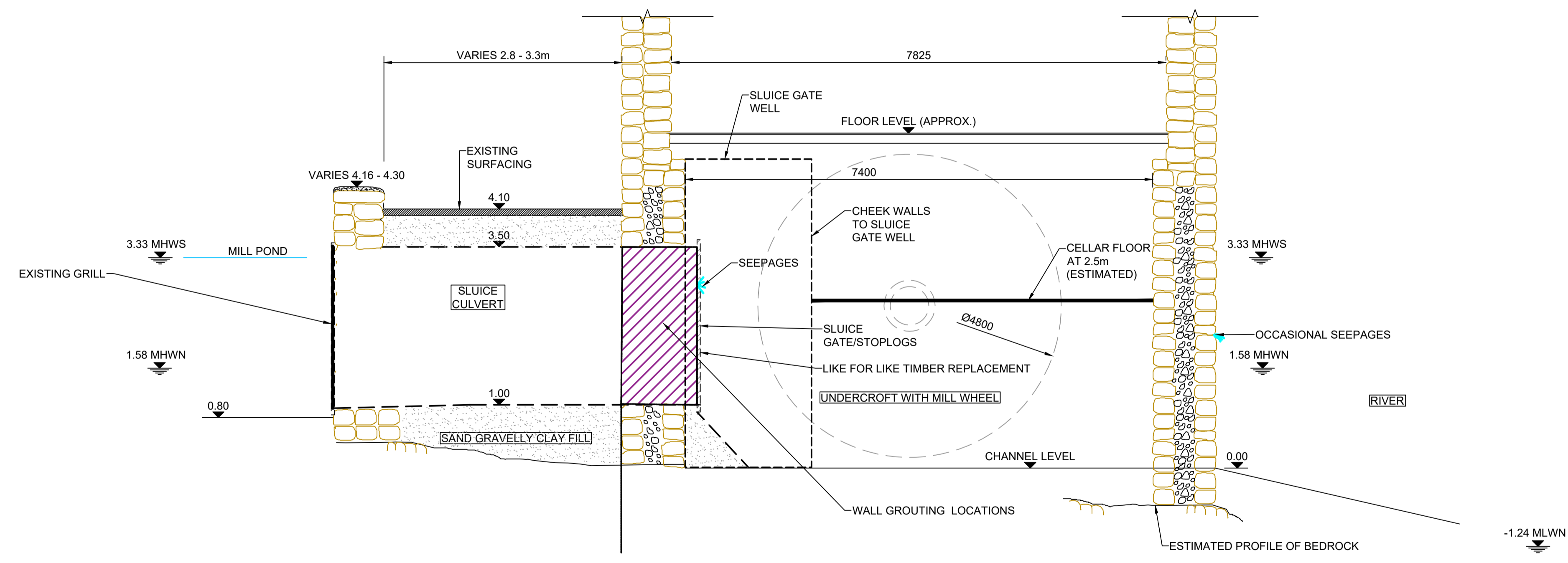

TYPICAL DETAIL OF CAUSEWAY STRENGTHENING X-X

1:50

SAFETY, HEALTH AND ENVIRONMENTAL INFORMATION	
In addition to the hazards/risks normally associated with the types of work detailed on this drawing, note the following:	
CONSTRUCTION	
WORKING ADJACENT TO A TIDAL RIVER, SUBJECT TO OCCASIONAL FLOODING. WORKING IN A CONFINED SPACE. WORKING NEAR EXCAVATIONS. WORKING NEAR OPERATIONAL FLAP GATES.	
MAINTENANCE/CLEANING	
CONFINED SPACE ENTRY REQUIRED FOR FUTURE ASSET INSPECTION (SLUICES)	
DECOMMISSIONING/DEMOLITION	
WORKING ADJACENT TO A TIDAL RIVER, SUBJECT TO OCCASIONAL FLOODING. WORKING IN A CONFINED SPACE. WORKING NEAR OPERATIONAL FLAP GATES.	
It is assumed that all works will be carried out by a competent contractor working, where appropriate, to an approved method statement	

- NOTES:**
- ALL DIMENSIONS ARE IN MILLIMETRES UNLESS OTHERWISE SHOWN.
 - ALL LEVELS TO ORDNANCE DATUM NEWLYN UNLESS STATED OTHERWISE.
 - THIS DRAWING INDICATES THE SHE RISKS FOR THE WHOLE SITE. REFER TO EACH INDIVIDUAL WORKS AREA FOR SPECIFIC SITE RISKS.
 - THE LOCATION OF SERVICES IS NOT KNOWN. ALL SERVICES SHALL BE TRACED BY THE CONTRACTOR TO CONFIRM THE PRESENCE OF ANY SERVICES.
 - PROPOSED WORKS ARE EXCAVATION ALONG BASE OF DAM WALL TO ALLOW INSPECTION FOR VOIDS, REMOVAL OF EXISTING DAM FILL MATERIAL AND REPLACEMENT WITH ENGINEERED FILL, LIME MORTAR RENDERING OF DAM WALL AND MILL HOUSE WALL, REMOVAL OF GRILLAGES TO SLUICE CULVERT, FIXING OF TEMPORARY PLATES TO BLOCK SLUICE CULVERTS AND PROVISIONALLY GROUTING.
 - GROUT PIPES TO BE 25MM RIGID PLASTIC PIPES. GROUTING IS PROVISIONAL AND WILL BE SUBJECT TO FURTHER INSTRUCTION.
 - LIME MORTAR POINTING SHALL BE NHL 3.5

Rev.	Date	Description	By	CHK'd	App'd
P06	16/05/26	SCHEME TITLE ALTERATION	MJE	RM	DF
P04	05/03/24	MINOR AMENDMENTS	CK	RM	DF
P03	05/03/24	TITLE BLOCK UPDATED	CK	RM	DF
P02	24/2/23	PLAN ADDED	CK	RM	DF
P01	26/11/21	FIRST ISSUE	MJE	RM	DF

Drawing Status: **FOR INFORMATION**

ATKINS

West Glamorgan House
12 Orchard Street
Swansea
SA1 5AD

Tel: +44 (0)1792 641172
Fax: +44 (0)1792 472019
www.atkinsglobal.com

Copyright © Atkins Limited (2017)

Client:

Pembrokeshire Coast National Park Authority
Winch Lane, Haverfordwest
Pembrokeshire SA61 1P7
Tel: 01437 744336

Project Title		CAREW MILL AND CAUSEWAY 2026 REPAIRS	
Drawing Title		REPAIR WORKS IN VICINITY OF THE MILL HOUSE (INTERNAL) SECTIONS	
Scale	Designed	Drawn	Checked
AS SHOWN	RM	MJE	RM
Original Size	Date	Date	Date
A1	26/11/21	26/11/21	26/11/21
Drawing Number	Revision		
5129589.016-ATK-ZZ-DR-D-0002	P06		