

hydro installation at Nant y Wenynen.

EXISTING POST-2015 TURBINE HOUSE AND OUTFALL.

date MAY 2026
 scale 1: 100 & 1:500
 paper size A3
 drawn by GC
 checked by NW
 job number 09/001
 drawing no 09001/03/G

NGW HYDRO
 Phone 07415700264

This drawing is based on a 2012
 TYGVHydro Ltd. drawing.

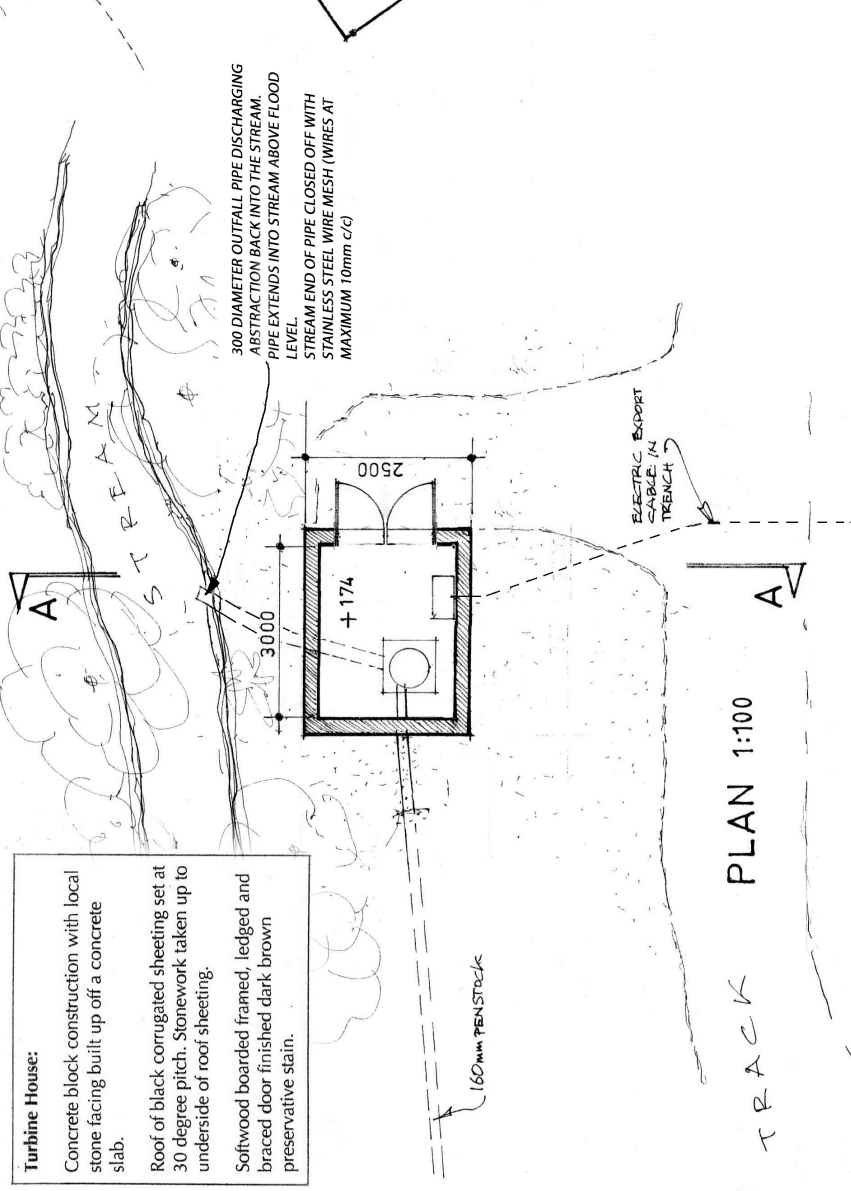
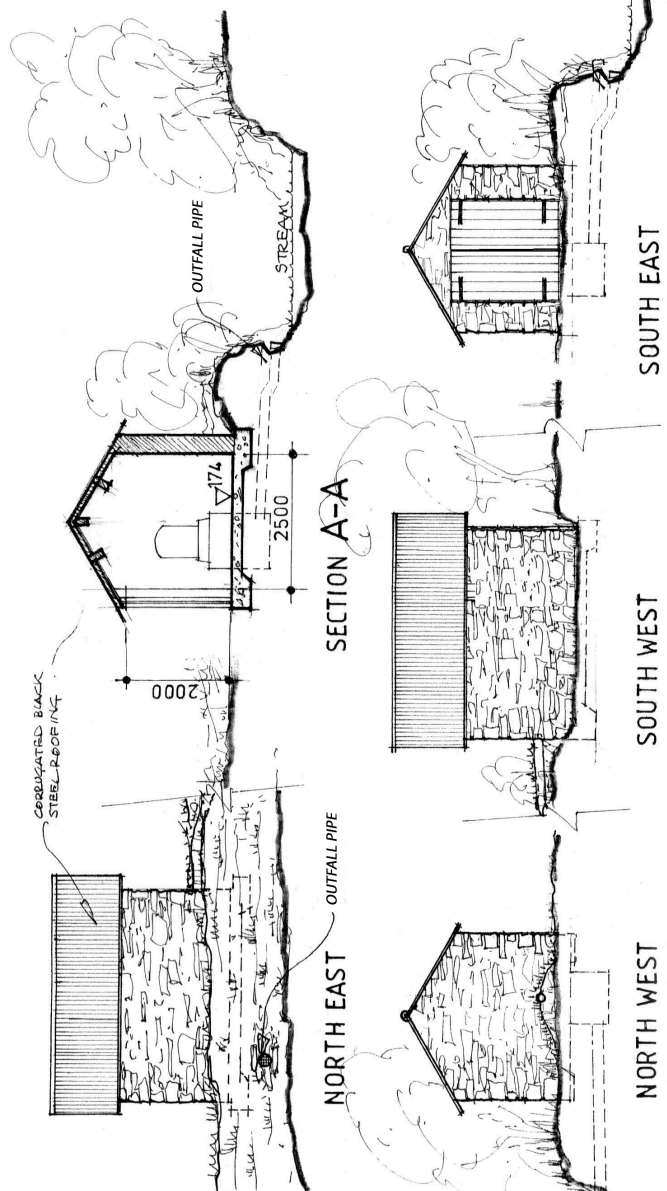

Turbine House:
 Concrete block construction with local stone facing built up off a concrete slab.
 Roof of black corrugated sheeting set at 30 degree pitch. Stonework taken up to underside of roof sheeting.
 Softwood boarded framed, ledged and braced door finished dark brown preservative stain.

160mm PEN STOCK