

# Permit with introductory note

The Environmental Permitting (England & Wales) Regulations 2016

---

Morgans of Usk Limited

Package treatment plant and infiltration  
system serving  
Alice Springs Court  
Kemys Commander  
Usk  
Monmouthshire  
NP15 1JG

Permit number

EPR/BB3497HV

**Package treatment plant and infiltration system  
serving Alice Springs Court  
Permit Number EPR/BB3497HV**

**Introductory note**

**This introductory note does not form a part of the permit**

The main features of the permit are as follows.

The permit allows a discharge of 10.8m<sup>3</sup>/day of secondary treated sewage effluent from a package treatment plant discharging to a British Standards infiltration system. The treatment system is serving a new development of 18, 2-bedroom apartments which are used as holiday lets.

The status log of the permit sets out the permitting history, including any changes to the permit reference number.

<b>Status log of the permit</b>		
<b>Description</b>	<b>Date</b>	<b>Comments</b>
Application PAN-005828	Duly made 29/07/2019	Application for discharge of secondary treated sewage effluent.
Permit determined EPR- BB3497HV	25/11/2019	Permit issued to Morgans of Usk Limited

End of introductory note

# Permit

The Environmental Permitting (England and Wales) Regulations 2016

## Permit number

**EPR/BB3497HV**

The Natural Resources Body for Wales (“Natural Resources Wales”) hereby authorises, under regulation 13 of the Environmental Permitting (England and Wales) Regulations 2016

**Morgans of Usk Limited** (“the operator”),

whose registered office is

**21 Gold Tops**

**Newport**

**Gwent**

**NP20 4PG**

company registration number **2137982**

to operate a groundwater activity at

**Alice Springs Court**

**Kemys Commander**

**Usk**

**Monmouthshire**

**NP15 1JG**

to the extent authorised by and subject to the conditions of this permit.

Name	Date
<b>Melissa Broad</b>	<b>25<sup>th</sup> November 2019</b>

Authorised on behalf of Natural Resources Wales

# Conditions

## 1 Management

### 1.1 General management

- 1.1.1 The operator shall manage and operate the activities:
- (a) in accordance with a written management system that identifies and minimises risks of pollution, including those arising from operations, maintenance, accidents, incidents, non-conformances and those drawn to the attention of the operator as a result of complaints; and
  - (b) using sufficient competent persons and resources.
- 1.1.2 Records demonstrating compliance with condition 1.1.1 shall be maintained.
- 1.1.3 Any person having duties that are or may be affected by the matters set out in this permit shall have convenient access to a copy of it kept at or near the place where those duties are carried out.

## 2 Operations

### 2.1 Permitted activities

- 2.1.1 The operator is only authorised to carry out the activities specified in schedule 1 table S1.1 (the "activities").

### 2.2 The site

- 2.2.1 The activities shall not extend beyond the site, being the land shown edged in green and the discharge shall be made at the point marked on the site plan at schedule 7 to this permit and as listed in table S3.2 (discharge points).

### 2.3 Operating techniques

- 2.3.1 The infiltration system specified in table S1.1 shall be constructed to comply with the following:
- (a) no part of the infiltration system constructed shall be more than 2 metres below ground level;
  - (b) no part of the infiltration system shall be less than 1.2 metres above the highest predicted annual groundwater level;
  - (c) the infiltration system shall not connect to any land drainage system;
  - (d) the infiltration system shall not be situated within 10 metres of any watercourse (including any ditch that runs dry for part of the year), or any other surface water;

- (e) the infiltration system shall not be situated within 50 metres of a well or borehole used for water supply.

2.3.2 The sewage treatment plant and infiltration system shall conform to all relevant British Standards in force at the time of installation.

## **3 Emissions and monitoring**

### **3.1 Emissions to water, air or land**

- 3.1.1 There shall be no point source emissions to water, air or land except from the sources and emission points listed in schedule 3 tables S3.1, S3.2 and S3.3.
- 3.1.2 The limits given in schedule 3 shall not be exceeded.

### **3.2 Emissions of substances not controlled by emission limits**

- 3.2.1 For the activity referenced in schedule 1, table S1.1 the operator shall take appropriate measures as far as is reasonably practicable:
  - (a) to prevent the input of hazardous substances to groundwater; and
  - (b) where a non-hazardous pollutant is not controlled by an emission limit, to limit the input of such non-hazardous pollutants to groundwater so as to ensure that inputs do not cause pollution of groundwater.

### **3.3 Monitoring**

- 3.3.1 Permanent means of access shall be provided to enable sampling/monitoring to be carried out in relation to the emission points specified in schedule 3 tables S3.1, S3.2 and S3.3 unless otherwise agreed in writing by Natural Resources Wales.

## **4 Information**

### **4.1 Records**

- 4.1.1 All records required to be made by this permit shall:
  - (a) be legible;
  - (b) be made as soon as reasonably practicable;
  - (c) if amended, be amended in such a way that the original and any subsequent amendments remain legible, or are capable of retrieval; and
  - (d) be retained, unless otherwise agreed in writing by Natural Resources Wales, for at least 6 years from the date when the records were made.
- 4.1.2 The operator shall keep on site all records, plans and the management system required to be maintained by this permit, unless otherwise agreed in writing by Natural Resources Wales.

## 4.2 Reporting

- 4.2.1 The operator shall send all reports and notifications required by the permit to Natural Resources Wales using the contact details supplied in writing by Natural Resources Wales.

## 4.3 Notifications

- 4.3.1 Natural Resources Wales shall be notified without delay following the detection of:
- (a) any malfunction, breakdown or failure of equipment or techniques, accident, or emission of a substance not controlled by an emission limit which has caused, is causing or may cause significant pollution;
  - (b) the breach of a limit specified in the permit; or
  - (c) any significant adverse environmental effects.
  - (d) any emergency discharge that has occurred.
- 4.3.2 Any information provided under condition 4.3.1 shall be confirmed by sending the information listed in schedule 5 to this permit within the time period specified in that schedule.
- 4.3.3 Where Natural Resources Wales has requested in writing that it shall be notified when the operator is to undertake monitoring and/or spot sampling, the operator shall inform Natural Resources Wales when the relevant monitoring and/or spot sampling is to take place. The operator shall provide this information to Natural Resources Wales at least 14 days before the date the monitoring is to be undertaken.
- 4.3.4 Natural Resources Wales shall be notified within 14 days of the occurrence of the following matters, except where such disclosure is prohibited by Stock Exchange rules:
- Where the operator is a registered company:
- (a) any change in the operator's trading name, registered name or registered office address; and
  - (b) any steps taken with a view to the operator going into administration, entering into a company voluntary arrangement or being wound up.
- Where the operator is a corporate body other than a registered company:
- (a) any change in the operator's name or address; and
  - (b) any steps taken with a view to the dissolution of the operator.
- 4.3.5 Where the operator proposes to make a change in the nature or functioning, or an extension of the activities, which may have consequences for the environment and the change is not otherwise the subject of an application for approval under the Regulations or this permit:
- (a) Natural Resources Wales shall be notified at least 14 days before making the change; and
  - (b) the notification shall contain a description of the proposed change in operation.

## **4.4 Interpretation**

- 4.4.1 In this permit the expressions listed in schedule 6 shall have the meaning given in that schedule.
- 4.4.2 In this permit references to reports and notifications mean written reports and notifications, except where reference is made to notification being made “without delay”, in which case it may be provided by telephone.

# Schedule 1 – Operations

Table S1.1 Activities	
Description of activity	Limits of specified activity
Groundwater activity: discharge into land of secondary treated sewage effluent	<p>The drainage field shall be designed in accordance with the British Standard BS 6297:2007+A1:2008 'Code of practice for the design and installation of drainage fields for use in wastewater treatment'. (All following references to 'the British Standard' are references to this document).</p> <p>Where the minimum British Standard percolation test value (Vp) of 15 as referred in section 6.2 of the British Standard cannot be complied with the discharge is permissible only if the following additional requirements apply:</p> <ul style="list-style-type: none"> <li>i. the minimum floor area of the drainage field shall be calculated using a Vp equal to 15; and</li> <li>ii. a minimum 700 mm deep layer of medium or coarse washed sand shall be laid on a geotextile membrane, below the granular fill distribution layer as referred to in section 6.6, figures 4 and 5 of the British Standard.</li> </ul>



## **Schedule 2 - Waste types, raw materials and fuels**

Wastes are not accepted as part of the permitted activities and there are no restrictions on raw materials or fuels under this schedule.

## Schedule 3 – Emissions and monitoring

**Table S3.1 Point Source emissions to water (other than sewer) and land – emission limits and monitoring requirements**

Emission point ref. & location	Parameter	Limit (incl. unit)	Reference Period	Monitoring frequency	Compliance statistic
Outlet 1 on site plan in schedule 7 outflow from sewage treatment plant prior to discharge into drainage field	Maximum daily flow	10.8 m <sup>3</sup> /day	Total daily volume	N/A	Maximum
	Visible oil or grease	No significant trace present	Instantaneous (spot sample)	N/A	No significant trace

**Table S3.2 Discharge points**

Effluent Name	Discharge Point	Discharge point NGR	Receiving Environment
Secondary treated sewage effluent	Outlet 1	SO 34732 05457	Groundwater via an infiltration system

**Table S3.3 Monitoring points**

Effluent and discharge point	Monitoring type	Monitoring point NGR	Monitoring point reference
Secondary treated sewage effluent via outlet 1	Effluent sampling	SO 34732 05457	Outlet 1

## **Schedule 4 - Reporting**

There is no reporting under this schedule.

## Schedule 5 - Notification

These pages outline the information that the operator must provide.

Units of measurement used in information supplied under Part A and B requirements shall be appropriate to the circumstances of the emission. Where appropriate, a comparison should be made of actual emissions and authorised emission limits.

If any information is considered commercially confidential, it should be separated from non-confidential information, supplied on a separate sheet and accompanied by an application for commercial confidentiality under the provisions of the EP Regulations.

### Part A

Permit Number	EPR-BB3497HV
Name of operator	
Location of Facility	Alice Springs, Kemys Commander, Usk, Monmouthshire NP15 1JG
Time and date of the detection	

#### (a) Notification requirements for any malfunction, breakdown or failure of equipment or techniques, accident, or emission of a substance not controlled by an emission limit which has caused, is causing or may cause significant pollution

##### To be notified within 24 hours of detection

Date and time of the event	
Reference or description of the location of the event	
Description of where any release into the environment took place	
Substances(s) potentially released	
Best estimate of the quantity or rate of release of substances	
Measures taken, or intended to be taken, to stop any emission	
Description of the failure or accident.	

#### (b) Notification requirements for the breach of a limit

##### To be notified within 24 hours of detection unless otherwise specified below

Emission point reference/ source	
Parameter(s)	
Limit	
Measured value and uncertainty	
Date and time of monitoring	
Measures taken, or intended to be taken, to stop the emission	

Time periods for notification following detection of a breach of a limit	
Parameter	Notification period

(c) Notification requirements for the detection of any significant adverse environmental effect	
To be notified within 24 hours of detection	
Description of where the effect on the environment was detected	
Substances(s) detected	
Concentrations of substances detected	
Date of monitoring/sampling	

## Part B - to be submitted as soon as practicable

Any more accurate information on the matters for notification under Part A.	
Measures taken, or intended to be taken, to prevent a recurrence of the incident	
Measures taken, or intended to be taken, to rectify, limit or prevent any pollution of the environment which has been or may be caused by the emission	
The dates of any unauthorised emissions from the facility in the preceding 24 months.	

<b>Name*</b>	
<b>Post</b>	
<b>Signature</b>	
<b>Date</b>	

\* authorised to sign on behalf of the operator

## Schedule 6 - Interpretation

“accident” means an accident that may result in pollution.

“annually” means once every year.

“application” means the application for this permit, together with any additional information supplied by the operator as part of the application and any response to a notice served under Schedule 5 to the EP Regulations.

“emissions to land” includes emissions to groundwater.

“EP Regulations” means The Environmental Permitting (England and Wales) Regulations SI 2016 No.1154 and words and expressions used in this permit which are also used in the Regulations have the same meanings as in those Regulations.

“emissions of substances not controlled by emission limits” means emissions of substances to air, water or land from the activities, either from the emission points specified in schedule 3 or from other localised or diffuse sources, which are not controlled by an emission limit.

“groundwater” means all water, which is below the surface of the ground in the saturation zone and in direct contact with the ground or subsoil.

“Natural Resources Wales” means the Natural Resources Body for Wales established by article 3 of the Natural Resources Body for Wales (Establishment) Order 2012. The Natural Resources Body for Wales (Functions) Order 2013 transferred the relevant functions of the Countryside Council for Wales, and functions of the Environment Agency and the Forestry Commission in Wales to the Natural Resources Body for Wales.

“quarter” means a calendar year quarter commencing on 1 January, 1 April, 1 July or 1 October.

“year” means calendar year ending 31 December.

# Schedule 7 - Site plan

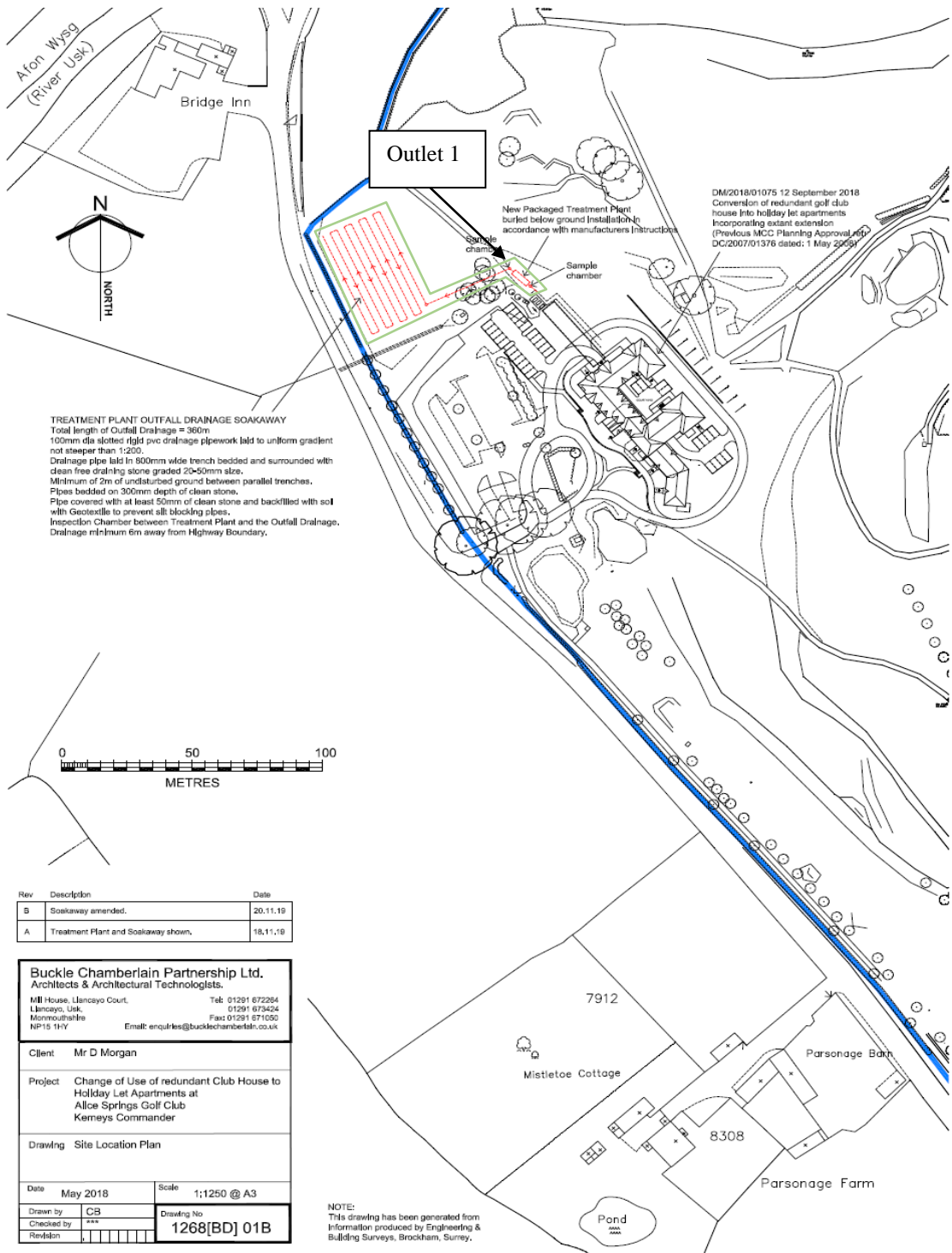

© Crown Copyright and database right 2019. Ordnance Survey licence number 100019741.

END OF PERMIT