

Notes

1. This drawing has been prepared in accordance with the scope of RPS's appointment with its client and is subject to the terms and conditions of that appointment. RPS accepts no liability for any use of this document other than by its client and only for the purposes for which it was prepared and provided.
2. If received electronically it is the recipients responsibility to print to correct scale. Only written dimensions should be used.
3. This drawing should be read in conjunction with all other relevant drawings and specifications.

Legend

- Landscaped Area
- Existing Shrubby Area
- Existing Native Trees and Shrubs
- Concrete
- Aggregate Crushed Stone
- Ditch / Reen
- Denotes Existing structure to be made good
- Denotes new works to powerstation

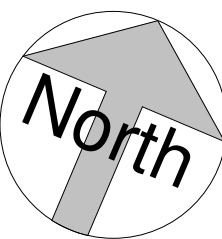

P06	Drawing revised and updated to reflect new topographical survey	PBR	TFH	12/09/19
P05	Site boundary revised	PBR	TFH	01/08/19
P04	Drawing revised to current details	PBR	TFH	03/07/19
P03	Drawing sent to team prior to design change	PBR	TFH	14/06/19
P02	Drawing revised and updated to show day silo adjacent main power station, new lime silo adjacent existing and primary storage facility to show 4 large silos	PBR	NB	07/06/19
P01	Initial Issue	PBR	TFH	21.05.19
Rev	Description	By	Ckd	Date



Suite D10, Josephs Well, Hanover Walk
Leeds, West Yorkshire LS3 1AB, United Kingdom
T:0113 220 6190 E:exp@rpsgroup.com

Client



Project SUP Fuel Conversion project

Title Proposed SUP Site Plan

Status	Scale @ A1	Date Created
Preliminary	As indicated	20/05/19
Task Team Manager	Information Author	Task Information Manager
TFH	PBR	NB

Document Number
019784-RPS-SI-ZZ-DR-A-5003

Project Code - Originator - Zone - Level - Type - Role - Drawing Number

RPS Project Number	Suitability	Revision
NK019784	S0	P06
rpsgroup.com		

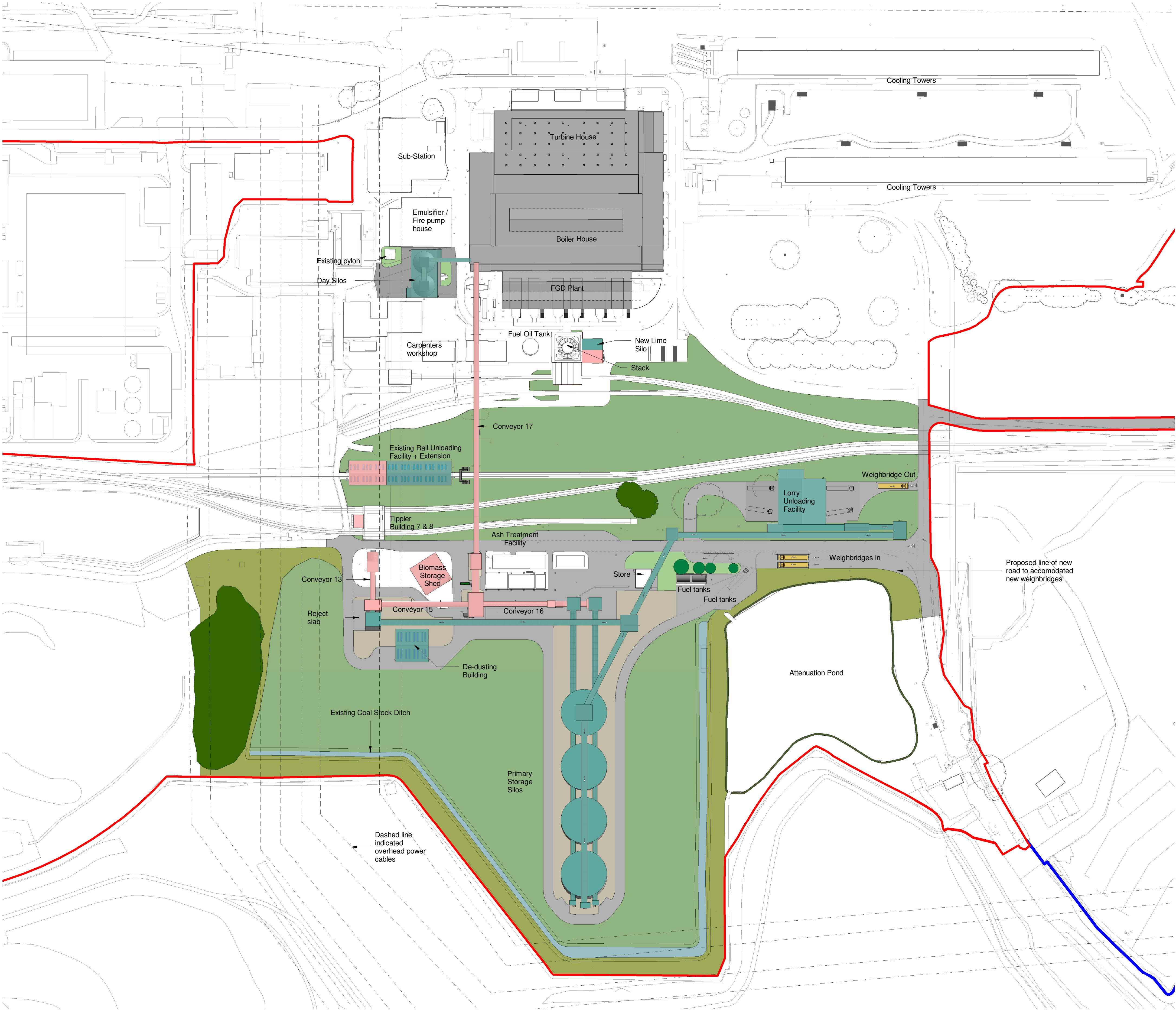

1 Site Plan.
1 : 1250

