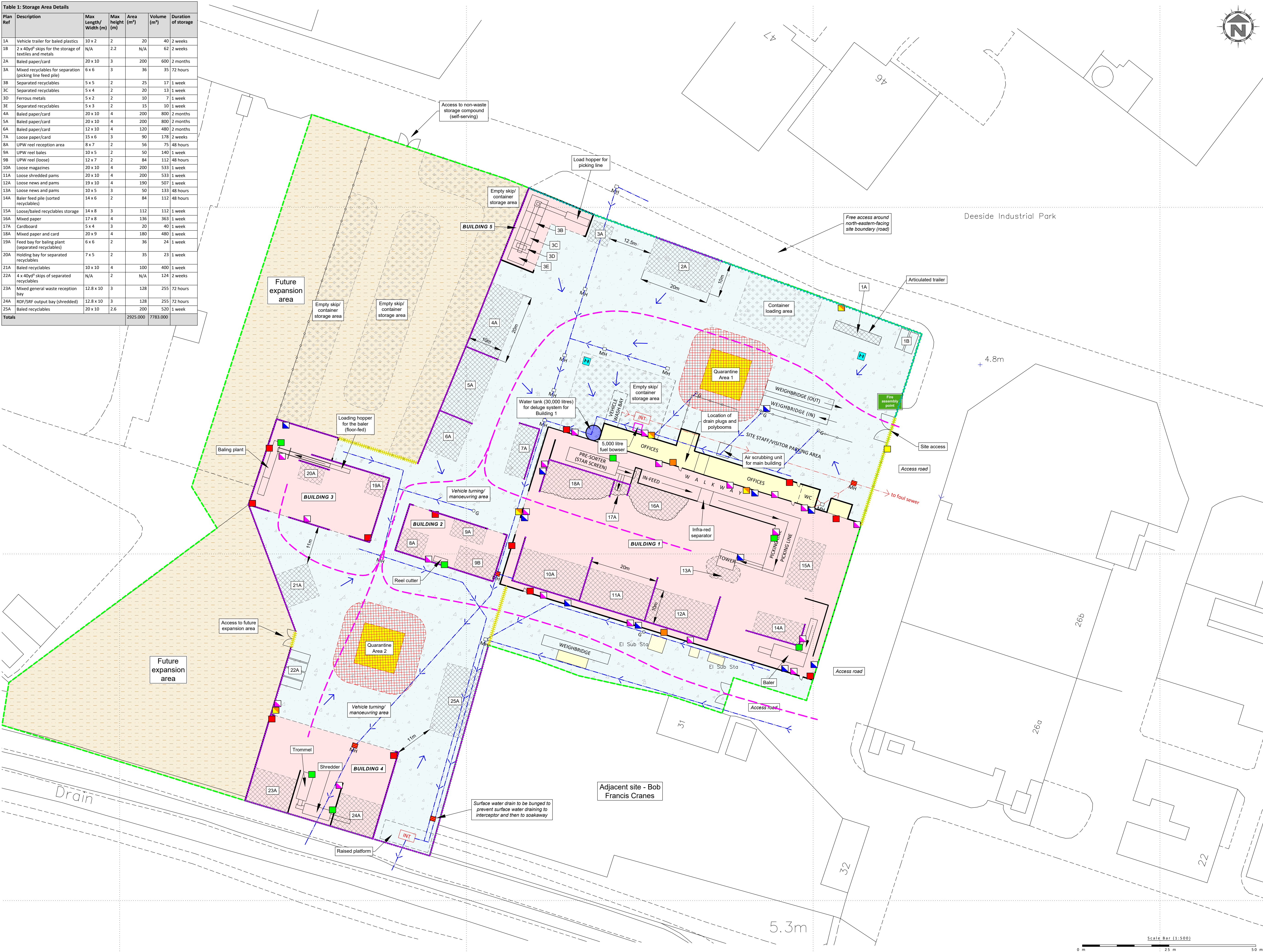

Table 1: Storage Area Details					
Plan Ref	Description	Max Length/Width (m)	Max height (m)	Area (m²)	Volume (m³)
1A	Vehicle trailer for baled plastics	10 x 2	2	20	40
1B	2 x 40yd³ skips for the storage of textiles and metals	N/A	2.2	N/A	62
2A	Baled paper/card	20 x 10	3	200	600
3A	Mixed recyclables for separation (picking line feed pile)	6 x 6	3	36	35
3B	Separated recyclables	5 x 5	2	25	17
3C	Separated recyclables	5 x 4	2	20	13
3D	Ferrous metals	5 x 2	2	10	7
3E	Separated recyclables	5 x 3	2	15	10
4A	Baled paper/card	20 x 10	4	200	800
5A	Baled paper/card	20 x 10	4	200	800
6A	Baled paper/card	12 x 10	4	120	480
7A	Loose paper/card	15 x 6	3	90	178
8A	UPW reel reception area	8 x 7	2	56	75
9A	UPW reel bales	10 x 5	2	50	140
9B	UPW reel (loose)	12 x 7	2	84	112
10A	Loose magazines	20 x 10	4	200	533
11A	Loose shredded pams	20 x 10	4	200	533
12A	Loose news and pams	19 x 10	4	190	507
13A	Loose news and pams	10 x 5	3	50	133
14A	Baler feed pile (sorted recyclables)	14 x 6	2	84	112
15A	Loose/baled recyclables storage	14 x 8	3	112	112
16A	Mixed paper	17 x 8	4	136	363
17A	Cardboard	5 x 4	3	20	40
18A	Mixed paper and card	20 x 9	4	180	480
19A	Feed bay for baling plant (separated recyclables)	6 x 6	2	36	24
20A	Holding bay for separated recyclables	7 x 5	2	35	23
21A	Baled recyclables	10 x 10	4	100	400
22A	4 x 40yd³ skips of separated recyclables	N/A	2	N/A	124
23A	Mixed general waste reception bay	12.8 x 10	3	128	255
24A	RDF/SRF output bay (shredded)	12.8 x 10	3	128	255
25A	Baled recyclables	20 x 10	2.6	200	520
Totals				2925.000	7783.000



NOTES  
Drawing for indication only. Reproduced with the permission of the controller of H.M.S.O. Crown copyright licence No. 100022432. This drawing is copyright and property of Oaktree Environmental Ltd

REVISION HISTORY			
Rev	Date	Init	Description
-	21.1.19	RS	Initial Drawing

- Key:
- Permit boundary
  - Storage areas (see Table 1 for full details)
  - Other (non-waste operational/storage areas)
  - Sealed buildings
  - Concrete areas
  - Stone surface (free-draining)
  - Other buildings (offices, etc.)
  - Quarantine area (with 6m buffer zone)
  - MH Manhole (surface and foul)
  - INT Interceptor
  - G Gully
  - Mains water / hose reel
  - Spill kit
  - Fire fighting equipment (extinguishers, etc.)
  - Main electrics shut off
  - Access routes for emergency vehicles
  - Fire alarm
  - Surface water drainage
  - Foul water drainage
  - Concrete firewall
  - Concrete kerbing (min 150 mm)
  - Polyboom deployment locations (150 mm)
  - Manholes/drainage to be plugged in the event of a fire incident
  - Plant electric control boxes
  - Drainage fall direction
  - Emergency box location

**Oaktree Environmental Ltd**  
Waste, Planning and Environmental Consultants

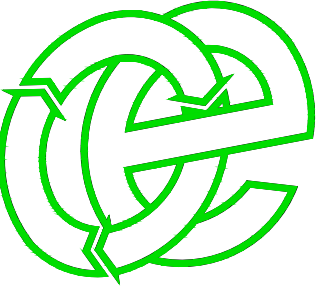

DRAWING TITLE  
LAYOUT & FIRE PLAN

CLIENT  
Parry & Evans Ltd

PROJECT/SITE  
Unit 103, Zone 1, Deeside Industrial Park, Flintshire CH5 2LR

SCALE @ A1  
1:500

JOB NO  
002

CLIENT NO  
1537

DRAWING NUMBER  
1537-DEE-MAP-03

REV  
-

STATUS  
Issued

DRAWN  
RS

CHECKED  
RS

DATE  
17.12.19

Lime House, Road Two, Winsford, Cheshire, CW7 3QZ  
t: 01606 558833 | e: sales@oaktree-environmental.co.uk