

0 10 100
Millimetres

DO NOT SCALE

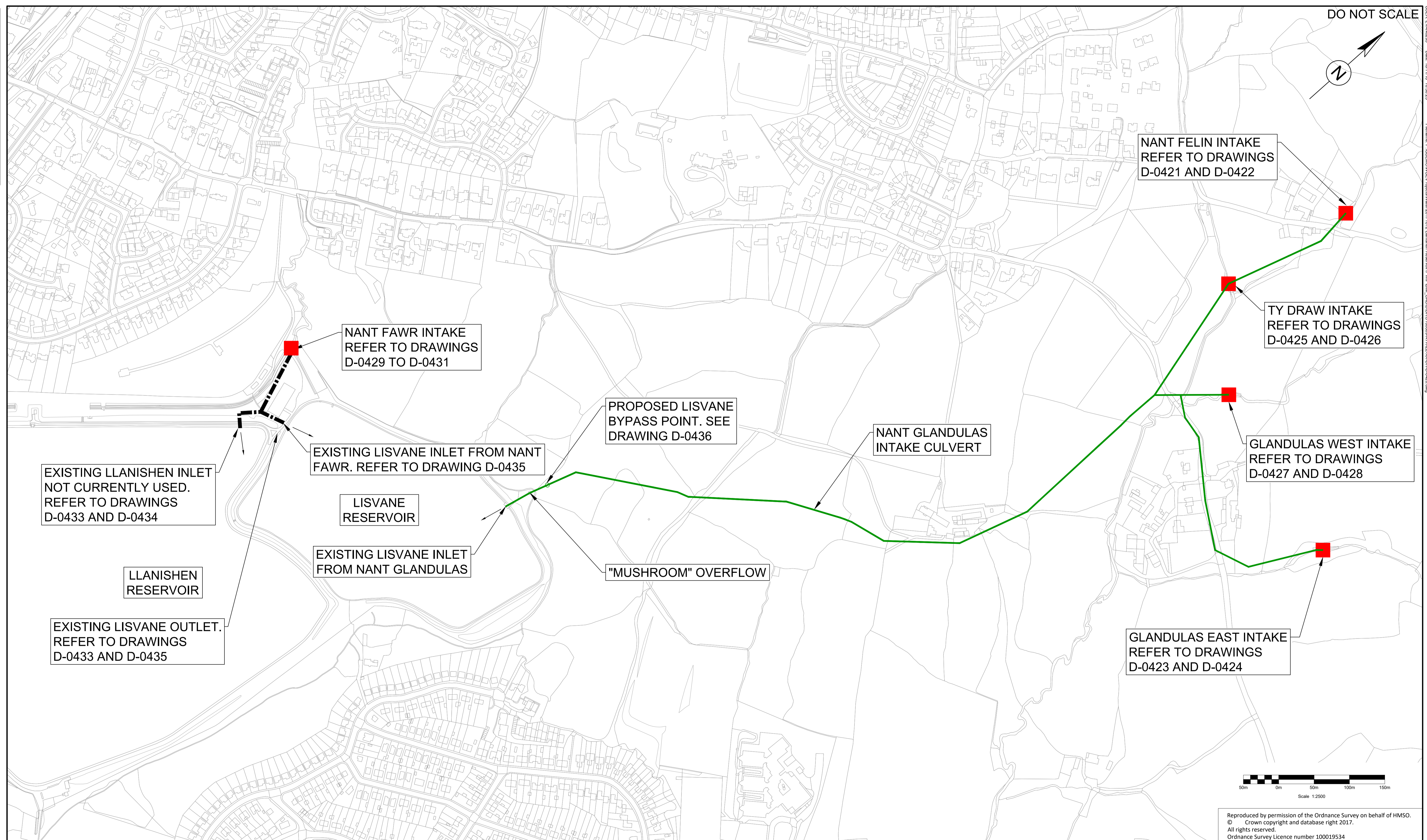
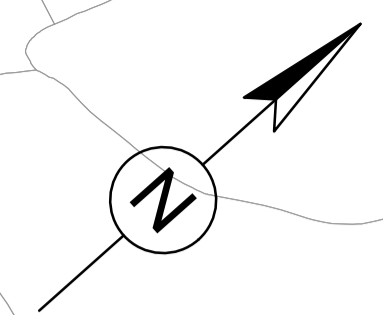

EXISTING LLANISHEN INLET
NOT CURRENTLY USED.
REFER TO DRAWINGS
D-0433 AND D-0434

LLANISHEN
RESERVOIR

EXISTING LISVANE OUTLET.
REFER TO DRAWINGS
D-0433 AND D-0435

NANT FAWR INTAKE
REFER TO DRAWINGS
D-0429 TO D-0431

EXISTING LISVANE INLET FROM NANT
FAWR. REFER TO DRAWING D-0435

LISVANE
RESERVOIR

EXISTING LISVANE INLET
FROM NANT GLANDULAS

PROPOSED LISVANE
BYPASS POINT. SEE
DRAWING D-0436

"MUSHROOM" OVERFLOW

NANT GLANDULAS
INTAKE CULVERT

NANT FELIN INTAKE
REFER TO DRAWINGS
D-0421 AND D-0422

TY DRAW INTAKE
REFER TO DRAWINGS
D-0425 AND D-0426

GLANDULAS WEST INTAKE
REFER TO DRAWINGS
D-0427 AND D-0428

GLANDULAS EAST INTAKE
REFER TO DRAWINGS
D-0423 AND D-0424

50m 0m 50m 100m 150m
Scale 1:2500

Reproduced by permission of the Ordnance Survey on behalf of HMSO.
© Crown copyright and database right 2017.
All rights reserved.
Ordnance Survey Licence number 100019534

- NOTES**
- ALL LEVELS IN METERS TO ORDNANCE DATUM NEWLYN.
 - ALL DIMENSIONS IN MILLIMETERS UNLESS OTHERWISE STATED.
 - WORKS TO BE IN ACCORDANCE WITH CESWI 7th EDITION AND DCWW CIVIL ENGINEERING SPECIFICATION OCTOBER 2013 ALONG WITH ATKINS SUPPLEMENTARY SPECIFICATION REF. 5160809-ATK-ZZ-RP-C-1037.



SAFETY, HEALTH AND ENVIRONMENTAL INFORMATION			
In addition to the hazards/risks normally associated with the types of work detailed on this drawing, note the following:			
CONSTRUCTION			
REFER TO INDIVIDUAL DRAWINGS FOR SPECIFIC SHE INFORMATION			
MAINTENANCE/CLEANING			
REFER TO INDIVIDUAL DRAWINGS FOR SPECIFIC SHE INFORMATION			
DECOMMISSIONING/DEMOLITION			
REFER TO INDIVIDUAL DRAWINGS FOR SPECIFIC SHE INFORMATION			
It is assumed that all works will be carried out by a competent contractor working, where appropriate, to an approved method statement			

Rev.	Date	Description	By	CHK'd	App'd
C1	16/11/18	FOR CONSTRUCTION	ARJ	AJM	CL
P3	28/08/18	CHANGES FOLLOWING DESIGN REVIEW	AN		
P2	03/08/18	CHANGES FOLLOWING DESIGN REVIEW			
P1	31/07/18	FIRST ISSUE			

Drawing Status: **FOR CONSTRUCTION**

ATKINS

West Glamorgan House
12 Orchard Street
Swansea
SA1 5AD

Tel: +44 (0)1792 641172
Fax: +44 (0)1792 472019
www.atkinsglobal.com

Copyright © Atkins Limited (2018)

Client:

Project Title		LLANISHEN RESERVOIR			
Drawing Title		INTAKE PLAN			
Scale	Designed	Drawn	Checked	Authorised	
1:2500	TR	AP	AJM	CL	
Original Size	Date	Date	Date	Date	
A1	05/07/18	06/07/18	16/11/18	16/11/18	
Drawing Number					Revision
5160809-ATK-ZZ-XX-DR-D-0420					C1