

100 / 01 - General Arrangement

1:50

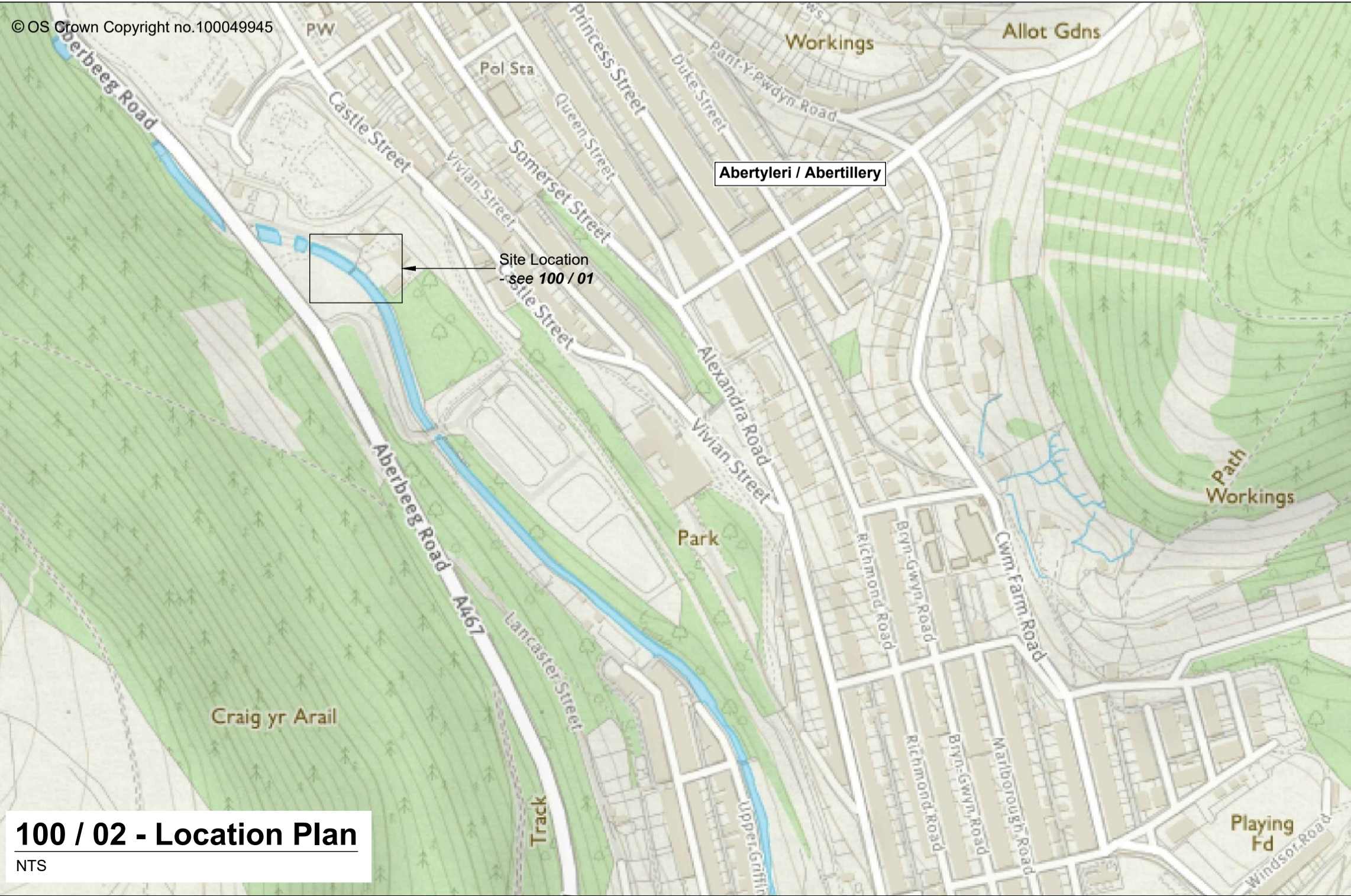

SAFETY HEALTH & ENVIRONMENTAL INFORMATION

In addition to the hazards/risks normally associated with the type of work detailed on this drawing, note the following risks and information.

Risks listed here are not exhaustive. Refer to Designer's Risk Assessment and pre-construction phase plan.

CONSTRUCTION

C1

Managing flow & stage levels in River Ebbw Fach

- Monitor flow levels & flood warnings.
- Check adequacy of cut-off & stability of cofferdams.

C2

Managing seepage flows through weir

- Monitor seepage.
- Check stability of cut face in weir and assess permeability of formation material.
- Check adequacy of cut-off & stability of cofferdams.

C3

Risk of falls from height

- Check depth of excavations.
- Check adequate edge protection and access provision onto weir.

C4

Lifting

- Check crane lifting facilities & constraints.
- Check access weight & size restrictions for crane at bridge crossings along access route to site.

C5

Interface with public & other site operations

- Check adequate warning signs and fencing in place.

C6

Services

- Check for services.

C7

Stability of Excavations & Structures

- Carry out inspection pits to check weir construction & depth to footings for adjoining abutment wall.
- Check temporary works & construction sequencing to maintaining structural integrity of weir and stability of adjacent abutment wall.

ENVIRONMENTAL

E1

Japanese Knotweed Present

- To be removed as a controlled substance by a certified contractor.

E2

Contamination

- Contractor to monitor arisings and prevent release of harmful materials into watercourse

For information relating to Use, Cleaning and Maintenance see the Health and Safety File

It is assumed that all works will be carried out by a competent contractor working, where appropriate, to an approved method statement

NOTES:

1. DIMENSIONS:

- Are in millimetres unless otherwise stated.
- Marked thus (*) are approximate.
- All levels are in metres to Site Datum.

2. SPECIFICATION:

All works to be carried out in accordance with the Natural Resources Wales Minimum Technical Requirements which shall be the latest edition of the Civil Engineering Specification for the Water Industry (CESWI).

For Information Purposes only

Not for construction

| | | |
|---------------------------------------|----------------|--------------------------|
| A05 | Outline Design | 29 / 05 / 20 |
| A04 | Outline Design | 16 / 04 / 20 |
| A03 | Outline Design | 11 / 03 / 20 |
| A02 | Outline Design | 10 / 03 / 20 |
| A01 | Outline Design | 05 / 03 / 20 |
| Issue | Description | Date |
| Status | | |
| Outline Design | | |
| Scales | As shown | Current Issue Signatures |
| Original Size | A1 | Author M. Giblin |
| Datum | N / A | Checker G. Bilotta |
| Grid | N / A | Approver T. Coe |
| © Copyright reserved | | |
| Filename: | | |
| Client | | |
| | | |
| | | |
| PROJECT | | |
| 02769 Gas Works Fish Pass | | |
| TITLE | | |
| Outline Design General Arrangement | | |
| Drawing No. | Project No. | Issue |
| 0100 | - 02769 | - A05 |

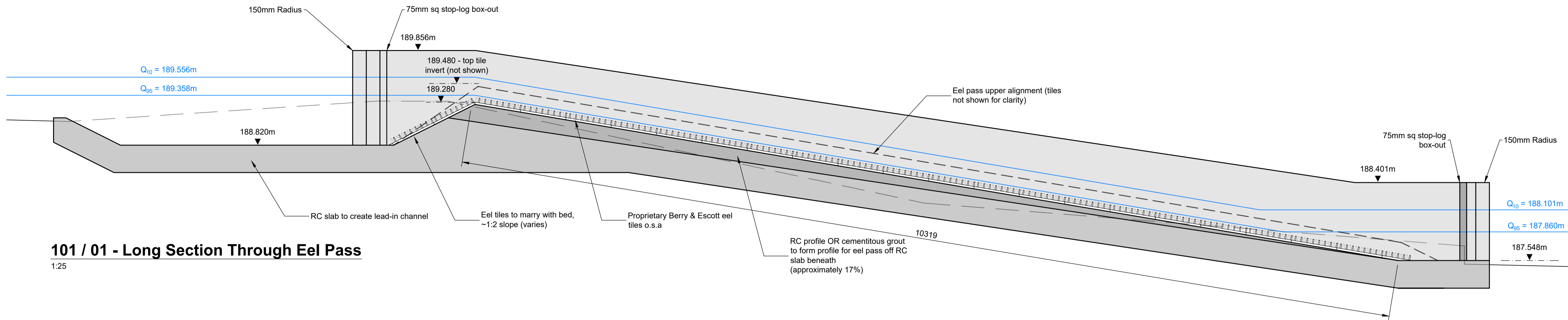

101 / 01 - Long Section Through Eel Pass

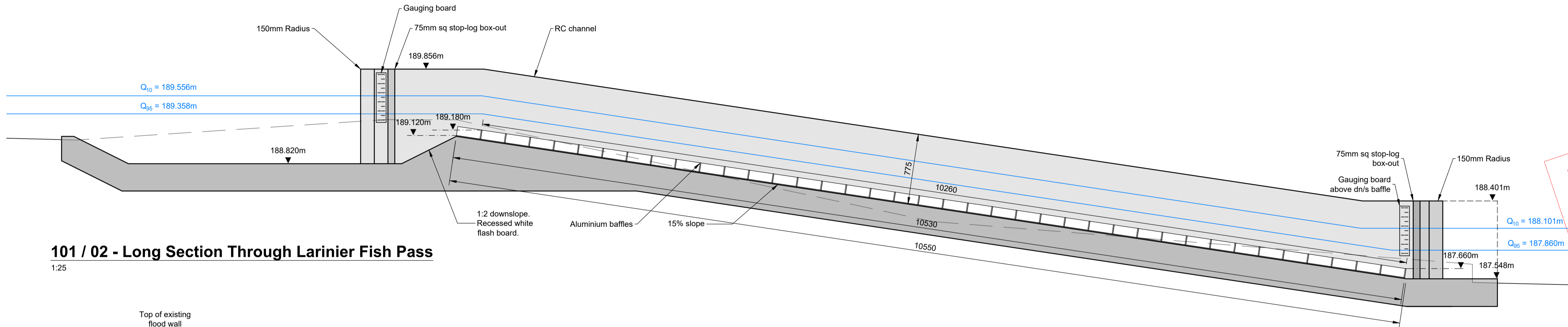

101 / 02 - Long Section Through Larinier Fish Pass

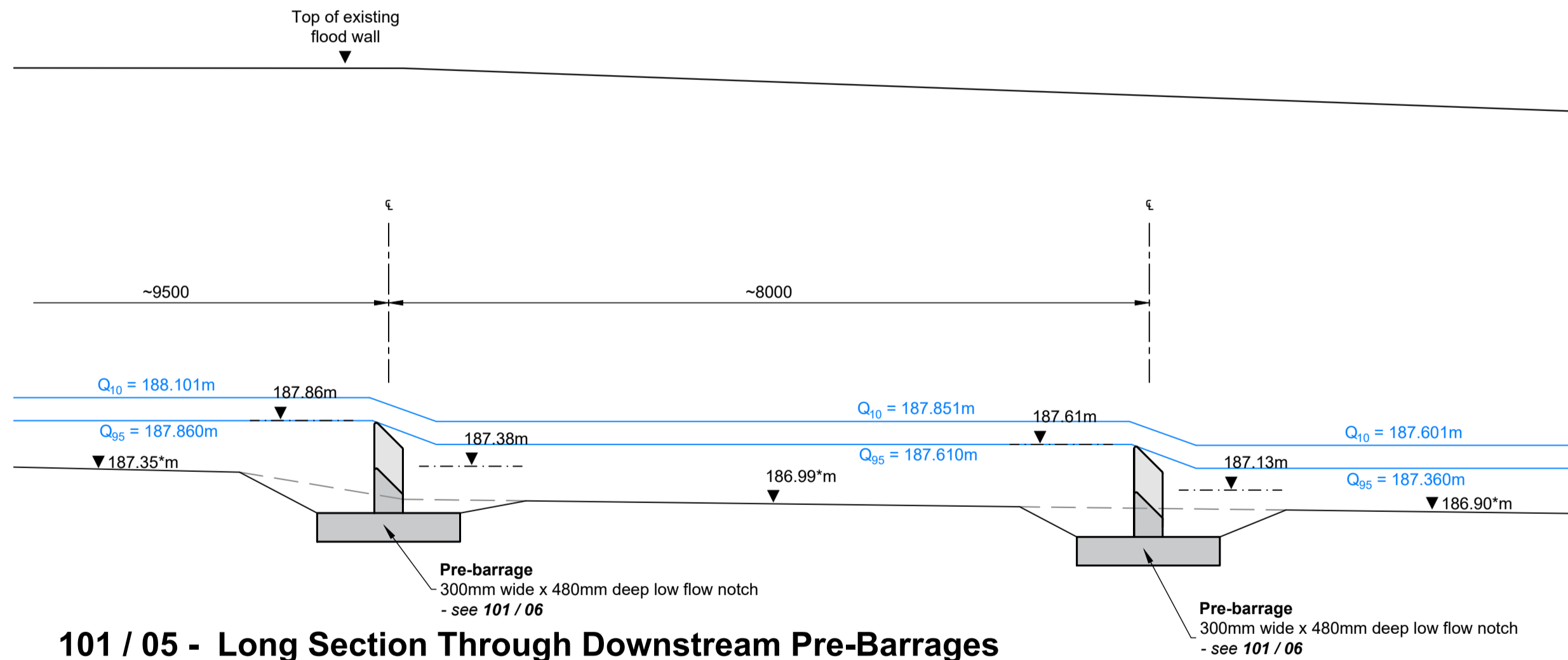

101 / 05 - Long Section Through Downstream Pre-Barrages

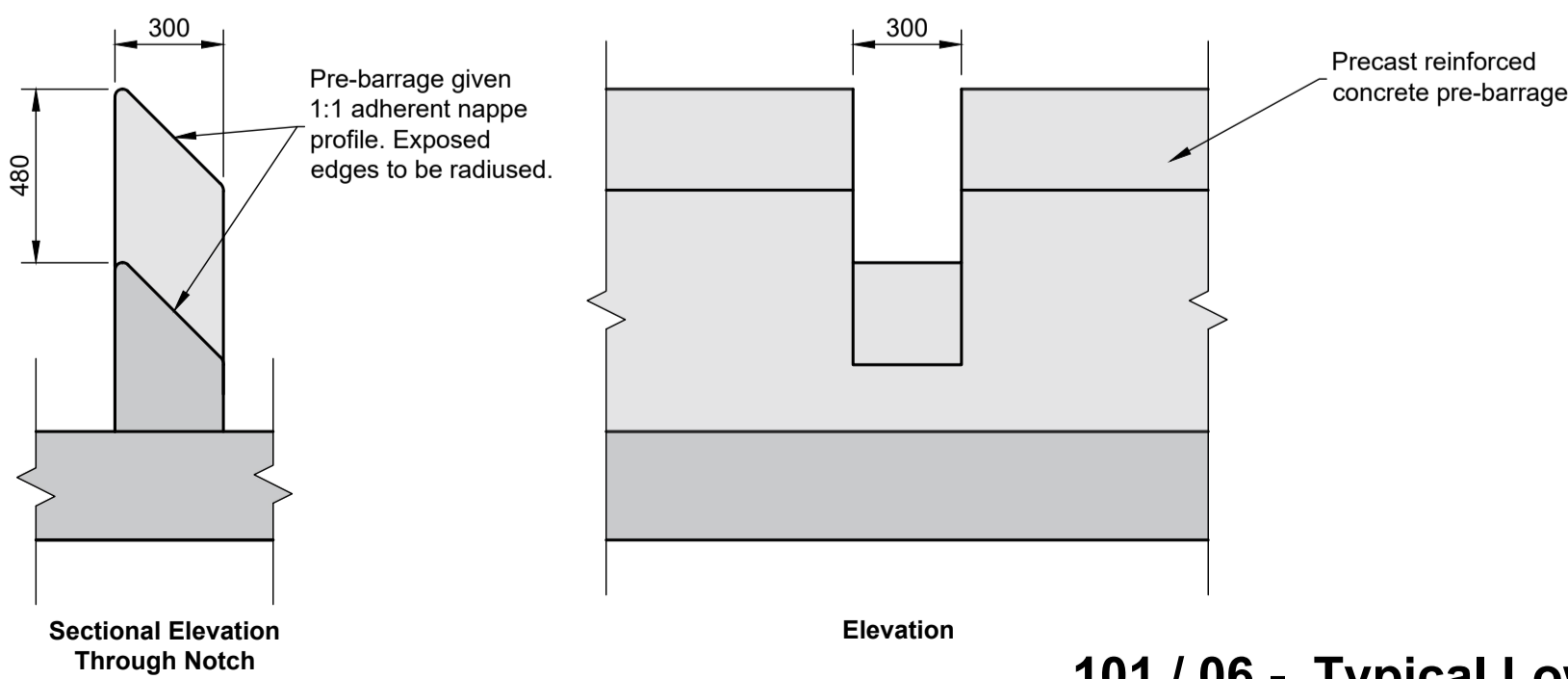

101 / 06 - Typical Low Flow Notch Detail

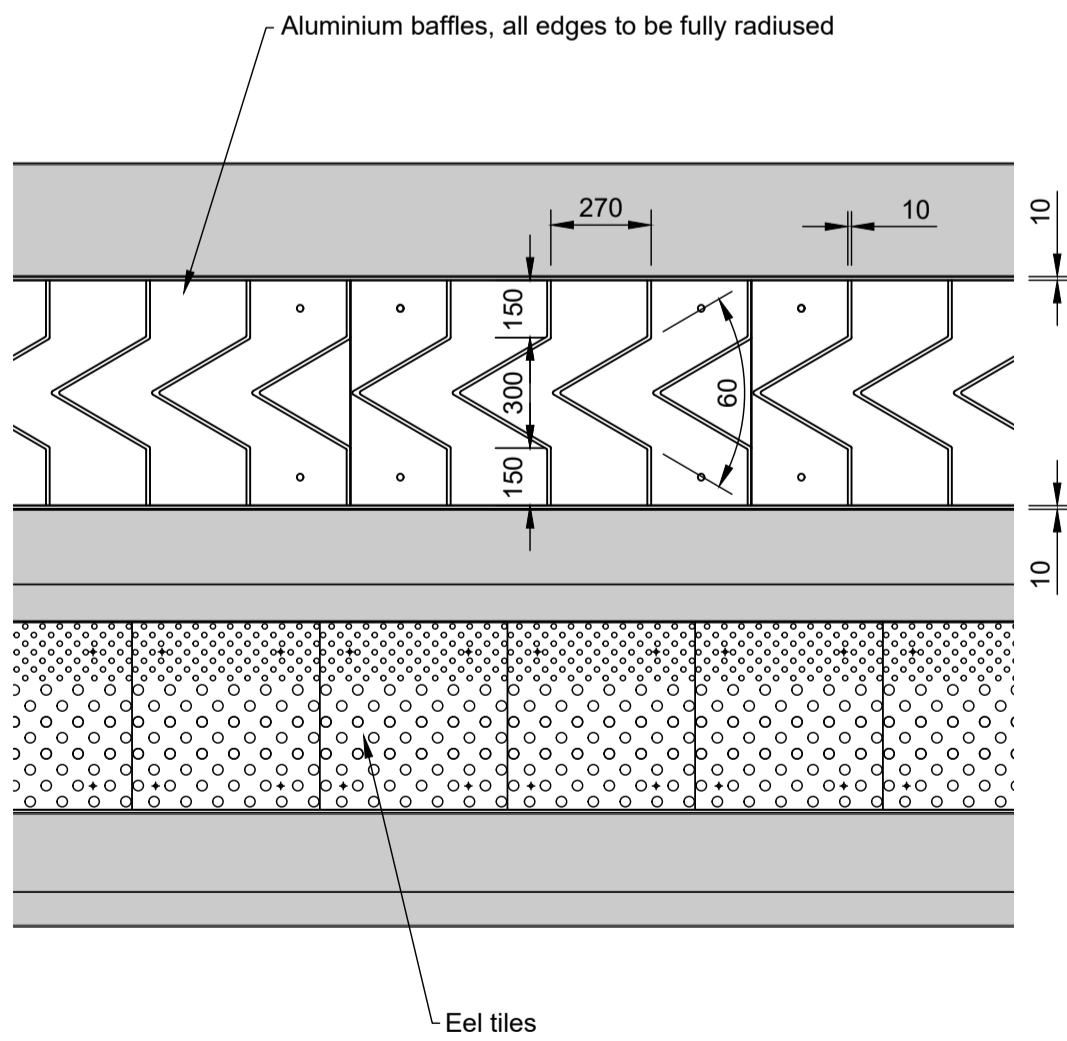

101 / 04 - Larinier Baffle & Eel Tile Typical Plan

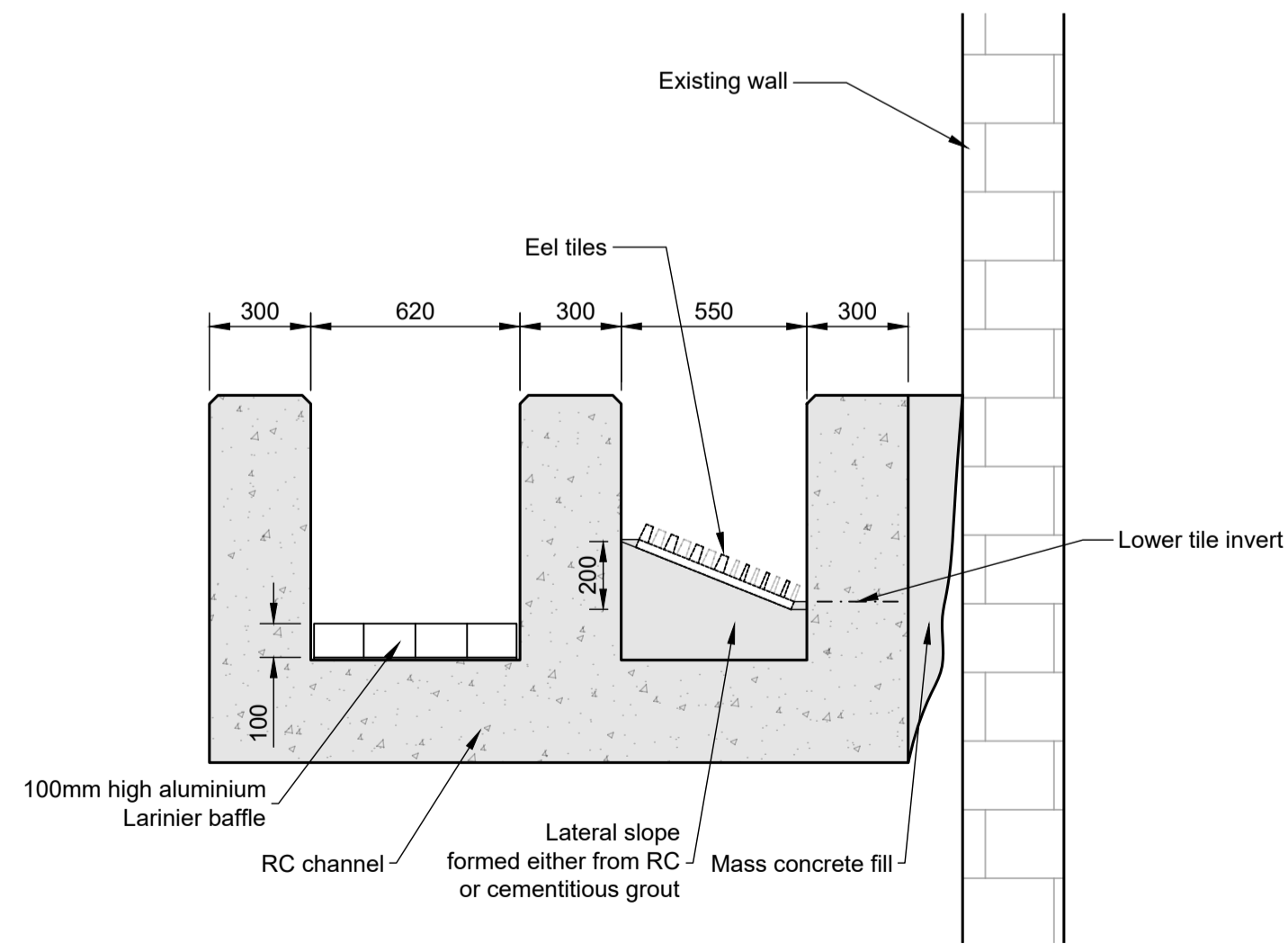

101 / 03 - Section Through Pass

NOTES:

1. **DIMENSIONS:**
- Are in millimetres unless otherwise stated.
 - Marked thus (*) are approximate.
 - All levels are in metres to Site Datum.
2. **SPECIFICATION:**
- All works to be carried out in accordance with the Natural Resources Wales Minimum Technical Requirements which shall be the latest edition of the Civil Engineering Specification for the Water Industry (CESWI).

For Information Purposes only

Not for construction

| A05 | Outline Design | 29 / 05 / 20 |
|-------|----------------|--------------|
| A04 | Outline Design | 16 / 04 / 20 |
| A03 | Outline Design | 11 / 03 / 20 |
| A02 | Outline Design | 10 / 03 / 20 |
| A01 | Outline Design | 05 / 03 / 20 |
| Issue | Description | Date |

| Outline Design | | | |
|----------------|----------|--------------------------|------------|
| Scales | As shown | Current Issue Signatures | |
| | | Author | M. Giblin |
| Original Size | A1 | Checker | G. Bilotta |
| Datum | N / A | Approver | T. Coe |
| Grid | N / A | © Copyright reserved | |

| | |
|-----------|---|
| Filename: | |
| Client |  |

| |
|---|
|  |
|---|

| | |
|---------|------------------------------|
| PROJECT | 02769 Gas Works Fish Pass |
|---------|------------------------------|

| | |
|-------|--|
| TITLE | Outline Design Sections and Details |
|-------|--|

| | | |
|-------------|-------------|-------|
| Drawing No. | Project No. | Issue |
| 0101 | - 02769 | - A05 |