

Evacuation Zoning

Evacuation Zoning		
Site Areas	Local Evacuation Point	Full Site Evacuation Point
Preproduction (including boilers) Engineering Workshop Stores Refiner Particle Board Press & Finishing Line T&G Middle Road Offices (Purchasing, Management Office, Projects, Engineering, Fire) Paper Impregnation (VITS) MF Resin ESMIL Canteen	Middle Road – Base of the stairs to the Canteen	Main Car Park Area "A"
Despatch Warehouse Sales / Despatch / IT Offices Weighbridge EHS & Fire Offices Reception	Despatch Walkway – By canopy entrance	Main Car Park Area "B"
MDF Press & MDF Finishing Line Process Lab Technical Office Farmhouse	Farmhouse Gate	Main Car Park Area "C"
Sawmill Chip Preparation Logyard Silos Gas Engines Chipper	Sawmill Walkway – South-side	Main Car Park Area "D"
Formalin.	Sawmill Walkway – North-side	Main Car Park Area "D"
Kronoplus Logyard (Excluding Chipper) Garage	North Gate – Await instruction from Fire Team to ensure safe evacuation	North Gate

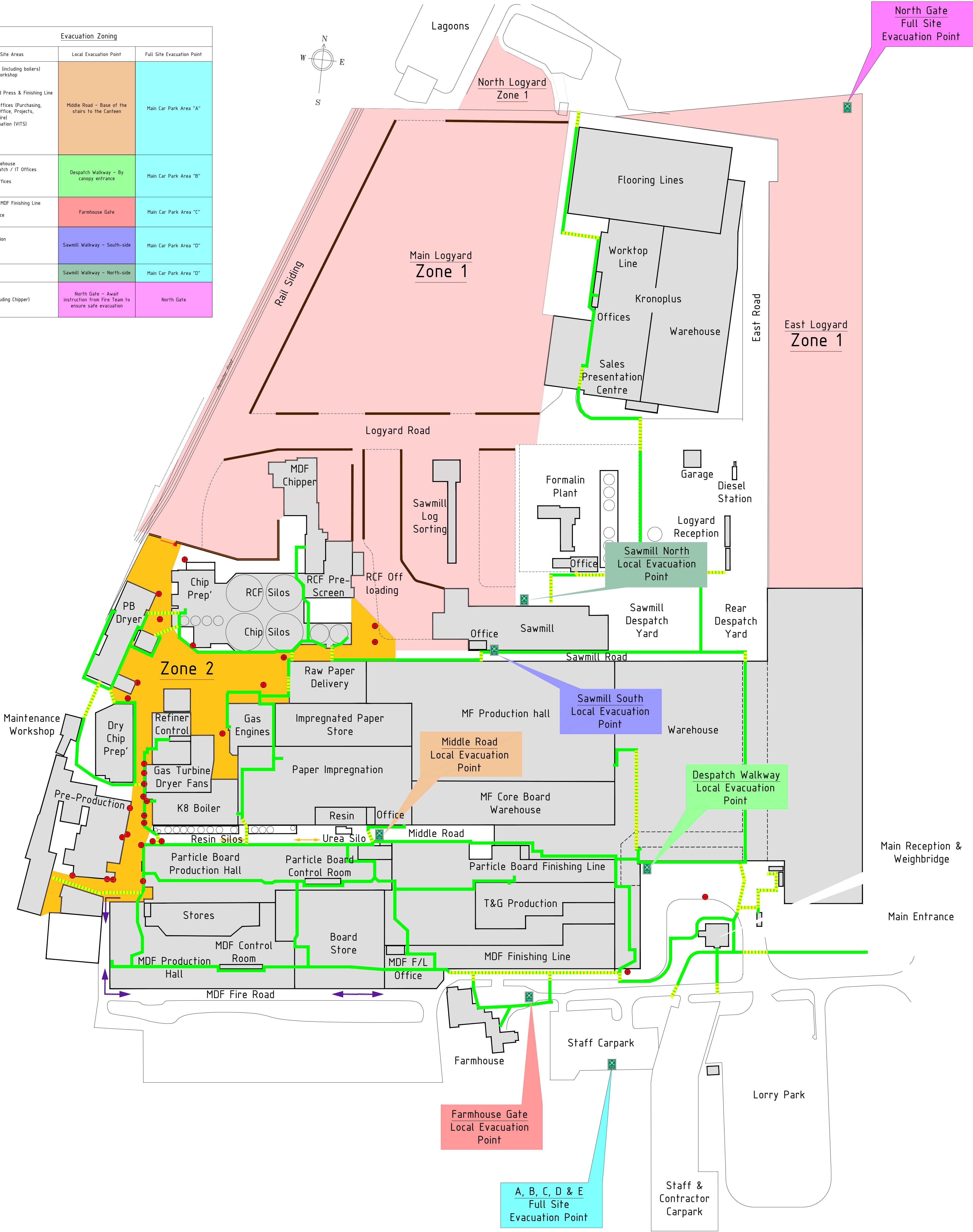
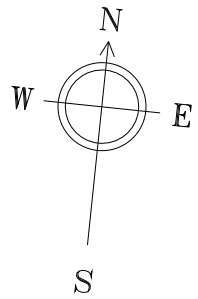

Key

- Zone 1 Area – Strictly NO PEDESTRIAN ACCESS without sign-in at Logyard Reception
- Zone 2 Area – Strictly NO ACCESS during Wig-Wag light operation
- Buildings
- Wig-Wag lights
- Pedestrian Crossing Point
- Pedestrian Routes
- Fire assembly point

K	Drawing split into separate Pedestrian & Traffic sheets. Evacuation summary table added.	04.11.2019	M.Walch
J	Overall layout redesign. Addition of Wig-Wag lights & main points of interest	18.05.2019	M.Walch
I	Pedestrian routes up-dated. Dry Chip Prep & Schrader added	21.03.2019	M.T.
H	General update & relocation of Zone 1 gate	27/11/2018	M.W.
G	General update	12/02/2018	M.W.
F	PAL area update & water tanker sprinkler route added	18/01/2018	M.W.
E	General update	21/06/2018	M.W.
D	Site building outlines & traffic routes updated	06/12/2017	M.W.
C	Site building outline updated	04/04/2016	M.W.
B	Urea site project site access added – N/A pages	29/03/2008	M.T.
A	Plan extended to include Kronoplus	02/02/2004	M.T.
Revised	Drawn	Date	Name
Status	Project leader	Date	Name
Drawn	20/06/2000	M.T.	sign
Checked			
Project number		Project name	
Kronospan Limited Chirk Chirk Wrexham LL14 5BT Tel: 01492 301811 33281			
Kronospan Chirk Evacuation Zoning			
7000/197			
K 3/3			