

Permit with introductory note

The Environmental Permitting (England & Wales) Regulations 2016

Hampshire Demolition and Recycling
Limited

Pengarnddu Industrial Estate Transfer
Station

Pengarnddu Industrial Estate

Pengarnddu

Merthyr Tydfil

CF48 2TA

Permit number

EPR/BB3995FD

Pengarnddu Industrial Estate Transfer Station

Permit number EPR/BB3995FD

Introductory note

This introductory note does not form a part of the permit

The main features of the permit are as follows.

This is a Tier 3 bespoke permit for a hazardous and non-hazardous waste transfer station with treatment.

Treatment operations are limited to non hazardous wastes and can include manual and/or mechanical sorting, sorting and/or separation, screening, shredding, and crushing.

The site is permitted to accept and store hazardous waste in covered skips, prior to it being transferred from site to a suitable waste treatment or disposal facility.

The purpose of the facility is to clear the site of numerous existing stockpiles of abandoned waste which was left behind by a previous occupant of the site. The site is only permitted to treat waste already on-site within existing stockpiles 1-12 and off-site from existing stockpile 13. As a result of this purpose the site is only intended to operate for a limited period, until this waste is removed.

The maximum quantity of waste accepted and processed on site shall not exceed 11,600 tonnes per year as per Table S3.1 and should only be accepted from the Stockpile 13.

Relevant storage and treatment capacity thresholds have been included in the permit to reflect the legal waste facility operational limits; above which, the site would be operating as an Industrial Emissions Directive installation. (See Table S1.1 for relevant limits.)

This permit does not allow any point source emission into surface waters or groundwater except:

- clean, rainfall dependant drainage from areas of the site not used in connection with the storage and/or treatment of waste, and
- integral discharge(s) from the permitted activity (external areas of the site used in connection with the storage and/or treatment of waste) in accordance with the limits set out in Table S1.1.

There are to be no emissions to surface and/or groundwater from the buildings on site.

All emissions from the activity which are not controlled via actual emission limits, are controlled through the 'emission of substances not controlled by emission limits condition' and any all relevant process requirements set out in Tables S1.1 and S1.2.

The burning of any wastes, either in the open, inside buildings or in any form of incinerator is not permitted.

The status log of the permit sets out the permitting history, including any changes to the permit reference number.

Status log of the permit		
Description	Date	Comments
Application EPR/BB3995FD/A001	Duly made 28/05/2020	Application for a Hazardous and Non-Hazardous Waste Transfer Station with Treatment.
Additional information received in response to Schedule 5 notice No 1	25/09/2020	Consisting of: <ul style="list-style-type: none"> • Odour Management Plan (V3) • Dust and Emissions Management Plan (V4)
	02/10/2020	Consisting of: <ul style="list-style-type: none"> • Noise and Vibration Management Plan (V3) • Summary of Schedule 5 response
	05/10/2020	Consisting of: <ul style="list-style-type: none"> • Fire Prevention Management Plan (V4)
Additional information received in response to Schedule 5 notices No 1 and No 2	03/12/2020	Consisting of: <ul style="list-style-type: none"> • Noise and Vibration Management Plan (V4)
	09/12/2020	Consisting of: <ul style="list-style-type: none"> • Dust Emissions Management Plan (V5) • Fire Prevention Management Plan (V5) • Summary of Schedule 5 response including clarification regarding hazardous waste operations.
Permit determined EPR/BB3995FD	30/12/2020	Permit issued to Hampshire Demolition and Recycling Limited.

End of introductory note

Permit

The Environmental Permitting (England and Wales) Regulations 2016

Permit number

EPR/BB3995FD

The Natural Resources Body for Wales (“Natural Resources Wales”) authorises, under regulation 13 of the Environmental Permitting (England and Wales) Regulations 2016

Hampshire Demolition and Recycling Limited (“the operator”),

whose registered office is

**62 Cygnet Court
Timothys Bridge Road
Stratford Enterprise Park
Stratford Upon Avon
England
CV37 9NW**

company registration number 08660913

to operate waste operations at
**Pengarnddu Industrial Estate Transfer Station
Pengarnddu Industrial Estate
Pengarnddu
Merthyr Tydfil
CF48 2TA**

to the extent authorised by and subject to the conditions of this permit.

Name	Date
Iwan G Hughes	30/12/2020

Authorised on behalf of Natural Resources Wales

Conditions

1 Management

1.1 General management

- 1.1.1 The operator shall manage and operate the activities:
- (a) in accordance with a written management system that identifies and minimises risks of pollution, including those arising from operations, maintenance, accidents, incidents, non-conformances, closure and those drawn to the attention of the operator as a result of complaints; and
 - (b) using sufficient competent persons and resources.
- 1.1.2 Records demonstrating compliance with condition 1.1.1 shall be maintained.
- 1.1.3 Any person having duties that are or may be affected by the matters set out in this permit shall have convenient access to a copy of it kept at or near the place where those duties are carried out.
- 1.1.4 The operator shall comply with the requirements of an approved competence scheme

1.2 Avoidance, recovery and disposal of wastes produced by the activities

- 1.2.1 The operator shall take appropriate measures to ensure that:
- (a) the waste hierarchy referred to in Article 4 of the Waste Framework Directive is applied to the generation of waste by the activities; and
 - (b) any waste generated by the activities is treated in accordance with the waste hierarchy referred to in Article 4 of the Waste Framework Directive; and
 - (c) where disposal is necessary, this is undertaken in a manner which minimises its impact on the environment.
- 1.2.2 The operator shall review and record at least every four years whether changes to those measures should be made and take any further appropriate measures identified by a review.

2 Operations

2.1 Permitted activities

- 2.1.1 The operator is only authorised to carry out the activities specified in schedule 1 table S1.1 (the “activities”).

2.2 The site

- 2.2.1 The activities shall not extend beyond the site, being the land shown edged in green on the site plan at schedule 7 to this permit.

2.3 Operating techniques

- 2.3.1 (a) The activities shall, subject to the conditions of this permit, be operated using the techniques and in the manner described in the documentation specified in schedule 1, table S1.2, unless otherwise agreed in writing by Natural Resources Wales.
- (b) If notified by Natural Resources Wales that the activities are giving rise to pollution, the operator shall submit to Natural Resources Wales for approval within the period specified, a revision of any plan or other documentation ("plan") specified in schedule 1, table S1.2 or otherwise required under this permit which identifies and minimises the risks of pollution relevant to that plan, and shall implement the approved revised plan in place of the original from the date of approval, unless otherwise agreed in writing by Natural Resources Wales.
- 2.3.2 Waste shall only be accepted if:
- (a) it is of a type and quantity listed in schedule 2 table(s) S2.1 [, S2.2 etc.]; and
- (b) it conforms to the description in the documentation supplied by the producer and holder.

2.4 Pre-operational conditions

- 2.4.1 The operations specified in schedule 1 table S1.4 shall not commence until the measures specified in that table have been completed.

2.5 Technical requirements

WEEE treatment

- 2.5.1 The storage (including temporary storage) and treatment of WEEE shall be carried out in accordance with the technical requirements of Annex VIII of the WEEE Directive.

Hazardous waste storage and treatment

- 2.5.2 Hazardous waste shall not be mixed, either with a different category of hazardous waste or with other waste, substances or materials, unless it is authorised by schedule 1 table S1.1 and appropriate measures are taken.

3 Emissions and monitoring

3.1 Emissions of substances not controlled by emission limits

- 3.1.1 Emissions of substances not controlled by emission limits (excluding odour) shall not cause pollution. The operator shall not be taken to have breached this condition if appropriate measures, including, but not limited to, those specified in any approved emissions management plan, have been taken to prevent or where that is not practicable, to minimise, those emissions.
- 3.1.2 The operator shall:
- (a) if notified by Natural Resources Wales that the activities are giving rise to pollution, submit to Natural Resources Wales for approval within the period specified, an emissions management plan which identifies and minimises the risks of pollution from emissions of substances not controlled by emission limits;
 - (b) implement the approved emissions management plan, from the date of approval, unless otherwise agreed in writing by Natural Resources Wales.
- 3.1.3 All liquids in containers, whose emission to water or land could cause pollution, shall be provided with secondary containment, unless the operator has used other appropriate measures to prevent or where that is not practicable, to minimise, leakage and spillage from the primary container.

3.2 Odour

- 3.2.1 Emissions from the activities shall be free from odour at levels likely to cause pollution outside the site, as perceived by an authorised officer of Natural Resources Wales, unless the operator has used appropriate measures, including, but not limited to, those specified in any approved odour management plan, to prevent or where that is not practicable to minimise the odour.

3.3 Noise and vibration

- 3.3.1 Emissions from the activities shall be free from noise and vibration at levels likely to cause pollution outside the site, as perceived by an authorised officer of Natural Resources Wales, unless the operator has used appropriate measures, including, but not limited to, those specified in any approved noise and vibration management plan to prevent or where that is not practicable to minimise the noise and vibration.

3.4 Pests

- 3.4.1 The activities shall not give rise to the presence of pests which are likely to cause pollution, hazard or annoyance outside the boundary of the site. The operator shall not be taken to have breached this condition if appropriate measures, including, but not limited to, those specified in any approved pests management plan, have been taken to prevent or where that is not practicable, to minimise the presence of pests on the site.
- 3.4.2 The operator shall:
- (a) if notified by Natural Resources Wales, submit to Natural Resources Wales for approval within the period specified, a pests management plan which identifies and minimises risks of pollution, hazard or annoyance from pests;

- (b) implement the pests management plan, from the date of approval, unless otherwise agreed in writing by Natural Resources Wales.

3.5 Fire

3.5.1 The operator shall manage and operate the activities in accordance with a written fire prevention plan using the current, relevant fire prevention and mitigation plan guidance.

3.5.2 The operator shall:

- (a) if notified by Natural Resources Wales that the activities could cause a fire risk, submit to Natural Resources Wales a fire prevention and mitigation plan which identifies and minimises the risks of fire;
- (b) Operate the activity in accordance with the fire prevention and mitigation plan, from the date of submission, unless otherwise agreed in writing by Natural Resources Wales.

4 Information

4.1 Records

4.1.1 All records required to be made by this permit shall:

- (a) be legible;
- (b) be made as soon as reasonably practicable;
- (c) if amended, be amended in such a way that the original and any subsequent amendments remain legible, or are capable of retrieval; and
- (d) be retained, unless otherwise agreed in writing by Natural Resources Wales, for at least 6 years from the date when the records were made, or in the case of the following records until permit surrender:
 - (i) off-site environmental effects; and
 - (ii) matters which affect the condition of the land and groundwater.

4.1.2 The operator shall keep on site all records, plans and the management system required to be maintained by this permit, unless otherwise agreed in writing by Natural Resources Wales.

4.2 Reporting

4.2.1 The operator shall send all reports and notifications required by the permit to Natural Resources Wales using the contact details supplied in writing by Natural Resources Wales.

4.2.2 Within one month of the end of each quarter, the operator shall submit to Natural Resources Wales using the form made available for the purpose, the information specified on the form relating to the site and the waste accepted and removed from it during the previous quarter.

4.3 Notifications

4.3.1 Natural Resources Wales shall be notified without delay following the detection of:

- (a) any malfunction, breakdown or failure of equipment or techniques, accident, or emission of a substance not controlled by an emission limit which has caused, is causing or may cause significant pollution;
 - (b) the breach of a limit specified in the permit; or
 - (c) any significant adverse environmental effects.
- 4.3.2 Any information provided under condition 4.3.1 shall be confirmed by sending the information listed in schedule 5 to this permit within the time period specified in that schedule.
- 4.3.3 Where Natural Resources Wales has requested in writing that it shall be notified when the operator is to undertake monitoring and/or spot sampling, the operator shall inform Natural Resources Wales when the relevant monitoring and/or spot sampling is to take place. The operator shall provide this information to Natural Resources Wales at least 14 days before the date the monitoring is to be undertaken.
- 4.3.4 Natural Resources Wales shall be notified within 14 days of the occurrence of the following matters, except where such disclosure is prohibited by Stock Exchange rules:

Where the operator is a registered company:

 - (a) any change in the operator's trading name, registered name or registered office address; and
 - (b) any steps taken with a view to the operator going into administration, entering into a company voluntary arrangement or being wound up.

Where the operator is a corporate body other than a registered company:

 - (a) any change in the operator's name or address; and
 - (b) any steps taken with a view to the dissolution of the operator.

In any other case:

 - (a) the death of any of the named operators (where the operator consists of more than one named individual);
 - (b) any change in the operator's name(s) or address(es); and
 - (c) any steps taken with a view to the operator, or any one of them, going into bankruptcy, entering into a composition or arrangement with creditors, or, in the case of them being in a partnership, dissolving the partnership.
- 4.3.5 Where the operator proposes to make a change in the nature or functioning, or an extension of the activities, which may have consequences for the environment and the change is not otherwise the subject of an application for approval under the Regulations or this permit:
 - (a) Natural Resources Wales shall be notified at least 14 days before making the change; and
 - (b) the notification shall contain a description of the proposed change in operation.

4.4 Interpretation

- 4.4.1 In this permit the expressions listed in schedule 6 shall have the meaning given in that schedule.

- 4.4.2 In this permit references to reports and notifications mean written reports and notifications, except where reference is made to notification being made “without delay”, in which case it may be provided by telephone.

Schedule 1 - Operations

Table S1.1 activities

Activity reference	Description of activities for waste operations	Limits of activities
A1 - Hazardous and Non-Hazardous Waste Transfer Station with Treatment	<p>R3: Recycling/ reclamation of organic substances which are not used as solvents</p> <p>R4: Recycling/ reclamation of metals and metal compounds</p> <p>R5: Recycling/ reclamation of other inorganic compounds</p> <p>R13: Storage of waste pending any of the operations numbered R1 to R12 (excluding temporary storage, pending collection, on the site where it is produced)</p> <p>D9: Physico-chemical treatment not specified elsewhere in this Annex which results in final compounds or mixtures which are discarded by means of any of the operations numbered D1 to D12 (e.g. evaporation, drying, calcination, etc.)</p> <p>D13: Blending or Mixing prior to submission to any disposal operation numbered D1 to D12.</p> <p>D14: Repackaging prior to submission to any of the operations numbered D1 to D13.</p> <p>D15: Storage pending any of the operations numbered D1 to D14 (excluding temporary storage pending collection on the site where it is produced).</p>	<p>All non-hazardous waste must be stored and treated on an impermeable surface with sealed drainage. Except for the insitu existing waste stockpiles 1-12 (as per Table 3.3.1 and Figure 3.1.1 of the Fire Prevention and Mitigation Plan referred to in Table S1.2 of this permit) which can be stored on hardstanding or impermeable surface with sealed drainage. No additional waste is permitted to be added to these stockpiles.</p> <p>Treatment operations shall be limited to manual and/or mechanical:</p> <ul style="list-style-type: none"> - sorting and/or separation - bulking - screening - shredding - crushing. <p>of permitted waste for the purpose of recovery and/or disposal.</p> <p>All hazardous waste must be stored in covered skips on an impermeable surface with sealed drainage.</p> <p>There shall be no treatment of hazardous waste other than bulking up for onward transfer.</p> <p>The maximum quantity of hazardous waste that can be stored at the site in total for recovery or disposal, shall not exceed 50 tonnes at any one time.</p> <p>Waste can only be brought on to site from the off-site existing waste stockpile 13. Stockpile 13 is defined by the Operating Techniques and Monitoring Plan referenced in Tables S1.2 of this permit.</p> <p>Waste types as specified in Table S2.1.</p>

Discharge of rain water run-off from the emission point 'SW1' indicated on the FPMP Layout Plan (Drawing No: CRM.0127.001.PE.D.004) in Appendix B of the Fire Prevention and Mitigation Plan referenced in Table S1.2 Operating Techniques of this permit	<p>Drainage consisting solely of:</p> <ul style="list-style-type: none"> - clean, rainfall dependant drainage from areas of the site not used in connection with the storage and/or treatment of waste - run-off from the impermeable surface from external areas of the site used to store and/or treat waste. <p>No visible oil or grease shall be present in the discharge.</p> <p>There shall be no discharge from the buildings on site used to store and/or treat waste.</p>
---	--

Table S1.2 Operating techniques

Description	Parts	Date Received
Technical Guidance Document: 'How to comply with your environmental permit'	All relevant sections	N/A
Sector Guidance Note IPPC S5.06: Guidance for the Recovery and Disposal of Hazardous and Non Hazardous Waste	All relevant sections	N/A
Fire prevention and mitigation plan guidance - Waste	All relevant sections	N/A
Application	Table 1a of the application Form Part B4.	28/05/2020
	Operating Techniques and Monitoring Plan – Pengarnddu Industrial Estate Transfer Station. Report No. CRM.0127.001.PE.R.006. Dated May 2020. Sections: 2.3 Waste Treatment 2.4 Description and location of Stockpile 13 2.5 Pre-acceptance procedures for Stockpile 13 2.6 Waste acceptance Procedures for Stockpile 13 2.7 Waste Treatment Proposed for Stockpile 133.4 Control of Fugitive Releases to Water, Land and Groundwater 3.10 Accidents	28/05/2020
Response to Schedule 5 Notice 1 dated 04/09/20	Odour Management Plan – Pengarnddu Industrial Estate Transfer Station. Version 3. Report No. CRM 0127.001.PE.R.011 OMP Dated. September 2020	25/09/2020

Table S1.2 Operating techniques

Description	Parts	Date Received
Response to Schedule 5 Notice 1 (re-issue) and 2 dated 10/11/2020	Noise and Vibration Management Plan – Pengarnddu Industrial Estate Transfer Station. Version 4. Report No. CRM. 0127.001.PE.R.012. Dated November 2020	03/12/2020
	Dust and Emissions Management Plan - Pengarnddu Industrial Estate Transfer Station. Version 5. Report No. CRM 0127.001.P.R.010. Dated December 2020. -All Sections	09/12/2020
	Fire Prevention and Mitigation Plan - Pengarnddu Industrial Estate Transfer Station. Version 5. Report No. CRM 0127.001.PE.R.008. Dated December 2020. -All Sections	09/12/2020
	Schedule 5 Response Document. Ref CRM.0127.001PE.L002. Dated: 09/12/2020. Sections: Response to Question 33 regarding hazardous waste.	09/12/2020

Table S1.4 Pre-operational measures for future development

Reference	Operation	Pre-operational measures
PO1	Acceptance of hazardous waste.	Prior to the accepting hazardous waste from the existing waste in Stockpile 13, the operator must submit evidence, for approval by Natural Resources Wales, that the Technically Competent Manager (TCM) holds the relevant hazardous waste Technical Competence certification for the site activities.

Schedule 2 - Waste types, raw materials and fuels

Table S2.1 Permitted waste types and quantities for Hazardous and Non-Hazardous waste Transfer Station with Treatment

Maximum quantity	The maximum quantity of waste to be accepted on site shall not exceed 11600 tonnes per year.
Exclusions	Notwithstanding the waste types set out in this table, wastes having any of the following characteristics shall not be accepted: <ul style="list-style-type: none"> • consisting solely or mainly of dusts, powders or loose fibres • sludges • odorous or odour producing • All waste not from the on site existing waste stockpiles 1 – 12 or the offsite existing waste Stockpile 13. (Stockpile 13 is defined by the Operating Techniques and Monitoring Plan referenced in Tables S1.2 of this permit).
Waste code	Description
17	CONSTRUCTION AND DEMOLITION WASTES (INCLUDING EXCAVATED SOIL FROM CONTAMINATED SITES)
17 01	concrete, bricks, tiles and ceramics
17 01 01	concrete
17 01 02	bricks
17 01 03	tiles and ceramics
17 01 06*	mixtures of, or separate fractions of concrete, bricks, tiles and ceramics containing hazardous substances
17 01 07	mixtures of concrete, bricks, tiles and ceramics other than those mentioned in 17 01 06
17 02	wood, glass and plastic
17 02 01	wood
17 02 02	glass
17 02 03	plastic
17 02 04*	glass, plastic and wood containing or contaminated with hazardous substances
17 03	bituminous mixtures, coal tar and tarred products
17 03 01*	bituminous mixtures containing coal tar
17 03 02	bituminous mixtures other than those mentioned in 17 03 01
17 03 03*	coal tar and tarred products
17 04	metals (including their alloys)
17 04 01	copper, bronze, brass
17 04 02	aluminium
17 04 03	lead
17 04 04	zinc
17 04 05	iron and steel
17 04 06	tin
17 04 07	mixed metals
17 04 09*	metal waste contaminated with hazardous substances
17 04 10*	cables containing oil, coal tar and other hazardous substances
17 04 11	cables other than those mentioned in 17 04 10
17 05	soil (including excavated soil from contaminated sites), stones and dredging spoil
17 05 03*	soil and stones containing hazardous substances
17 05 04	soil and stones other than those mentioned in 17 05 03

17 05 05*	dredging spoil containing hazardous substances
17 05 06	dredging spoil other than those mentioned in 17 05 05
17 05 07*	track ballast containing hazardous substances
17 05 08	track ballast other than those mentioned in 17 05 07
17 06	insulation materials and asbestos-containing construction materials
17 06 01*	insulation materials containing asbestos
17 06 03*	other insulation materials consisting of or containing hazardous substances
17 06 04	insulation materials other than those mentioned in 17 06 01 and 17 06 03
17 06 05*	construction materials containing asbestos
17 08	gypsum-based construction material
17 08 01*	gypsum-based construction materials contaminated with hazardous substances
17 08 02	gypsum-based construction materials other than those mentioned in 17 08 01
17 09	other construction and demolition wastes
17 09 01*	construction and demolition wastes containing mercury
17 09 02*	construction and demolition wastes containing PCB (for example PCB-containing sealants, PCB-containing resin-based floorings, PCB-containing sealed glazing units, PCB-containing capacitors)
17 09 03*	other construction and demolition wastes (including mixed wastes) containing hazardous substances
17 09 04	mixed construction and demolition wastes other than those mentioned in 17 09 01, 17 09 02 and 17 09 03
19	WASTES FROM WASTE MANAGEMENT FACILITIES, OFF-SITE WASTE WATER TREATMENT PLANTS AND THE PREPARATION OF WATER INTENDED FOR HUMAN CONSUMPTION AND WATER FOR INDUSTRIAL USE
19 01	wastes from incineration or pyrolysis of waste
19 01 02	ferrous materials removed from bottom ash
19 01 11*	bottom ash and slag containing hazardous substances
19 01 12	bottom ash and slag other than those mentioned in 19 01 11
19 01 13*	fly ash containing hazardous substances
19 01 14	fly ash other than those mentioned in 19 01 13
19 01 15*	boiler dust containing hazardous substances
19 01 16	boiler dust other than those mentioned in 19 01 15
19 01 17*	pyrolysis wastes containing hazardous substances
19 01 18	pyrolysis wastes other than those mentioned in 19 01 17
19 01 99	wastes not otherwise specified
19 05	wastes from aerobic treatment of solid wastes
19 05 01	non-composted fraction of municipal and similar wastes
19 05 02	non-composted fraction of animal and vegetable waste
19 05 03	off-specification compost
19 05 99	wastes not otherwise specified
19 06	wastes from anaerobic treatment of waste
19 06 03	liquor from anaerobic treatment of municipal waste
19 06 04	digestate from anaerobic treatment of municipal waste
19 06 05	liquor from anaerobic treatment of animal and vegetable waste
19 06 06	digestate from anaerobic treatment of animal and vegetable waste
19 06 99	wastes not otherwise specified
19 07	landfill leachate
19 07 02*	landfill leachate containing hazardous substances
19 07 03	landfill leachate other than those mentioned in 19 07 02
19 10	wastes from shredding of metal-containing wastes

19 10 01	iron and steel waste
19 10 02	non-ferrous waste
19 10 03*	fluff-light fraction and dust containing hazardous substances
19 10 04	fluff-light fraction and dust other than those mentioned in 19 10 03
19 10 05*	other fractions containing hazardous substances
19 10 06	other fractions other than those mentioned in 19 10 05
19 11	wastes from oil regeneration
19 11 01*	spent filter clays
19 11 02*	acid tars
19 11 03*	aqueous liquid wastes
19 11 04*	wastes from cleaning of fuel with bases
19 11 05*	sludges from on-site effluent treatment containing hazardous substances
19 11 06	sludges from on-site effluent treatment other than those mentioned in 19 11 05
19 11 07*	wastes from flue-gas cleaning
19 11 99	wastes not otherwise specified
19 12	wastes from the mechanical treatment of waste (for example sorting, crushing, compacting, pelletising) not otherwise specified
19 12 01	paper and cardboard
19 12 02	ferrous metal
19 12 03	non-ferrous metal
19 12 04	plastic and rubber
19 12 05	glass
19 12 06*	wood containing hazardous substances
19 12 07	wood other than that mentioned in 19 12 06
19 12 08	textiles
19 12 09	minerals (for example sand, stones)
19 12 10	combustible waste (refuse derived fuel)
19 12 11*	other wastes (including mixtures of materials) from mechanical treatment of waste containing hazardous substances
19 12 12	other wastes (including mixtures of materials) from mechanical treatment of wastes other than those mentioned in 19 12 11
19 13	wastes from soil and groundwater remediation
19 13 01*	solid wastes from soil remediation containing hazardous substances
19 13 02	solid wastes from soil remediation other than those mentioned in 19 13 01
19 13 03*	sludges from soil remediation containing hazardous substances
19 13 04	sludges from soil remediation other than those mentioned in 19 13 03
19 13 05*	sludges from groundwater remediation containing hazardous substances
19 13 06	sludges from groundwater remediation other than those mentioned in 19 13 05
20	MUNICIPAL WASTES (HOUSEHOLD WASTE AND SIMILAR COMMERCIAL, INDUSTRIAL AND INSTITUTIONAL WASTES) INCLUDING SEPARATELY COLLECTED FRACTIONS
20 01	separately collected fractions (except 15 01)
20 01 01	paper and cardboard
20 01 02	glass
20 01 08	biodegradable kitchen and canteen waste
20 01 10	clothes
20 01 11	textiles
20 01 13*	solvents
20 01 14*	acids
20 01 15*	alkalines

20 01 17*	photochemicals
20 01 19*	pesticides
20 01 21*	fluorescent tubes and other mercury-containing waste
20 01 23*	discarded equipment containing chlorofluorocarbons
20 01 25	edible oil and fat
20 01 26*	oil and fat other than those mentioned in 20 01 25
20 01 27*	paint, inks, adhesives and resins containing hazardous substances
20 01 28	paint, inks, adhesives and resins other than those mentioned in 20 01 27
20 01 29*	detergents containing hazardous substances
20 01 30	detergents other than those mentioned in 20 01 29
20 01 31*	cytotoxic and cytostatic medicines
20 01 32	medicines other than those mentioned in 20 01 31
20 01 33*	batteries and accumulators included in 16 06 01, 16 06 02 or 16 06 03 and unsorted batteries and accumulators containing these batteries
20 01 34	batteries and accumulators other than those mentioned in 20 01 33
20 01 35*	discarded electrical and electronic equipment other than those mentioned in 20 01 21 and 20 01 23 containing hazardous components
20 01 36	discarded electrical and electronic equipment other than those mentioned in 20 01 21, 20 01 23 and 20 01 35
20 01 37*	wood containing hazardous substances
20 01 38	wood other than that mentioned in 20 01 37
20 01 39	plastics
20 01 40	metals
20 01 99	other fractions not otherwise specified
20 02	garden and park wastes (including cemetery waste)
20 02 01	biodegradable waste
20 02 02	soil and stones
20 02 03	other non-biodegradable wastes
20 03	other municipal wastes
20 03 01	mixed municipal waste
20 03 02	waste from markets
20 03 03	street-cleaning residues
20 03 04	septic tank sludge
20 03 06	waste from sewage cleaning
20 03 07	bulky waste
20 03 99	municipal wastes not otherwise specified

Schedule 3 – Emissions and monitoring

There are no emission limits or associated monitoring requirements.

Schedule 4 - Reporting

There is no reporting under this schedule.

Schedule 5 - Notification

These pages outline the information that the operator must provide.

Units of measurement used in information supplied under Part A and B requirements shall be appropriate to the circumstances of the emission. Where appropriate, a comparison should be made of actual emissions and authorised emission limits.

If any information is considered commercially confidential, it should be separated from non-confidential information, supplied on a separate sheet and accompanied by an application for commercial confidentiality under the provisions of the EP Regulations.

Part A

Permit Number	
Name of operator	
Location of Facility	
Time and date of the detection	

(a) Notification requirements for any malfunction, breakdown or failure of equipment or techniques, accident, or emission of a substance not controlled by an emission limit which has caused, is causing or may cause significant pollution

To be notified within 24 hours of detection
--

Date and time of the event	
Reference or description of the location of the event	
Description of where any release into the environment took place	
Substances(s) potentially released	
Best estimate of the quantity or rate of release of substances	
Measures taken, or intended to be taken, to stop any emission	
Description of the failure or accident.	

(b) Notification requirements for the breach of a limit
--

To be notified within 24 hours of detection unless otherwise specified below

Emission point reference/ source	
Parameter(s)	
Limit	
Measured value and uncertainty	
Date and time of monitoring	
Measures taken, or intended to be taken, to stop the emission	

Time periods for notification following detection of a breach of a limit	
Parameter	Notification period

(c) Notification requirements for the detection of any significant adverse environmental effect	
To be notified within 24 hours of detection	
Description of where the effect on the environment was detected	
Substances(s) detected	
Concentrations of substances detected	
Date of monitoring/sampling	

Part B - to be submitted as soon as practicable

Any more accurate information on the matters for notification under Part A.	
Measures taken, or intended to be taken, to prevent a recurrence of the incident	
Measures taken, or intended to be taken, to rectify, limit or prevent any pollution of the environment which has been or may be caused by the emission	
The dates of any unauthorised emissions from the facility in the preceding 24 months.	

Name*	
Post	
Signature	
Date	

* authorised to sign on behalf of the operator

Schedule 6 - Interpretation

“accident” means an accident that may result in pollution.

“Annex I” means Annex I to Directive 2008/98/EC of the European Parliament and of the Council on waste.

“Annex II” means Annex II to Directive 2008/98/EC of the European Parliament and of the Council on waste.

“application” means the application for this permit, together with any additional information supplied by the operator as part of the application and any response to a notice served under Schedule 5 to the EP Regulations.

“authorised officer” means any person authorised by Natural Resources Wales under section 108(1) of The Environment Act 1995 to exercise, in accordance with the terms of any such authorisation, any power specified in section 108(4) of that Act.

“best available treatment, recovery and recycling techniques” shall have the meaning given to it in the document published jointly by the Department for Environment, Food and Rural Affairs, the Welsh Assembly Government and the Scottish Executive on 27th November 2006, entitled “Guidance on Best Available Treatment, Recovery and Recycling Techniques (BATRR) and Treatment of Waste Electrical and Electronic Equipment (WEEE).

“building” means a construction that has the objective of providing sheltering cover and minimising emissions of noise, particulate matter, odour and litter.

“D” means a disposal operation provided for in Annex I to Directive 2008/98/EC of the European Parliament and of the Council on waste.

“emissions to land” includes emissions to groundwater.

“emissions of substances not controlled by emission limits” means emissions of substances to air, water or land from the activities, either from the emission points specified in schedule 3 or from other localised or diffuse sources, which are not controlled by an emission limit.

“EP Regulations” means The Environmental Permitting (England and Wales) Regulations SI 2016 No.1154 and words and expressions used in this permit which are also used in the Regulations have the same meanings as in those Regulations.

“groundwater” means all water, which is below the surface of the ground in the saturation zone and in direct contact with the ground or subsoil.

“hazardous property” has the meaning in Annex III of the Waste Framework Directive.

“hazardous substance” means a substance classified as hazardous as a consequence of fulfilling the criteria laid down in parts 2 to 5 of Annex I to Regulation (EC) No 1272/2008.

“hazardous waste” has the meaning given in the Hazardous Waste (Wales) Regulations 2005 (as amended).

“impermeable surface” means a surface or pavement constructed and maintained to a standard sufficient to prevent the transmission of liquids beyond the surface.

“Pests” means Birds, Vermin and Insects.

“quarter” means a calendar year quarter commencing on 1 January, 1 April, 1 July or 1 October.

“R” means a recovery operation provided for in Annex II to Directive 2008/98/EC of the European Parliament and of the Council on waste.

“Waste code” means the six digit code referable to a type of waste in accordance with the list of wastes established by Commission Decision 2000/532/EC as amended from time to time (the ‘List of Wastes Decision’) and in relation to hazardous waste, includes the asterisk.

“Waste Framework Directive” or “WFD” means Waste Framework Directive 2008/98/EC of the European Parliament and of the Council on waste.

“WEEE” means waste electrical and electronic equipment.

“WEEE Directive” means Directive 2012/19/EU of the European Parliament and of the Council of 4th July 2012 on waste electrical and electronic equipment (WEEE).

“year” means calendar year ending 31 December.

Schedule 7 - Site plan

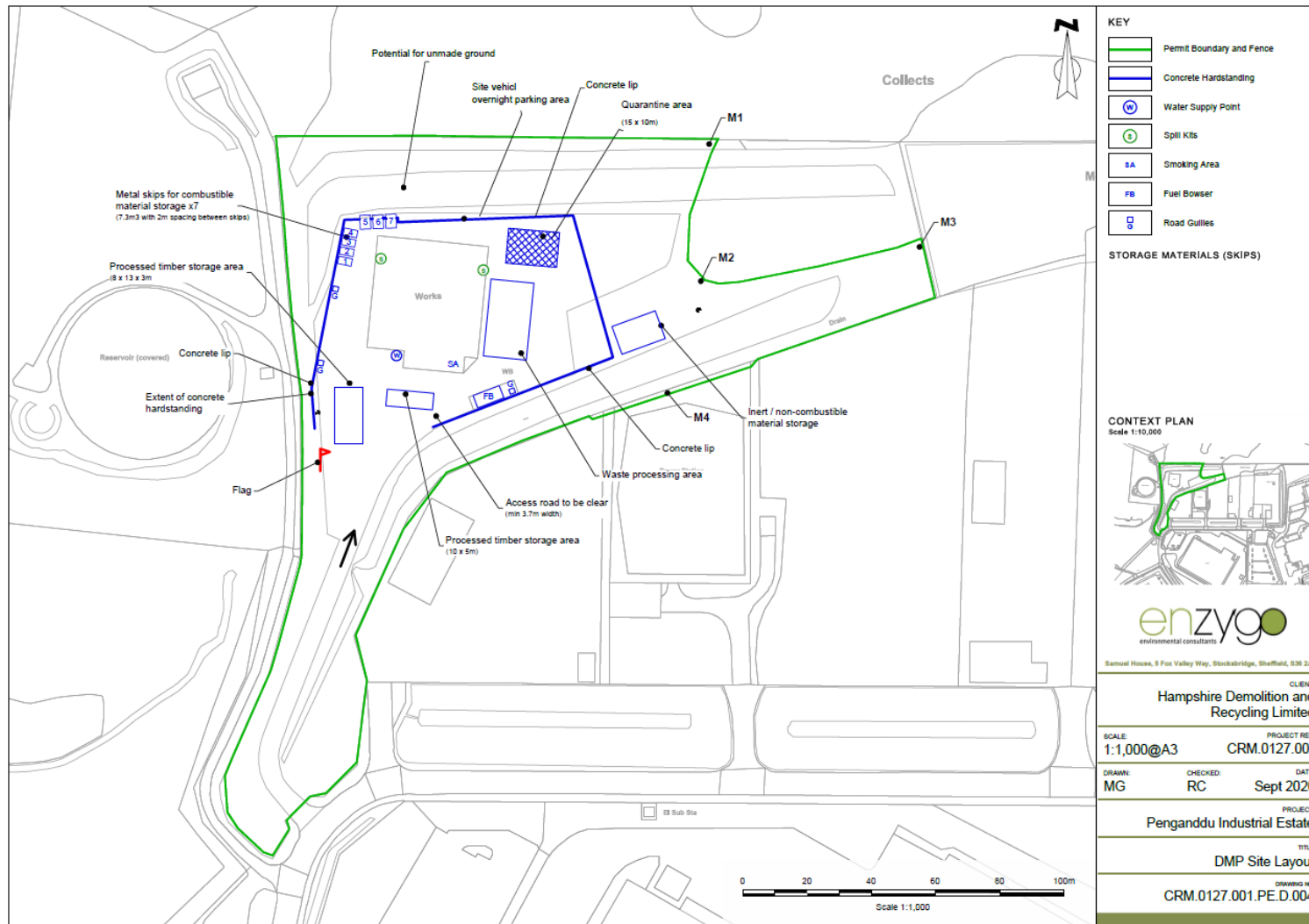

END OF PERMIT