

Permit with introductory note

The Environmental Permitting (England & Wales) Regulations 2016

Enviroparks (Wales) Limited

**Hirwaun Materials Recovery Facility
Ninth Avenue
Hirwaun Industrial Estate
Hirwaun
CF44 9NA**

Permit number

EPR/WB3490HQ

Hirwaun Materials Recovery Facility

Permit number EPR/WB3490HQ

Introductory note

This introductory note does not form a part of the permit

The main features of the permit are as follows.

The Hirwaun Materials Recovery Facility is located at Ninth Avenue, Hirwaun Industrial Estate, Hirwaun. It lies in an industrial area with industrial buildings to the south and east and open land to the west. To the north of the site lies Penderyn Reservoir. The installation will be used to treat mainly commercial and industrial wastes in order to extract ferrous metal, wood, inert aggregate, plastics, cardboard and mixed paper for recycling. Some household wastes may also be treated. The residual materials will be prepared for use as a Refuse Derived Fuel (RDF) which will be transferred off-site to an energy from waste facility for thermal recovery. All waste will be unloaded, processed and loaded up inside the Material Recovery Facility Building. There is one emission to surface water of uncontaminated, clean surface water from roofs and clean landscaped areas. There is one emission to public sewer of drainage from all waste processing areas.

The regulated facility is listed as a Schedule 1 Part A installation under Section 5.4 A (1) (b) – Recovery or a mix of recovery and disposal of non-hazardous waste with a capacity exceeding 75 tonnes per day (or 100 tonnes per day if the only waste treatment activity is anaerobic digestion), involving the following activities and, excluding activities covered by Council Directive 91/271/EEC – (ii) pre-treatment of waste for incineration or co-incineration.

Treatment operations at the site shall be limited to manual and/or mechanical sorting, separation, screening, shredding and baling of permitted wastes for the purposes of recovery.

The maximum quantity of waste to be accepted on site shall not exceed 240,000 tonnes per year.

The status log of the permit sets out the permitting history, including any changes to the permit reference number.

Status log of the permit		
Description	Date	Comments
Application EPR/DP3037EU/A001	Duly made 05/03/14	Application for Material Recovery Facility
Additional information requested	01/05/14	Schedule 5 Notice
Additional information received	15/05/14	Response to Schedule 5 Notice
Permit determined EPR/DP3037EU/A001	17/10/14	Permit issued to Biffa Waste Services Limited
Transfer application EPR/WB3490HQ/T001	Duly made 02/11/15	Application to transfer the permit from Biffa Waste Services Limited to Enviroparks (Wales) Limited
Transfer determined EPR/WB3490HQ/T001	09/12/15	Permit transferred in full to Enviroparks (Wales) Limited
Regulation 61(1) Notice sent to the Operator	05/04/19	Issue of a Notice under Regulation 61(1) of the EPR. Natural Resources Wales initiated review and variation to vary the permit following the publication of the revised Best Available Techniques (BAT) Reference Document (BRef) for Waste Treatment
Regulation 61 Notice response received	13/08/20	Response received from the operator
Additional information received	12/11/20	Updated site layout / installation boundary plan
NRW-initiated variation determined EPR/WB3490HQ/V002	22/02/21	Varied and consolidated permit issued in modern condition format

End of introductory note

Permit

The Environmental Permitting (England and Wales) Regulations 2016

Permit number

EPR/WB3490HQ

This is the consolidated permit referred to in the variation and consolidation notice for application **EPR/WB3490HQ/V002** authorising,

Enviroparks (Wales) Limited ("the operator")

whose registered office is

First Floor Offices

Park Chambers

10 Hereford Road

Abergavenny

Monmouthshire

Wales

NP7 5PR

company registration number **07034699**

to operate **an installation** at

Hirwaun Materials Recovery Facility

Ninth Avenue

Hirwaun Industrial Estate

Hirwaun

CF44 9NA

to the extent authorised by and subject to the conditions of this permit.

Name	Date
Holly Noble	22/02/2021

Authorised on behalf of Natural Resources Wales

Conditions

1 Management

1.1 General management

- 1.1.1 The operator shall manage and operate the activities:
- (a) in accordance with a written management system that identifies and minimises risks of pollution, including those arising from operations, maintenance, accidents, incidents, non-conformances, closure and those drawn to the attention of the operator as a result of complaints; and
 - (b) using sufficient competent persons and resources.
- 1.1.2 Records demonstrating compliance with condition 1.1.1 shall be maintained.
- 1.1.3 Any person having duties that are or may be affected by the matters set out in this permit shall have convenient access to a copy of it kept at or near the place where those duties are carried out.
- 1.1.4 The operator shall comply with the requirements of an approved competence scheme.

1.2 Energy efficiency

- 1.2.1 The operator shall:
- (a) take appropriate measures to ensure that energy is used efficiently in the activities;
 - (b) review and record at least every four years whether there are suitable opportunities to improve the energy efficiency of the activities; and
 - (c) take any further appropriate measures identified by a review.

1.3 Efficient use of raw materials

- 1.3.1 The operator shall:
- (a) take appropriate measures to ensure that raw materials and water are used efficiently in the activities;
 - (b) maintain records of raw materials and water used in the activities;
 - (c) review and record at least every four years whether there are suitable alternative materials that could reduce environmental impact or opportunities to improve the efficiency of raw material and water use; and
 - (d) take any further appropriate measures identified by a review.

1.4 Avoidance, recovery and disposal of wastes produced by the activities

- 1.4.1 The operator shall take appropriate measures to ensure that:
- (a) the waste hierarchy referred to in Article 4 of the Waste Framework Directive is applied to the generation of waste by the activities;
 - (b) any waste generated by the activities is treated in accordance with the waste hierarchy referred to in Article 4 of the Waste Framework Directive; and
 - (c) where disposal is necessary, this is undertaken in a manner which minimises its impact on the environment.

- 1.4.2 The operator shall review and record at least every four years whether changes to those measures should be made and take any further appropriate measures identified by a review.

2 Operations

2.1 Permitted activities

- 2.1.1 The operator is only authorised to carry out the activities specified in schedule 1 table S1.1 (the “activities”).
- 2.1.2 Waste authorised by this permit shall be clearly distinguished from any other waste on the site.

2.2 The site

- 2.2.1 The activities shall not extend beyond the site, being the land shown edged in blue on the site plan at schedule 7 to this permit.

2.3 Operating techniques

- 2.3.1 (a) The activities shall, subject to the conditions of this permit, be operated using the techniques and in the manner described in the documentation specified in schedule 1, table S1.2, unless otherwise agreed in writing by Natural Resources Wales.
- (b) If notified by Natural Resources Wales that the activities are giving rise to pollution, the operator shall submit to Natural Resources Wales for approval within the period specified, a revision of any plan or other documentation (“plan”) specified in schedule 1, table S1.2 or otherwise required under this permit which identifies and minimises the risks of pollution relevant to that plan, and shall implement the approved revised plan in place of the original from the date of approval, unless otherwise agreed in writing by Natural Resources Wales.
- 2.3.2 Waste shall only be accepted if:
- (a) it is of a type and quantity listed in schedule 2 table S2.1; and
- (b) it conforms to the description in the documentation supplied by the producer and holder.
- 2.3.3 The operator shall ensure that where waste produced by the activities is sent to a relevant waste operation, that operation is provided with the following information, prior to the receipt of the waste:
- (a) the nature of the process producing the waste;
- (b) the composition of the waste;
- (c) the handling requirements of the waste;
- (d) the hazardous property associated with the waste, if applicable; and
- (e) the waste code of the waste.
- 2.3.4 The operator shall ensure that where waste produced by the activities is sent to a landfill site, it meets the waste acceptance criteria for that landfill.

2.4 Pre-operational conditions

- 2.4.1 The activities shall not be brought into operation until the measures specified in schedule 1 table S1.3 have been completed.

3 Emissions and monitoring

3.1 Emissions to water, air or land

- 3.1.1 There shall be no point source emissions to water, air or land except from the sources and emission points listed in schedule 3 tables S3.1, S3.2 and S3.3.
- 3.1.2 The limits given in schedule 3 shall not be exceeded.
- 3.1.3 Periodic monitoring shall be carried out at least once every 5 years for groundwater and 10 years for soil, unless such monitoring is based on a systematic appraisal of the risk of contamination.

3.2 Emissions of substances not controlled by emission limits

- 3.2.1 Emissions of substances not controlled by emission limits (excluding odour) shall not cause pollution. The operator shall not be taken to have breached this condition if appropriate measures, including, but not limited to, those specified in any approved emissions management plan, have been taken to prevent or where that is not practicable, to minimise, those emissions.
- 3.2.2 The operator shall:
 - (a) if notified by Natural Resources Wales that the activities are giving rise to pollution, submit to Natural Resources Wales for approval within the period specified, an emissions management plan which identifies and minimises the risks of pollution from emissions of substances not controlled by emission limits;
 - (b) implement the approved emissions management plan, from the date of approval, unless otherwise agreed in writing by Natural Resources Wales.
- 3.2.3 All liquids in containers, whose emission to water or land could cause pollution, shall be provided with secondary containment, unless the operator has used other appropriate measures to prevent or where that is not practicable, to minimise, leakage and spillage from the primary container.

3.3 Odour

- 3.3.1 Emissions from the activities shall be free from odour at levels likely to cause pollution outside the site, as perceived by an authorised officer of Natural Resources Wales, unless the operator has used appropriate measures, including, but not limited to, those specified in any approved odour management plan, to prevent or where that is not practicable to minimise the odour.
- 3.3.2 The operator shall:
 - (a) if notified by Natural Resources Wales that the activities are giving rise to pollution outside the site due to odour, submit to Natural Resources Wales for approval within the period specified, an odour management plan which identifies and minimises the risks of pollution from odour;
 - (b) implement the approved odour management plan, from the date of approval, unless otherwise agreed in writing by Natural Resources Wales.

3.4 Noise and vibration

- 3.4.1 Emissions from the activities shall be free from noise and vibration at levels likely to cause pollution outside the site, as perceived by an authorised officer of Natural Resources Wales, unless the operator has used appropriate measures, including, but not limited to, those specified in any approved noise and vibration management plan to prevent or where that is not practicable to minimise the noise and vibration.
- 3.4.2 The operator shall:

- (a) if notified by Natural Resources Wales that the activities are giving rise to pollution outside the site due to noise and vibration, submit to Natural Resources Wales for approval within the period specified, a noise and vibration management plan which identifies and minimises the risks of pollution from noise and vibration;
- (b) implement the approved noise and vibration management plan, from the date of approval, unless otherwise agreed in writing by Natural Resources Wales.

3.5 Monitoring

- 3.5.1 The operator shall, unless otherwise agreed in writing by Natural Resources Wales, undertake the monitoring specified in the following tables in schedule 3 to this permit:
 - (a) point source emissions specified in tables S3.1, S3.2 and S3.3.
- 3.5.2 The operator shall maintain records of all monitoring required by this permit including records of the taking and analysis of samples, instrument measurements (periodic and continual), calibrations, examinations, tests and surveys and any assessment or evaluation made on the basis of such data.
- 3.5.3 Monitoring equipment, techniques, personnel and organisations employed for the emissions monitoring programme and the environmental or other monitoring specified in condition 3.5.1 shall have either MCERTS certification or MCERTS accreditation (as appropriate), where available, unless otherwise agreed in writing by Natural Resources Wales.
- 3.5.4 Permanent means of access shall be provided to enable sampling/monitoring to be carried out in relation to the emission points specified in schedule 3 tables S3.1, S3.2 and S3.3 unless otherwise agreed in writing by Natural Resources Wales.

3.6 Pests

- 3.6.1 The activities shall not give rise to the presence of pests which are likely to cause pollution, hazard or annoyance outside the boundary of the site. The operator shall not be taken to have breached this condition if appropriate measures, including, but not limited to, those specified in any approved pests management plan, have been taken to prevent or where that is not practicable, to minimise the presence of pests on the site.
- 3.6.2 The operator shall:
 - (a) if notified by Natural Resources Wales, submit to Natural Resources Wales for approval within the period specified, a pests management plan which identifies and minimises risks of pollution, hazard or annoyance from pests;
 - (b) implement the pests management plan, from the date of approval, unless otherwise agreed in writing by Natural Resources Wales.

3.7 Fire

- 3.7.1 The operator shall manage and operate the activities in accordance with a written fire prevention plan using the current, relevant fire prevention and mitigation plan guidance.
- 3.7.2 The operator shall:
 - (a) if notified by Natural Resources Wales that the activities could cause a fire risk, submit to Natural Resources Wales a fire prevention mitigation plan which identifies and minimises the risks of fire;
 - (b) Operate the activity in accordance with the fire prevention mitigation plan, from the date of submission, unless otherwise agreed in writing by Natural Resources Wales.

4 Information

4.1 Records

4.1.1 All records required to be made by this permit shall:

- (a) be legible;
- (b) be made as soon as reasonably practicable;
- (c) if amended, be amended in such a way that the original and any subsequent amendments remain legible, or are capable of retrieval; and
- (d) be retained, unless otherwise agreed in writing by Natural Resources Wales, for at least 6 years from the date when the records were made, or in the case of the following records until permit surrender:
 - (i) off-site environmental effects; and
 - (ii) matters which affect the condition of the land and groundwater.

4.1.2 The operator shall keep on site all records, plans and the management system required to be maintained by this permit, unless otherwise agreed in writing by Natural Resources Wales.

4.2 Reporting

4.2.1 The operator shall send all reports and notifications required by the permit to Natural Resources Wales using the contact details supplied in writing by Natural Resources Wales.

4.2.2 A report or reports on the performance of the activities over the previous year shall be submitted to Natural Resources Wales by 31 January (or other date agreed in writing by Natural Resources Wales) each year. The report(s) shall include as a minimum:

- (a) a review of the results of the monitoring and assessment carried out in accordance with the permit including an interpretive review of that data;
- (b) the annual production / treatment data set out in schedule 4 table S4.2; and
- (c) the performance parameters set out in schedule 4 table S4.3 using the forms specified in table S4.4 of that schedule.

4.2.3 Within 28 days of the end of the reporting period the operator shall, unless otherwise agreed in writing by Natural Resources Wales, submit reports of the monitoring and assessment carried out in accordance with the conditions of this permit, as follows:

- (a) in respect of the parameters and emission points specified in schedule 4 table S4.1;
- (b) for the reporting periods specified in schedule 4 table S4.1 and using the forms specified in schedule 4 table S4.4 ; and
- (c) giving the information from such results and assessments as may be required by the forms specified in those tables.

4.2.4 The operator shall, unless notice under this condition has been served within the preceding four years, submit to Natural Resources Wales, within six months of receipt of a written notice, a report assessing whether there are other appropriate measures that could be taken to prevent, or where that is not practicable, to minimise pollution.

4.2.5 Within 1 month of the end of each quarter, the operator shall submit to Natural Resources Wales using the form made available for the purpose, the information specified on the form relating to the site and the waste accepted and removed from it during the previous quarter.

4.3 Notifications

- 4.3.1 (a) In the event that the operation of the activities gives rise to an incident or accident which significantly affects or may significantly affect the environment, the operator must immediately—
- (i) inform Natural Resources Wales,
 - (ii) take the measures necessary to limit the environmental consequences of such an incident or accident, and
 - (iii) take the measures necessary to prevent further possible incidents or accidents;
- (b) in the event of a breach of any permit condition the operator must immediately—
- (i) inform Natural Resources Wales, and
 - (ii) take the measures necessary to ensure that compliance is restored within the shortest possible time;
- (c) in the event of a breach of permit condition which poses an immediate danger to human health or threatens to cause an immediate significant adverse effect on the environment, the operator must immediately suspend the operation of the activities or the relevant part of it until compliance with the permit conditions has been restored.
- 4.3.2 Any information provided under condition 4.3.1 (a)(i), or 4.3.1 (b)(i) where the information relates to the breach of a limit specified in the permit, shall be confirmed by sending the information listed in schedule 5 to this permit within the time period specified in that schedule.
- 4.3.3 Where Natural Resources Wales has requested in writing that it shall be notified when the operator is to undertake monitoring and/or spot sampling, the operator shall inform Natural Resources Wales when the relevant monitoring and/or spot sampling is to take place. The operator shall provide this information to Natural Resources Wales at least 14 days before the date the monitoring is to be undertaken.
- 4.3.4 Natural Resources Wales shall be notified within 14 days of the occurrence of the following matters, except where such disclosure is prohibited by Stock Exchange rules:
- Where the operator is a registered company:
- (a) any change in the operator's trading name, registered name or registered office address; and
 - (b) any steps taken with a view to the operator going into administration, entering into a company voluntary arrangement or being wound up.
- Where the operator is a corporate body other than a registered company:
- (a) any change in the operator's name or address; and
 - (b) any steps taken with a view to the dissolution of the operator.
- In any other case:
- (a) the death of any of the named operators (where the operator consists of more than one named individual);
 - (b) any change in the operator's name(s) or address(es); and
 - (c) any steps taken with a view to the operator, or any one of them, going into bankruptcy, entering into a composition or arrangement with creditors, or, in the case of them being in a partnership, dissolving the partnership.

4.3.5 Where the operator proposes to make a change in the nature or functioning, or an extension of the activities, which may have consequences for the environment and the change is not otherwise the subject of an application for approval under the Regulations or this permit:

(a) Natural Resources Wales shall be notified at least 14 days before making the change;
and

(b) the notification shall contain a description of the proposed change in operation.

4.3.6 Natural Resources Wales shall be given at least 14 days notice before implementation of any part of the site closure plan.

4.4 Interpretation

4.4.1 In this permit the expressions listed in schedule 6 shall have the meaning given in that schedule.

4.4.2 In this permit references to reports and notifications mean written reports and notifications, except where reference is made to notification being made “immediately”, in which case it may be provided by telephone.

Schedule 1 - Operations

Table S1.1 activities			
Activity reference	Activity listed in Schedule 1 of the EP Regulations	Description of specified activity and WFD Annex I and II operations	Limits of specified activity and waste types
A1	S5.4 A1 (b) (ii)	Pre-treatment of waste for incineration or co-incineration	From receipt of waste to storage of baled Refuse Derived Fuel (RDF)
		D15: Storage pending any of the waste operations numbered D1 to D14 (excluding temporary storage, pending collection, on the site where it is produced).	All waste shall be stored on an impermeable surface with sealed drainage.
		D14: Repackaging prior to submission to any of the operations numbered D1 to D13.	All waste shall be treated inside a building served with an impermeable surface with sealed drainage.
		R13: Storage of waste pending any of the operations numbered R1 to R12 (excluding temporary storage, pending collection, on the site where it is produced).	Treatment consisting only of: - mechanical and manual sorting - separation - screening - shredding - baling of non-hazardous waste for the purpose of recovery.
		R3: Recycling/reclamation of organic substances which are not used as solvents (including composting and other biological transformation processes).	The burning of any wastes, either in the open, inside buildings or in any form of incinerator is not permitted. This permit does not allow for any heat treatment of waste.
		R4: Recycling/reclamation of metals and metal compounds	Production of material to be used as RDF shall be limited to waste types as specified in Table S2.1.
		R5: Recycling/reclamation of other inorganic compounds	
Directly Associated Activity			
A2	Discharge	Discharge to sewer	Potentially contaminated drainage from waste handling areas
A3	Storage	Storage and use of diesel fuel and lubricating and hydraulic oils for plant	Includes receipt and storage
A4	Storage	Storage and use of chemicals for odour suppression.	Includes receipt and storage

Table S1.2 Operating techniques

Description	Parts	Date Received
Application EPR/DP3037EU/A001	All parts of Operating techniques and compliance with BAT	29/01/14
Response to request for additional information	Response to questions 1, 2, 4 and 6 of Schedule 5 notice dated 1st May 2014	15/05/14
Response to request for additional information	Environmental Risk Assessment	15/05/14
Response to regulation 61(1) Notice – request for information dated 05/04/2019 detailing how the Operator will comply with the BAT conclusions for Waste Treatment, under Directive 2010/75/EU of the European Parliament and of the Council	Response to Regulation 61 Notice for Waste Treatment - Enviroparks BATC Aug 20	13/08/20
Fire prevention and mitigation plan guidance – Waste Management	All relevant sections	N/A
Fire prevention and mitigation plan	All relevant sections	In line with Pre-Operational Measure 2

Table S1.3 Pre-operational measures

Reference	Pre-operational measures
POM 1	At least one calendar month before the commencement of operation the operator shall submit for approval an Odour Management Plan in line with the Environment Agency's guidance: "H4-Odour Management – How to Comply with your Environmental Permit" and "Odour Management Plans for Waste Handling Facilities".
POM 2	At least one calendar month before the commencement of operation the operator shall submit for approval a fire management plan based on Natural Resources Wales Guidance document Fire prevention and mitigation plan guidance – Waste Management
POM 3	At least one calendar month before the commencement of operation the operator shall submit the final site drainage plan. This shall include a copy of the consent to discharge to foul sewer.
POM 4	At least six months before the commencement of operation the operator shall submit for approval a BAT Assessment of the permitted activities against the revised Best Available Techniques (BAT) Reference Document (BRef) for Waste Treatment published on the 17 August 2018 in the Official Journal of the European Union. The Operator shall describe how operations meet each of the relevant standards.

Table S1.3 Pre-operational measures	
Reference	Pre-operational measures
POM 5	<p>At least six months before the commencement of operation the operator shall submit for approval a baseline report containing information necessary to determine the current state of soil and groundwater contamination;</p> <p>or</p> <p>Provide a summary report referring to information previously submitted where you are satisfied that such information represents the current state of soil and groundwater contamination;</p> <p>so as to enable a quantified comparison to be made with the state of soil and groundwater contamination upon definitive cessation of activity.</p>
POM 6	<p>At least six months before the commencement of operation the operator shall submit for approval information for priority hazardous substances and any other relevant substances. The emissions monitoring for these substances should be carried out using the methods and standards described in the M18 guidance on "Monitoring of discharges to water and sewer".</p> <p>With reference to the risk assessment guidance on the gov.uk website entitled "Surface water pollution risk assessment for your environmental permit the Operator is to carry out the following assessments:</p> <ul style="list-style-type: none"> – Screening tests for priority hazardous pollutants and any other relevant priority hazardous substances. – For any substance which is not screened out by the screening tests you will need to carry out modelling, as described in the risk assessment guidance "Surface water pollution risk assessment for your environmental permit". <p>You must provide us with the results from the emissions monitoring, the results from the screening tests and the results from any modelling.</p>

Schedule 2 - Waste types, raw materials and fuels

Table S2.1 Permitted waste types and quantities for production of RDF

Maximum quantity	The maximum quantity of waste to be accepted on site shall not exceed 240,000 tonnes per annum
Waste code	Description
02	WASTES FROM AGRICULTURE, HORTICULTURE, AQUACULTURE, FORESTRY, HUNTING AND FISHING, FOOD PREPARATION AND PROCESSING
02 01	Wastes from agriculture, horticulture, aquaculture, forestry, hunting and fishing
02 01 03	Plant tissue waste
02 01 04	Waste plastics (except packaging)
02 01 07	Waste from forestry
03	WASTES FROM WOOD PROCESSING AND THE PRODUCTION OF PAPER, CARDBOARD, PULP, PANELS AND FURNITURE
03 01	Wastes from wood processing and the production of panels and furniture
03 01 01	Waste bark and cork
03 01 05	Sawdust, shavings, cuttings, wood, particle board and veneer other than those mentioned in 03 01 04
03 03	Wastes from pulp, paper and cardboard production and processing
03 03 01	Waste bark and wood
03 03 08	Waste from sorting of paper and cardboard destined for recycling
04	WASTES FROM THE LEATHER, FUR AND TEXTILE INDUSTRIES
04 02	Wastes from the textile industry
04 02 09	Wastes from composite materials (impregnated textile, elastomer, plastomer)
04 02 15	Wastes from finishing other than those mentioned in 04 02 14
04 02 21	Waste from unprocessed textile fibres
04 02 22	Waste from processed textile fibres
07	WASTES FROM ORGANIC CHEMICAL PROCESSES
07 02	Wastes from the MFSU of plastics, synthetic rubber and man-made fibres
07 02 13	Waste plastic
09	WASTES FROM THE PHOTOGRAPHIC INDUSTRY
09 01	Wastes from the photographic industry
09 01 07	Photographic film and paper containing silver or silver compounds
09 01 08	Photographic film and paper free of silver or silver compounds
09 01 10	Single-use cameras without batteries
09 01 12	Single-use cameras containing batteries other than those mentioned in 09 01 11
12	WASTES FROM SHAPING AND PHYSICAL AND MECHANICAL SURFACE TREATMENT OF METALS AND PLASTICS
12 01	Wastes from shaping and physical and mechanical surface treatment of metals and plastics
12 01 05	Plastics shavings and turnings
15	WASTE PACKAGING, ABSORBENTS, WIPING CLOTHS, FILTER MATERIALS AND PROTECTIVE CLOTHING NOT OTHERWISE SPECIFIED
15 01	Packaging (including separately collected municipal packaging waste)
15 01 01	Paper and cardboard packaging
15 01 02	Plastic packaging
15 01 03	Wooden packaging

Table S2.1 Permitted waste types and quantities for production of RDF

Maximum quantity	The maximum quantity of waste to be accepted on site shall not exceed 240,000 tonnes per annum
Waste code	Description
15 01 04	Metallic packaging
15 01 05	Composite packaging
15 01 06	Mixed packaging
15 01 07	Glass packaging
15 01 09	Textile packaging
15 02	Absorbents, filter materials, wiping cloths and protective clothing
15 02 03	Absorbents, filter materials, wiping cloths, protective clothing other than those mentioned in 15 02 02
17	CONSTRUCTION AND DEMOLITION WASTES (INCLUDING EXCAVATED SOIL FROM CONTAMINATED SITES)
17 02	Wood, glass and plastic
17 02 01	Wood
17 02 02	Glass
17 02 03	Plastic
19	WASTES FROM WASTE MANAGEMENT FACILITIES, OFF-SITE WASTE WATER TREATMENT PLANTS AND THE PREPARATION OF WATER INTENDED FOR HUMAN CONSUMPTION AND WATER FOR INDUSTRIAL USE
19 02	Wastes from physico/chemical treatments of waste (including dechromatation, decyanidation, neutralisation)
19 02 03	Premixed waste composed only of non-hazardous wastes
19 02 10	Combustible wastes other than those mentioned in 19 02 08 and 19 02 09
19 05	Wastes from aerobic treatment of solid wastes
19 05 01	Non-composted fraction of municipal and similar waste
19 05 02	Non-composted fraction of animal and vegetable waste
19 12	Wastes from the mechanical treatment of waste (e.g. sorting, crushing, compacting, pelletising) not otherwise specified
19 12 01	Paper and cardboard
19 12 02	Ferrous metal
19 12 03	Non-ferrous metal
19 12 04	Plastic and rubber
19 12 05	glass
19 12 07	Wood other than that mentioned in 19 12 06
19 12 08	Textiles
19 12 10	Combustible waste (refuse derived fuel)
20	MUNICIPAL WASTES (HOUSEHOLD WASTE AND SIMILAR COMMERCIAL, INDUSTRIAL AND INSTITUTIONAL WASTES) INCLUDING SEPARATELY COLLECTED FRACTIONS
20 01	Separately collected fractions (except 15 01)
20 01 01	Paper and cardboard
20 01 02	glass
20 01 10	Clothes
20 01 11	Textiles
20 01 38	Wood other than that mentioned in 20 01 37
20 01 39	Plastics
20 01 40	metals
20 02	Garden and park wastes (including cemetery waste)
20 02 01	Biodegradable waste

Table S2.1 Permitted waste types and quantities for production of RDF

Maximum quantity	The maximum quantity of waste to be accepted on site shall not exceed 240,000 tonnes per annum
Waste code	Description
20 02 03	Other non-biodegradable waste
20 03	Other municipal wastes
20 03 01	Mixed municipal waste
20 03 02	Waste from markets
20 03 03	Street cleaning residues

Schedule 3 – Emissions and monitoring

Table S3.1 Point source emissions to air – emission limits and monitoring requirements

Emission point ref. & location	Source	Parameter	Limit (including unit)	Reference period	Monitoring frequency	Monitoring standard or method
No point source emissions to air	-	-	-	-	-	-

Table S3.2 Point Source emissions to water (other than sewer) and land – emission limits and monitoring requirements

Emission point ref. & location	Source	Parameter	Limit (including unit)	Reference Period	Monitoring frequency	Monitoring standard or method
S1 - Emission point to swale	Clean rainwater run-off from roof top and areas not associated with waste handling	No parameters set	No limit set	-	-	-

Table S3.3 Point Source emissions to sewer, effluent treatment plant or other transfers off-site emission limits and monitoring requirements

Emission point ref. & location	Source	Parameter	Limit (including unit)	Reference Period	Monitoring frequency	Monitoring standard or method
F1 on site plan in Schedule 7 – release of waste water to sewer in accordance with Dŵr Cymru Welsh Water Trade Effluent consent	Waste water from Vehicle wash and waste storage area in building	To be agreed upon completion of pre-operational measure 4 ^{Note 1}	To be agreed upon completion of pre-operational measure 4	To be agreed upon completion of pre-operational measure 4	To be agreed upon completion of pre-operational measure 4	To be agreed upon completion of pre-operational measure 4

Note 1: The monitoring of parameters and limits to be set are to be agreed, if substances are identified as relevant following completion of the waste water inventory required by BAT 3 of the Waste Treatment BREF Document (EU 2018), to be provided as part response to pre-operational measure 4 by the operator.

Schedule 4 - Reporting

Parameters, for which reports shall be made, in accordance with conditions of this permit, are listed below.

Table S4.1 Reporting of monitoring data

Parameter	Emission or monitoring point/reference	Reporting period	Period begins
Emissions to sewer Parameters as required by condition 3.5.1.	F1	To be agreed with NRW	To be agreed with NRW

Table S4.2: Annual production/treatment

Parameter	Units
Total Refuse Derived Fuel (RDF) produced	tonnes
Total amount of waste treated	tonnes

Table S4.3 Performance parameters

Parameter	Frequency of assessment	Units
Water usage	Annually	m ³
Energy usage	Annually	MWh
Generation of residues	Annually	tonnes
Generation of waste water	Annually	m ³
Total raw material used	Annually	tonnes

Table S4.4 Reporting forms

Media/parameter	Reporting format	Date of form
Sewer	Form sewer1 or other form as agreed in writing by Natural Resources Wales	22/02/2021
Water usage	Form water usage 1 or other form as agreed in writing by Natural Resources Wales	22/02/2021
Energy usage	Form energy 1 or other form as agreed in writing by Natural Resources Wales	22/02/2021
Other performance indicators	Form performance 1 or other form as agreed in writing by Natural Resources Wales	22/02/2021
Waste Subject to Conditions 4.2.5	Waste tonnage return form from the Natural Resources Wales website or other form as agreed in writing by Natural Resources Wales	N/A

Schedule 5 - Notification

These pages outline the information that the operator must provide.

Units of measurement used in information supplied under Part A and B requirements shall be appropriate to the circumstances of the emission. Where appropriate, a comparison should be made of actual emissions and authorised emission limits.

If any information is considered commercially confidential, it should be separated from non-confidential information, supplied on a separate sheet and accompanied by an application for commercial confidentiality under the provisions of the EP Regulations.

Part A

Permit Number	
Name of operator	
Location of Facility	
Time and date of the detection	

(a) Notification requirements for any activity that gives rise to an incident or accident which significantly affects or may significantly affect the environment	
To be notified within 24 hours of detection	
Date and time of the event	
Reference or description of the location of the event	
Description of where any release into the environment took place	
Substances(s) potentially released	
Best estimate of the quantity or rate of release of substances	
Measures taken, or intended to be taken, to stop any emission	
Description of the failure or accident.	

(b) Notification requirements for the breach of a permit condition	
To be notified within 24 hours of detection	
Emission point reference/ source	
Parameter(s)	
Limit	
Measured value and uncertainty	
Date and time of monitoring	
Measures taken, or intended to be taken, to stop the emission	

Time periods for notification following detection of a breach of a limit	
Parameter	Notification period

(c) In the event of a breach of permit condition which poses an immediate danger to human health or threatens to cause an immediate significant adverse effect on the environment:

To be notified within 24 hours of detection

Description of where the effect on the environment was detected	
Substances(s) detected	
Concentrations of substances detected	
Date of monitoring/sampling	

Part B - to be submitted as soon as practicable

Any more accurate information on the matters for notification under Part A.	
Measures taken, or intended to be taken, to prevent a recurrence of the incident	
Measures taken, or intended to be taken, to rectify, limit or prevent any pollution of the environment which has been or may be caused by the emission	
The dates of any unauthorised emissions from the facility in the preceding 24 months.	

Name*	
Post	
Signature	
Date	

* authorised to sign on behalf of the operator

Schedule 6 - Interpretation

“accident” means an accident that may result in pollution.

“Annex I” means Annex I to Directive 2008/98/EC of the European Parliament and of the Council on waste.

“Annex II” means Annex II to Directive 2008/98/EC of the European Parliament and of the Council on waste.

“application” means the application for this permit, together with any additional information supplied by the operator as part of the application and any response to a notice served under Schedule 5 to the EP Regulations.

“authorised officer” means any person authorised by Natural Resources Wales under section 108(1) of The Environment Act 1995 to exercise, in accordance with the terms of any such authorisation, any power specified in section 108(4) of that Act.

“best available treatment, recovery and recycling techniques” shall have the meaning given to it in the document published jointly by the Department for Environment, Food and Rural Affairs, the Welsh Assembly Government and the Scottish Executive on 27th November 2006, entitled “Guidance on Best Available Treatment, Recovery and Recycling Techniques (BATRRT) and Treatment of Waste Electrical and Electronic Equipment (WEEE).

“building” means a construction that has the objective of providing sheltering cover and minimising emissions of noise, particulate matter, odour and litter.

“disposal” or “D” means any of the operations provided for in Annex I to Directive 2008/98/EC of the European Parliament and of the Council on waste.

“emissions of substances not controlled by emission limits” means emissions of substances to air, water or land from the activities, either from the emission points specified in schedule 3 or from other localised or diffuse sources, which are not controlled by an emission or background concentration limit.

“EP Regulations” means The Environmental Permitting (England and Wales) Regulations SI 2016 No.1154 and words and expressions used in this permit which are also used in the Regulations have the same meanings as in those Regulations.

“groundwater” means all water, which is below the surface of the ground in the saturation zone and in direct contact with the ground or subsoil.

“hazardous property” has the meaning in Annex III of the Waste Framework Directive

“hazardous waste” has the meaning given in the Hazardous Waste (Wales) Regulations 2005 (as amended)

“hazardous substance” means a substance classified as hazardous as a consequence of fulfilling the criteria laid down in parts 2 to 5 of Annex I to Regulation (EC) No 1272/2008

“impermeable surface” means a surface or pavement constructed and maintained to a standard sufficient to prevent the transmission of liquids beyond the pavement surface.

“Industrial Emissions Directive” means DIRECTIVE 2010/75/EU OF THE EUROPEAN PARLIAMENT AND OF THE COUNCIL of 24 November 2010 on industrial emissions

“MCERTS” means the Environment Agency’s Monitoring Certification Scheme.

“Pests” means Birds, Vermin and Insects.

“quarter” means a calendar year quarter commencing on 1 January, 1 April, 1 July or 1 October.

“recovery” or “R” means any of the operations provided for in Annex II to Directive 2008/98/EC of the European Parliament and of the Council on waste.

“residue” means the solid waste generated by the waste treatment activity and is not directly related to the type of waste treated in the plant.

“*Sorting*” means sorting that may be undertaken by hand or machinery. Sorting enables materials to be processed and recycled appropriately. It may involve separation of different waste types or the separation of different metal types including different ferrous metals, non-ferrous metals and non-metallic materials (e.g. paper and plastic). The sorted metals are graded by visual inspection, supplemented by chemical and other laboratory tests. The physical sorting may be assisted by conveyors and electromagnets.

“*Waste code*” means the six digit code referable to a type of waste in accordance with the list of wastes established by Commission Decision 2000/532/EC as amended from time to time (the ‘List of Wastes Decision’) and in relation to hazardous waste, includes the asterisk.

“*Waste Framework Directive*” or “*WFD*” means Waste Framework Directive 2008/98/EC of the European Parliament and of the Council on waste.

“*Waste Treatment BAT Conclusions*” means the BAT Conclusions for the Waste Treatment sector published as a Commission Implementing Decision EU 2018/1447 in the Official Journal of the EU on 17 August 2018

“*Year*” means calendar year ending 31 December.

Where a minimum limit is set for any emission parameter, for example pH, reference to exceeding the limit shall mean that the parameter shall not be less than that limit.

Unless otherwise stated, any references in this permit to concentrations of substances in emissions into air means: in relation to emissions from combustion processes, the concentration in dry air at a temperature of 273K, at a pressure of 101.3 kPa and with an oxygen content of 3% dry for liquid and gaseous fuels, 6% dry for solid fuels; and/or

in relation to emissions from non-combustion sources, the concentration at a temperature of 273K and at a pressure of 101.3 kPa, with no correction for water vapour content.

Schedule 7 - Site plan

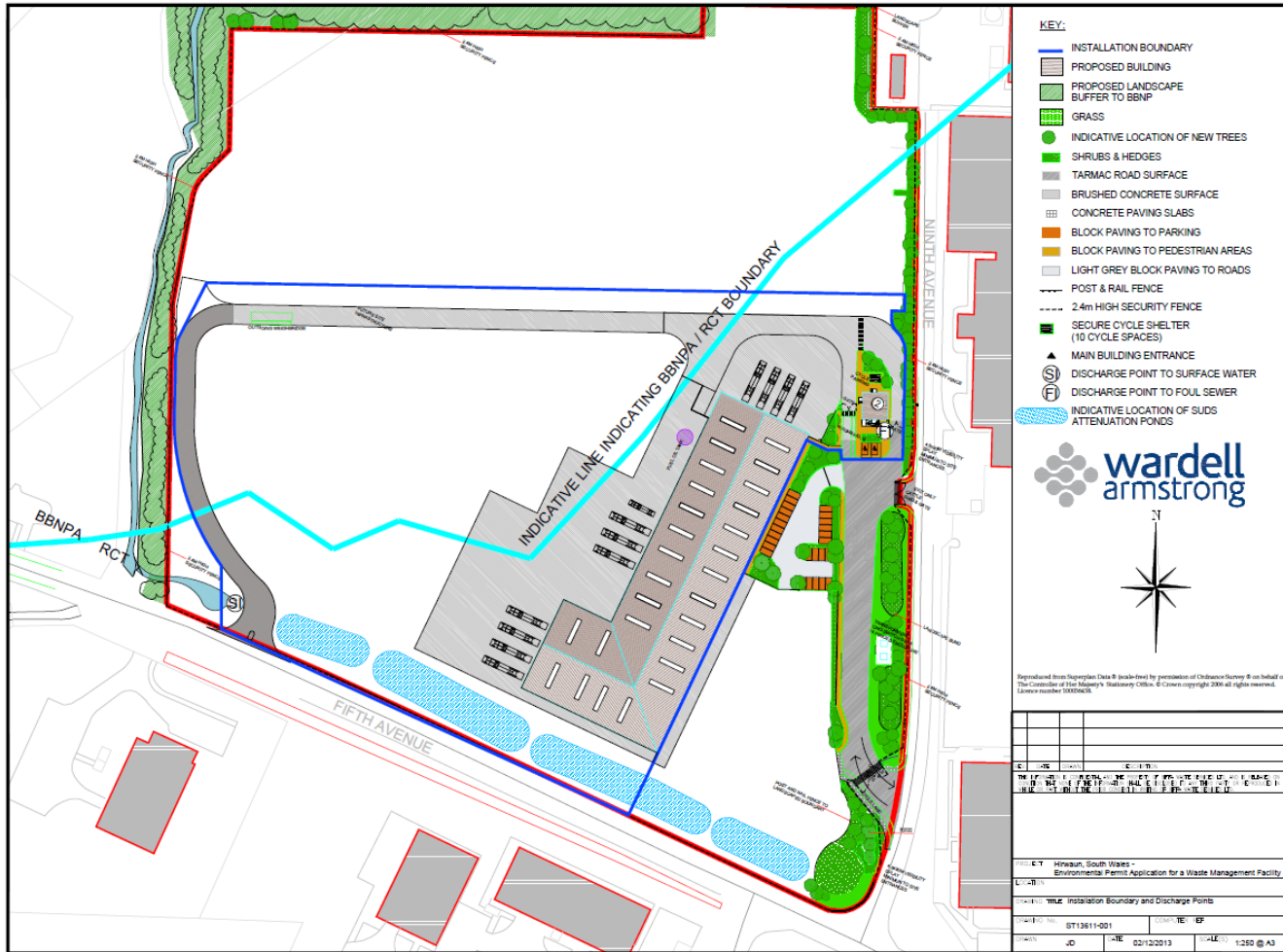

© Crown Copyright and database right 2020. Ordnance Survey licence number 100019741.

END OF PERMIT