

Notes

1. This drawing has been prepared in accordance with the scope of RPS's appointment with its client and is subject to the terms and conditions of that appointment. RPS accepts no liability for any use of this document other than by its client and only for the purposes for which it was prepared and provided.
2. If received electronically it is the recipients responsibility to print to correct scale. Only written dimensions should be used.
3. This drawing should be read in conjunction with all other relevant drawings and specifications.

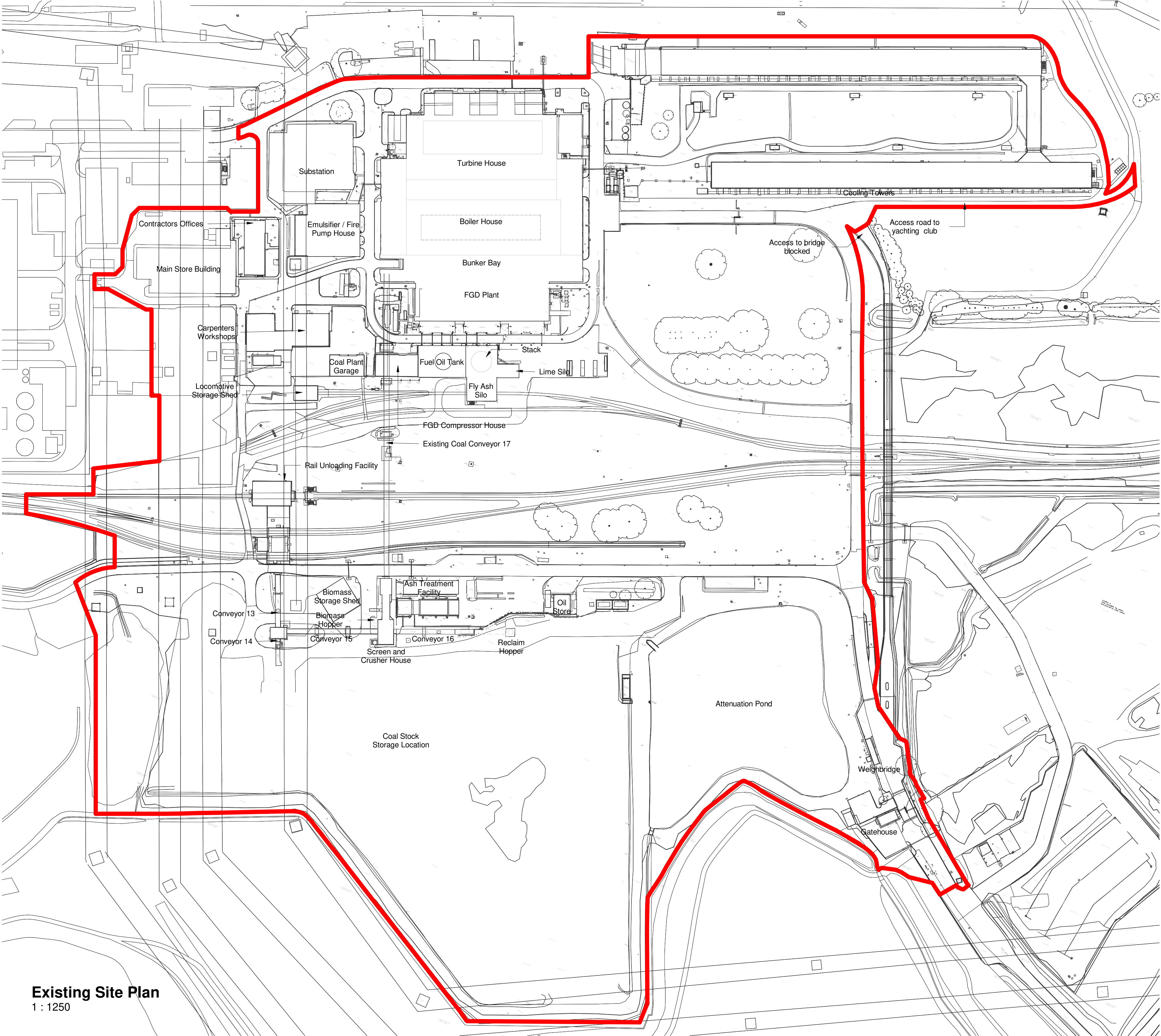

Existing Site Plan  
1 : 1250

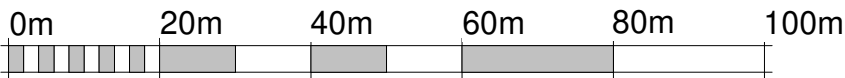
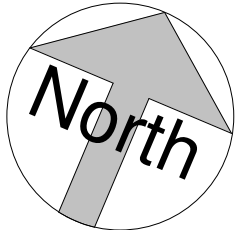

VISUAL SCALE 1:1000 @ A1

P06	Redline boundary plan revised to suit new site layout	PBR	TFH	04/02/20
P05	Drawing revised and updated to reflect new topographical survey	PBR	TFH	12/09/19
P04	Site boundry revised	PBR	TFH	01/08/19
P03	Drawing revised to curent details	PBR	TFH	03/07/19
P02	Drawing updated and revised to current format	PBR	NB	07/06/19
P01	First Issue	TFH	PR	13/05/19
Rev	Description	By	Ckd	Date



Suite D10, Josephs Well, Hanover Walk  
Leeds, West Yorkshire LS3 1AB, United Kingdom  
T:0113 220 6190 E:exp@rpsgroup.com



Project SUP Fuel Conversion project

Title Existing SUP Site Plan

Status	Scale @ A1	Date Created
Preliminary	1 : 1250	05/13/19
Task Team Manager	Information Author	Task Information Manager
TFH	TFH	PR

Document Number  
019784-RPS-SI-ZZ-DR-A-5002

RPS Project Number	Suitability	Revision
NK019784	S0	P06
rpsgroup.com		