

100
0 10
Millimetres

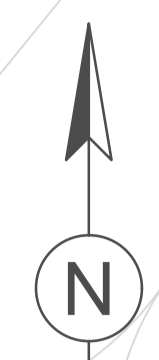

DO NOT SCALE

NOTES:

- ALL DIMENSIONS ARE IN MILLIMETRES UNLESS NOTED OTHERWISE.
- ALL LEVELS IN METRES TO ORDNANCE DATUM NEWLYN.

KEY

- EXISTING CONCRETE FOOTPATH TO BE RETAINED/RENEWED
- EXISTING COBBLED EDGE TO BE RETAINED
- PROPOSED FLOOD DEFENCE WALL
- PROPOSED LOCATION OF TILT BARRIER
- POSITION OF CURRENT SEA DEFENCES
- PROPOSED LOCATION OF LAMP POST POSITIONED ON ROAD SIDE OF PROPOSED FLOOD DEFENCES TO PROVIDE PROTECTION FROM SEA WATER. PROTECTION FROM VEHICLES WILL BE REQUIRED
- POTENTIAL IMPROVEMENT WORKS WITHIN THE HATCHED AREA- SEE NOTE ON DRAWING
- EXISTING BOLLARDS TO BE RELOCATED
- PROPOSED BENCHES GREEN INDICATES WALL FIXED BENCHES. BROWN INDICATES FREE STANDING BENCHES
- EXISTING TREES TO BE RETAINED AND PROTECTED DURING CONSTRUCTION
- PROPOSED CYCLE PARKING BAYS

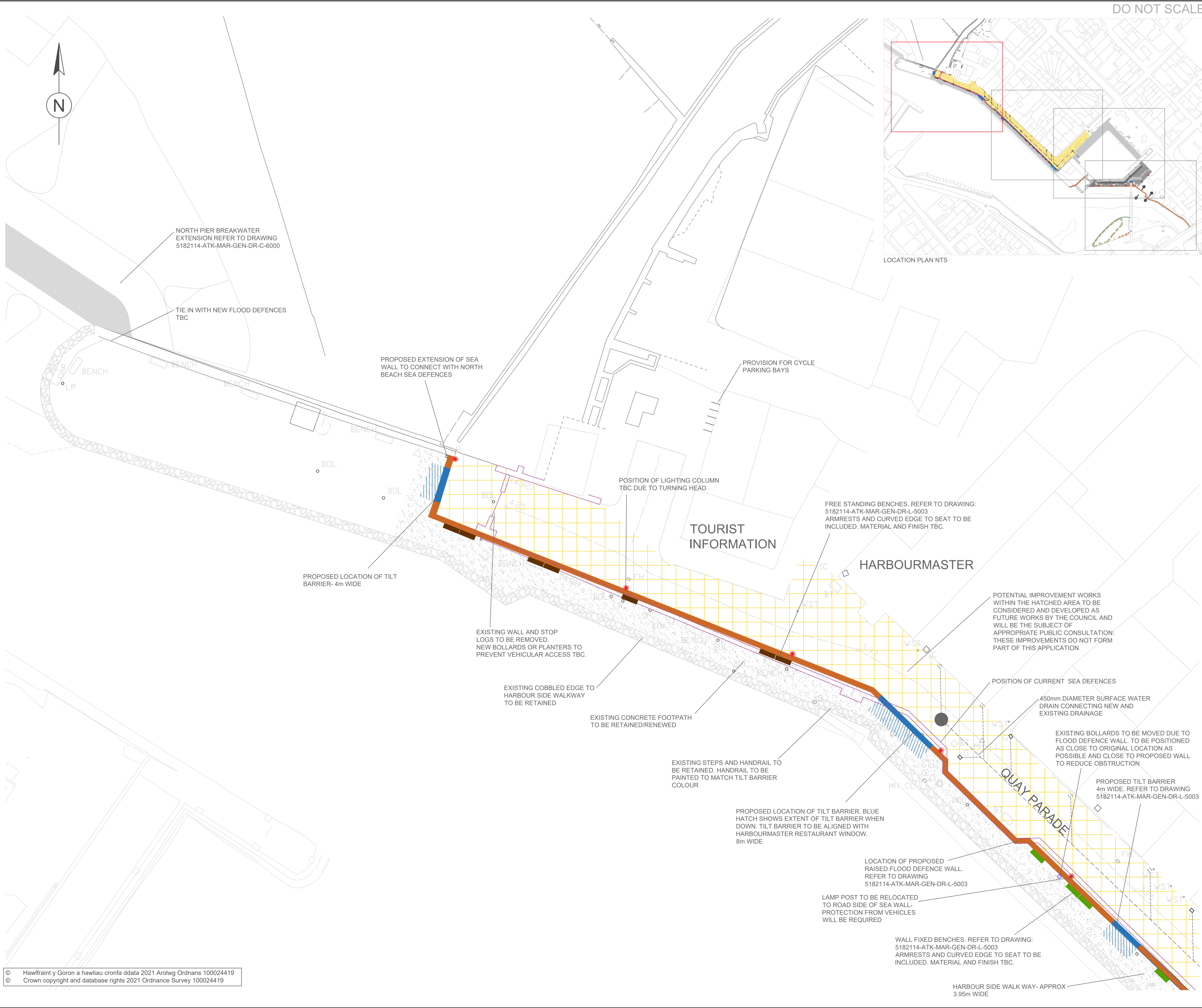
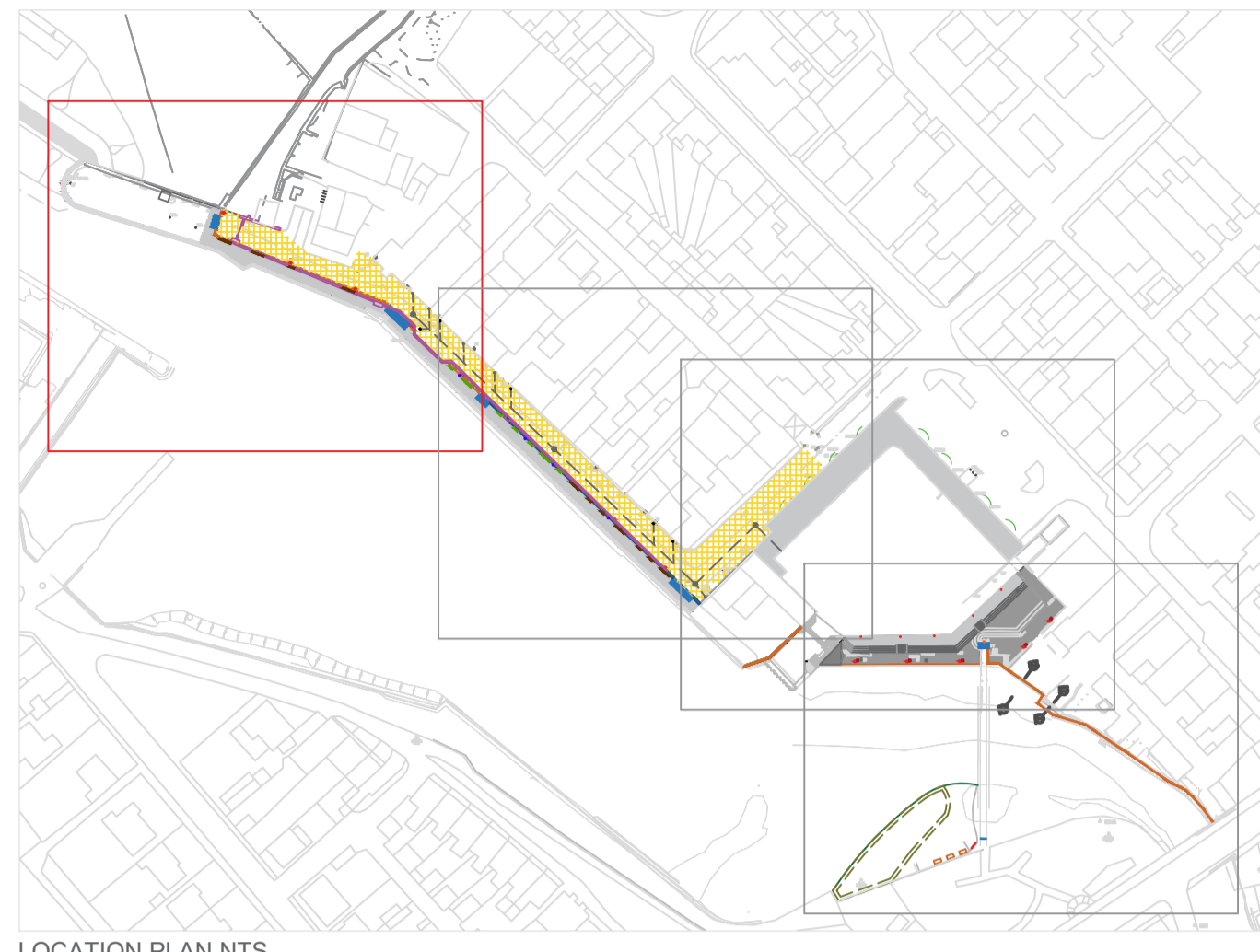

SAFETY, HEALTH AND ENVIRONMENTAL INFORMATION

In addition to the hazards/risks normally associated with the types of work detailed on this drawing, note the following:

CONSTRUCTION

Potential for striking live underground services or unrecorded services. Risk of collapse of unstable structures such as South Pier. Access to the car park near the Yacht club is restricted as the area is used for boat storage during the winter. Access to Quay Parade is narrow with parked vehicles present adjacent to the harbour wall. The harbour is operational with small leisure craft and fishing boats accessing and egressing during high water. Potential presence of Sabellaria at North Beach. Presence of historic fish traps on South Beach to be demarked during construction.

MAINTENANCE/CLEANING

N/A

DECOMMISSIONING/DEMOLITION

N/A

It is assumed that all works will be carried out by a competent contractor working, where appropriate, to an approved method statement

Rev.	Date	Description	By	Chk'd	App'd
C03	16.04.21	FOR PLANNING	JS	MJT	RAM
C02	26.03.21	FOR PLANNING	JS	JL	RAM
C01	10.03.21	FOR CLIENT COMMENT	JS	JL	RAM

Drawing Status: **FOR PLANNING** Suitability: **A1**

ATKINS West Glamorgan House
12 Orchard Street
Swansea SA1 5AD
Tel: +44 (0)1792 641172
Fax: +44 (0)1792 472019
Copyright © Atkins Limited (2013) www.atkinsglobal.com

Client: Cyngor Sir CEREDIGION County Council

Project Title: **ABERAERON COASTAL DEFENCE SCHEME**

Drawing Title: **QUAY PARADE PLAN 1**

Scale	Designed	Drawn	Checked	Authorised
1:200	JS	JS	JL	RAM
Original Size	Date	Date	Date	Date
A1	16.04.21	16.04.21	16.04.21	16.04.21
Drawing Number	Revision			
5182114-ATK-MAR-GEN-DR-L-5001	C03			