

ENTRANCE / ROAD DETAIL

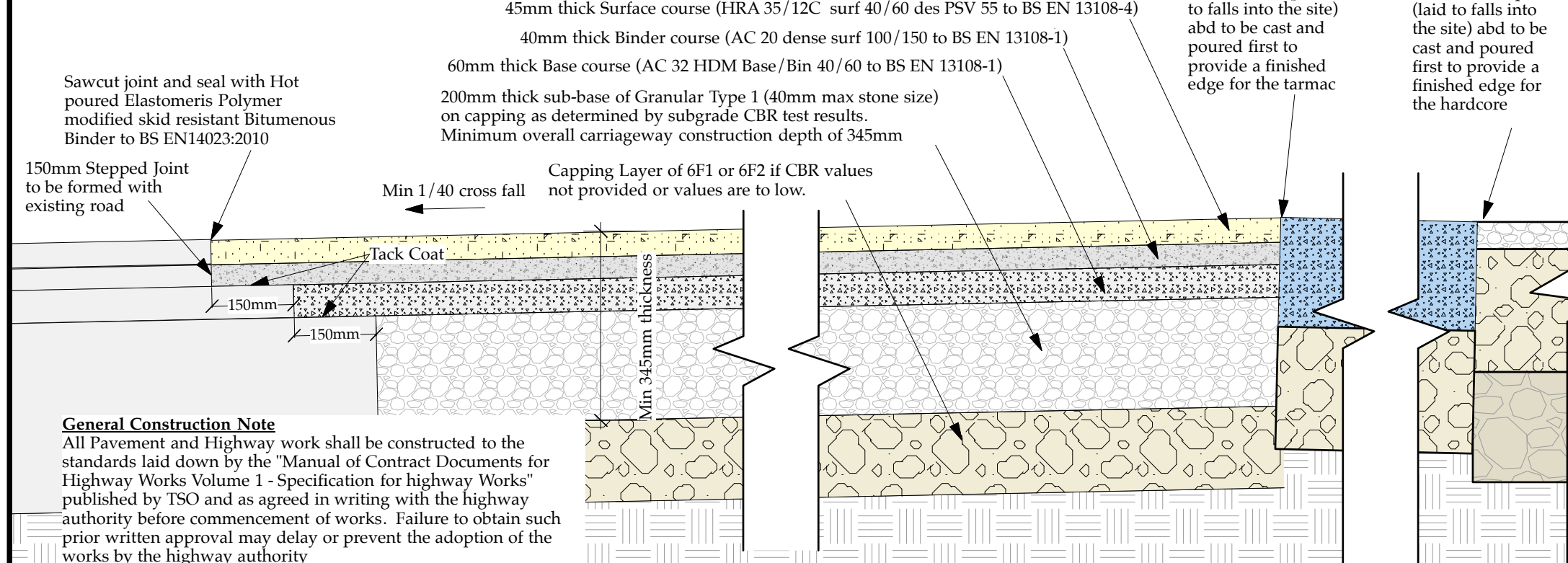

DETAIL CONCRETE ENTRANCE RAMP

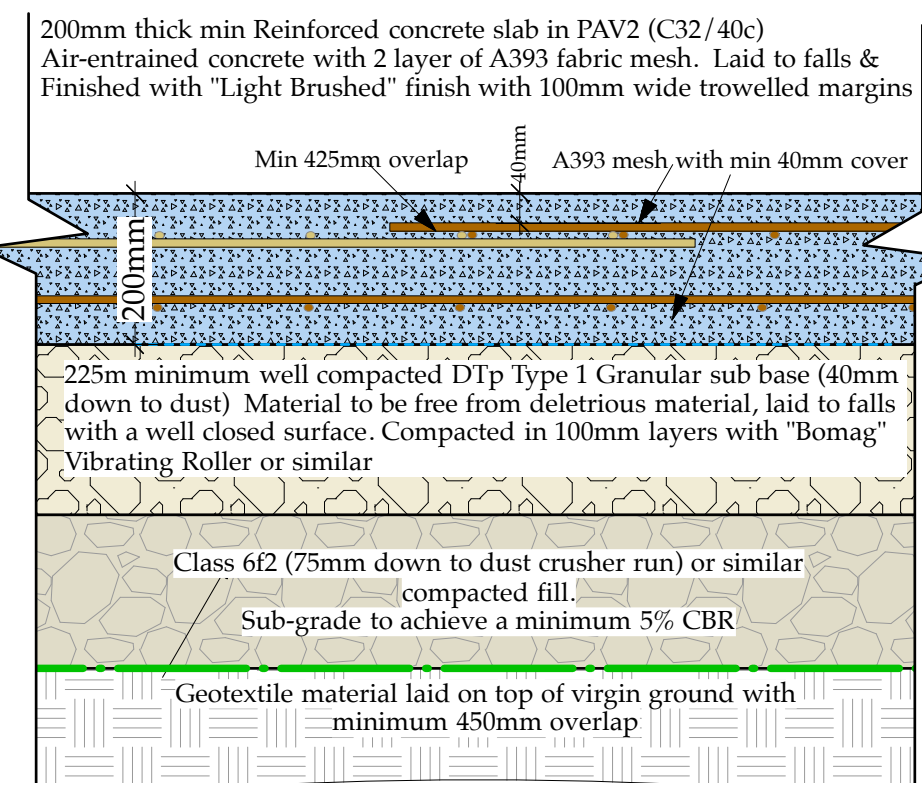

DETAIL CONCRETE CONNECTION

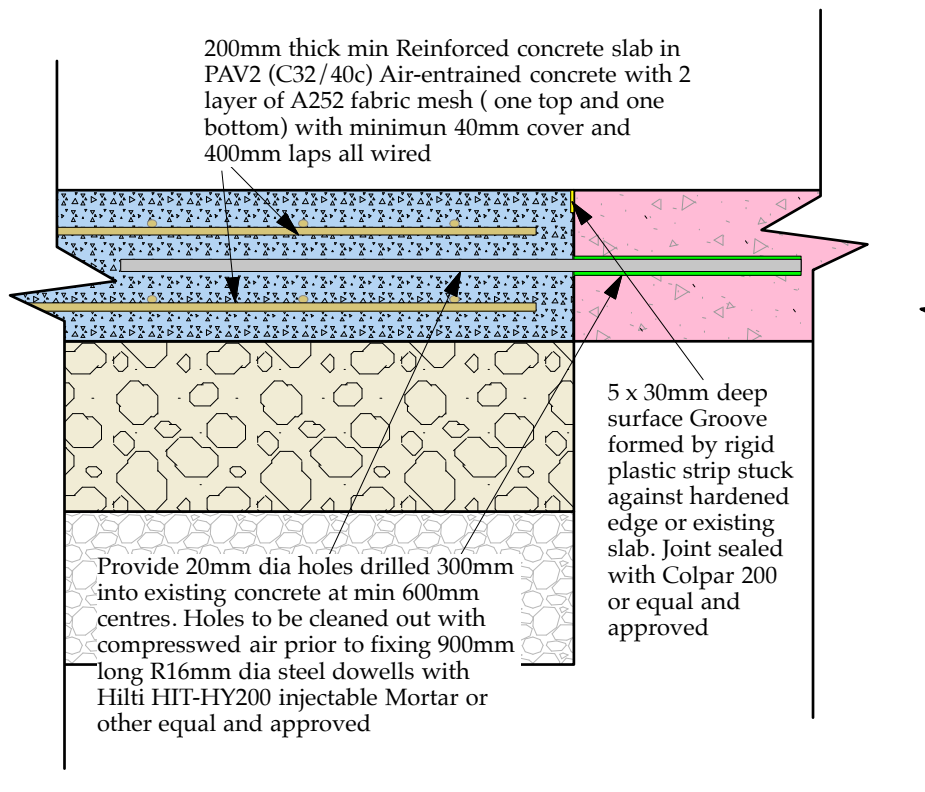

DETAIL GRAVELLED HARDSTANDING

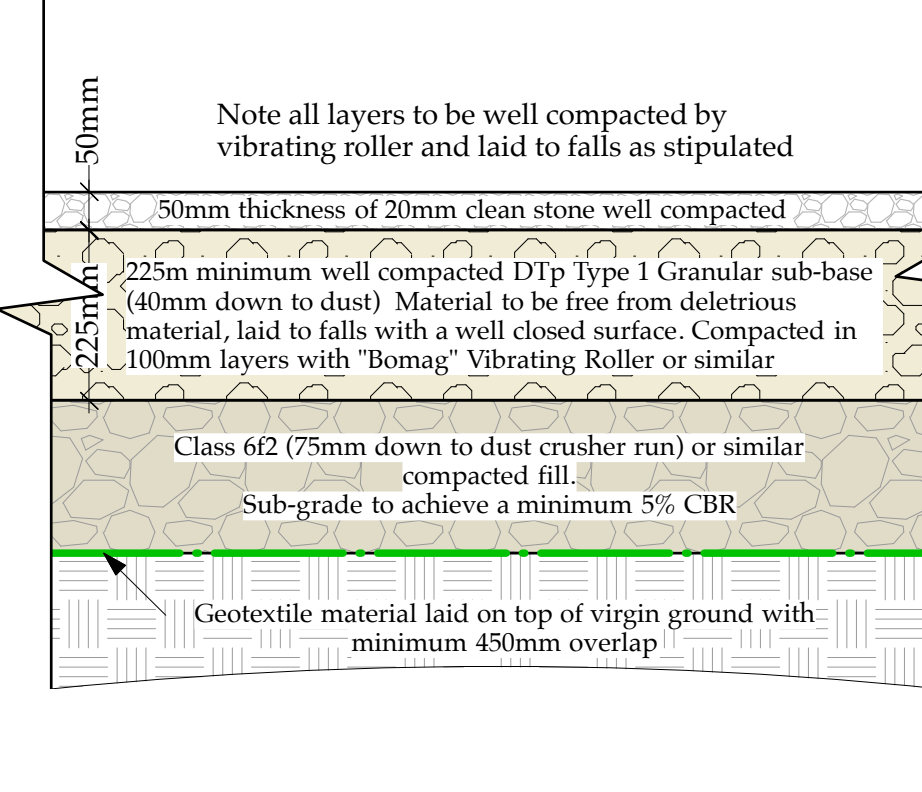

KERB DETAIL

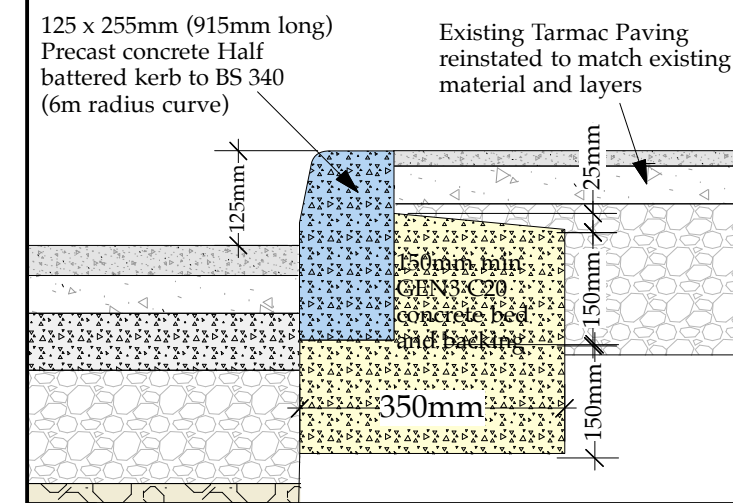

NB2

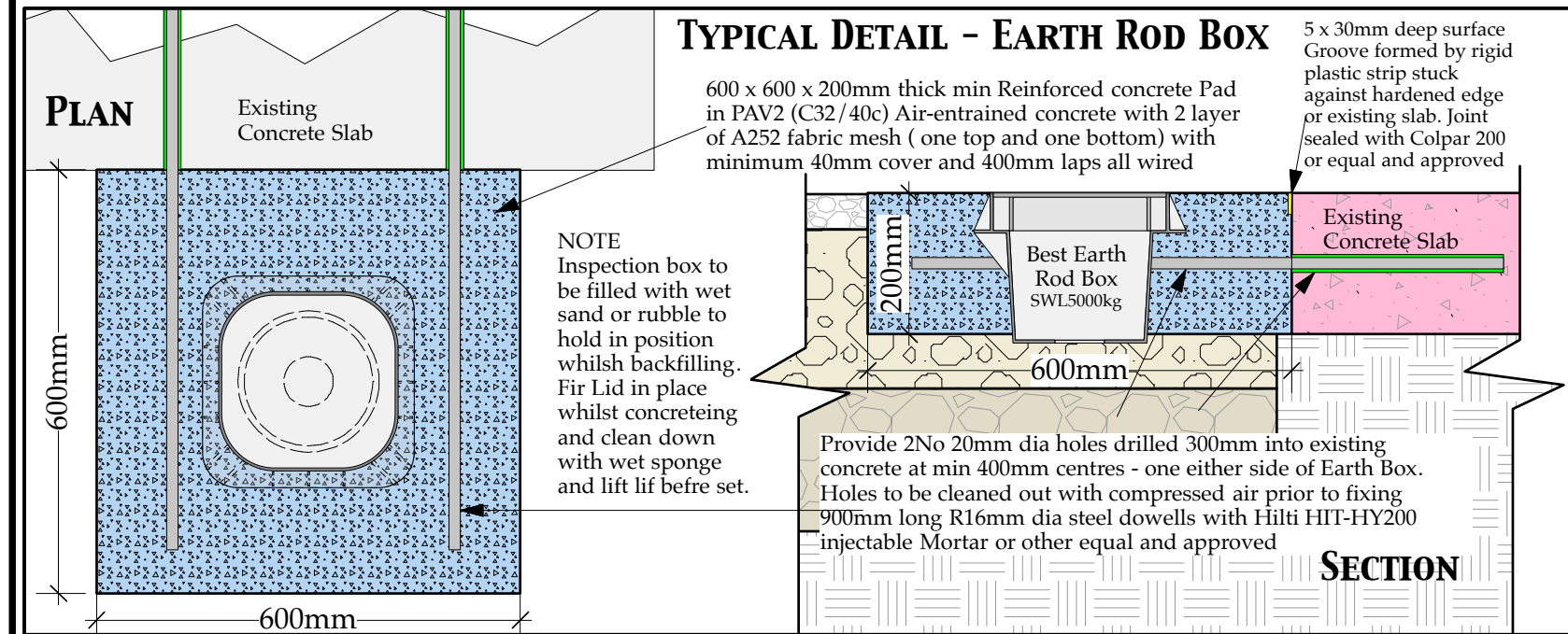

PROPOSED MAINTENANCE ENTRANCE GATES USING EXISTING FENCE PANELS

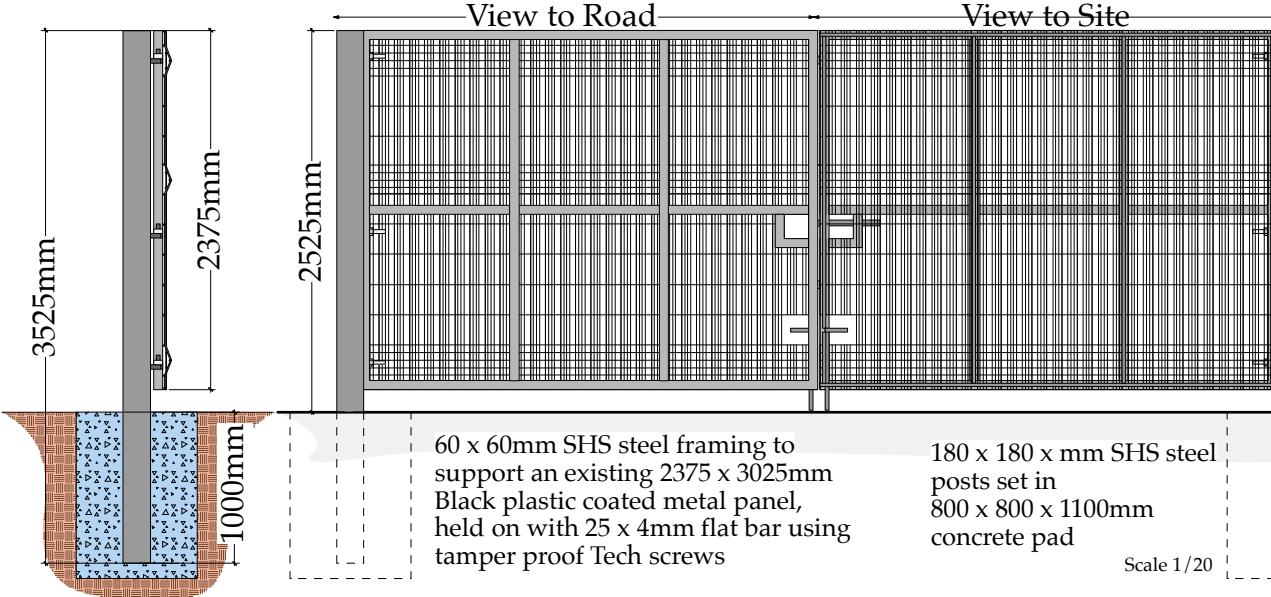

EXISTING DISMANTLED FENCE TO BE RE ERRECTED

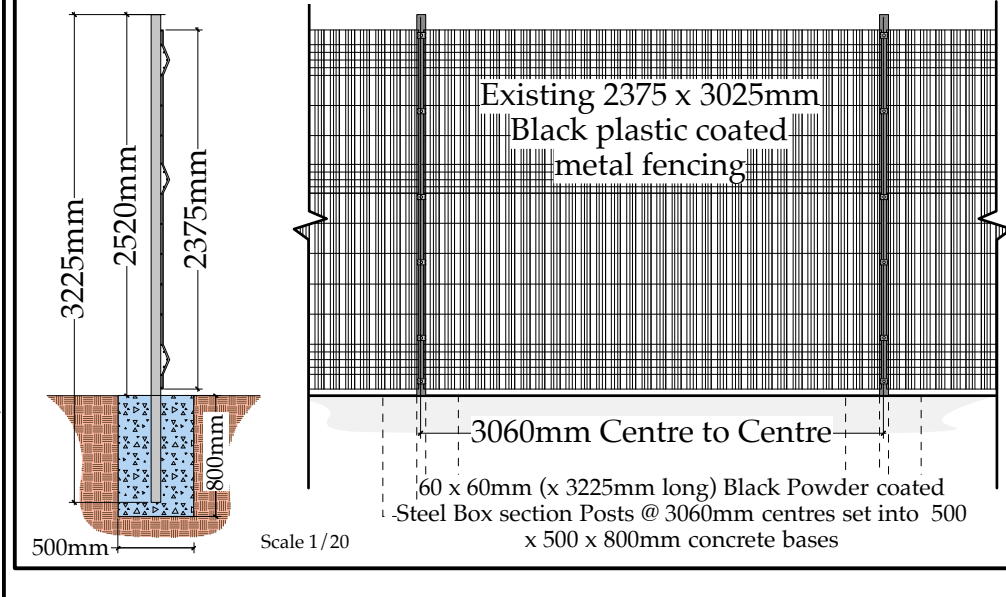

PROPOSED NEW FENCE TO EXTEND SECURE COMPOUND

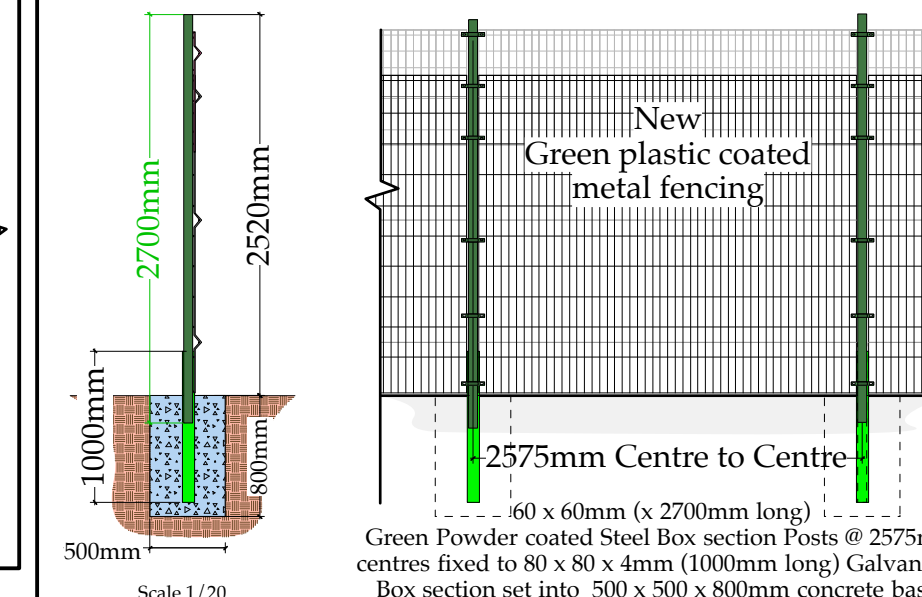

R. Arwel Davies & Co
 Chartered Building Surveyors
 Llwyn Derw, Prion, Denbigh, Denbighshire Tel 01745 890 635

Property
 Unit B & C, Tir Llwyd Enterprise Park
 Kinnel Bay, Nr Rhyl,
 Sir Conwy, LL18 5JZ

Clients
 North West Biomass Ltd

Project Title
 Proposed Combined Heat & Power Unit

Drawing Title
 As Proposed Rear Hardstanding

Drawings No.
 2016/10/AP3/d

Date
 18th Oct 2017

Scale
 1/100, 1/20 & 1/10

Drawn on A1 sheet by
 R. Arwel Davies