

Permit with introductory note

The Environmental Permitting (England & Wales) Regulations 2010

Mr Martyn Langford

Rhosddu Farm Poultry Farm
Rhosddu Farm
Llansantffraid-Ym-Mechain
Welshpool
Powys
SY22 6TH

Permit number
EPR/AB3095HL

Rhosddu Farm Poultry Unit

Permit number EPR/AB3095HL

Introductory note

This introductory note does not form a part of the permit

The main features of the permit are as follows.

Rhosddu Farm Poultry Unit is situated approximately 3.5 kilometres to the south west of the village of Llansantffraid-ym-Mechain in Powys. The installation is approximately centred on National Grid Reference SJ 20483 17208.

The installation is operated by Mr Martyn Langford and will house a maximum of 56,000 laying birds. The birds will be brought to the site at the time that they start to lay eggs and will be removed after approximately 54-64 weeks on an all-out basis. The birds will be housed in three buildings built to the best environmental standards. The birds are able to enter and exit the buildings by means of pop holes and can then range outside. All three houses are equipped with high velocity roof fans for ventilation. There will be two 180Kw Combined Heat and Power Units and one 211Kw Biomass Boiler whose purpose is to partly produce electric for use on the site and partly to provide warm air within the poultry houses. Some biomass drying will take place to ensure the biomass dry matter content is optimum for the units. Litter in house 1 will be removed on an end of crop basis. Houses 2 and 3 are equipped with manure belts which are operated twice per week to remove litter.

After the stock are removed, the remaining litter is removed and the buildings are washed and disinfected. All wash waters are collected in a sealed underground tank.

The status log of the permit sets out the permitting history, including any changes to the permit reference number.

Status log of the permit		
Description	Date	Comments
Application EPR/NP3431VM/A001	28/10/2014	Application for Installation
Additional information requested	05/12/2015	
Additional information received	12/12/2014	Information detailing how the existing poultry houses meet BAT. Assessment of odour emissions from normal operation of the poultry unit.
Additional information requested	05/02/2015	
Additional information received	07/03/2015	Odour Modelling Report
Permit determined EPR/AB3095HL	08/04/2015	Permit Issued

Status log of the permit

Description	Date	Comments
Variation Application EPR/AB3095HL/V002	Duly Made 03/10/2016	
Variation Determined EPR/AB3095HL/V002	03/11/2016	Permit Issued

End of introductory note

Permit

The Environmental Permitting (England and Wales) Regulations 2010

Permit number
EPR/AB3095HL

This is the consolidated permit referred to in the variation and consolidation notice for application EPR/AB3095HL/V002 authorising,

Martyn Langford ("the operator"),
of

Rhosddu Farm
Llansantffraid-Ym-Mechain
Welshpool
Powys
SY22 6TH

to operate an installation at

Rhosddu Farm Poultry Unit
Rhosddu Farm
Llansantffraid-Ym-Mechain
Welshpool
Powys
SY22 6TH

to the extent authorised by and subject to the conditions of this permit.

Name	Date
	3rd November 2016

Victoria Seller

Authorised on behalf of Natural Resources Wales

Conditions

1 Management

1.1 General management

1.1.1 The operator shall manage and operate the activities:

- (a) in accordance with a written management system that identifies and minimises risks of pollution, including those arising from operations, maintenance, accidents, incidents, non-conformances, closure and those drawn to the attention of the operator as a result of complaints; and
- (b) using sufficient competent persons and resources.

1.1.2 Records demonstrating compliance with condition 1.1.1 shall be maintained.

1.1.3 Any person having duties that are or may be affected by the matters set out in this permit shall have convenient access to a copy of it kept at or near the place where those duties are carried out.

1.2 Energy efficiency

1.2.1 The operator shall:

- (a) take appropriate measures to ensure that energy is used efficiently in the activities;
- (b) review and record at least every four years whether there are suitable opportunities to improve the energy efficiency of the activities; and
- (c) take any further appropriate measures identified by a review.

1.3 Efficient use of raw materials

1.3.1 The operator shall:

- (a) take appropriate measures to ensure that raw materials and water are used efficiently in the activities;
 - (b) maintain records of raw materials and water used in the activities;
 - (c) review and record at least every four years whether there are suitable alternative materials that could reduce environmental impact or opportunities to improve the efficiency of raw material and water use;
- and
- (d) take any further appropriate measures identified by a review.

1.4 Avoidance, recovery and disposal of wastes produced by the activities

1.4.1 The operator shall take appropriate measures to ensure that:

- (a) the waste hierarchy referred to in Article 4 of the Waste Framework Directive is applied to the generation of waste by the activities; and
- (b) any waste generated by the activities is treated in accordance with the waste hierarchy referred to in Article 4 of the Waste Framework Directive; and
- (c) where disposal is necessary, this is undertaken in a manner which minimises its impact on the environment.

- 1.4.2 The operator shall review and record at least every four years whether changes to those measures should be made and take any further appropriate measures identified by a review.

2 Operations

2.1 Permitted activities

- 2.1.1 The operator is only authorised to carry out the activities specified in schedule 1 table S1.1 (the “activities”).

2.2 The site

- 2.2.1 The activities shall not extend beyond the site, being the land shown edged in green on the site plan at schedule 7 to this permit.

2.3 Operating techniques

- 2.3.1 (a) The activities shall, subject to the conditions of this permit, be operated using the techniques and in the manner described in the documentation specified in schedule 1, table S1.2, unless otherwise agreed in writing by Natural Resources Wales.
- (b) If notified by Natural Resources Wales that the activities are giving rise to pollution, the operator shall submit to Natural Resources Wales for approval within the period specified, a revision of any plan specified in schedule 1, table S1.2 or otherwise required under this permit which identifies and minimises the risks of pollution relevant to that plan, and shall implement the approved revised plan in place of the original from the date of approval, unless otherwise agreed in writing by Natural Resources Wales.
- 2.3.2 The operator shall maintain and implement a system to record the number of animal places and animal movements.
- 2.3.3 The operator shall maintain and implement a system to record the quantities of solid manure or slurry exported from the installation, as defined on the site plan in schedule 7. The record shall include as a minimum:
- the date of export from the site
 - the quantity exported
 - details of the receiving site
- 2.3.4 The operator shall ensure that where waste produced by the activities is sent to a relevant waste operation, that operation is provided with the following information, prior to the receipt of the waste:
- (a) the nature of the process producing the waste;
- (b) the composition of the waste;
- (c) the handling requirements of the waste;
- (d) the hazardous property associated with the waste, if applicable; and
- (e) the waste code of the waste.

- 2.3.5 The operator shall ensure that where waste produced by the activities is sent to a landfill site, it meets the waste acceptance criteria for that landfill.

2.4 Pre-operational conditions

- 2.5.1 The activities shall not be brought into operation until the measures specified in schedule 1 table S1.4A have been completed.

3 Emissions and monitoring

3.1 Emissions to water, air or land

- 3.1.1 There shall be no point source emissions to water, air or land except from the sources and emission points listed in schedule 3 tables S3.1 and S3.2.

3.2 Emissions of substances not controlled by emission limits

- 3.2.1 Emissions of substances not controlled by emission limits (excluding odour) shall not cause pollution. The operator shall not be taken to have breached this condition if appropriate measures, including, but not limited to, those specified in any approved emissions management plan, have been taken to prevent or where that is not practicable, to minimise, those emissions.
- 3.2.2 The operator shall:
- (a) if notified by Natural Resources Wales that the activities are giving rise to pollution, submit to Natural Resources Wales for approval within the period specified, an emissions management plan which identifies and minimises the risks of pollution from emissions of substances not controlled by emission limits;
 - (b) implement the approved emissions management plan, from the date of approval, unless otherwise agreed in writing by Natural Resources Wales.
- 3.2.3 All liquids in containers, whose emission to water or land could cause pollution, shall be provided with secondary containment, unless the operator has used other appropriate measures to prevent or where that is not practicable, to minimise, leakage and spillage from the primary container.
- 3.2.4 Periodic monitoring shall be carried out at least once every 5 years for groundwater and 10 years for soil, unless such monitoring is based on a systematic appraisal of the risk of contamination

3.3 Odour

- 3.3.1 Emissions from the activities shall be free from odour at levels likely to cause pollution outside the site, as perceived by an authorised officer of Natural Resources Wales, unless the operator has used appropriate measures, including, but not limited to, those specified in any approved odour management plan, to prevent or where that is not practicable to minimise the odour.

3.4 Noise and vibration

- 3.4.1 Emissions from the activities shall be free from noise and vibration at levels likely to cause pollution outside the site, as perceived by an authorised officer of Natural Resources Wales, unless the operator has used appropriate measures, including, but not limited to, those specified in any approved noise and vibration management plan to prevent or where that is not practicable to minimise the noise and vibration.
- 3.4.2 The operator shall:

- (a) if notified by Natural Resources Wales that the activities are giving rise to pollution outside the site due to noise and vibration, submit to Natural Resources Wales for approval within the period specified, a noise and vibration management plan which identifies and minimises the risks of pollution from noise and vibration;
- (b) implement the approved noise and vibration management plan, from the date of approval, unless otherwise agreed in writing by Natural Resources Wales.

3.5 Monitoring

- 3.5.1 The operator shall, unless otherwise agreed in writing by Natural Resources Wales, undertake the monitoring specified in the following tables in schedule 3 to this permit:
 - (a) point source emissions specified in tables S3.1 and S3.2.
- 3.5.2 The operator shall maintain records of all monitoring required by this permit including records of the taking and analysis of samples, instrument measurements (periodic and continual), calibrations, examinations, tests and surveys and any assessment or evaluation made on the basis of such data.

3.6 Pests

- 3.6.1 The activities shall not give rise to the presence of pests which are likely to cause pollution, hazard or annoyance outside the boundary of the site. The operator shall not be taken to have breached this condition if appropriate measures, including, but not limited to, those specified in any approved pests management plan, have been taken to prevent or where that is not practicable, to minimise the presence of pests on the site.
- 3.6.2 The operator shall:
 - (a) if notified by Natural Resources Wales, submit to Natural Resources Wales for approval within the period specified, a pests management plan which identifies and minimises risks of pollution, hazard and annoyance from pests;
 - (b) implement the pests management plan, from the date of approval, unless otherwise agreed in writing by Natural Resources Wales.

4 Information

4.1 Records

- 4.1.1 All records required to be made by this permit shall:
 - (a) be legible;
 - (b) be made as soon as reasonably practicable;
 - (c) if amended, be amended in such a way that the original and any subsequent amendments remain legible, or are capable of retrieval; and
 - (d) be retained, unless otherwise agreed in writing by Natural Resources Wales, for at least 6 years from the date when the records were made, or in the case of the following records until permit surrender:
 - (i) off-site environmental effects; and
 - (ii) matters which affect the condition of the land and groundwater.
- 4.1.2 The operator shall keep on site all records, plans and the management system required to be maintained by this permit, unless otherwise agreed in writing by Natural Resources Wales.

4.2 Reporting

- 4.2.1 The operator shall send all reports and notifications required by the permit to Natural Resources Wales using the contact details supplied in writing by Natural Resources Wales.
- 4.2.2 The operator shall, unless notice under this condition has been served within the preceding four years, submit to Natural Resources Wales, within six months of receipt of a written notice, a report assessing whether there are other appropriate measures that could be taken to prevent, or where that is not practicable, to minimise pollution.

4.3 Notifications

- 4.3.1 (a) In the event that the operation of the activities gives rise to an incident or accident which significantly affects or may significantly affect the environment, the operator must immediately:
- (i) inform Natural Resources Wales;
 - (ii) take the measures necessary to limit the environmental consequences of such an incident or accident; and
 - (iii) take the measures necessary to prevent further possible incidents or accidents.
- (b) In the event of a breach of any permit condition the operator must immediately:
- (i) inform Natural Resources Wales; and
 - (ii) take the measures necessary to ensure that compliance is restored within the shortest possible time.
- (c) In the event of a breach of permit condition which poses an immediate danger to human health or threatens to cause an immediate significant adverse effect on the environment, the operator must immediately suspend the operation of the activities or the relevant part of it until compliance with the permit conditions has been restored.
- 4.3.2 Any information provided under condition 4.3.1 shall be confirmed by sending the information listed in schedule 5 to this permit within the time period specified in that schedule.
- 4.3.3 Where Natural Resources Wales has requested in writing that it shall be notified when the operator is to undertake monitoring and/or spot sampling, the operator shall inform Natural Resources Wales when the relevant monitoring and/or spot sampling is to take place. The operator shall provide this information to Natural Resources Wales at least 14 days before the date the monitoring is to be undertaken.
- 4.3.4 Natural Resources Wales shall be notified within 14 days of the occurrence of the following matters, except where such disclosure is prohibited by Stock Exchange rules:

Where the operator is a registered company:

- (a) any change in the operator's trading name, registered name or registered office address; and
- (b) any steps taken with a view to the operator going into administration, entering into a company voluntary arrangement or being wound up.

Where the operator is a corporate body other than a registered company:

- (a) any change in the operator's name or address; and
- (b) any steps taken with a view to the dissolution of the operator.

In any other case:

- (a) the death of any of the named operators (where the operator consists of more than one named individual);

- (b) any change in the operator's name(s) or address(es); and
 - (c) any steps taken with a view to the operator, or any one of them, going into bankruptcy, entering into a composition or arrangement with creditors, or, in the case of them being in a partnership, dissolving the partnership.
- 4.3.5 Where the operator proposes to make a change in the nature or functioning, or an extension of the activities, which may have consequences for the environment and the change is not otherwise the subject of an application for approval under the Regulations or this permit:
 - (a) Natural Resources Wales shall be notified at least 14 days before making the change; and
 - (b) the notification shall contain a description of the proposed change in operation.
- 4.3.6 Natural Resources Wales shall be given at least 14 days notice before implementation of any part of the site closure plan.

4.4 Interpretation

- 4.4.1 In this permit the expressions listed in schedule 6 shall have the meaning given in that schedule.
- 4.4.2 In this permit references to reports and notifications mean written reports and notifications, except where reference is made to notification being made "without delay", in which case it may be provided by telephone

Schedule 1 - Operations

Table S1.1 activities		
Activity listed in Schedule 1 of the EP Regulations	Description of specified activity	Limits of specified activity
Section 6.9 A(1)(a)(i) Rearing of poultry intensively in an installation with more than 40,000 places	The rearing of poultry in a facility with a capacity for 56,000 places.	From receipt of birds, raw materials and fuels onto the site to removal of birds and associated wastes from site
Directly Associated Activity		
Biomass Boiler	Operation of a Biomass Boiler with a thermal rated input not exceeding 211kW, for site heating requirements, burning biomass fuel not comprising waste or animal carcasses.	From receipt of raw materials and fuels, to release of combustion products to air and associated wastes removed from site.
Combined Heat and Power Units (CHP)	The operation of two CHP Units with an aggregated thermal rated input not exceeding 360Kw.	From receipt of raw materials and fuels, to release of combustion products to air and associated wastes removed from site.

Table S1.2 Operating techniques		
Description	Parts	Date Received
Application EPR/NP3431VM/A001	Responses to section 3 of Form Part B3 of the application form and referenced supporting documentation. Best available techniques as described in BAT conclusions under Directive 2010/75/EU of the European Parliament and of the Council on industrial emissions for Intensive Farming installations.	20/10/14
Additional information requested EPR/NP3431VM/A001	Response to Request for Information confirming assessment of the risk of odours from normal operation and description of how the design of the existing poultry houses (houses 1 and 2) meet BAT.	12/12/14
Response to Schedule 5 Notice dated 05/02/15	Response to question detailing odour modelling assessment. Technical Standards detailed in Section 1.1 of the report 'An Odour Dispersion Modelling Study of the Impact of the Proposed Expansion to the Free Range Egg Laying Units at Rhosddu Farm, Llansantffraid-ym-mechain in Powys' provided under Regulation 60 of Environmental Permitting Regulations.	07/03/15
Additional information requested 27/03/15	Response to Request for Information confirming that litter and manure removed from houses 2 and 3 using manure belts will be taken off site immediately following completion of removal from the houses.	27/03/15

Table S1.4A Pre-operational measures	
Reference	Pre-operational measures -
1	At least 14 days before the use of the new poultry unit the operator shall inform Natural Resources Wales that the installation of high velocity roof fans with vertical discharge stacks on poultry houses 1 and 2 (sheds 1 and 2 as shown on the Site Plan in Schedule 7) is complete.

Schedule 2 – Waste types, raw materials and fuels

Table S2.1 Raw materials and fuels	
Raw materials and fuel description	Specification
Virgin timber (including wood chips and pellets), miscanthus or straw	Not to include any waste material

Schedule 3 – Emissions and monitoring

Table S3.1 Point source emissions to air – emission limits and monitoring requirements						
Emission point ref. & location	Parameter	Source	Limit (incl. unit)	Reference period	Monitoring frequency	Monitoring standard or method
A1 (high velocity) roof fan outlets the three poultry houses shown on the site plan as shown on the site plan in schedule 7	---	Poultry house 1, 2 and 3	---	---	---	---
Exhaust from generator as shown on the site plan in schedule 7	---	Generator	---	---	---	---
Air vent from diesel storage tank as shown on the site layout plan in schedule 7	---	Storage tank	---	---	---	---
Exhaust chimney from one Biomass Boiler located at 320455,317147	---	Biomass Boiler	---	---	---	---
Exhaust from CHP Units (2 Units with One exhaust) located at 320454,317142	---	2 CHP Units	---	---	---	---

Table S3.2 Point Source emissions to water (other than sewer) – emission limits and monitoring requirements						
Emission point ref. & location	Parameter	Source	Limit (incl. unit)	Reference Period	Monitoring frequency	Monitoring standard or method
At least 14 days before the use of the new poultry unit the operator shall inform Natural Resources Wales that the installation of high velocity roof fans with vertical discharge stacks on poultry houses 1 and 2 (sheds 1 and 2 as shown on the Site Plan in Schedule 7) is complete.	None set	Rainwater draining from the roofs of the three poultry houses and yard area	None set	---	---	---

Schedule 4 – Reporting

There is no reporting under this schedule.

Schedule 5 - Notification

These pages outline the information that the operator must provide.

Units of measurement used in information supplied under Part A and B requirements shall be appropriate to the circumstances of the emission. Where appropriate, a comparison should be made of actual emissions and authorised emission limits.

If any information is considered commercially confidential, it should be separated from non-confidential information, supplied on a separate sheet and accompanied by an application for commercial confidentiality under the provisions of the EP Regulations.

Part A

Permit Number	
Name of operator	
Location of Facility	
Time and date of the detection	

(a) Notification requirements for any malfunction, breakdown or failure of equipment or techniques, accident, or emission of a substance not controlled by an emission limit which has caused, is causing or may cause significant pollution	
To be notified within 24 hours of detection	
Date and time of the event	
Reference or description of the location of the event	
Description of where any release into the environment took place	
Substances(s) potentially released	
Best estimate of the quantity or rate of release of substances	
Measures taken, or intended to be taken, to stop any emission	
Description of the failure or accident.	

(b) Notification requirements for the breach of a limit	
To be notified within 24 hours of detection unless otherwise specified below	
Emission point reference/ source	
Parameter(s)	
Limit	
Measured value and uncertainty	
Date and time of monitoring	
Measures taken, or intended to be taken, to stop the emission	

Time periods for notification following detection of a breach of a limit	
Parameter	Notification period

(c) Notification requirements for the detection of any significant adverse environmental effect	
To be notified within 24 hours of detection	
Description of where the effect on the environment was detected	
Substances(s) detected	
Concentrations of substances detected	
Date of monitoring/sampling	

Part B - to be submitted as soon as practicable

Any more accurate information on the matters for notification under Part A.	
Measures taken, or intended to be taken, to prevent a recurrence of the incident	
Measures taken, or intended to be taken, to rectify, limit or prevent any pollution of the environment which has been or may be caused by the emission	
The dates of any unauthorised emissions from the facility in the preceding 24 months.	

Name*	
Post	
Signature	
Date	

* authorised to sign on behalf of the operator

Schedule 6 - Interpretation

“Accident” means an accident that may result in pollution.

“Application” means the application for this permit, together with any additional information supplied by the operator as part of the application and any response to a notice served under Schedule 5 to the EP Regulations.

“Authorised officer” means any person authorised by Natural Resources Wales under section 108(1) of The Environment Act 1995 to exercise, in accordance with the terms of any such authorisation, any power specified in section 108(4) of that Act.

“Building” means a construction that has the objective of providing sheltering cover and minimising emissions of noise, particulate matter, odour and litter.

“Emissions to land” includes emissions to groundwater.

“Emissions of substances not controlled by emission limits” means emissions of substances to air, water or land from the activities, *either from the emission points specified in schedule 3 or from other localised or diffuse sources, which are not controlled by an emission limit..*

“EP Regulations” means The Environmental Permitting (England and Wales) Regulations SI 2010 No.675 and words and expressions used in this permit which are also used in the Regulations have the same meanings as in those Regulations.

“Groundwater” means all water, which is below the surface of the ground in the saturation zone and in direct contact with the ground or subsoil.

“Industrial Emissions Directive” means DIRECTIVE 2010/75/EU OF THE EUROPEAN PARLIAMENT AND OF THE COUNCIL of 24 November 2010 on industrial emissions

“Manure and slurry” have the following meaning:

- Manures may be either slurries or solid manures.
- Slurries consist of excreta produced by livestock whilst in a yard or building mixed with rainwater and wash water and, in some cases, waste bedding and feed. Slurries can be pumped or discharged by gravity.
- Slurry includes duck effluent, seepage from manure and wash water.
- Solid manures include farmyard manure (FYM) and comprise material from straw-based housing systems, excreta with lots of straw/sawdust/woodchips in it, or solids from mechanical separators.
- Most poultry systems produce solid manure (litter).
- Solid manure can generally be stacked.

“Manure management plan” means the requirements described in Section 2.3 of SGN 6.09 How to Comply – Intensive Farming.

“Pests” means Birds, Vermin and Insects.

“SGN How to comply – Intensive Farming” The EPR Sector Guidance Note 6.09 for intensive pig and poultry farmers, version 2 published January 2010.

“Year” means calendar year ending 31 December.

Schedule 7 - Site plan

Installation boundary plan

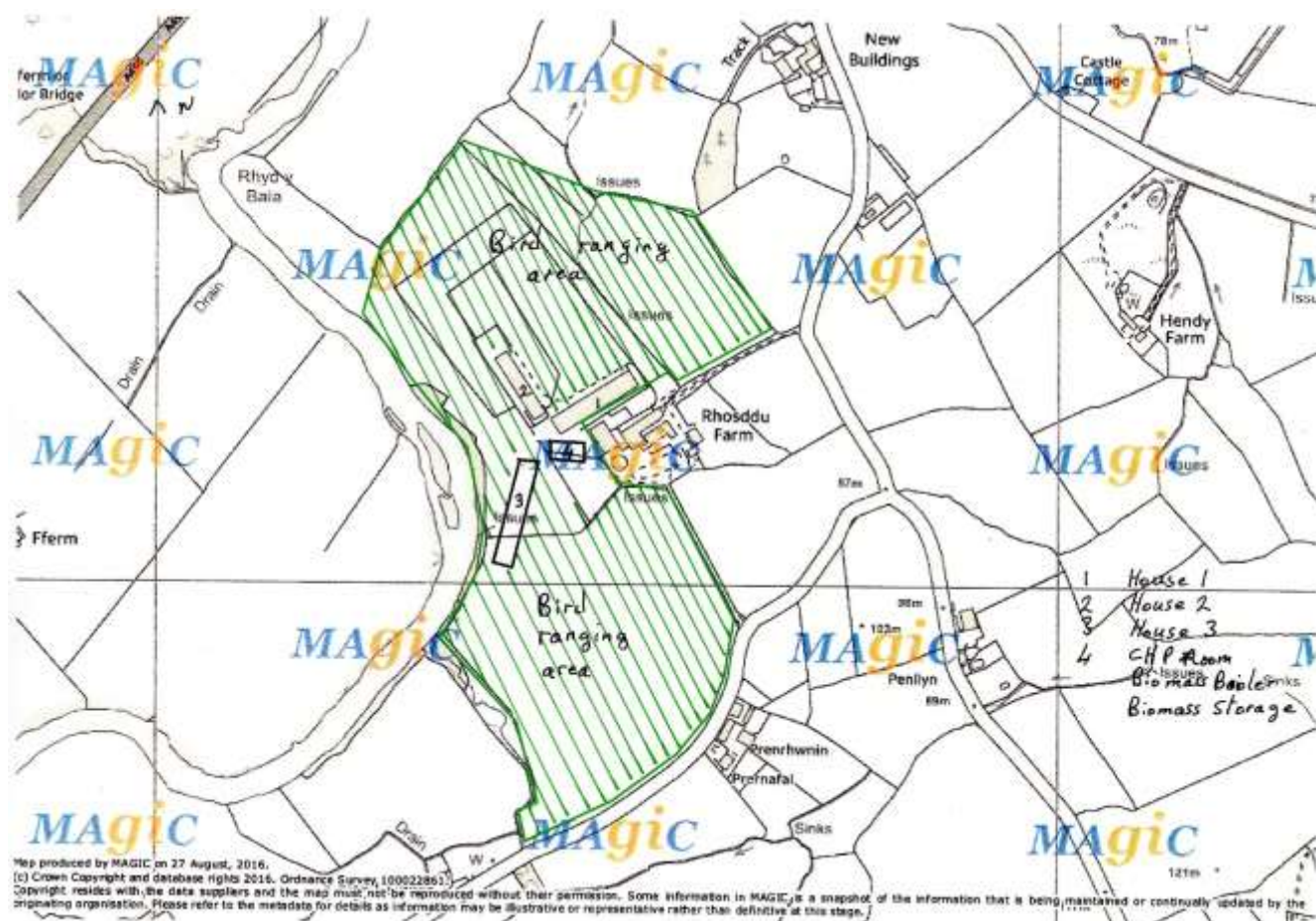

©Crown Copyright. All rights reserved. Natural Resources Wales, 100030994, 2016.

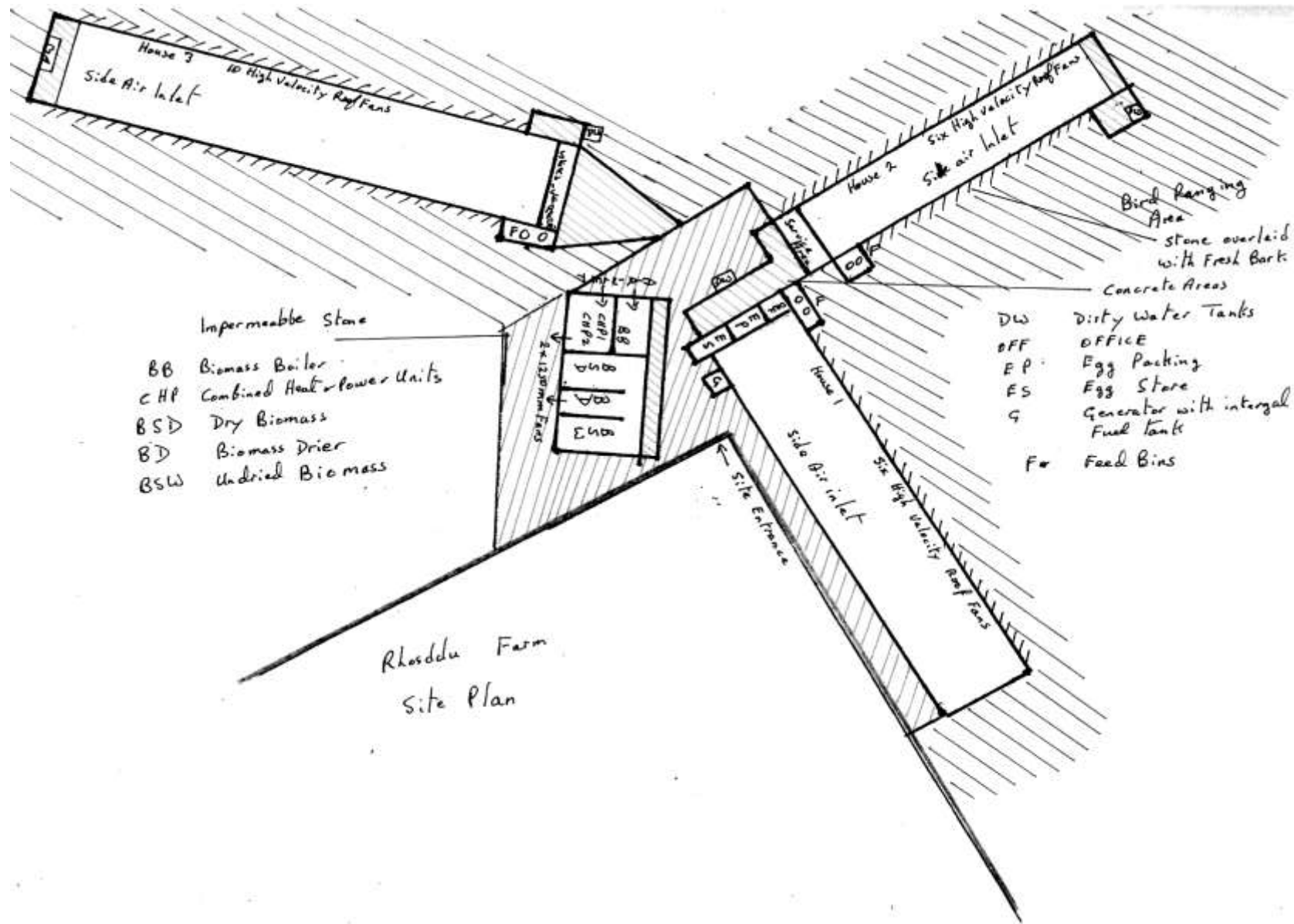

END OF PERMIT

Permit Number EPR/AB3095HL