

## Permit with introductory note

The Environmental Permitting (England & Wales) Regulations 2016

---

**Biffa Waste Services Limited**

**Cardiff Waste Management Resource  
Centre**

**Waterside Business Park**

**Lamby Way**

**Rumney**

**Cardiff**

**CF3 2EQ**

Permit number

**EPR/CB3394CM**

# **Cardiff Waste Management Resource Centre**

## **Permit number EPR/CB3394CM**

### **Introductory note**

#### **This introductory note does not form a part of the permit**

The main features of the permit are as follows.

The installation is a waste transfer station for hazardous waste and a non-hazardous waste operations with a site maximum throughput for the entire site of 7500 tonnes per year located at Waterside Business Park, Lamby way, Rumney Cardiff centred at national grid reference ST 22019 78619 and operated by Biffa waste services limited.

The site will comprise of external and internal activities. External activity will comprise only of loading/unloading and the storage of redundant gas containers. The entire site will be covered by impermeable concrete or tarmac surfacing. Loading and unloading takes place within a designated area that has a sealed drainage with a 9m<sup>3</sup> tank and can be isolated from the rest of the surface water drainage.

Internal activities are waste treatment, storage, shredding and crushing. These take place in designated bays within the buildings. Each of the bays will be situated upon impermeable concrete and each bay will have its own sealed drainage systems which drains the collected liquids to a storage tank. The collected liquid in the storage tanks will be emptied and tankered for disposal off site.

There are no channelled emissions to air. Discharge to surface water sewer will only consist of uncontaminated surface runoff and limited to 5 l/s. The discharge to surface water sewer goes through multiple oil interceptors and the source is only from external areas on site where no waste treatment or storage is to take place. The site will also have a 420m<sup>3</sup> site drainage storage tank installed along the western boundary of the proposed site, comprised of double skinned construction and will be fitted with both high level and leak detection alarms. The tank will provide redundancy to the surface water management system during a storm event and is designed with a capacity for a 1 in 100 year storm (+30% for climate change) and will provide storage for up to a 720-minute storm, and a single connection to the surface water system, allowing inflow or outflow according to balancing requirements.

The Cardiff Waste Management Resource Centre is to replace the existing Cardiff waste transfer station located at Curran Embankment permitted as EPR/SP3031SJ.

The status log of the permit sets out the permitting history, including any changes to the permit reference number.

<b>Status log of the permit</b>		
<b>Description</b>	<b>Date</b>	<b>Comments</b>
Application PAN-010745 (EPR/CB3394CM/A001)	18/06/2020	Application for a new bespoke permit for a waste transfer station.
Additional information received	Duly Made 27/11/2020	Additional information requested application duly made
Schedule 5 Notice requiring further information	08/01/2021	Requiring Fire prevention mitigation plan, Best Available Techniques assessment and Noise impact Assessment
Additional information received	09/04/2021	Response to schedule 5 for updated Fire prevention mitigation plan, BAT assessment and noise impact assessment
Schedule 5 Notice requiring further information	02/06/2021	Requiring odour management plan
Additional information received	16/07/2021	Response to schedule 5 for Odour management plan received
Additional information received	28/09/2021	Revised site Drainage layout and supporting statement
Additional information received	19/11/2021	Revised Fire prevention mitigation plan with freeboard amended to 1 meter.
Permit determined EPR/CB3394CM	29/12/2021	Permit issued to Biffa Waste Services Limited

End of introductory note

# Permit

The Environmental Permitting (England and Wales) Regulations 2016

Permit number  
**EPR/CB3394CM**

The Natural Resources Body for Wales (“Natural Resources Wales”) authorises,  
under regulation 13 of the Environmental Permitting (England and Wales)  
Regulations 2016

**Biffa Waste Services Limited** (“the operator”),

whose registered office is

**Coronation Road  
Cressex  
High Wycombe  
Buckinghamshire  
HP12 3TZ**

company registration number 00946107

to operate an installation at

**Cardiff Waste Management Resource Centre  
Waterside Business Park  
Lamby Way  
Rumney  
Cardiff  
CF3 2EQ**

to the extent authorised by and subject to the conditions of this permit.

Signed

Date

<b>Paul Williams</b>	<b>29/12/2021</b>
----------------------	-------------------

Authorised on behalf of Natural Resources Wales

# Conditions

## 1 Management

### 1.1 General management

- 1.1.1 The operator shall manage and operate the activities:
- (a) in accordance with a written management system that identifies and minimises risks of pollution, including those arising from operations, maintenance, accidents, incidents, non-conformances, closure and those drawn to the attention of the operator as a result of complaints; and
  - (b) using sufficient competent persons and resources.
- 1.1.2 Records demonstrating compliance with condition 1.1.1 shall be maintained.
- 1.1.3 Any person having duties that are or may be affected by the matters set out in this permit shall have convenient access to a copy of it kept at or near the place where those duties are carried out.
- 1.1.4 The operator shall comply with the requirements of an approved competence scheme.

### 1.2 Energy efficiency

- 1.2.1 For the following activities referenced in schedule 1, table S1.1 (A1 to A6) the operator shall:
- (a) take appropriate measures to ensure that energy is used efficiently in the activities;
  - (b) review and record at least every four years whether there are suitable opportunities to improve the energy efficiency of the activities; and
  - (c) take any further appropriate measures identified by a review.

### 1.3 Efficient use of raw materials

- 1.3.1 The operator shall:
- (a) take appropriate measures to ensure that raw materials and water are used efficiently in the activities;
  - (b) maintain records of raw materials and water used in the activities;
  - (c) review and record at least every four years whether there are suitable alternative materials that could reduce environmental impact or opportunities to improve the efficiency of raw material and water use; and
  - (d) take any further appropriate measures identified by a review.

### 1.4 Avoidance, recovery and disposal of wastes produced by the activities

- 1.4.1 The operator shall take appropriate measures to ensure that:
- (a) the waste hierarchy referred to in Article 4 of the Waste Framework Directive is applied to the generation of waste by the activities; and

- (b) any waste generated by the activities is treated in accordance with the waste hierarchy referred to in Article 4 of the Waste Framework Directive; and
  - (c) where disposal is necessary, this is undertaken in a manner which minimises its impact on the environment.
- 1.4.2 The operator shall review and record at least every four years whether changes to those measures should be made and take any further appropriate measures identified by a review.

## **2 Operations**

### **2.1 Permitted activities**

- 2.1.1 The operator is only authorised to carry out the activities specified in schedule 1 table S1.1 (the “activities”).
- 2.1.2 Waste authorised by this permit shall be clearly distinguished from any other waste on the site.

### **2.2 The site**

- 2.2.1 The activities shall not extend beyond the site, being the land shown edged in green on the site plan at schedule 7 to this permit.

### **2.3 Operating techniques**

- 2.3.1
  - (a) The activities shall, subject to the conditions of this permit, be operated using the techniques and in the manner described in the documentation specified in schedule 1, table S1.2, unless otherwise agreed in writing by Natural Resources Wales.
  - (b) If notified by Natural Resources Wales that the activities are giving rise to pollution, the operator shall submit to Natural Resources Wales for approval within the period specified, a revision of any plan or other documentation (“plan”) specified in schedule 1, table S1.2 or otherwise required under this permit which identifies and minimises the risks of pollution relevant to that plan, and shall implement the approved revised plan in place of the original from the date of approval, unless otherwise agreed in writing by Natural Resources Wales.
- 2.3.2 Waste shall only be accepted if:
  - (a) it is of a type and quantity listed in schedule 2 tables S2.2, S2.3, S2.4; and
  - (b) it conforms to the description in the documentation supplied by the producer and holder.
- 2.3.3 The operator shall ensure that where waste produced by the activities is sent to a relevant waste operation, that operation is provided with the following information, prior to the receipt of the waste:
  - (a) the nature of the process producing the waste;
  - (b) the composition of the waste;
  - (c) the handling requirements of the waste;

- (d) the hazardous property associated with the waste, if applicable; and
- (e) the waste code of the waste.

2.3.4 The operator shall ensure that where waste produced by the activities is sent to a landfill site, it meets the waste acceptance criteria for that landfill.

2.3.5 Hazardous waste shall not be mixed, either with a different category of hazardous waste or with other waste, substances or materials, unless it is authorised by schedule 1 table S1.1 and appropriate measures are taken.

## **2.4 Improvement programme**

2.4.1 The operator shall complete the improvements specified in schedule 1 table S1.3 by the date specified in that table unless otherwise agreed in writing by Natural Resources Wales.

2.4.2 Except in the case of an improvement which consists only of a submission to Natural Resources Wales, the operator shall notify Natural Resources Wales within 14 days of completion of each improvement.

## **2.5 Pre-operational conditions**

2.5.1 The activities shall not be brought into operation until the measures specified in schedule 1 table S1.4A have been completed.

# **3 Emissions and monitoring**

## **3.1 Emissions to water, air or land**

3.1.1 There shall be no point source emissions to water, air or land except from the sources and emission points listed in schedule 3.

3.1.2 The limits given in schedule 3 shall not be exceeded.

3.1.3 Periodic monitoring shall be carried out at least once every 5 years for groundwater and 10 years for soil, unless such monitoring is based on a systematic appraisal of the risk of contamination.

## **3.2 Emissions of substances not controlled by emission limits**

3.2.1 Emissions of substances not controlled by emission limits (excluding odour) shall not cause pollution. The operator shall not be taken to have breached this condition if appropriate measures, including, but not limited to, those specified in any approved emissions management plan, have been taken to prevent or where that is not practicable, to minimise, those emissions.

3.2.2 The operator shall:

- (a) if notified by Natural Resources Wales that the activities are giving rise to pollution, submit to Natural Resources Wales for approval within the period specified, an emissions management plan which identifies and minimises the risks of pollution from emissions of substances not controlled by emission limits;

- (b) implement the approved emissions management plan, from the date of approval, unless otherwise agreed in writing by Natural Resources Wales.

3.2.3 All liquids in containers, whose emission to water or land could cause pollution, shall be provided with secondary containment, unless the operator has used other appropriate measures to prevent or where that is not practicable, to minimise, leakage and spillage from the primary container.

### **3.3 Odour**

3.3.1 Emissions from the activities shall be free from odour at levels likely to cause pollution outside the site, as perceived by an authorised officer of Natural Resources Wales, unless the operator has used appropriate measures, including, but not limited to, those specified in any approved odour management plan, to prevent or where that is not practicable to minimise the odour.

### **3.4 Noise and vibration**

3.4.1 Emissions from the activities shall be free from noise and vibration at levels likely to cause pollution outside the site, as perceived by an authorised officer of Natural Resources Wales, unless the operator has used appropriate measures, including, but not limited to, those specified in any approved noise and vibration management plan to prevent or where that is not practicable to minimise the noise and vibration.

3.4.2 The operator shall:

- (a) if notified by Natural Resources Wales that the activities are giving rise to pollution outside the site due to noise and vibration, submit to Natural Resources Wales for approval within the period specified, a noise and vibration management plan which identifies and minimises the risks of pollution from noise and vibration;
- (b) implement the approved noise and vibration management plan, from the date of approval, unless otherwise agreed in writing by Natural Resources Wales.

### **3.5 Monitoring**

3.5.1 The operator shall, unless otherwise agreed in writing by Natural Resources Wales, undertake the monitoring specified in the following tables in schedule 3 to this permit:

- (a) point source emissions specified in table S3.1

3.5.2 The operator shall maintain records of all monitoring required by this permit including records of the taking and analysis of samples, instrument measurements (periodic and continual), calibrations, examinations, tests and surveys and any assessment or evaluation made on the basis of such data.



## **3.6 Pests**

- 3.6.1 The activities shall not give rise to the presence of pests which are likely to cause pollution, hazard or annoyance outside the boundary of the site. The operator shall not be taken to have breached this condition if appropriate measures, including, but not limited to, those specified in any approved pests management plan, have been taken to prevent or where that is not practicable, to minimise the presence of pests on the site.
- 3.6.2 The operator shall:
- (a) if notified by Natural Resources Wales, submit to Natural Resources Wales for approval within the period specified, a pests management plan which identifies and minimises risks of pollution, hazard or annoyance from pests;
  - (b) implement the pests management plan, from the date of approval, unless otherwise agreed in writing by Natural resources Wales

## **3.7 Fire**

- 3.7.1 The operator shall manage and operate the activities in accordance with a written fire prevention plan using the current, relevant fire prevention plan guidance.
- 3.7.2 The operator shall:
- (a) if notified by Natural Resources Wales that the activities could cause a fire risk, submit to Natural Resources Wales a fire prevention plan which identifies and minimises the risks of fire;
  - (b) operate the activity in accordance with the fire prevention plan, from the date of submission, unless otherwise agreed in writing by Natural Resources Wales.

# **4 Information**

## **4.1 Records**

- 4.1.1 All records required to be made by this permit shall:
- (a) be legible;
  - (b) be made as soon as reasonably practicable;
  - (c) if amended, be amended in such a way that the original and any subsequent amendments remain legible, or are capable of retrieval; and
  - (d) be retained, unless otherwise agreed in writing by Natural Resources Wales, for at least 6 years from the date when the records were made, or in the case of the following records until permit surrender:
    - (i) off-site environmental effects; and
    - (ii) matters which affect the condition of the land and groundwater.
- 4.1.2 The operator shall keep on site all records, plans and the management system required to be maintained by this permit, unless otherwise agreed in writing by Natural Resources Wales.

## 4.2 Reporting

- 4.2.1 The operator shall send all reports and notifications required by the permit to Natural Resources Wales using the contact details supplied in writing by Natural Resources Wales.
- 4.2.2 For the following activities referenced in schedule 1, table S1.1 (A1 to A7). A report or reports on the performance of the activities over the previous year shall be submitted to Natural Resources Wales by 31 January (or other date agreed in writing by Natural Resources Wales) each year. The report(s) shall include as a minimum:
- (a) a review of the results of the monitoring and assessment carried out in accordance with the permit including an interpretive review of that data;
  - (b) the annual production / treatment data set out in schedule 4 table S4.2; and
  - (c) the performance parameters set out in schedule 4 table S4.3 using the forms specified in table S4.4 of that schedule.
- 4.2.3 Within 28 days of the end of the reporting period the operator shall, unless otherwise agreed in writing by Natural Resources Wales, submit reports of the monitoring and assessment carried out in accordance with the conditions of this permit, as follows:
- (a) in respect of the parameters and emission points specified in schedule 4 table S4.1;
  - (b) for the reporting periods specified in schedule 4 table S4.1 and using the forms specified in schedule 4 table S4.4; and
  - (c) giving the information from such results and assessments as may be required by the forms specified in those tables.
- 4.2.4 The operator shall, unless notice under this condition has been served within the preceding four years, submit to Natural Resources Wales, within six months of receipt of a written notice, a report assessing whether there are other appropriate measures that could be taken to prevent, or where that is not practicable, to minimise pollution.
- 4.2.5 Within 1 month of the end of each quarter, the operator shall submit to Natural Resources Wales using the form made available for the purpose, the information specified on the form relating to the site and the waste accepted and removed from it during the previous quarter.

## 4.3 Notifications

- 4.3.1 (a) In the event that the operation of the activities gives rise to an incident or accident which significantly affects or may significantly affect the environment, the operator must immediately—
- (i) inform Natural Resources Wales,
  - (ii) take the measures necessary to limit the environmental consequences of such an incident or accident, and
  - (iii) take the measures necessary to prevent further possible incidents or accidents;
- (b) in the event of a breach of any permit condition the operator must immediately—
- (i) inform Natural Resources Wales, and

- (ii) take the measures necessary to ensure that compliance is restored within the shortest possible time;
  - (c) in the event of a breach of permit condition which poses an immediate danger to human health or threatens to cause an immediate significant adverse effect on the environment, the operator must immediately suspend the operation of the activities or the relevant part of it until compliance with the permit conditions has been restored.
- 4.3.2 Any information provided under condition 4.3.1 (a)(i), or 4.3.1 (b)(i) where the information relates to the breach of a limit specified in the permit, shall be confirmed by sending the information listed in schedule 5 to this permit within the time period specified in that schedule.
- 4.3.3 Where Natural Resources Wales has requested in writing that it shall be notified when the operator is to undertake monitoring and/or spot sampling, the operator shall inform Natural Resources Wales when the relevant monitoring and/or spot sampling is to take place. The operator shall provide this information to Natural Resources Wales at least 14 days before the date the monitoring is to be undertaken.
- 4.3.4 Natural Resources Wales shall be notified within 14 days of the occurrence of the following matters, except where such disclosure is prohibited by Stock Exchange rules:

Where the operator is a registered company:

- (a) any change in the operator's trading name, registered name or registered office address; and
- (b) any steps taken with a view to the operator going into administration, entering into a company voluntary arrangement or being wound up.

Where the operator is a corporate body other than a registered company:

- (a) any change in the operator's name or address; and
- (b) any steps taken with a view to the dissolution of the operator.

In any other case:

- (a) the death of any of the named operators (where the operator consists of more than one named individual);
  - (b) any change in the operator's name(s) or address(es); and
  - (c) any steps taken with a view to the operator, or any one of them, going into bankruptcy, entering into a composition or arrangement with creditors, or, in the case of them being in a partnership, dissolving the partnership.
- 4.3.5 Where the operator proposes to make a change in the nature or functioning, or an extension of the activities, which may have consequences for the environment and the change is not otherwise the subject of an application for approval under the Regulations or this permit:
  - (a) Natural Resources Wales shall be notified at least 14 days before making the change; and
  - (b) the notification shall contain a description of the proposed change in operation.
- 4.3.6 Natural Resources Wales shall be given at least 14 days notice before implementation of any part of the site closure plan.

## **4.4 Interpretation**

- 4.4.1 In this permit the expressions listed in schedule 6 shall have the meaning given in that schedule.
- 4.4.2 In this permit references to reports and notifications mean written reports and notifications, except where reference is made to notification being made “immediately”, in which case it may be provided by telephone.

# Schedule 1 - Operations

Table S1.1 activities			
Activity reference	Activity listed in Schedule 1 of the EP Regulations	Description of specified activity and WFD Annex I and II operations	Limits of specified activity and waste types
A1	S5.3 Part A(1)(a)(iii)	Disposal or recovery of hazardous waste with a capacity exceeding 10 tonnes per day involving mixing, blending and bulking of hazardous waste	Up to 7500 tonnes per year. Only waste types specified in tables S2.2 and S2.3
A2	S5.3 Part A(1)(a)(iv)	Re-Packaging of hazardous wastes and Re-Packaging of Laboratory Smalls (Transfer Station)	Up to 7500 tonnes per year. Only waste types specified in tables S2.2 and S2.3
A3	S5.6 Part A(1)(a)	Temporary Storage of Hazardous Waste and Waste Oil	Only waste types specified in table S2.2 and S2.3
Directly Associated Activity			
A4	Treatment and storage of packaging waste	Treatment (Washing, Crushing and shredding) and storage of packaging waste associated with hazardous waste transfer/ bulking operations only	
A5	Discharge of surface water	Discharge of surface water from external operational areas to surface water sewer	
A6	Fuel and oil storage	Storage of fuel and oils to support the operation of plant and equipment	

**Table S1.1 activities**

Activity reference	Description of activities for waste operations	Limits of activities
A7	<p><b>R3:</b> Recycling/reclamation of organic substances which are not used as solvents</p> <p><b>R4:</b> Recycling/reclamation of metals and metal compounds</p> <p><b>R5:</b> Recycling/reclamation of other inorganic compounds</p> <p><b>R13:</b> Storage of waste pending any of the operations numbered R1 to R12 (excluding temporary storage, pending collection, on the site where it is produced)</p> <p><b>D9:</b> Physico-chemical treatment not specified elsewhere in this Annex which results in final compounds or mixtures which are discarded by means of any of the operations numbered D1 to D12 (e.g. evaporation, drying, calcination, etc.)</p> <p><b>D14:</b> Repackaging prior to submission to any of operations numbered D1 to D13</p> <p><b>D15:</b> Storage pending any of the operations numbered D1 to D14 (excluding temporary storage, pending collection, on the site where the waste is produced)</p>	<p>Operations shall be limited to:</p> <ol style="list-style-type: none"> <li>1. Up to 7500 tonnes per year</li> <li>2. Waste types as specified in Table S2.4</li> <li>3. Treatment activities limited to blending, mixing, shredding and repackaging of non-hazardous waste for onward transfer.</li> </ol>

**Table S1.2 Operating techniques**

Description	Parts	Date Received
Application	All information submitted as part of application Safety operating procedures, SOP 1 to SOP 15 Best available techniques as described in BAT conclusions under Directive 2010/75/EU of the European Parliament and of the Council Waste Treatment	18/06/2020
Response to request for more information	All additional information in response to request for more information	27/11/2020
Response to Schedule 5 Notice dated 08/01/2021	<ul style="list-style-type: none"> <li>• Revised supporting statement including additional Best available techniques as described in BAT conclusions under Directive 2010/75/EU of the European Parliament and of the Council Waste Treatment</li> <li>• Safety operating procedures reference SOP 12 (revised), SOP Operation of crusher and SOP Operation of shredder</li> <li>• Fire risk assessment</li> </ul>	09/04/2021
Response to Schedule 5 Notice dated 02/06/2021	Odour management plan BF5023/OMP.R0	16/07/2021

**Table S1.2 Operating techniques**

<b>Description</b>	<b>Parts</b>	<b>Date Received</b>
Revision to drainage layout	Supporting statement (4 <sup>th</sup> Revision) BF5023/05/R4 Indicative Drainage layout (3 <sup>rd</sup> revision) BF5023/09/04 Rev 3	28/09/2021
Response to query on freeboard	Revised Fire prevention and mitigation plan BF5023/07 Rev 2	19/11/2021

**Table S1.3 Improvement programme requirements**

<b>Reference</b>	<b>Requirement</b>	<b>Date</b>
IC 1	<p>Following successful commissioning and establishment of routine steady operation, the Operator shall undertake noise monitoring at the nearest local receptors. This shall include:</p> <ul style="list-style-type: none"> <li>•A full noise monitoring survey and assessment meeting the BS4142:2014 standard.</li> <li>•1/3rd octave and narrow band (FFT) measurements to identify any tonal elements or low frequency noise.</li> <li>•Reference to the Welsh Government Noise and soundscape action plan 2018-2023.</li> </ul> <p>Upon completion of the work, a written report shall be submitted to Natural Resources Wales for approval.</p> <p>The report shall make reference to the predictions in the report produced in accordance with the Noise impact assessment. If rating levels likely to cause complaints at sensitive receptors are detected, the report shall include an assessment of the most suitable abatement techniques, an estimate of the cost and a proposed timetable for their installation. The Operator must implement the plan as approved, including any required improvements, and from the date stipulated by Natural Resources Wales.</p>	Within 6 months of the start of operation

Table S1.4A Pre-operational measures	
Reference	Pre-operational measures
PO1	<p>At least four months before (or other date agreed in writing with Natural Resources Wales) the site is brought online, the Operator shall submit to Natural Resources Wales, and obtain Natural Resources Wales' written approval to it, a revised Fire Prevention and Mitigation Plan (FPMP) for the installation. The report shall follow the FPMP requirements in the most recent guidance available on the Natural Resource Wales website (<a href="https://naturalresources.wales/permits-and-permissions/environmental-permits/guidance-to-help-you-comply-with-your-environmental-permit/?lang=en">https://naturalresources.wales/permits-and-permissions/environmental-permits/guidance-to-help-you-comply-with-your-environmental-permit/?lang=en</a>) or demonstrate equivalence to this, and shall address all outstanding information issues identified by the Operator or Natural Resources Wales. These outstanding issues to be include, but is not limited to the following:</p> <ul style="list-style-type: none"> <li>• Final location of Drum Crusher, Shredder and other plant equipment.</li> <li>• Emergency plan for site to be reviewed and revised as appropriate.</li> <li>• Any update(s) to the firefighting strategy out of operational hours.</li> <li>• Details on specification of the CCTV systems put in place for detection. (such as CCTV visual flame detection systems, spark, infrared and ultraviolet detection</li> </ul> <p>The revised FPMP submitted shall be single, standalone document detailing all FPMP requirements.</p> <p>Waste shall not be brought onto site until the plan is approved in writing by Natural Resources Wales.</p>



## Schedule 2 - Waste types, raw materials and fuels

**Table S2.1 Raw materials and fuels**

Raw materials and fuel description	Specification
Table not in use	-

**Table S2.2 Permitted waste types and quantities for Storage of Waste Oil**

Maximum quantity	Table S2.2, S2.3 and S2.4 combined total of 7500 tonnes per year
Waste code	Description
<b>05</b>	<b>WASTE FROM PETROLEUM REFINING, NATURAL GAS PURIFICATION AND PYROLYTIC TREATMENT OF COAL</b>
<b>05 01</b>	<b>Waste From Petroleum Refining</b>
05 01 05*	Oil Spills
05 01 06*	Oily sludges from maintenance operations of plant or equipment
05 01 12*	Oil Containing acids
<b>08</b>	<b>WASTES FROM THE MANUFACTURE, FORMULATION, SUPPLY AND USE (MFSU) OF COATINGS (PAINTS, VARNISHES AND VITREOUS ENAMELS), ADHESIVES, SEALANT AND PRINTING INK</b>
<b>08 03</b>	<b>Wastes from MFSU of Printing Inks</b>
08 03 19*	Disperse oil
<b>12</b>	<b>WASTE FROM SHAPING AND PHYSICAL AND MECHANICAL SURFACE TREATMENT OF METALS AND PLASTICS</b>
<b>12 01</b>	<b>Wastes from Shaping and Physical and Mechanical Surface Treatment of Metals and Plastics</b>
12 01 10*	Synthetic machining oils
12 01 18*	Metal sludge (grinding, honing and lapping sludge) containing oil
12 01 19*	Readily biodegradable machining oil
<b>13</b>	<b>OIL WASTE AND WASTES OF LIQUID FUELS (except edible oils and those found in chapters 05,12 and 19)</b>
<b>13 01</b>	<b>Waste Hydraulic oils</b>
13 01 01*	hydraulic oils, containing PCBs
13 01 04*	chlorinated emulsions
13 01 05*	non-chlorinated emulsions
13 01 09*	mineral-based chlorinated hydraulic oils
13 01 10*	mineral based non-chlorinated hydraulic oils
13 01 11*	synthetic hydraulic oils
13 01 12*	readily biodegradable hydraulic oils
13 01 13*	other hydraulic oils
<b>13 02</b>	<b>Waste Engine, Gear and Lubricating Oils</b>
13 02 04*	mineral-based chlorinated engine, gear and lubricating oils
13 02 05*	mineral-based non-chlorinated engine, gear and lubricating oils
13 02 06*	synthetic engine, gear and lubricating oils
13 02 07*	readily biodegradable engine, gear and lubricating oils
13 02 08*	other engine, gear and lubricating oils
<b>13 03</b>	<b>Waste Insulating and Heat Transmission Oil</b>
13 03 01*	insulating or heat transmission oils containing PCBs
13 03 06*	mineral-based chlorinated insulating and heat transmission oils other than those mentioned in 13 03 01

**Table S2.2 Permitted waste types and quantities for Storage of Waste Oil**

Maximum quantity	Table S2.2, S2.3 and S2.4 combined total of 7500 tonnes per year
<b>Waste code</b>	<b>Description</b>
13 03 07*	mineral-based non-chlorinated insulating and heat transmission oils
13 03 08*	synthetic insulating and heat transmission oils
13 03 09*	readily biodegradable insulating and heat transmission oils
13 03 10*	other insulating and heat transmission oils
<b>13 04</b>	<b>Bilge Oils</b>
13 04 01*	bilge oils from inland navigation
13 04 02*	bilge oils from jetty sewers
13 04 03*	bilge oils from other navigation
<b>13 05</b>	<b>Oil/Water Separator Contents</b>
13 05 01*	solids from grit chambers and oil/water separators
13 05 02*	sludges from oil/water separators
13 05 03*	interceptor sludges
13 05 06*	oil from oil/water separators
13 05 07*	oily water from oil/water separators
13 05 08*	mixtures of wastes from grit chambers and oil/water separators
<b>13 07</b>	<b>Wasters of Liquid Fuels</b>
13 07 01*	fuel oil and diesel
13 07 02*	petrol
13 07 03*	other fuels (including mixtures)
<b>13 08</b>	<b>Oil Wastes Not Otherwise specified</b>
13 08 01*	desalter sludges or emulsions
13 08 02*	other emulsions
13 08 99*	wastes not otherwise specified

<b>Table S2.3 Permitted waste types and quantities for Hazardous Waste Transfer Station Activities</b>	
Maximum quantity	Table S2.2, S2.3 and S2.4 combined total of 7500 tonnes per year
<b>Waste code</b>	<b>Description</b>
<b>01</b>	<b>WASTES RESULTING FROM EXPLORATION, MINING, QUARRYING, AND PHYSICAL AND CHEMICAL TREATMENT OF MINERALS</b>
<b>01 03</b>	<b>Wastes from Physical and Chemical Processing of Metalliferous Minerals</b>
01 03 04*	acid-generating tailings from processing of sulphide ore
01 03 05*	other tailings containing hazardous substances
<b>01 04</b>	<b>Wastes from Physical and Chemical Processing of Non-Metalliferous Minerals</b>
01 04 07*	wastes containing hazardous substances from physical and chemical processing of non-metalliferous minerals
<b>01 05</b>	<b>Drilling Muds and Other Drilling Wastes</b>
01 05 05*	oil-containing drilling muds and wastes
01 05 06*	drilling muds and other drilling wastes containing hazardous substances
<b>02</b>	<b>WASTES FROM AGRICULTURE, HORTICULTURE, AQUACULTURE, FORESTRY, HUNTING AND FISHING, FOOD PREPARATION AND PROCESSING</b>
<b>02 01</b>	<b>Wastes from Agriculture, Horticulture, Aquaculture, Forestry, Hunting and Fishing</b>
02 01 08*	agrochemical waste containing hazardous substances
<b>03</b>	<b>WASTES FROM WOOD PROCESSING AND THE PRODUCTION OF PANELS AND FURNITURE, PULP, PAPER AND CARDBOARD</b>
<b>03 01</b>	<b>Wastes from Wood Processing and The Production of Panels and Furniture</b>
03 01 04*	sawdust, shavings, cuttings, wood, particle board and veneer containing hazardous substances
<b>03 02</b>	<b>Wastes from Wood Preservation</b>
03 02 01*	non-halogenated organic wood preservatives
03 02 02*	organochlorinated wood preservatives
03 02 03*	organometallic wood preservatives
03 02 04*	inorganic wood preservatives
03 02 05*	other wood preservatives containing hazardous substances
<b>04</b>	<b>WASTES FROM THE LEATHER, FUR AND TEXTILE INDUSTRIES</b>
<b>04 01</b>	<b>Wastes from The Leather and Fur Industry</b>
04 01 03*	degreasing wastes containing solvents without a liquid phase
<b>04 02</b>	<b>Wastes from The Textile Industry</b>
04 02 14*	wastes from finishing containing organic solvents
04 02 16*	dye stuffs and pigments containing hazardous substances
04 02 19*	sludges from on-site effluent treatment containing hazardous substances
<b>05</b>	<b>WASTES FROM PETROLEUM REFINING, NATURAL GAS PURIFICATION AND PYROLYTIC TREATMENT OF COAL</b>
<b>05 01</b>	<b>Wastes from Petroleum Refining</b>
05 01 02*	desalter sludges
05 01 03*	tank bottom sludges
05 01 04*	acid alkyl sludges
05 01 05*	oil spills
05 01 06*	oily sludges from maintenance operations of the plant or equipment
05 01 07*	acid tars
05 01 08*	other tars
05 01 09*	sludges from on-site effluent treatment containing hazardous substances

**Table S2.3 Permitted waste types and quantities for Hazardous Waste Transfer Station Activities**

Maximum quantity	Table S2.2, S2.3 and S2.4 combined total of 7500 tonnes per year
<b>Waste code</b>	<b>Description</b>
05 01 11*	wastes from cleaning of fuels with bases
05 01 12*	oil containing acids
05 01 15*	spent filter clays
<b>05 06</b>	<b>Wastes from The Pyrolytic Treatment of Coal</b>
05 06 01*	acid tars
05 06 03*	other tars
<b>05 07</b>	<b>Wastes from Natural Gas Purification and Transportation</b>
05 07 01*	wastes containing mercury
<b>06</b>	<b>WASTES FROM INORGANIC CHEMICAL PROCESSES</b>
<b>06 01</b>	<b>Wastes from The Manufacture, Formulation, Supply and Use (MFSU) of Acids</b>
06 01 01*	sulphuric acid and sulphurous acid
06 01 02*	hydrochloric acid
06 01 03*	hydrofluoric acid
06 01 04*	phosphoric and phosphorous acid
06 01 05*	nitric acid and nitrous acid
06 01 06*	other acids
<b>06 02</b>	<b>Wastes from The MFSU of Bases</b>
06 02 01*	calcium hydroxide
06 02 03*	ammonium hydroxide
06 02 04*	sodium and potassium hydroxide
06 02 05*	other bases
<b>06 03</b>	<b>Wastes from The MFSU of Salts and Their Solutions and Metallic Oxides</b>
06 03 11*	solid salts and solutions containing cyanides
06 03 13*	solid salts and solutions containing heavy metals
06 03 15*	metallic oxides containing heavy metals
<b>06 04</b>	<b>Metal-Containing Wastes Other Than Those Mentioned In 06 03</b>
06 04 03*	wastes containing arsenic
06 04 04*	wastes containing mercury
06 04 05*	wastes containing other heavy metals
<b>06 05</b>	<b>Sludges from On-Site Effluent Treatment</b>
06 05 02*	sludges from on-site effluent treatment containing hazardous substances
<b>06 06</b>	<b>Wastes from The MFSU of Sulphur Chemicals, Sulphur Chemical Processes and Desulphurisation Processes</b>
06 06 02*	wastes containing hazardous sulphides
<b>06 07</b>	<b>Wastes from The MFSU of Halogens and Halogen Chemical Processes</b>
06 07 01*	wastes containing asbestos from electrolysis
06 07 02*	activated carbon from chlorine production
06 07 03*	barium sulphate sludge containing mercury
06 07 04*	solutions and acids, for example contact acid
<b>06 08</b>	<b>Wastes from The MFSU of Silicon and Silicon Derivatives</b>
06 08 02*	wastes containing hazardous chlorosilanes
<b>06 09</b>	<b>Wastes from The MFSU of Phosphorous Chemicals and Phosphorous Chemical Processes</b>
06 09 03*	calcium-based reaction wastes containing or contaminated with hazardous substances
<b>06 10</b>	<b>Wastes from The MFSU Of Nitrogen Chemicals, Nitrogen Chemical Processes and Fertiliser Manufacture</b>

**Table S2.3 Permitted waste types and quantities for Hazardous Waste Transfer Station Activities**

Maximum quantity	Table S2.2, S2.3 and S2.4 combined total of 7500 tonnes per year
<b>Waste code</b>	<b>Description</b>
06 10 02*	wastes containing hazardous substances
<b>06 13</b>	<b>Wastes from Inorganic Chemical Processes Not Otherwise Specified</b>
06 13 01*	inorganic plant protection products, wood-preserving agents and other biocides.
06 13 02*	spent activated carbon (except 06 07 02)
06 13 04*	wastes from asbestos processing
06 13 05*	Soot
<b>07</b>	<b>WASTES FROM ORGANIC CHEMICAL PROCESSES</b>
<b>07 01</b>	<b>Wastes from The Manufacture, Formulation, Supply and Use (MFSU) Of Basic Organic Chemicals</b>
07 01 01*	aqueous washing liquids and mother liquors
07 01 03*	organic halogenated solvents, washing liquids and mother liquors
07 01 04*	other organic solvents, washing liquids and mother liquors
07 01 07*	halogenated still bottoms and reaction residues
07 01 08*	other still bottoms and reaction residues
07 01 09*	halogenated filter cakes and spent absorbents
07 01 10*	other filter cakes and spent absorbents
07 01 11*	sludges from on-site effluent treatment containing hazardous substances
<b>07 02</b>	<b>Wastes from The MFSU of Plastics, Synthetic Rubber and Man-Made Fibres</b>
07 02 01*	aqueous washing liquids and mother liquors
07 02 03*	organic halogenated solvents, washing liquids and mother liquors
07 02 04*	other organic solvents, washing liquids and mother liquors
07 02 07*	halogenated still bottoms and reaction residues
07 02 08*	other still bottoms and reaction residues
07 02 09*	halogenated filter cakes and spent absorbents
07 02 10*	other filter cakes and spent absorbents
07 02 11*	sludges from on-site effluent treatment containing hazardous substances
07 02 14*	wastes from additives containing hazardous substances
07 02 16*	wastes containing hazardous silicones
<b>07 03</b>	<b>Wastes from The MFSU of Organic Dyes and Pigments (Except 06 11)</b>
07 03 01*	aqueous washing liquids and mother liquors
07 03 03*	organic halogenated solvents, washing liquids and mother liquors
07 03 04*	other organic solvents, washing liquids and mother liquors
07 03 07*	halogenated still bottoms and reaction residues
07 03 08*	other still bottoms and reaction residues
07 03 09*	halogenated filter cakes and spent absorbents
07 03 10*	other filter cakes and spent absorbents
07 03 11*	sludges from on-site effluent treatment containing hazardous substances
<b>07 04</b>	<b>Wastes from The MFSU Of Organic Plant Protection Products (Except 02 01 08 and 02 01 09), Wood Preserving Agents (Except 03 02) and Other Biocides</b>
07 04 01*	aqueous washing liquids and mother liquors
07 04 03*	organic halogenated solvents, washing liquids and mother liquors
07 04 04*	other organic solvents, washing liquids and mother liquors
07 04 07*	halogenated still bottoms and reaction residues
07 04 08*	other still bottoms and reaction residues
07 04 09*	halogenated filter cakes and spent absorbents
07 04 10*	other filter cakes and spent absorbents

**Table S2.3 Permitted waste types and quantities for Hazardous Waste Transfer Station Activities**

Maximum quantity	Table S2.2, S2.3 and S2.4 combined total of 7500 tonnes per year
Waste code	Description
07 04 11*	sludges from on-site effluent treatment containing hazardous substances
07 04 13*	solid wastes containing hazardous substances
<b>07 05</b>	<b>Wastes from The MFSU of Pharmaceuticals</b>
07 05 01*	aqueous washing liquids and mother liquors
07 05 03*	organic halogenated solvents, washing liquids and mother liquors
07 05 04*	other organic solvents, washing liquids and mother liquors
07 05 07*	halogenated still bottoms and reaction residues
07 05 08*	other still bottoms and reaction residues
07 05 09*	halogenated filter cakes and spent absorbents
07 05 10*	other filter cakes and spent absorbents
07 05 11*	sludges from on-site effluent treatment containing hazardous substances
07 05 13*	solid wastes containing hazardous substances
<b>07 06</b>	<b>Wastes from The MFSU of Fats, Grease, Soaps, Detergents, Disinfectants and Cosmetics</b>
07 06 01*	aqueous washing liquids and mother liquors
07 06 03*	organic halogenated solvents, washing liquids and mother liquors
07 06 04*	other organic solvents, washing liquids and mother liquors
07 06 07*	halogenated still bottoms and reaction residues
07 06 08*	other still bottoms and reaction residues
07 06 09*	halogenated filter cakes and spent absorbents
07 06 10*	other filter cakes and spent absorbents
07 06 11*	sludges from on-site effluent treatment containing hazardous substances
<b>07 07</b>	<b>Wastes from The MFSU of Fine Chemicals and Chemical Products Not Otherwise Specified</b>
07 07 01*	aqueous washing liquids and mother liquors
07 07 03*	organic halogenated solvents, washing liquids and mother liquors
07 07 04*	other organic solvents, washing liquids and mother liquors
07 07 07*	halogenated still bottoms and reaction residues
07 07 08*	other still bottoms and reaction residues
07 07 09*	halogenated filter cakes and spent absorbents
07 07 10*	other filter cakes and spent absorbents
07 07 11*	sludges from on-site effluent treatment containing hazardous substances
<b>08</b>	<b>WASTES FROM THE MANUFACTURE, FORMULATION, SUPPLY AND USE (MFSU) OF COATINGS (PAINTS, VARNISHES AND VITREOUS ENAMELS), ADHESIVES, SEALANTS AND PRINTING INKS</b>
<b>08 01</b>	<b>Wastes from MFSU and Removal of Paint and Varnish</b>
08 01 11*	waste paint and varnish containing organic solvents or other hazardous substances
08 01 13*	sludges from paint or varnish containing organic solvents or other hazardous substances
08 01 15*	aqueous sludges containing paint or varnish containing organic solvents or other hazardous substances
08 01 17*	wastes from paint or varnish removal containing organic solvents or other hazardous substances
08 01 19*	aqueous suspensions containing paint or varnish containing organic solvents or other hazardous substances
08 01 21*	waste paint or varnish remover
<b>08 03</b>	<b>Wastes from MFSU of Printing Inks</b>

**Table S2.3 Permitted waste types and quantities for Hazardous Waste Transfer Station Activities**

Maximum quantity	Table S2.2, S2.3 and S2.4 combined total of 7500 tonnes per year
Waste code	Description
08 03 12*	waste ink containing hazardous substances
08 03 14*	ink sludges containing hazardous substances
08 03 16*	waste etching solutions
08 03 17*	waste printing toner containing hazardous substances
<b>08 04</b>	<b>Wastes from MFSU of Adhesives and Sealants (Including Waterproofing Products)</b>
08 04 09*	waste adhesives and sealants containing organic solvents or other hazardous substances
08 04 11*	adhesive and sealant sludges containing organic solvents or other hazardous substances
08 04 13*	aqueous sludges containing adhesives or sealants containing organic solvents or other hazardous substances
08 04 15*	aqueous liquid waste containing adhesives or sealants containing organic solvents or other hazardous substances
08 04 17*	rosin oil
<b>08 05</b>	<b>Wastes Not Otherwise Specified In 08</b>
08 05 01*	waste isocyanates
<b>09</b>	<b>WASTES FROM THE PHOTOGRAPHIC INDUSTRY</b>
<b>09 01</b>	<b>Wastes from The Photographic Industry</b>
09 01 01*	water-based developer and activator solutions
09 01 02*	water-based offset plate developer solutions
09 01 03*	solvent-based developer solutions
09 01 04*	fixer solutions
09 01 05*	bleach solutions and bleach fixer solutions
09 01 06*	wastes containing silver from on-site treatment of photographic wastes
09 01 11*	single-use cameras containing batteries included in 16 06 01, 16 06 02 or 16 06 03
09 01 13*	aqueous liquid waste from on-site reclamation of silver other than those mentioned in 09 01 06
<b>10</b>	<b>WASTES FROM THERMAL PROCESSES</b>
<b>10 01</b>	<b>Wastes from Power Stations and Other Combustion Plants (Except 19)</b>
10 01 04*	oil fly ash and boiler dust
10 01 09*	sulphuric acid
10 01 13*	fly ash from emulsified hydrocarbons used as fuel
10 01 14*	bottom ash, slag and boiler dust from co-incineration containing hazardous substances
10 01 16*	fly ash from co-incineration containing hazardous substances
10 01 18*	wastes from gas cleaning containing hazardous substances
10 01 20*	sludges from on-site effluent treatment containing hazardous substances
10 01 22*	aqueous sludges from boiler cleansing containing hazardous substances
<b>10 02</b>	<b>Wastes from The Iron and Steel Industry</b>
10 02 07*	solid wastes from gas treatment containing hazardous substances
10 02 11*	wastes from cooling-water treatment containing oil
10 02 13*	sludges and filter cakes from gas treatment containing hazardous substances
<b>10 03</b>	<b>Wastes from Aluminium Thermal Metallurgy</b>
10 03 04*	primary production slags
10 03 08*	salt slags from secondary production
10 03 09*	black drosses from secondary production

**Table S2.3 Permitted waste types and quantities for Hazardous Waste Transfer Station Activities**

Maximum quantity	Table S2.2, S2.3 and S2.4 combined total of 7500 tonnes per year
<b>Waste code</b>	<b>Description</b>
10 03 15*	skimmings that are flammable or emit, upon contact with water, flammable gases in hazardous quantities
10 03 17*	tar-containing wastes from anode manufacture
10 03 19*	flue-gas dust containing hazardous substances
10 03 21*	other particulates and dust (including ball-mill dust) containing hazardous substances
10 03 23*	solid wastes from gas treatment containing hazardous substances
10 03 25*	sludges and filter cakes from gas treatment containing hazardous substances
10 03 27*	wastes from cooling-water treatment containing oil
10 03 29*	wastes from treatment of salt slags and black drosses containing hazardous substances
<b>10 04</b>	<b>Wastes from Lead Thermal Metallurgy</b>
10 04 01*	slags from primary and secondary production
10 04 02*	dross and skimmings from primary and secondary production
10 04 03*	calcium arsenate
10 04 04*	flue-gas dust
10 04 05*	other particulates and dust
10 04 06*	solid wastes from gas treatment
10 04 07*	sludges and filter cakes from gas treatment
10 04 09*	wastes from cooling-water treatment containing oil
<b>10 05</b>	<b>Wastes from Zinc Thermal Metallurgy</b>
10 05 03*	flue-gas dust
10 05 05*	solid waste from gas treatment
10 05 06*	sludges and filter cakes from gas treatment
10 05 08*	wastes from cooling-water treatment containing oil
<b>10 06</b>	<b>Wastes from Copper Thermal Metallurgy</b>
10 06 03*	flue-gas dust
10 06 06*	solid wastes from gas treatment
10 06 07*	sludges and filter cakes from gas treatment
10 06 09*	wastes from cooling-water treatment containing oil
<b>10 07</b>	<b>Wastes from Silver, Gold and Platinum Thermal Metallurgy</b>
10 07 07*	wastes from cooling-water treatment containing oil
<b>10 08</b>	<b>Wastes from Other Non-Ferrous Thermal Metallurgy</b>
10 08 08*	salt slag from primary and secondary production
10 08 10*	dross and skimmings that are flammable or emit, upon contact with water, flammable gases in dangerous quantities
10 08 12*	tar-containing wastes from anode manufacture
10 08 15*	flue-gas dust containing hazardous substances
10 08 17*	sludges and filter cakes from flue-gas treatment containing hazardous substances
10 08 19*	wastes from cooling-water treatment containing oil
<b>10 09</b>	<b>Wastes from Casting of Ferrous Pieces</b>
10 09 05*	casting cores and moulds which have not undergone pouring containing dangerous substances
10 09 07*	casting cores and moulds which have undergone pouring containing dangerous substances
10 09 09*	flue-gas dust containing dangerous substances
10 09 11*	other particulates containing dangerous substances
10 09 13*	waste binders containing dangerous substances



**Table S2.3 Permitted waste types and quantities for Hazardous Waste Transfer Station Activities**

Maximum quantity	Table S2.2, S2.3 and S2.4 combined total of 7500 tonnes per year
Waste code	Description
10 09 15*	waste crack-indicating agent containing dangerous substances
<b>10 10</b>	<b>Wastes from Casting of Non-Ferrous Pieces</b>
10 10 05*	casting cores and moulds which have not undergone pouring containing dangerous substances
10 10 07*	casting cores and moulds which have undergone pouring containing dangerous substances
10 10 09*	flue-gas dust containing dangerous substances
10 10 11*	other particulates containing dangerous substances
10 10 13*	waste binders containing dangerous substances
10 10 15*	waste crack-indicating agent containing dangerous substances
<b>10 11</b>	<b>Wastes from Manufacture of Glass and Glass Products</b>
10 11 09*	waste preparation mixture before thermal processing, containing dangerous substances
10 11 11*	waste glass in small particles and glass powder containing heavy metals (for example from cathode ray tubes)
10 11 13*	glass-polishing and -grinding sludge containing dangerous substances
10 11 15*	solid wastes from flue-gas treatment containing dangerous substances
10 11 17*	sludges and filter cakes from flue-gas treatment containing dangerous substances
10 11 19*	solid wastes from on-site effluent treatment containing dangerous substances
<b>10 12</b>	<b>Wastes from Manufacture of Ceramic Goods, Bricks, Tiles and Construction Products</b>
10 12 09*	solid wastes from gas treatment containing dangerous substances
10 12 11*	wastes from glazing containing heavy metals
<b>10 13</b>	<b>Wastes from Manufacture of Cement, Lime, Plaster and Articles and Products Made from Them</b>
10 13 09*	wastes from asbestos-cement manufacture containing asbestos
10 13 12*	solid wastes from gas treatment containing dangerous substances
<b>10 14</b>	<b>Waste from Crematoria</b>
10 14 01*	waste from gas cleaning containing mercury
<b>11</b>	<b>WASTES FROM CHEMICAL SURFACE TREATMENT AND COATING OF METALS AND OTHER MATERIALS; NON-FERROUS HYDROMETALLURGY</b>
<b>11 01</b>	<b>Wastes from Chemical Surface Treatment and Coating of Metals and Other Materials (For Example Galvanic Processes, Zinc Coating Processes, Pickling Processes, Etching, Phosphating, Alkaline Degreasing, Anodising)</b>
11 01 05*	pickling acids
11 01 06*	acids not otherwise specified
11 01 07*	pickling bases
11 01 08*	phosphatising sludges
11 01 09*	sludges and filter cakes containing dangerous substances
11 01 11*	aqueous rinsing liquids containing dangerous substances
11 01 13*	degreasing wastes containing dangerous substances
11 01 15*	eluate and sludges from membrane systems or ion exchange systems containing dangerous substances
11 01 16*	saturated or spent ion exchange resins
11 01 98*	other wastes containing dangerous substances
<b>11 02</b>	<b>Wastes from Non-Ferrous Hydrometallurgical Processes</b>
11 02 02*	sludges from zinc hydrometallurgy (including jarosite, goethite)
11 02 05*	wastes from copper hydrometallurgical processes containing dangerous substances

**Table S2.3 Permitted waste types and quantities for Hazardous Waste Transfer Station Activities**

Maximum quantity	Table S2.2, S2.3 and S2.4 combined total of 7500 tonnes per year
Waste code	Description
11 02 07*	other wastes containing dangerous substances
<b>11 03</b>	<b>Sludges and Solids from Tempering Processes</b>
11 03 01*	wastes containing cyanide permitted
11 03 02*	other wastes
<b>11 05</b>	<b>Wastes from Hot Galvanising Processes</b>
11 05 03*	solid wastes from gas treatment
11 05 04*	spent flux
<b>12</b>	<b>WASTES FROM SHAPING AND PHYSICAL AND MECHANICAL SURFACE TREATMENT OF METALS AND PLASTICS</b>
<b>12 01</b>	<b>Wastes from Shaping and Physical and Mechanical Surface Treatment of Metals and Plastics</b>
12 01 06*	mineral-based machining oils containing halogens (except emulsions and solutions)
12 01 07*	mineral-based machining oils free of halogens (except emulsions and solutions)
12 01 08*	machining emulsions and solutions containing halogens
12 01 09*	machining emulsions and solutions free of halogens
12 01 10*	synthetic machining oils
12 01 12*	spent waxes and fats
12 01 14*	machinery sludges containing dangerous substances
12 01 15*	machining sludges other than those mentioned in 12 01 14
12 01 16*	waste blasting material containing dangerous substances
12 01 18*	metal sludge (grinding, honing and lapping sludge) containing oil
12 01 19*	readily biodegradable machining oil
12 01 20*	spent grinding bodies and grinding materials containing dangerous substances
<b>12 03</b>	<b>Wastes from Water and Steam Degreasing Processes (Except 11)</b>
12 03 01*	aqueous washing liquids
12 03 02*	steam degreasing wastes
<b>14</b>	<b>ORGANIC SOLVENTS, REFRIGERANTS AND PROPELLANTS (EXCEPT 7 AND 8)</b>
<b>14 06</b>	<b>Waste Organic Solvents, Refrigerants and Foam/Aerosol Propellants</b>
14 06 01*	chlorofluorocarbons, HCFC, HFC
14 06 02*	other halogenated solvents and solvent mixtures
14 06 03*	other solvents and solvent mixtures
14 06 04*	sludges or solid wastes containing halogenated solvents
<b>15</b>	<b>PACKAGING; ABSORBENTS, WIPING CLOTHS, FILTER MATERIALS AND PROTECTIVE CLOTHING NOT OTHERWISE SPECIFIED</b>
<b>15 01</b>	<b>Packaging (Including Separately Collected Municipal Packaging Waste)</b>
15 01 10*	packaging containing residues of or contaminated by dangerous substances
15 01 11*	metallic packaging containing a hazardous solid porous matrix (for example asbestos), including empty pressure containers
<b>15 02</b>	<b>Absorbents, Filter Materials, Wiping Cloths and Protective Clothing</b>
15 02 02*	absorbents, filter materials (including oil filters not otherwise specified), wiping cloths, protective clothing contaminated by hazardous substances
<b>16</b>	<b>WASTES NOT OTHERWISE SPECIFIED IN THE LIST</b>
<b>16 01</b>	<b>End of Life Vehicles from Different Means of Transport (Including Off-Road Machinery) and Wastes from Dismantling of End Life Vehicles and Vehicle Maintenance (Except 13, 14, 16 06 And 16 08)</b>

**Table S2.3 Permitted waste types and quantities for Hazardous Waste Transfer Station Activities**

Maximum quantity	Table S2.2, S2.3 and S2.4 combined total of 7500 tonnes per year
<b>Waste code</b>	<b>Description</b>
16 01 07*	oil filters
16 01 08*	components containing mercury
16 01 09*	components containing PCBs
16 01 11*	brake pads containing asbestos permitted
16 01 13*	brake fluids
16 01 14*	antifreeze fluids containing dangerous substances
16 01 21*	hazardous components other than those mentioned in 16 01 07 to 16 01 11 and 16 01 13 and 16 01 14
<b>16 02</b>	<b>Wastes from Electrical and Electronic Equipment</b>
16 02 09*	transformers and capacitors containing PCBs
16 02 10*	discarded equipment containing or contaminated by PCBs other than those mentioned in 16 02 09
16 02 11*	discarded equipment containing chlorofluorocarbons, HCFC, HFC
16 02 12*	discarded equipment containing free asbestos
16 02 13*	discarded equipment containing hazardous components other than those mentioned in 16 02 09 to 16 02 12
16 02 15*	hazardous components removed from discarded equipment
<b>16 03</b>	<b>Off-Specification Batches and Unused Products</b>
16 03 03*	inorganic wastes containing dangerous substances
16 03 05*	organic wastes containing dangerous substances
<b>16 05</b>	<b>Gases in Pressure Containers and Discarded Chemicals</b>
16 05 04*	gases in pressure containers (including halons) containing dangerous substances
16 05 07*	discarded inorganic chemicals consisting of or containing dangerous substances
16 05 08*	discarded organic chemicals consisting of or containing dangerous substances
<b>16 06</b>	<b>Batteries and Accumulators</b>
16 06 01*	lead batteries
16 06 02*	ni-cd batteries
16 06 03*	mercury-containing batteries
16 06 06*	separately collected electrolyte from batteries and accumulators
<b>16 07</b>	<b>Wastes from Transport Tank, Storage Tank and Barrel Cleaning (Except 05 And 13)</b>
16 07 08*	wastes containing oil
16 07 09*	wastes containing other dangerous substances
<b>16 08</b>	<b>Spent Catalysts</b>
16 08 02*	spent catalysts containing dangerous transition metals <sup>3</sup> or dangerous transition metal compounds
16 08 05*	spent catalysts containing phosphoric acid
16 08 06*	spent liquids used as catalysts
16 08 07*	spent catalysts contaminated with dangerous substances
<b>16 09</b>	<b>Oxidising Substances</b>
16 09 01*	permanganates, for example potassium substances
16 09 02*	chromates, for example potassium chromate, potassium or sodium dichromate
16 09 03*	peroxides, for example hydrogen peroxide
16 09 04*	oxidising substances, not otherwise specified
<b>16 10</b>	<b>Aqueous Liquid Wastes Destined for Off-Site Treatment</b>
16 10 01*	aqueous liquid wastes containing dangerous substances
16 10 03*	aqueous concentrates containing dangerous substances
<b>16 11</b>	<b>Waste Linings and Refractories</b>

**Table S2.3 Permitted waste types and quantities for Hazardous Waste Transfer Station Activities**

Maximum quantity	Table S2.2, S2.3 and S2.4 combined total of 7500 tonnes per year
<b>Waste code</b>	<b>Description</b>
16 11 01*	carbon-based and refractories from metallurgical processes containing dangerous substances
16 11 03*	other linings and refractories from metallurgical processes containing dangerous substances
16 11 05*	linings and refractories from non-metallurgical processes containing dangerous substances
<b>17</b>	<b>CONSTRUCTION AND DEMOLITION WASTES (INCLUDING EXCAVATED SOIL FROM CONTAMINATED SITES)</b>
<b>17 01</b>	<b>Concrete, Bricks, Tiles and Ceramics</b>
17 01 06*	mixtures of, or separate fractions of concrete, bricks, tiles and ceramics containing dangerous substances
<b>17 02</b>	<b>Wood, Glass and Plastic</b>
17 02 04*	glass, plastic and wood containing or contaminated with dangerous substances
<b>17 03</b>	<b>Bituminous Mixtures, Coal Tar and Tarred Products</b>
17 03 01*	bituminous mixtures containing coal tar
17 03 03*	coal tar and tarred products permitted
<b>17 04</b>	<b>Metals (Including Their Alloys)</b>
17 04 09*	metal waste contaminated with dangerous substances
17 04 10*	cables containing oil, coal tar and other dangerous substances
<b>17 05</b>	<b>Soil (Including Excavated Soil from Contaminated Sites), Stones and Dredging Spoil</b>
17 05 03*	soil and stones containing dangerous substances
17 05 05*	dredging spoil containing dangerous substances
17 05 07*	track ballast containing dangerous substances
<b>17 06</b>	<b>Insulation Materials and Asbestos-Containing Construction Materials</b>
17 06 01*	insulation materials containing asbestos
17 06 03*	other insulation materials consisting of or containing dangerous substances
17 06 05*	construction materials containing asbestos
<b>17 08</b>	<b>Gypsum-Based Construction Material</b>
17 08 01*	gypsum-based construction materials contaminated with dangerous substances
<b>17 09</b>	<b>Other Construction and Demolition Wastes</b>
17 09 01*	construction and demolition wastes containing mercury
17 09 03*	other construction and demolition wastes (including mixed wastes) containing dangerous substances
<b>18</b>	<b>WASTES FROM HUMAN OR ANIMAL HEALTH CARE AND/OR RELATED RESEARCH (EXCEPT KITCHEN AND RESTAURANT WASTES NOT ARISING FROM IMMEDIATE HEALTH CARE)</b>
<b>18 01</b>	<b>Wastes from Natal Care, Diagnosis, Treatment or Prevention of Disease in Humans</b>
18 01 03*	wastes whose collection and disposal is subject to special requirements in order to prevent infection
18 01 06*	chemicals consisting of or containing dangerous substances
18 01 08*	cytotoxic and cytostatic medicines
18 01 10*	amalgam waste from dental care
<b>18 02</b>	<b>Wastes from Research, Diagnosis, Treatment or Prevention of Disease Involving Animals</b>
18 02 05*	chemicals consisting of or containing dangerous substances
18 02 07*	cytotoxic and cytostatic medicines

**Table S2.3 Permitted waste types and quantities for Hazardous Waste Transfer Station Activities**

Maximum quantity	Table S2.2, S2.3 and S2.4 combined total of 7500 tonnes per year
Waste code	Description
<b>19</b>	<b>WASTES FROM WASTE MANAGEMENT FACILITIES, OFF-SITE WASTEWATER TREATMENT PLANTS AND THE PREPARATION OF WATER INTENDED FOR HUMAN CONSUMPTION AND WATER FOR INDUSTRIAL USE</b>
<b>19 01</b>	<b>Wastes from Incineration or Pyrolysis of Waste</b>
19 01 05*	filter cake from gas treatment
19 01 06*	aqueous liquid wastes from gas treatment and other aqueous liquid wastes
19 01 07*	solid wastes from gas treatment
19 01 10*	spent activated carbon from flue-gas treatment
19 01 11*	bottom ash and slag containing dangerous substances
19 01 13*	fly ash containing dangerous substances
19 01 15*	boiler dust containing dangerous substances
19 01 17*	pyrolysis wastes containing dangerous substances
<b>19 02</b>	<b>Wastes from Physio/Chemical Treatments of Waste (Including Dechromatation, Decyanidation, Neutralisation)</b>
19 02 04*	premixed wastes composed of at least one hazardous waste
19 02 05*	sludges from physio/chemical treatment containing dangerous substances
19 02 07*	oil and concentrates from separation
19 02 08*	liquid combustible wastes containing dangerous substances
19 02 09*	solid combustible wastes containing dangerous substances
19 02 11*	other wastes containing dangerous substances
<b>19 03</b>	<b>Stabilised/Solidified Wastes</b>
19 03 04*	wastes marked as hazardous, partly6 stabilised
19 03 06*	wastes marked as hazardous, solidified
<b>19 04</b>	<b>Vitrified Waste and Wastes from Vitrification</b>
19 04 02*	fly ash and other flue-gas treatment wastes
19 04 03*	non-vitrified solid phase
<b>19 07</b>	<b>Landfill Leachate</b>
19 07 02*	landfill leachate containing dangerous substances
<b>19 08</b>	<b>Wastes from Wastewater Treatment Plants Not Otherwise Specified</b>
19 08 05*	sludges from treatment of urban wastewater
19 08 06*	saturated or spent ion exchange resins
19 08 07*	solutions and sludges from regeneration of ion exchanges
19 08 08*	membrane system waste containing heavy metals
19 08 10*	grease and oil mixture from oil/water separation other than those mentioned in 19 08 09
19 08 11*	sludges containing dangerous substances from biological treatment of industrial wastewater
19 08 13*	sludges containing dangerous substances from other treatment of industrial wastewater
<b>19 10</b>	<b>Wastes from Shredding of Metal-Containing Wastes</b>
19 10 03*	fluff-light fraction and dust containing dangerous substances
19 10 05*	other fractions containing dangerous substances
<b>19 11</b>	<b>Wastes from Oil Regeneration</b>
19 11 01*	spent filter clays
19 11 02*	acid tars
19 11 03*	aqueous liquid wastes
19 11 04*	wastes from cleaning of fuel with bases

**Table S2.3 Permitted waste types and quantities for Hazardous Waste Transfer Station Activities**

Maximum quantity	Table S2.2, S2.3 and S2.4 combined total of 7500 tonnes per year
Waste code	Description
19 11 05*	sludges from on-site effluent treatment containing dangerous substances
19 11 07*	wastes from flue-gas cleaning
<b>19 12</b>	<b>Steps from The Mechanical Treatment of Waste (For Examples Sorting, Crushing, Compacting, Palletising) Not Otherwise Specified</b>
19 12 06*	wood containing dangerous substances
<b>19 13</b>	<b>wastes from soil and groundwater remediation</b>
19 13 01*	solid wastes from soil remediation containing dangerous substances
19 13 03*	sludges from soil remediation containing dangerous substances
19 13 05*	sludges from groundwater remediation containing dangerous substances
<b>20</b>	<b>MUNICIPAL WASTES (HOUSEHOLD WASTE AND SIMILAR COMMERCIAL, INDUSTRIAL AND INSTITUTIONAL WASTES) INCLUDING SEPARATELY COLLECTED FRACTIONS</b>
<b>20 01</b>	<b>Separately Collected Fractions (Except 15 01)</b>
20 01 13*	solvents
20 01 14*	acids
20 01 15*	alkalines
20 01 17*	photochemicals
20 01 19*	pesticides
20 01 21*	fluorescent tubes and other mercury-containing waste
20 01 23*	discarded equipment containing chlorofluorocarbons
20 01 26*	oil and fat other than those mentioned in 20 01 25
20 01 27*	paint, inks, adhesives and resins containing dangerous substances
20 01 29*	detergents containing dangerous substances
20 01 31*	cytotoxic and cytostatic medicines
20 01 33*	batteries and accumulators included in 16 06 01, 16 06 02 or 16 06 03 and unsorted batteries and accumulators containing these batteries
20 01 35*	discarded electrical and electronic equipment other than those mentioned in 20 01 21 and 20 01 23 containing hazardous components
20 01 37*	wood containing dangerous substances

**Table S2.4 Permitted waste types and quantities for Non-Hazardous Waste Transfer Station Operations**

Maximum quantity	Table S2.2, S2.3 and S2.4 combined total of 7500 tonnes per year
Waste Code	Description
<b>01</b>	<b>WASTES RESULTING FROM EXPLORATION, MINING, QUARRYING, AND PHYSICAL AND CHEMICAL TREATMENT OF MINERALS</b>
<b>01 01</b>	<b>Wastes from Mineral Excavation</b>
01 01 01	wastes from mineral metalliferous excavation
01 01 02	wastes from mineral non-metalliferous excavation
<b>01 03</b>	<b>Wastes from Physical and Chemical Processing of Metalliferous Minerals</b>
01 03 06	tailings other than those mentioned in 01 03 04 and 01 03 05
01 03 07	other wastes containing dangerous substances from physical and chemical processing of metalliferous minerals
01 03 08	dusty and powdery wastes other than those mentioned in 01 03 07
01 03 09	red mud from alumina production other than the wastes mentioned in 01 03 07
<b>01 04</b>	<b>Wastes from Physical and Chemical Processing of Non- Metalliferous Minerals</b>

**Table S2.4 Permitted waste types and quantities for Non-Hazardous Waste Transfer Station Operations**

Maximum quantity	Table S2.2, S2.3 and S2.4 combined total of 7500 tonnes per year
Waste Code	Description
01 04 07	wastes containing dangerous substances from physical and chemical processing of non-metalliferous minerals
01 04 08	waste gravel and crushed rocks other than those mentioned in 01 04 07
01 04 09	waste sand and clays
01 04 10	dusty and powdery wastes other than those mentioned in 01 04 07
01 04 11	wastes from potash and rock salt processing other than those mentioned in 01 04 07
01 04 12	tailings and other wastes from washing and cleaning of minerals other than those mentioned in 01 04 07 and 01 04 11
01 04 13	wastes from stone cutting and sawing other than those mentioned in 01 04 07
<b>01 05</b>	<b>Drilling Muds and Other Drilling Wastes</b>
01 05 04	freshwater drilling muds and wastes
01 05 07	barite-containing drilling muds and wastes other than those mentioned in 01 05 05
01 05 08	chloride-containing drilling muds and wastes other than those mentioned in 01 05 05
<b>02</b>	<b>WASTES FROM AGRICULTURE, HORTICULTURE, AQUACULTURE, FORESTRY, HUNTING AND FISHING, FOOD PREPARATION AND PROCESSING</b>
<b>02 01</b>	<b>Wastes from Agriculture, Horticulture, Aquaculture, Forestry, Hunting and Fishing</b>
02 01 01	sludges from washing and cleaning
02 01 04	waste plastics (except packaging)
02 01 09	agrochemical waste other than those mentioned in 02 01 08
02 01 10	waste metal
<b>02 03</b>	<b>Wastes from Fruit, Vegetables, Cereals, Edible Oils, Cocoa, Coffee, Tea and Tobacco Preparation and Processing; Conserve Production; Yeast and Yeast Extract Production, Molasses Preparation and Fermentation</b>
02 03 01	sludges from washing, cleaning, peeling, centrifuging and separation
02 03 02	wastes from preserving agents
02 03 03	wastes from solvent extraction
02 03 04	materials unsuitable for consumption or processing
02 03 05	sludges from on-site effluent treatment
<b>02 04</b>	<b>Wastes from Sugar Processing</b>
02 04 01	soil from cleaning and washing beet
02 04 02	off-specification calcium carbonate
02 04 03	sludges from on-site effluent treatment
<b>02 05</b>	<b>Wastes from The Dairy Products Industry</b>
02 05 01	materials unsuitable for consumption or processing
02 05 02	sludges from on-site effluent treatment
<b>02 06</b>	<b>Wastes from The Baking and Confectionery Industry</b>
02 06 01	materials unsuitable for consumption or processing
02 06 02	wastes from preserving agents
02 06 03	sludges from on-site effluent treatment
<b>02 07</b>	<b>Wastes from The Production of Alcoholic and Non-Alcoholic Beverages (Except Coffee, Tea and Cocoa)</b>
02 07 01	wastes from washing, cleaning and mechanical reduction of raw materials
02 07 02	wastes from spirits distillation

**Table S2.4 Permitted waste types and quantities for Non-Hazardous Waste Transfer Station Operations**

Maximum quantity	Table S2.2, S2.3 and S2.4 combined total of 7500 tonnes per year
<b>Waste Code</b>	<b>Description</b>
02 07 03	wastes from chemical treatment
02 07 04	materials unsuitable for consumption or processing
02 07 05	sludges from on-site effluent treatment
<b>03</b>	<b>WASTES FROM WOOD PROCESSING AND THE PRODUCTION OF PANELS AND FURNITURE, PULP, PAPER AND CARDBOARD</b>
<b>03 01</b>	<b>Wastes from Wood Processing and The Production of Panels and Furniture</b>
03 01 05	sawdust, shavings, cuttings, wood, particle board and veneer other than those mentioned in
<b>03 02</b>	<b>Wastes from Wood Preservation</b>
03 02 99	wood preservatives not otherwise specified
<b>03 03</b>	<b>Wastes from Pulp, Paper and Cardboard Production and Processing</b>
03 03 02	green liquor sludge (from recovery of cooking liquor)
03 03 05	de-inking sludges from paper recycling
03 03 07	mechanically separated rejects from pulping of wastepaper and cardboard
03 03 08	wastes from sorting of paper and cardboard destined for recycling
03 03 09	lime mud waste
03 03 10	fibre rejects, fibre-, filler- and coating-sludges from mechanical separation
03 03 11	sludges from on-site effluent treatment other than those mentioned in 03 03 10
<b>04</b>	<b>WASTES FROM THE LEATHER, FUR AND TEXTILE INDUSTRIES</b>
<b>04 01</b>	<b>Wastes from The Leather and Fur Industry</b>
04 01 02	liming waste
04 01 04	tanning liquor containing chromium
04 01 05	tanning liquor free of chromium
04 01 06	sludges, in particular from on-site effluent treatment containing chromium
04 01 08	waste tanned leather (blue sheetings, shavings, cuttings, buffing dust) containing chromium
04 01 09	wastes from dressing and finishing
<b>04 02</b>	<b>Wastes from The Textile Industry</b>
04 02 09	wastes from composite materials (impregnated textile, elastomer, plastomer)
04 02 10	organic matter from natural products (for examples grease, wax)
04 02 15	wastes from finishing other than those mentioned in 04 02 14
04 02 17	dyesuffs and pigments other than those mentioned in 04 02 16
04 02 20	sludges from on-site effluent treatment other than those mentioned in 04 02 19
04 02 21	wastes from unprocessed textile fibres
04 02 22	wastes from processed textile fibres
<b>05</b>	<b>WASTES FROM PETROLEUM REFINING, NATURAL GAS PURIFICATION AND PYROLYTIC TREATMENT OF COAL</b>
<b>05 01</b>	<b>Wastes from Petroleum Refining</b>
05 01 10	sludges from on-site effluent treatment other than those mentioned in 05 01 09
05 01 13	boiler feedwater sludges
05 01 14	wastes from cooling columns
05 01 16	sulphur-containing wastes from petroleum desulphurisation
05 01 17	bitumen
<b>05 06</b>	<b>Wastes from The Pyrolytic Treatment of Coal</b>
05 06 04	waste from cooling columns
<b>05 07</b>	<b>Wastes from Natural Gas Purification and Transportation</b>



**Table S2.4 Permitted waste types and quantities for Non-Hazardous Waste Transfer Station Operations**

Maximum quantity	Table S2.2, S2.3 and S2.4 combined total of 7500 tonnes per year
Waste Code	Description
05 07 02	wastes containing sulphur
05 07 99	any wastes generated from natural gas purification and transportation that do not contain mercury or sulphur
<b>06</b>	<b>WASTES FROM INORGANIC CHEMICAL PROCESSES</b>
<b>06 01</b>	<b>Wastes from The Manufacture, Formulation, Supply and Use (MFSU) Of Acids</b>
06 01 99	waste from MFSU of acids not containing dangerous substances
<b>06 03</b>	<b>Wastes from The MFSU Of Salts and Their Solutions and Metallic Oxides</b>
06 03 14	solid salts and solutions other than those mentioned in 06 03 11 and 06 03 13
06 03 16	metallic oxides other than those mentioned in 06 03 15
<b>06 05</b>	<b>Sludges from On-Site Effluent Treatment</b>
06 05 03	sludges from on-site effluent treatment other than those mentioned in 06 05 02
<b>06 06</b>	<b>Wastes from The MFSU Of Sulphur Chemicals, Sulphur Chemical Processes and Desulphurisation Processes</b>
06 06 03	wastes containing sulphides other than those mentioned in 06 06 02
<b>06 09</b>	<b>Wastes from The MFSU Of Phosphorous Chemicals and Phosphorous Chemical Processes</b>
06 09 02	phosphorous slag
06 09 04	calcium-based reaction wastes other than those mentioned in 06 09 03
<b>06 11</b>	<b>Wastes from The Manufacture of Inorganic Pigments and Opacifiers</b>
06 11 01	calcium-based reaction wastes from titanium dioxide production
<b>06 13</b>	<b>Wastes from Inorganic Chemical Processes Not Otherwise Specified</b>
06 13 03	carbon black
<b>07</b>	<b>WASTES FROM ORGANIC CHEMICAL PROCESSES</b>
<b>07 01</b>	<b>Wastes from The Manufacture, Formulation, Supply and Use (MFSU) Of Basic Organic Chemicals</b>
07 01 12	sludges from on-site effluent treatment other than those mentioned in 07 01 11
<b>07 02</b>	<b>Wastes from The MFSU Of Plastics, Synthetic Rubber and Manmade Fibres</b>
07 02 12	sludges from on-site effluent treatment other than those mentioned in 07 02 11
07 02 15	wastes from additives other than those mentioned in 07 02 14
07 02 17	waste containing silicones other than those mentioned in 07 02 16
<b>07 03</b>	<b>Wastes from The MFSU Of Organic Dyes and Pigments (Except 06 11)</b>
07 03 12	sludges from on-site effluent treatment other than those mentioned in 07 03 11
<b>07 04</b>	<b>Wastes from The MFSU Of Organic Plant Protection Products (Except 02 01 08)</b>
07 04 12	sludges from on-site effluent treatment other than those mentioned in 07 04 11
<b>07 05</b>	<b>Wastes from The MFSU Of Pharmaceuticals</b>
07 05 12	sludges from on-site effluent treatment other than those mentioned in 07 05 11
07 05 14	solid wastes other than those mentioned in 07 05 13
<b>07 06</b>	<b>Wastes from The MFSU Of Fats, Grease, Soaps, Detergents, Disinfectants and Cosmetics</b>
07 06 12	sludges from on-site effluent treatment other than those mentioned in 07 06 11
<b>07 07</b>	<b>Wastes from The MFSU Of Fine Chemicals and Chemical Products Not Otherwise Specified</b>
07 07 12	sludges from on-site effluent treatment other than those mentioned in 07 07 11
<b>08</b>	<b>WASTES FROM THE MFSU OF COATINGS (PAINTS, VARNISHES AND VITREOUS ENAMELS), ADHESIVES, SEALANTS AND PRINTING INKS</b>
<b>08 01</b>	<b>Wastes from MFSU And Removal of Paint and Varnish</b>

**Table S2.4 Permitted waste types and quantities for Non-Hazardous Waste Transfer Station Operations**

Maximum quantity	Table S2.2, S2.3 and S2.4 combined total of 7500 tonnes per year
<b>Waste Code</b>	<b>Description</b>
08 01 12	waste paint and varnish other than those mentioned in 08 01 11
08 01 14	sludges from paint or varnish other than those mentioned in 08 01 13
08 01 16	aqueous sludges containing paint or varnish other than those mentioned in 08 01 15
08 01 18	wastes from paint or varnish removal other than those mentioned in 08 01 17
08 01 20	aqueous suspensions containing paint or varnish other than those mentioned in 08 01 19
<b>08 02</b>	<b>Wastes from MFSU Of Other Coatings (Including Ceramic Materials)</b>
08 02 01	waste coating powders
08 02 02	aqueous sludges containing ceramic materials
08 02 03	aqueous suspensions containing ceramic materials
<b>08 03</b>	<b>Wastes from MFSU Of Printing Inks</b>
08 03 07	aqueous sludges containing ink
08 03 08	aqueous liquid waste containing ink
08 03 13	waste ink other than those mentioned in 08 03 12
08 03 15	ink sludges other than those mentioned in 08 03 14
08 03 18	waste printing toner other than those mentioned in 08 03 17
<b>08 04</b>	<b>Wastes from MFSU Of Adhesives and Sealants (Including Waterproofing Products)</b>
08 04 10	waste adhesives and sealants other than those mentioned in 08 04 09
08 04 12	adhesive and sealant sludges other than those mentioned in 08 04 11
08 04 14	aqueous sludges containing adhesives or sealants other than those mentioned in 08 04 13
08 04 15	aqueous liquid waste containing adhesives or sealants containing organic solvents or other dangerous substances
08 04 16	aqueous liquid waste containing adhesives or sealants other than those mentioned in 08 04 15
<b>09</b>	<b>WASTES FROM THE PHOTOGRAPHIC INDUSTRY</b>
<b>09 01</b>	<b>Wastes from The Photographic Industry</b>
09 01 07	photographic film and paper containing silver or silver compounds
09 01 08	photographic film and paper free from of silver or silver compounds
09 01 10	single-use cameras without batteries
09 01 12	single-use cameras containing batteries other than those mentioned in 09 01 11
<b>10</b>	<b>WASTES FROM THERMAL PROCESSES</b>
<b>10 01</b>	<b>Wastes from Power Stations and Other Combustion Plants (Except 19)</b>
10 01 01	bottom ash, slag and boiler dust (excluding boiler dust mentioned in 10 01 04)
10 01 02	coal fly ash
10 01 03	fly ash from peat and untreated wood
10 01 05	calcium-based reaction wastes from flue-gas desulphurisation in solid form
10 01 07	calcium-based reaction wastes from flue-gas desulphurisation in sludge form
10 01 15	bottom ash, slag and boiler dust from co-incineration other than those mentioned in 10 01 14
10 01 17	fly ash from co-incineration other than those mentioned in 10 01 16
10 01 19	wastes from gas cleaning other than those mentioned in 10 01 05, 10 01 07 and 10 01 18
10 01 21	sludges from on-site effluent treatment other than those mentioned in 10 01 20
10 01 23	aqueous sludges from boiler cleansing other than those mentioned in 10 01 22
10 01 24	sands from fluidised beds

**Table S2.4 Permitted waste types and quantities for Non-Hazardous Waste Transfer Station Operations**

Maximum quantity	Table S2.2, S2.3 and S2.4 combined total of 7500 tonnes per year
<b>Waste Code</b>	<b>Description</b>
10 01 25	wastes from fuel storage and preparation of coal-fired power plants
10 01 26	wastes from cooling-water treatment
<b>10 02</b>	<b>Wastes from The Iron and Steel Industry</b>
10 02 01	wastes from the processing of slag
10 02 02	unprocessed slag
10 02 08	solid wastes from gas treatment other than those mentioned in 10 02 07
10 02 10	mill scales
10 02 12	wastes from cooling-water treatment other than those mentioned in 10 02 11
10 02 14	sludges and filter cakes from gas treatment other than those mentioned in 10 02 13
10 02 15	other sludges and filter cakes
<b>10 03</b>	<b>Wastes from Aluminium Thermal Metallurgy</b>
10 03 02	anode scraps
10 03 05	waste alumina
10 03 16	skimmings other than those mentioned in 10 03 15
10 03 18	carbon-containing wastes from anode manufacture other than those mentioned in 10 03 17
10 03 20	flue-gas dust other than those mentioned in 10 03 19
10 03 22	other particulates and dust (including ball-mill dust) other than those mentioned in 10 03 21
10 03 24	solid wastes from gas treatment other than those mentioned in 10 03 23
10 03 26	sludges and filter cakes from gas treatment other than those mentioned in 10 03 25
10 03 28	wastes from cooling-water treatment other than those mentioned in 10 03 27
10 03 30	wastes from treatment of salt slags and black drosses other than those mentioned in 10 03 29
<b>10 04</b>	<b>Wastes from Lead Thermal Metallurgy</b>
10 04 10	wastes from cooling-water treatment other than those mentioned in 10 04 09
<b>10 05</b>	<b>Wastes from Zinc Thermal Metallurgy</b>
10 05 01	slags from primary and secondary production
10 05 04	other particulates and dust
10 05 09	wastes from cooling-water treatment other than those mentioned in 10 05 08
10 05 10	dross and skimmings that are flammable or emit, upon contact with water, flammable gas in dangerous quantities
10 05 11	dross and skimmings other than those mentioned in 10 05 10
<b>10 06</b>	<b>Wastes from Copper Thermal Metallurgy</b>
10 06 01	slags from primary and secondary production
10 06 02	dross and skimmings from primary and secondary production
10 06 04	other particulates and dust
10 06 10	wastes from cooling-water treatment other than those mentioned in 10 06 09
<b>10 07</b>	<b>Wastes from Silver, Gold and Platinum Thermal Metallurgy</b>
10 07 01	slags from primary and secondary production
10 07 02	dross and skimmings from primary and secondary production
10 07 03	solid wastes from gas treatment
10 07 04	other particulates and dust
10 07 05	sludges and filter cakes from gas treatment
10 07 08	wastes from cooling-water treatment other than those mentioned in 10 07 07

**Table S2.4 Permitted waste types and quantities for Non-Hazardous Waste Transfer Station Operations**

Maximum quantity	Table S2.2, S2.3 and S2.4 combined total of 7500 tonnes per year
<b>Waste Code</b>	<b>Description</b>
<b>10 08</b>	<b>Wastes from Other Non-Ferrous Thermal Metallurgy</b>
10 08 04	particulates and dust
10 08 09	other slags
10 08 11	dross and skimmings other than those mentioned in 10 08 10
10 08 13	tar-containing wastes from anode manufacture other than those mentioned in 10 08 12
10 08 14	anode scrap
10 08 16	flue-gas dust other than those mentioned in 10 08 15
10 08 18	sludges and filter cakes from flue-gas treatment other than those mentioned in 10 08 17
10 08 20	wastes from cooling-water treatment other than those mentioned in 10 08 19
<b>10 09</b>	<b>Wastes from Casting of Ferrous Pieces</b>
10 09 03	furnace slag
10 09 06	casting cores and moulds which have not undergone pouring other than those mentioned in 10 09 05
10 09 08	casting cores and moulds which have undergone pouring other than those mentioned in 10 09 07
10 09 10	flue-gas dust other than those mentioned in 10 09 09
10 09 12	other particulates other than those mentioned in 10 09 11
10 09 14	waste binders other than those mentioned in 10 09 13
10 09 16	waste crack-indicating agent other than those mentioned in 10 09 15
<b>10 10</b>	<b>Wastes from Casting of Non-Ferrous Pieces</b>
10 10 03	furnace slag
10 10 06	casting cores and moulds which have not undergone pouring other than those mentioned in 10 10 05
10 10 08	casting cores and moulds which have undergone pouring other than those mentioned in 10 10 07
10 10 10	flue-gas dust other than those mentioned in 10 10 09
10 10 12	other particulates other than those mentioned in 10 10 11
10 10 14	waste binders other than those mentioned in 10 10 13
10 10 16	waste crack-indicating agent other than those mentioned in 10 10 15
<b>10 11</b>	<b>Wastes from Manufacture of Glass and Glass Products</b>
10 11 03	waste glass-based fibrous materials
10 11 05	particulates and dust
10 11 10	waste preparation mixture before thermal processing, other than those mentioned in 10 11 09
10 11 12	waste-glass other than those mentioned in 10 11 11
10 11 14	glass-polishing and -grinding sludge other than those mentioned in 10 11 13
10 11 16	solid wastes from flue-gas treatment other than those mentioned in 10 11 15
10 11 18	sludges and filter cakes from flue-gas treatment other than those mentioned in 10 11 17
10 11 20	solid wastes from on-site effluent treatment other than those mentioned in 10 11 19
<b>10 12</b>	<b>Wastes from Manufacture of Ceramic Goods, Bricks, Tiles and Construction Products</b>
10 12 01	waste preparation mixture before thermal processing
10 12 03	particulates and dust
10 12 05	sludges and filter cakes from gas treatment

**Table S2.4 Permitted waste types and quantities for Non-Hazardous Waste Transfer Station Operations**

Maximum quantity	Table S2.2, S2.3 and S2.4 combined total of 7500 tonnes per year
<b>Waste Code</b>	<b>Description</b>
10 12 06	discarded moulds
10 12 08	waste ceramics, bricks, tiles and construction products (after thermal processing)
10 12 10	solid wastes from gas treatment other than those mentioned in 10 12 09
10 12 12	wastes from glazing other than those mentioned in 10 12 11
10 12 13	sludges from on-site effluent treatment
<b>10 13</b>	<b>Wastes from Manufacture of Cement, Lime, Plaster and Articles and Products Made from Them</b>
10 13 01	waste preparation mixture before thermal processing
10 13 04	wastes from calcinations and hydration of lime
10 13 06	particulates and dust (except 10 13 12 and 10 13 13)
10 13 07	sludges and filter cakes from gas treatment
10 13 10	wastes from asbestos-cement manufacture other than those mentioned in 10 13 09
10 13 11	wastes from cement-based composite materials other than those mentioned in 10 13 09 and 10 13 10
10 13 13	solid wastes from gas treatment other than those mentioned in 10 13 12
10 13 14	waste concrete and concrete sludge
<b>11</b>	<b>WASTES FROM CHEMICAL SURFACE TREATMENT AND COATING OF METALS AND OTHER MATERIALS; NON-FERROUS HYDROMETALLURGY</b>
<b>11 01</b>	<b>Wastes from Chemical Surface Treatment and Coating of Metals and Other Materials (For Example Galvanic Processes, Zinc Coating Processes, Pickling Processes, Etching, Phosphating, Alkaline Degreasing, Anodising)</b>
11 01 10	sludges and filter cakes other than those mentioned in 11 01 09
11 01 12	aqueous rinsing liquids other than those mentioned in 11 01 11
11 01 14	degreasing wastes other than those mentioned in 11 01 13
<b>11 02</b>	<b>Wastes from Non-Ferrous Hydrometallurgical Processes</b>
11 02 03	wastes from the production of anodes for aqueous electrolytical processes
11 02 06	wastes from copper hydrometallurgical; processes other than those mentioned in 11 02 05
<b>11 05</b>	<b>Wastes from Hot Galvanising Processes</b>
11 05 01	hard zinc
11 05 02	zinc ash
<b>12</b>	<b>WASTES FROM SHAPING AND PHYSICAL AND MECHANICAL SURFACE TREATMENT OF METALS AND PLASTICS</b>
<b>12 01</b>	<b>Wastes from Shaping and Physical and Mechanical Surface Treatment of Metals and Plastics</b>
12 01 01	ferrous metal filings and turnings
12 01 02	ferrous metal dust and particles
12 01 03	non-ferrous metal filings and turnings
12 01 04	non-ferrous metal dust and particles
12 01 05	plastics shavings and turnings
12 01 13	welding wastes
12 01 15	machining sludges other than those mentioned in 12 01 14
12 01 17	waste blasting material other than those mentioned in 12 01 16
12 01 21	spent grinding bodies and grinding materials other than those mentioned in 12 01 20
<b>14</b>	<b>ORGANIC SOLVENTS, REFRIGERANTS AND PROPELLANTS (EXCEPT 7 AND 8)</b>

**Table S2.4 Permitted waste types and quantities for Non-Hazardous Waste Transfer Station Operations**

Maximum quantity	Table S2.2, S2.3 and S2.4 combined total of 7500 tonnes per year
Waste Code	Description
<b>14 06</b>	<b>Waste Organic Solvents, Refrigerants and Foam/Aerosol Propellants</b>
14 06 05	sludges or solid wastes containing other solvents
<b>15</b>	<b>PACKAGING; ABSORBENTS, WIPING CLOTHS, FILTER MATERIALS AND PROTECTIVE CLOTHING NOT OTHERWISE</b>
<b>15 01</b>	<b>Packaging (Including Separately Collected Municipal Packaging Waste)</b>
15 01 01	paper and cardboard packaging
15 01 02	plastic packaging
15 01 03	wooden packaging
15 01 04	metallic packaging
15 01 05	composite packaging
15 01 06	mixed packaging
15 01 07	glass packaging
15 01 09	textile packaging
<b>15 02</b>	<b>Absorbents, Filter Materials, Wiping Cloths and Protective Clothing</b>
15 02 03	absorbents, filter materials, wiping cloths and protective clothing other than those mentioned in 15 02 02
<b>16</b>	<b>WASTES NOT OTHERWISE SPECIFIED IN THE LIST</b>
<b>16 01</b>	<b>End of Life Vehicles from Different Means of Transport (Including Off-Road Machinery) And Wastes From Dismantling of End Life Vehicles and Vehicle Maintenance (Except 13, 14, 16 06 And 16 08)</b>
16 01 03	end-of-life tyres
16 01 12	brake pads other than those mentioned in 16 01 11
16 01 15	antifreeze fluids other than those mentioned in 16 01 14
16 01 16	tanks for liquefied gas
16 01 17	ferrous metal
16 01 18	non-ferrous metal
16 01 19	plastic
16 01 20	glass
16 01 22	components not otherwise specified
<b>16 02</b>	<b>Wastes from Electrical and Electronic Equipment</b>
16 02 14	discarded equipment other than those mentioned in 16 02 09 to 16 02 13
16 02 16	components removed from discarded equipment other than those mentioned in 16 02 15
<b>16 03</b>	<b>Off-Specification Batches and Unused Products</b>
16 03 04	inorganic wastes other than those mentioned in 16 03 03
16 03 06	organic wastes other than those mentioned in 16 03 05
<b>16 05</b>	<b>Gases in Pressure Containers and Discarded Chemicals</b>
16 05 05	gases in pressure containers other than those mentioned in 16 05 04
16 05 06	laboratory chemicals, consisting of or containing dangerous substances, including mixtures of laboratory chemicals
16 05 09	discarded chemicals other than those mentioned in 16 05 06, 16 05 07 or 16 05 08
<b>16 06</b>	<b>Batteries and Accumulators</b>
16 06 04	alkaline batteries (except 16 06 03)
16 06 05	other batteries and accumulators

**Table S2.4 Permitted waste types and quantities for Non-Hazardous Waste Transfer Station Operations**

Maximum quantity	Table S2.2, S2.3 and S2.4 combined total of 7500 tonnes per year
Waste Code	Description
<b>16 07</b>	<b>Wastes from Transport Tank, Storage Tank and Barrel Cleaning (Except 05 And 13)</b>
16 07 99	wastes not otherwise specified
<b>16 08</b>	<b>Spent Catalysts</b>
16 08 01	spent catalysts containing gold, silver, rhenium, rhodium, palladium, iridium or platinum (except 16 08 07)
16 08 03	spent catalysts containing metals or transition metal compounds not otherwise specified
16 08 04	spent fluid catalytic cracking catalysts (except 16 08 07)
<b>16 10</b>	<b>Aqueous Liquid Wastes Destined for Off-Site Treatment</b>
16 10 02	aqueous liquid wastes other than those mentioned in 16 10 01
16 10 04	aqueous concentrates other than those mentioned in 16 10 03
<b>16 11</b>	<b>Waste Linings and Refractories</b>
16 11 02	carbon-based linings and refractories from metallurgical processes other than those mentioned in 16 11 01
16 11 04	other linings and refractories from metallurgical processes other than those mentioned in 16 11 03
16 11 06	linings and refractories from non-metallurgical processes other than those mentioned in 16 11 05
<b>17</b>	<b>CONSTRUCTION AND DEMOLITION WASTES (INCLUDING EXCAVATED SOIL FROM CONTAMINATED SITES)</b>
<b>17 01</b>	<b>Concrete, Bricks, Tiles and Ceramics</b>
17 01 01	concrete
17 01 02	bricks
17 01 03	tiles and ceramics
17 01 07	mixtures of concrete, bricks, tiles and ceramics other than those mentioned in 17 01 06
<b>17 02</b>	<b>Wood, Glass and Plastic</b>
17 02 01	wood
17 02 02	glass
17 02 03	plastic
<b>17 03</b>	<b>Bituminous Mixtures, Coal Tar and Tarred Products</b>
17 03 02	bituminous mixtures other than those mentioned in 17 03 01 permitted
<b>17 04</b>	<b>Metals (Including Their Alloys)</b>
17 04 01	copper, bronze, brass
17 04 02	aluminium
17 04 03	lead
17 04 04	zinc
17 04 05	iron and steel
17 04 06	tin
17 04 07	mixed metals
17 04 11	cables other than those mentioned in 17 04 10
<b>17 05</b>	<b>Soil (Including Excavated Soil from Contaminated Sites), Stones and Dredging Spoil</b>
17 05 04	soil and stones other than those mentioned in 17 05 03
17 05 06	dredging spoil other than those mentioned in 17 05 05
17 05 08	track ballast other than those mentioned in 17 05 07
<b>17 06</b>	<b>Insulation Materials and Asbestos-Containing Construction Materials</b>

**Table S2.4 Permitted waste types and quantities for Non-Hazardous Waste Transfer Station Operations**

Maximum quantity	Table S2.2, S2.3 and S2.4 combined total of 7500 tonnes per year
Waste Code	Description
17 06 04	insulation materials other than those mentioned in 17 06 01 and 17 06 03
<b>17 08</b>	<b>Gypsum-Based Construction Material</b>
17 08 02	gypsum-based construction materials other than those mentioned in 17 08 01
<b>17 09</b>	<b>Other Construction and Demolition Wastes</b>
17 09 04	mixed construction and demolition waste other than those mentioned in 17 09 01, 17 09 02 and 17 09 03
<b>18</b>	<b>WASTES FROM HUMAN OR ANIMAL HEALTH CARE AND/OR RELATED RESEARCH (EXCEPT KITCHEN AND RESTAURANT WASTES NOT ARISING FROM IMMEDIATE HEALTH CARE)</b>
<b>18 01</b>	<b>Wastes from Natal Care, Diagnosis, Treatment or Prevention of Disease in Humans</b>
18 01 01	sharps (except 18 01 03)
18 01 04	wastes whose collection and disposal is subject to special requirements in order to prevent infection (for example dressings, plaster cases, linen, disposable clothing, diapers)
18 01 07	chemicals other than those mentioned in 18 01 06
18 01 09	medicines other than those mentioned in 18 01 08
<b>18 02</b>	<b>Wastes from Research, Diagnosis, Treatment or Prevention of Disease Involving Animals</b>
18 02 01	sharps (except 18 02 02)
18 02 03	Wastes whose collection and disposal is not subject to special requirements in order to prevent infection
18 02 06	chemicals other than those mentioned in 18 02 05
18 02 08	medicines other than those mentioned in 18 01 07
<b>19</b>	<b>WASTES FROM WASTE MANAGEMENT FACILITIES, OFF-SITE WASTEWATER TREATMENT PLANTS AND THE PREPARATION OF WATER INTENDED FOR HUMAN CONSUMPTION AND WATER FOR INDUSTRIAL USE</b>
<b>19 01</b>	<b>Wastes from Incineration or Pyrolysis of Waste</b>
19 01 02	ferrous materials removed from bottom ash
19 01 12	bottom ash and slag other than those mentioned in 19 01 11
19 01 14	fly ash other than those mentioned in 19 01 13
19 01 16	boiler dust other than those mentioned in 19 01 15
19 01 18	pyrolysis wastes other than those mentioned in 19 01 17
19 01 19	sands from fluidised beds
<b>19 02</b>	<b>Wastes from Physio/Chemical Treatments of Waste (Including Dechromatation, Decyanidation, Neutralisation)</b>
19 02 03	premixed wastes composed only of non-hazardous wastes
19 02 06	sludges from physio/chemical treatment other than those mentioned in 19 02 05
19 02 10	combustible wastes other than those mentioned in 19 02 08 and 19 02 09
<b>19 03</b>	<b>Stabilised/Solidified Wastes</b>
19 03 05	stabilised wastes other than those mentioned in 19 03 04
19 03 07	solidified wastes other than those mentioned in 19 03 06
<b>19 04</b>	<b>Vitrified Waste and Wastes from Vitrification</b>
19 04 01	vitrified waste
19 04 04	aqueous liquid wastes from vitrified waste tempering
<b>19 05</b>	<b>Wastes from Aerobic Treatment of Solid Wastes</b>
19 05 03	off-specification compost



**Table S2.4 Permitted waste types and quantities for Non-Hazardous Waste Transfer Station Operations**

Maximum quantity	Table S2.2, S2.3 and S2.4 combined total of 7500 tonnes per year
<b>Waste Code</b>	<b>Description</b>
<b>19 07</b>	<b>Landfill Leachate</b>
19 07 03	landfill leachate other than those mentioned in 19 07 02
<b>19 08</b>	<b>Wastes from Wastewater Treatment Plants Not Otherwise Specified</b>
19 08 01	screenings
19 08 02	waste from desanding
19 08 05	sludges from treatment of urban wastewater
19 08 09	grease and oil mixture from oil/water separation containing edible oil and fats
19 08 12	sludges from biological treatment of industrial wastewater other than those mentioned in 19 08 11
19 08 14	sludges from other treatment of industrial wastewater other than those mentioned in 19 08 13
<b>19 09</b>	<b>Wastes from The Preparation of Water Intended for Human Consumption or Water for Industrial Use</b>
19 09 01	solid waste from primary filtration and screenings
19 09 02	sludges from water clarification
19 09 03	sludges from decarbonation
19 09 04	spent activated carbon
19 09 05	saturated or spent ion exchange resins
19 09 06	solutions and sludges from regeneration of ion exchangers
<b>19 10</b>	<b>Wastes from Shredding of Metal-Containing Wastes</b>
19 10 01	iron and steel waste
19 10 02	non-ferrous waste
19 10 04	fluff-light fraction and dust other than those mentioned in 19 10 03
19 10 06	other fractions other than those mentioned in 19 10 05
<b>19 11</b>	<b>Wastes from Oil Regeneration</b>
19 11 06	sludges from on-site effluent treatment other than those mentioned in 19 11 05
<b>19 12</b>	<b>Steps from The Mechanical Treatment of Waste (For Examples Sorting, Crushing, Compacting, Palletising) Not Otherwise Specified</b>
19 12 01	paper and cardboard
19 12 02	ferrous metal
19 12 03	non-ferrous metal
19 12 04	plastic and rubber
19 12 05	glass
19 12 07	wood other than that mentioned in 19 12 06
19 12 08	textiles
19 12 09	minerals (for example sand, stones)
19 12 10	combustible waste (refuse derived fuel)
19 12 11	other wastes (including mixtures of materials) from mechanical treatment of waste containing dangerous substances
19 12 12	other wastes (including mixtures of materials) from mechanical treatment of wastes other than those mentioned in 19 12 11
<b>19 13</b>	<b>Wastes from Soil and Groundwater Remediation</b>
19 13 02	solid wastes from soil remediation other than those mentioned in 19 13 01
19 13 04	sludges from soil remediation other than those mentioned in 19 13 03
19 13 06	sludges from groundwater remediation other than those mentioned in 19 13 05
19 13 07	aqueous liquid wastes and aqueous concentrates from groundwater remediation containing dangerous substances

**Table S2.4 Permitted waste types and quantities for Non-Hazardous Waste Transfer Station Operations**

Maximum quantity	Table S2.2, S2.3 and S2.4 combined total of 7500 tonnes per year
Waste Code	Description
19 13 08	aqueous liquid wastes and aqueous concentrates from groundwater remediation other than those mentioned in 19 13 07
<b>20</b>	<b>MUNICIPAL WASTES (HOUSEHOLD WASTE AND SIMILAR COMMERCIAL, INDUSTRIAL AND INSTITUTIONAL WASTES) INCLUDING SEPARATELY COLLECTED FRACTIONS</b>
<b>20 01</b>	<b>Separately Collected Fractions (Except 15 01)</b>
20 01 01	paper and cardboard
20 01 02	Glass
20 01 10	Clothes
20 01 11	Textiles
20 01 25	edible oil and fat
20 01 28	paint, inks, adhesives and resins other than those mentioned in 20 01 27
20 01 30	detergents other than those mentioned in 20 01 29
20 01 32	medicines other than those mentioned in 20 01 31
20 01 34	batteries and accumulators other than those mentioned in 20 01 33
20 01 36	discarded electrical and electronic equipment other than those mentioned in 20 01 21, 20 01 23 and 20 01 35
20 01 38	wood other than that mentioned in 20 01 37
20 01 39	Plastics
20 01 40	Metals
20 01 41	wastes from chimney sweeping
20 01 99	non-infectious healthcare wastes
<b>20 02</b>	<b>Garden and Park Wastes (Including Cemetery Waste)</b>
20 02 02	soil and stones
20 02 03	other non-biodegradable wastes
<b>20 03</b>	<b>Other Municipal Wastes</b>
20 03 01	mixed municipal waste
20 03 02	waste from markets
20 03 03	street-cleaning residues
20 03 04	septic tank sludge
20 03 06	waste from sewage cleaning
20 03 07	bulky waste

## Schedule 3 – Emissions and monitoring

**Table S3.1 Point source emissions to surface water sewer– emission limits and monitoring requirements**

Emission point ref. & location	Source	Parameter	Limit (incl. Unit)	Reference period	Monitoring frequency	Monitoring standard or method
SW7 [Point SW7 on drawing reference BF5023/09/04 (Rev 3)] emission to Surface water sewer	Uncontaminated Surface Water	No parameters set	-	-	-	-

## Schedule 4 - Reporting

Parameters, for which reports shall be made, in accordance with conditions of this permit, are listed below.

<b>Table S4.1 Reporting of monitoring data</b>			
<b>Parameter</b>	<b>Emission or monitoring point/reference</b>	<b>Reporting period</b>	<b>Period begins</b>
-	-	-	-

<b>Table S4.2: Annual production/treatment</b>	
<b>Parameter</b>	<b>Units</b>
Hazardous Waste Treatment	tonnes
Non-Hazardous Waste Treatment	tonnes

<b>Table S4.3 Performance parameters</b>		
<b>Parameter</b>	<b>Frequency of assessment</b>	<b>Units</b>
Water usage	Annually	tonnes
Energy usage	Annually	MWh

<b>Table S4.4 Reporting forms</b>		
<b>Media/parameter</b>	<b>Reporting format</b>	<b>Date of form</b>
Water usage	Form water usage 1 or other form as agreed in writing by Natural Resources Wales	29/12/2021
Energy usage	Form energy 1 or other form as agreed in writing by Natural Resources Wales	29/12/2021
Other performance indicators	Form performance 1 or other form as agreed in writing by Natural Resources Wales	29/12/2021
Waste Subject to Condition 4.2.5	Waste tonnage return form from Natural Resources Wales website or other form as agreed in writing by Natural Resources Wales	29/12/2021

## Schedule 5 - Notification

These pages outline the information that the operator must provide.

Units of measurement used in information supplied under Part A and B requirements shall be appropriate to the circumstances of the emission. Where appropriate, a comparison should be made of actual emissions and authorised emission limits.

If any information is considered commercially confidential, it should be separated from non-confidential information, supplied on a separate sheet and accompanied by an application for commercial confidentiality under the provisions of the EP Regulations.

### Part A

Permit Number	<b>EPR/CB3394CM</b>
Name of operator	<b>Biffa Waste Services Limited</b>
Location of Facility	<b>Cardiff Waste Management Resource Centre, Waterside Business Park, Lamby Way, Rumney, Cardiff, CF3 2EQ</b>
Time and date of the detection	

<b>(a) Notification requirements for any activity that gives rise to an incident or accident which significantly affects or may significantly affect the environment</b>	
<b>To be notified within 24 hours of detection</b>	
Date and time of the event	
Reference or description of the location of the event	
Description of where any release into the environment took place	
Substances(s) potentially released	
Best estimate of the quantity or rate of release of substances	
Measures taken, or intended to be taken, to stop any emission	
Description of the failure or accident.	

<b>(b) Notification requirements for the breach of a permit condition</b>	
<b>To be notified within 24 hours of detection</b>	
Emission point reference/ source	
Parameter(s)	
Limit	
Measured value and uncertainty	
Date and time of monitoring	
Measures taken, or intended to be taken, to stop the emission	

Time periods for notification following detection of a breach of a limit	
Parameter	Notification period
All, unless separately agreed in writing with Natural Resources Wales	Within 24 hours of detection unless otherwise specified

<b>(c) In the event of a breach of permit condition which poses an immediate danger to human health or threatens to cause an immediate significant adverse effect on the environment:</b>	
<b>To be notified within 24 hours of detection</b>	
Description of where the effect on the environment was detected	
Substances(s) detected	
Concentrations of substances detected	
Date of monitoring/sampling	

## Part B - to be submitted as soon as practicable

Any more accurate information on the matters for notification under Part A.	
Measures taken, or intended to be taken, to prevent a recurrence of the incident	
Measures taken, or intended to be taken, to rectify, limit or prevent any pollution of the environment which has been or may be caused by the emission	
The dates of any unauthorised emissions from the facility in the preceding 24 months.	

<b>Name*</b>	
<b>Post</b>	
<b>Signature</b>	
<b>Date</b>	

\* authorised to sign on behalf of the operator

## Schedule 6 - Interpretation

*“accident”* means an accident that may result in pollution.

*“Annex I”* means Annex I to Directive 2008/98/EC of the European Parliament and of the Council on waste.

*“Annex II”* means Annex II to Directive 2008/98/EC of the European Parliament and of the Council on waste.

*“application”* means the application for this permit, together with any additional information supplied by the operator as part of the application and any response to a notice served under Schedule 5 to the EP Regulations.

*“authorised officer”* means any person authorised by Natural Resources Wales under section 108(1) of The Environment Act 1995 to exercise, in accordance with the terms of any such authorisation, any power specified in section 108(4) of that Act.

*“building”* means a construction that has the objective of providing sheltering cover and minimising emissions of noise, particulate matter, odour and litter.

*“disposal” or “D”* means any of the operations provided for in Annex I to Directive 2008/98/EC of the European Parliament and of the Council on waste.

*“emissions to land”* includes emissions to groundwater.

*“EP Regulations”* means The Environmental Permitting (England and Wales) Regulations SI 2016 No.1154 and words and expressions used in this permit which are also used in the Regulations have the same meanings as in those Regulations.

*“emissions of substances not controlled by emission limits”* means emissions of substances to air, water or land from the activities, either from the emission points specified in schedule 3 or from other localised or diffuse sources, which are not controlled by an emission limit..

*“groundwater”* means all water, which is below the surface of the ground in the saturation zone and in direct contact with the ground or subsoil.

*“hazardous property”* has the meaning in Annex III of the Waste Framework Directive

*“hazardous waste”* has the meaning given in the Hazardous Waste (Wales) Regulations 2005 (as amended)

*“hazardous substance”* means a substance classified as hazardous as a consequence of fulfilling the criteria laid down in parts 2 to 5 of Annex I to Regulation (EC) No 1272/2008

*“Industrial Emissions Directive”* means DIRECTIVE 2010/75/EU OF THE EUROPEAN PARLIAMENT AND OF THE COUNCIL of 24 November 2010 on industrial emissions

*“Pests”* means Birds, Vermin and Insects.

*“quarter”* means a calendar year quarter commencing on 1 January, 1 April, 1 July or 1 October.

*“recovery” or “R”* means any of the operations provided for in Annex II to Directive 2008/98/EC of the European Parliament and of the Council on waste.

*“Waste code”* means the six digit code referable to a type of waste in accordance with the list of wastes established by Commission Decision 2000/532/EC as amended from time to time (the ‘List of Wastes Decision’) and in relation to hazardous waste, includes the asterisk.

*“Waste Framework Directive”* or *“WFD”* means Waste Framework Directive 2008/98/EC of the European Parliament and of the Council on waste

*“year”* means calendar year ending 31 December

.



# Schedule 7 - Site plan

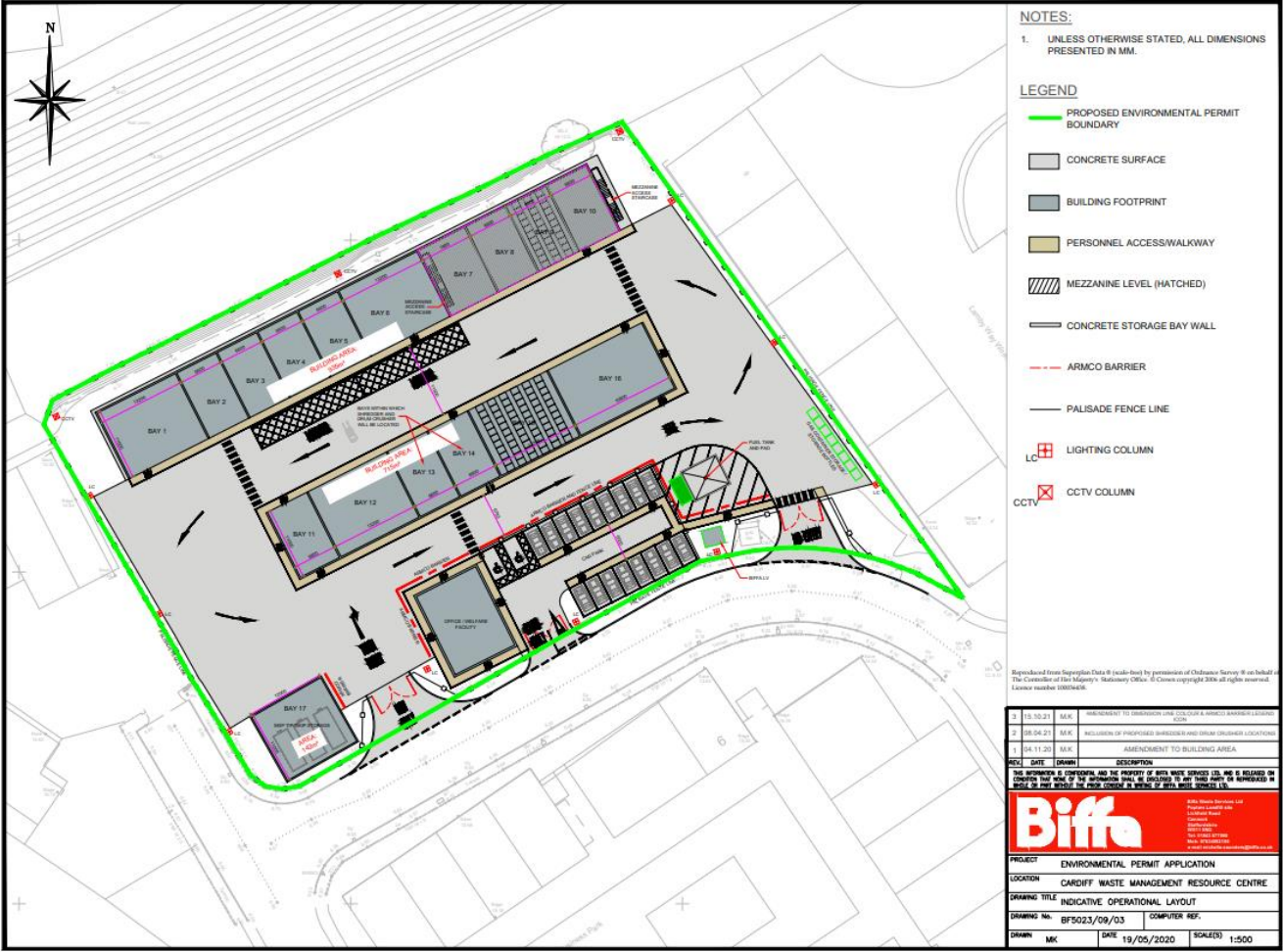

© Crown Copyright and database right 2021. Ordnance Survey licence number 100019741.

END OF PERMIT