

DETAIL 1 - ROAD CROSSING

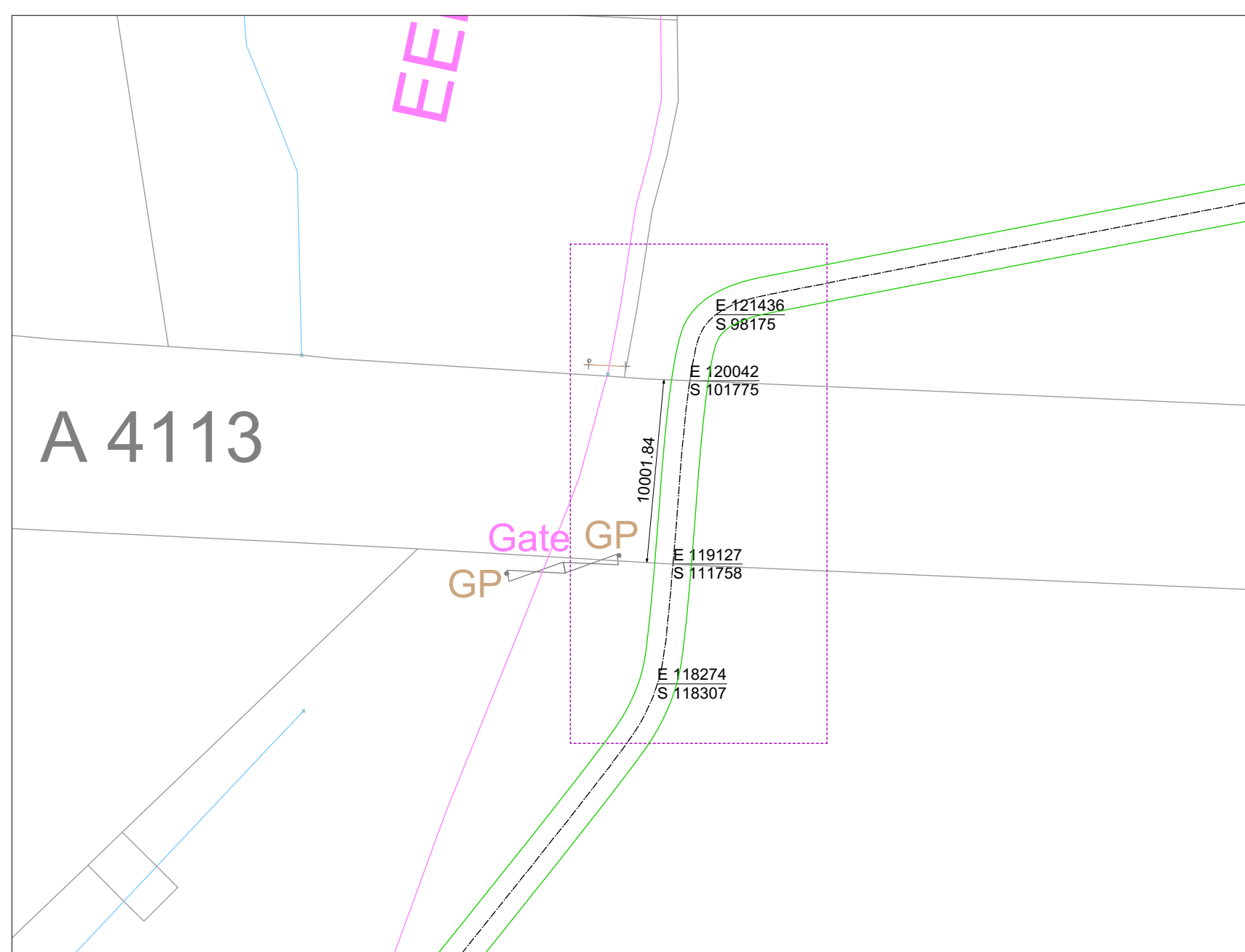

DETAIL 2 - UPHILL SECTION

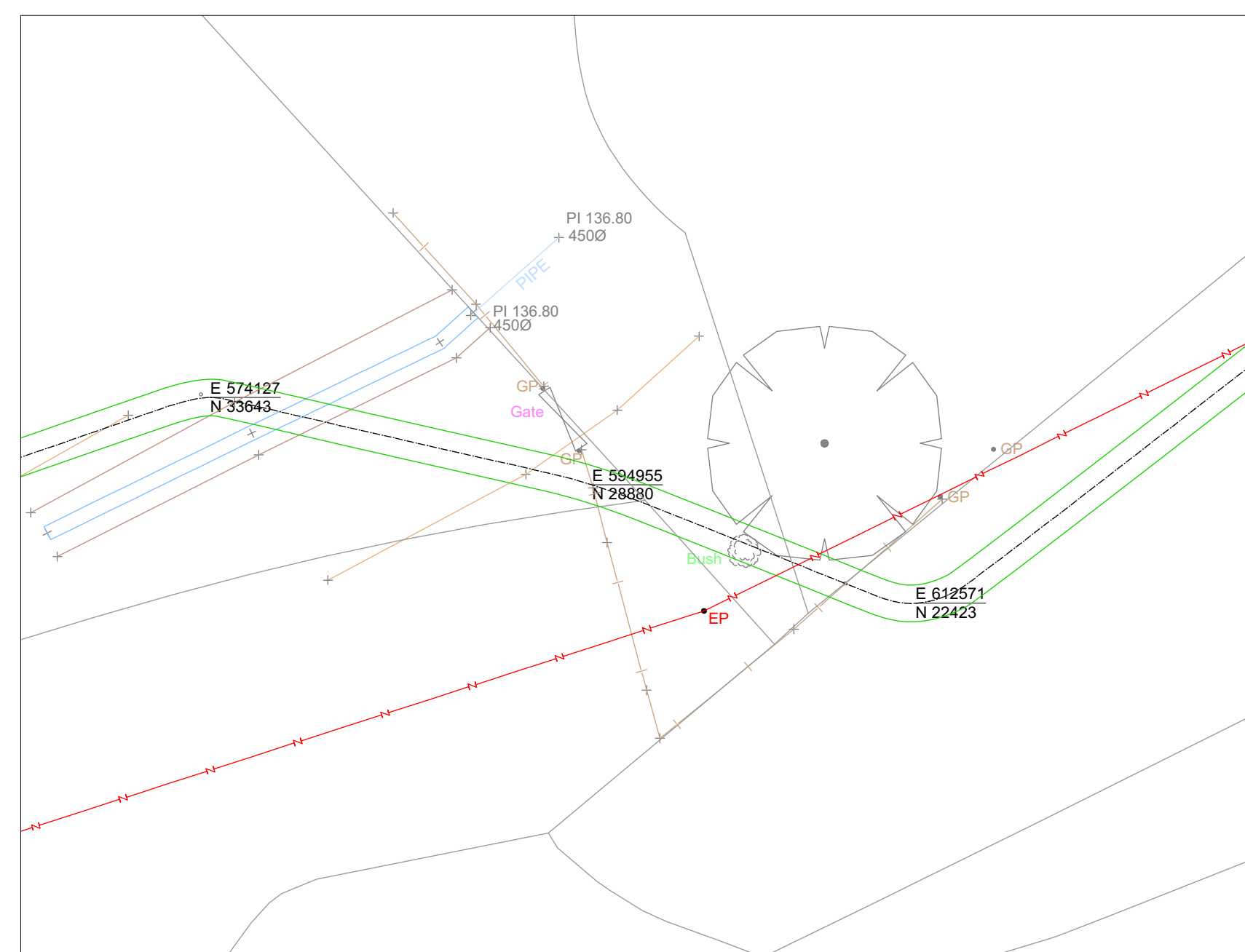

DETAIL 3 - OUTFALL INTO RIVER TEME

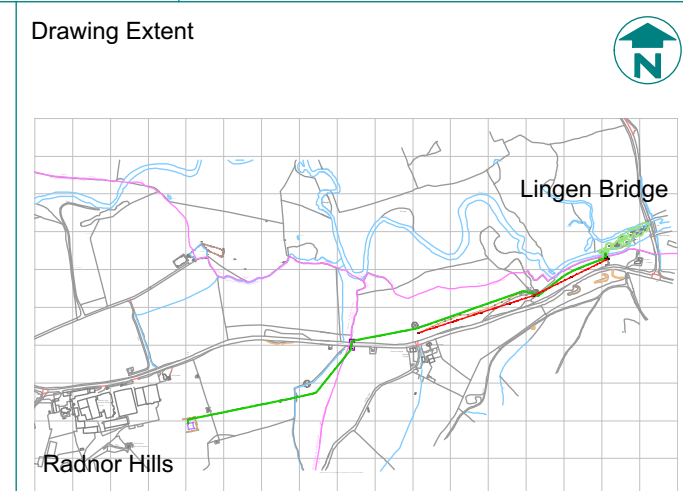
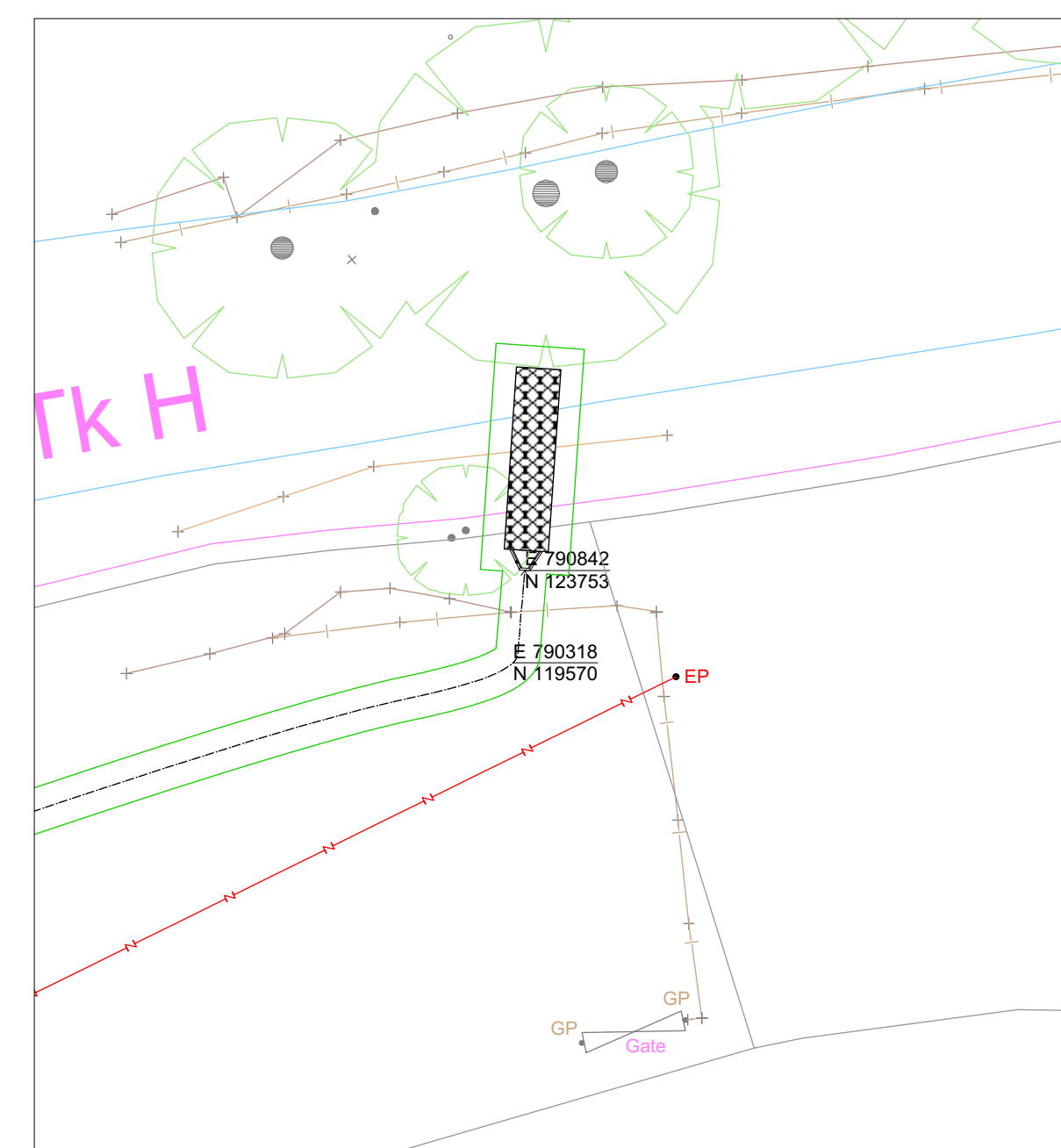

Key

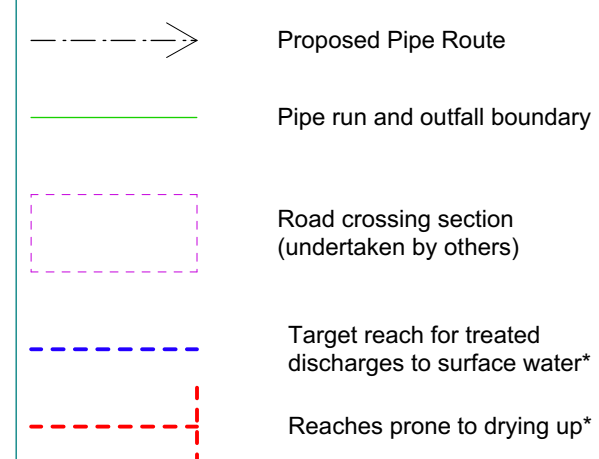

*Taken for RUKHydro Report

General Notes

1. Do not scale drawings. Dimensions govern.
2. All dimensions shall be verified on site before proceeding with the work.
3. WWT Consulting is to be notified in writing of any discrepancies.
4. Drawings to be read in conjunction with the relevant specification documents.
5. To be read in conjunction with the following drawings:

RAD02-4-100-5-001 Process Effluent Pipe Run Construction Details

Revision	Date	Description
----------	------	-------------

Consultant
WILDFOWL & WETLANDS TRUST
SLIMBRIDGE
GLOUCESTERSHIRE GL2 7BT
www.wwtconsulting.co.uk



Client
RADNOR HILLS MINERAL WATER COMPANY Ltd
HEARTSEASE
KNIGHTON
POWYS



Sustainability Consultant SUSTAINABLE DIRECTION Ltd

sustainable direction
thinking of the future

Hydrology Consultant	RUKHYDRO LIMITED
6 Claremont Buildings Claremont Bank Shrewsbury	

Survey Engineer
INVAR MAPPING SURVEYS
1 STIPERSTONES,
MINSTERLEY, SHREWSBURY,
SHROPSHIRE, SY5 0LZ



Project Title
EFFLUENT PROCESSING SOLUTIONS

Drawing Title
PROCESS EFFLUENT PIPE RUN GENERAL
ARRANGEMENT PLAN

Date 23/03/17	Drawn DN	Checked MS	Scale 1:2000 @ A1
Project ref. RAD02	Stage [4] TECHNICAL DESIGN		Scale 1:4000 @ A3
Drawing No. RAD02-4-100-1-001			Revision