



NOTE

1. DO NOT SCALE FROM THIS DRAWING. WORK FROM FIGURED DIMENSIONS ONLY. ALL DIMENSIONS ARE IN MILLIMETRES AND ALL LEVELS ARE IN METRES ABOVE ORDNANCE DATUM U.N.O.
2. NO DEVIATION FROM THE DETAILS SHOWN ON THIS DRAWING WILL BE PERMITTED WITHOUT PRIOR WRITTEN AGREEMENT.
3. THIS DRAWING IS TO BE READ IN CONJUNCTION WITH ALL RELEVANT ARCHITECTS, ENGINEERS AND SPECIALIST DRAWINGS AND SPECIFICATIONS.

LEGEND

- SITE ACCESS
- HAUL TRACK
- PERIMETER TRACK
- SITE BOUNDARY
- COMPOSTING SLAB
- WESTERN CATCHMENT
- EASTERN CATCHMENT

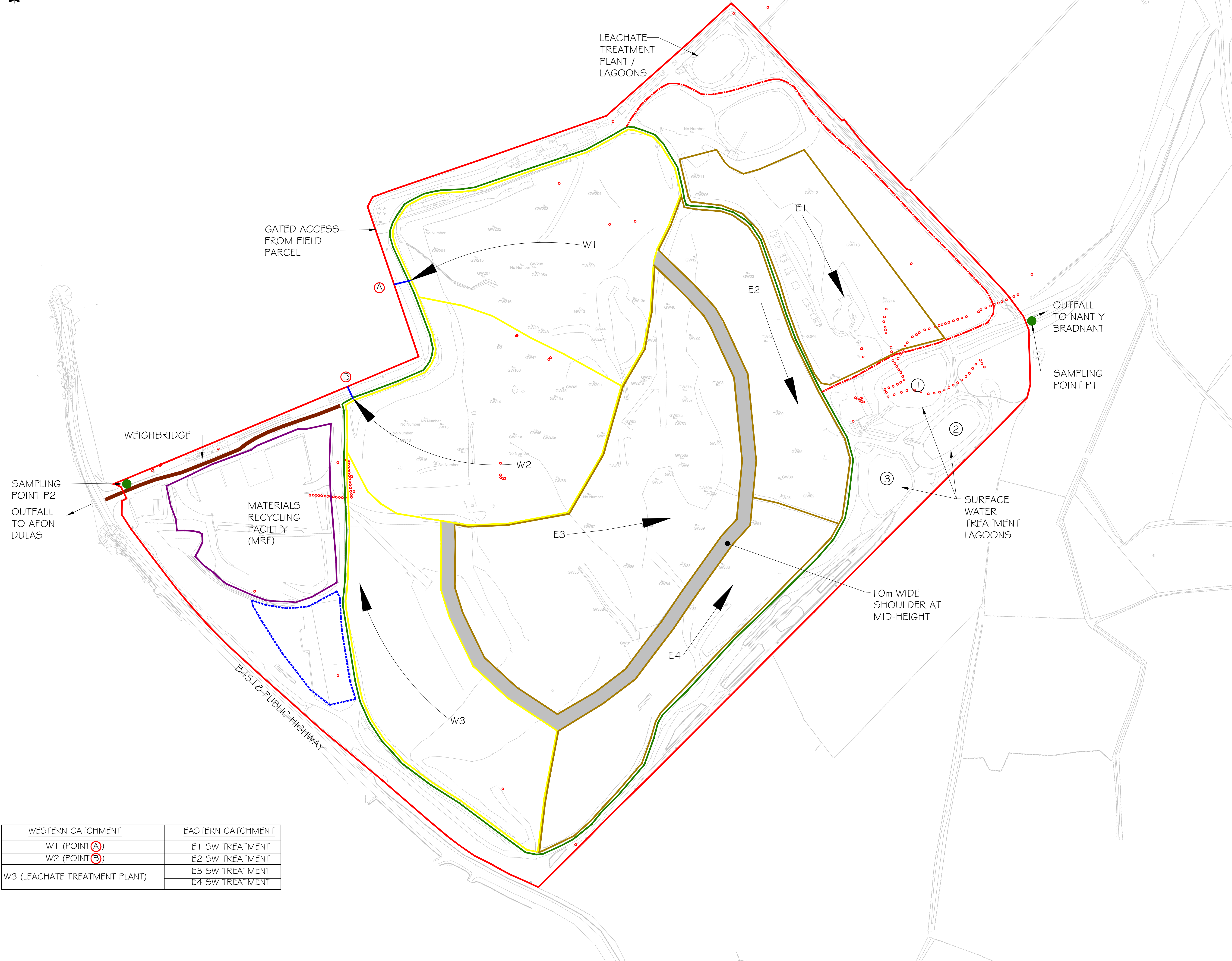

WESTERN CATCHMENT	EASTERN CATCHMENT
W1 (POINT A)	E1 SW TREATMENT
W2 (POINT B)	E2 SW TREATMENT
W3 (LEACHATE TREATMENT PLANT)	E3 SW TREATMENT
	E4 SW TREATMENT

PRELIMINARY DRAWING  
FOR INFORMATION  
PURPOSES ONLY

C2	CATCHMENTS ADDED	RWG	SBB	SBB	4.03.18	
C1	ISSUED FOR INFORMATION	RWG	SBB	SBB	6.02.18	
REV	MODIFICATIONS	BY	RE	AP	DATE	
POTTERS WASTE MANAGEMENT						
PROJECT:						
BRYN POSTEG LANDFILL SITE						
TITLE:						
SURFACE WATER MANAGEMENT PLAN						
DRAWN BY RWG		DATE 16.02.2018				
REVIEWED BY SBB		SCALE @ A1 1:1250		JOB REF: 3221		
AUTHORISED BY SBB		ISSUE AO		REVISION C2		
DRAWING NUMBER 3428-CAU-XX-XX-RP-V-0300						
<div>Caulmert</div> <div>engineering environmental planning</div>						