

- Legend/Notes
- ALL LEVELS ARE IN METRES UNLESS STATED OTHERWISE.
 - ALL DIMENSIONS IN MILLIMETRES UNLESS STATED OTHERWISE.
 - FOR GENERAL NOTES REFER TO DRAWING 164441-ALG-WLS-DJP-DRG-ECV-111100.

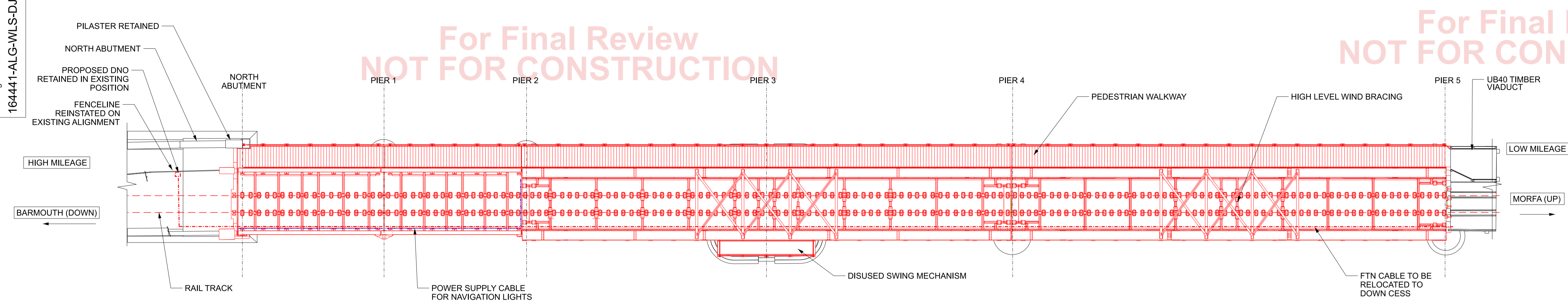

PROPOSED PLAN
SCALE 1:200

For Final Review
NOT FOR CONSTRUCTION

For Final Review
NOT FOR CONSTRUCTION

For Final Review
NOT FOR CONSTRUCTION

For Final Review
NOT FOR CONSTRUCTION

P01	15/11/21	First Issue	LW	RS	JP
B01	15/11/21	First Issue	LW	RS	JP
Rev	Date	Description of Revisions	Drawn	Chkd	Appr
Status					Suitability
Fit for Internal Review & Comment					S3



Authorised	Signed	Date
Contractor(s) Alun Griffiths (Contractors) Ltd		
Location	DOVEY JN - PWLLHELLI	
Type	CAD Drawing	Sub-type General Arrangement
Role	Civil Engineer	Sub-Role Structures and Buildings
Zone	Wales Region	
Phasing	Project Stage	GRIP 5
Region	Western and Wales	

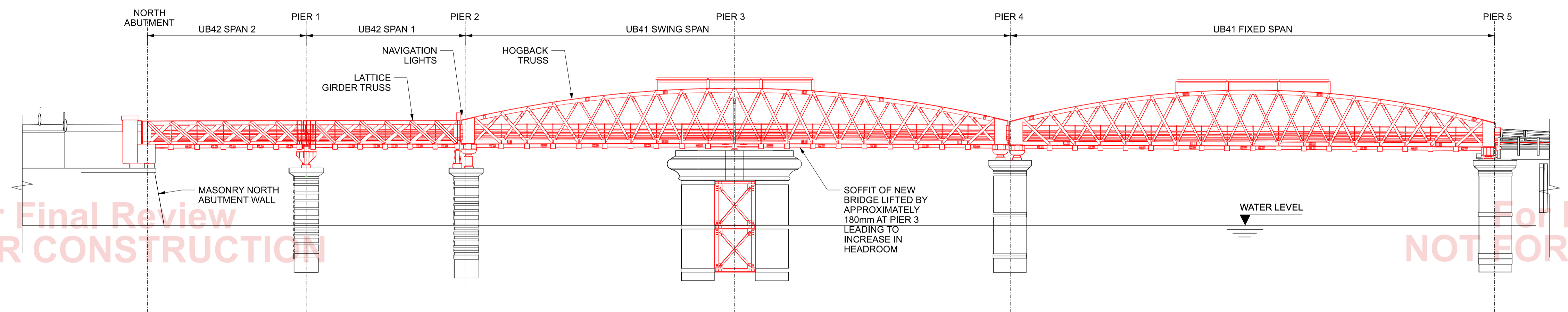

PROPOSED WEST ELEVATION
SCALE 1:200



SAFETY, HEALTH AND ENVIRONMENTAL INFORMATION

THE FOLLOWING NOTES HIGHLIGHT SIGNIFICANT RESIDUAL HAZARDS IDENTIFIED BY THE DESIGNER. TYPICAL HAZARDS THAT SHOULD BE IDENTIFIED BY A COMPETENT CONTRACTOR ARE NOT INCLUDED. THE CONTRACTOR SHALL CARRY OUT THE WORKS USING AN APPROVED SAFE SYSTEM OF WORK.

FURTHER INFORMATION ON HAZARDS CAN BE FOUND IN THE DRA AND / OR CSM HAZARD LOG.

REF.	HAZARD	STAGE	MITIGATING MEASURE
31	OVERLOADING OF EXISTING CAISSONS	C	PERMANENT LOADING NOT TO EXCEED 10% OF EXISTING AND LIVE LOAD NOT TO EXCEED RAS. FULL ASSESSMENT IN 164441-ALG-WLS-DJP-REP-ECV-000002.

Contract No.	164441		
Contract Title	Barmouth Metallic		
Drawing Title	Barmouth Viaduct UB41 & UB42 Replacement Proposed General Arrangement UB41 & UB42		
Designed	Signed	Electronically Signed	Date 15/11/21
Drawn	L.Wheatland	Signed	Electronically Signed
Checked	R.Strosccio	Signed	Electronically Signed
Approved		Signed	Date
Scale(s)	ELR & Mileage	99.1633	to 0
Alternative Reference			Sheet of
Drawing Number	164441-ALG-WLS-DJP-DRG-ECV-111090		Revision B01

NOT FOR CONSTRUCTION

For Final Review