

Notice of variation and consolidation with introductory note

Environmental Permitting (England & Wales) Regulations 2010

Simec Uskmouth Power Limited

Uskmouth Power Plant
West Nash Road
Newport
Gwent
NP18 2BZ

Variation application number
EPR/LP3131SW/V002

Permit number
EPR/ LP3131SW

Uskmouth Power Plant

Permit number EPR/LP3131SW

Introductory note

This introductory note does not form a part of the notice.

Under the Environmental Permitting (England & Wales) Regulations 2010 (schedule 5, part 1, paragraph 19) a variation may comprise a consolidated permit reflecting the variations and a notice specifying the variations included in that consolidated permit.

Schedule 1 of the notice specifies that all the conditions of the permit have been varied and schedule 2 comprises a consolidated permit which reflects the variations being made and contains all conditions relevant to this permit.

The requirements of the Industrial Emissions Directive (IED) 2010/75/EU are given force in Wales through the Environmental Permitting (England and Wales) Regulations 2010 (the EPR) (as amended).

This Permit, for the operation of large combustion plant (LCP), as defined by articles 28 and 29 of the Industrial Emissions Directive (IED), is varied by Natural Resources Wales to implement the special provisions for LCP given in the IED, by the 1 January 2016 (Article 82(3)). The IED makes special provisions for LCP under Chapter III, introducing new Emission Limit Values (ELVs) applicable to LCP, referred to in Article 30(2) and set out in Annex V.

As well as implementing Chapter III of IED, the consolidated variation notice takes into account and brings together in a single document all previous variations that relate to the original permit issued. It also modernises all conditions to reflect the conditions contained in our current generic permit template.

The Operator has chosen to operate this LCP under the Transitional National Plan (TNP) compliance route. This is a change from the previous operating regime which was Large Combustion Plant Directive ELV compliance.

The variation notice uses an updated LCP number in accordance with the most recent DEFRA LCP reference numbers. The LCP reference has changed as follows:

- LCP261 is changed to LCP312.

The plant is owned by Simec Uskmouth Power Limited, formerly Uskmouth Power Company Limited.

The rest of the installation is unchanged and continues to be operated as follows:

The station is coal fired and consists of three 121MW steam turbine driven alternators, each having a dedicated boiler and associated plant. Whilst the station is predominantly coal-fired, there is also capability to burn a small percentage of biomass and the boilers burn fuel oil for the purpose of start-up and for flame stabilisation under low-load operation. The main emissions from the installation are to air, comprising combustion products, mainly oxides of nitrogen, sulphur dioxide, carbon dioxide and carbon monoxide, and to water, comprising cooling water and surface water drainage. Abatement equipment includes flue gas desulphurisation and use of low NOx burners. Product from the flue gas desulphurisation process is conditioned with water and either sold or disposed of.

The schedules specify the changes made to the permit.

The status log of a permit sets out the permitting history, including any changes to the permit reference number.

Status log of the permit		
Description	Date	Comments
Application LP3131SW	Duly made 30/03/06	
Schedule 4	26/04/06	22/06/06, 22/06/06, 22/05/06
Additional Information Received	04/09/06	

Status log of the permit		
Description	Date	Comments
Schedule 4	15/09/06	23/10/06, 14/11/06, 27/11/06
Additional Information Received	01/03/07	
Additional Information Received	09/08/07	
Permit determined	24/10/07	
Regulation 60 Notice sent to the Operator	14/11/14	Issue of a Notice under Regulation 60(1) of the EPR. Natural Resources Wales initiated review and variation to vary the permit under IED to implement the special provisions for LCP under Chapter III, introducing new Emission Limit Values (ELVs) applicable to LCP, referred to in Article 30(2) and set out in Annex V. The permit is also updated to modern conditions.
Regulation 60 Notice response	31/03/15	Response received from the Operator.
Additional information received	19/06/15	Response to request for further information (RFI) dated 20/05/15.
Additional information received	25/11/15	Updated site plan provided by the Operator.
Additional information received	11/12/15	Information provided by the Operator relating to SNCR abatement trials.
Variation determined EPR/LP3131SW/V002	23/12/15	Varied and consolidated permit issued in modern condition format. Variation effective from 01/01/2016.

Superseded or Partially Superseded Licences/Authorisations/Consents relating to this installation			
Holder	Reference Number	Date of Issue	Fully or Partially Superseded
Uskmouth Power Plant	BA9436 and all subsequent variations (IPC permit)	15/10/98	Fully superseded

Other Part A installation permits relating to this installation		
Operator	Permit number	Date of issue
Simec Uskmouth Power Limited (water discharge consent)	AN0285201	07/10/98

End of introductory note

Notice of variation and consolidation

The Environmental Permitting (England and Wales) Regulations 2010

The Natural Resources Body for Wales ("Natural Resources Wales") in exercise of its powers under regulation 20 of the Environmental Permitting (England and Wales) Regulations 2010 varies and consolidates

Permit number

EPR/LP3131SW

Issued to

Simec Uskmouth Power Limited ("the operator")

whose registered office is

West Nash Road

Newport

Gwent

NP18 2BZ

company registration number 05104786

to operate a regulated facility

Uskmouth Power Plant

West Nash Road

Newport

Gwent

NP18 2BZ

to the extent set out in the schedules.

The notice shall take effect from 01/01/2016

Name	Date
	23/12/2015

Victoria Seller

Authorised on behalf of Natural Resources Wales

Schedule 1

All conditions have been varied by the consolidated permit as a result of a Natural Resources Wales initiated variation.

Schedule 2 – consolidated permit

Consolidated permit issued as a separate document.

Permit with introductory note

Environmental Permitting (England & Wales) Regulations 2010

Simec Uskmouth Power Limited

Uskmouth Power Plant
West Nash Road
Newport
Gwent
NP18 2BZ

Variation application number
EPR/LP3131SW/V002

Permit number
EPR/ LP3131SW

Uskmouth Power Plant

Permit number EPR/LP3131SW

Introductory note

This introductory note does not form a part of the notice.

This permit controls the operation of a large combustion plant. The relevant listed activity is Section 1.1 A(1)(a): Burning any fuel in an appliance with a rated thermal input of 50 megawatts or more. The permit implements the Chapter III requirements for large combustion plant (LCP) of the EU Directive on Industrial Emissions.

The main features of the installation are as follows. The plant is owned by Simec Uskmouth Power Limited (formerly Uskmouth Power Company Limited) who also carries out operation and maintenance. The station is coal fired and consists of three 121MW electrical output steam turbine driven alternators, each having a dedicated boiler and associated plant. Whilst the station is predominantly coal-fired, there is capability to burn a small percentage of biomass and the boilers burn fuel oil for the purpose of start-up and for flame stabilisation under low-load operation. The station is situated on 212 acres of land between the Severn Estuary, the River Usk and the Caldicot Levels, all of which are designated habitats sites at this location. The main emissions from the installation are to air, comprising combustion products, mainly oxides of nitrogen, sulphur dioxide, carbon dioxide and carbon monoxide, and to water, comprising cooling water and surface water drainage. Abatement equipment includes flue gas desulphurisation and use of low NO_x burners. Product from the flue gas desulphurisation process is conditioned with water and either sold or disposed of.

Table S1.3 contains an improvement condition, IC6, requiring the operators to produce a plan showing how the installation will contribute to total emissions of SO₂ from existing major coal and oil-fired power stations in England and Wales being minimised and not exceeding 70kt/year from 2020. The final update to the plan is due by 1st April 2016.

The status log of a permit sets out the permitting history, including any changes to the permit reference number.

Status log of the permit		
Description	Date	Comments
Application LP3131SW	Duly made 30/03/06	
Schedule 4	26/04/06	22/06/06, 22/06/06, 22/05/06
Additional Information Received	04/09/06	
Schedule 4	15/09/06	23/10/06, 14/11/06, 27/11/06
Additional Information Received	01/03/07	
Additional Information Received	09/08/07	
Permit determined	24/10/07	
Regulation 60 Notice sent to the Operator	14/11/14	Issue of a Notice under Regulation 60(1) of the EPR. Natural Resources Wales initiated review and variation to vary the permit under IED to implement the special provisions for LCP under Chapter III, introducing new Emission Limit Values (ELVs) applicable to LCP, referred to in Article 30(2) and set out in Annex V. The permit is also updated to modern conditions.
Regulation 60 Notice response	31/03/15	Response received from the Operator.

Status log of the permit		
Description	Date	Comments
Additional information received	19/06/15	Response to request for further information (RFI) dated 20/05/15.
Additional information received	25/11/15	Updated site plan provided by the Operator.
Additional information received	11/12/15	Information provided by the Operator relating to SNCR abatement trials.
Variation determined EPR/LP3131SW/V002	23/12/15	Varied and consolidated permit issued in modern condition format. Variation effective from 01/01/2016.

Superseded or Partially Superseded Licences/Authorisations/Consents relating to this installation			
Holder	Reference Number	Date of Issue	Fully or Partially Superseded
Uskmouth Power Plant	BA9436 and all subsequent variations (IPC permit)	15/10/98	Fully superseded

Other Part A installation permits relating to this installation		
Operator	Permit number	Date of issue
Simec Uskmouth Power Limited (water discharge consent)	AN0285201	07/10/98

End of introductory note

Permit

The Environmental Permitting (England and Wales) Regulations 2010

Permit number

EPR/LP3131SW

This is the consolidated permit referred to in the variation and consolidation notice for application EPR/LP3131SW/V002 authorising,

Simec Uskmouth Power Limited (“the operator”),

whose registered office is

West Nash Road

Newport

Gwent

NP18 2BZ

company registration number 05104786

to operate an installation at

Uskmouth Power Plant

West Nash Road

Newport

Gwent

NP18 2BZ

to the extent authorised by and subject to the conditions of this permit.

Name	Date
	23/12/2015

Victoria Seller

Authorised on behalf of Natural Resources Wales

Conditions

1 Management

1.1 General management

- 1.1.1 The operator shall manage and operate the activities:
- (a) in accordance with a written management system that identifies and minimises risks of pollution, including those arising from operations, maintenance, accidents, incidents, non-conformances, closure and those drawn to the attention of the operator as a result of complaints; and
 - (b) using sufficient competent persons and resources.
- 1.1.2 Records demonstrating compliance with condition 1.1.1 shall be maintained.
- 1.1.3 Any person having duties that are or may be affected by the matters set out in this permit shall have convenient access to a copy of it kept at or near the place where those duties are carried out.

1.2 Energy efficiency

- 1.2.1 The operator shall:
- (a) take appropriate measures to ensure that energy is used efficiently in the activities;
 - (b) take appropriate measures to ensure the efficiency of energy generation at the permitted installation is maximised;
 - (c) review and record at least every four years whether there are suitable opportunities to improve the energy efficiency of the activities; and
 - (d) take any further appropriate measures identified by a review.

1.3 Efficient use of raw materials

- 1.3.1 The operator shall:
- (a) take appropriate measures to ensure that raw materials and water are used efficiently in the activities;
 - (b) maintain records of raw materials and water used in the activities;
 - (c) review and record at least every four years whether there are suitable alternative materials that could reduce environmental impact or opportunities to improve the efficiency of raw material and water use; and
 - (d) take any further appropriate measures identified by a review.

1.4 Avoidance, recovery and disposal of wastes produced by the activities

- 1.4.1 The operator shall take appropriate measures to ensure that:
- (a) the waste hierarchy referred to in Article 4 of the Waste Framework Directive is applied to the generation of waste by the activities;
 - (b) any waste generated by the activities is treated in accordance with the waste hierarchy referred to in Article 4 of the Waste Framework Directive; and
 - (c) where disposal is necessary, this is undertaken in a manner which minimises its impact on the environment.

- 1.4.2 The operator shall review and record at least every four years whether changes to those measures should be made and take any further appropriate measures identified by a review.

2 Operations

2.1 Permitted activities

- 2.1.1 The operator is only authorised to carry out the activities specified in schedule 1 table S1.1 (the “activities”).

2.2 The site

- 2.2.1 The activities shall not extend beyond the site, being the land shown edged in green on the site plan at schedule 7 to this permit.

2.3 Operating techniques

- 2.3.1 The activities shall, subject to the conditions of this permit, be operated using the techniques and in the manner described in the documentation specified in schedule 1, table S1.2, unless otherwise agreed in writing by Natural Resources Wales.
- 2.3.2 For the following activities referenced in schedule 1, table S1.1: LCP312. Without prejudice to condition 2.3.1, the activities shall be operated in accordance with the “Electricity Supply Industry IED Compliance Protocol for Utility Boilers and Gas Turbines” revision 1 dated February 2015 or any later version unless otherwise agreed in writing by Natural Resources Wales.
- 2.3.3 If notified by Natural Resources Wales that the activities are giving rise to pollution, the operator shall submit to Natural Resources Wales for approval within the period specified, a revision of any plan or other documentation (“plan”) specified in schedule 1, table S1.2 or otherwise required under this permit which identifies and minimises the risks of pollution relevant to that plan, and shall implement the approved revised plan in place of the original from the date of approval, unless otherwise agreed in writing by Natural Resources Wales.
- 2.3.4 Any raw materials or fuels listed in schedule 2 table S2.1 shall conform to the specifications set out in that table.
- 2.3.5 For the following activities referenced in schedule 1, table S1.1: LCP312. The end of the start-up period and the start of the shutdown period shall conform to the specifications set out in Schedule 1, tables S1.2 and S1.4
- 2.3.6 For the following activities referenced in schedule 1, table S1.1: LCP312. The following conditions apply where there is a malfunction or breakdown of any abatement equipment:
Unless otherwise agreed in writing by Natural Resources Wales:
- (i) if a return to normal operations is not achieved within 24 hours, the operator shall reduce or close down operations, or shall operate the activities using low polluting fuels;
 - (ii) the cumulative duration of breakdown in any 12-month period shall not exceed 120 hours; and
 - (iii) the cumulative duration of malfunction in any 12-month period shall not exceed 120 hours.
- 2.3.7 Waste shall only be accepted if:
- (a) it is of a type and quantity listed in schedule 2 table S2.2; and
 - (b) it conforms to the description in the documentation supplied by the producer and holder.
- 2.3.8 Records shall be kept of all waste accepted onto the site.

- 2.3.9 The operator shall ensure that where waste produced by the activities is sent to a relevant waste operation, that operation is provided with the following information, prior to the receipt of the waste:
- (a) the nature of the process producing the waste;
 - (b) the composition of the waste;
 - (c) the handling requirements of the waste;
 - (d) the hazardous property associated with the waste, if applicable; and
 - (e) the waste code of the waste.
- 2.3.10 The operator shall ensure that where waste produced by the activities is sent to a landfill site, it meets the waste acceptance criteria for that landfill.

2.4 Improvement programme

- 2.4.1 The operator shall complete the improvements specified in schedule 1 table S1.3 by the date specified in that table unless otherwise agreed in writing by Natural Resources Wales.
- 2.4.2 Except in the case of an improvement which consists only of a submission to Natural Resources Wales, the operator shall notify Natural Resources Wales within 14 days of completion of each improvement.

2.5 Pre-operational conditions

There are no pre-operational conditions in this permit.

3 Emissions and monitoring

3.1 Emissions to water, air or land

- 3.1.1 There shall be no point source emissions to water, air or land except from the sources and emission points listed in schedule 3 tables S3.1, S3.2 and S3.3.
- 3.1.2 The limits given in schedule 3 shall not be exceeded.
- 3.1.3 Where a substance is specified in schedule 3 tables S3.2 or S3.3 but no limit is set for it, the concentration of such substance in emissions to water from the relevant emission point shall be no greater than the background concentration.
- 3.1.4 Total annual emissions from the LCP emission points set out in schedule 3 tables S3.1 and S3.2 of a substance listed in schedule 3 table S3.3 shall not exceed the relevant limit in table S3.3.
- 3.1.5 Periodic monitoring shall be carried out at least once every 5 years for groundwater and 10 years for soil, unless such monitoring is based on a systematic appraisal of the risk of contamination.

3.2 Emissions of substances not controlled by emission limits

- 3.2.1 Emissions of substances not controlled by emission limits (excluding odour) shall not cause pollution. The operator shall not be taken to have breached this condition if appropriate measures, including, but not limited to, those specified in any approved emissions management plan, have been taken to prevent or where that is not practicable, to minimise, those emissions.
- 3.2.2 The operator shall:
- (a) if notified by Natural Resources Wales that the activities are giving rise to pollution, submit to Natural Resources Wales for approval within the period specified, an emissions management plan which identifies and minimises the risks of pollution from emissions of substances not controlled by emission limits;

- (b) implement the approved emissions management plan, from the date of approval, unless otherwise agreed in writing by Natural Resources Wales.

3.2.3 All liquids in containers, whose emission to water or land could cause pollution, shall be provided with secondary containment, unless the operator has used other appropriate measures to prevent or where that is not practicable, to minimise, leakage and spillage from the primary container.

3.3 Odour

3.3.1 Emissions from the activities shall be free from odour at levels likely to cause pollution outside the site, as perceived by an authorised officer of Natural Resources Wales, unless the operator has used appropriate measures, including, but not limited to, those specified in any approved odour management plan, to prevent or where that is not practicable to minimise the odour.

3.3.2 The operator shall:

- (a) if notified by Natural Resources Wales that the activities are giving rise to pollution outside the site due to odour, submit to Natural Resources Wales for approval within the period specified, an odour management plan which identifies and minimises the risks of pollution from odour;
- (b) implement the approved odour management plan, from the date of approval, unless otherwise agreed in writing by Natural Resources Wales.

3.4 Noise and vibration

3.4.1 Emissions from the activities shall be free from noise and vibration at levels likely to cause pollution outside the site, as perceived by an authorised officer of Natural Resources Wales, unless the operator has used appropriate measures, including, but not limited to, those specified in any approved noise and vibration management plan to prevent or where that is not practicable to minimise the noise and vibration.

3.4.2 The operator shall:

- (a) if notified by Natural Resources Wales that the activities are giving rise to pollution outside the site due to noise and vibration, submit to Natural Resources Wales for approval within the period specified, a noise and vibration management plan which identifies and minimises the risks of pollution from noise and vibration;
- (b) implement the approved noise and vibration management plan, from the date of approval, unless otherwise agreed in writing by Natural Resources Wales.

3.5 Monitoring

3.5.1 The operator shall, unless otherwise agreed in writing by Natural Resources Wales, undertake the monitoring specified in the following tables in schedule 3 to this permit:

- (a) point source emissions specified in tables S3.1, S3.2 and S3.3; and
- (b) process monitoring specified in table S3.4.

3.5.2 The operator shall maintain records of all monitoring required by this permit including records of the taking and analysis of samples, instrument measurements (periodic and continuous), calibrations, examinations, tests and surveys and any assessment or evaluation made on the basis of such data.

3.5.3 Monitoring equipment, techniques, personnel and organisations employed for the emissions monitoring programme and the environmental or other monitoring specified in condition 3.5.1 shall have either MCERTS certification or MCERTS accreditation (as appropriate), where available, unless otherwise agreed in writing by Natural Resources Wales.

- 3.5.4 Permanent means of access shall be provided to enable sampling/monitoring to be carried out in relation to the emission points specified in schedule 3 tables S3.1, S3.2, S3.3 and S3.4 unless otherwise agreed in writing by Natural Resources Wales.

3.6 Monitoring for the purposes of the Industrial Emissions Directive

Chapter III

- 3.6.1 All monitoring required by this permit shall be carried out in accordance with the provisions of Annex V of the Industrial Emissions Directive.
- 3.6.2 If the monitoring results for more than 10 days a year are invalidated within the meaning set out in condition 3.6.7, the operator shall:
- (a) within 28 days of becoming aware of this fact, review the causes of the invalidations and submit to Natural Resources Wales for approval, proposals for measures to improve the reliability of the continuous measurement systems, including a timetable for the implementation of those measures; and
 - (b) implement the approved proposals.
- 3.6.3 Continuous measurement systems on emission points from the LCP shall be subject to quality control by means of parallel measurements with reference methods at least once every calendar year.
- 3.6.4 Unless otherwise agreed in writing by Natural Resources Wales in accordance with condition 3.6.5 below, the operator shall carry out the methods, including the reference measurement methods, to use and calibrate continuous measurement systems in accordance with the appropriate CEN standards.
- 3.6.5 If CEN standards are not available, ISO standards, national or international standards which will ensure the provision of data of an equivalent scientific quality shall be used, as agreed in writing with Natural Resources Wales.
- 3.6.6 Where required by a condition of this permit to check the measurement equipment, the operator shall submit a report to Natural Resources Wales in writing, within 28 days of the completion of the check.
- 3.6.7 Where Continuous Emission Monitors are installed to comply with the monitoring requirements in schedule 3, table S3.1; the Continuous Emission Monitors shall be used such that:
- (a) for the continuous measurement systems fitted to the LCP release points defined in table S3.1 the validated hourly, monthly and daily averages shall be determined from the measured valid hourly average values after having subtracted the value of the 95% confidence interval
 - (b) the 95% confidence interval for nitrogen oxides and sulphur dioxide of a single measured result shall be taken to be 20%;
 - (c) the 95% confidence interval for dust releases of a single measured result shall be taken to be 30%;
 - (d) the 95% confidence interval for carbon monoxide releases of a single measured result shall be taken to be 10%;
 - (e) an invalid hourly average means an hourly average period invalidated due to malfunction of, or maintenance work being carried out on, the continuous measurement system. However, to allow some discretion for zero and span gas checking, or cleaning (by flushing), an hourly average period will count as valid as long as data has been accumulated for at least two thirds of the period (40 minutes). Such discretionary periods are not to exceed more than 5 in any one 24-hour period unless agreed in writing. Where plant may be operating for less than the 24-hour period, such discretionary periods are not to exceed more than one quarter of the overall valid hourly average periods unless agreed in writing; and
 - (f) any day, in which more than three hourly average values are invalid shall be invalidated.

4 Information

4.1 Records

4.1.1 All records required to be made by this permit shall:

- (a) be legible;
- (b) be made as soon as reasonably practicable;
- (c) if amended, be amended in such a way that the original and any subsequent amendments remain legible, or are capable of retrieval; and
- (d) be retained, unless otherwise agreed in writing by Natural Resources Wales, for at least 6 years from the date when the records were made, or in the case of the following records until permit surrender:
 - (i) Off-site environmental effects; and
 - (ii) Matters which affect the condition of the land and groundwater.

4.1.2 The operator shall keep on site all records, plans and the management system required to be maintained by this permit, unless otherwise agreed in writing by Natural Resources Wales.

4.2 Reporting

4.2.1 The operator shall send all reports and notifications required by the permit to Natural Resources Wales using the contact details supplied in writing by Natural Resources Wales.

4.2.2 A report or reports on the performance of the activities over the previous year shall be submitted to Natural Resources Wales by 31 January (or other date agreed in writing by Natural Resources Wales) each year. The report(s) shall include as a minimum:

- (a) a review of the results of the monitoring and assessment carried out in accordance with the permit including an interpretive review of that data;
- (b) the annual production /treatment data set out in schedule 4 table S4.2;
- (c) the performance parameters set out in schedule 4 table S4.3 using the forms specified in table S4.4 of that schedule; and
- (d) where condition 2.3.6 applies, the cumulative duration of breakdown and cumulative duration of malfunction in any 12 month period.

4.2.3 Within 28 days of the end of the reporting period the operator shall, unless otherwise agreed in writing by Natural Resources Wales, submit reports of the monitoring and assessment carried out in accordance with the conditions of this permit, as follows:

- (a) in respect of the parameters and emission points specified in schedule 4 table S4.1;
- (b) for the reporting periods specified in schedule 4 table S4.1 and using the forms specified in schedule 4 table S4.3; and
- (c) giving the information from such results and assessments as may be required by the forms specified in those tables.

4.2.4 The operator shall, unless notice under this condition has been served within the preceding four years, submit to Natural Resources Wales, within six months of receipt of a written notice, a report assessing whether there are other appropriate measures that could be taken to prevent, or where that is not practicable, to minimise pollution.

4.2.5 Within 1 month of the end of each quarter, the operator shall submit to Natural Resources Wales using the form made available for the purpose, the information specified on the form relating to the site and the waste accepted and removed from it during the previous quarter, if during that quarter

the total amount accepted exceeds 100 tonnes of non-hazardous waste or 10 tonnes of hazardous waste.

- 4.2.6 Within 10 days of the notification of malfunction or breakdown the operator shall submit an Air Quality Risk Assessment as outlined in the IED Compliance Protocol (condition 2.3.2).
- 4.2.7 For the following activities referenced in schedule 1, table S1.1: LCP312. Unless otherwise agreed in writing with Natural Resources Wales, within 1 month of the end of each quarter, the operator shall submit to the TNP Register and Natural Resources Wales using the form IED RTA1, listed in table S4.4, the information specified on the form relating to the site's mass emissions.

4.3 Notifications

4.3.1 In the event:

- (a) that the operation of the activities gives rise to an incident or accident which significantly affects or may significantly affect the environment, the operator must immediately—
 - (i) inform Natural Resources Wales,
 - (ii) take the measures necessary to limit the environmental consequences of such an incident or accident, and
 - (iii) take the measures necessary to prevent further possible incidents or accidents;
- (b) of a breach of any permit condition the operator must immediately—
 - (i) inform Natural Resources Wales, and
 - (ii) take the measures necessary to ensure that compliance is restored within the shortest possible time;
- (c) of a breach of permit condition which poses an immediate danger to human health or threatens to cause an immediate significant adverse effect on the environment, the operator must immediately suspend the operation of the activities or the relevant part of it until compliance with the permit conditions has been restored.
- (d) of any malfunction or breakdown of abatement equipment relating to condition 2.3.6, the operator shall notify Natural Resources Wales within 48 hours unless notification has already been made under (a) to (c) above.

4.3.2 Any information provided under condition 4.3.1 [(a)(i), 4.3.1 (b)(i) where the information relates to the breach of a condition specified in the permit, or 4.3.1 (d) where the information relates to malfunction or breakdown of abatement equipment] shall be confirmed by sending the information listed in schedule 5 to this permit within the time period specified in that schedule.

4.3.3 Where Natural Resources Wales has requested in writing that it shall be notified when the operator is to undertake monitoring and/or spot sampling, the operator shall inform Natural Resources Wales when the relevant monitoring and/or spot sampling is to take place. The operator shall provide this information to Natural Resources Wales at least 14 days before the date the monitoring is to be undertaken.

4.3.4 Natural Resources Wales shall be notified within 14 days of the occurrence of the following matters, except where such disclosure is prohibited by Stock Exchange rules:

Where the operator is a registered company:

- (a) any change in the operator's trading name, registered name or registered office address; and
- (b) any steps taken with a view to the operator going into administration, entering into a company voluntary arrangement or being wound up.

Where the operator is a corporate body other than a registered company:

- (c) any change in the operator's name or address; and
- (d) any steps taken with a view to the dissolution of the operator.

- 4.3.5 Where the operator proposes to make a change in the nature or functioning, or an extension of the activities, which may have consequences for the environment and the change is not otherwise the subject of an application for approval under the Regulations or this permit:
- (a) Natural Resources Wales shall be notified at least 14 days before making the change; and
 - (b) the notification shall contain a description of the proposed change in operation.
- 4.3.6 Natural Resources Wales shall be given at least 14 days notice before implementation of any part of the site closure plan.
- 4.3.7 Where the operator has entered into a climate change agreement with the Government, Natural Resources Wales shall be notified within one month of:
- (a) a decision by the Secretary of State not to re-certify the agreement;
 - (b) a decision by either the operator or the Secretary of State to terminate the agreement; and
 - (c) any subsequent decision by the Secretary of State to re-certify such an agreement.
- 4.3.8 The operator shall inform Natural Resources Wales in writing of the closure of any LCP within 28 days of the date of closure.

4.4 Interpretation

- 4.4.1 In this permit the expressions listed in schedule 6 shall have the meaning given in that schedule.
- 4.4.2 In this permit references to reports and notifications mean written reports and notifications, except where reference is made to notification being made “immediately” in which case it may be provided by telephone.

Schedule 1 – Operations

Table S1.1 activities			
Activity reference	Activity listed in Schedule 1 of the EP Regulations	Description of specified activity	Limits of specified activity
A1	Section 1.1 A(1) (a): Burning any fuel in an appliance with a rated thermal input of 50 megawatts or more.	LCP312: electricity generation in three coal fired units 13, 14 and 15.	Receipt of coal and biomass at the coal mills, and the supply of oil to the combustion unit and any associated activities necessary to maintain the operation of the plant and fuel supplies through to the discharge of exhaust gases from the stack, ash removal from the combustion process and the export of steam to the steam systems.
A2	Section 3.5 Part B(f)	Pulverised fuel ash (PFA) handling and storage	Removal of ash from the combustion process to despatch from site.
A3	Section 4.2 Part A(1)(a)(iv)	Operation of six Flue Gas Desulphurisation (FGD) units	Receipt of calcium oxide to despatch of FGD end product.
Directly Associated Activity			
A4	Directly associated activity	Surface water drainage	Handling and storage of site drainage until discharge to the site surface water system.
A5	Directly associated activity	Water treatment	From receipt of raw materials and raw water to dispatch of demineralised water to the process and chemical effluent to the drainage system via cooling system.
A6	Directly associated activity	The generation and export of electricity	The receipt of steam at the steam turbine to the export of electricity to the national grid station and the direct generation of electricity.
A7	Directly associated activity	Fuel Storage	Receipt and handling of coal, oil and biomass up to the delivery of coal and solid biomass to the coal mills and delivery of oil and gas to the combustion units.
A8	Directly associated activity	The use of treated effluent from Welsh Water sewage treatment works to condense steam.	The pumping, filtering (including use of hydrocyclones) and chemical treatment of water, its use in the condenser and the cooling water system to the discharge of the water back to 'Julian's Pill'.

Table S1.2 Operating techniques		
Description	Parts	Date Received
Application	The response to section 2.1 and 2.2 in the Application.	23/03/06

Table S1.2 Operating techniques		
Description	Parts	Date Received
Response to regulation 60(1) Notice – request for information dated 14/11/14	Compliance routes and operating techniques identified in response to questions 2 (LCP compliance route), 3 (TNP evidence of notification), 4 (LCP configuration), 5 (LCP net rated thermal input), 6 (MSUL/MSDL) and 7 (Sector compliance for coal fired power stations entering into the TNP or LLD).	Received 31/03/15
Receipt of additional information to the regulation 60(1) Notice. requested by letter dated 20/05/15	Additional information provided for response to questions 2 (LCP compliance route), 3 (TNP evidence of notification), 5 (LCP net rated thermal input) and 6 (MSUL/MSDL).	Received 19/06/15
Receipt of additional information to the regulation 60(1) Notice.	Further information received relating to SNCR abatement trials.	Received 11/12/15

Table S1.3 Improvement programme requirements		
Reference	Requirement	Date
IC1	<p>A written report shall be submitted to Natural Resources Wales for approval. The report shall include the results of an assessment of whether there are other appropriate measures that could be taken to prevent, or where that is not practicable, to minimise pollution for the activities covered by this permit. The report shall be in sufficient detail to allow a permit review. The report shall also contain a timescale for the implementation of any individual measures identified to improve the performance of the installation, including emissions control performance, as appropriate following the review. The notification requirements of condition 2.4.2 shall be deemed to have been complied with on submission of the report.</p> <p>The individual measures detailed in the report shall be implemented by the operator from the date of approval by Natural Resources Wales.</p>	Deferred until LCP BRef review
IC2	<p>A written report shall be submitted to the Environment Agency for approval. The report shall contain a protocol detailing the methodology for measuring the fraction of PM10 and PM2.5 within the release of total particulate matter from the combustion process. The protocol shall include but not be restricted to a variety of operating scenarios including start up and shut down, changes in operating loads and patterns and types of abatement. The report shall also contain a proposed time-scale within which the proposed sampling program contained within the protocol will be completed. The notification requirements of condition 2.4.2 shall be deemed to have been complied with on submission of the report.</p> <p>The program shall be implemented by the operator from the date of approval in writing by the Environment Agency.</p>	Complete
IC3	<p>A written report shall be submitted to the Environment Agency for approval. The report shall include a detailed assessment, including economic factors, of the options to increase firing of biomass fuels. Where appropriate, the report shall contain dates for the implementation of individual measures. The notification requirements of condition 2.4.2 shall be deemed to have been complied with on submission of the report. The individual measures detailed in the report shall be implemented by the operator from the date of approval by the Environment Agency.</p>	Complete

Table S1.3 Improvement programme requirements		
Reference	Requirement	Date
IC4	A written report shall be submitted to the Environment Agency for approval. The report shall include the results of a water efficiency audit in accordance with section 2.4.3 of IPPC Sector Guidance Note for the Combustion Sector. The report shall also contain a timescale for the implementation of any individual measures identified to address any deficiencies. The notification requirements of condition 2.4.2 shall be deemed to have been complied with on submission of the report. The individual measures detailed in the report shall be implemented by the operator from the date of approval by the Environment Agency.	Complete
IC5	A written report shall be submitted to the Environment Agency for approval. The report shall include the results of a waste minimisation audit in accordance with section 2.4.2 of IPPC Sector Guidance Note for the Combustion Sector. The report shall also contain a timescale for the implementation of any individual measures identified to address any deficiencies. The notification requirements of condition 2.4.2 shall be deemed to have been complied with on submission of the report. The individual measures detailed in the report shall be implemented by the operator from the date of approval by the Environment Agency.	Complete
IC6	Provide a written plan of how this installation will contribute to total emissions of SO ₂ from existing major coal-fired power stations in England and Wales being minimised and in any case not exceeding 70 kt/y by 2020. The report should consider scenarios for electricity demand in 2020 and give the planned arrangements for SO ₂ emissions control at this installation. (Existing coal-fired stations comprise LCP that might still be operating in 2020. These are at Aberthaw, Cottam, Drax, Eggborough, Ferrybridge, Fiddlers Ferry, Ratcliffe, Rugeley, Uskmouth and West Burton). The plan should be implemented after approval by Natural Resources Wales.	01/04/08 with updated versions by 01/04/12 & 01/04/16
IC7	A written report shall be submitted to Natural Resources Wales for approval. The report shall contain a protocol for a monitoring programme to assess changes in acidification and eutrophication deposition and ecological effects at appropriate Natura 2000 sites. The protocol will include the selection of the Natura 2000 sites and a time scale for implementation of the programme. The notification requirements of condition 2.4.2 shall be deemed to have been complied with on submission of the report. The protocol detailed in the report shall be implemented by the Operator from the date of approval by Natural Resources Wales.	31/12/2016
IC8	A written procedure shall be submitted to the Environment Agency detailing the measures to be used so that monitoring equipment, personnel and organisations employed for the emissions monitoring programme shall have either MCERTS certification or accreditation in accordance with condition 3.5.3. The notification requirements of condition 2.4.2 shall be deemed to have been complied with on submission of the procedure. The procedure shall be implemented by the operator from the date of approval in writing by the Environment Agency.	Complete
IC9	A written report shall be submitted to the Environment Agency for approval to detail how emissions to water from the coal and ash handling areas shall be minimised through the construction of a lined coal storage facility, lined lagoon system and lined drainage facility to replace existing gravel drainage system. This shall include an environmental assessment on completion of the project. The notification requirements of condition 2.4.2 shall be deemed to have been complied with on submission of the summary. The proposals shall be implemented by the Operator from the date of approval in writing by the Environment Agency.	Complete
IC10	A written plan shall be submitted to the Environment Agency for approval detailing the results of a survey of hard-standing, kerbing, and secondary containment for raw material, intermediate, product and waste storage areas and the measures to comply with the requirements of Section 2.2.5 of the Environment Agency Guidance Note IPPC Sector Guidance Note Combustion Activities V2.03. Where appropriate, the plan shall contain dates for the implementation of individual measures. The notification requirements of condition 2.4.2 shall be deemed to have been complied with on submission of the plan.	Complete

Table S1.3 Improvement programme requirements		
Reference	Requirement	Date
IC11	<p>The operator shall carry out a review of the Accident Management Plan to take account of the installation of the SNCR trial and associated equipment. If the review extends to the entire installation then it will be deemed to have met the requirement of Condition 1.2.1 (b).</p> <p>The reviewed plan shall be submitted to Natural Resources Wales for approval, and the measures and controls identified in the approved plan shall be implemented within 1 month of the written approval of the report by Natural Resources Wales.</p>	31/01/16
IC12	<p>A written report shall be submitted to Natural Resources Wales for approval. The report shall describe the outcome of the SNCR abatement trials submitted as further information to the Regulation 60 Notice response dated 11/12/15. The report shall include quantification of the potential nitrogen oxides emission reductions achieved and relevant performance parameters including but not limited to</p> <ul style="list-style-type: none"> • ash quality (and review against quality protocol specifications where relevant) • ammonia emissions • tube failure rates • start up, shut down thresholds and boiler stability • slagging • thermal performance • bag filter performance • mercury and other trace element emissions <p>The notification requirements of condition 2.4.2 shall be deemed to have been complied with on submission of the reports.</p>	01/07/16

Table S1.4 Start-up and Shut-down thresholds		
Emission Point and Unit Reference	“Minimum start-up load” Load in MW and as percent of rated power output (%)	“Minimum shut-down load” Load in MW and as percent of rated power output (%)
A4 LCP312: units 13, 14 and 15	70 MW; 57.9%	60 MW; 49.6%

Schedule 2 – Waste types, raw materials and fuels

Table S2.1 Raw materials and fuels	
Raw materials and fuel description	Specification
Gas oil	Less than 0.1% w/w sulphur content
Biomass fuels	As defined in Article 2(11) of EU Directive 2001/80/EC and included in the application or otherwise agreed in writing with Natural Resources Wales

Table S2.2 Permitted waste types and quantities for use as fuels	
Waste code	Description
Relevant exempt biomass	Biomass fuels exempt from the requirements of the Waste Incineration Directive and Large Combustion Plant Directive (as defined in Article 2(11) of EU Directive 2001/80/EC and Article 2 of EU Directive 2007/76/EC) and included in the application or otherwise agreed in writing with Natural Resources Wales
Relevant exempt waste	Other fuels exempt from the requirements of the Waste Incineration Directive 2000/76/EC and included in the application or otherwise agreed in writing with Natural Resources Wales for use in the installation

Schedule 3 – Emissions and monitoring

Table S3.1 Point source emissions to air from coal fired boiler plant >100MWth operating under the Transitional National Plan

Emission point ref. & location	Parameter	Source	Limit (including unit)- these limits do not apply during start up or shut down.	Reference period	Monitoring frequency	Monitoring standard or method
A4 [Point A4 on site plan in schedule 7]	Oxides of nitrogen (NO and NO ₂ expressed as NO ₂)	LCP312 >100MWth Coal fired boiler plant	450 mg/m ³	Calendar monthly mean	Continuous	BS EN 14181
A4 [Point A4 on site plan in schedule 7]	Oxides of nitrogen (NO and NO ₂ expressed as NO ₂)	LCP312 Coal fired boiler plant	550 mg/m ³	95% of validated daily means within a calendar year	Continuous	BS EN 14181
A4 [Point A4 on site plan in schedule 7]	Sulphur dioxide	LCP312 Coal fired boiler plant	350 mg/m ³	Calendar monthly mean	Continuous	BS EN 14181
A4 [Point A4 on site plan in schedule 7]	Sulphur dioxide	LCP312 Coal fired boiler plant	440 mg/m ³	95% of validated daily means within a calendar year	Continuous	BS EN 14181
A4 [Point A4 on site plan in schedule 7]	Dust	LCP312 Coal fired boiler plant	20 mg/m ³	Calendar monthly mean	Continuous	BS EN 14181
A4 [Point A4 on site plan in schedule 7]	Dust	LCP312 Coal fired boiler plant	35 mg/m ³	95% of validated daily means within a calendar year	Continuous	BS EN 14181
A4 [Point A4 on site plan in schedule 7]	Oxygen	LCP312 coal fired boiler plant	-	-	Continuous As appropriate to reference	BS EN 14181
A4 [Point A4 on site plan in schedule 7]	Water vapour	LCP312 coal fired boiler plant	-	-	Continuous As appropriate to reference	BS EN 14181
A4 [Point A4 on site plan in schedule 7]	Stack gas temperature	LCP312 coal fired boiler plant	-	-	Continuous As appropriate to reference	Traceable to national standards
A4 [Point A4 on site plan in schedule 7]	Stack gas pressure	LCP312 coal fired boiler plant	-	-	Continuous As appropriate to reference	Traceable to national standards

Table S3.1 Point source emissions to air from coal fired boiler plant >100MWth operating under the Transitional National Plan

Emission point ref. & location	Parameter	Source	Limit (including unit)- these limits do not apply during start up or shut down.	Reference period	Monitoring frequency	Monitoring standard or method
A4 [Point A4 on site plan in schedule 7]	Total mercury	LCP312 coal fired boiler plant	-	-	Annual	BS EN13211
A4 [Point A4 on site plan in schedule 7]	Stack gas volume flow	LCP312 coal fired boiler plant	-	-	Continuous	BS EN 16911 & TGN M2
A4 [Point A4 on site plan in schedule 7]	As required by the Method Implementation Document for BS EN 15259	LCP312 Coal fired boiler plant	-	-	Pre-operation and when there is a significant operational change	BS EN 15259
A5 [Point A5 on site plan in schedule 7]	-	Lime Silo	-	-	-	-
A6 [Point A6 on site plan in schedule 7]	-	End product silo vent filter	-	-	-	-
A7 [Point A7 on site plan in schedule 7]	-	Main fuel oil storage tank vent	-	-	-	-
A8 [Point A8 on site plan in schedule 7]	-	Hydrochloric acid vent	-	-	-	-
A9 [Point A9 on site plan in schedule 7]	-	Hydrogen peroxide tank vent	-	-	-	-

Table S3.2 Point Source emissions to water (other than sewer) – emission limits and monitoring requirements

Emission point ref. & location	Parameter	Source	Limit (incl. unit)	Reference period	Monitoring frequency	Monitoring standard or method¹
W1a on site plan in schedule 7	Total suspended solids	Surface Water	75 mg/l	Spot	Weekly	BS EN 872:2005
W1a on site plan in schedule 7	pH	Surface Water	6-9	Spot	Weekly	BS 6068-2.50:1995
W1a on site plan in schedule 7	Cadmium	Process effluent, surface water	0.01 mg/l	Spot	Every three months	ISO, BS EN or SCA Blue Book Method
W1a on site plan in schedule 7	Mercury	Process effluent, surface water	0.005 mg/l	Spot	Every three months	ISO, BS EN or SCA Blue Book Method
W1b on site plan in schedule 7	Total suspended solids	Surface Water	75 mg/l	Spot	Weekly	BS EN 872:2005
W1b on site plan in schedule 7	pH	Surface Water	6-9	Spot	Weekly	BS 6068-2.50:1995
W1b on site plan in schedule 7	Cadmium	Process effluent, surface water	0.01 mg/l	Spot	Every three months	ISO, BS EN or SCA Blue Book Method
W1b on site plan in schedule 7	Mercury	Process effluent, surface water	0.005 mg/l	Spot	Every three months	ISO, BS EN or SCA Blue Book Method
W2 on site plan in schedule 7	Total Suspended Solids	Process effluent, surface water	150mg/l	Spot	Weekly	BS EN 872:2005
W2 on site plan in schedule 7	pH	Process effluent, surface water	6-9	Instantaneous	Continuous	ISO, BS EN or SCA Blue Book Method
W2 on site plan in schedule 7	Temperature	Process effluent, surface water	30°C	Instantaneous	Continuous	ISO, BS EN or SCA Blue Book Method
W2 on site plan in schedule 7	Biological Oxygen Demand	Process effluent, surface water	100 mg/l	Spot	Weekly	BS EN 1899-1
W2 on site plan in schedule 7	Zinc	Process effluent, surface water	2mg/l	Spot	Weekly	BS 6068-2.29:1987

Table S3.2 Point Source emissions to water (other than sewer) – emission limits and monitoring requirements

Emission point ref. & location	Parameter	Source	Limit (incl. unit)	Reference period	Monitoring frequency	Monitoring standard or method¹
W2 on site plan in schedule 7	Copper	Process effluent, surface water	0.8 mg/l	Spot	Weekly	BS 6068-2.29:1987
W2 on site plan in schedule 7	Nickel	Process effluent, surface water	0.4 mg/l	Spot	Weekly	BS 6068-2.29:1987
W2 on site plan in schedule 7	Lead	Process effluent, surface water	0.8 mg/l	Spot	Weekly	BS 6068-2.29:1987
W2 on site plan in schedule 7	Chromium	Process effluent, surface water	0.8 mg/l	Spot	Weekly	BS EN 1233:1997
W2 on site plan in schedule 7	Flow	Process effluent, surface water	210 Litres/second max	Instantaneous	Continuous	ISO, BS EN or SCA Blue Book Method
W2 on site plan in schedule 7	Flow	Process effluent, surface water	19872 m ³ /day	Instantaneous	Continuous	ISO, BS EN or SCA Blue Book Method
W2 on site plan in schedule 7	Cadmium	Process effluent, surface water	0.01 mg/l	Spot	Weekly	ISO, BS EN or SCA Blue Book Method
W2 on site plan in schedule 7	Mercury	Process effluent, surface water	0.005 mg/l	Spot	Weekly	ISO, BS EN or SCA Blue Book Method
W3 on site plan in schedule 7	No parameters set	Surface water	-	-	-	-

¹Or other ISO, BS EN or SCA Blue Book Method as approved by Natural Resources Wales in writing.

Table S3.3 Annual limits (excluding start up and shut down except where otherwise stated).				
Substance	Medium	Limit (including unit)		Emission Points
Dust, sulphur dioxide and oxides of nitrogen	Air	Assessment year	LCP TNP Limit	A4, LCP312
		01/01/16 and subsequent years until 31/12/19	Emission allowance figure shown in the TNP Register as at 30 April the following year	
		01/01/20-30/06/20	Emission allowance figure shown in the TNP Register as at 31 October 2020	

Table S3.4 Process monitoring requirements				
Emission point reference or source or description of point of measurement	Parameter	Monitoring frequency	Monitoring standard or method	Other specifications
W1a, W1b and W2	Oil and grease	Daily	-	Visual inspection for oil.
Coal delivery	-	-	-	Coal shall be delivered by sea, rail or road.
W2	Free chlorine	-	-	Cooling water shall not be released to water when free chlorine levels are above 0.1mg/l.

Schedule 4 – Reporting

Parameters, for which reports shall be made, in accordance with conditions of this permit, are listed below.

Table S4.1 Reporting of monitoring data			
Parameter	Emission or monitoring point/reference	Reporting period	Period begins
Oxides of nitrogen	A4	Every 3 months for continuous monitoring	1 January, 1 April, 1 July, 1 October
Dust	A4	Every 3 months for continuous monitoring	1 January, 1 April, 1 July, 1 October
Sulphur dioxide	A4	Every 3 months for continuous monitoring	1 January, 1 April, 1 July, 1 October
Emissions to Water Parameters as required by condition 3.5.1	W1a, W1b, W2	Monthly	Permit issue

Table S4.2: Annual production/treatment	
Parameter	Units
Power generated (net)	GWh

Table S4.3 Chapter III Performance parameters for reporting to DEFRA		
Parameter	Frequency of assessment	Units
Thermal Input Capacity for each LCP	Annually	MW
Annual Fuel Usage for each LCP	Annually	TJ
Total Emissions to Air of NO _x for each LCP	Annually	t
Total Emissions to Air of SO ₂ for each LCP	Annually	t
Total Emissions to Air of particulate matter (dust) for each LCP	Annually	t
Operating Hours for each LCP	Annually	h

Table S4.4 Reporting forms				
Media/ parameter	Reporting format	Starting Point	NRW recipient	Date of form
Air & Energy	Form IED AR1 – SO ₂ , NO _x and dust mass emission and energy	01/01/16	SI	31/12/15
Air	Form IED RTA1 –TNP quarterly emissions summary log	01/01/16	SI & TNP Register	31/12/15
LCP	Form IED HR1 – operating hours	01/01/16	SI	31/12/15
Air	Form IED CON 1 – continuous monitoring	01/01/16	SI	31/12/15
CEMs	Form IED CEM – Invalidation Log	01/01/16	SI	31/12/15
LCP	Form IED BD1 – Cumulative annual rolling malfunction and breakdown hours	01/01/16	SI	31/12/15
Air	Form IED MF1 – pollutant concentrations during any day with malfunction or breakdown of abatement plant	01/01/16	SI	31/12/15
Air	Form IED PM1 – discontinuous monitoring and load.	01/01/16	SI	31/12/15
Water	Form water 1 or other form as agreed in writing by Natural Resources Wales	01/01/16	SI	24/10/07

Schedule 5 – Notification

These pages outline the information that the operator must provide.

Units of measurement used in information supplied under Part A and B requirements shall be appropriate to the circumstances of the emission. Where appropriate, a comparison should be made of actual emissions and authorised emission limits.

If any information is considered commercially confidential, it should be separated from non-confidential information, supplied on a separate sheet and accompanied by an application for commercial confidentiality under the provisions of the EP Regulations.

Part A

Permit Number	EPR/LP3131SW
Name of operator	Simec Uskmouth Power Limited
Location of Facility	Uskmouth Power Plant
Time and date of the detection	

(a) Notification requirements for any malfunction, breakdown or failure of equipment or techniques, accident, or emission of a substance not controlled by an emission limit which has caused, is causing or may cause significant pollution	
To be notified immediately	
Date and time of the event	
Reference or description of the location of the event	
Description of where any release into the environment took place	
Substances(s) potentially released	
Best estimate of the quantity or rate of release of substances	
Measures taken, or intended to be taken, to stop any emission	
Description of the failure or accident.	

(b) Notification requirements for the breach of a limit	
To be notified immediately unless otherwise specified below	
Emission point reference/ source	
Parameter(s)	
Limit	
Measured value and uncertainty	
Date and time of monitoring	

(b) Notification requirements for the breach of a limit	
To be notified immediately unless otherwise specified below	
Measures taken, or intended to be taken, to stop the emission	
Time periods for notification following detection of a breach of a limit	
Parameter	Notification period

(c) Notification requirements for the detection of any significant adverse environmental effect	
To be notified immediately	
Description of where the effect on the environment was detected	
Substances(s) detected	
Concentrations of substances detected	
Date of monitoring/sampling	

Part B – to be submitted as soon as practicable

Any more accurate information on the matters for notification under Part A.	
Measures taken, or intended to be taken, to prevent a recurrence of the incident	
Measures taken, or intended to be taken, to rectify, limit or prevent any pollution of the environment which has been or may be caused by the emission	
The dates of any unauthorised emissions from the facility in the preceding 24 months.	

Name*	
Post	
Signature	
Date	

* authorised to sign on behalf of the operator

Part C Malfunction or Breakdown of LCP abatement equipment

Permit Number	
Name of operator	
Location of Facility	
LCP Number	
Malfunction or breakdown	
Date of malfunction or breakdown	

(a) Notification requirements for any malfunction and breakdown of abatement equipment as defined by the Industrial Emission Directive*.	
To be notified within 48 hours of abatement equipment malfunction and breakdown	
Time at which malfunction or breakdown commenced	
Time at which malfunction or breakdown ceased	
Duration of the breakdown event in hours and minutes	
Reasons for malfunction or breakdown	
Where the abatement plant has failed, give the hourly average concentration of all measured pollutants.	
Cumulative breakdown operation in current year (at end of present event)	
Cumulative malfunction operation in current year (at end of present event)	
Name**	
Post	
Signature **	
Date	

* See section 3.6 and Appendix E of ESI Compliance Protocol for guidance

** authorised to sign on behalf of the operator

Schedule 6 – Interpretation

“accident” means an accident that may result in pollution.

“Air Quality Risk Assessment” has the meaning given in Annex D of IED Compliance Protocol for Utility Boilers and Gas Turbines.

“application” means the application for this permit, together with any additional information supplied by the operator as part of the application and any response to a notice served under Schedule 5 to the EP Regulations.

“authorised officer” means any person authorised by Natural Resources Wales under section 108(1) of The Environment Act 1995 to exercise, in accordance with the terms of any such authorisation, any power specified in section 108(4) of that Act.

“background concentration” means such concentration of that substance as is present in:

- for emissions to surface water, the surface water quality up-gradient of the site; or
- for emissions to sewer, the surface water quality up-gradient of the sewage treatment works discharge.

“base load” means: (i) as a mode of operation, operating for >4000hrs pa; and (ii) as a load, the maximum load under ISO conditions that can be sustained continuously, i.e. maximum continuous rating.

“breakdown” has the meaning given in the ESI IED Compliance Protocol for Utility Boilers and Gas Turbines.

“calendar monthly mean” means the value across a calendar month of all validated hourly means.

“CEN” means Comité Européen de Normalisation.

“closure” means closure of all or individual units comprising a large combustion plant in accordance with the guidance provided on closure criteria for large combustion plant subject to the TNP.

“Combustion Technical Guidance Note” means IPPC Sector Guidance Note Combustion Activities, version 2.03 dated 27th July 2005 published by Environment Agency.

“DLN” means dry, low NO_x burners.

“emissions to land” includes emissions to groundwater.

“Energy efficiency” the annual net plant energy efficiency means the value calculated from the operational data collected over the year.

“EP Regulations” means The Environmental Permitting (England and Wales) Regulations SI 2010 No.675 and words and expressions used in this permit which are also used in the Regulations have the same meanings as in those Regulations.

“emissions of substances not controlled by emission limits” means emissions of substances to air, water or land from the activities, either from the emission points specified in schedule 3 or from other localised or diffuse sources, which are not controlled by an emission or background concentration limit.

“FGD” means flue gas desulphurisation.

“groundwater” means all water, which is below the surface of the ground in the saturation zone and in direct contact with the ground or subsoil.

“Industrial Emissions Directive” means DIRECTIVE 2010/75/EU OF THE EUROPEAN PARLIAMENT AND OF THE COUNCIL of 24 November 2010 on industrial emissions.

“large combustion plant” or “LCP” is a combustion plant or group of combustion plants discharging waste gases through a common windshield or stack, where the total thermal input is 50 MW or more, based on net calorific value. The calculation of thermal input, excludes individual combustion plants with a rated thermal input below 15MW.

“low polluting fuels” means biomass or coal with an average as-received sulphur content of less than 0.4% by mass as described in the ESI IED Compliance Protocol for Utility Boilers and Gas Turbines.

“malfunction” has the meaning given in the ESI IED Compliance Protocol for Utility Boilers and Gas Turbines.

“Mid-merit” means combustion plant operating between 1,500 and 4,000 hrs/yr.

“MCERTS” means the Environment Agency’s Monitoring Certification Scheme.

“mcr” means maximum continuous rating.

“MSDL” means minimum shut-down load as defined in Implementing Decision 2012/249/EU.

“MSUL” means minimum start-up load as defined in Implementing Decision 2012/249/EU.

“Natural gas” means naturally occurring methane with no more than 20% by volume of inert or other constituents.

“ncv” means net calorific value.

“NRW” means Natural Resources Wales

“operational hours” are whole hours commencing from the first unit ending start up and ending when the last unit commences shut down.

“quarter” means a calendar year quarter commencing on 1 January, 1 April, 1 July or 1 October.

“SI” means site inspector

“TNP Register” means the register maintained by the Environment Agency in accordance with regulation 4 of the Large Combustion Plants (Transitional National Plan) Regulations 2015 SI2015 No.1973.

Where a minimum limit is set for any emission parameter, for example pH, reference to exceeding the limit shall mean that the parameter shall not be less than that limit.

Unless otherwise stated, any references in this permit to concentrations of substances in emissions into air means:

- in relation to emissions from combustion processes, the concentration in dry air at a temperature of 273K, at a pressure of 101.3 kPa and with an oxygen content of 3% dry for liquid and gaseous fuels, 6% dry for solid fuels; and/or
- in relation to emissions from gas turbine or compression ignition engine combustion processes, the concentration in dry air at a temperature of 273K, at a pressure of 101.3kPa and with an oxygen content of 15% dry for liquid and gaseous fuels; and/or
- in relation to emissions from combustion processes comprising a gas turbine with a waste heat boiler, the concentration in dry air at a temperature of 273K, at a pressure of 101.3kPa and with an oxygen content of 15% dry, unless the waste heat boiler is operating alone, in which case, with an oxygen content of 3% dry for liquid and gaseous fuels; and/or
- in relation to emissions from non-combustion sources, the concentration at a temperature of 273K and at a pressure of 101.3 kPa, with no correction for water vapour content.

“year” means calendar year ending 31 December.

Schedule 7 – Site plan

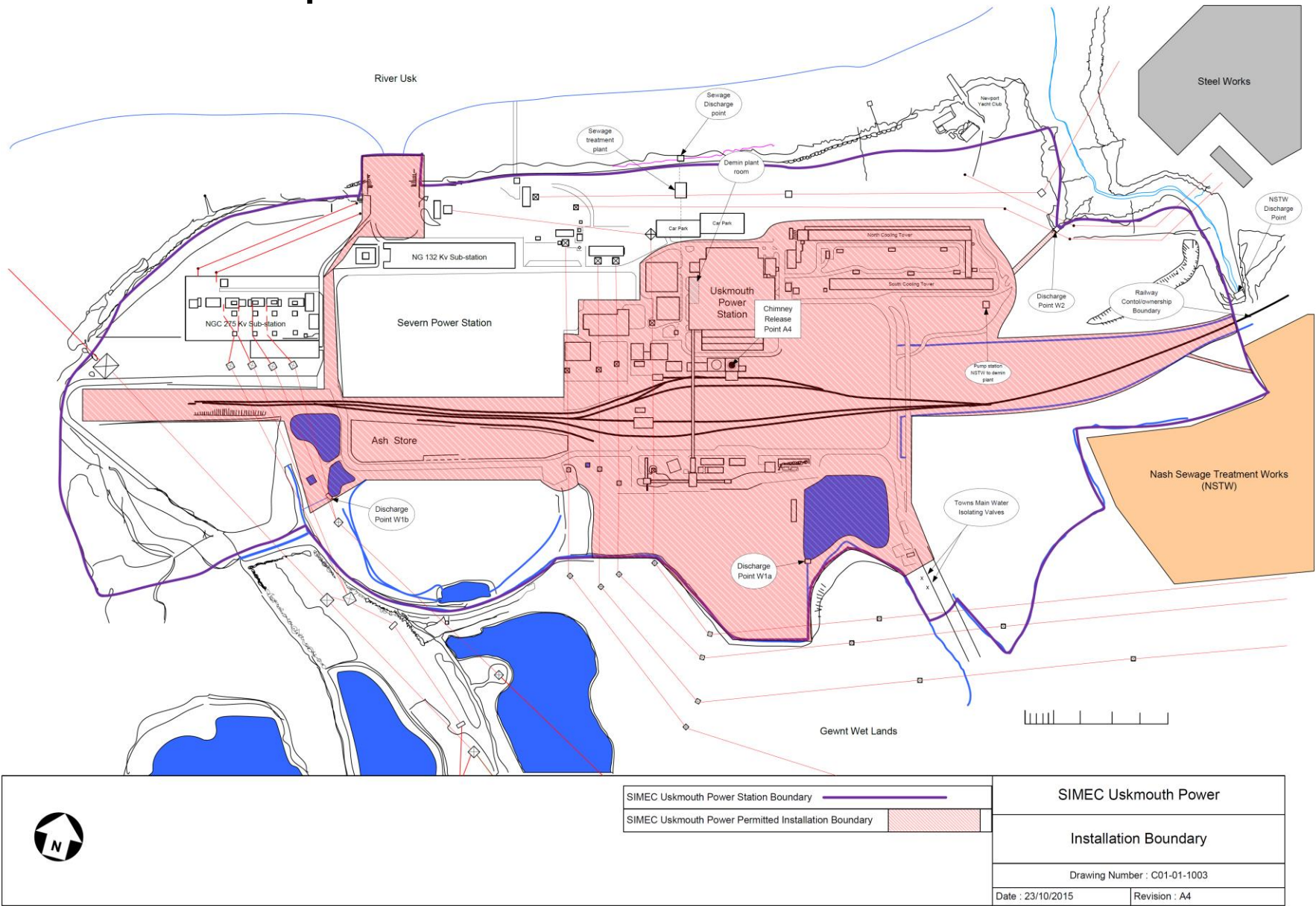

END OF PERMIT