

ENVIRONMENTAL PROTECTION ACT 1990. SITE LICENCE.

LICENCE REF No: EAWML/34235

FACILITY TYPE: Vehicle Depollution & Dismantling
(Authorised Treatment) Facility

The Environment Agency, in pursuance of Part II of the Environmental Protection Act 1990 and Regulation 45 of The End-of-Life Vehicles Regulations 2003, hereby grant a site licence authorising the keeping and treating of controlled waste on the land specified in schedule 1 to this licence to **Mr. David Jonathan Evans**, that person being in occupation of the said land, the said licence being subject to the conditions specified in schedule 2 to this licence.

SCHEDULE 1.- SPECIFIED LAND.

The licence relates to the land at **Units 7a/7b, 12/12a and 14 Players Industrial Estate, Clydach, Swansea SA6 5BQ** (hereinafter called "the site") shown edged red on Drawing Reference Number **DJE/001**, and attached to this licence.

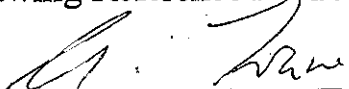
Signed 
Authorised to sign on behalf of the Environment Agency

Name:- **Audrey Evans**
Team Leader

Dated 30th June 2005

FOR ENVIRONMENT AGENCY OFFICIAL USE ONLY.

YOUR ATTENTION IS DRAWN TO THE RIGHTS OF APPEAL DETAILED IN THE NOTES AT THE
END OF THIS LICENCE.

ENVIRONMENTAL PROTECTION ACT 1990. SITE LICENCE.

LICENCE REF No: EAWML/34235

FACILITY TYPE: Vehicle Depollution & Dismantling
(Authorised Treatment) Facility

The Environment Agency, in pursuance of Part II of the Environmental Protection Act 1990 and Regulation 45 of The End-of-Life Vehicles Regulations 2003, hereby grant a site licence authorising the keeping and treating of controlled waste on the land specified in schedule 1 to this licence to **Mr. David Jonathan Evans**, that person being in occupation of the said land, the said licence being subject to the conditions specified in schedule 2 to this licence.

SCHEDULE 1.- SPECIFIED LAND.

The licence relates to the land at **Units 7a/7b, 12/12a and 14 Players Industrial Estate, Clydach, Swansea SA6 5BQ** (hereinafter called "the site") shown edged red on Drawing Reference Number **DJE/001**, and attached to this licence.

Signed _____
Authorised to sign on behalf of the Environment Agency

Name:- **Audrey Evans**
Team Leader

Dated 30th June 2005

FOR ENVIRONMENT AGENCY OFFICIAL USE ONLY.

**YOUR ATTENTION IS DRAWN TO THE RIGHTS OF APPEAL DETAILED IN THE NOTES AT THE
END OF THIS LICENCE.**

EXPLANATORY NOTES - including rights of appeal.

RIGHTS OF APPEAL

Section 43(1) of the Environmental Protection Act 1990 provides that:

Where, except in pursuance of a direction given by the Secretary of State, a licence is granted subject to conditions, the applicant may appeal from the decision to the Secretary of State.

Therefore, if you feel aggrieved by the decision detailed on the attached notice, you may obtain the appropriate form on which to give written notice of an appeal from:-

The Planning Inspectorate
Room 4/19
Eagle Wing, Temple Quay House
2 The Square
Temple Quay
Bristol
BS1 6PN

Tel: 0117 372 8812
Fax: 0117 372 6093

For Wales, the address is:
The Planning Inspectorate
National Assembly for Wales
Environmental Protection Division
Crown Buildings
Cardiff
CF10 3NQ

Tel: 02920 823859
Fax: 02920 825150

This notice of appeal should be accompanied by the following information:

a statement of the grounds of appeal;

a copy of the licence;

a copy of any correspondence relevant to the appeal;

a copy of any other document relevant to the appeal including, in particular, any relevant consent, determination, notice, planning permission, established use certificate or certificate of lawful use or development and

a statement indicating whether you wish the appeal to be in the form of a hearing or on the basis of written representations.

You are also required to serve a copy of your notice of appeal, together with copies of any the above documents that have accompanied your notice of appeal, on the Environment Agency (at the address overleaf). You should appeal within 6 months of the date that this notice takes effect but the Secretary of State may allow notice of appeal to be given after the expiry of this time period.

Schedule 2: Conditions

1 General considerations

1.1 **Application of conditions to all waste motor vehicles**

- 1.1.1 The conditions of this licence apply to the recovery (including storage) of all waste motor vehicles as defined by regulation 50 of the End-of-life Vehicles Regulations 2003.

1.2 **Technical Requirements for the Treatment and Storage of waste motor vehicles**

- 1.2.1 The storage (including temporary storage) and treatment of waste motor vehicles shall only be carried out at the site if it meets the standards set out in Schedule 5 of the End-of-life Vehicles Regulations 2003.
- 1.2.2 Storage and treatment operations of waste motor vehicles shall meet the requirements of Schedule 5 of the ELV Regulations. Infrastructure and equipment provided to meet these obligations shall be maintained in working order and shall be used to give effect to their purpose.
- 1.2.3 The removal of coolants from air-conditioning units shall be in accordance with the "Guidance on the Recovery and Disposal of Controlled Substances Contained in Refrigerators and Freezers" published by the Environment Agency.

2 Specific considerations

2.1 **Specified waste motor vehicle storage and treatment operations**

- 2.1.1 The Operator is authorised to carry out the activities specified in Table 2.1

2.2 **Specified Waste Management Operations & Exempt Waste Management Operations**

- 2.2.1 Where wastes are being brought onto the site for waste management operations which are exempt from licensing under the 1994 Regulations, then the wastes which are subject to the specified waste management operations shall be kept clearly segregated and identified from those wastes which are being kept on the site for the exempt waste management operations.

Table 2.1 Specified end-of-life vehicle storage and treatment operations

Specified Operation	Permitted Waste Types (and European Waste Catalogue number) which may be subject to the Specified Operation	Limits on Specified Operations
<u>STORAGE</u>		
R13: Storage of wastes pending any of the operations numbered R1 to R12 (excluding temporary storage, pending collection, on the site where it is produced).	(i) 16 01 04 End of life vehicles **	<ul style="list-style-type: none"> Maximum storage capacity 100 vehicles stored on an Impermeable Pavement with a sealed drainage system at any one time. Vehicles shall only be stored on the area marked on the site plans attached to this licence .
D15: Storage of wastes pending any of the operations numbered D1 to D14 (excluding temporary storage, pending collection, on the site where it is produced	(ii) 16 01 06 End of life vehicles (containing neither liquids nor other hazardous components)	<ul style="list-style-type: none"> Maximum storage capacity 1000 vehicles at any one time.
	(iii) Residual wastes produced as a result of depollution or further treatment	<ul style="list-style-type: none"> Maximum storage capacity 50 tonnes, not exceeding 10 tonnes of hazardous waste. At any one time. Residual wastes arising from depollution of vehicle shall only be stored on the area marked on the site plans attached to this licence . Maximum storage time of 1 year prior to disposal or 3 years prior to recovery <p>The overall maximum storage capacity shall not exceed 1100 vehicles and 50 tonnes of residual waste, not exceeding 10 tonnes of hazardous waste removed from depolluted vehicles</p>
<u>TREATMENT</u>		
R3: Recycling / reclamation of metals and metal compounds:	(i) 16 01 04 End of life vehicles **	<ul style="list-style-type: none"> 40 vehicles per week Treatment of vehicles shall only be carried out on the area marked on the site plans attached to this licence .
R4: Recycling / reclamation of other inorganic materials	(ii) 16 01 06 End of life vehicles containing neither liquids nor other hazardous components)	<ul style="list-style-type: none"> 40 vehicles per week Treatment of vehicles shall only be carried out on the area marked on the site plans attached to this licence . <p>The overall annual through put of the site shall not exceed 2500 tonnes.</p>

EWC entries marked with a ** may be hazardous depending on threshold concentrations. Please refer to Agency Technical Guidance WM2 or subsequent guidance for further advice

2.3 **Fit and proper person**

2.3.1 Any changes in the technically competent management of the site, the name of any incoming person and evidence that such a person has the required technical competence, shall be submitted to the Agency in writing within 5 working days of the change in management.

2.3.2 In the event of the Licence Holder being convicted of any relevant offence and which is in addition to any already notified to the Agency, then full details shall be provided to the Agency within 14 days following sentencing, whether or not the conviction or sentence is subsequently appealed. Such details shall include the nature of the offence, the place and date of conviction, and any fine or other penalty imposed.

2.3.3 In the event that the Licence Holder lodges an appeal against any such conviction, the Licence holder shall notify the Agency of this within 14 days of the lodging. The Licence Holder shall notify the Agency of the results of that appeal within 14 days of the appeal being decided.

2.4 **Notification of change of operator's or holder's details**

2.4.1 The following information shall be notified in writing within 5 working days to the Agency:

- a** any change in the Licence Holder's name(s) or address(es);
- b** the operator at the time of issue of the licence and of any change in the operator or in the operator's trading name, address, registered name or registered office address (if different from the Licence Holder);

2.5 **Notifications and submissions to the Agency**

2.5.1 Except where otherwise specified, all notifications and submissions to the Agency under the requirements of these licence conditions:

- a** shall be made in writing to the address specified by the Agency in writing at the time of issue of this licence, or as subsequently specified by written notification to the Licence Holder
- b** shall quote the licence reference number and the name of the Licence Holder.

3 Site engineering for pollution prevention & control

3.1 **Engineering site containment & drainage systems**

Provision & maintenance of site containment & drainage systems

3.1.1 No waste shall be deposited, stored, treated or otherwise handled in any area of the site until the engineered site containment and drainage system for that area has been constructed and completed in accordance with condition 3.1.2. Unless authorised in writing by the Agency.

3.1.2 The engineered site containment and drainage systems shall be designed, constructed, inspected, validated and maintained, and shall be fully documented and recorded, to be fit for purpose and meet the standards specified in Table 3.1 below.

Table 3.1 Site containment & drainage standards

Type of Site Surface & Drainage	Minimum Specified Standards of Design, Construction & Maintenance
a) Hardstanding	<p>Areas of hardstanding shall be constructed of granular material (e.g. crushed stone, aggregate, road planings or other similar material) and maintained such that the working surface:</p> <ul style="list-style-type: none"> i) shall remain even ii) shall not be subject to settlement or differential settlement iii) shall not be subject to rutting by vehicles even when wet iv) shall have sufficient durability to allow cleaning for example by scraping v) shall remain free of standing water.
b) Impermeable pavement, bunding and sills	<p>Areas of impermeable pavement, bunding and sills shall be constructed and maintained so as to prevent fluids running off the pavement and the transmission of fluids through the pavement or joints.</p> <p>Where there is a risk of chemical corrosion, areas of impermeable pavement, kerbs, bunds and sills shall be provided with suitable resistance to minimise such corrosion.</p>
c) Sealed drainage systems	<p>Drainage to areas of impermeable pavement shall be provided by a sealed drainage system, that is comprised of a drainage system with impermeable components which does not leak and which will ensure that:-</p> <ul style="list-style-type: none"> • no liquid will run off the pavement other than via the system; and • except where they may be lawfully discharged, all liquids entering the system are collected in a sealed sump. <ul style="list-style-type: none"> i) Sealed sumps shall be inspected no less frequently than daily and after rain, emptied when the collected liquids reach 80% of the capacity of the sump as measured using a dipstick or equivalent gauge, and constructed and maintained so as to collect and contain all liquids which run off the pavement; ii) Inspections and emptying of sealed sumps shall be recorded in the site diary. iii) Uncontaminated drainage from clean yard areas shall be kept separate and discharged to either surface water or sewer or watercourse or soakaway.
d) Covered buildings or roofed areas	<p>Where wastes are stored in a building:</p> <ul style="list-style-type: none"> i) the building shall be designed, constructed and maintained to prevent ingress of rain and surface water. ii) roof water shall be kept separate from contaminated water and other liquids and shall be discharged to either surface water or a sewer or a water course or a soakaway.
e) Fixed bays	<p>Fixed bays and other fixed containers used for the storage and treatment of wastes must be constructed and maintained to a standard which is fit for purpose.</p>
f) Storage areas for tanks, skips, drums and other containers	<p>All tanks, skips, drums and other containers which are used for the storage or treatment of wastes shall be constructed and maintained so that they do not leak any liquids contained in them.</p> <p>All tanks (and their associated inlet and outlet pipes and valves) which are used for the storage or treatment of wastes shall be stored within a bunded or silled area with impermeable pavement, which shall be isolated from the drainage system and shall meet the following specifications:</p> <ul style="list-style-type: none"> • The bunded or silled area shall be designed and constructed to contain 110%

Table 3.1 Site containment & drainage standards

Type of Site Surface & Drainage	Minimum Specified Standards of Design, Construction & Maintenance
	<p>of the volume of the largest container or tank.</p> <ul style="list-style-type: none"> The bunded or silled area shall be inspected no less frequently than weekly and after rain and shall be emptied so as to maintain a capacity of 110% of the volume of the largest container or tank. Rainwater shall be removed by bailing or pumping and shall be treated as contaminated water and disposed of to either an approved discharge or a suitably licensed or permitted facility.
g) Inspection and maintenance of engineered containment	<p>All areas of hardstanding, impermeable pavement, sealed drainage systems, covered buildings, roofed areas, fixed bays and storage areas for tanks, skips, drums and other containers:</p> <p>i) shall be inspected no less frequently than monthly, to ensure the continuing integrity and fitness for purpose of their construction, and the inspection and any necessary maintenance shall be recorded in the site diary; and</p> <p>ii) in the event of any damage occurring which breaches the integrity of the engineered containment so that it no longer meets the specified standards, the Licence Holder shall cease importing waste into or treating waste in the affected area, shall notify the Agency immediately, and shall not recommence importing waste into or treating waste in the affected area until it has been repaired to a standard at least as good as the original specification.</p>

*Construction quality assurance of **new** site containment & drainage systems*

- 3.1.3 No wastes shall be deposited, stored, treated or otherwise handled in any area or any fixed tank for which an engineered site containment and drainage system is to be newly constructed to meet the requirements of this condition until:
- a** details of the identities, relevant experience and relevant qualifications of the personnel who will be providing Quality Assurance of the engineered site containment and drainage systems have been submitted in writing to the Agency and acknowledged in writing by the Agency;
 - b** the engineered site containment and drainage system has been constructed in accordance with the other requirements of condition 3.1;
 - c** the Validation Report on the construction of the engineered site containment and drainage system has been submitted in writing to the Agency, and the Agency has confirmed in writing that it has no objection to the placement of wastes on that containment area.

*Construction quality assurance of **existing** site containment & drainage systems*

- 3.1.4 No wastes shall be deposited, stored, treated or otherwise handled in any area or any fixed tank for which a previously constructed and existing engineered site containment and drainage system is being used to meet the requirements of this condition unless:

- a** details of the identities, relevant experience and relevant qualifications of the suitably qualified Engineer who will be providing inspection and validation of the existing engineered site containment and drainage systems have been submitted in writing to the Agency and acknowledged in writing by the Agency;
- b** the engineered site containment and drainage system for that area has been inspected by the designated Engineer and has been maintained or improved, in accordance with their recorded advice, to be fit for purpose in that:
 - i** areas of impermeable pavement are laid to take weight of relevant vehicles, plant and equipment without cracking or breaking; and
 - ii** areas of impermeable pavement are free from cracks which could increase permeability; and
 - iii** areas of impermeable pavement are resistant to mechanical, physical and chemical stresses to which they may be subjected; and
 - iv** areas of impermeable pavement fall towards the drainage system to prevent ponding; and
 - v** no liquid will run off areas of impermeable pavement other than via the drainage system; and
 - vi** the drainage system is sealed so that it does not leak and is capable of collecting and containing liquids draining from the impermeable pavement ; and
 - vii** liquid from the drainage system is disposed of to an approved discharge.

3.1.5 The existing engineered site containment and drainage system shall be maintained in accordance with the recommendations of the designated engineer and the requirements of Table 3.1.

4 Site infrastructure

4.1 Site security

4.1.1 All reasonable precautions must be taken to ensure that the site shall be secure and that no waste may escape from it.

4.2 Provision of site identification board

4.2.1 No end-of-life vehicles shall be received at the site unless an identification board is provided at or near the site entrance.

4.2.2 The board shall be easily readable from outside the site entrance in daylight hours, and shall display the following information:

- a** Site name and address;
- b** Licence Holder name (company name, not individual name unless justified as necessary);
- c** Operator name (company name, not individual name unless justified as necessary);
- d** Licence number;

- e** Emergency contact name and telephone number (for security reasons, personal names and home phone numbers should not be used);
- f** Statement that the site is an Authorised Treatment Facility, licensed by the Environment Agency;
- g** Agency national numbers: 08708 506506 and 0800 807060 (or any other number subsequently notified in writing by the Agency);
- h** Days and hours the site is open to receive waste.

5 Site operations

5.1 Leaks & spillages

Potentially polluting leaks & spillages from vehicles, plant & equipment

- 5.1.1 All vehicles used on the site by the operator, and all plant and all equipment used on the site in connection with specified waste management operations, shall be operated and maintained with the objective of preventing potentially polluting leaks and spillages of wastes or other potentially polluting materials which are to be used in combination with those wastes in the specified waste management operations.

Potentially polluting leaks & spillages from tanks, skips, drums & other containers

- 5.1.2 Each tank, skip, drum or other container used to hold wastes which consist of or contain end of life vehicle fluids or hazardous residual wastes, or other potentially polluting materials which are to be used in combination with those wastes in the specified waste management operations shall be:

- a** loaded and unloaded in accordance with the handling procedures specified in Table 5.1;
- b** filled and emptied in accordance with the filling and emptying procedures specified in Table 5.1;
- c** clearly and unambiguously labelled regarding its contents, unless the contents are clearly identifiable by visual inspection;
- d** inspected and maintained according to the maintenance schedules and procedures specified in Table 5.1, which shall be fully documented and recorded;
- e** in the event of damage or deterioration to a container that is, or is likely to cause, a leak, that container shall be repaired or replaced immediately.

Control & remediation of leaks & spillages

- 5.1.3 All areas of impermeable pavement shall be provided with suitable cleanser-degreaser equipment.
- 5.1.4 In the event of any potentially polluting leak or spillage occurring on site, documented control and remediation procedures shall be implemented immediately and recorded, and shall meet the standards specified in Table 5.1 below.

Table 5.1 Standards for prevention & control of leaks and spillages

Action	Specified standards
a) Loading and unloading skips, drums and other containers	<p>i) Loading and unloading of skips, drums and other containers shall be supervised at all times by a member of staff.</p> <p>ii) Lids/ caps/ bungs or other closures shall be in place during loading/ unloading.</p> <p>iii) Loading/ unloading shall be carried out in an area provided with engineered containment of the type required for that waste and of the standard of containment specified under condition 3.1.</p>
b) Filling and emptying, tanks, drums and other containers	<p>i) Filling and emptying of tanks, drums and other containers shall be supervised at all times by a member of staff.</p> <p>ii) Lids/ caps/ bungs or other closures shall be in place at the end of filling</p> <p>iii) Containers, tanks and drums shall not be filled beyond their operational capacity.</p> <p>iv) Filling and emptying shall be carried out in a bunded area maintained in accordance with condition 3.1</p> <p>v) Measurement of level/ void space shall be by physical dipping prior to loading.</p>
c) Inspection, maintenance and repair of skips, tanks, drums and other containers	<p>i) Skips, tanks, drums and other containers shall be inspected daily for leaks.</p> <p>ii) Any fixed tanks found to be leaking shall have their contents immediately transferred to an alternative appropriate tank or container.</p> <p>iii) Any skips, drums and/or other containers found to be leaking either shall be immediately transferred to a larger appropriate over-container or shall have their contents immediately transferred to an alternative appropriate tank or container.</p>
d) Control and remediation of leaks and spillages	<p>i) Minor spillages of oil, fuel or other end of life vehicle fluid shall be cleaned up immediately, using sand or proprietary absorbent to clean up liquids and placed in alternative containers.</p> <p>ii) Major spillages of oil, fuel or other end of life vehicle fluid which are causing or are likely to cause polluting emissions to the environment:</p> <ul style="list-style-type: none">• Immediate action shall taken to contain the spillage and prevent liquid from entering surface water drains, water courses and unsurfaced ground;• the spillage shall be cleared immediately and placed in alternative appropriate containers;• the Agency shall be informed immediately.

5.2 **Fires on the site**

Prohibition of fires on site

- 5.2.1 No wastes shall be burned on the site.

Actions to be taken in the event of a fire

- 5.2.2 In the event of a fire on the site, immediately following taking action to suppress and extinguish the fire, the following actions shall be implemented immediately and recorded in the site diary:

- a** the Agency shall be informed of the fire; and
- b** so far as practicable, contaminated site drainage shall be prevented from entering any surface water drain or water course or unsurfaced ground.

5.3 **Waste acceptance & control procedures**

Waste acceptance procedures

- 5.3.1 All wastes shall be received, inspected, accepted or rejected, and recorded in accordance with the standards specified in Table 5.3 below.

Waste control procedures

- 5.3.2 All wastes accepted at the site shall be handled, kept and recorded in accordance with the standards specified in Table 5.3 below.

Waste despatch procedures

- 5.3.3 All outgoing wastes shall be inspected, despatched and recorded in accordance with the standards specified in Table 5.3 below.

Table 5.3 Standards for waste acceptance and control procedures

Stage of Waste Handling	Specified standards
a) Waste inspection	<p>All vehicles received at the site:</p> <p>i) Shall be inspected on receipt to confirm their description and depollution status against the relevant waste transfer note and any other accompanying documentation.</p> <p>ii) Shall be kept segregated from depolluted vehicles until they either been confirmed and recorded as previously having been depolluted or alternatively have been depolluted on site in accordance with the standards set out in Schedule 5 of the End-of-life Vehicles Regulations 2003.</p>
b) Waste control procedures: quarantine storage and rejection of wastes	<p>i) Any items of non-permitted waste which are detected after acceptance at the site, shall be placed immediately in a designated quarantine container, as marked on site plans attached to this licence, and, where these are or appear to be special wastes, the Agency shall be informed immediately;</p> <p>ii) In the quarantine area, wastes shall be kept segregated from other wastes which are or are likely to be incompatible;</p> <p>iii) Quarantined wastes shall be removed from site within 7 days;</p> <p>iv) The maximum quantity of wastes kept in the quarantine storage area shall be 4.6m³ at any one time.</p> <p>v) A record shall be kept in the site diary of all rejected wastes and all wastes kept in quarantine storage.</p>
c) Identification of wastes	<p>Storage areas, tanks and other containers shall be clearly defined and labelled to identify the wastes stored within them, and shall be located on the area so marked on the site plans attached to this licence.</p>
d) Waste despatch procedures	<p>All wastes despatched from the site shall be inspected prior to despatch to confirm their description and composition.</p>
e) Incompatible wastes	<p>Incompatible wastes that are likely, in combination with each other or with other material at the facility, to give rise to pollution of the environment or harm to human health outside the site, shall be clearly identified and kept physically separate in designated areas.</p>

5.4

Handling and storage of residual wastes

5.4.1

Residual wastes shall only be handled and stored on the site in accordance with the standards specified in Table 5.4 below.

Table 5.4 Standards for handling and/or storage of residual wastes

Storage requirement	Specified standards
a) End of life vehicle fluids	<p>i) Unless otherwise agreed in writing with the Environment Agency, all fluids drained from vehicles shall be segregated by type and stored in separate, appropriate tanks which are fit for purpose. The tanks shall be clearly and unambiguously labelled regarding their contents.</p> <p>ii) Fluids shall only be stored in areas provided with an impermeable pavement and a sealed drainage system provided in accordance with condition 3.1 at the location marked on the site plans attached to this licence .</p>
b) Batteries, oil filters, oil contaminated parts, PCB/PCT containing condensers, components identified as containing mercury and brake pads containing asbestos.	<p>i) Once removed from vehicles, these components shall be segregated by type and stored within dedicated appropriate containers which are fit for purpose. The containers shall be clearly and unambiguously labelled regarding their contents.</p> <p>ii) These components shall only be stored in areas provided with an impermeable pavement and a sealed drainage system.</p> <p>iii) Lead acid batteries shall be stored in containers with an impermeable, acid resistant base and a lid to prevent ingress of surface water.</p>
c) Tyres, air bags and liquefied gas tanks.	<p>i) Once removed from vehicles, these waste types shall be stored in separately designated areas, as marked on the site plans attached to this licence . Impermeable pavement provided with a sealed drainage system in accordance with condition 3.1</p> <p>ii) Tyres shall be stored in stable stacks with individual capacities of no greater than 50 cubic metres and to a height of no greater than 3 metres Individual tyre stacks shall not be stored within 6 metres of each other or otherwise recommended by the Fire Service</p> <p>iii) Individual tyre stacks shall not be stored within 5 metres of the site boundary or 15 metres of a building</p> <p>iv) Tyre stacks shall not be located within 10 metres of any area used for flame cutting operations.</p>
d) Uncontaminated plastic, glass and ferrous and non-ferrous metal wastes arising from the treatment of end of life vehicles	<p>i) These materials shall be stored in areas with hardstanding or impermeable pavement.</p>

Site records

6.1 **Records of waste movements**

- 6.1.1 A summary of the waste types and quantities accepted and the waste types and quantities removed from the site shall be made for each financial year and shall be submitted to the Agency within 1 month following the end of that year. The summary record shall be in the format specified in Appendix B, and shall include the specified information.

6.2 **Site diary**

- 6.2.1 A site diary shall be kept secure and shall be available for inspection at the site when required by an authorised officer of the Agency. This shall include a record of the following events, in accordance with the other conditions of this licence:

- a** construction work
- b** maintenance
- c** breakdowns
- d** emergencies
- e** problems with waste received and action taken
- f** technically competent management attendance on site: the date and the time onto site and the time left site
- g** complaints about site operations and actions taken
- h** environmental problems and remedial actions

- 6.2.2 Each record shall be completed within 24 hours of the relevant event.

Interpretation

In this permit the following expressions shall have the following meanings:

"Impermeable surface" means a surface or pavement constructed and maintained to a standard sufficient to prevent the transmission of liquids beyond the pavement surface, and should be read in conjunction with the term "sealed drainage system" (below).

"Sealed drainage system" in relation to an impermeable pavement, means a drainage system with impermeable components which does not leak and which will ensure that:

- (a) no liquid will run off the pavement otherwise than via the system;
- (b) except where they may lawfully be discharged, all liquids entering the system are collected in a sealed sump

"Secure": A place is secure in relation to end-of-life vehicles or waste kept in it if all reasonable precautions are taken to ensure that the end-of-life vehicles, their contents or waste cannot escape from it.

"Technically competent management", "technical competence" and "relevant person" shall be as defined under Section 74, Environmental Protection Act 1990.

"ELV Regulations" means the End of Life Vehicles Regulations 2003 SI 2635.

"End-of-life Vehicles Directive" means Directive 2000/53/EC on end-of life vehicles.

"waste motor vehicle" means a motor vehicle of any type that is waste and includes an end-of-life vehicle.

"Residual wastes produced as a result of depollution or further treatment" means those waste that are removed from vehicles during depollution or further treatment which consist of any wastes specified in the following table:

Appendices to conditions

Appendix A: EWC Catalogue Numbers (Condition 2.1)

Residual wastes as a result of depollution or subsequent treatment	
Waste type	Waste Categories and European Waste Catalogue No.
Vehicle batteries	16 06 01 lead batteries *
	16 06 05 other batteries and accumulators *
Oil filters	16 01 07 oil filters *
PCB/PCT containing condensers	16 01 09 components containing PCBs **
	16 01 21 hazardous components (other than those mentioned in 16 01 07 to 16 01 11 and 16 01 13 and 16 01 14) **
Components identified as containing mercury	16 01 08 components containing mercury **
Brake pads	16 01 11 brake pads containing asbestos **
	16 01 12 brake pads other than those mentioned in 16 01 11
Tyres	16 01 03 end-of-life tyres
Air bags	16 01 10 explosive components (for example air bags) *
Liquefied gas tanks	16 01 16 tanks for liquefied gas
End of life vehicle fluids:	
Hydraulic Oils	13 01 09 Mineral based chlorinated hydraulic oils *
	13 01 10 Mineral based non-chlorinated hydraulic oils *
	13 01 11 Synthetic hydraulic oils *
	13 01 12 Readily biodegradable hydraulic oils *
	13 01 13 Other hydraulic oils *
Engine, gear and lubricating oils	13 02 04 Mineral based chlorinated engine, gear and lubricating oils *
	13 02 05 Mineral based non-chlorinated hydraulic oils *
	13 02 06 synthetic engine, gear and lubricating oils *
	13 02 07 readily biodegradable engine, gear and lubricating oils *
	13 02 08 other engine, gear and lubricating oils *
Fuel	13 07 01 Fuel oil and diesel *
	13 07 02 Petrol *
	13 07 03 Other fuels (including mixtures) *
Air conditioning fluids	14 06 01 Chlorofluorocarbons, HCFC, HFC *
	14 06 02 Other halogenated solvents and solvent mixtures *
	14 06 03 Other solvents and solvent mixtures *
Brake fluids	16 01 13 Brake fluids *
Antifreeze fluids	16 01 14 Antifreeze fluids containing dangerous substances **
	16 01 15 Antifreeze fluids other than those mentioned in 16 01 14
Any other fluid contained in the end of life vehicle	16 01 22 Components not otherwise specified
Plastic, glass and ferrous and non-ferrous metal wastes arising from the treatment of end of life vehicles	16 01 17 Ferrous Metal
	16 01 18 Non-ferrous metal
	16 01 19 Plastic
	16 01 20 Glass

EWC entries marked with a * are hazardous wastes

EWC entries marked with a ** may be hazardous depending on threshold concentrations. Please refer to Agency Technical Guidance WM2 or subsequent guidance for further advice

**Appendix B: Format for summary records of wastes accepted and removed
(Condition 6.1)**

ENLARGED:

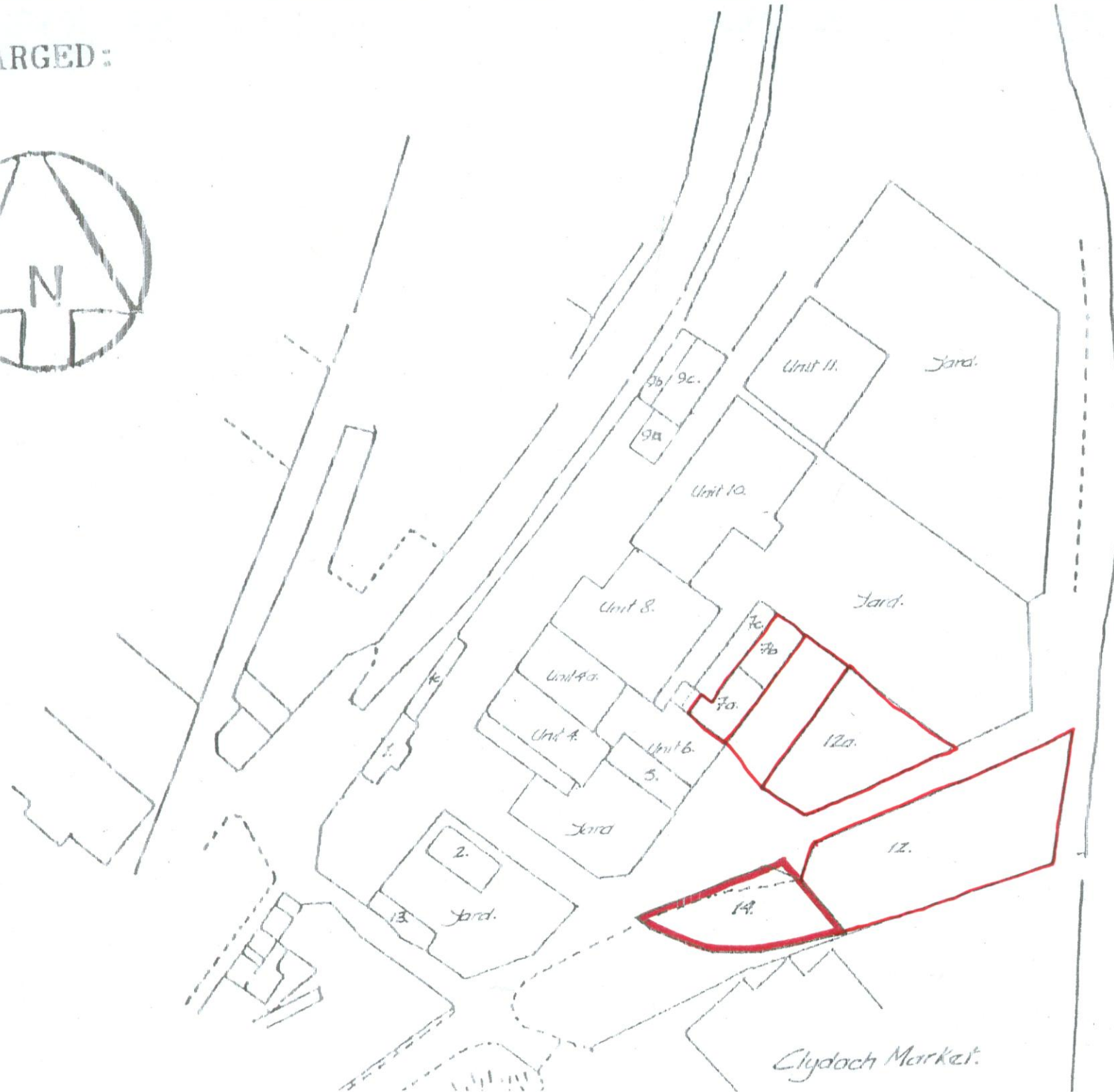
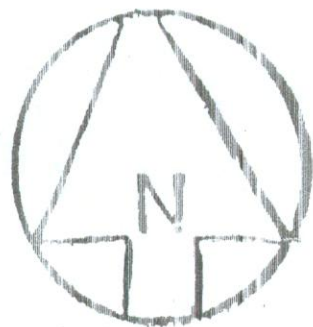

DJE/001

UNIT 12

STORAGE SHEDS

HARDSTANDING

FOR

DISMANTLING

OF

VEHICLES

OPEN STORAGE

FOR

VEHICLES

PLAN REFERRED TO

FOR IDENTIFICATION ONLY

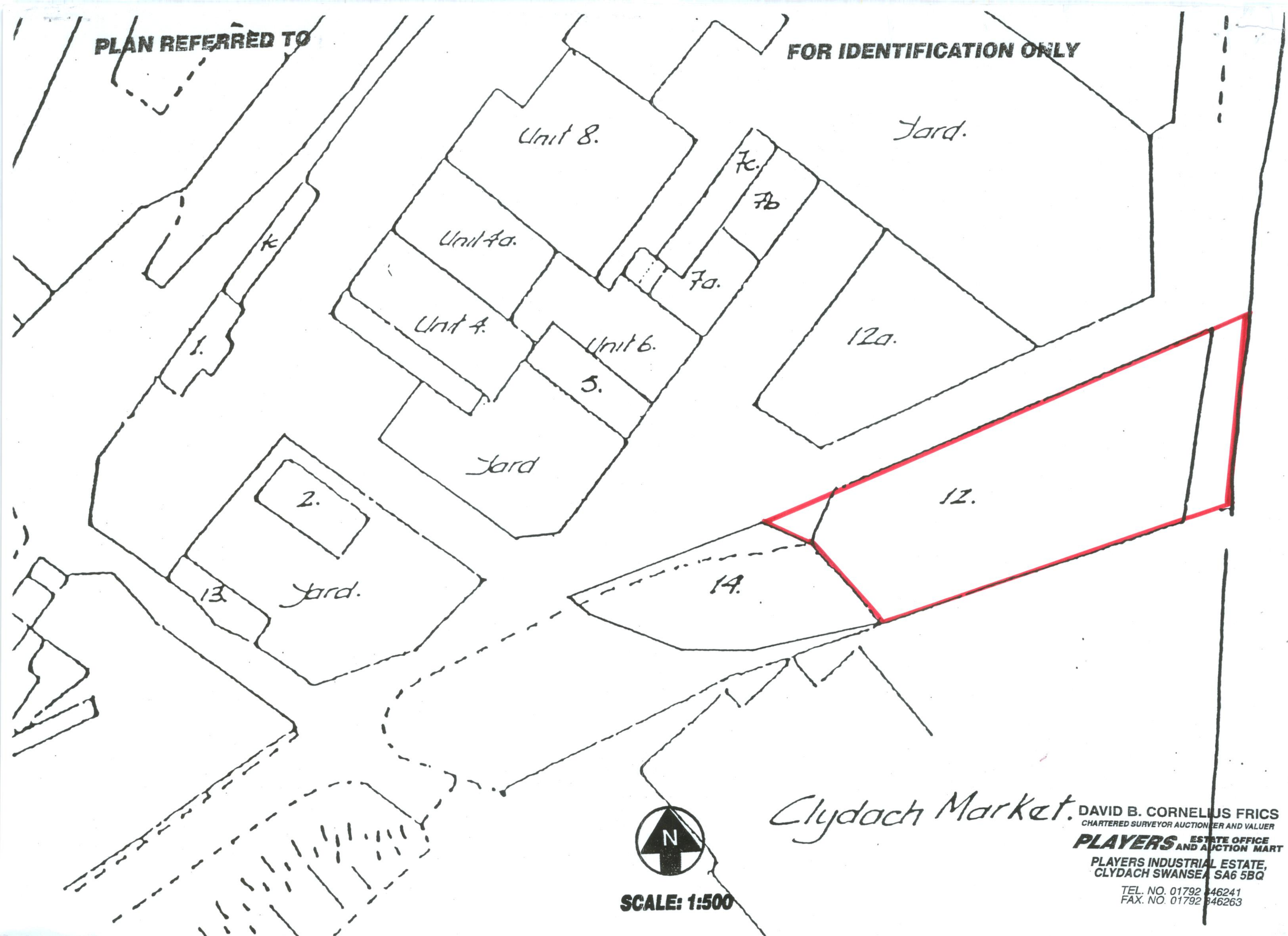

SCALE: 1:500

Clydach Market.

DAVID B. CORNELIUS FRICS
CHARTERED SURVEYOR AUCTIONEER AND VALUER
PLAYERS ESTATE OFFICE
AND AUCTION MART
PLAYERS INDUSTRIAL ESTATE,
CLYDACH SWANSEA SA6 5BQ

TEL. NO. 01792 46241
FAX. NO. 01792 46263

UNIT 12A.

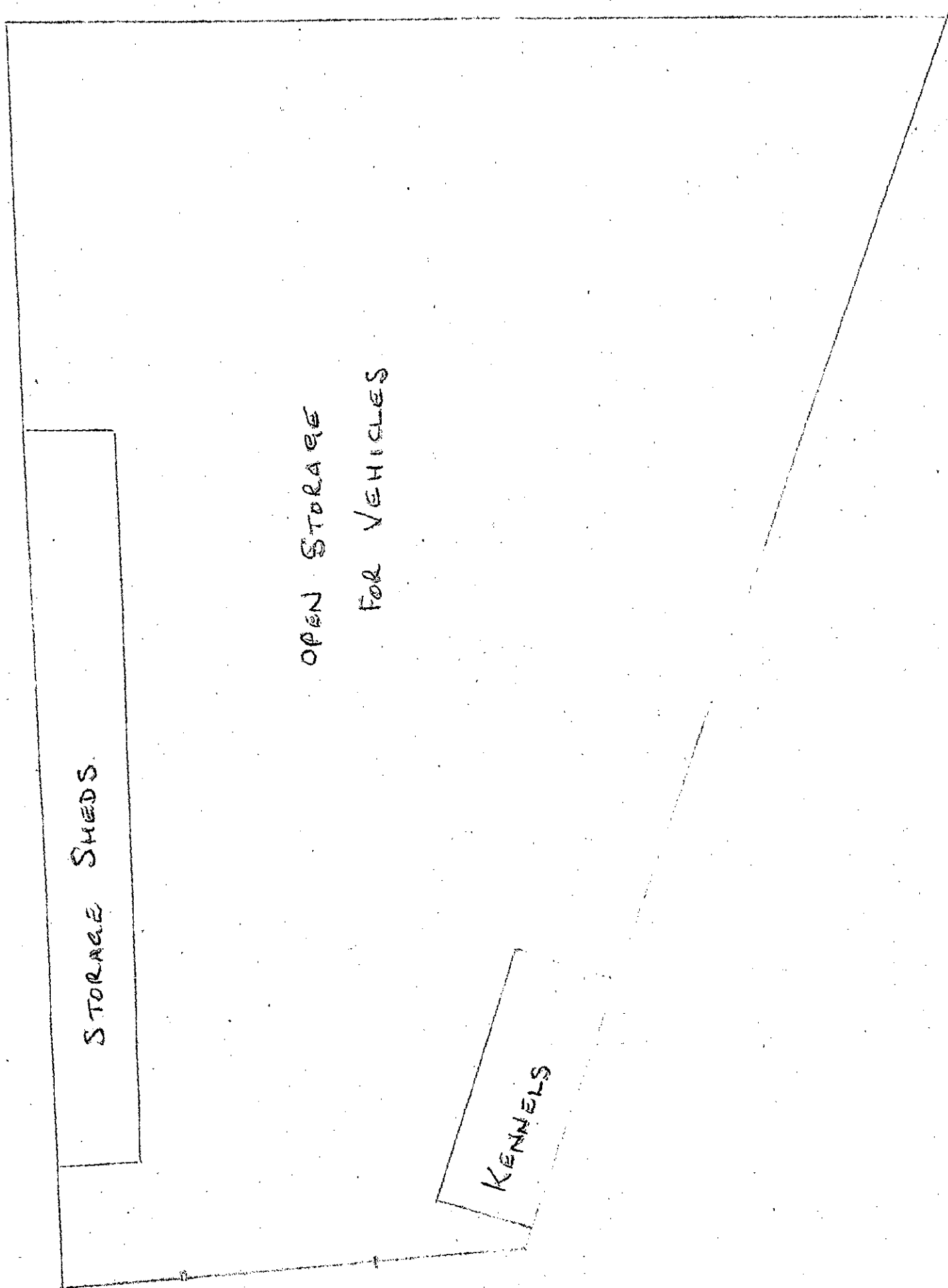

PLAN REFERRED TO

FOR IDENTIFICATION ONLY

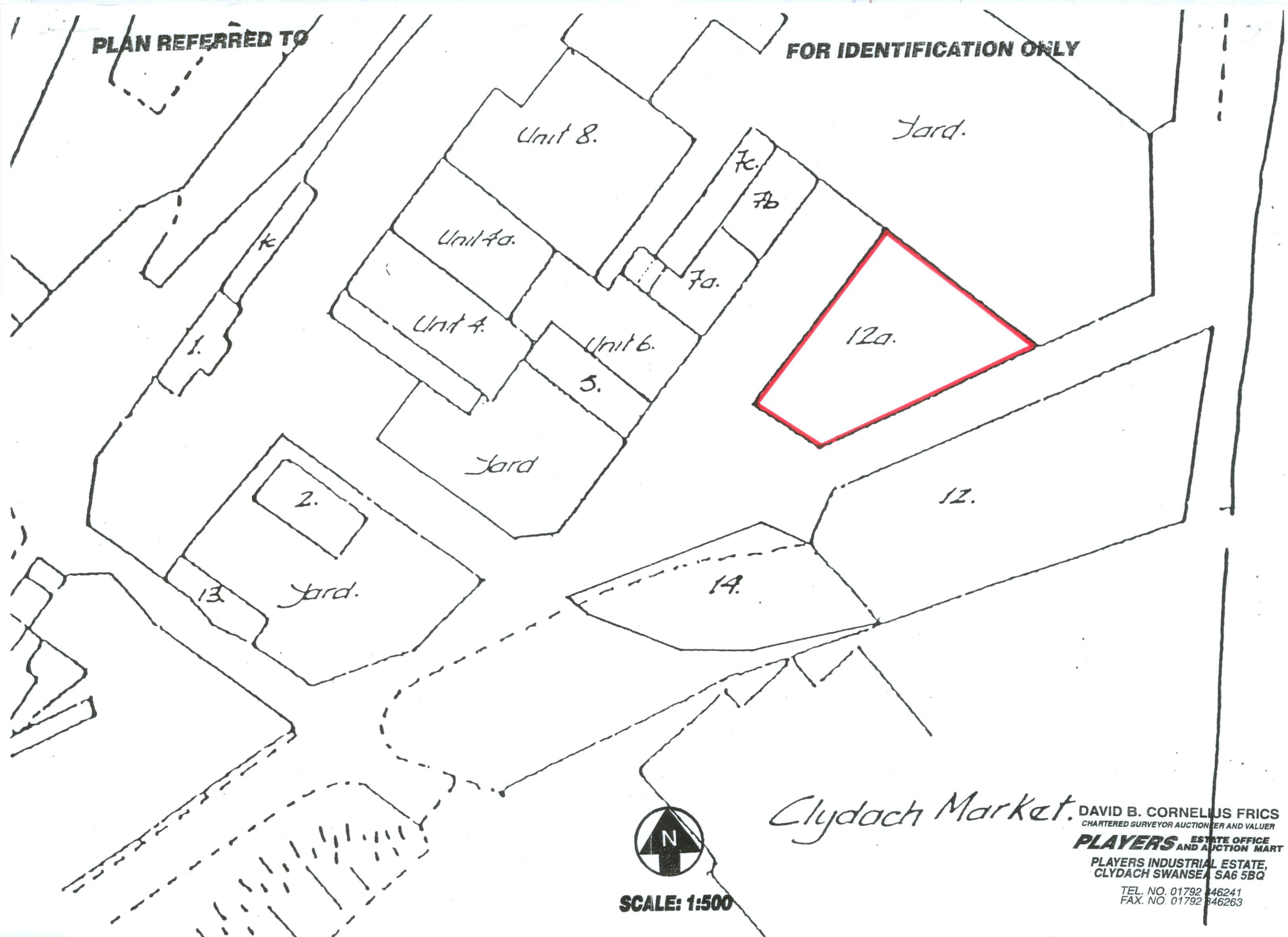

SCALE: 1:500

Clydach Market.

DAVID B. CORNELIUS FRICS
CHARTERED SURVEYOR AUCTIONEER AND VALUER
PLAYERS ESTATE OFFICE
AND AUCTION MART
PLAYERS INDUSTRIAL ESTATE,
CLYDACH SWANSEA SA6 5BQ
TEL. NO. 01792 346241
FAX. NO. 01792 346263

UNIT 14

CAR
SALES

OFFICE

PLAN REFERRED TO

FOR IDENTIFICATION ONLY

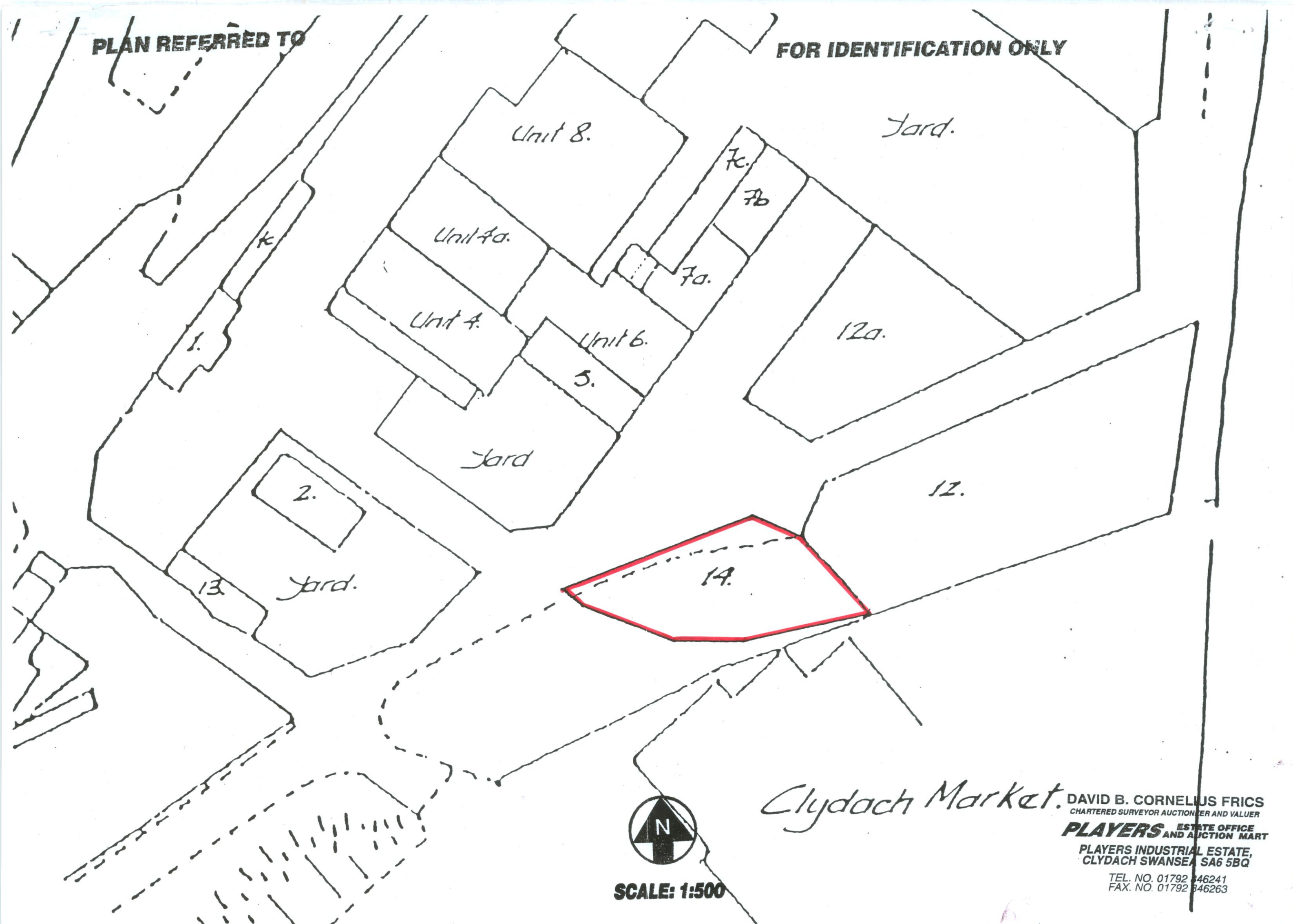

SCALE: 1:500

Clydach Market.

DAVID B. CORNELIUS FRICS
CHARTERED SURVEYOR AUCTIONEER AND VALUER
PLAYERS ESTATE OFFICE
AND AUCTION MART
PLAYERS INDUSTRIAL ESTATE,
CLYDACH SWANSEA SA6 5BQ
TEL. NO. 01792 346241
FAX. NO. 01792 346263

UNIT 7B

DIESEL

PETROL

BRAKE
FLUID

HYDRAULIC
FLUID

ETC.

STORAGE TANKS.

DE-FOULTING BAY

DOORS WITH RAMP

FORECOURT

PLAN REFERRED TO

FOR IDENTIFICATION ONLY

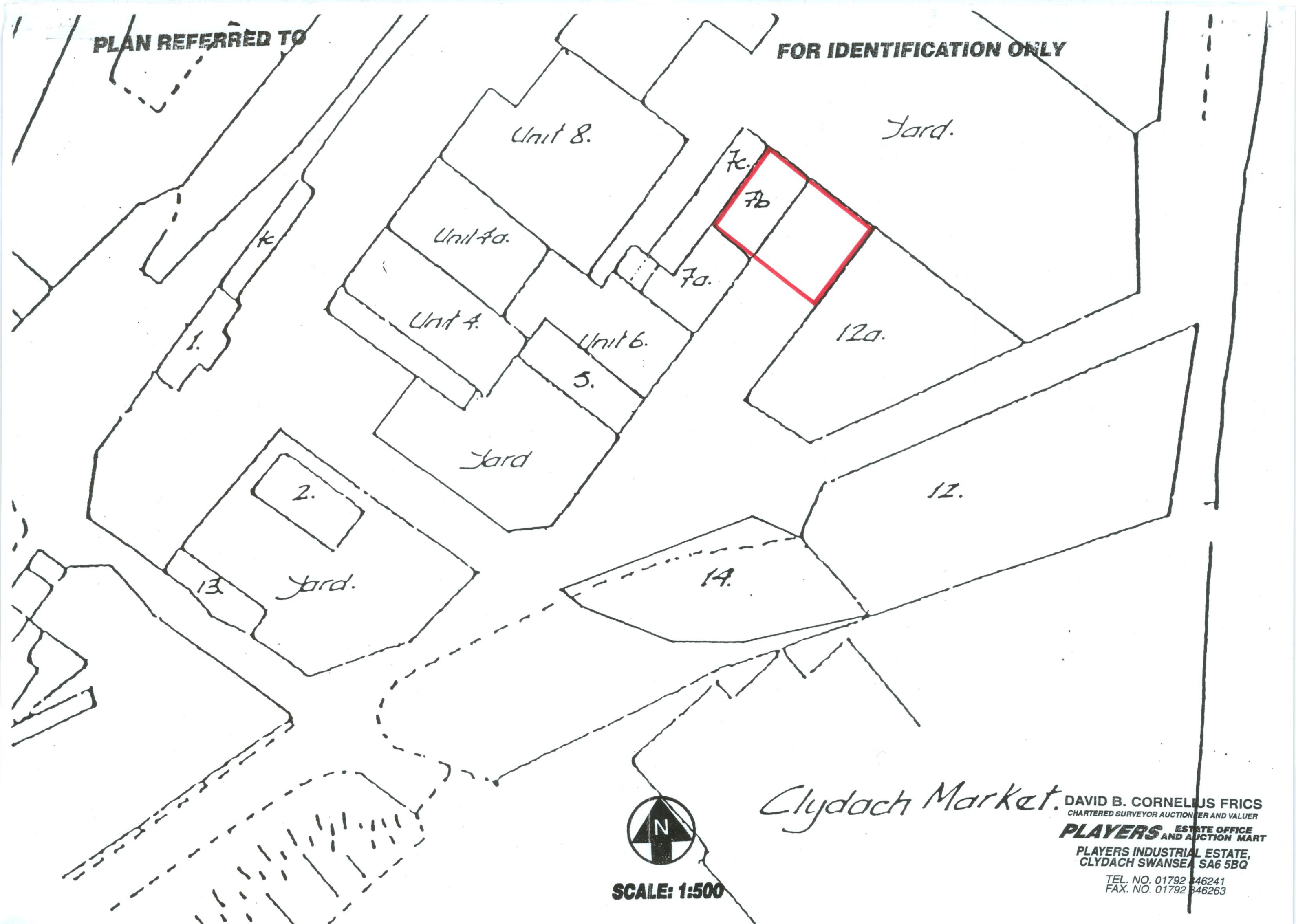

SCALE: 1:500

Clydach Market.

DAVID B. CORNELIUS FRICS
CHARTERED SURVEYOR AUCTIONEER AND VALUER
PLAYERS ESTATE OFFICE
AND AUCTION MART
PLAYERS INDUSTRIAL ESTATE,
CLYDACH SWANSEA SA6 5BQ
TEL. NO. 01792 346241
FAX. NO. 01792 346263

UNIT 7A

TOILETS

SALES
COUNTER

COMPLETELY SHELVED UNIT
FOR STORAGE OF PARTS

RECEPTION

FORECOURT

PLAN REFERRED TO

FOR IDENTIFICATION ONLY

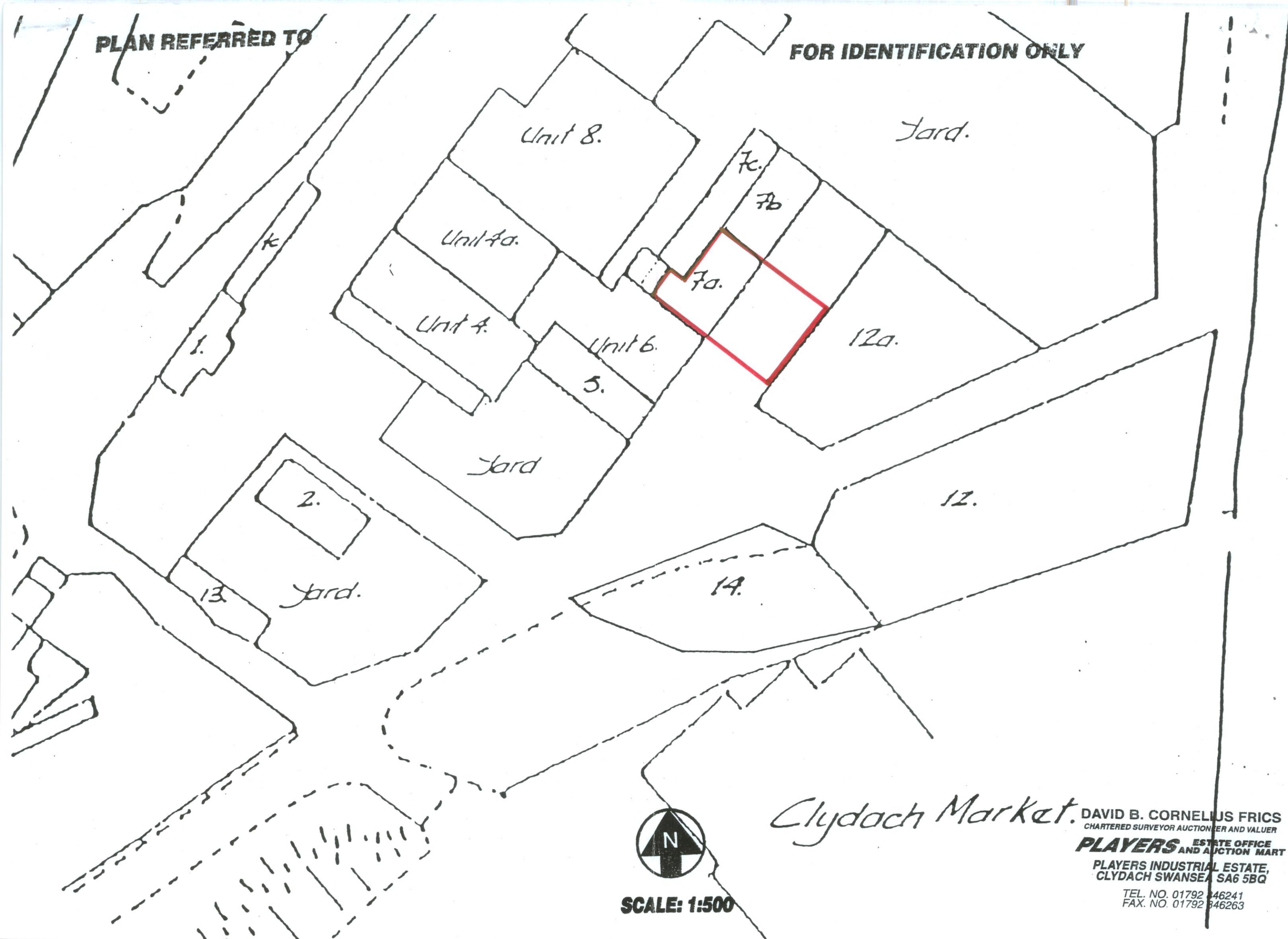

SCALE: 1:500

Clydach Market.

DAVID B. CORNELIUS FRICS
CHARTERED SURVEYOR AUCTIONEER AND VALUER

PLAYERS ESTATE OFFICE
AND AUCTION MART

PLAYERS INDUSTRIAL ESTATE,
CLYDACH SWANSEA SA6 5BQ

TEL. NO. 01792 446241
FAX. NO. 01792 446263