



Ceri Environmental Consulting Ltd

SAW MILLS COTTAGE, Sawmills, Kerry,  
NEWTOWN, SY16 4LL

Groundsure  
Reference:

GS-4200976

Your Reference:

Paperback\_Anglesey

Report Date

22 Aug 2017

Report Delivery  
Method:

Email - pdf

## Enviro Insight

Address: 226215 381132,

Dear Sir/ Madam,

Thank you for placing your order with Groundsure. Please find enclosed the **Groundsure Enviro Insight** as requested.

If you need any further assistance, please do not hesitate to contact our helpline on 08444 159000 quoting the above Groundsure reference number.

Yours faithfully,

Managing Director  
Groundsure Limited

Enc.  
Groundsure Enviroinsight

Address: 226215 381132,  
Date: 22 Aug 2017  
Reference: GS-4200976  
Client: Ceri Environmental Consulting Ltd



Aerial Photograph Capture date: 18-Apr-2015  
Grid Reference: 226272,381234  
Site Size: 2.17ha

Report Reference: GS-4200976  
Client Reference: Paperback\_Anglesey

# Contents Page

Contents Page	3
Overview of Findings	6
Using this report	10
1. Historical Land Use	11
1. Historical Industrial Sites	12
1.1 Potentially Contaminative Uses identified from 1:10,000 scale Mapping	12
1.2 Additional Information – Historical Tank Database	12
1.3 Additional Information – Historical Energy Features Database	13
1.4 Additional Information – Historical Petrol and Fuel Site Database	13
1.5 Additional Information – Historical Garage and Motor Vehicle Repair Database	13
1.6 Potentially Infilled Land	14
2. Environmental Permits, Incidents and Registers Map	15
2. Environmental Permits, Incidents and Registers	16
2.1 Industrial Sites Holding Licences and/or Authorisations	16
2.1.1 Records of historic IPC Authorisations within 500m of the study site	16
2.1.2 Records of Part A(1) and IPPC Authorised Activities within 500m of the study site	17
2.1.3 Records of Red List Discharge Consents (potentially harmful discharges to controlled waters) within 500m of the study site	22
2.1.4 Records of List 1 Dangerous Substances Inventory Sites within 500m of the study site	22
2.1.5 Records of List 2 Dangerous Substance Inventory Sites within 500m of the study site	22
2.1.6 Records of Part A(2) and Part B Activities and Enforcements within 500m of the study site	22
2.1.7 Records of Category 3 or 4 Radioactive Substances Authorisations	22
2.1.8 Records of Licensed Discharge Consents within 500m of the study site	23
2.1.9 Records of Water Industry Referrals (potentially harmful discharges to the public sewer) within 500m of the study site	24
2.1.10 Records of Planning Hazardous Substance Consents and Enforcements within 500m of the study site	24
2.2 Dangerous or Hazardous Sites	24
2.3 Environment Agency/Natural Resources Wales Recorded Pollution Incidents	24
2.3.1 Records of National Incidents Recording System, List 2 within 500m of the study site	24
2.3.2 Records of National Incidents Recording System, List 1 within 500m of the study site	25
2.4 Sites Determined as Contaminated Land under Part 2A EPA 1990	25
3. Landfill and Other Waste Sites Map	26
3. Landfill and Other Waste Sites	27
3.1 Landfill Sites	27
3.1.1 Records from Environment Agency/Natural Resources Wales landfill data within 1000m of the study site	27
3.1.2 Records of Environment Agency/Natural Resources Wales historic landfill sites within 1500m of the study site	27
3.1.3 Records of BGS/DoE non-operational landfill sites within 1500m of the study site	27
3.1.4 Records of Landfills from Local Authority and Historical Mapping Records within 1500m of the study site	28
3.2 Other Waste Sites	28
3.2.1 Records of waste treatment, transfer or disposal sites within 500m of the study site	28
3.2.2 Records of Environment Agency/Natural Resources Wales licensed waste sites within 1500m of the study site	28
4. Current Land Use Map	29
4. Current Land Uses	30
4.1 Current Industrial Data	30
4.2 Petrol and Fuel Sites	30
4.3 National Grid High Voltage Underground Electricity Transmission Cables	31
4.4 National Grid High Pressure Gas Transmission Pipelines	31

5. Geology	32
5.1 Artificial Ground and Made Ground.....	32
5.2 Superficial Ground and Drift Geology .....	32
5.3 Bedrock and Solid Geology .....	32
6 Hydrogeology and Hydrology	33
6a. Aquifer Within Superficial Geology	33
6b. Aquifer Within Bedrock Geology and Abstraction Licenses	34
6c. Hydrogeology – Source Protection Zones and Potable Water Abstraction Licenses	35
6d. Hydrogeology – Source Protection Zones within confined aquifer	36
6e. Hydrology – Detailed River Network and River Quality	37
6.Hydrogeology and Hydrology	38
6.1 Aquifer within Superficial Deposits.....	38
6.2 Aquifer within Bedrock Deposits.....	38
6.3 Groundwater Abstraction Licences.....	39
6.4 Surface Water Abstraction Licences.....	39
6.5 Potable Water Abstraction Licences.....	39
6.6 Source Protection Zones.....	39
6.7 Source Protection Zones within Confined Aquifer.....	39
6.8 Groundwater Vulnerability and Soil Leaching Potential.....	40
6.9 River Quality.....	40
6.9.1 Biological Quality:.....	40
6.9.2 Chemical Quality:.....	40
6.10 Detailed River Network.....	40
6.11 Surface Water Features.....	44
7a. Environment Agency/Natural Resources Wales Flood Map for Planning (from rivers and the sea)	45
7b. Environment Agency/Natural Resources Wales Risk of Flooding from Rivers and the Sea (RoFRaS)	46
Map	46
7 Flooding	47
7.1 River and Coastal Zone 2 Flooding.....	47
7.2 River and Coastal Zone 3 Flooding.....	47
7.3 Risk of Flooding from Rivers and the Sea (RoFRaS) Flood Rating.....	47
7.4 Flood Defences.....	48
7.5 Areas benefiting from Flood Defences.....	48
7.6 Areas benefiting from Flood Storage.....	48
7.7 Groundwater Flooding Susceptibility Areas.....	48
7.7.1 Are there any British Geological Survey groundwater flooding susceptibility areas within 50m of the boundary of the study site? Yes.....	48
7.7.2 What is the highest susceptibility to groundwater flooding in the search area based on the underlying geological conditions?.....	48
7.8 Groundwater Flooding Confidence Areas.....	48
8. Designated Environmentally Sensitive Sites Map	49
8. Designated Environmentally Sensitive Sites	50
8.1 Records of Sites of Special Scientific Interest (SSSI) within 2000m of the study site:.....	50
8.2 Records of National Nature Reserves (NNR) within 2000m of the study site:.....	50
8.3 Records of Special Areas of Conservation (SAC) within 2000m of the study site:.....	50
8.4 Records of Special Protection Areas (SPA) within 2000m of the study site:.....	51
8.5 Records of Ramsar sites within 2000m of the study site:.....	51
8.6 Records of Ancient Woodland within 2000m of the study site: .....	52
8.7 Records of Local Nature Reserves (LNR) within 2000m of the study site:.....	52
8.8 Records of World Heritage Sites within 2000m of the study site:.....	52
8.9 Records of Environmentally Sensitive Areas within 2000m of the study site: .....	53

8.10 Records of Areas of Outstanding Natural Beauty (AONB) within 2000m of the study site: .....	53
8.11 Records of National Parks (NP) within 2000m of the study site: .....	55
8.12 Records of Nitrate Sensitive Areas within 2000m of the study site:.....	55
8.13 Records of Nitrate Vulnerable Zones within 2000m of the study site:.....	55
8.14 Records of Green Belt land within 2000m of the study site:.....	55
<b>9. Natural Hazards Findings</b>	<b>56</b>
9.1 Detailed BGS GeoSure Data.....	56
9.1.1 Shrink Swell.....	56
9.1.2 Landslides.....	56
9.1.3 Soluble Rocks.....	56
9.1.4 Compressible Ground.....	57
9.1.5 Collapsible Rocks.....	57
9.1.6 Running Sand.....	57
9.2 Radon.....	57
9.2.1 Radon Affected Areas.....	57
9.2.2 Radon Protection.....	58
<b>10. Mining</b>	<b>59</b>
10.1 Coal Mining.....	59
10.2 Non-Coal Mining.....	59
10.3 Brine Affected Areas .....	59
<b>Contact Details</b>	<b>60</b>
<b>Standard Terms and Conditions</b>	<b>62</b>



# Overview of Findings

For further details on each dataset, please refer to each individual section in the main report as listed. Where the database has been searched a numerical result will be recorded. Where the database has not been searched '-' will be recorded.

Section 1: Historical Industrial Sites	On-site	0-50	51-250	251-500
1.1 Potentially Contaminative Uses identified from 1:10,000 scale mapping	1	0	4	10
1.2 Additional Information – Historical Tank Database	0	0	13	17
1.3 Additional Information – Historical Energy Features Database	0	0	0	0
1.4 Additional Information – Historical Petrol and Fuel Site Database	0	0	0	0
1.5 Additional Information – Historical Garage and Motor Vehicle Repair Database	0	0	0	0
1.6 Potentially Infilled Land	0	0	4	10

Section 2: Environmental Permits, Incidents and Registers	On-site	0-50m	51-250	251-500
2.1 Industrial Sites Holding Environmental Permits and/or Authorisations				
2.1.1 Records of historic IPC Authorisations	0	0	7	0
2.1.2 Records of Part A(1) and IPPC Authorised Activities	0	0	39	0
2.1.3 Records of Red List Discharge Consents	0	0	0	0
2.1.4 Records of List 1 Dangerous Substances Inventory sites	0	0	0	0
2.1.5 Records of List 2 Dangerous Substances Inventory sites	0	0	0	0
2.1.6 Records of Part A(2) and Part B Activities and Enforcements	0	0	0	0
2.1.7 Records of Category 3 or 4 Radioactive Substances Authorisations	0	0	0	0
2.1.8 Records of Licensed Discharge Consents	0	0	0	7
2.1.9 Records of Water Industry Referrals	0	0	0	0
2.1.10 Records of Planning Hazardous Substance Consents and Enforcements within 500m of the study site	0	0	0	0
2.2 Records of COMAH and NIHHS sites	1	0	0	0
2.3 Environment Agency/Natural Resources Wales Recorded Pollution Incidents				
2.3.1 National Incidents Recording System, List 2	0	0	1	3
2.3.2 National Incidents Recording System, List 1	0	0	0	0
2.4 Sites Determined as Contaminated Land under Part 2A EPA 1990	0	0	0	0

Section 3: Landfill and Other Waste Sites	On-site	0-50m	51-250	251-500	501-1000	1000-1500
3.1 Landfill Sites						
3.1.1 Environment Agency/Natural Resources Wales Registered Landfill Sites	0	0	0	0	0	Not searched
3.1.2 Environment Agency/Natural Resources Wales Historic Landfill Sites	0	0	0	0	0	2
3.1.3 BGS/DoE Landfill Site Survey	0	0	0	0	0	0
3.1.4 Records of Landfills in Local Authority and Historical Mapping Records	0	0	0	0	0	1
3.2 Landfill and Other Waste Sites Findings						
3.2.1 Operational and Non-Operational Waste Treatment, Transfer and Disposal Sites	0	0	0	0	Not searched	Not searched
3.2.2 Environment Agency/Natural Resources Wales Licensed Waste Sites	0	0	0	0	0	2

Section 4: Current Land Use	On-site	0-50m	51-250	251-500
4.1 Current Industrial Sites Data	1	4	8	Not searched
4.2 Records of Petrol and Fuel Sites	0	0	0	0
4.3 National Grid Underground Electricity Cables	0	0	0	0
4.4 National Grid Gas Transmission Pipelines	0	0	0	0

Section 5: Geology	
5.1 Are there any records of Artificial Ground and Made Ground present beneath the study site?	No
5.2 Are there any records of Superficial Ground and Drift Geology present beneath the study site?	Yes
5.3 For records of Bedrock and Solid Geology beneath the study site see the detailed findings section.	

Section 6: Hydrogeology and Hydrology				0-500m		
6.1 Are there any records of Strata Classification in the Superficial Geology within 500m of the study site?				Yes		
6.2 Are there any records of Strata Classification in the Bedrock Geology within 500m of the study site?				Yes		
	On-site	0-50m	51-250	251-500	501-1000	1000-2000
6.3 Groundwater Abstraction Licences (within 2000m of the study site)	0	0	0	0	0	0
6.4 Surface Water Abstraction Licences (within 2000m of the study site)	0	0	0	0	0	0
6.5 Potable Water Abstraction Licences (within 2000m of the study site)	0	0	0	0	0	0
6.6 Source Protection Zones (within 500m of the study site)	0	0	0	0	Not searched	Not searched
6.7 Source Protection Zones within Confined Aquifer	0	0	0	0	Not searched	Not searched
6.8 Groundwater Vulnerability and Soil Leaching Potential (within 500m of the study site)	0	0	1	0	Not searched	Not searched

Section 6: Hydrogeology and Hydrology	0-500m					
	On-site	0-50m	51-250	251-500	501-1000	1000-1500
6.9 Is there any Environment Agency/Natural Resources Wales information on river quality within 1500m of the study site?	No	No	No	No	No	No
6.10 Detailed River Network entries within 500m of the site	0	7	18	29	Not searched	Not searched
6.11 Surface water features within 250m of the study site	No	Yes	Yes	Not searched	Not searched	Not searched

Section 7: Flooding						
7.1 Are there any Environment Agency Zone 2 floodplains within 250m of the study site?	Yes					
7.2 Are there any Environment Agency/Natural Resources Wales Zone 3 floodplains within 250m of the study site	Yes					
7.3 What is the Risk of flooding from Rivers and the Sea (RoFRaS) rating for the study site?	Very Low					
7.4 Are there any Flood Defences within 250m of the study site?	No					
7.5 Are there any areas benefiting from Flood Defences within 250m of the study site?	No					
7.6 Are there any areas used for Flood Storage within 250m of the study site?	No					
7.7 What is the maximum BGS Groundwater Flooding susceptibility within 50m of the study site?	Potential at Surface					
7.8 What is the BGS confidence rating for the Groundwater Flooding susceptibility areas?	Moderate					

Section 8: Designated Environmentally Sensitive Sites	On-site	0-50m	51-250	251-500	501-1000	1000-2000
8.1 Records of Sites of Special Scientific Interest (SSSI)	0	0	0	0	1	1
8.2 Records of National Nature Reserves (NNR)	0	0	0	0	0	0
8.3 Records of Special Areas of Conservation (SAC)	0	0	0	0	2	2
8.4 Records of Special Protection Areas (SPA)	0	0	0	1	0	2
8.5 Records of Ramsar sites	0	0	0	0	0	0
8.6 Records of Ancient Woodlands	0	0	0	5	5	3
8.7 Records of Local Nature Reserves (LNR)	0	0	0	0	0	0
8.8 Records of World Heritage Sites	0	0	0	0	0	0
8.9 Records of Environmentally Sensitive Areas	0	0	0	0	0	0



Section 8: Designated Environmentally Sensitive Sites	On-site	0-50m	51-250	251-500	501-1000	1000-2000
8.10 Records of Areas of Outstanding Natural Beauty (AONB)	1	0	0	0	4	55
8.11 Records of National Parks	0	0	0	0	0	0
8.12 Records of Nitrate Sensitive Areas	0	0	0	0	0	0
8.13 Records of Nitrate Vulnerable Zones	0	0	0	0	0	0
8.14 Records of Green Belt land	0	0	0	0	0	0

## Section 9: Natural Hazards

9.1 What is the maximum risk of natural ground subsidence?	Moderate
9.1.1 What is the maximum Shrink-Swell hazard rating identified on the study site?	Low
9.1.2 What is the maximum Landslides hazard rating identified on the study site?	Very Low
9.1.3 What is the maximum Soluble Rocks hazard rating identified on the study site?	Negligible
9.1.4 What is the maximum Compressible Ground hazard rating identified on the study site?	Moderate
9.1.5 What is the maximum Collapsible Rocks hazard rating identified on the study site?	Very Low
9.1.6 What is the maximum Running Sand hazard rating identified on the study site?	Moderate
9.2 Radon	
9.2.1 Is the property in a Radon Affected Area as defined by the Health Protection Agency (HPA) and if so what percentage of homes are above the Action Level?	The property is not in a Radon Affected Area, as less than 1% of properties are above the Action Level.
9.2.2 Is the property in an area where Radon Protection are required for new properties or extensions to existing ones as described in publication BR211 by the Building Research Establishment?	No radon protective measures are necessary.

## Section 10: Mining

10.1 Are there any coal mining areas within 75m of the study site?	No
10.2 Are there any Non-Coal Mining areas within 50m of the study site boundary?	Yes
10.3 Are there any brine affected areas within 75m of the study site?	No

# Using this report

The following report is designed by Environmental Consultants for Environmental Professionals bringing together the most up-to-date market leading environmental data. This report is provided under and subject to the Terms & Conditions agreed between Groundsure and the Client. The document contains the following sections:

## 1. Historical Industrial Sites

Provides information on past land uses that may pose a risk to the study site in terms of potential contamination from activities or processes. Potentially Infilled Land features are also included. This search is conducted using radii of up to 500m.

## 2. Environmental Permits, Incidents and Registers

Provides information on Regulated Industrial Activities and Pollution Incidents as recorded by Regulatory Authorities, and sites determined as Contaminated Land. This search is conducted using radii up to 500m.

## 3. Landfills and Other Waste Sites

Provides information on landfills and other waste sites that may pose a risk to the study site. This search is conducted using radii up to 1500m.

## 4. Current Land Uses

Provides information on current land uses that may pose a risk to the study site in terms of potential contamination from activities or processes. These searches are conducted using radii of up to 500m. This includes information on potentially contaminative industrial sites, petrol stations and fuel sites as well as high pressure gas pipelines and underground electricity transmission lines.

## 5. Geology

Provides information on artificial and superficial deposits and bedrock beneath the study site.

## 6. Hydrogeology and Hydrology

Provides information on productive strata within the bedrock and superficial geological layers, abstraction licenses, Source Protection Zones (SPZs) and river quality. These searches are conducted using radii of up to 2000m.

## 7. Flooding

Provides information on river and coastal flooding, flood defences, flood storage areas and groundwater flood areas. This search is conducted using radii of up to 250m.

## 8. Designated Environmentally Sensitive Sites

Provides information on the Sites of Special Scientific Interest (SSSI), National Nature Reserves (NNR), Special Areas of Conservation (SAC), Special Protection Areas (SPA), Ramsar sites, Local Nature Reserves (LNR), Areas of Outstanding Natural Beauty (AONB), National Parks (NP), Environmentally Sensitive Areas, Nitrate Sensitive Areas, Nitrate Vulnerable Zones and World Heritage Sites and Scheduled Ancient Woodland. These searches are conducted using radii of up to 2000m.

## 9. Natural Hazards

Provides information on a range of natural hazards that may pose a risk to the study site. These factors include natural ground subsidence and radon..

## 10. Mining

Provides information on areas of coal and non-coal mining and brine affected areas.

## 11. Contacts

This section of the report provides contact points for statutory bodies and data providers that may be able to provide further information on issues raised within this report. Alternatively, Groundsure provide a free Technical Helpline (08444 159000) for further information and guidance.

## Note: Maps

Only certain features are placed on the maps within the report. All features represented on maps found within this search are given an identification number. This number identifies the feature on the mapping and correlates it to the additional information provided below. This identification number precedes all other information and takes the following format -Id: 1, Id: 2, etc. Where numerous features on the same map are in such close proximity that the numbers would obscure each other a letter identifier is used instead to represent the features. (e.g. Three features which overlap may be given the identifier "A" on the map and would be identified separately as features 1A, 3A, 10A on the data tables provided).

Where a feature is reported in the data tables to a distance greater than the map area, it is noted in the data table as "Not Shown".

All distances given in this report are in Metres (m). Directions are given as compass headings such as N: North, E: East, NE: North East from the nearest point of the study site boundary.

# 1. Historical Land Use

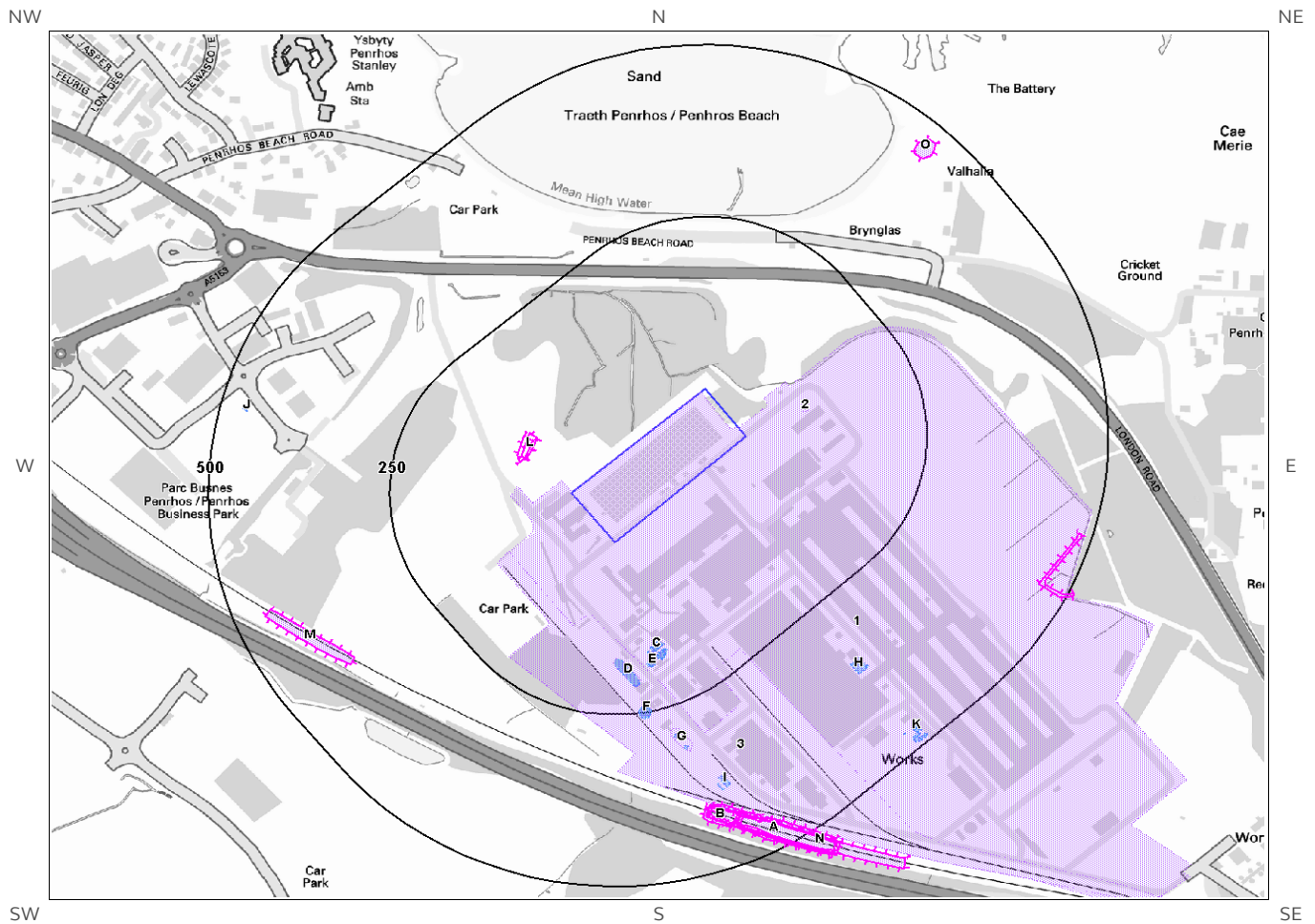

© Crown copyright and database rights 2017.  
Ordnance Survey license 100035207.

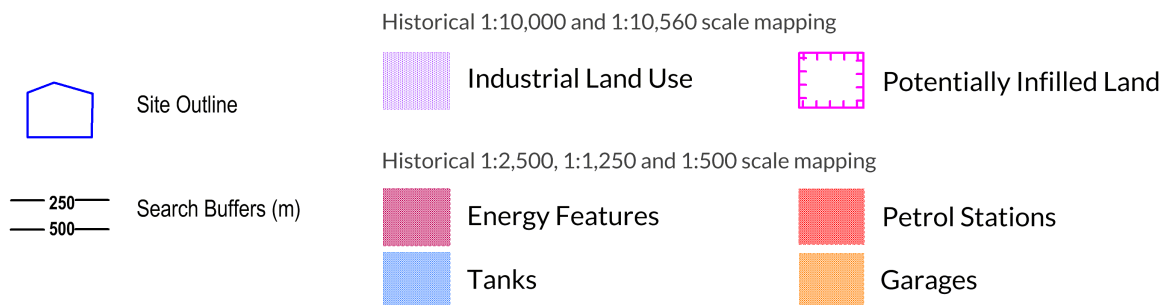

# 1. Historical Industrial Sites

## 1.1 Potentially Contaminative Uses identified from 1:10,000 scale Mapping

The systematic analysis of data extracted from standard 1:10,560 and 1:10,000 scale historical maps provides the following information:

Records of sites with a potentially contaminative past land use within 500m of the search boundary: 15

ID	Distance [m]	Direction	Use	Date
1	0	On Site	Aluminium Works	1977
2	86	NE	Unspecified Tank	1977
3	109	S	Railway Sidings	1977
4D	168	S	Unspecified Tanks	1977
5F	241	S	Unspecified Tank	1977
6G	283	S	Unspecified Tanks	1977
7M	383	SW	Cuttings	1887
8A	403	S	Cuttings	1926
9B	404	S	Cuttings	1959
10A	405	S	Cuttings	1949
11A	405	S	Cuttings	1899
12B	407	S	Cuttings	1887
13A	433	SE	Cuttings	1959
14N	434	SE	Cuttings	1887
15O	448	NE	Sand Pit	1899

## 1.2 Additional Information – Historical Tank Database

The systematic analysis of data extracted from High Detailed 1:1,250 and 1:2,500 scale historical maps provides the following information.

Records of historical tanks within 500m of the search boundary: 30

ID	Distance (m)	Direction	Use	Date
16C	155	SE	Unspecified Tank	1993
17C	155	SE	Unspecified Tank	1973
18C	164	S	Unspecified Tank	1995
19C	168	SE	Unspecified Tank	1973
20C	168	SE	Tanks	1993
21D	170	S	Tanks	1973
22C	170	SE	Tanks	1995
23C	171	S	Unspecified Tank	1973

24E	178	S	Unspecified Tank	1973
25E	179	S	Unspecified Tank	1993
26E	179	S	Unspecified Tank	1995
27F	242	S	Unspecified Tank	1973
28F	243	S	Unspecified Tank	1995
29G	291	S	Unspecified Tank	1973
30G	311	S	Unspecified Tank	1973
31H	346	SE	Tanks	1993
32H	349	SE	Tanks	1995
33I	369	SE	Unspecified Tank	1973
34I	377	S	Unspecified Tank	1995
35J	461	W	Tanks	1995
36J	461	W	Tanks	1996
37J	462	W	Tanks	1987
38J	462	W	Tanks	1993
39K	469	SE	Tanks	1973
40K	470	SE	Unspecified Tank	1993
41K	470	SE	Tanks	1995
42K	482	SE	Unspecified Tank	1973
43K	483	SE	Tanks	1995
44K	489	SE	Tanks	1973
45K	491	SE	Unspecified Tank	1995

### 1.3 Additional Information – Historical Energy Features Database

The systematic analysis of data extracted from High Detailed 1:1,250 and 1:2,500 scale historical maps provides the following information.

Records of historical energy features within 500m of the search boundary: 0

Database searched and no data found.

### 1.4 Additional Information – Historical Petrol and Fuel Site Database

The systematic analysis of data extracted from High Detailed 1:1,250 and 1:2,500 scale historical maps provides the following information.

Records of historical petrol stations and fuel sites within 500m of the search boundary: 0

Database searched and no data found.

### 1.5 Additional Information – Historical Garage and Motor Vehicle Repair Database

The systematic analysis of data extracted from High Detailed 1:1,250 and 1:2,500 scale historical maps

provides the following information.

Records of historical garage and motor vehicle repair sites within 500m of the search boundary: 0

Database searched and no data found.

## 1.6 Potentially Infilled Land

Records of Potentially Infilled Features from 1:10,000 scale mapping within 500m of the study site: 14









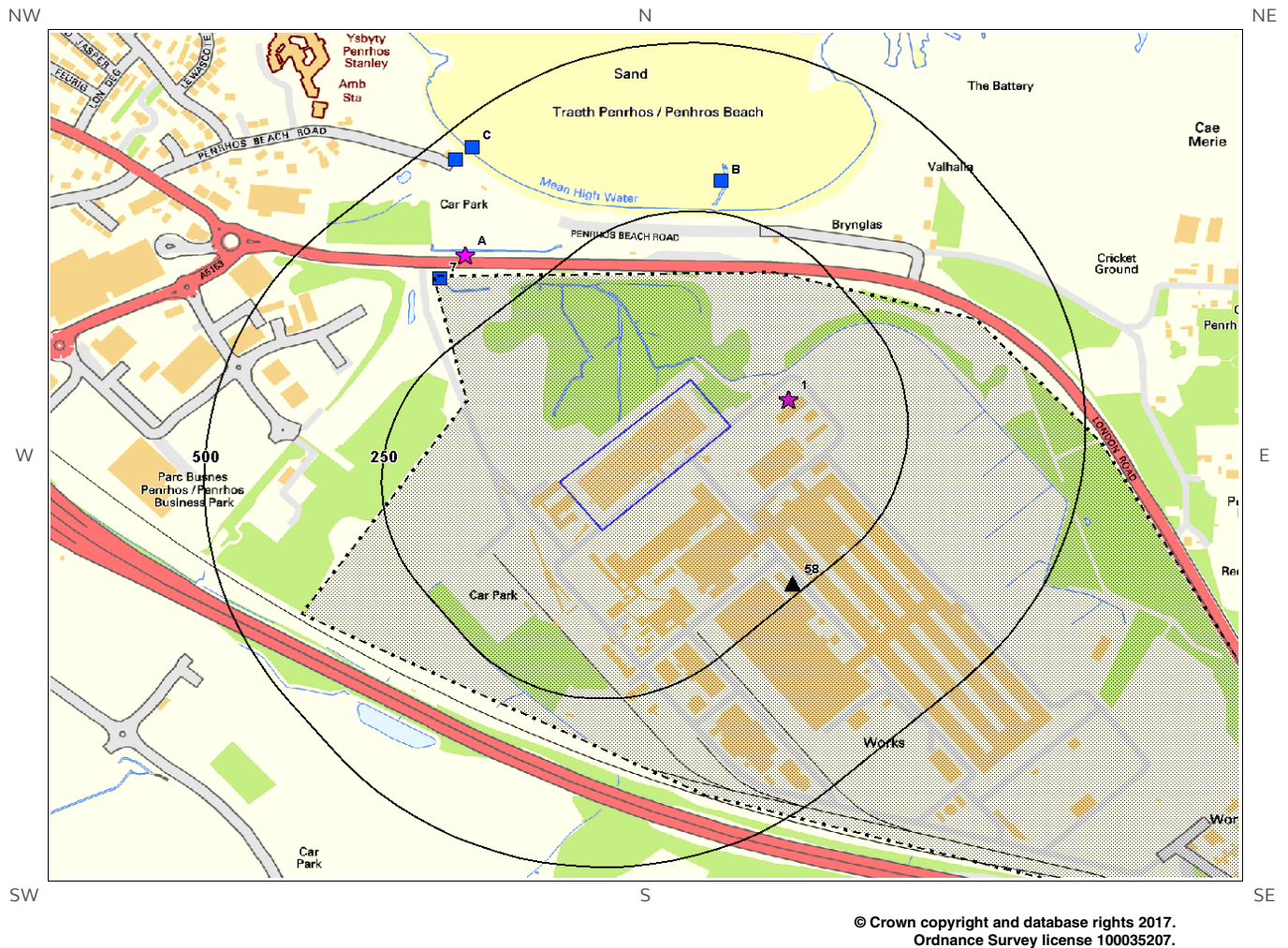





The following Historical Potentially Infilled Features derived from the Historical Mapping information is provided by Groundsure:

ID	Distance(m)	Direction	Use	Date
46L	80	NW	Pond	1887
47L	80	NW	Pond	1899
48L	80	NW	Pond	1949
49L	82	NW	Pond	1959
50M	383	SW	Cuttings	1887
51A	403	S	Cuttings	1926
52B	404	S	Cuttings	1959
53A	405	S	Cuttings	1949
54A	405	S	Cuttings	1899
55B	407	S	Cuttings	1887
56A	433	SE	Cuttings	1959
57N	434	SE	Cuttings	1887
58O	448	NE	Sand Pit	1899
59	457	SE	Pond	1887



## 2. Environmental Permits, Incidents and Registers Map



- |   |                    |   |                               |   |  |
|---|--------------------|---|-------------------------------|---|--|
|  | Site Outline       |  | Recorded Pollution Incident   |  | RAS 3 & 4 Authorisations                                       |
|  | Search Buffers (m) |  | Dangerous Substances (List 1) |  | Part A(1) Authorised Processes and Historic IPC Authorisations |
|   |                    |  | Dangerous Substances (List 2) |  | Part A(2) and Part B Authorised Processes                      |
|   |                    |  | Water Industry Referrals      |  | COMAH / NIHHS Sites  |
|   |                    |  | Licenced Discharge Consents   |  | Sites Determined as Contaminated Land                          |
|   |                    |  | Red List Discharge Consents   |  | Hazardous Substance Consents and Enforcements                  |

## 2. Environmental Permits, Incidents and Registers

### 2.1 Industrial Sites Holding Licences and/or Authorisations

Searches of information provided by the Environment Agency/Natural Resources Wales and Local Authorities reveal the following information:

#### 2.1.1 Records of historic IPC Authorisations within 500m of the study site:

7

The following IPC Authorisations are represented as points on the Environmental Permits, Incidents and Registers Map:

ID	Distance (m)	Direction	NGR	Details
98D	236	SE	226500 381000	Operator: Anglesey Aluminium Metal Ltd Address: Penrhos Works, P O Box 4, Holyhead, Gwynedd, LL65 2UJ Process: Tar And Bitumen Processes Permit Number: BD7464 Original Permit Number: IPCMINVAR Date Approved: 24-11-1998 Effective Date: 30-11-1998 Status: Revoked - Now Ippc
99D	236	SE	226500 381000	Operator: Anglesey Aluminium Metal Ltd Address: Penrhos Works, P O Box 4, Holyhead, Gwynedd, LL65 2UJ Process: Non-ferrous Metals Permit Number: BK8265 Original Permit Number: IPCMINVAR Date Approved: - Effective Date: - Status: Valid
100D	236	SE	226500 381000	Operator: Anglesey Aluminium Metal Ltd Address: Penrhos Works, P O Box 4, Holyhead, Gwynedd, LL65 2UJ Process: Non-ferrous Metals Permit Number: AX0372 Original Permit Number: IPCMINVAR Date Approved: 12-12-1996 Effective Date: 31-12-1996 Status: Superseded By Variation
101D	236	SE	226500 381000	Operator: Anglesey Aluminium Metal Ltd Address: Penrhos Works, P O Box 4, Holyhead, Gwynedd, LL65 2UJ Process: Non-ferrous Metals Permit Number: AS6799 Original Permit Number: IPCAIRAPP Date Approved: 27-11-1995 Effective Date: 4-12-1995 Status: Superseded By Variation
102D	236	SE	226500 381000	Operator: Anglesey Aluminium Metal Ltd Address: Penrhos Works, P O Box 4, Holyhead, Gwynedd, LL65 2UJ Process: Non-ferrous Metals Permit Number: BD7456 Original Permit Number: IPCMINVAR Date Approved: 24-11-1998 Effective Date: 30-11-1998 Status: Revoked - Now Ippc
103D	236	SE	226500 381000	Operator: Anglesey Aluminium Metal Ltd Address: Penrhos Works, P O Box 4, Holyhead, Gwynedd, LL65 2UJ Process: Tar And Bitumen Processes Permit Number: AT1865 Original Permit Number: IPCAIRAPP Date Approved: 27-11-1995 Effective Date: 4-12-1995 Status: Superseded By Variation

ID	Distance (m)	Direction	NGR	Details
104D	236	SE	226500 381000	Operator: Anglesey Aluminium Metal Ltd Address: Penrhos Works, P O Box 4, Holyhead, Gwynedd, LL65 2UJ Process: Tar And Bitumen Processes Permit Number: AX0399 Original Permit Number: IPCMINVAR Date Approved: 12-12-1996 Effective Date: 31-12-1996 Status: Superseded By Variation

### 2.1.2 Records of Part A(1) and IPPC Authorised Activities within 500m of the study site:

39

The following Part A(1) and IPPC Authorised Activities are represented as points on the Environmental Permits, Incidents and Registers Map:

ID	Distance (m)	Direction	NGR	Details
59D	236	SE	226500 381000	Operator: Anglesey Aluminium Metal Ltd Installation Name: Holyhead Aluminium Smelter Process: NON-FERROUS METALS; PRODUCING FROM RAW MATERIALS BY METALLURGICAL ACTIVITIES ETC Permit Number: LP3931TH Original Permit Number: BL1100IX EPR Reference: - Issue Date: 19/11/2010 Effective Date: 19/11/2010 Last date noted as effective: 2017-04-01 Status: Superseded
60D	236	SE	226500 381000	Operator: Anglesey Aluminium Metal Ltd Installation Name: Holyhead Aluminium Smelter Process: NON-FERROUS METALS; PRODUCING FROM RAW MATERIALS BY METALLURGICAL ACTIVITIES ETC Permit Number: DP3532KF Original Permit Number: BL1100IX EPR Reference: - Issue Date: 18/12/2009 Effective Date: 18/12/2009 Last date noted as effective: 2017-04-01 Status: Superseded
61D	236	SE	226500 381000	Operator: Anglesey Aluminium Metal Ltd Installation Name: Holyhead Aluminium Smelter Process: NON-FERROUS METALS; PRODUCING FROM RAW MATERIALS BY METALLURGICAL ACTIVITIES ETC Permit Number: YP3439ZF Original Permit Number: BL1100IX EPR Reference: - Issue Date: 9/11/2012 Effective Date: 9/11/2012 Last date noted as effective: 2017-04-01 Status: Superseded
62D	236	SE	226500 381000	Operator: Anglesey Aluminium Metal Ltd Installation Name: Holyhead Aluminium Smelter Process: FERROUS METALS; PRODUCING, MELTING OR REFINING Permit Number: MP3135ZT Original Permit Number: BL1100IX EPR Reference: - Issue Date: 14/3/2013 Effective Date: 14/3/2013 Last date noted as effective: 2017-04-01 Status: Superseded
63D	236	SE	226500 381000	Operator: Anglesey Aluminium Metal Ltd Installation Name: Holyhead Aluminium Smelter Process: NON-FERROUS METALS; PRODUCING FROM RAW MATERIALS BY METALLURGICAL ACTIVITIES ETC Permit Number: TP3237EB Original Permit Number: BL1100IX EPR Reference: - Issue Date: 2/5/2014 Effective Date: 2/5/2014 Last date noted as effective: 2017-04-01 Status: Surrender Effective

ID	Distance (m)	Direction	NGR	Details	
64D	236	SE	226500 381000	Operator: Anglesey Aluminium Metal Ltd Installation Name: Holyhead Aluminium Smelter Process: NON-FERROUS METALS; PRODUCING FROM RAW MATERIALS BY METALLURGICAL ACTIVITIES ETC	Permit Number: BP3731CL Original Permit Number: BL1100IX EPR Reference: - Issue Date: - Effective Date: - Last date noted as effective: 2012-10-01 Status: Determination
65D	236	SE	226500 381000	Operator: Anglesey Aluminium Metal Renewables Ltd Installation Name: Holyhead Aluminium Smelter Process: ASSOCIATED PROCESS	Permit Number: ZP3337KE Original Permit Number: ZP3337KE EPR Reference: - Issue Date: 8/3/2010 Effective Date: 8/3/2010 Last date noted as effective: 2013-04-01 Status: Superseded
66D	236	SE	226500 381000	Operator: Anglesey Aluminium Metal Ltd Installation Name: Holyhead Aluminium Smelter Process: -	Permit Number: BL1100IX Original Permit Number: BL1100IX EPR Reference: - Issue Date: 30/5/2003 Effective Date: 30/5/2003 Last date noted as effective: 2017-04-01 Status: Superseded
67D	236	SE	226500 381000	Operator: Anglesey Aluminium Metal Ltd Installation Name: - Process: NON-FERROUS METALS; PRODUCING FROM RAW MATERIALS BY METALLURGICAL ACTIVITIES ETC	Permit Number: BL1100 Original Permit Number: BL1100 EPR Reference: - Issue Date: 30-5-2003 Effective Date: 30-5-2003 Last date noted as effective: 2004-10-01 Status: Superseded By Pas
68D	236	SE	226500 381000	Operator: Anglesey Aluminium Metal Ltd Installation Name: Holyhead Aluminium Smelter Process: NON-FERROUS METALS; PRODUCING FROM RAW MATERIALS BY METALLURGICAL ACTIVITIES ETC	Permit Number: NP3633ER Original Permit Number: BL1100IX EPR Reference: - Issue Date: 29/10/2013 Effective Date: 29/10/2013 Last date noted as effective: 2017-04-01 Status: Superseded
69D	236	SE	226500 381000	Operator: Anglesey Aluminium Metal Ltd Installation Name: Holyhead Aluminium Smelter Process: FERROUS METALS; PRODUCING, MELTING OR REFINING	Permit Number: NP3633ER Original Permit Number: BL1100IX EPR Reference: - Issue Date: 29/10/2013 Effective Date: 29/10/2013 Last date noted as effective: 2017-04-01 Status: Superseded
70D	236	SE	226500 381000	Operator: Anglesey Aluminium Metal Ltd Installation Name: Holyhead Aluminium Smelter Process: NON-FERROUS METALS; PRODUCING FROM RAW MATERIALS BY METALLURGICAL ACTIVITIES ETC	Permit Number: BL1100IX Original Permit Number: BL1100IX EPR Reference: - Issue Date: 30/5/2003 Effective Date: 30/5/2003 Last date noted as effective: 2017-04-01 Status: Superseded
71D	236	SE	226500 381000	Operator: Anglesey Aluminium Metal Ltd Installation Name: Holyhead Aluminium Smelter Process: NON-FERROUS METALS; PRODUCING FROM RAW MATERIALS BY METALLURGICAL ACTIVITIES ETC	Permit Number: MP3135ZT Original Permit Number: BL1100IX EPR Reference: - Issue Date: 14/3/2013 Effective Date: 14/3/2013 Last date noted as effective: 2017-04-01 Status: Superseded

ID	Distance (m)	Direction	NGR	Details	
72D	236	SE	226500 381000	Operator: Anglesey Aluminium Metal Ltd Installation Name: Holyhead Aluminium Smelter Process: NON-FERROUS METALS; PRODUCING FROM RAW MATERIALS BY METALLURGICAL ACTIVITIES ETC	Permit Number: JP3532SB Original Permit Number: BL1100IX EPR Reference: - Issue Date: 29/6/2005 Effective Date: 30/6/2005 Last date noted as effective: 2017-04-01 Status: Superseded
73D	236	SE	226500 381000	Operator: Anglesey Aluminium Metal Ltd Installation Name: Holyhead Aluminium Smelter Process: FERROUS METALS; PRODUCING, MELTING OR REFINING	Permit Number: TP3237EB Original Permit Number: BL1100IX EPR Reference: - Issue Date: 2/5/2014 Effective Date: 2/5/2014 Last date noted as effective: 2017-04-01 Status: Surrender Effective
74D	236	SE	226500 381000	Operator: Anglesey Aluminium Metal Renewables Ltd Installation Name: Anglesey Renewable Energy Plant Epr/zp3337ke Process: ASSOCIATED PROCESS	Permit Number: NP3539TD Original Permit Number: ZP3337KE EPR Reference: - Issue Date: 10/3/2011 Effective Date: 10/3/2011 Last date noted as effective: 2017-04-01 Status: Effective
75D	236	SE	226500 381000	Operator: Anglesey Aluminium Metal Renewables Ltd Installation Name: Anglesey Renewable Energy Plant Epr/zp3337ke Process: NON-FERROUS METALS; PRODUCING FROM RAW MATERIALS BY METALLURGICAL ACTIVITIES ETC	Permit Number: NP3539TD Original Permit Number: ZP3337KE EPR Reference: - Issue Date: 10/3/2011 Effective Date: 10/3/2011 Last date noted as effective: 2017-04-01 Status: Effective
76D	236	SE	226500 381000	Operator: Anglesey Aluminium Metal Renewables Ltd Installation Name: Holyhead Aluminium Smelter Process: -	Permit Number: ZP3337KE Original Permit Number: ZP3337KE EPR Reference: - Issue Date: 8/3/2010 Effective Date: 8/3/2010 Last date noted as effective: 2017-04-01 Status: Superseded
77D	236	SE	226500 381000	Operator: Anglesey Aluminium Metal Renewables Ltd Installation Name: Holyhead Aluminium Smelter Process: -	Permit Number: ZP3337KE Original Permit Number: ZP3337KE EPR Reference: - Issue Date: 8/3/2010 Effective Date: 8/3/2010 Last date noted as effective: 2017-04-01 Status: Superseded
78D	236	SE	226500 381000	Operator: Anglesey Aluminium Metal Renewables Ltd Installation Name: Holyhead Aluminium Smelter Process: Unless falling within Part A (2) of this section, producing nonferrous metals fr...	Permit Number: ZP3337KE Original Permit Number: ZP3337KE EPR Reference: - Issue Date: 8/3/2010 Effective Date: 8/3/2010 Last date noted as effective: 2017-04-01 Status: Superseded
79D	236	SE	226500 381000	Operator: Anglesey Aluminium Metal Renewables Ltd Installation Name: Holyhead Aluminium Smelter Process: -	Permit Number: ZP3337KE Original Permit Number: ZP3337KE EPR Reference: - Issue Date: 8/3/2010 Effective Date: 8/3/2010 Last date noted as effective: 2017-04-01 Status: Superseded

ID	Distance (m)	Direction	NGR	Details	
80D	236	SE	226500 381000	Operator: Anglesey Aluminium Metal Renewables Ltd Installation Name: Holyhead Aluminium Smelter Process: ASSOCIATED PROCESS	Permit Number: ZP3337KE Original Permit Number: ZP3337KE EPR Reference: - Issue Date: 8/3/2010 Effective Date: 8/3/2010 Last date noted as effective: 2017-04-01 Status: Superseded
81D	236	SE	226500 381000	Operator: Anglesey Aluminium Metal Ltd Installation Name: Holyhead Aluminium Smelter Process: -	Permit Number: BL1100IX Original Permit Number: - EPR Reference: - Issue Date: 29/10/2013 Effective Date: 29/10/2013 Last date noted as effective: 2017-04-01 Status: Effective
82D	236	SE	226500 381000	Operator: Anglesey Aluminium Metal Ltd Installation Name: Holyhead Aluminium Smelter Process: NON-FERROUS METALS; PRODUCING FROM RAW MATERIALS BY METALLURGICAL ACTIVITIES ETC	Permit Number: BL1100IX Original Permit Number: - EPR Reference: - Issue Date: 29/10/2013 Effective Date: 29/10/2013 Last date noted as effective: 2017-04-01 Status: Effective
83D	236	SE	226500 381000	Operator: Orthios Installation Name: Anglesey Renewable Energy Plant Process: -	Permit Number: ZP3337KE Original Permit Number: - EPR Reference: - Issue Date: 10/6/2016 Effective Date: 10/6/2016 Last date noted as effective: 2017-04-01 Status: Effective
84D	236	SE	226500 381000	Operator: Orthios Installation Name: Anglesey Renewable Energy Plant Process: -	Permit Number: ZP3337KE Original Permit Number: - EPR Reference: - Issue Date: 10/6/2016 Effective Date: 10/6/2016 Last date noted as effective: 2017-04-01 Status: Effective
85D	236	SE	226500 381000	Operator: Orthios Installation Name: Anglesey Renewable Energy Plant Process: Unless falling within Part A (2) of this section, producing nonferrous metals fr...	Permit Number: ZP3337KE Original Permit Number: - EPR Reference: - Issue Date: 10/6/2016 Effective Date: 10/6/2016 Last date noted as effective: 2017-04-01 Status: Effective
86D	236	SE	226500 381000	Operator: Orthios Installation Name: Anglesey Renewable Energy Plant Process: -	Permit Number: ZP3337KE Original Permit Number: - EPR Reference: - Issue Date: 10/6/2016 Effective Date: 10/6/2016 Last date noted as effective: 2017-04-01 Status: Effective
87D	236	SE	226500 381000	Operator: Orthios Installation Name: Anglesey Renewable Energy Plant Process: ASSOCIATED PROCESS	Permit Number: ZP3337KE Original Permit Number: - EPR Reference: - Issue Date: 10/6/2016 Effective Date: 10/6/2016 Last date noted as effective: 2017-04-01 Status: Effective



ID	Distance (m)	Direction	NGR	Details	
88D	236	SE	226500 381000	Operator: Orthios Installation Name: Anglesey Renewable Energy Plant Process: -	Permit Number: ZP3337KE Original Permit Number: - EPR Reference: - Issue Date: 10/6/2016 Effective Date: 10/6/2016 Last date noted as effective: 2017-04-01 Status: Issued
89D	236	SE	226500 381000	Operator: Orthios Installation Name: Anglesey Renewable Energy Plant Process: -	Permit Number: ZP3337KE Original Permit Number: - EPR Reference: - Issue Date: 10/6/2016 Effective Date: 10/6/2016 Last date noted as effective: 2017-04-01 Status: Issued
90D	236	SE	226500 381000	Operator: Orthios Installation Name: Anglesey Renewable Energy Plant Process: Unless falling within Part A (2) of this section, producing nonferrous metals fr...	Permit Number: ZP3337KE Original Permit Number: - EPR Reference: - Issue Date: 10/6/2016 Effective Date: 10/6/2016 Last date noted as effective: 2017-04-01 Status: Issued
91D	236	SE	226500 381000	Operator: Orthios Installation Name: Anglesey Renewable Energy Plant Process: -	Permit Number: ZP3337KE Original Permit Number: - EPR Reference: - Issue Date: 10/6/2016 Effective Date: 10/6/2016 Last date noted as effective: 2017-04-01 Status: Issued
92D	236	SE	226500 381000	Operator: Orthios Installation Name: Anglesey Renewable Energy Plant Process: ASSOCIATED PROCESS	Permit Number: ZP3337KE Original Permit Number: - EPR Reference: - Issue Date: 10/6/2016 Effective Date: 10/6/2016 Last date noted as effective: 2017-04-01 Status: Issued
93D	236	SE	226500 381000	Operator: Orthios Installation Name: Anglesey Renewable Energy Plant Process: -	Permit Number: ZP3337KE Original Permit Number: - EPR Reference: - Issue Date: 10/6/2016 Effective Date: 10/6/2016 Last date noted as effective: 2017-04-01 Status: Issued
94D	236	SE	226500 381000	Operator: Orthios Installation Name: Anglesey Renewable Energy Plant Process: -	Permit Number: ZP3337KE Original Permit Number: - EPR Reference: - Issue Date: 10/6/2016 Effective Date: 10/6/2016 Last date noted as effective: 2017-04-01 Status: Issued
95D	236	SE	226500 381000	Operator: Orthios Installation Name: Anglesey Renewable Energy Plant Process: Unless falling within Part A (2) of this section, producing nonferrous metals fr...	Permit Number: ZP3337KE Original Permit Number: - EPR Reference: - Issue Date: 10/6/2016 Effective Date: 10/6/2016 Last date noted as effective: 2017-04-01 Status: Issued

ID	Distance (m)	Direction	NGR		Details
96D	236	SE	226500 381000	Operator: Orthios Installation Name: Anglesey Renewable Energy Plant Process: -	Permit Number: ZP3337KE Original Permit Number: - EPR Reference: - Issue Date: 10/6/2016 Effective Date: 10/6/2016 Last date noted as effective: 2017-04-01 Status: Issued
97D	236	SE	226500 381000	Operator: Orthios Installation Name: Anglesey Renewable Energy Plant Process: ASSOCIATED PROCESS	Permit Number: ZP3337KE Original Permit Number: - EPR Reference: - Issue Date: 10/6/2016 Effective Date: 10/6/2016 Last date noted as effective: 2017-04-01 Status: Issued

### 2.1.3 Records of Red List Discharge Consents (potentially harmful discharges to controlled waters) within 500m of the study site:

0

Database searched and no data found.

### 2.1.4 Records of List 1 Dangerous Substances Inventory Sites within 500m of the study site:

0

Database searched and no data found.

### 2.1.5 Records of List 2 Dangerous Substance Inventory Sites within 500m of the study site:

0

Database searched and no data found.

### 2.1.6 Records of Part A(2) and Part B Activities and Enforcements within 500m of the study site:

0

Database searched and no data found.

### 2.1.7 Records of Category 3 or 4 Radioactive Substances Authorisations:

0

Database searched and no data found.

## 2.1.8 Records of Licensed Discharge Consents within 500m of the study site:

7

The following Licensed Discharge Consents records are represented as points on the Environmental Permits, Incidents and Registers Map:

ID	Distance (m)	Direction	NGR	Details
5B	298	N	226400 381600	<p>Address: PENRHOS WORKS PO BOX 4 HOLYHEAD YN, PENRHOS WORKS PO BOX 4 HOLYHEAD, PO BOX 4 HOLYHEAD YNYS MON, HOLYHEAD YNYS MON, HOLYHEAD YNYS MON, YNYS MON Effluent Type: TRADE DISCHARGES - UNSPECIFIED Permit Number: CG0336401 Permit Version: 2</p> <p>Receiving Water: IRISH SEA - COASTAL Status: REVOKED AND REPLACED BY IPC AUTHORISATION Issue date: 13/05/1994 Effective Date: 13-Aug-1994 Revocation Date: 15/05/1996</p>
6B	298	N	226400 381600	<p>Address: PENRHOS WORKS PO BOX 4 HOLYHEAD YN, PENRHOS WORKS PO BOX 4 HOLYHEAD, PO BOX 4 HOLYHEAD YNYS MON, HOLYHEAD YNYS MON, HOLYHEAD YNYS MON, YNYS MON Effluent Type: UNSPECIFIED Permit Number: CG0336401 Permit Version: 1</p> <p>Receiving Water: IRISH SEA - COASTAL Status: REVOKED - UNSPECIFIED Issue date: 04/02/1985 Effective Date: 04-May-1985 Revocation Date: 12/08/1994</p>
7	340	NW	226004 381455	<p>Address: HOLYHEAD WWTW FINAL EFFLUENT PS, HOLYHEAD WWTW, PENRHOS INDUSTRIAL ESTATE, HOLYHEAD, ANGLESEY, LL65 2QU Effluent Type: SEWAGE DISCHARGES - SEWER STORM OVERFLOW - WATER COMPANY Permit Number: CG0433001 Permit Version: 1</p> <p>Receiving Water: UN-NAMED WATERCOURSE Status: NEW CONSENT (WRA 91, S88 &amp; SCHED 10 AS AMENDED BY ENV ACT 1995) Issue date: 20/05/2005 Effective Date: 31-Dec-2005 Revocation Date: -</p>
8C	462	NW	226050 381650	<p>Address: HOLYHEAD PENRHOS BEACH P.S., HOLYHEAD PENRHOS BEACH P.S., UNKNOWN, UNKNOWN, UNKNOWN, UNKNOWN Effluent Type: UNSPECIFIED Permit Number: CG0147301 Permit Version: 1</p> <p>Receiving Water: COASTAL WATERS Status: REVOKED - UNSPECIFIED Issue date: 29/09/1987 Effective Date: 29-Sep-1987 Revocation Date: 22/02/1993</p>
9C	462	NW	226050 381650	<p>Address: HOLYHEAD PENRHOS BEACH P.S., HOLYHEAD PENRHOS BEACH P.S., UNKNOWN, UNKNOWN, UNKNOWN, UNKNOWN Effluent Type: UNSPECIFIED Permit Number: CG0147301 Permit Version: 2</p> <p>Receiving Water: COASTAL WATERS Status: NEW CONSENT, BY APPLICATION (WRA 91, SECTION 88) Issue date: 23/11/1992 Effective Date: 23-Feb-1993 Revocation Date: 30/12/2005</p>
10C	463	NW	226026 381631	<p>Address: PENRHOS BEACH PUMPING STATION, BEACH ROAD, PENRHOS BEACH, HOLYHEAD, ANGLESEY Effluent Type: SEWAGE DISCHARGES - PUMPING STATION - WATER COMPANY Permit Number: CG0147301 Permit Version: 3</p> <p>Receiving Water: BEDDMANARCH BAY Status: VARIED BY APPLICATION - (WRA 91 SCHED 10 - AS AMENDED BY ENV ACT 1995) Issue date: 25/05/2005 Effective Date: 31-Dec-2005 Revocation Date: -</p>
11C	463	NW	226026 381631	<p>Address: PENRHOS BEACH PUMPING STATION, BEACH ROAD, PENRHOS BEACH, HOLYHEAD, ANGLESEY Effluent Type: SEWAGE DISCHARGES - PUMPING STATION - WATER COMPANY Permit Number: CG0147301 Permit Version: 3</p> <p>Receiving Water: BEDDMANARCH BAY Status: VARIED BY APPLICATION - (WRA 91 SCHED 10 - AS AMENDED BY ENV ACT 1995) Issue date: 25/05/2005 Effective Date: 31-Dec-2005 Revocation Date: -</p>

### 2.1.9 Records of Water Industry Referrals (potentially harmful discharges to the public sewer) within 500m of the study site:

0

Database searched and no data found.

### 2.1.10 Records of Planning Hazardous Substance Consents and Enforcements within 500m of the study site:

0

Database searched and no data found.

## 2.2 Dangerous or Hazardous Sites

Records of COMAH & NIHHS sites within 500m of the study site:

1

The following COMAH & NIHHS Authorisation records provided by the Health and Safety Executive are represented as polygons or buffered points on the Environmental Permits, Incidents and Registers Map:

ID	Distance (m)	Direction	Company	Address	Operational Status	Tier
58	0	On Site	Anglesey Aluminium Metal Ltd	Anglesey Aluminium Metal Ltd, Holyhead, Penrhos Works, Holyhead, Anglesey, LL65 2UJ	Historical COMAH Site	-

## 2.3 Environment Agency/Natural Resources Wales Recorded Pollution Incidents

### 2.3.1 Records of National Incidents Recording System, List 2 within 500m of the study site:

4

The following NIRS List 2 records are represented as points on the Environmental Permits, Incidents and Registers Map:

ID	Distance (m)	Direction	NGR	Details
1	90	NE	226494 381276	<p>Incident Date: 19-Mar-2002 Incident Identification: 64962 Pollutant: Atmospheric Pollutants and Effects Pollutant Description: Soot/Smuts</p> <p>Water Impact: Category 4 (No Impact) Land Impact: Category 4 (No Impact) Air Impact: Category 3 (Minor)</p>

ID	Distance (m)	Direction	NGR	Details
2A	345	NW	226040 381490	Incident Date: 08-Aug-2001 Incident Identification: 22668 Pollutant: Atmospheric Pollutants and Effects Pollutant Description: Damage to Buildings Vehicles and Vegetation Water Impact: Category 4 (No Impact) Land Impact: Category 4 (No Impact) Air Impact: Category 3 (Minor)
3A	345	NW	226040 381490	Incident Date: 08-Aug-2001 Incident Identification: 22668 Pollutant: Atmospheric Pollutants and Effects Pollutant Description: "Damage to Buildings, Vehicles and Vegetation" Water Impact: Category 4 (No Impact) Land Impact: Category 4 (No Impact) Air Impact: Category 3 (Minor)
4A	345	NW	226040 381490	Incident Date: 08-Aug-2001 Incident Identification: 22668 Pollutant: Atmospheric Pollutants and Effects Pollutant Description: Damage to Buildings, Vehicles and Vegetation Water Impact: Category 4 (No Impact) Land Impact: Category 4 (No Impact) Air Impact: Category 3 (Minor)

### 2.3.2 Records of National Incidents Recording System, List 1 within 500m of the study site:

0

Database searched and no data found.

## 2.4 Sites Determined as Contaminated Land under Part 2A EPA 1990

How many records of sites determined as contaminated land under Section 78R of the Environmental Protection Act 1990 are there within 500m of the study site?

0

Database searched and no data found.

# 3. Landfill and Other Waste Sites Map

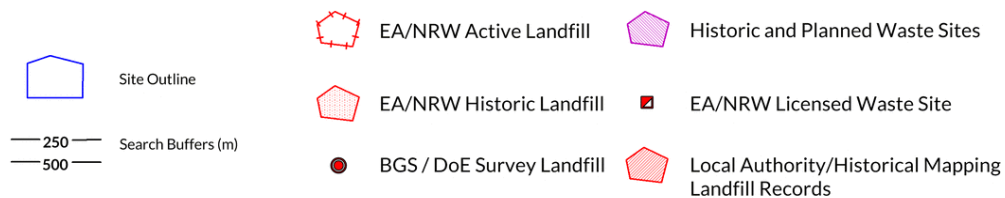
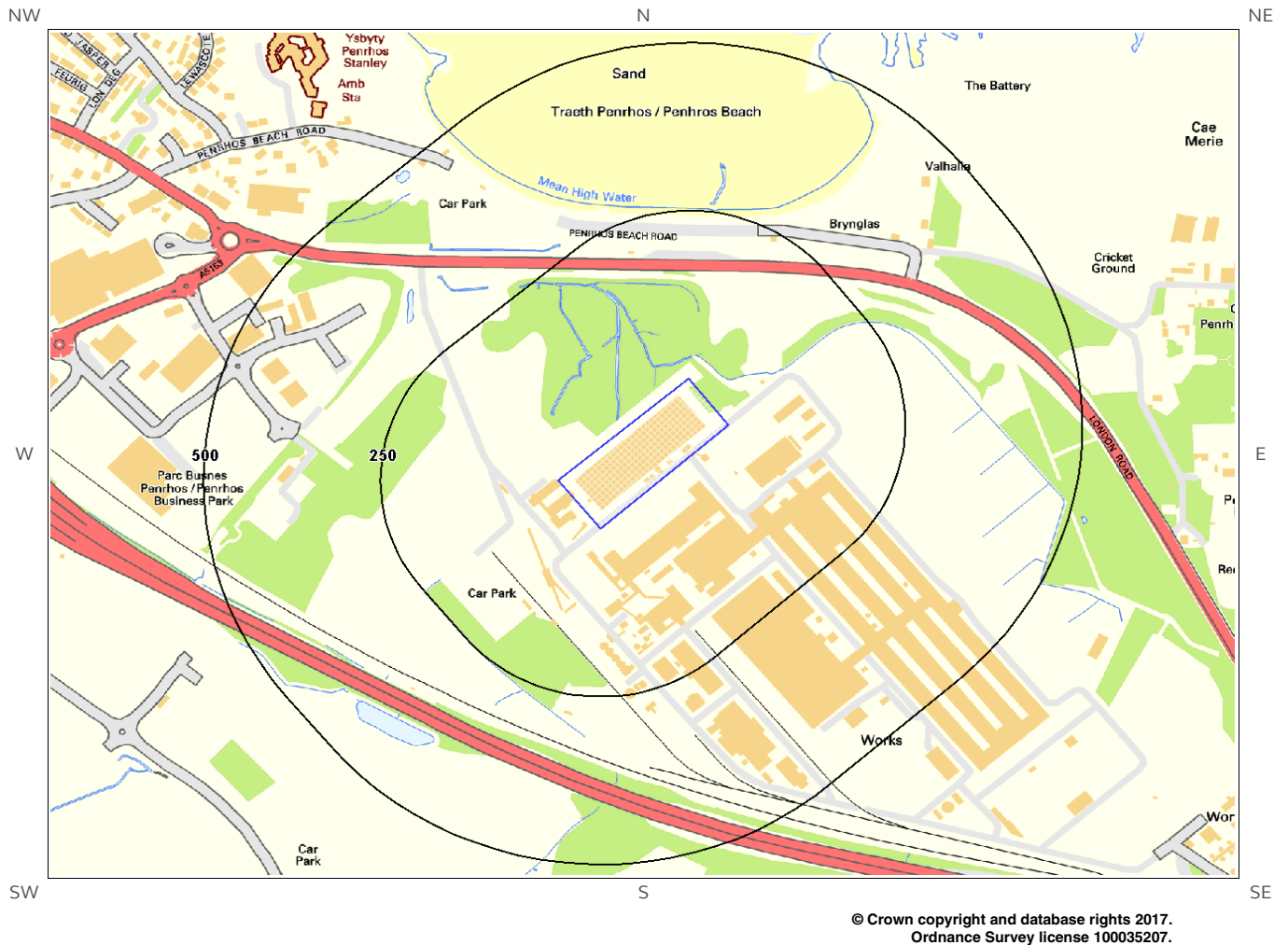



# 3. Landfill and Other Waste Sites

## 3.1 Landfill Sites

3.1.1 Records from Environment Agency/Natural Resources Wales landfill data within 1000m of the study site:

0

Database searched and no data found.

3.1.2 Records of Environment Agency/Natural Resources Wales historic landfill sites within 1500m of the study site:

2

The following landfill records are represented as either points or polygons on the Landfill and Other Waste Sites map:

ID	Distance (m)	Direction	NGR	Details
Not shown	1039	SE	227000 380200	Site Address: Cae Glas Road, Penrhos Waste Licence: - Site Reference: - Waste Type: Inert, Industrial, Commercial, Household, Special Environmental Permitting Regulations (Waste) Reference: - Licence Issue: Licence Surrendered: Licence Holder Address: - Operator: - Licence Holder: Isle of Anglesey Borough Council First Recorded: 31-Dec-1968 Last Recorded: 31-Dec-1980
Not shown	1241	W	224900 381600	Site Address: Kingsland, Greenfield Road, Holyhead Waste Licence: Yes Site Reference: 4 Waste Type: Inert Environmental Permitting Regulations (Waste) Reference: - Licence Issue: 31-Dec-1978 Licence Surrendered: Licence Holder Address: Rail House, Holyhead Operator: - Licence Holder: Shipping and Port Manager First Recorded: 31-Dec-1978 Last Recorded: 31-Dec-1979

3.1.3 Records of BGS/DoE non-operational landfill sites within 1500m of the study site:

0

Database searched and no data found.

### 3.1.4 Records of Landfills from Local Authority and Historical Mapping Records within 1500m of the study site:

1

The following landfill records are represented as points or polygons on the Landfill and Other Waste Sites map:

ID	Distance (m)	Direction	NGR	Site Address	Source	Data Type
Not shown	1042	SE	227027 380247	Refuse Tip	1973 mapping	Polygon

## 3.2 Other Waste Sites

### 3.2.1 Records of waste treatment, transfer or disposal sites within 500m of the study site:

0

Database searched and no data found.

### 3.2.2 Records of Environment Agency/Natural Resources Wales licensed waste sites within 1500m of the study site:

2

The following waste treatment, transfer or disposal sites records are represented as points on the Landfill and Other Waste Sites map:

ID	Distance (m)	Direction	NGR	Details
Not shown	1425	W	224796 381521	<p>Site Address: Berwyn Yard, Porthdafarch Road, Holyhead, Ynys Mon, LL65 2SA Type: Household, Commercial &amp; Industrial Waste T Stn Size: &lt; 25000 tonnes Environmental Permitting Regulations (Waste) Licence Number: GRA001 EPR reference: WP3294FU/V003 Operator: David Owen Gray &amp; Elizabeth Gray Waste Management licence No: 37217 Annual Tonnage: 6758.0</p> <p>Issue Date: 10/11/2000 Effective Date: - Modified: 10/03/2006 Surrendered Date: 0 Expiry Date: 0 Cancelled Date: 0 Status: Expired Site Name: Gray's Engineering &amp; Plant Correspondence Address: -</p>
Not shown	1426	W	224795 381520	<p>Site Address: Gray's Engineering &amp; Plant, Holyhead, Isle of Anglesey, LL65 2SA Type: - Size: Unknown Environmental Permitting Regulations (Waste) Licence Number: WP3294FU EPR reference: - Operator: David Owen Gray &amp; Elizabeth Gray Waste Management licence No: 0 Annual Tonnage: 0.0</p> <p>Issue Date: 10/11/2000 Effective Date: 10/11/2000 Modified: - Surrendered Date: - Expiry Date: - Cancelled Date: - Status: Expired Site Name: - Correspondence Address: -</p>

## 4. Current Land Use Map

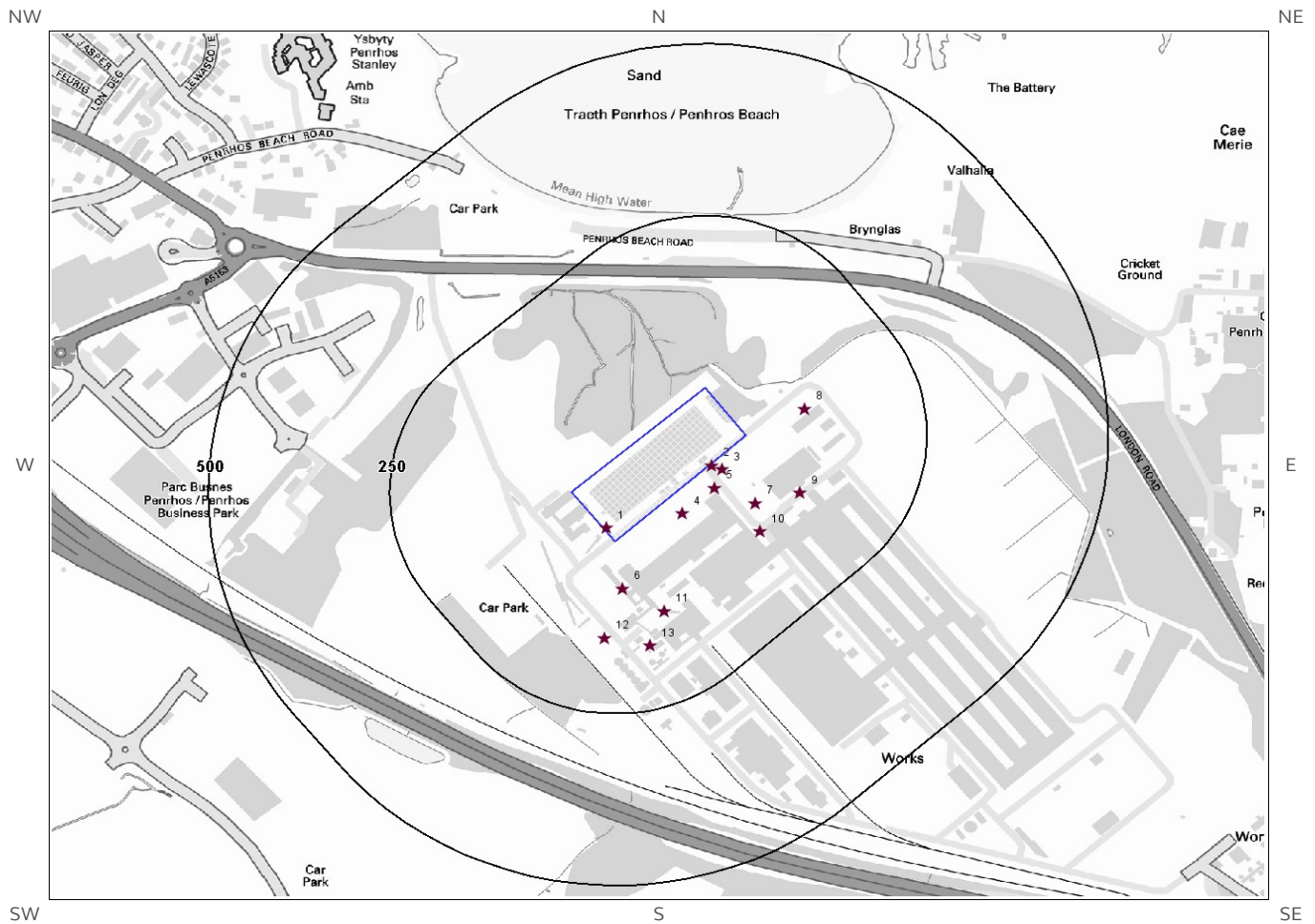

© Crown copyright and database rights 2017.  
Ordnance Survey license 100035207.



## 4. Current Land Uses

### 4.1 Current Industrial Data

Records of potentially contaminative industrial sites within 250m of the study site:

13

The following records are represented as points on the Current Land Uses map.

ID	Distance (m)	Direction	Company	NGR	Address	Activity	Category
1	0	On Site	Conveyor	226221 381102	LL65	Conveyors	Industrial Features
2	2	SE	Conveyor	226366 381193	LL65	Conveyors	Industrial Features
3	16	SE	Hopper	226381 381187	LL65	Hoppers and Silos	Farming
4	29	SE	Works	226326 381123	LL65	Unspecified Works Or Factories	Industrial Features
5	30	SE	Hopper	226370 381160	LL65	Hoppers and Silos	Farming
6	68	S	Conveyor	226243 381014	LL65	Conveyors	Industrial Features
7	83	SE	Hoppers	226426 381138	LL65	Hoppers and Silos	Farming
8	90	NE	Chimney	226494 381275	LL65	Chimneys	Industrial Features
9	112	SE	Hoppers	226488 381153	LL65	Hoppers and Silos	Farming
10	118	SE	Hoppers	226432 381097	LL65	Hoppers and Silos	Farming
11	121	SE	Conveyor	226301 380981	LL65	Conveyors	Industrial Features
12	140	S	Conveyor	226219 380942	LL65	Conveyors	Industrial Features
13	158	S	Tank	226281 380931	LL65	Tanks (Generic)	Industrial Features

### 4.2 Petrol and Fuel Sites

Records of petrol or fuel sites within 500m of the study site:

0

Database searched and no data found.

### 4.3 National Grid High Voltage Underground Electricity Transmission Cables

This dataset identifies the high voltage electricity transmission lines running between generating power plants and electricity substations. The dataset does not include the electricity distribution network (smaller, lower voltage cables distributing power from substations to the local user network). This information has been extracted from databases held by National Grid and is provided for information only with no guarantee as to its completeness or accuracy. National Grid do not offer any warranty as to the accuracy of the available data and are excluded from any liability for any such inaccuracies or errors.

Records of National Grid high voltage underground electricity transmission cables within 500m of the study site:

0

Database searched and no data found.

---

### 4.4 National Grid High Pressure Gas Transmission Pipelines

This dataset identifies high-pressure, large diameter pipelines which carry gas between gas terminals, power stations, compressors and storage facilities. The dataset does not include the Local Transmission System (LTS) which supplies gas directly into homes and businesses. This information has been extracted from databases held by National Grid and is provided for information only with no guarantee as to its completeness or accuracy. National Grid do not offer any warranty as to the accuracy of the available data and are excluded from any liability for any such inaccuracies or errors.

Records of National Grid high pressure gas transmission pipelines within 500m of the study site:

0

Database searched and no data found.

---

# 5. Geology

## 5.1 Artificial Ground and Made Ground

Database searched and no data found.

The database has been searched on site, including a 50m buffer.

---

## 5.2 Superficial Ground and Drift Geology

The database has been searched on site, including a 50m buffer.

Lex Code	Description	Rock Type
GFDUD-XSV	GLACIOFLUVIAL DEPOSITS, DEVENSIAN	SAND AND GRAVEL
TFD-XCZ	TIDAL FLAT DEPOSITS	CLAY AND SILT
TILLD-DMTN	TILL, DEVENSIAN	DIAMICTON

---

## 5.3 Bedrock and Solid Geology

The database has been searched on site, including a 50m buffer.

Lex Code	Description	Rock Type
NNH-SMPS	NEW HARBOUR GROUP	MICA SCHIST AND PSAMMITE

(Derived from the BGS 1:50,000 Digital Geological Map of Great Britain)

---



# 6 Hydrogeology and Hydrology

## 6a. Aquifer Within Superficial Geology

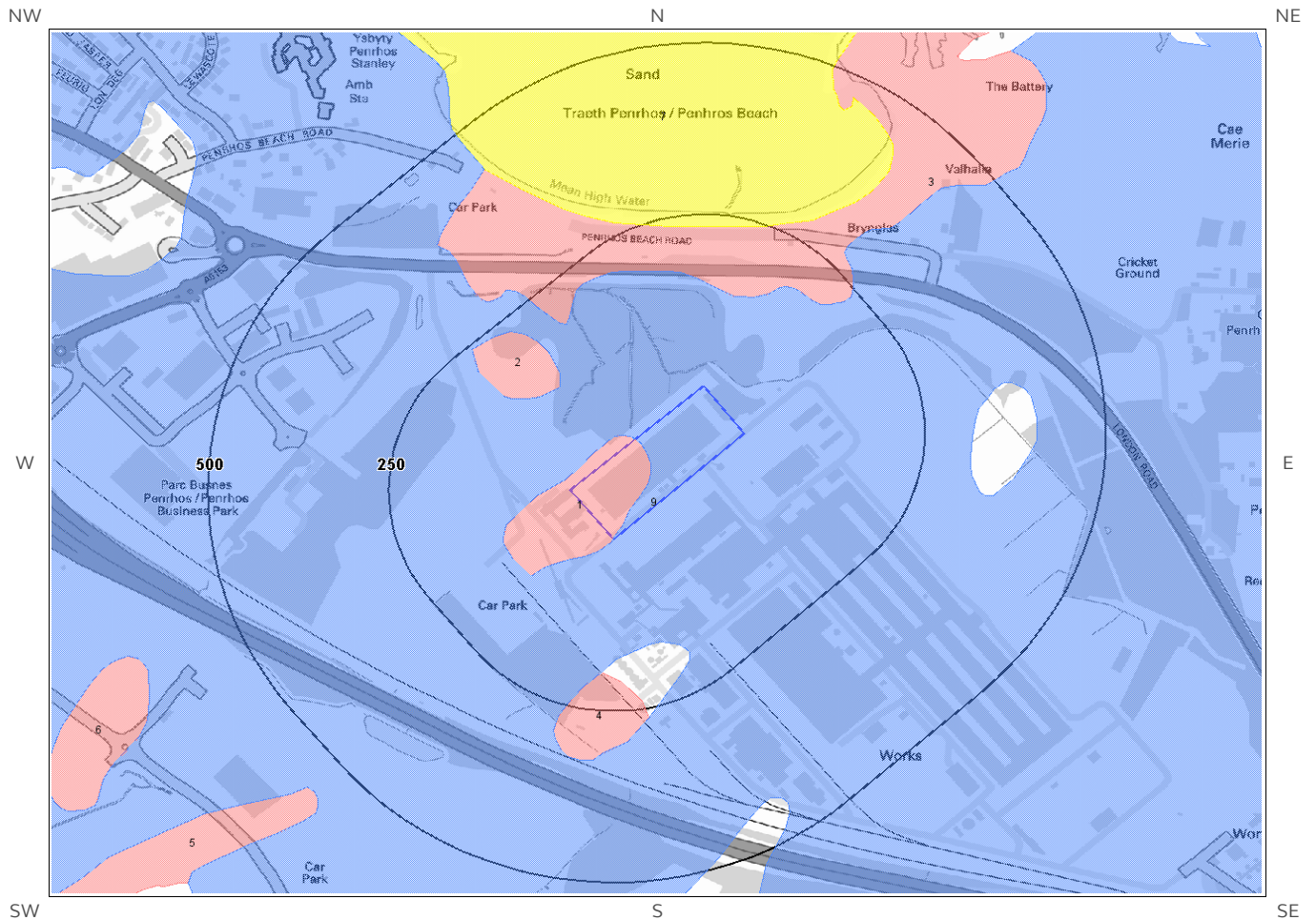

© Crown copyright and database rights 2017  
Ordnance Survey license 100035207.

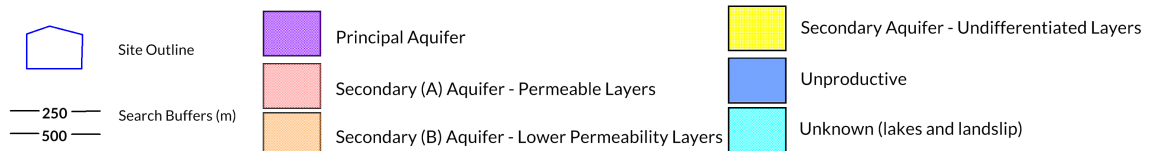

# 6b. Aquifer Within Bedrock Geology and Abstraction Licenses



© Crown copyright and database rights 2017  
Ordnance Survey license 100035207.

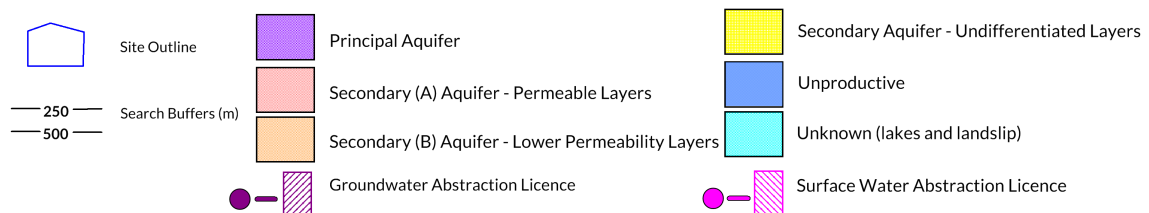

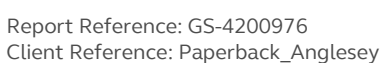
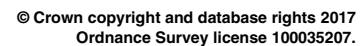



# 6d. Hydrogeology – Source Protection Zones within confined aquifer

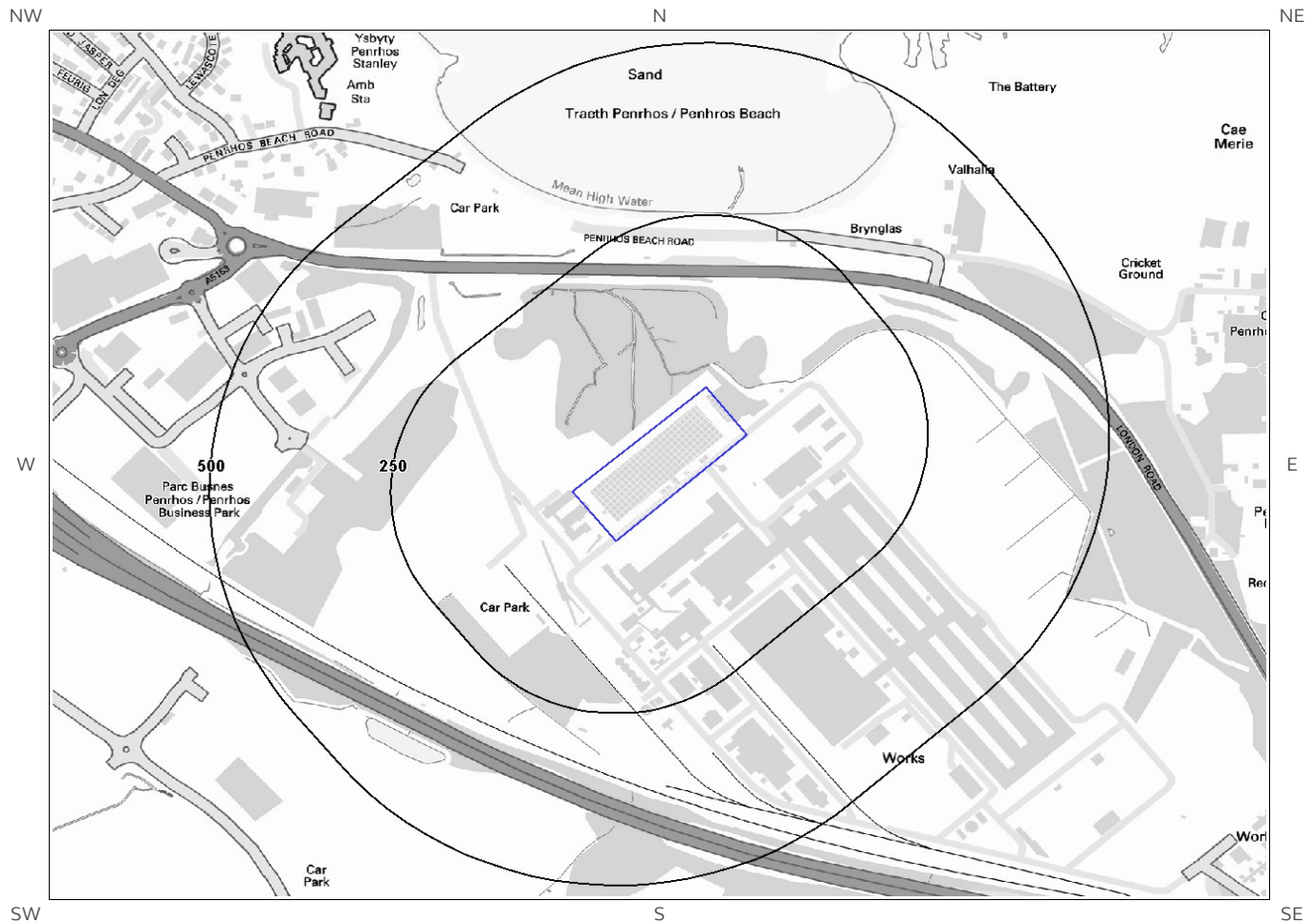

© Crown copyright and database rights 2017  
Ordnance Survey license 100035207.

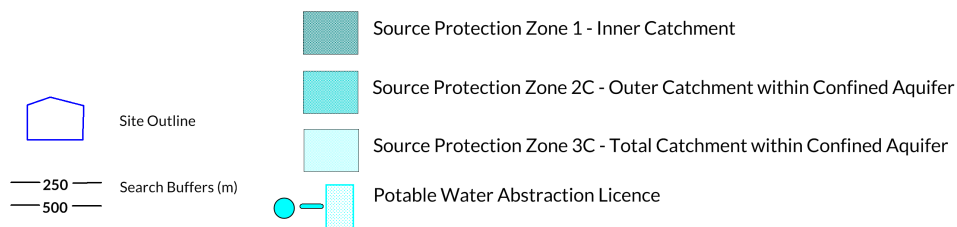

# 6e. Hydrology – Detailed River Network and River Quality

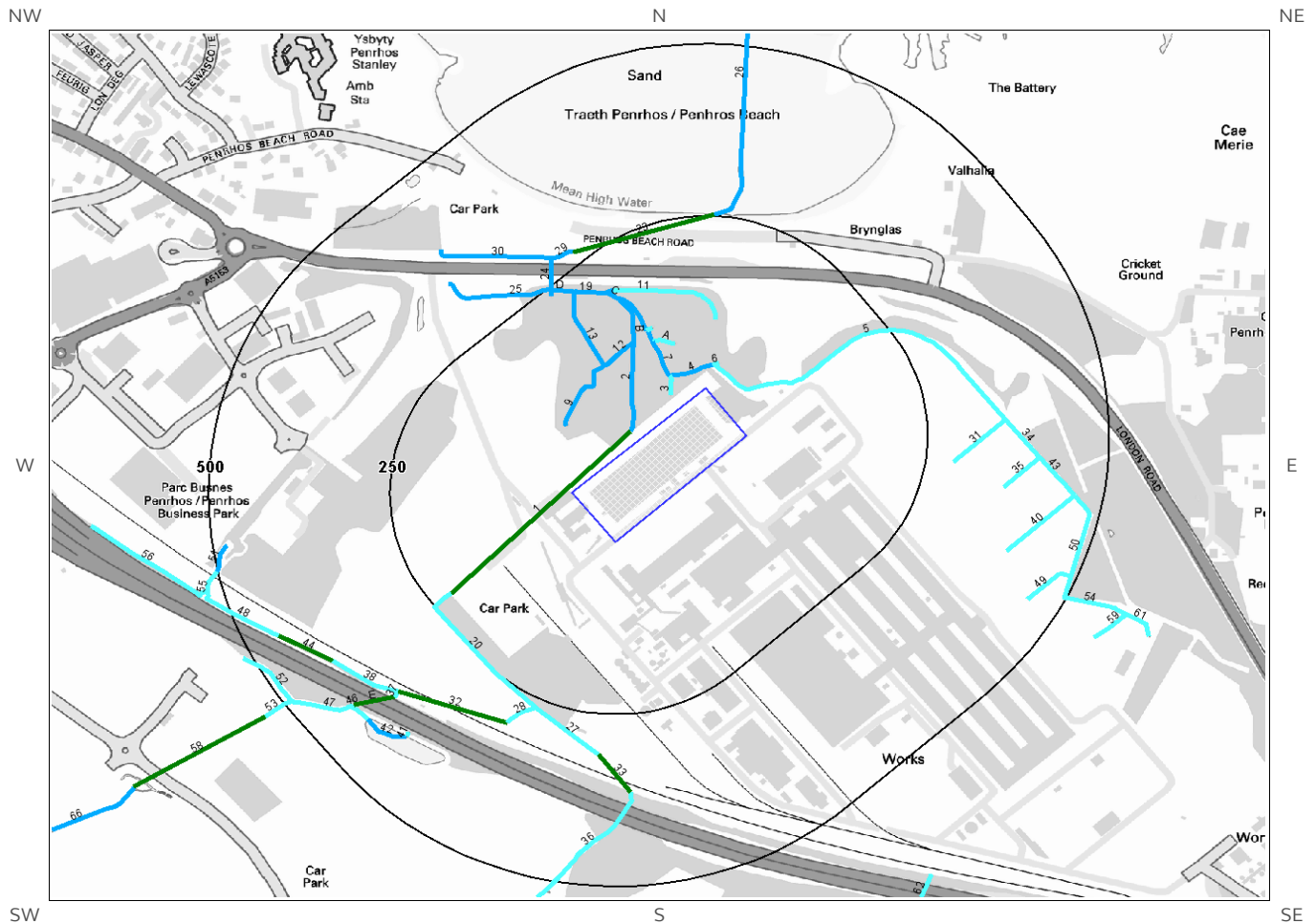

© Crown copyright and database rights 2017.  
Ordnance Survey license 100035207.

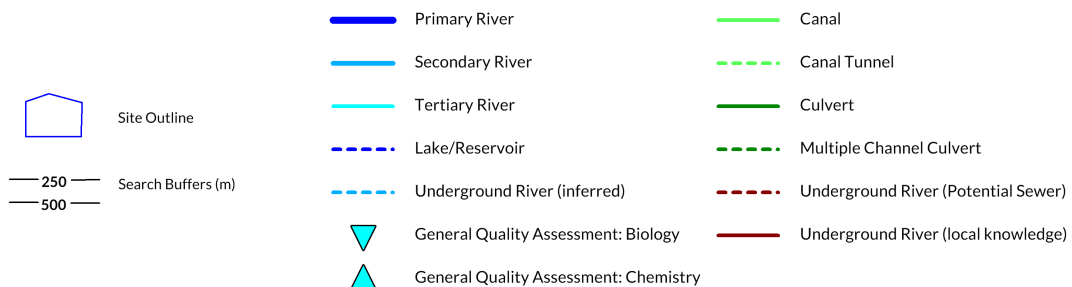

# 6. Hydrogeology and Hydrology

## 6.1 Aquifer within Superficial Deposits

Are there records of strata classification within the superficial geology at or in proximity to the property? **Yes**

From 1 April 2010, the Environment Agency/Natural Resources Wales's Groundwater Protection Policy has been using aquifer designations consistent with the Water Framework Directive. For further details on the designation and interpretation of this information, please refer to the Groundsure Enviro Insight User Guide.

The following aquifer records are shown on the Aquifer within Superficial Geology Map (6a):

ID	Distance (m)	Direction	Designation	Description
1	0	On Site	Secondary A	Permeable layers capable of supporting water supplies at a local rather than strategic scale, and in some cases forming an important source of base flow to rivers. These are generally aquifers formerly classified as minor aquifers
9	0	On Site	Unproductive	These are rock layers or drift deposits with low permeability that have negligible significance for water supply or river base flow
2	125	NW	Secondary A	Permeable layers capable of supporting water supplies at a local rather than strategic scale, and in some cases forming an important source of base flow to rivers. These are generally aquifers formerly classified as minor aquifers
3	136	N	Secondary A	Permeable layers capable of supporting water supplies at a local rather than strategic scale, and in some cases forming an important source of base flow to rivers. These are generally aquifers formerly classified as minor aquifers
4	194	S	Secondary A	Permeable layers capable of supporting water supplies at a local rather than strategic scale, and in some cases forming an important source of base flow to rivers. These are generally aquifers formerly classified as minor aquifers
7	232	N	Secondary (undifferentiated)	Assigned where it is not possible to attribute either category A or B to a rock type. In general these layers have previously been designated as both minor and non-aquifer in different locations due to the variable characteristics of the rock type

## 6.2 Aquifer within Bedrock Deposits

Are there records of strata classification within the bedrock geology at or in proximity to the property? **Yes**

From 1 April 2010, the Environment Agency/Natural Resources Wales's Groundwater Protection Policy has been using aquifer designations consistent with the Water Framework Directive. For further details on the designation and interpretation of this information, please refer to the Groundsure Enviro Insight User Guide.

The following aquifer records are shown on the Aquifer within Bedrock Geology Map (6b):

ID	Distance (m)	Direction	Designation	Description
1	0	On Site	Secondary B	Predominantly lower permeability layers which may store/yield limited amounts of groundwater due to localised features such as fissures, thin permeable horizons and weathering. These are generally the water-bearing parts of the former non-aquifers

### 6.3 Groundwater Abstraction Licences

Are there any Groundwater Abstraction Licences within 2000m of the study site? No

Database searched and no data found.

---

### 6.4 Surface Water Abstraction Licences

Are there any Surface Water Abstraction Licences within 2000m of the study site? No

Database searched and no data found.

---

### 6.5 Potable Water Abstraction Licences

Are there any Potable Water Abstraction Licences within 2000m of the study site? No

Database searched and no data found.

---

### 6.6 Source Protection Zones

Are there any Source Protection Zones within 500m of the study site? No

Database searched and no data found.

---

### 6.7 Source Protection Zones within Confined Aquifer

Are there any Source Protection Zones within the Confined Aquifer within 500m of the study site? No

Historically, Source Protection Zone maps have been focused on regulation of activities which occur at or near the ground surface, such as prevention of point source pollution and bacterial contamination of water supplies. Sources in confined aquifers were often considered to be protected from these surface pressures due to the presence of a low permeability confining layer (e.g. glacial till, clay). The increased interest in subsurface activities such as onshore oil and gas exploration, ground source heating and cooling requires protection zones for confined sources to be marked on SPZ maps where this has not already been done.

Database searched and no data found.

---



## 6.8 Groundwater Vulnerability and Soil Leaching Potential

Is there any Environment Agency/Natural Resources Wales information on groundwater vulnerability and soil leaching potential within 500m of the study site? Yes

Distance (m)	Direction	Classification	Soil Vulnerability Category	Description
197	N	Minor Aquifer/High Leaching Potential	H1	Soils which readily transmit liquid discharges because they are shallow or susceptible to rapid flow directly to rock, gravel or groundwater.

## 6.9 River Quality

Is there any Environment Agency/Natural Resources Wales information on river quality within 1500m of the study site? No

### 6.9.1 Biological Quality:

Database searched and no data found.

### 6.9.2 Chemical Quality:

Database searched and no data found.

## 6.10 Detailed River Network

Are there any Detailed River Network entries within 500m of the study site? Yes

The following Detailed River Network records are represented on the Hydrology Map (6e):

ID	Distance (m)	Direction	Details
1	8	NW	<div>River Name: -</div> <div>Welsh River Name: -</div> <div>Alternative Name: -</div> <div>River Type: Culvert</div> <div>Main River Status: Currently Undefined</div>
2	17	NW	<div>River Name: -</div> <div>Welsh River Name: -</div> <div>Alternative Name: -</div> <div>River Type: Secondary River</div> <div>Main River Status: Currently Undefined</div>
3	23	NW	<div>River Name: -</div> <div>Welsh River Name: -</div> <div>Alternative Name: -</div> <div>River Type: Tertiary River</div> <div>Main River Status: Currently Undefined</div>
4	29	NW	<div>River Name: Drain</div> <div>Welsh River Name: -</div> <div>Alternative Name: -</div> <div>River Type: Secondary River</div> <div>Main River Status: Currently Undefined</div>

ID	Distance (m)	Direction	Details	
5	34	NE	River Name: Drain Welsh River Name: - Alternative Name: -	River Type: Tertiary River Main River Status: Currently Undefined
6	35	N	River Name: - Welsh River Name: - Alternative Name: -	River Type: Tertiary River Main River Status: Currently Undefined
7	46	NW	River Name: Drain Welsh River Name: - Alternative Name: -	River Type: Secondary River Main River Status: Currently Undefined
8A	78	NW	River Name: Drain Welsh River Name: - Alternative Name: -	River Type: Tertiary River Main River Status: Currently Undefined
9	80	NW	River Name: - Welsh River Name: - Alternative Name: -	River Type: Secondary River Main River Status: Currently Undefined
10A	99	NW	River Name: Drain Welsh River Name: - Alternative Name: -	River Type: Secondary River Main River Status: Currently Undefined
11	101	N	River Name: Drain Welsh River Name: - Alternative Name: -	River Type: Tertiary River Main River Status: Currently Undefined
12	113	NW	River Name: - Welsh River Name: - Alternative Name: -	River Type: Secondary River Main River Status: Currently Undefined
13	114	NW	River Name: Drain Welsh River Name: - Alternative Name: -	River Type: Secondary River Main River Status: Currently Undefined
14A	114	NW	River Name: - Welsh River Name: - Alternative Name: -	River Type: Tertiary River Main River Status: Currently Undefined
15B	115	NW	River Name: Drain Welsh River Name: - Alternative Name: -	River Type: Secondary River Main River Status: Currently Undefined
16B	116	NW	River Name: - Welsh River Name: - Alternative Name: -	River Type: Secondary River Main River Status: Currently Undefined
17C	173	NW	River Name: - Welsh River Name: - Alternative Name: -	River Type: Secondary River Main River Status: Currently Undefined
18C	191	NW	River Name: - Welsh River Name: - Alternative Name: -	River Type: Secondary River Main River Status: Currently Undefined
19	193	NW	River Name: - Welsh River Name: - Alternative Name: -	River Type: Secondary River Main River Status: Currently Undefined
20	221	SW	River Name: Drain Welsh River Name: - Alternative Name: -	River Type: Tertiary River Main River Status: Currently Undefined
21D	224	NW	River Name: - Welsh River Name: - Alternative Name: -	River Type: Secondary River Main River Status: Currently Undefined
22D	238	NW	River Name: - Welsh River Name: - Alternative Name: -	River Type: Secondary River Main River Status: Currently Undefined
23	240	N	River Name: - Welsh River Name: - Alternative Name: -	River Type: Culvert Main River Status: Currently Undefined

ID	Distance (m)	Direction	Details	
24	245	NW	River Name: - Welsh River Name: - Alternative Name: -	River Type: Secondary River Main River Status: Currently Undefined
25	245	NW	River Name: Drain Welsh River Name: - Alternative Name: -	River Type: Secondary River Main River Status: Currently Undefined
26	253	N	River Name: - Welsh River Name: - Alternative Name: -	River Type: Secondary River Main River Status: Currently Undefined
27	264	SW	River Name: - Welsh River Name: - Alternative Name: -	River Type: Tertiary River Main River Status: Currently Undefined
28	264	SW	River Name: Drain Welsh River Name: - Alternative Name: -	River Type: Tertiary River Main River Status: Currently Undefined
29	269	NW	River Name: - Welsh River Name: - Alternative Name: -	River Type: Secondary River Main River Status: Currently Undefined
30	282	NW	River Name: Drain Welsh River Name: - Alternative Name: -	River Type: Secondary River Main River Status: Currently Undefined
31	287	E	River Name: Drain Welsh River Name: - Alternative Name: -	River Type: Tertiary River Main River Status: Currently Undefined
32	301	SW	River Name: - Welsh River Name: - Alternative Name: -	River Type: Culvert Main River Status: Currently Undefined
33	309	S	River Name: - Welsh River Name: - Alternative Name: -	River Type: Culvert Main River Status: Currently Undefined
34	358	E	River Name: - Welsh River Name: - Alternative Name: -	River Type: Tertiary River Main River Status: Currently Undefined
35	362	E	River Name: Drain Welsh River Name: - Alternative Name: -	River Type: Tertiary River Main River Status: Currently Undefined
36	363	S	River Name: - Welsh River Name: - Alternative Name: -	River Type: Tertiary River Main River Status: Currently Undefined
37	369	SW	River Name: - Welsh River Name: - Alternative Name: -	River Type: Tertiary River Main River Status: Currently Undefined
38	369	SW	River Name: - Welsh River Name: - Alternative Name: -	River Type: Tertiary River Main River Status: Currently Undefined
39E	377	SW	River Name: - Welsh River Name: - Alternative Name: -	River Type: Culvert Main River Status: Currently Undefined
40	395	SE	River Name: Drain Welsh River Name: - Alternative Name: -	River Type: Tertiary River Main River Status: Currently Undefined
41	396	SW	River Name: - Welsh River Name: - Alternative Name: -	River Type: Tertiary River Main River Status: Currently Undefined
42	403	SW	River Name: - Welsh River Name: - Alternative Name: -	River Type: Secondary River Main River Status: Currently Undefined

ID	Distance (m)	Direction	Details	
43	406	E	River Name: - Welsh River Name: - Alternative Name: -	River Type: Tertiary River Main River Status: Currently Undefined
44	410	SW	River Name: - Welsh River Name: - Alternative Name: -	River Type: Culvert Main River Status: Currently Undefined
45E	426	SW	River Name: - Welsh River Name: - Alternative Name: -	River Type: Tertiary River Main River Status: Currently Undefined
46	428	SW	River Name: - Welsh River Name: - Alternative Name: -	River Type: Tertiary River Main River Status: Currently Undefined
47	430	SW	River Name: - Welsh River Name: - Alternative Name: -	River Type: Tertiary River Main River Status: Currently Undefined
48	453	SW	River Name: - Welsh River Name: - Alternative Name: -	River Type: Tertiary River Main River Status: Currently Undefined
49	455	SE	River Name: Drain Welsh River Name: - Alternative Name: -	River Type: Tertiary River Main River Status: Currently Undefined
50	461	E	River Name: - Welsh River Name: - Alternative Name: -	River Type: Tertiary River Main River Status: Currently Undefined
51	481	W	River Name: - Welsh River Name: - Alternative Name: -	River Type: Secondary River Main River Status: Currently Undefined
52	490	SW	River Name: - Welsh River Name: - Alternative Name: -	River Type: Tertiary River Main River Status: Currently Undefined
53	490	SW	River Name: Drain Welsh River Name: - Alternative Name: -	River Type: Tertiary River Main River Status: Currently Undefined
54	492	SE	River Name: Drain Welsh River Name: - Alternative Name: -	River Type: Tertiary River Main River Status: Currently Undefined

## 6.11 Surface Water Features

Are there any surface water features within 250m of the study site?

Yes

The following surface water records are not represented on mapping:

Distance (m)	Direction
17	NW
23	NW
32	NE
58	NE
78	NW
80	NW
100	N
222	SW

# 7a. Environment Agency/Natural Resources Wales Flood Map for Planning (from rivers and the sea)

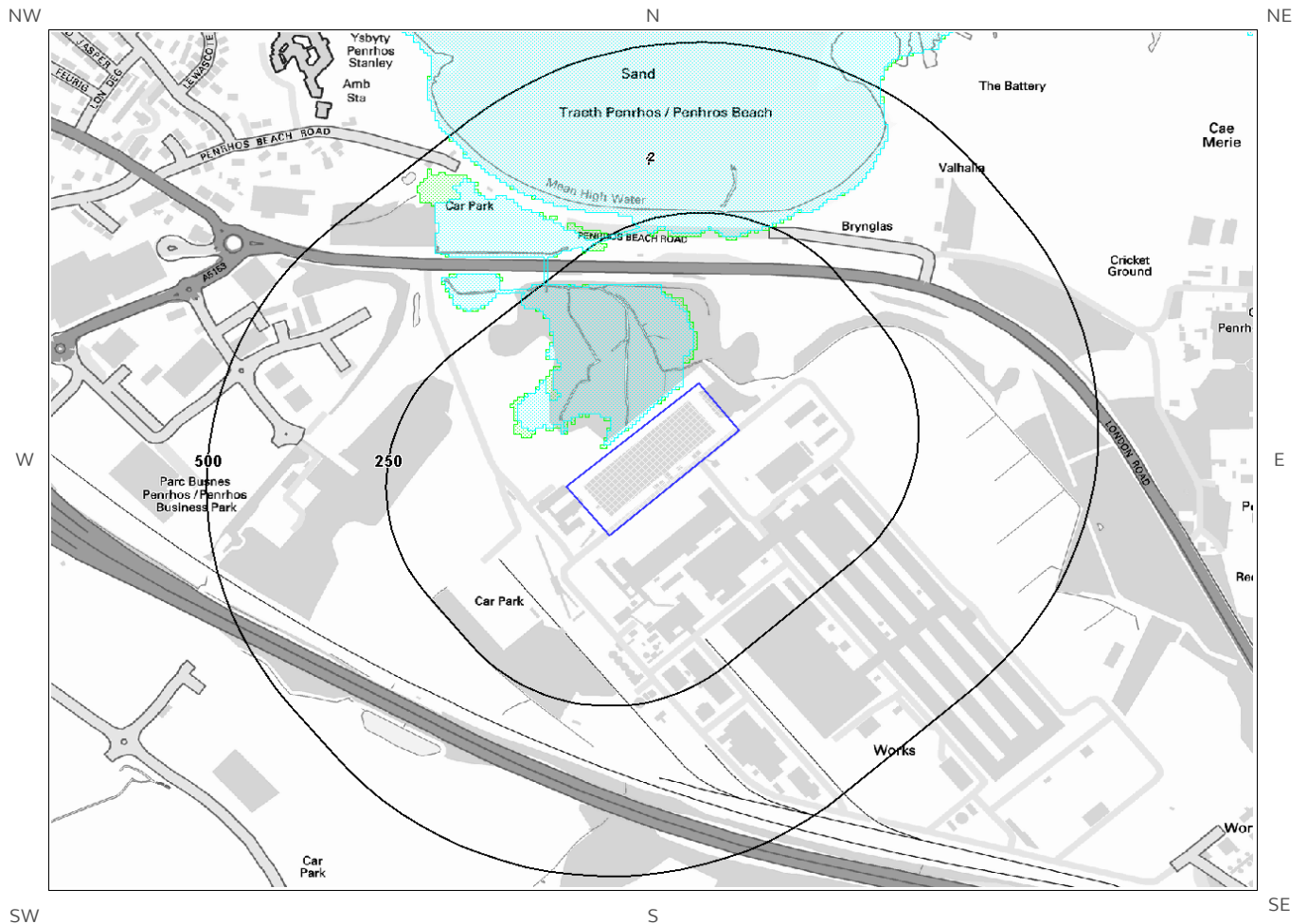

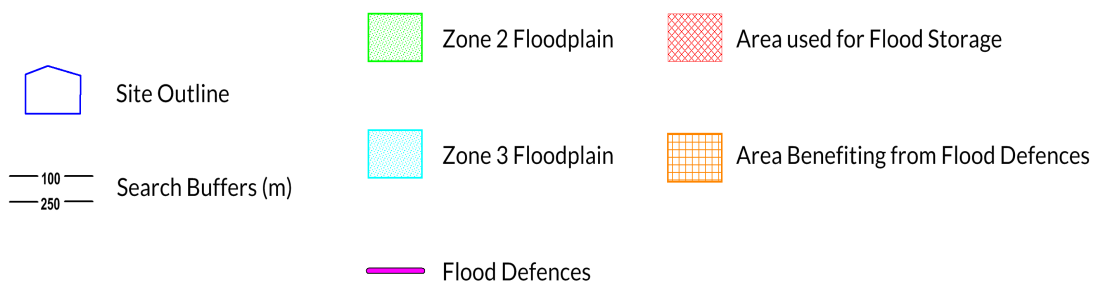

© Crown copyright and database rights 2017.  
Ordnance Survey license 100035207.

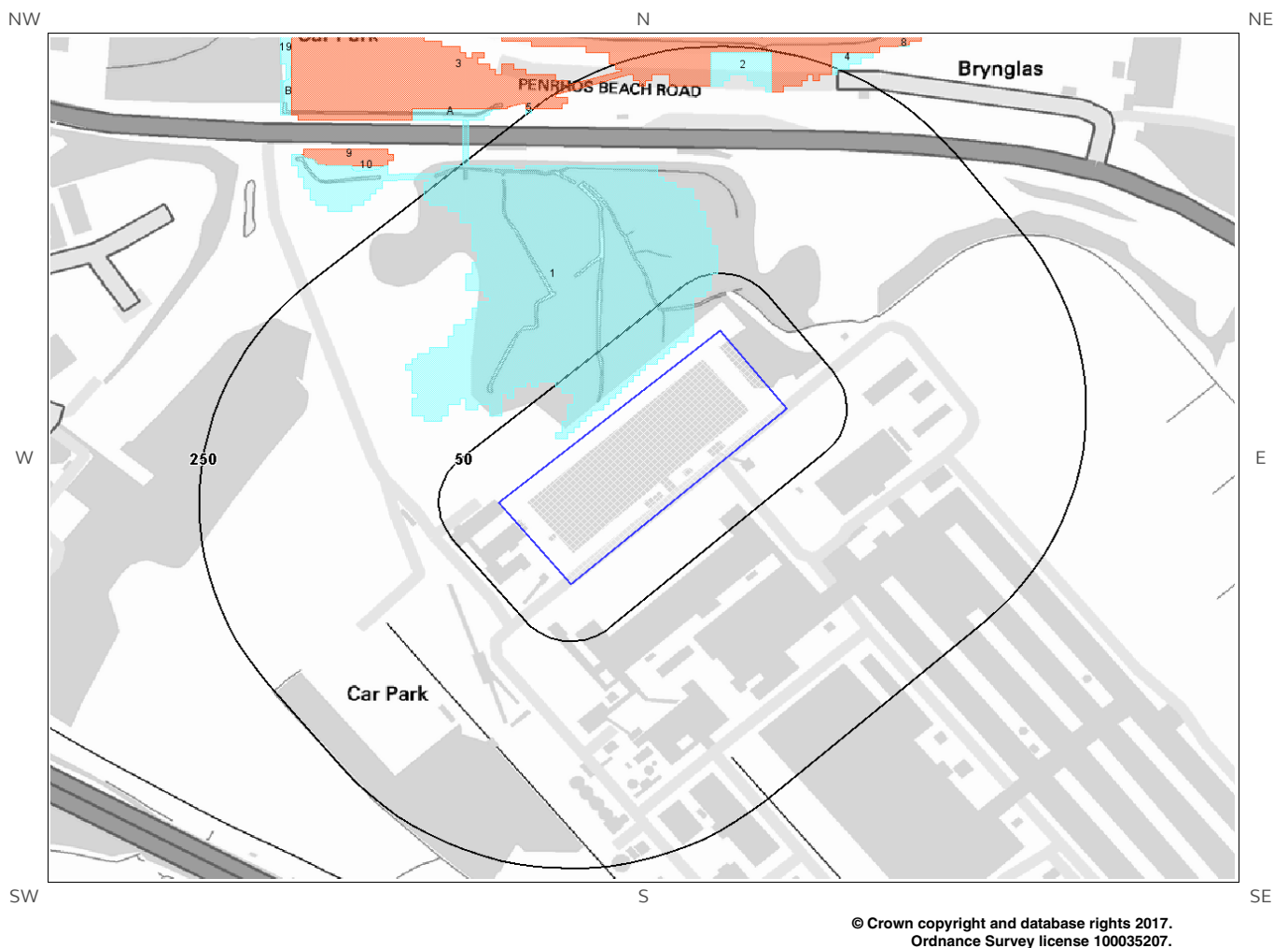

# 7b. Environment Agency/Natural Resources Wales Risk of Flooding from Rivers and the Sea (RoFRaS) Map





 Site Outline

 Search Buffers (m)

RoFRaS Rating

 Very Low

 Low

 Medium

 High



# 7 Flooding

## 7.1 River and Coastal Zone 2 Flooding

Is the site within 250m of an Environment Agency/Natural Resources Wales Zone 2 floodplain? Yes

Environment Agency/Natural Resources Wales Zone 2 floodplains estimate the annual probability of flooding as between 1 in 1000 (0.1%) and 1 in 100 (1%) from rivers and between 1 in 1000 (0.1%) and 1 in 200 (0.5%) from the sea. Any relevant data is represented on Map 7a – Flood Map for Planning:

ID	Distance (m)	Direction	Update	Type
1	8	NW	19-Jun-2017	Zone 2 - (Fluvial /Tidal Models)

## 7.2 River and Coastal Zone 3 Flooding

Is the site within 250m of an Environment Agency/Natural Resources Wales Zone 3 floodplain? Yes

Zone 3 shows the extent of a river flood with a 1 in 100 (1%) or greater chance of occurring in any year or a sea flood with a 1 in 200 (0.5%) or greater chance of occurring in any year. Any relevant data is represented on Map 7a – Flood Map for Planning.

ID	Distance (m)	Direction	Update	Type
1	8	NW	19-Jun-2017	Zone 3 - (Fluvial Models)

## 7.3 Risk of Flooding from Rivers and the Sea (RoFRaS) Flood Rating

What is the highest risk of flooding onsite? Very Low

The Environment Agency/Natural Resources Wales RoFRaS database provides an indication of river and coastal flood risk at a national level on a 50m grid with the flood rating at the centre of the grid calculated and given above. The data considers the probability that the flood defences will overtop or breach by considering their location, type, condition and standard of protection.

RoFRaS data for the study site indicates the property is in an area with a Very Low (less than 1 in 1000) chance of flooding in any given year.

Any relevant data within 250m is represented on the RoFRaS Flood map. Data to 50m is reported in the table below.

ID	Distance (m)	Direction	RoFRaS flood Risk
1	8.0	NW	Low

## 7.4 Flood Defences

Are there any Flood Defences within 250m of the study site? No  
Database searched and no data found.

---

## 7.5 Areas benefiting from Flood Defences

Are there any areas benefiting from Flood Defences within 250m of the study site? No

---

## 7.6 Areas benefiting from Flood Storage

Are there any areas used for Flood Storage within 250m of the study site? No

---

## 7.7 Groundwater Flooding Susceptibility Areas

7.7.1 Are there any British Geological Survey groundwater flooding susceptibility areas within 50m of the boundary of the study site? Yes

Does this relate to Clearwater Flooding or Superficial Deposits Flooding? Superficial Deposits Flooding

Notes: Groundwater flooding may either be associated with shallow unconsolidated sedimentary aquifers which overlie unproductive aquifers (Superficial Deposits Flooding), or with unconfined aquifers (Clearwater Flooding).

---

7.7.2 What is the highest susceptibility to groundwater flooding in the search area based on the underlying geological conditions?

Potential at Surface

Where potential for groundwater flooding to occur at surface is indicated, this means that given the geological conditions in the area groundwater flooding hazard should be considered in all land-use planning decisions. It is recommended that other relevant information e.g. records of previous incidence of groundwater flooding, rainfall, property type, and land drainage information be investigated in order to establish relative, but not absolute, risk of groundwater flooding.

---

## 7.8 Groundwater Flooding Confidence Areas

What is the British Geological Survey confidence rating in this result? Moderate

Notes: Groundwater flooding is defined as the emergence of groundwater at the ground surface or the rising of groundwater into man-made ground under conditions where the normal range of groundwater levels is exceeded.

The confidence rating is on a threefold scale - Low, Moderate and High. This provides a relative indication of the BGS confidence in the accuracy of the susceptibility result for groundwater flooding. This is based on the amount and precision of the information used in the assessment. In areas with a relatively lower level of confidence the susceptibility result should be treated with more caution. In other areas with higher levels of confidence the susceptibility result can be used with more confidence.

# 8. Designated Environmentally Sensitive Sites Map

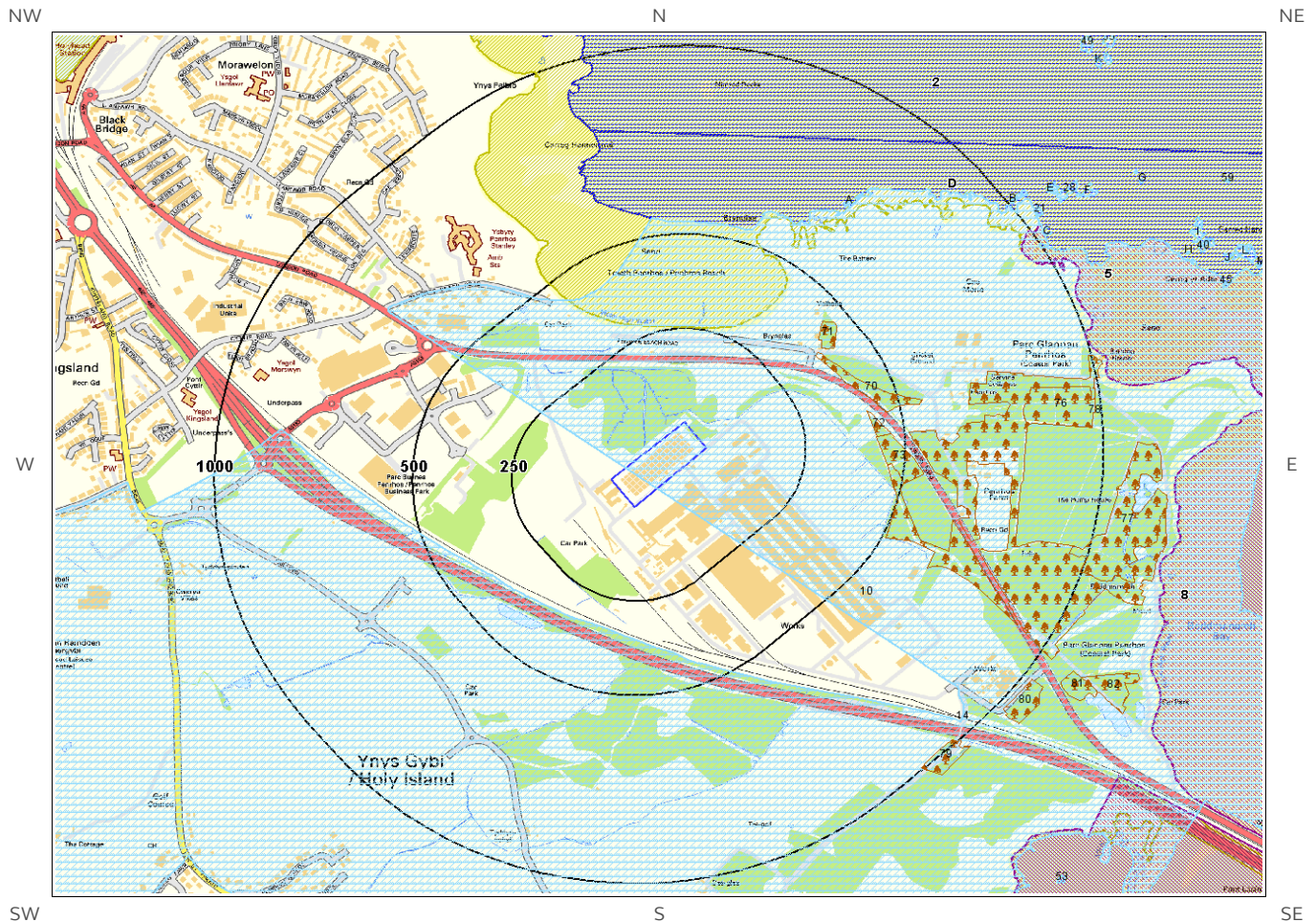

© Crown copyright and database rights 2017.  
Ordnance Survey license 100035207.

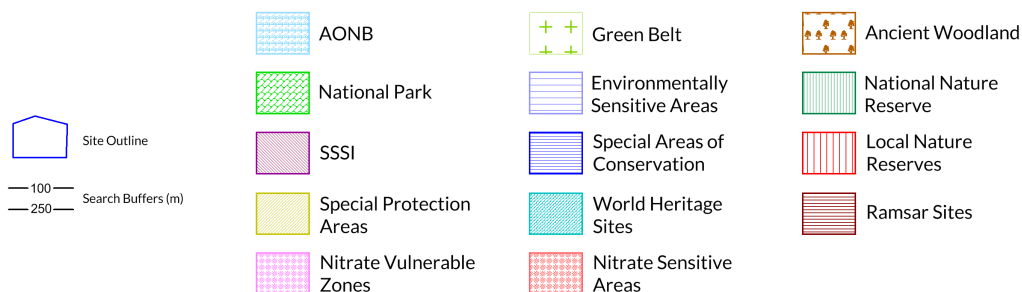

# 8. Designated Environmentally Sensitive Sites

Presence of Designated Environmentally Sensitive Sites within 2000m of the study site? Yes

## 8.1 Records of Sites of Special Scientific Interest (SSSI) within 2000m of the study site:

2

The following Site of Special Scientific Interest (SSSI) records provided by Natural England/Natural Resources Wales are represented as polygons on the Designated Environmentally Sensitive Sites Map:

ID	Distance (m)	Direction	SSSI Name	Data Source
8	952	NE	BEDDMANARCH-CYMYRAN	Natural Resources Wales
Not shown	1225	S	BEDDMANARCH-CYMYRAN	Natural Resources Wales

## 8.2 Records of National Nature Reserves (NNR) within 2000m of the study site:

0

Database searched and no data found.

## 8.3 Records of Special Areas of Conservation (SAC) within 2000m of the study site:

4

The following Special Area of Conservation (SAC) records provided by Natural England/Natural Resources Wales are represented as polygons on the Designated Environmentally Sensitive Sites Map:

ID	Distance (m)	Direction	SAC Name	Data Source
1D	532	N	North Anglesey Marine / Gogledd Môn Forol	Natural Resources Wales
2	767	N	North Anglesey Marine / Gogledd Môn Forol	Natural Resources Wales
Not shown	1699	E	North Anglesey Marine / Gogledd Môn Forol	Natural Resources Wales
Not shown	1857	NE	North Anglesey Marine / Gogledd Môn Forol	Natural Resources Wales

## 8.4 Records of Special Protection Areas (SPA) within 2000m of the study site:

3

The following Special Protection Area (SPA) records provided by Natural England/Natural Resources Wales are represented as polygons on the Designated Environmentally Sensitive Sites Map:

ID	Distance (m)	Direction	SPA Name	Data Source
5	252	N	Anglesey Terns / Morwenoliaid Ynys Môn	Natural Resources Wales
Not shown	1225	S	Anglesey Terns / Morwenoliaid Ynys Môn	Natural Resources Wales
Not shown	1259	SE	Anglesey Terns / Morwenoliaid Ynys Môn	Natural Resources Wales

## 8.5 Records of Ramsar sites within 2000m of the study site:

0

Database searched and no data found.

## 8.6 Records of Ancient Woodland within 2000m of the study site:

13

The following records of Designated Ancient Woodland provided by Natural England/Natural Resources Wales are represented as polygons on the Designated Environmentally Sensitive Sites Map:

ID	Distance (m)	Direction	Ancient Woodland Name	Data Source
70	368	NE	Unknown	Ancient and Semi-Natural Woodland
71	393	NE	Unknown	Ancient and Semi-Natural Woodland
72	417	E	Unknown	Ancient and Semi-Natural Woodland
73	429	E	Unknown	Ancient Replanted Woodland
74	458	E	Unknown	Ancient and Semi-Natural Woodland
75	512	E	Unknown	Ancient and Semi-Natural Woodland
76	803	E	Unknown	Ancient Replanted Woodland
77	954	E	Unknown	Ancient Replanted Woodland
78	978	E	Unknown	Ancient and Semi-Natural Woodland
79	987	SE	Unknown	Restored Ancient Woodland Site
80	1018	SE	Unknown	Ancient Replanted Woodland
81	1087	SE	Unknown	Ancient and Semi-Natural Woodland
82	1120	SE	Unknown	Restored Ancient Woodland Site

## 8.7 Records of Local Nature Reserves (LNR) within 2000m of the study site:

0

Database searched and no data found.

## 8.8 Records of World Heritage Sites within 2000m of the study site:

0

Database searched and no data found.



## 8.9 Records of Environmentally Sensitive Areas within 2000m of the study site:

0

Database searched and no data found.

## 8.10 Records of Areas of Outstanding Natural Beauty (AONB) within 2000m of the study site:

60

The following Area of Outstanding Natural Beauty (AONB) records provided by Natural England/Natural Resources Wales are represented as polygons on the Designated Environmentally Sensitive Sites Map:

ID	Distance (m)	Direction	AONB/NSA Name	Data Source
10	0	On Site	YNYS MON/ANGLESEY	Natural Resources Wales
11A	702	NE	YNYS MON/ANGLESEY	Natural Resources Wales
12A	706	NE	YNYS MON/ANGLESEY	Natural Resources Wales
13A	734	NE	YNYS MON/ANGLESEY	Natural Resources Wales
14	963	SE	YNYS MON/ANGLESEY	Natural Resources Wales
15B	1007	NE	YNYS MON/ANGLESEY	Natural Resources Wales
16B	1019	NE	YNYS MON/ANGLESEY	Natural Resources Wales
17C	1026	NE	YNYS MON/ANGLESEY	Natural Resources Wales
18B	1026	NE	YNYS MON/ANGLESEY	Natural Resources Wales
19C	1032	NE	YNYS MON/ANGLESEY	Natural Resources Wales
20C	1033	NE	YNYS MON/ANGLESEY	Natural Resources Wales
21	1040	NE	YNYS MON/ANGLESEY	Natural Resources Wales
22D	1040	NE	YNYS MON/ANGLESEY	Natural Resources Wales
Not shown	1081	S	YNYS MON/ANGLESEY	Natural Resources Wales
24E	1098	NE	YNYS MON/ANGLESEY	Natural Resources Wales
25E	1101	NE	YNYS MON/ANGLESEY	Natural Resources Wales
26E	1101	NE	YNYS MON/ANGLESEY	Natural Resources Wales
27E	1103	NE	YNYS MON/ANGLESEY	Natural Resources Wales
28	1107	NE	YNYS MON/ANGLESEY	Natural Resources Wales
29E	1107	NE	YNYS MON/ANGLESEY	Natural Resources Wales
30E	1109	NE	YNYS MON/ANGLESEY	Natural Resources Wales
31F	1147	NE	YNYS MON/ANGLESEY	Natural Resources Wales
32F	1191	NE	YNYS MON/ANGLESEY	Natural Resources Wales
33G	1300	NE	YNYS MON/ANGLESEY	Natural Resources Wales
34G	1304	NE	YNYS MON/ANGLESEY	Natural Resources Wales
35H	1316	NE	YNYS MON/ANGLESEY	Natural Resources Wales
36H	1342	NE	YNYS MON/ANGLESEY	Natural Resources Wales
37H	1347	NE	YNYS MON/ANGLESEY	Natural Resources Wales
38I	1347	NE	YNYS MON/ANGLESEY	Natural Resources Wales
39H	1348	NE	YNYS MON/ANGLESEY	Natural Resources Wales



ID	Distance (m)	Direction	AONB/NSA Name	Data Source
40	1350	NE	YNYS MON/ANGLESEY	Natural Resources Wales
41I	1362	NE	YNYS MON/ANGLESEY	Natural Resources Wales
42I	1362	NE	YNYS MON/ANGLESEY	Natural Resources Wales
43I	1371	NE	YNYS MON/ANGLESEY	Natural Resources Wales
44I	1375	NE	YNYS MON/ANGLESEY	Natural Resources Wales
45	1376	E	YNYS MON/ANGLESEY	Natural Resources Wales
46J	1398	E	YNYS MON/ANGLESEY	Natural Resources Wales
47J	1400	E	YNYS MON/ANGLESEY	Natural Resources Wales
48K	1404	NE	YNYS MON/ANGLESEY	Natural Resources Wales
49	1405	NE	YNYS MON/ANGLESEY	Natural Resources Wales
Not shown	1406	SW	YNYS MON/ANGLESEY	Natural Resources Wales
51L	1411	E	YNYS MON/ANGLESEY	Natural Resources Wales
52K	1427	NE	YNYS MON/ANGLESEY	Natural Resources Wales
53	1441	SE	YNYS MON/ANGLESEY	Natural Resources Wales
Not shown	1453	NE	YNYS MON/ANGLESEY	Natural Resources Wales
55	1457	NE	YNYS MON/ANGLESEY	Natural Resources Wales
56L	1461	E	YNYS MON/ANGLESEY	Natural Resources Wales
57M	1467	E	YNYS MON/ANGLESEY	Natural Resources Wales
58M	1469	E	YNYS MON/ANGLESEY	Natural Resources Wales
59	1483	NE	YNYS MON/ANGLESEY	Natural Resources Wales
Not shown	1486	NE	YNYS MON/ANGLESEY	Natural Resources Wales
Not shown	1488	E	YNYS MON/ANGLESEY	Natural Resources Wales
Not shown	1517	E	YNYS MON/ANGLESEY	Natural Resources Wales
Not shown	1526	NE	YNYS MON/ANGLESEY	Natural Resources Wales
Not shown	1550	E	YNYS MON/ANGLESEY	Natural Resources Wales
Not shown	1557	E	YNYS MON/ANGLESEY	Natural Resources Wales
Not shown	1604	SE	YNYS MON/ANGLESEY	Natural Resources Wales
Not shown	1671	SE	YNYS MON/ANGLESEY	Natural Resources Wales
Not shown	1683	SW	YNYS MON/ANGLESEY	Natural Resources Wales
Not shown	1712	E	YNYS MON/ANGLESEY	Natural Resources Wales

#### 8.11 Records of National Parks (NP) within 2000m of the study site:

0

Database searched and no data found.

---

#### 8.12 Records of Nitrate Sensitive Areas within 2000m of the study site:

0

Database searched and no data found.

---

#### 8.13 Records of Nitrate Vulnerable Zones within 2000m of the study site:

0

Database searched and no data found.

---

#### 8.14 Records of Green Belt land within 2000m of the study site:

0

Database searched and no data found.

---

# 9. Natural Hazards Findings

## 9.1 Detailed BGS GeoSure Data

BGS GeoSure Data has been searched to 50m. The data is included in tabular format. If you require further information on geology and ground stability, please obtain a **Groundsure Geo Insight**, available from our **website**. The following information has been found:

### 9.1.1 Shrink Swell

What is the maximum Shrink-Swell\* hazard rating identified on the study site? Low

The following natural subsidence information provided by the British Geological Survey is not represented on mapping:

Hazard
Ground conditions predominantly medium plasticity. Do not plant trees with high soil moisture demands near to buildings. For new build, consideration should be given to advice published by the National House Building Council (NHBC) and the Building Research Establishment (BRE). There is a possible increase in construction cost to reduce potential shrink-swell problems. For existing property, there is a possible increase in insurance risk, especially during droughts or where vegetation with high moisture demands is present.

### 9.1.2 Landslides

What is the maximum Landslide\* hazard rating identified on the study site? Very Low

The following natural subsidence information provided by the British Geological Survey is not represented on mapping:

Hazard
Slope instability problems are unlikely to be present. No special actions required to avoid problems due to landslides. No special ground investigation required, and increased construction costs or increased financial risks are unlikely due to potential problems with landslides.

### 9.1.3 Soluble Rocks

What is the maximum Soluble Rocks\* hazard rating identified on the study site? Negligible

The following natural subsidence information provided by the British Geological Survey is not represented on mapping:

Hazard
Soluble rocks are present, but unlikely to cause problems except under exceptional conditions. No special actions required to avoid problems due to soluble rocks. No special ground investigation required, and increased construction costs or increased financial risks are unlikely due to potential problems with soluble rocks.

\* This indicates an automatically generated 50m buffer and site.

#### 9.1.4 Compressible Ground

What is the maximum Compressible Ground\* hazard rating identified on the study site? Moderate

The following natural subsidence information provided by the British Geological Survey is not represented on mapping:

Hazard
Significant potential for compressibility problems. Avoid large differential loadings of ground. Do not drain or de-water ground near the property without technical advice. For new build consider possibility of compressible ground in ground investigation, construction and building design. Consider effects of groundwater changes. Extra construction costs are likely. For existing property possible increase in insurance risk from compressibility, especially if water conditions or loading of the ground change significantly.

#### 9.1.5 Collapsible Rocks

What is the maximum Collapsible Rocks\* hazard rating identified on the study site? Very Low

The following natural subsidence information provided by the British Geological Survey is not represented on mapping:

Hazard
Deposits with potential to collapse when loaded and saturated are unlikely to be present. No special ground investigation required or increased construction costs or increased financial risk due to potential problems with collapsible deposits.

#### 9.1.6 Running Sand

What is the maximum Running Sand\*\* hazard rating identified on the study site? Moderate

The following natural subsidence information provided by the British Geological Survey is not represented on mapping:

Hazard
Significant potential for running sand problems with relatively small changes in ground conditions. Avoid large amounts of water entering the ground (for example through pipe leakage or soak-aways). Do not dig (deep) holes into saturated ground near the property without technical advice. For new build consider the consequences of soil and groundwater conditions during and after construction. For existing property possible increase in insurance risk from running sand, for example, due to water leakage, high rainfall events or flooding.

### 9.2 Radon

#### 9.2.1 Radon Affected Areas

Is the property in a Radon Affected Area as defined by the Health Protection Agency (HPA) and if so what percentage of homes are above the Action Level? The property is not in a Radon Affected Area, as less than 1% of properties are above the Action Level.

\* This indicates an automatically generated 50m buffer and site.

### 9.2.2 Radon Protection

Is the property in an area where Radon Protection are required for new properties or extensions to existing

ones as described in publication BR211 by the Building Research Establishment?

No radon protective measures are necessary.

# 10. Mining

## 10.1 Coal Mining

Are there any coal mining areas within 75m of the study site? No

Database searched and no data found.

## 10.2 Non-Coal Mining

Are there any Non-Coal Mining areas within 50m of the study site boundary? Yes

The following non-coal mining information is provided by the BGS:

Distance (m)	Direction	Name	Commodity	Assessment of likelihood
0.0	On Site	Not available	Vein Mineral	Sporadic underground mining of restricted extent may have occurred. Potential for difficult ground conditions are unlikely and localised and are at a level where they need not be considered

Past underground mine workings are uncommon, localised and of limited area. The rock types present in this area are such that minor mineral veins may be present within them on which it is possible that there have been attempts to work these by underground methods and/or it is possible that small scale underground extraction of other materials may have occurred. All such occurrences are likely to be restricted in size and infrequent. It should be noted, however, that there is always the possibility of the existence of other sub-surface excavations, such as wells, cess pits, follies, air raid shelters/bunkers and other military structures etc. that could affect surface ground stability but which are outside the scope of this dataset. However, if in a coalfield area you should still consider a Coal Authority mining search for the area of interest.

## 10.3 Brine Affected Areas

Are there any brine affected areas within 75m of the study site? No

Guidance: No Guidance Required.

# Contact Details

**Groundsure Helpline**  
Telephone: 08444 159 000  
info@groundsure.com

**British Geological Survey Enquiries**

Kingsley Dunham Centre  
Keyworth, Nottingham NG12 5GG  
Tel: 0115 936 3143.  
Fax: 0115 936 3276.  
Email:

Web: [www.bgs.ac.uk](http://www.bgs.ac.uk)

BGS Geological Hazards Reports and general geological enquiries:  
[enquiries@bgs.ac.uk](mailto:enquiries@bgs.ac.uk)

**Natural Resources Wales**

Ty Cambria  
29 Newport Road  
Cardiff  
CF24 0TP  
Tel: 0300 065 3000  
Email: [enquiries@naturalresourceswales.gov.uk](mailto:enquiries@naturalresourceswales.gov.uk)

**Public Health England**

Public information access office  
Public Health England, Wellington House  
133-155 Waterloo Road, London, SE1 8UG  
[www.gov.uk/phe](http://www.gov.uk/phe)  
Email: [enquiries@phe.gov.uk](mailto:enquiries@phe.gov.uk)  
Main switchboard: 020 7654 8000

**The Coal Authority**

200 Lichfield Lane  
Mansfield  
Notts NG18 4RG  
Tel: 0345 7626 848  
DX 716176 Mansfield 5  
[www.coal.gov.uk](http://www.coal.gov.uk)

**Ordnance Survey**

Adanac Drive, Southampton  
SO16 0AS  
Tel: 08456 050505

**Local Authority**

Authority: Sir Ynys Mon - Isle of Anglesey County Council  
Phone: 01248 750 057  
Web: <http://www.anglesey.gov.uk>  
Address: Council Offices, Llangefni, Anglesey, LL77 7TW





**Gemapping PLC**  
Virginia Villas, High Street, Hartley Witney,  
Hampshire RG27 8NW  
Tel: 01252 845444



Acknowledgements: Site of Special Scientific Interest, National Nature Reserve, Ramsar Site, Special Protection Area, Special Area of Conservation data is provided by, and used with the permission of, Natural England who retain the Copyright and Intellectual Property Rights for the data.

PointX © Database Right/Copyright, Thomson Directories Limited © Copyright Link Interchange Network Limited © Database Right/Copyright and Ordnance Survey © Crown Copyright and/or Database Right. All Rights Reserved. Licence Number [03421028].

This report has been prepared in accordance with the Groundsure Ltd standard Terms and Conditions of business for work of this nature.

# Standard Terms and Conditions

Groundsure's Terms and Conditions can be viewed online at this link:  
<https://www.groundsure.com/terms-and-conditions-sept-2016>