

SURRENDER REPORT FOR EPR/UP3094FQ

BRYN Y GAER QUARRY, HOPE, FLINTSHIRE LL12 9SD

ASH WASTE SERVICES LTD

VERSION:	1.0	DATE:	12 FEBRUARY 2016		
DOC. REF:	2370-426-SR	AUTHOR:	JE	CHECKED:	
CLIENT NO:	426	JOB NO:	2370		



Oaktree Environmental Ltd

Waste, Planning & Environmental Consultants



Oaktree Environmental Ltd, Unit 5, Oasis Park, 19 Road One, Winsford, Cheshire, CW7 3RY
Tel: 01606 558833 | Fax: 01606 861183 | E-Mail: sales@oaktreeenvironmental.co.uk | Web: www.oaktree-environmental.co.uk
REGISTERED IN THE UK | COMPANY NO. 4850754

Document History:

<i>Version</i>	<i>Issue date</i>	<i>Author</i>	<i>Checked</i>	<i>Description</i>
1.0	12/02/2016	JE		Submission to NRW

CONTENTS

DOCUMENT HISTORY:	I
CONTENTS	II
LIST OF APPENDICES:	III
1 GENERAL CONSIDERATIONS	1
1.1 SITE OPERATOR/PERMIT HOLDER	1
1.2 SITE LOCATION & HISTORY	2
1.3 PERMIT AREA / WASTE MANAGEMENT OPERATIONS	3
1.4 SURRENDER REASON & TYPE	4
2 MEASURES TAKEN TO PROTECT THE LAND	5
2.1 UNDERSTANDING THE SITE	5
2.2 PERMITTED WASTE TYPES	5
2.3 WASTE ACCEPTANCE CRITERIA	6
2.4 LANDFILL GAS MONITORING AND REPORTING WITH THE WASTE	6
2.5 SURFACE WATER	7
3 POLLUTION INCIDENTS	8
3.1 CAR FORMS	8
3.2 SITE CONDITION REPORT	8
4 DECOMMISSIONING AND REMOVAL OF POLLUTION RISK	9
4.1 OIL/FUEL STORAGE	9
4.2 WASTE	9
4.3 FINAL RESTORATION – SEEDING AND PLANTING OF VEGETATION	9
5 STATEMENT OF SITE CONDITION	10
5.1 GENERAL	10

List of Appendices:

Appendix I - Drawings

Drawing No. ASH/101 - Permit Boundary Plan

Drawing No. ASH/BHL/BYG01 – Borehole Locations

Drawing No. 2370/426/11 – Proposed Landscaping Scheme

Drawing No. 2370-426-04(B). – Agreed Landscaping Proposal

Appendix II - Waste transfer notes and Waste Returns data summary

Appendix III - Site Diary Entries

Appendix IV - CAR forms

Appendix V - Gas monitoring data

1 GENERAL CONSIDERATIONS

1.1 Site Operator/Permit Holder

1.1.1 ASH WASTE SERVICES LTD are seeking to surrender EPR/UP3094FQ which is an A25 Environmental Permit (EP) ie deposit of waste for a recovery activity. A waste licence was issued in 1993 for the restoration of a disused quarry (Bryn y Gaer Quarry) to restore back to agricultural land. The permit which was transferred to the current permit holder in 2005 became an Environmental Permit (EP) in 1996. Tipping did not commence until after the permit was transferred.

1.1.2 The contact details for ASH WASTE SERVICES LTD are as follows:

ASH WASTE SERVICES LTD	Contact:	Zoe Hassall
Broughton Mills Road	Position:	Director
Bretton		
Flintshire		
CH4 0BY		

1.1.3 Oaktree Environmental Ltd have been engaged as consultants for ASH WASTE SERVICES LTD for many years and have been requested to assist in the preparation of this application to surrender EPR/UP3094FQ. Contact details for Oaktree Environmental Ltd are as follows:

Oaktree Environmental Ltd	Contact:	Jan Edwards
Unit 5, Oasis Park	Position:	Senior Consultant
19 Road One	Tel:	01606 558833
Winsford Industrial Estate	Fax:	01606 861182
Winsford	E-mail:	jan@oaktree-environmental.co.uk
Cheshire CW7 3RY		

1.2 Site Location & History

- 1.2.1 The site is located at BRYN Y GAER QUARRY, HOPE, FLINTSHIRE LL12 9SD, as shown on Drawing No. ASH/101. The national grid reference (NGR) for the site is SJ 31613 57708.
- 1.2.2 Quarrying at the site ceased in the 1980s and planning permission for infilling with inert wastes was issued by Alyn & Deeside District Council to Caird Environmental Ltd in December 1993. In 1997 an application was made to the local planning authority to continue infilling the quarry with inert wastes as the previous permission had expired. This was granted subject to a section 106 legal agreement. In 2002 Shanks Waste Solutions were the new owners of the site. A further planning permission was issued in April 2003.
- 1.2.3 In November 2003 ASH Waste Services Ltd purchased the site.
- 1.2.4 As detailed above the EP was issued on 21/01/1993 as a Waste Management Licence and transferred to ASH Waste Services Ltd on 25/01/2005. The infilling operation was confirmed as a 'recovery' activity and therefore a waste management activity due to the existence of the permit and Regulation 4(b) exclusion of the activities described in the 2002 Regulations. There was a modification issued on 13/09/2005 confirming the restoration scheme to be carried out under the 2003 Planning permission was to be regarded as a 'recovery' operation.
- 1.2.5 The objective of the restoration of the quarry was to stabilise the quarry walls to prevent rock fall and to complete a landform for country park after use. The 'infilling' was deemed to be 'landscaping' – restoring the quarry to an acceptable landform and improve the after use to which the site can be put.
- 1.2.6 The EP was varied on 11/3/2014 as an Administrative variation to update conditions 1.2, Table 1.7 and 2.1.1 to reflect changes to the planning permission and to update the permit holder's name and registered office address as held on Companies House and to update the facility name. Condition 1.2 updated the Planning Reference number. Table 1.7 updated the Drawing numbers. Condition

2.2.1 referenced the revised Final Contour Drawing which showed the proposed finished levels enabling the area to be used for Country Park activities.

- 1.2.7 Please see the Site Condition Report for the site (Doc. Ref. 3000-426-SCR) for a full consideration of the site's environmental setting, pollution history and historic land use.

1.3 Permit Area / Waste Management Operations

- 1.3.1 The area which is the subject of this Surrender Application is outlined in RED on Drawing No. ASH/101. All references to 'the site' in this report refer to this area and the associated infrastructure, plant and equipment.
- 1.3.2 The permit for the site (EPR/UP3094FQ) allowed for <60,000 tonnes of inert and non hazardous soil, stone and excavated material to be accepted per annum. A limited amount of inert hardcore was permitted to make up site access and site tracks. Planning was granted initially for a maximum of 80,000 cubic metres, which was increased by a further 13,000 cubic metres for the final restoration phase in the revised planning permission 051224 issued on 17th February 2014.
- 1.3.3 Wastes accepted onto site were solid, dry, non hazardous waste. The majority of the waste derived from local construction and demolition jobs and was delivered predominantly in 20 tonne load fixed body tipper vehicles. The permit was licensed to accept a selection of wastes from household, commercial and industrial sources but the waste accepted was restricted to EWC 17 01 07 (mixture of concrete, bricks, tiles and ceramics) for site haul road (17 05 04 (soil and stone), 19 12 09 (minerals- eg sands, stones), 20 02 02 (soils and stones) and 01 04 09 (waste sand and clays). Refer to Appendix II for details of material accepted on site). All waste was subjected to the strict waste acceptance procedure detailed in the site's Environmental Management System.
- 1.3.4 Technically competent staff were in place to oversee site operations.

1.3.5 Fencing and gates prevented unauthorised access. The site is served by a main entrance gate which was locked when the site was unmanned.

1.3.6 No fuel was stored on site.

1.4 Surrender Reason & Type

1.4.1 The restoration scheme has now been completed to the final landform for the site as detailed in Drawing No. sa3653 (Site Location Plan) and Drawing 2370/426/02 proposed Finished Levels. Seeding has been completed and landscaping (planting to be in accordance with the recommendations of British Standard BS4428 1989) and aftercare scheme have been discussed and agreed with the local planning authority with a view to the site being used for country park activities eg dog walking and including car parking area.

1.4.2 Electronic communication with the site's Environment Officer (EO) from Natural Resources Wales, confirmed the site may qualify for low risk surrender. This is due to the CAR Forms not showing any significant breaches which could have led to the site being contaminated and resulting in a pollution incident, and the fact that the relevant criteria in RGN 9 (Surrender guidance) can be met.

1.4.3 Based on the above, it has been concluded that there is no requirement for intrinsic ground investigations (i.e. boreholes, groundsure report), as the level of contamination will be low or negligible. The operator has cleared all existing plant and machinery including the shaker bar wheel wash and the site has been fully restored to the levels agreed by the local planning authority. The site has landscaping and aftercare scheme in place which is being overseen by the local planning officer.

2 MEASURES TAKEN TO PROTECT THE LAND

2.1 Understanding the Site

2.2 Permitted Waste Types

2.2.1 Waste types accepted at the site were restricted to only wastes as listed in Table 1 of the Environmental Permitting Regulations - guidance inert waste and in of RF13 (Defining Waste Recovery) Appendix 2. Therefore the likelihood of any contamination being present is considered as being extremely low. This is supported by the Site Inspection Reports and Compliance Assessment Reports completed by both Environment Agency Wales and Natural Resources Wales between 1996 and 2015. These reports are the records used in the Site Condition Report to assess the effectiveness of pollution prevention measures on site. As the site has been regularly inspected by the relevant regulatory bodies since 1993 there have been numerous inspection sheets completed and which will be held on file by NRW. During the lifetime of the permit, any instances of non-compliance would be identified on Compliance Assessment Report (CAR). According to the current operator's records of the CAR forms the only non-compliance instances on site were recorded for the 8th April 2014. The non compliances are summarised below.

- a) *General Management:* Staff competency/training- **lack of permit on site. Copy is kept in head office**
- b) *General Management:* Management system & operating procedures-**not complying with EMS control measures. This was rectified by the next day and which follow up inspection by NRW confirmed.**
- c) *Incident management:* site security: **Identification board not visible. The notice board was reinstalled on 15th April 2014.**
- d) *Amenity:* Deposits of mud on road: **Mud was being tracked onto the public highway**
- e) *Monitoring and records, maintenance and reporting:* records of activity, site diary, journal and events: **Site diary not held on site. Kept in Head Office**

As can be seen from the above, the breaches were not related to the deposit of waste as on the recovery activity and therefore should not have any influence on the surrender application.

2.2.2 A copy of the non compliance records have been included in Appendix IV.

2.3 Waste Acceptance Criteria

2.3.1 Pre-acceptance requirements and testing – There was a tiered system in place, with a basic screen test which identified if there was any need for any further testing. Usually the producer of the waste had testing procedures in place which instructed their analytic laboratories to carry out the necessary tests and the results would be forwarded to ASH Waste as part of their pre-acceptance procedure. If there was suspicion of any contamination of the waste, the producer would be instructed to carry out further testing. If the operator was confident that the waste was not contaminated then testing was not required. Only waste which meet the pre-acceptance criteria was accepted into Bryn y Gaer Quarry.

2.3.2 Visual tests were carried out by relevantly qualified persons on all loads accepted onto the Bryn y Gaer site.

2.3.3 Waste characterisation - the producer of the waste had the responsibility for characterising the waste and this information was used by ASH Waste Ltd to ascertain the suitability of the waste for Bryn y Gaer. Each individual waste stream would be characterised and tested as part of the waste characterisation.

2.4 Landfill gas monitoring and reporting with the waste

2.4.1 There was a requirement in the permit for monitoring and sampling of landfill gas to be undertaken in at least 4 locations. Monitoring boreholes for the monitoring of landfill gas were installed around the perimeter of the site within the body of the waste mass. Locations of the original boreholes can be seen on Drawing ASH/BHL/BYG01. (Copy attached in Appendix I). Each borehole consisted of minimum 150mm diameter containing a ridged HDPE casting of minimum internal diameter of 50mm. The annulus of the borehole being packed with non-calcareous

pea gravel and the surface of the borehole was fitted with a gas tight seal. The boreholes were designed for gas sampling and the headworks were protected from damage.

2.4.2 The boreholes were monitored by suitably competent/qualified persons for Methane, Carbon dioxide and Atmospheric pressure twice a year and the results were submitted to Environment Agency Wales/ Natural Resources Wales. Monitoring commenced in 1993.

2.4.3 A landfill gas generation action plan was never required as the gas results were not regarded as having exceeded the trigger levels of Methane 1% by volume nor Carbon dioxide 1.5% by volume.

2.4.4 Gas results for Bryn y Gaer Quarry have been submitted to the relevant authorities included the Local Planning Authority, Environment Agency Wales and Natural Resources Wales throughout the life of the site. Results from 2011 to 2015 have been included in Appendix V. Earlier data has been archived. All results indicate that there was no generation of gas.

2.5 Surface water

2.5.1 During the operational phase infill material was placed and compacted into layers to form gradients no steeper than 1 in 3, each layer placed to a fall to encourage surface water run-off. Operational soakaways constructed as filling progressed to encourage surface water to soak away. The site access road was constructed to shed water to the sides of the road which was intercepted and diverted to soakaways at the side of the road.

2.5.2 Post restoration phase - the management of surface water will be achieved by providing the agreed landform ie final contours, emplacement of free draining soils in the restored surface and vegetation growth and tree planting on the final levels.

3 POLLUTION INCIDENTS

3.1 CAR Forms

- 3.1.1 According to the current operator's records of the CAR forms the only non-compliance instances on site were recorded for the 8th April 2014. As indicated in 2.2.1, the CAR forms confirm that, the site does not have a history of any pollution incidents.

3.2 Site Condition Report

- 3.2.1 A Site Condition Report accompanies this application (Doc. Ref. 2370/426/SCR) and reference is made to the site's history as a disused quarry. As no qualitative assessments were carried out prior to the site being issued with planning and a waste licence, it is unknown whether the site had history of any pollution incidents before the current use. It is important to note that there have been no pollution incidents resulting from the permitted restoration operation.

4 DECOMMISSIONING AND REMOVAL OF POLLUTION RISK

4.1 Oil/Fuel Storage

- 4.1.1 No fuel has been stored on site. The operator has confirmed that there has been no spillages of oil/fuel during the life of the site.

4.2 Waste

- 4.2.1 The only potential risk would be rejected waste and this would be contained in clearly labelled skip or other container for the deposit of rejected waste which cannot be removed from the site immediately. However due to the strict pre-waste acceptance procedure carried out on all the loads accepted and therefore deposited on site, only wastes allowed under the permit have been used in the restoration of Bryn y Gaer Quarry.

4.3 Final Restoration – seeding and planting of vegetation

- 4.3.1 The seeding and landscaping scheme has been submitted and agreed with the local Planning Authority. Details are shown on Drawing No. 2370-426-04(B).

5 STATEMENT OF SITE CONDITION



5.1 General

- 5.1.1 For an EP surrender application to be successful, the operator must demonstrate that the site is not likely to cause pollution of the environment or harm to human health. The non-compliance as detailed in Section 2.2.1 above were not associated with the actual deposit of waste and no pollution incidents according to our records were recorded during the lifetime of the permit and therefore the land is deemed to be in satisfactory condition.
- 5.1.2 The site records, for example the site dairy, transfer notes, completed CAR forms, gas monitoring results associated with the recovery activity at Bryn y Gaer Quarry, all of which have been shared with the various regulators, show that the site did not cause pollution of the environment or harm to human health.

Appendix I

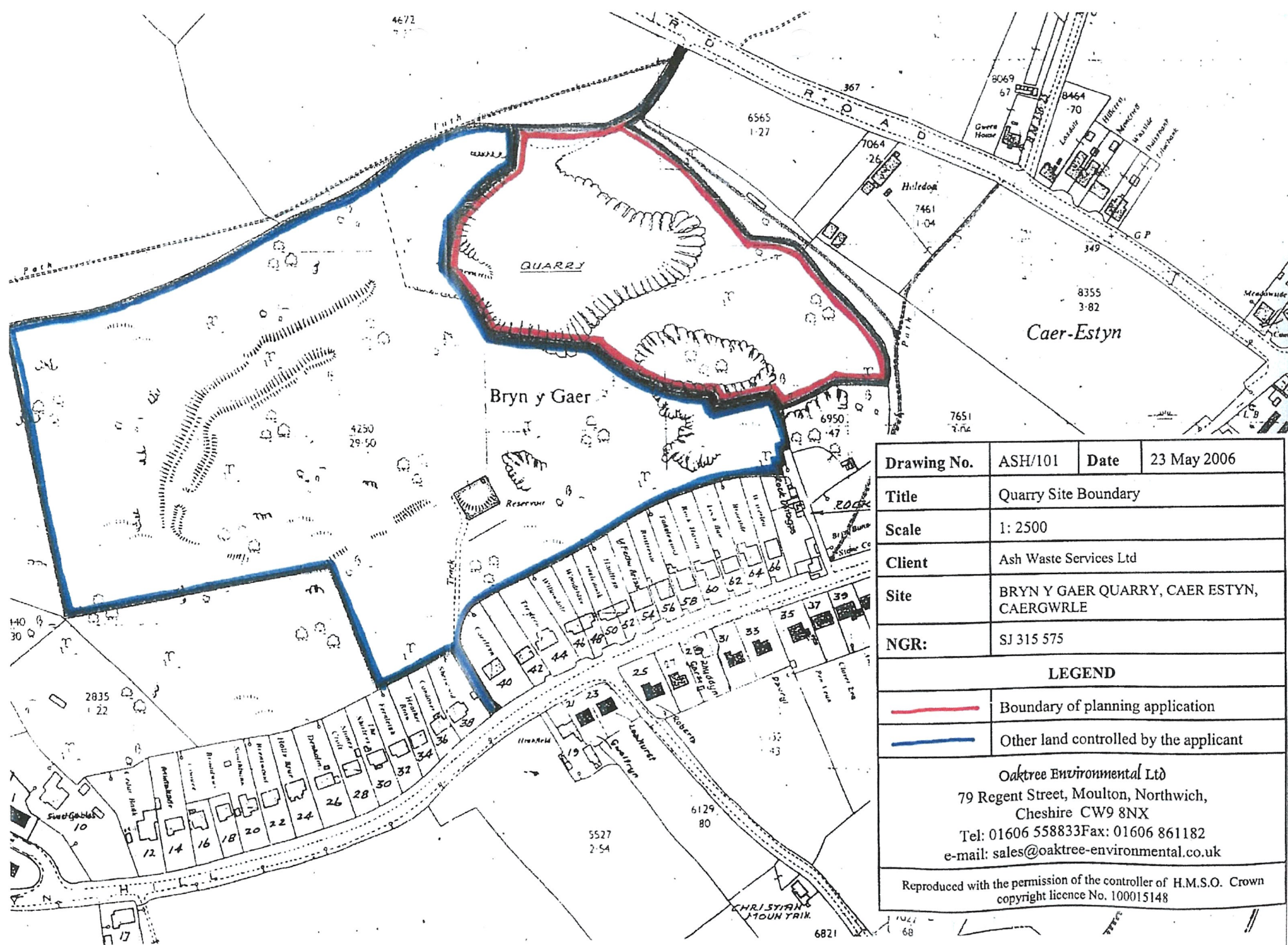
Drawings



Drawing No.	ASH/101	Date	23 May 2006
Title	Quarry Site Boundary		
Scale	1: 2500		
Client	Ash Waste Services Ltd		
Site	BRYN Y GAER QUARRY, CAER ESTYN, CAERGWRLE		
NGR:	SJ 315 575		
LEGEND			
	Boundary of planning application		
	Other land controlled by the applicant		
<p><i>Oaktree Environmental Ltd</i> 79 Regent Street, Moulton, Northwich, Cheshire CW9 8NX Tel: 01606 558833 Fax: 01606 861182 e-mail: sales@oaktree-environmental.co.uk</p>			
Reproduced with the permission of the controller of H.M.S.O. Crown copyright licence No. 100015148			

AS. Resource Managment Limited Bryn-y-Gaer Quarry, Gresford Road, Hope, Flintshire.

Client	ASH Waste Services Ltd
Drawing	Bryn-y-Gaer Quarry, Hope Location
Reference	ASH/BHLOC/BYG01
Scale	1 : 1250
Date	29 April 2008

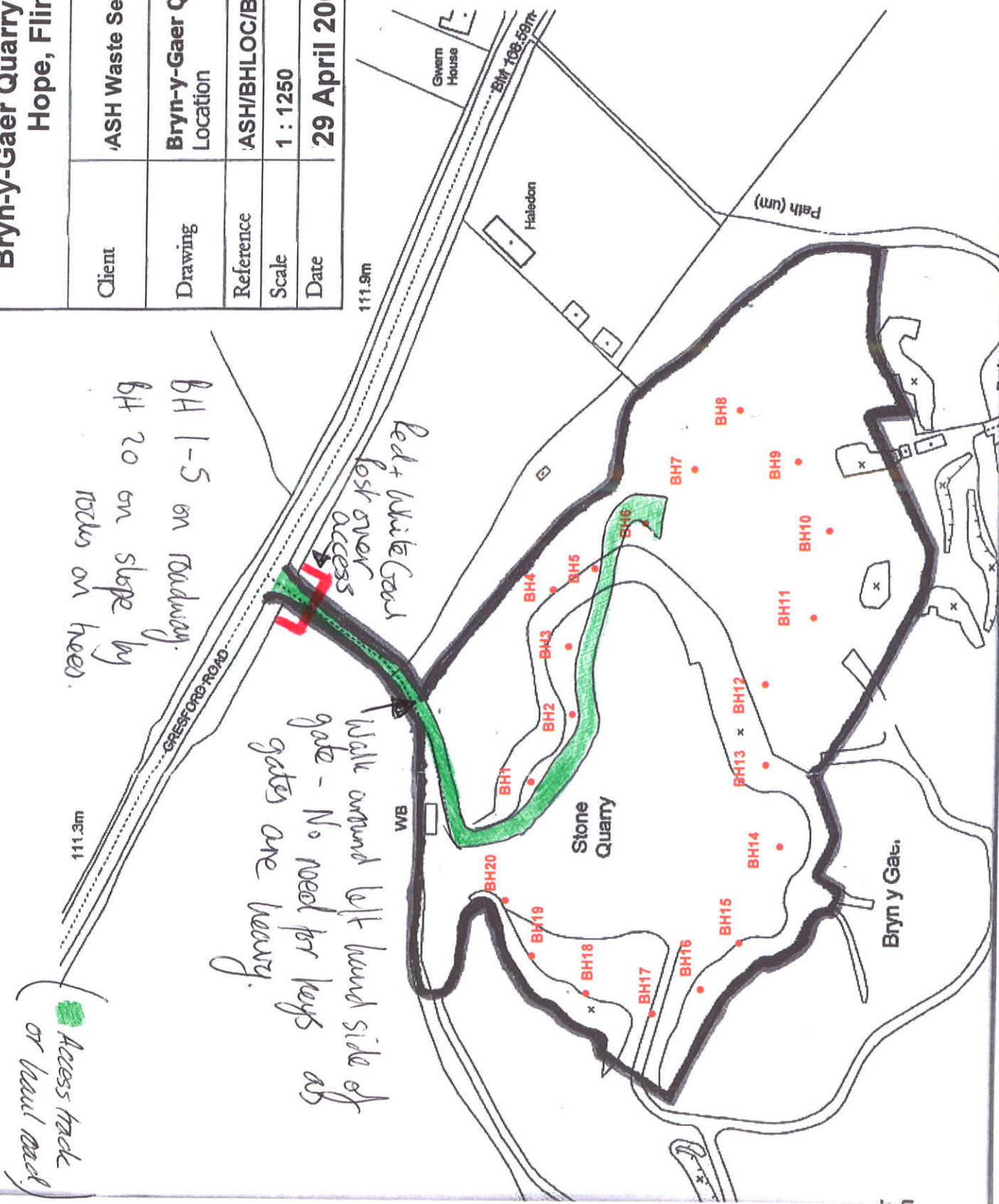

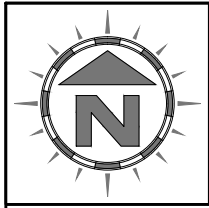

Reproduced with the permission of the controller of H.M.S.O. Crown copyright licence No. 100015148

GRESFORD ROAD

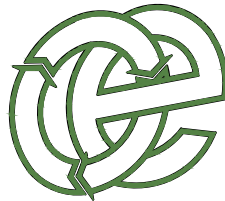

Oaktree Environmental Ltd
Waste Management and
Environmental Consultants
Unit 5, Oasis Park, 19 Road One,
Winsford, Cheshire CW7 3RY
Tel: 01606 558833 Fax: 01606 861182
E-mail: sales@oaktree-environmental.co.uk

Title: **FINAL CONTOURS PLAN**

Drawing No: **2370/426/11**

Client: **ASH Group Ltd**

Site: **Bryn y Gaer, Gresford Road, Llay**

Scale: **1:500**

NGR:

Date: **15 June 2015**

Printed At: **A2**

Revision: **-**

Drawn By: **RS**

Checked:

Job No: **2370**

Client No: **426**

KEY:

Final ground level contours (@ 1 m intervals)

Notes:

Data for the "final ground level contours" gathered during a topographical survey of the site undertaken on 5th February 2015 by Richard Sims of Oaktree Environmental Ltd using a Networked Topcon HIPER V Rover unit to the OSTN02 grid projection and OSGM02 Geoid.

Revision Details:

Rev:	Description:	Date:
-	Initial drawing	15/06/15

Scale Bar (1:500)

0 m 25 m 50 m

Bryn y Gaer

(c) Copyright Oaktree Environmental Ltd

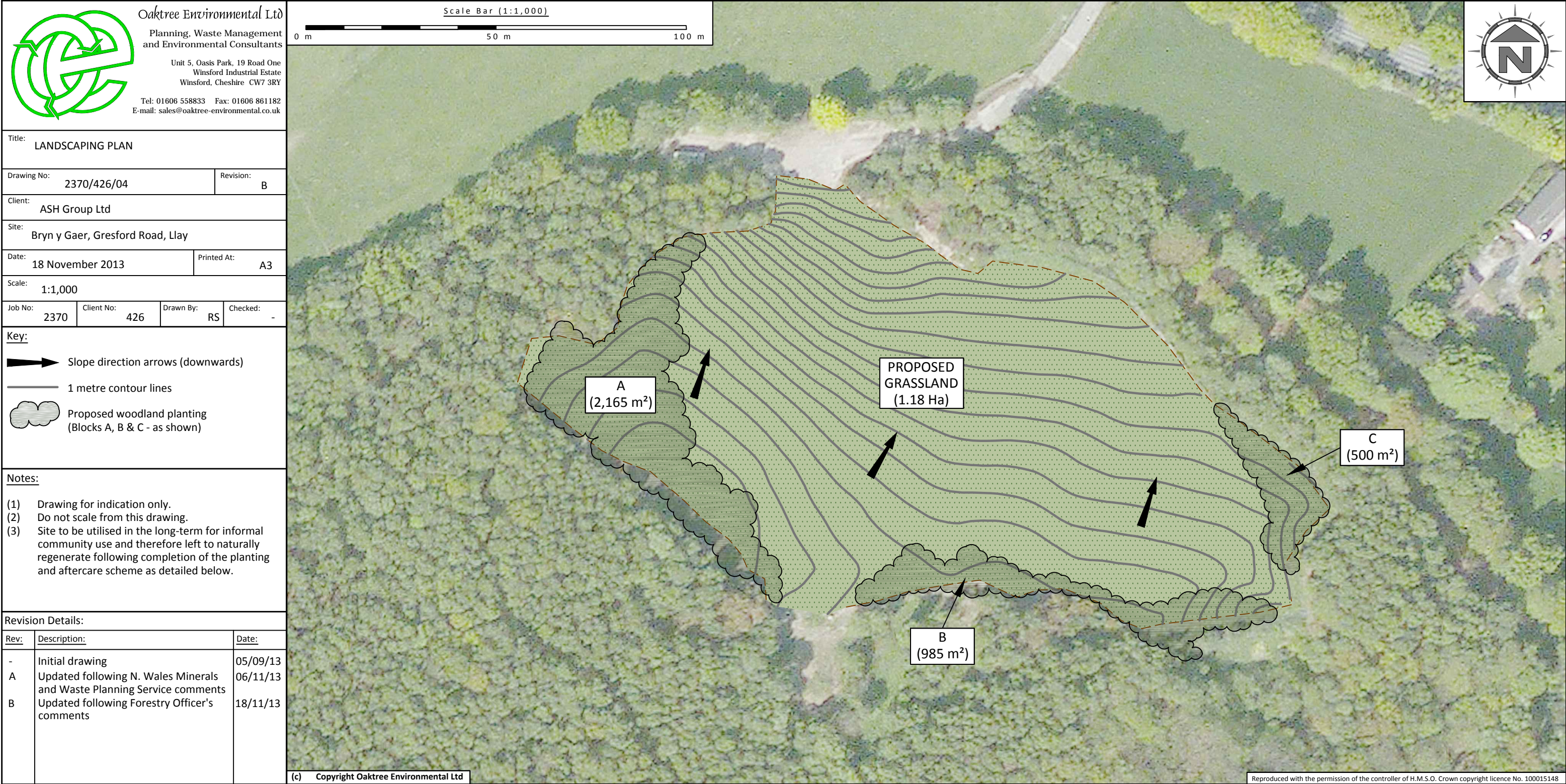

Appendix II

Waste Transfer Notes and Waste Returns data Summary



No: 42117

May 2008

A. Naons

Pontblyddyn

Flintshire

1 load.

Broughton Mill Road, Bretton, Flintshire CH4 0BY
 Sales Tel. 01244 660422 Accounts Tel. 01244 663500 Fax. 01244 661652
 www.alansskips.co.uk E-mail: enquiries@alansskips.co.uk

WAGON HIRE DIVISION

FREEPHONE 0800 195 4707

- 6 X 8 WHEEL TIPPERS
- DISPOSAL FACILITIES
- 8yd³ SKIP HIRE
- ROLL ON / ROLL OFF HIRE
- CRUSHER HIRE
- WE SUPPLY
- TOP SOIL
- CRUSHED BRICK / CONCRETE
- FILL MATERIALS
- LARGE & SMALL QUANTITIES

Contractor: A Naons		Driver's Name: P GRIFFITHS	
Site Address: Brook Cottage		Vehicle Reg. No: AHS2 ASH	
Pontblyddyn		Date: 14-5-08	
Description of Waste: Spoil		Order No:	

No.	Loads Removed From Site	Customer's Signature	Customer's Name Print
1	1 Load Tipped BRYN-Y-GAER		
2	1 Load Tipped BRYN-Y-GAER		
3			
4			
5			
6			
7			
8			

A.M.		P.M.		TRAVELLING TIME	HRS. WORKED EX. MEALTIME
FROM	TO	FROM	TO		

DRIVER'S SIGNATURE & DATE:	HIRER'S SIGNATURE & DATE:
DATE:	DATE:

Carriers License No. NOW / 269449

17 05 04



No: 33328

VAT Reg. No. 817 7436 09 Company Reg. No. 4829675

Lorry & JCB Hire • Waste Transfer Station • Tipping Facilities
Bulk Containers • Skip Hire • Top Soil + Hardcore AvailableBroughton Mill Road, Bretton, Flintshire CH4 0BY
Sales Tel. 01244 660422 Accounts Tel. 01244 663500
Fax. 01244 661652

www.alansskips.co.uk E-mail: enquiries@alansskips.co.uk

Freephone 0800 195 4707

VAT Reg. No. 817 7436 09

YOUR ORDER NO.		DATE 29.5.08	
DELIVERY / COLLECTION NOTE			
VEHICLE REG. NO. OX08LGE		PRODUCT ORDERED	
CUSTOMER NAME & ADDRESS		SOIL	
BNP DEVELOPMENTS		QUANTITY ORDERED	
BUCKLEY		4 x LOADS.	
to ASH TIP		PRICE PER TONNE	
BEYN-Y- GAER.			
PAYMENT DUE		WEIGHT	
GOODS		GROSS	
V.A.T. @		TARE	
INVOICE TOTAL		NETT	
OTHER INSTRUCTIONS			
.....		DELIVERED	<input checked="" type="checkbox"/>
.....		COLLECTED	<input type="checkbox"/>
SIGNED  PRINT			
YOUR CUSTOM IS GREATLY APPRECIATED AND YOU HAVE HELPED THE ENVIRONMENT BY USING OUR RECYCLED PRODUCT. PLEASE DO NOT HESITATE TO CALL AGAIN. THANK YOU. ALAN'S SKIP HIRE LTD.			

May 2008.
BNP Developments.

Flintshire (Buckley).

4 loads.

17 05 04

FLINTSHIRE.

230 loads

17 05 04

No: 37051



4163 tonnes.

VAT Reg. No. 817 7436 09 Company Reg. No. 4829675

Lorry & JCB Hire • Waste Transfer Station • Tipping Facilities
Bulk Containers • Skip Hire • Top Soil • Hardcore Available

Freephone 0800 195 4707

Broughton Mill Road, Bretton, Flintshire CH4 0BY

Sales Tel. 01244 660422 Accounts Tel. 01244 663500

Fax. 01244 661652

www.alansskips.co.uk E-mail: enquiries@alansskips.co.uk

YOUR ORDER NO.

DATE 10/12/08

DELIVERY / COLLECTION NOTE

VEHICLE REG. NO. CX08 LFF2

PRODUCT ORDERED

CUSTOMER NAME & ADDRESS

QUANTITY ORDERED

10 LOADS

PRICE PER TONNE

PAYMENT DUE

WEIGHT

GOODS

GROSS

V.A.T. @

TARE

INVOICE TOTAL

NETT

OTHER INSTRUCTIONS

DELIVERED ☐COLLECTED ☐

SIGNED

PRINT

YOUR CUSTOM IS GREATLY APPRECIATED AND YOU HAVE HELPED THE ENVIRONMENT
BY USING OUR RECYCLED PRODUCT. PLEASE DO NOT HESITATE TO CALL AGAIN.
THANK YOU. ALAN'S SKIP HIRE LTD.

Cheshire

23 loads

20 02 02

No: 33805



4163 tonnes.

VAT Reg. No. 817 7436 09 Company Reg. No. 4829675

Lorry & JCB Hire • Waste Transfer Station • Tipping Facilities
Bulk Containers • Skip Hire • Top Soil + Hardcore Available

Freephone 0800 195 4707

Broughton Mill Road, Bretton, Flintshire CH4 0BY

Sales Tel. 01244 660422 Accounts Tel. 01244 663500

Fax. 01244 661652

www.alansskips.co.uk E-mail: enquiries@alansskips.co.uk

VAT Reg. No. 817 7436 09

YOUR ORDER NO.

DATE 14.11.08

DELIVERY / COLLECTION NOTE

VEHICLE REG. NO. CX08 LGD

PRODUCT ORDERED

CUSTOMER NAME & ADDRESS

W E PARSONS

2 x 20 LOADS SPOL

CLUSTER ZOO

QUANTITY ORDERED

PRICE PER TONNE

PAYMENT DUE

WEIGHT

GOODS

GROSS

V.A.T. @

TARE

INVOICE TOTAL

NETT

OTHER INSTRUCTIONS

DELIVERED ☒COLLECTED ☐

SIGNED

PRINT

YOUR CUSTOM IS GREATLY APPRECIATED AND YOU HAVE HELPED THE ENVIRONMENT
BY USING OUR RECYCLED PRODUCT. PLEASE DO NOT HESITATE TO CALL AGAIN.

THANK YOU. ALAN'S SKIP HIRE LTD.

Appendix III

Site Diary Entries

Sum of Amount	Column Labels												
Row Labels	Q1 2008	Q1 2009	Q1 2012	Q2 2008	Q2 2009	Q2 2015	Q3 2008	Q3 2009	Q3 2014	Q4 2008	Q4 2014	Grand Total	
170107													
mixtures of concrete, bricks, tiles and ceramics other than those mentioned in 17 01 06	141											141	
170504													
soil and stones other than those mentioned in 17 05 03	3,547	6,679	3,572	8,655	11,045	2,880	8,503	3,711	1,424	21,599	2,700	74,314	
191209													
minerals (e.g. sand, stones)	10,317	6,950		13,720	5,251		8,217	4,489		5,683		54,628	
200202													
soil and stones	561	688		1,213	489		1,050			833		4,833	
010409													
waste sand and clays	380											380	
Grand Total	14,946	14,317	3,572	23,587	16,785	2,880	17,771	8,199	1,424	28,115	2,700	134,296	

	Origin	EWC Waste Code	Municipal source (Y/N)	Bio-degradable (Y/N)	State	Amount	Units	EWC Description
Q1 2008	Chester		No	No	Solid	90.5	Tonnes	soil and stones other than those mentioned in 17 05 03
Q1 2008	Chester	170504	No	No	Solid	126.7	Tonnes	soil and stones other than those mentioned in 17 05 03
Q1 2008	Chester	200202	Yes	No	Solid	253.4	Tonnes	soil and stones
Q1 2008	Ellesmere Port & Neston	200202	Yes	No	Solid	181	Tonnes	soil and stones
Q1 2008	Ellesmere Port & Neston	191209	No	No	Solid	452.5	Tonnes	minerals (e.g. sand, stones)
Q1 2008	Flintshire UA	191209	No	No	Solid	2678.8	Tonnes	minerals (e.g. sand, stones)
Q1 2008	Flintshire UA	170504	No	No	Solid	54.3	Tonnes	soil and stones other than those mentioned in 17 05 03
Q1 2008	Flintshire UA	170504	No	No	Solid	72.4	Tonnes	soil and stones other than those mentioned in 17 05 03
Q1 2008	Flintshire UA	170504	No	No	Solid	832.6	Tonnes	soil and stones other than those mentioned in 17 05 03
Q1 2008	Flintshire UA	170504	No	No	Solid	18.1	Tonnes	soil and stones other than those mentioned in 17 05 03
Q1 2008	Flintshire UA	170107	No	No	Solid	140.8	Tonnes	mixtures of concrete, bricks, tiles and ceramics other than those mentioned in 17 01 06
Q1 2008	Wrexham UA	191209	No	No	Solid	3276.1	Tonnes	minerals (e.g. sand, stones)
Q1 2008	Wrexham UA	170504	No	No	Solid	54.3	Tonnes	soil and stones other than those mentioned in 17 05 03
Q1 2008	Wrexham UA	170504	No	No	Solid	54.3	Tonnes	soil and stones other than those mentioned in 17 05 03
Q1 2008	Wrexham UA	170504	No	No	Solid	126.7	Tonnes	soil and stones other than those mentioned in 17 05 03
Q1 2008	Wrexham UA	170504	No	No	Solid	959.3	Tonnes	soil and stones other than those mentioned in 17 05 03
Q1 2008	Wrexham UA	010409	No	No	Solid	380.1	Tonnes	waste sand and clays
Q1 2008	Chester	170504	No	No	Solid	18.1	Tonnes	soil and stones other than those mentioned in 17 05 03
Q1 2008	Chester	170504	No	No	Solid	36.2	Tonnes	soil and stones other than those mentioned in 17 05 03
Q1 2008	Ellesmere Port & Neston	200202	Yes	No	Solid	126.7	Tonnes	soil and stones
Q1 2008	Ellesmere Port & Neston	191209	No	No	Solid	54.3	Tonnes	minerals (e.g. sand, stones)
Q1 2008	Flintshire UA	191209	No	No	Solid	1158.4	Tonnes	minerals (e.g. sand, stones)
Q1 2008	Flintshire UA	170504	No	No	Solid	253.4	Tonnes	soil and stones other than those mentioned in 17 05 03
Q1 2008	Flintshire UA	170504	No	No	Solid	36.2	Tonnes	soil and stones other than those mentioned in 17 05 03
Q1 2008	Flintshire UA	170504	No	No	Solid	18.1	Tonnes	soil and stones other than those mentioned in 17 05 03
Q1 2008	Flintshire UA	170504	No	No	Solid	180.1	Tonnes	soil and stones other than those mentioned in 17 05 03
Q1 2008	Wrexham UA	191209	No	No	Solid	2696.9	Tonnes	minerals (e.g. sand, stones)
Q1 2008	Wrexham UA	170504	No	No	Solid	144.8	Tonnes	soil and stones other than those mentioned in 17 05 03
Q1 2008	Wrexham UA	170504	No	No	Solid	470.6	Tonnes	soil and stones other than those mentioned in 17 05 03
Q2 2008	Chester	170504	No	No	Solid	235.3	Tonnes	soil and stones other than those mentioned in 17 05 03
Q2 2008	Chester	170504	No	No	Solid	18.1	Tonnes	soil and stones other than those mentioned in 17 05 03
Q2 2008	Chester	170504	No	No	Solid	4072.5	Tonnes	soil and stones other than those mentioned in 17 05 03
Q2 2008	Chester	200202	Yes	No	Solid	832.6	Tonnes	soil and stones
Q2 2008	Chester	170504	No	No	Solid	18.1	Tonnes	soil and stones other than those mentioned in 17 05 03
Q2 2008	Chester	170504	No	No	Solid	126.7	Tonnes	soil and stones other than those mentioned in 17 05 03
Q2 2008	Chester	170504	No	No	Solid	270.6	Tonnes	soil and stones other than those mentioned in 17 05 03
Q2 2008	Chester	170504	No	No	Solid	597.3	Tonnes	soil and stones other than those mentioned in 17 05 03
Q2 2008	Chester	170504	No	No	Solid	72.4	Tonnes	soil and stones other than those mentioned in 17 05 03
Q2 2008	Chester	170504	No	No	Solid	18.1	Tonnes	soil and stones other than those mentioned in 17 05 03
Q2 2008	Denbighshire UA	170504	No	No	Solid	36.2	Tonnes	soil and stones other than those mentioned in 17 05 03
Q2 2008	Flintshire UA	191209	No	No	Solid	5140.4	Tonnes	minerals (e.g. sand, stones)
Q2 2008	Flintshire UA	170504	No	No	Solid	686	Tonnes	soil and stones other than those mentioned in 17 05 03
Q2 2008	Flintshire UA	170504	No	No	Solid	181	Tonnes	soil and stones other than those mentioned in 17 05 03
Q2 2008	Flintshire UA	170504	No	No	Solid	54.36	Tonnes	soil and stones other than those mentioned in 17 05 03
Q2 2008	Flintshire UA	170504	No	No	Solid	36.2	Tonnes	soil and stones other than those mentioned in 17 05 03
Q2 2008	Flintshire UA	170504	No	No	Solid	18.1	Tonnes	soil and stones other than those mentioned in 17 05 03
Q2 2008	Ellesmere Port & Neston	170504	No	No	Solid	235.3	Tonnes	soil and stones other than those mentioned in 17 05 03
Q2 2008	Ellesmere Port & Neston	170504	No	No	Solid	72.4	Tonnes	soil and stones other than those mentioned in 17 05 03
Q2 2008	Ellesmere Port & Neston	200202	Yes	No	Solid	380.1	Tonnes	soil and stones
Q2 2008	Ellesmere Port & Neston	191209	No	No	Solid	5864.4	Tonnes	minerals (e.g. sand, stones)
Q2 2008	Wrexham UA	191209	No	No	Solid	2715	Tonnes	minerals (e.g. sand, stones)
Q2 2008	Wrexham UA	170504	No	No	Solid	1127.9	Tonnes	soil and stones other than those mentioned in 17 05 03
Q2 2008	Wrexham UA	170504	No	No	Solid	470.6	Tonnes	soil and stones other than those mentioned in 17 05 03
Q2 2008	Wrexham UA	170504	No	No	Solid	199.1	Tonnes	soil and stones other than those mentioned in 17 05 03
Q2 2008	Wrexham UA	170504	No	No	Solid	90.5	Tonnes	soil and stones other than those mentioned in 17 05 03
Q2 2008	Wrexham UA	170504	No	No	Solid	18.1	Tonnes	soil and stones other than those mentioned in 17 05 03
Q3 2008	Chester	170504	No	No	Solid	19.2	Tonnes	soil and stones other than those mentioned in 17 05 03
Q3 2008	Chester	200202	No	No	Solid	416.3	Tonnes	soil and stones
Q3 2008	Denbighshire UA	170504	No	No	Solid	181	Tonnes	soil and stones other than those mentioned in 17 05 03
Q3 2008	Denbighshire UA	170504	Yes	No	Solid	54.6	Tonnes	soil and stones other than those mentioned in 17 05 03
Q3 2008	Ellesmere Port & Neston	170504	No	No	Solid	144.8	Tonnes	soil and stones other than those mentioned in 17 05 03
Q3 2008	Ellesmere Port & Neston	191209	No	No	Solid	3728.6	Tonnes	minerals (e.g. sand, stones)
Q3 2008	Ellesmere Port & Neston	200202	No	No	Solid	488.7	Tonnes	soil and stones
Q3 2008	Ellesmere Port & Neston	200202	No	No	Solid	144.8	Tonnes	soil and stones
Q3 2008	Flintshire UA	170504	No	No	Solid	4163	Tonnes	soil and stones other than those mentioned in 17 05 03
Q3 2008	Flintshire UA	170504	No	No	Solid	217.2	Tonnes	soil and stones other than those mentioned in 17 05 03
Q3 2008	Flintshire UA	191209	No	No	Solid	72.4	Tonnes	minerals (e.g. sand, stones)
Q3 2008	Flintshire UA	191209	No	No	Solid	4072.5	Tonnes	minerals (e.g. sand, stones)
Q3 2008	Wirral	170504	No	No	Solid	1991	Tonnes	soil and stones other than those mentioned in 17 05 03
Q3 2008	Wrexham UA	170504	No	No	Solid	217.2	Tonnes	soil and stones other than those mentioned in 17 05 03
Q3 2008	Wrexham UA	170504	No	No	Solid	179	Tonnes	soil and stones other than those mentioned in 17 05 03
Q3 2008	Wrexham UA	170504	No	No	Solid	974.4	Tonnes	soil and stones other than those mentioned in 17 05 03
Q3 2008	Wrexham UA	170504	No	No	Solid	90.5	Tonnes	soil and stones other than those mentioned in 17 05 03
Q3 2008	Wrexham UA	170504	No	No	Solid	271.5	Tonnes	soil and stones other than those mentioned in 17 05 03
Q3 2008	Wrexham UA	191209	No	No	Solid	343.9	Tonnes	minerals (e.g. sand, stones)
Q4 2008	Chester	170504	No	No	Solid	36.2	Tonnes	soil and stones other than those mentioned in 17 05 03
Q4 2008	Chester	200202	No	No	Solid	724	Tonnes	soil and stones
Q4 2008	Ellesmere Port & Neston	170504	No	No	Solid	416.6	Tonnes	soil and stones other than those mentioned in 17 05 03
Q4 2008	Ellesmere Port & Neston	170504	No	No	Solid	524.9	Tonnes	soil and stones other than those mentioned in 17 05 03
Q4 2008	Ellesmere Port & Neston	191209	No	No	Solid	2009.1	Tonnes	minerals (e.g. sand, stones)
Q4 2008	Ellesmere Port & Neston	200202	No	No	Solid	108.6	Tonnes	soil and stones
Q4 2008	Flintshire UA	170504	No	No	Solid	312.9	Tonnes	soil and stones other than those mentioned in 17 05 03
Q4 2008	Flintshire UA	170504	No	No	Solid	199.1	Tonnes	soil and stones other than those mentioned in 17 05 03
Q4 2008	Flintshire UA	170504	No	No	Solid	90.5	Tonnes	soil and stones other than those mentioned in 17 05 03
Q4 2008	Flintshire UA	191209	No	No	Solid	3674.3	Tonnes	minerals (e.g. sand, stones)
Q4 2008	Flintshire UA	170504	No	No	Solid	17249.3	Tonnes	soil and stones other than those mentioned in 17 05 03
Q4 2008	Wrexham UA	170504	No	No	Solid	2769.3	Tonnes	soil and stones other than those mentioned in 17 05 03
Q1 2009	Chester	200202	Yes	No	Solid	144.8	Tonnes	soil and stones
Q1 2009	Chester	170504	No	No	Solid	452.5	Tonnes	soil and stones other than those mentioned in 17 05 03
Q1 2009	Chester	170504	No	No	Solid	18.1	Tonnes	soil and stones other than those mentioned in 17 05 03
Q1 2009	Chester	170504	No	No	Solid	380.1	Tonnes	soil and stones other than those mentioned in 17 05 03
Q1 2009	Chester	170504	No	No	Solid	36.2	Tonnes	soil and stones other than those mentioned in 17 05 03
Q1 2009	Chester	170504	No	No	Solid	18.2	Tonnes	soil and stones other than those mentioned in 17 05 03
Q1 2009	Denbighshire UA	170504	No	No	Solid	36.2	Tonnes	soil and stones other than those mentioned in 17 05 03
Q1 2009	Ellesmere Port & Neston	200202	Yes	No	Solid	543	Tonnes	soil and stones
Q1 2009	Ellesmere Port & Neston	191209	No	No	Solid	2678.8	Tonnes	minerals (e.g. sand, stones)
Q1 2009	Ellesmere Port & Neston	170504	No	No	Solid	615.4	Tonnes	soil and stones other than those mentioned in 17 05 03
Q1 2009	Flintshire UA	191209	No	No	Solid	2950.3	Tonnes	minerals (e.g. sand, stones)
Q1 2009	Flintshire UA	170504	No	No	Solid	343.9	Tonnes	soil and stones other than those mentioned in 17 05 03
Q1 2009	Flintshire UA	170504	No	No	Solid	181	Tonnes	soil and stones other than those mentioned in 17 05 03
Q1 2009	Flintshire UA	170504	No	No	Solid	144.8	Tonnes	soil and stones other than those mentioned in 17 05 03
Q1 2009	Wrexham UA	191209	No	No	Solid	1321.3	Tonnes	minerals (e.g. sand, stones)
Q1 2009	Wrexham UA	170504	No	No	Solid	2027.2	Tonnes	soil and stones other than those mentioned in 17 05 03
Q1 2009	Wrexham UA	170504	No	No	Solid	2226.3	Tonnes	soil and stones other than those mentioned in 17 05 03
Q1 2009	Wrexham UA	170504	No	No	Solid	162.8	Tonnes	soil and stones other than those mentioned in 17 05 03
Q1 2009	Wrexham UA	170504	No	No	Solid	36.2	Tonnes	soil and stones other than those mentioned in 17 05 03
Q2 2009	Chester	200202	Yes	No	Solid	72.4	Tonnes	soil and stones
Q2 2009	Chester	170504	No	No	Solid	271.5	Tonnes	soil and stones other than those mentioned in 17 05 03
Q2 2009	Chester	170504	No	No	Solid	72.4	Tonnes	soil and stones other than those mentioned in 17 05 03
Q2 2009	Chester	170504	No	No	Solid	705.9	Tonnes	soil and stones other than those mentioned in 17 05 03
Q2 2009	Chester	170504	No	No	Solid	4199.2	Tonnes	soil and stones other than those mentioned in 17 05 03
Q2 2009	Ellesmere Port & Neston	200202	Yes	No	Solid	416.3	Tonnes	soil and stones
Q2 2009	Ellesmere Port & Neston	191209	No	No	Solid	2099.6	Tonnes	minerals (e.g. sand, stones)

Q2 2009	Ellesmere Port & Neston	170504	No	No	Solid	144.8	Tonnes	soil and stones other than those mentioned in 17 05 03
Q2 2009	Ellesmere Port & Neston	170504	Yes	No	Solid	705.9	Tonnes	soil and stones other than those mentioned in 17 05 03
Q2 2009	Ellesmere Port & Neston	170504	No	No	Solid	796.4	Tonnes	soil and stones other than those mentioned in 17 05 03
Q2 2009	Ellesmere Port & Neston	170504	No	No	Solid	72.8	Tonnes	soil and stones other than those mentioned in 17 05 03
Q2 2009	Flintshire UA	191209	No	No	Solid	3095.1	Tonnes	minerals (e.g. sand, stones)
Q2 2009	Flintshire UA	170504	No	No	Solid	941.2	Tonnes	soil and stones other than those mentioned in 17 05 03
Q2 2009	Flintshire UA	170504	No	No	Solid	561.1	Tonnes	soil and stones other than those mentioned in 17 05 03
Q2 2009	Flintshire UA	170504	No	No	Solid	488.7	Tonnes	soil and stones other than those mentioned in 17 05 03
Q2 2009	Flintshire UA	170504	No	No	Solid	489.6	Tonnes	soil and stones other than those mentioned in 17 05 03
Q2 2009	Flintshire UA	170504	No	No	Solid	73.2	Tonnes	soil and stones other than those mentioned in 17 05 03
Q2 2009	Wrexham UA	191209	No	No	Solid	56.7	Tonnes	minerals (e.g. sand, stones)
Q2 2009	Wrexham UA	170504	No	No	Solid	1339.4	Tonnes	soil and stones other than those mentioned in 17 05 03
Q2 2009	Wrexham UA	170504	No	No	Solid	183	Tonnes	soil and stones other than those mentioned in 17 05 03
Q3 2009	Chester	191209	No	No	Solid	36.2	Tonnes	minerals (e.g. sand, stones)
Q3 2009	Chester	170504	No	No	Solid	108.6	Tonnes	soil and stones other than those mentioned in 17 05 03
Q3 2009	Chester	170504	No	No	Solid	1484.2	Tonnes	soil and stones other than those mentioned in 17 05 03
Q3 2009	Flintshire UA	191209	No	No	Solid	2081.5	Tonnes	minerals (e.g. sand, stones)
Q3 2009	Flintshire UA	170504	No	No	Solid	796.4	Tonnes	soil and stones other than those mentioned in 17 05 03
Q3 2009	Wrexham UA	170504	No	No	Solid	995.5	Tonnes	soil and stones other than those mentioned in 17 05 03
Q3 2009	Ellesmere Port & Neston	191209	No	No	Solid	2371.1	Tonnes	minerals (e.g. sand, stones)
Q3 2009	Ellesmere Port & Neston	170504	No	No	Solid	325.8	Tonnes	soil and stones other than those mentioned in 17 05 03
Q1 2012	Flintshire UA	170504	No	No	Solid	3572	Tonnes	soil and stones other than those mentioned in 17 05 03
Q3 2014	Chester	170504	N	No	Solid	1424	Tonnes	soil and stones other than those mentioned in 17 05 03
Q4 2014	Flintshire	170504	N	No	Solid	2700	Tonnes	soil and stones other than those mentioned in 17 05 03
Q2 2015	Flintshire	170504	N	No	Solid	2880	Tonnes	soil and stones other than those mentioned in 17 05 03

Topic	Mon	Tues	Wed	Thurs	Fri	Sat	Sun	Comments / Observations / Remedial Actions
Site Entrance & Notice Board	Good	Good	✓	OK	Good			
Perimeter fence & Gates & CCTV	OK	✓	OK	OK	✓			
Weighbridge & Wheelwash	N/A	N/A	N/A	N/A	N/A			
Condition of Site, Roads & Surfaces	AM PM Clean	AM PM Clean	AM PM Road	AM PM Good	AM PM Good	AM PM	AM PM	
Vermin (Birds, Rats, Flies)	None	None	No	No	None			
Odours (On and Off Site)	AM PM No	AM PM No	AM PM No	AM PM No	AM PM None	AM PM	AM PM	
Noise Levels	OK	OK	OK	OK	✓			
Control of Litter / Mud / Debris	x ✓	x ✓	x ✓	x ✓	x ✓			* wheel wash steam cleaner on site. + op.
Fuel Bund & Fuel Storage Area	NA	N/A	✓	✓	None			
Foul Water Drains & Interceptor	NA	N/A	N/A	N/A	✓			
Surface Water & Ditches	OK	OK	OK	OK	OK			
Waste Types / Quantities Inert	Inert Soil	Spoil	Soil ✓	Spoil	Spoil*			clean top soil type
Waste Types / Quantities Biodegradable	No.	No	No	No	No			
Waste Types / Quantities Special	No.	No	No	No	No			
Waste / Container Storage	No	No	No	No	No			
Machine Breakdowns	None	None	Wap	None	None			
Trommel & Picking Line	N/A	N/A	N/A	N/A	N/A			
Evidence of Fire / Fires	No.	No	No	No	No			
Accidents on Site	None	None	None	None	None			
Rejected Loads	None	None	None	No	None			
Weather Conditions	✓	Good	✓	Good	Good			
Completed by (Daily)	✓	✓	✓	✓	✓			
Checked by (Weekly)	✓	✓	✓	✓	✓			



General Comments

Monday			<i>Drives quarry on site, remove from site</i>	EA Visit
Site COTC Cover	AM <i>8:00</i>	PM		
Staff on Annual Leave	AM <i>10:00</i>	PM		
Staff Off on Sick Leave	AM	PM		
Tuesday				EA Visit
Site COTC Cover	AM	PM		
Staff on Annual Leave	AM	PM		
Staff Off on Sick Leave	AM	PM		
Wednesday			<i>210 needs fuel + air filter blower out wheel wash / refill browser / clean nozzles on lane</i>	EA Visit
Site COTC Cover	AM	PM		
Staff on Annual Leave	AM	PM		
Staff Off on Sick Leave	AM	PM		
Thursday				EA Visit
Site COTC Cover	AM <i>8:00</i>	PM <i>4:30</i>		
Staff on Annual Leave	AM	PM		
Staff Off on Sick Leave	AM	PM		
Friday			<i>Roads clean Site Tidy fuel needed for excavator</i>	EA Visit
Site COTC Cover	AM	PM		
Staff on Annual Leave	AM <i>8:00</i>	PM <i>10:00</i>		
Staff Off on Sick Leave	AM <i>3:30</i>	PM <i>4:30</i>		
Saturday				EA Visit
Site COTC Cover	AM	PM		
Staff on Annual Leave	AM	PM		
Staff Off on Sick Leave	AM	PM		
Sunday				EA Visit

[illegible]



General Comments:

Monday				Road sweeper Jet washer + wheel washer all present on site Till Road and grade site. spirit Antus.	EA Visit
No. Loads into site					
Staff on annual leave	AM	PM			
Staff off on sick leave	AM	PM			
Tuesday				Sweeper + Jet Washer + wheel washer sit Roads very clean.	EA Visit
No. Loads into site					
Staff on annual leave	AM	PM			
Staff off on sick leave	AM	PM			
Wednesday				Same as above no problems	EA Visit
No. Loads into site					
Staff on annual leave	AM	PM			
Staff off on sick leave	AM	PM			
Thursday				All as per above.	EA Visit
No. Loads into site					
Staff on annual leave	AM	PM			
Staff off on sick leave	AM	PM			
Friday				problem with down pour. Daily water on road not mud. 10 attended and sorted	EA Visit
No. Loads into site					
Staff on annual leave	AM	PM			
Staff off on sick leave	AM	PM			
Saturday					EA Visit
No. Loads into site	AM				
Staff on annual leave	AM				
Staff off on sick leave	AM				
Sunday					EA Visit

Daily Site Monitoring, Inspections and Environmental Log [ASH/RF/3]

Week Commencing: 17/10/14

Site: BRYN-Y-GAER INERT LANDFILL

[illegible]



General Comments:

Monday			Road sweeper late turning up 12 lanes held back until arrived at 9.30 Road excellent No Breakdown	EA Visit
No. Loads into site				
Staff on annual leave	AM	PM		
Staff off on sick leave	AM	PM		
Tuesday			Road good. No problems Sweeper on site 7.50 explained as should have been 7.30. Road good.	EA Visit
No. Loads into site				
Staff on annual leave	AM	PM		
Staff off on sick leave	AM	PM		
Wednesday			Road restored back to original fine line. Batter down to many in with existing slopes and rock face.	EA Visit
No. Loads into site				
Staff on annual leave	AM	PM		
Staff off on sick leave	AM	PM		
Thursday			All good, dry materials, sound clays	EA Visit
No. Loads into site				
Staff on annual leave	AM	PM		
Staff off on sick leave	AM	PM		
Friday			Final stages of Restoration. Sweeper on site Cleaner Power washer. Soil over areas as road filled	EA Visit
No. Loads into site				
Staff on annual leave	AM	PM		
Staff off on sick leave	AM	PM		
Saturday				EA Visit
No. Loads into site	AM			
Staff on annual leave	AM			
Staff off on sick leave	AM			
Sunday				EA Visit
No. Loads into site				
Staff on annual leave				
Staff off on sick leave				

Appendix IV

CAR Forms

This form will report compliance with your permit as determined by an NRW officer

Site	Bryn Y Gaer Quarry			Permit Ref	37050		
Operator/ Permit holder	Ash Waste Services Ltd						
Date	08/04/2014			Time in	15:15	Out	15:35
What parts of the permit were assessed	General considerations, site infrastructure, site operations, site records						
Assessment	Site Inspection	EPR Activity:	Installation	Waste Op	X	Water Discharge	
Recipient's name/position	John Dennan - Director						
Officer's name	Rachel Twiss, Andrew Sowerby			Date issued	29/04/2014		

Section 1 - Compliance Assessment Summary

This is based on the requirements of the permit under the Environmental Permitting Regulations. A detailed explanation and any action you may need to take are given in the "Detailed Assessment of Compliance" (section 3). This summary details where we believe any non-compliance with the permit has occurred, the relevant condition and how the non-compliance has been categorised using our Compliance Classification Scheme (CCS). CCS scores can be consolidated or suspended, where appropriate, to reflect the impact of some non-compliances more accurately. For more details of our CCS scheme, contact your local office.

Permit Conditions and Compliance Summary			Condition(s) breached
a) Permitted activities	1. Specified by permit	A	
b) Infrastructure	1. Engineering for prevention & control of pollution	A	
	2. Closure & decommissioning	NA	
	3. Site drainage engineering (clean & foul)	N	
	4. Containment of stored materials	N	
	5. Plant and equipment	N	
c) General management	1. Staff competency/ training	C3	1.4.2
	2. Management system & operating procedures	C3	4.1.1
	3. Materials acceptance	A	
	4. Storage handling, labelling, segregation	N	
d) Incident management	1. Site security	C4	3.1.1
	2. Accident, emergency & incident planning	N	
e) Emissions	1. Air	A	
	2. Land & Groundwater	A	
	3. Surface water	N	
	4. Sewer	NA	
	5. Waste	N	
f) Amenity	1. Odour	A	
	2. Noise	A	
	3. Dust/fibres/particulates	A	
	4. Pests, birds & scavengers	A	
	5. Deposits on road	C3	4.1
g) Monitoring and records, maintenance and reporting	1. Monitoring of emissions & environment	N	
	2. Records of activity, site diary, journal & events	C4	7.3.1
	3. Maintenance records	N	
	4. Reporting & notification	N	
h) Resource efficiency	1. Efficient use of raw materials	NA	
	2. Energy	NA	

KEY: C1, C2, C3, C4 = CCS breach category (* suspended scores are marked with an asterisk),
A = Assessed (no evidence of non-compliance), N = Not assessed, NA = Not Applicable, O = Ongoing non-compliance – not scored

Number of breaches recorded	5	Total compliance score (see section 5 for scoring scheme)	12.2
------------------------------------	---	---	------

If the Total No Breaches is greater than zero, then please see Section 3 for details of our proposed enforcement response

Section 2 – Compliance Assessment Report Detail

This section contains a report of our findings and will usually include information on:

- the part(s) of the permit that were assessed (e.g. maintenance, training, combustion plant, etc)
- where the type of assessment was 'Data Review' details of the report/results triggering the assessment
- any non-compliances identified
- any non-compliances with directly applicable legislation
- details of any multiple non-compliances
- information on the compliance score accrued inc. details of suspended or consolidated scores.
- details of advice given
- any other areas of concern
- all actions requested
- any examples of good practice.
- a reference to photos taken

This report should be clear, comprehensive, unambiguous and normally completed within 14 days of an assessment.

This site visit was carried out as a result of an incident report where mud was being tracked onto the public highway from the Bryn y Gaer site. The weather at the time was fine and dry although it had rained the previous day.

On approaching the site mud could clearly be seen on the public highway. On entry to the track leading up to the site, deep, wet mud was present which covered the whole track and area below the sloped bank where material was being deposited.

One wagon was on site and parked up below the bank. On being asked if a site manager/supervisor was present the driver said the only other staff member present was the machine operative. On scaling the bank to get a look at the whole site the material recently brought onto site looked to be clean and consisted mostly of soil. The operative continued with his work whilst photographs across the site were taken.

During the site inspection the following breaches were observed:

c1) General management – staff competency and training, Permit Condition 1.4.2 - Availability of licence and working plan - CCS category 3 breach

A copy of the permit and the working plan should be kept available on site for reference when required by all staff carrying out work under the requirements of the licence. These documents were not available on site and this was confirmed the following day by John Dennen.

c2) General management - management system and operating procedures, Permit Condition 4.1.1 – CCS category 3 breach

The control measures outlined in the permit, working plan/EMS and the Mud Management plan were not being implemented to prevent the deposit of tracking of mud or debris arising from the site onto the public highway. However, a road sweeper was in place.

d1) Incident management – site security, Permit Condition 3.1.1 - Provision of site identification board - CCS category 4 breach

The permit clearly states that no wastes shall be received at the site until an identification board has been provided at or near the site entrance. No identification board was in place at the time of this visit and the days following until 15th April.

f5) Amenity – deposits on road, Permit Condition 4.1 - Control of mud and debris - CCS category 3 breach

Mud was clearly visible being tracked onto the public highway from the site.

g2) MRMR – records of activity, site diary, journal & events, Permit Condition 7.3.1 - Site diary - CCS category 4 breach

A site diary should be kept secure and available for inspection at the site when required by an unauthorised officer of Natural Resources Wales. This was not available on site.

General comments

I was encouraged to see that ASH had partly addressed the issue of excess mud within the site during a following visit to meet with John Dennen on 10th April. Some of the mud situated on the upper track and open parking area on the site had been scraped off and deposited in a temporary lagoon at the base of the slope. Some of the rough ground was now visible. The amount of mud being tracked onto the highway had been reduced as a result although there was still a need for the road sweeper.

The site manager said that some further removal of mud would be carried out in this area and some hardcore would be brought onto site to improve the track. The site manager agreed to improve the management of the mud from within the site and keep on top of the prevention of mud being tracked onto the road. If necessary all vehicles leaving site should be cleaned prior to leaving the site as outlined in the permit, working plan/EMS and Mud Management Plan.

Regular drive-bys will be carried out by NRW to monitor the levels of mud on the road.

Thank you for your time on site and please keep me updated on site progress and activities.

kind regards
Rachel Twiss

In this document, 'Natural Resources Wales' means the Natural Resources Body for Wales established by Article 3 of the Natural Resources Body for Wales (Establishment) Order 2012



	EPR Compliance Assessment Report	Report ID: 37050/0207189
This form will report compliance with your permit as determined by an NRW officer		
Site	Bryn Y Gaer Quarry	Permit 37050
Operator/ Permit	Ash Waste Services Ltd	Date 08/04/2014

Section 3- Enforcement Response	Only one of the boxes below should be ticked
<p>You must take immediate action to rectify any non-compliance and prevent repetition. Non-compliance with your permit conditions constitutes an offence and can result in criminal prosecutions and/or suspension or revocation of a permit. Please read the detailed assessment in Section 2 and the steps you need to take in Section 4 below.</p>	
Other than the provision of advice and guidance, at present we do not intend to take further enforcement action in respect of the non-compliance identified above. This does not preclude us from taking enforcement action if further relevant information comes to light or advice isn't followed.	<input type="checkbox"/>
In respect of the above non-compliance you have been issued with a warning. At present we do not intend to take further enforcement action. This does not preclude us from taking additional enforcement action if further relevant information comes to light or offences continue.	<input checked="" type="checkbox"/>
We will now consider what enforcement action is appropriate and notify you, referencing this form.	<input type="checkbox"/>

Section 4- Action(s)			
Where non-compliance has been detected and an enforcement response has been selected above, this section summarises the steps you need to take to return to compliance and also provides timescales for this to be done.			
Criteria Ref.	CCS Category	Action Required/Advised	Due Date
See Section 1 above			
C1	C3	Ensure that the site permit and working plan/environment management system are available to staff on site	Immediately
C2	C3	Ensure the control measures outlined in the permit, working plan/EMS and the mud management plan are implemented as required	Immediately
D1	C4	Site identification board required at or near to site entrance	Immediately
F5	C3	Prevent mud on road	Immediately
G2	C4	Ensure site diary is available on site	Immediately

Section 5 - Compliance notes for the Operator

To ensure you correct actual or potential non-compliance we may

- advise on corrective actions verbally or in writing
- require you to take specific actions in writing
- issue a notice
- require you to review your procedures or management system
- change some of the conditions of your permit
- decide to undertake a full review of your permit

Any breach of a permit condition is an offence and we may take legal action against you.

- We will normally provide advice and guidance to assist you to come back into compliance either after an offence is committed or where we consider that an offence is likely to be committed. This is without prejudice to any other enforcement response that we consider may be required.
- Enforcement action can include the issue of a formal caution, prosecution, the service of a notice and or suspension or revocation of the permit.

See our Enforcement and Civil Sanctions guidance for further information

This report does not relieve the site operator of the responsibility to

- ensure you comply with the conditions of the permit at all times and prevent pollution of the environment
- ensure you comply with other legislative provisions which may apply.

Non-compliance scores and categories

CCS category	Description	Score
C1	A non-compliance which could have a major environmental effect	60
C2	A non-compliance which could have a significant environmental effect	31
C3	A non-compliance which could have a minor environmental effect	4
C4	A non-compliance which has no potential environmental effect	0.1

Operational Risk Appraisal (Opra) - Compliance assessment findings may affect your Opra score and/or your charges. This score influences the resource we use to assess permit compliance.

Section 6 – General Information

Data protection notice

The information on this form will be processed by the Natural Resources Wales (NRW) to fulfill its regulatory and monitoring functions and to maintain the relevant public register(s). The NRW may also use and/or disclose it in connection with:

- offering/providing you with its literature/services relating to environmental matters
- consulting with the public, public bodies and other organisations (e.g. Health and Safety Executive, local authorities) on environmental issues
- carrying out statistical analysis, research and development on environmental issues
- providing public register information to enquirers
- investigating possible breaches of environmental law and taking any resulting action
- preventing breaches of environmental law
- assessing customer service satisfaction and improving its service
- Freedom of Information Act/Environmental Information Regulations request.

The NRW may pass it on to its agents/representatives to do these things on its behalf. You should ensure that any persons named on this form are informed of the contents of this data protection notice.

Disclosure of information

The NRW will provide a copy of this report to the public register(s). However, if you consider that any information contained in this report should not be released to the public register(s) on the grounds of commercial confidentiality, you must write to your local area office within twenty working days of receipt of this form indicating which information it concerns and why it should not be released, giving your reasons in full.

Customer charter

What can I do if I disagree with this compliance assessment report?

If you are unable to resolve the issue with your site officer, you should firstly discuss the matter with the officer's line managers. If you wish to raise your dispute further through our official Complaints and Commendations procedure, phone our general enquiry number 0300 065 3000 (Mon to Fri 08.00–18.00) and ask for the Customer Contact team or send an email to enquiries@naturalresourceswales.gov.uk. If you are still dissatisfied you can make a complaint to the Public Services Ombudsman for Wales. For advice on how to complain to the Ombudsman phone their helpline on 0845 607 0987.

	EPR Compliance Assessment Report	Report ID: 37050/0214873
This form will report compliance with your permit as determined by an NRW officer		
Site	Bryn Y Gaer Quarry	Permit Ref 37050
Operator/ Permit holder	Ash Waste Services Ltd	
Date	30/06/2014	Time in 11:55 Out 12:15
What parts of the permit were assessed	Amenity and Management System	
Assessment	Site Inspection EPR Activity: Installation Waste Op: <input checked="" type="checkbox"/> Water Discharge: <input type="checkbox"/>	
Recipient's name/position	John Dennon - Director	
Officer's name	Rachel Twiss	Date issued 17/07/2014

Section 1 - Compliance Assessment Summary

This is based on the requirements of the permit under the Environmental Permitting Regulations. A detailed explanation and any action you may need to take are given in the "Detailed Assessment of Compliance" (section 3). This summary details where we believe any non-compliance with the permit has occurred, the relevant condition and how the non-compliance has been categorised using our Compliance Classification Scheme (CCS). CCS scores can be consolidated or suspended, where appropriate, to reflect the impact of some non-compliances more accurately. For more details of our CCS scheme, contact your local office.

Permit Conditions and Compliance Summary			Condition(s) breached
a) Permitted activities	1. Specified by permit	N	
b) Infrastructure	1. Engineering for prevention & control of pollution	N	
	2. Closure & decommissioning	N	
	3. Site drainage engineering (clean & foul)	N	
	4. Containment of stored materials	N	
	5. Plant and equipment	N	
c) General management	1. Staff competency/ training	N	
	2. Management system & operating procedures	C3	4.1
	3. Materials acceptance	N	
	4. Storage handling, labelling, segregation	N	
d) Incident management	1. Site security	N	
	2. Accident, emergency & incident planning	N	
e) Emissions	1. Air	N	
	2. Land & Groundwater	N	
	3. Surface water	N	
	4. Sewer	N	
	5. Waste	N	
f) Amenity	1. Odour	N	
	2. Noise	N	
	3. Dust/fibres/particulates	N	
	4. Pests, birds & scavengers	N	
	5. Deposits on road	C3	4.1.1
g) Monitoring and records, maintenance and reporting	1. Monitoring of emissions & environment	N	
	2. Records of activity, site diary, journal & events	N	
	3. Maintenance records	N	
	4. Reporting & notification	A	
h) Resource efficiency	1. Efficient use of raw materials	N	
	2. Energy	N	

KEY: C1, C2, C3, C4 = CCS breach category (* suspended scores are marked with an asterisk), A = Assessed (no evidence of non-compliance), N = Not assessed, NA = Not Applicable, O = Ongoing non-compliance – not scored

Number of breaches recorded	2	Total compliance score (see section 5 for scoring scheme)	8
------------------------------------	---	---	---

If the Total No Breaches is greater than zero, then please see Section 3 for details of our proposed enforcement response

Section 2 – Compliance Assessment Report Detail

This section contains a report of our findings and will usually include information on:

- the part(s) of the permit that were assessed (e.g. maintenance, training, combustion plant, etc)
- where the type of assessment was 'Data Review' details of the report/results triggering the assessment
- any non-compliances identified
- any non-compliances with directly applicable legislation
- details of any multiple non-compliances
- information on the compliance score accrued inc. details of suspended or consolidated scores.
- details of advice given
- any other areas of concern
- all actions requested
- any examples of good practice.
- a reference to photos taken

This report should be clear, comprehensive, unambiguous and normally completed within 14 days of an assessment.

This visit to site was conducted following a report to NRW that the main highway outside Bryn y Gaer Quarry was very muddy, wet and had some debris present. The weather at the time was fine and dry.

On speaking to John Dennan some wagons had left site first thing that morning and tracked mud from site onto the main highway after wet conditions during the previous weekend. The wheel wash facility was not in use as had not been reinstated to account for this.

During the site inspection the following breaches were observed:

F5 - Amenity - Deposits on road, Permit Condition 4.1 - CCS Category 3 Breach

C2 - Management - Management Systems & Operating Procedures - CCS Category 3 Breach, Permit Condition 4.1.1

Ultimately, vehicles should not have left site without the necessary checks and actions taken to prevent mud and debris from being deposited onto the main highway.

Although action was taken immediately the incident could have been prevented and I would expect in future that all procedures will be followed in line with the site permit, EMS and Mud Management Plan.

The 2013 waste returns submitted have been reviewed and I am pleased to say that on this occasion no issues were apparent.

Please keep me informed of activities on site.

regards
Rachel Twiss

In this document, 'Natural Resources Wales' means the Natural Resources Body for Wales established by Article 3 of the Natural Resources Body for Wales (Establishment) Order 2012

	EPR Compliance Assessment Report	Report ID: 37050/0214873
This form will report compliance with your permit as determined by an NRW officer		
Site	Bryn Y Gaer Quarry	Permit 37050
Operator/ Permit	Ash Waste Services Ltd	Date 30/06/2014

Section 3- Enforcement Response	Only one of the boxes below should be ticked
You must take immediate action to rectify any non-compliance and prevent repetition. Non-compliance with your permit conditions constitutes an offence and can result in criminal prosecutions and/or suspension or revocation of a permit. Please read the detailed assessment in Section 2 and the steps you need to take in Section 4 below.	
Other than the provision of advice and guidance, at present we do not intend to take further enforcement action in respect of the non-compliance identified above. This does not preclude us from taking enforcement action if further relevant information comes to light or advice isn't followed.	<input type="checkbox"/>
In respect of the above non-compliance you have been issued with a warning. At present we do not intend to take further enforcement action. This does not preclude us from taking additional enforcement action if further relevant information comes to light or offences continue.	<input checked="" type="checkbox"/>
We will now consider what enforcement action is appropriate and notify you, referencing this form.	

Section 4- Action(s)			
Where non-compliance has been detected and an enforcement response has been selected above, this section summarises the steps you need to take to return to compliance and also provides timescales for this to be done.			
Criteria Ref.	CCS Category	Action Required/Advised	Due Date
See Section 1 above			
C2	C3	Ensure the control measures outlined in the permit, working plan/EMS and the mud management plan are implemented as required	Immediately
F5	C3	Prevent mud and debris deposits on the road	Immediately

Section 5 - Compliance notes for the Operator

To ensure you correct actual or potential non-compliance we may

- advise on corrective actions verbally or in writing
- require you to take specific actions in writing
- issue a notice
- require you to review your procedures or management system
- change some of the conditions of your permit
- decide to undertake a full review of your permit

Any breach of a permit condition is an offence and we may take legal action against you.

● We will normally provide advice and guidance to assist you to come back into compliance either after an offence is committed or where we consider that an offence is likely to be committed. This is without prejudice to any other enforcement response that we consider may be required.

● Enforcement action can include the issue of a formal caution, prosecution, the service of a notice and or suspension or revocation of the permit.

See our Enforcement and Civil Sanctions guidance for further information

This report does not relieve the site operator of the responsibility to

- ensure you comply with the conditions of the permit at all times and prevent pollution of the environment
- ensure you comply with other legislative provisions which may apply.

Non-compliance scores and categories

CCS category	Description	Score
C1	A non-compliance which could have a major environmental effect	60
C2	A non-compliance which could have a significant environmental effect	31
C3	A non-compliance which could have a minor environmental effect	4
C4	A non-compliance which has no potential environmental effect	0.1

Operational Risk Appraisal (Opra) - Compliance assessment findings may affect your Opra score and/or your charges. This score influences the resource we use to assess permit compliance.

Section 6 – General Information

Data protection notice

The information on this form will be processed by the Natural Resources Wales (NRW) to fulfill its regulatory and monitoring functions and to maintain the relevant public register(s). The NRW may also use and/or disclose it in connection with:

- offering/providing you with its literature/services relating to environmental matters
- consulting with the public, public bodies and other organisations (e.g. Health and Safety Executive, local authorities) on environmental issues
- carrying out statistical analysis, research and development on environmental issues
- providing public register information to enquirers
- investigating possible breaches of environmental law and taking any resulting action
- preventing breaches of environmental law
- assessing customer service satisfaction and improving its service
- Freedom of Information Act/Environmental Information Regulations request.

The NRW may pass it on to its agents/representatives to do these things on its behalf. You should ensure that any persons named on this form are informed of the contents of this data protection notice.

Disclosure of information

The NRW will provide a copy of this report to the public register(s). However, if you consider that any information contained in this report should not be released to the public register(s) on the grounds of commercial confidentiality, you must write to your local area office within twenty working days of receipt of this form indicating which information it concerns and why it should not be released, giving your reasons in full.

Customer charter

What can I do if I disagree with this compliance assessment report?

If you are unable to resolve the issue with your site officer, you should firstly discuss the matter with the officer's line managers. If you wish to raise your dispute further through our official Complaints and Commendations procedure, phone our general enquiry number 0300 065 3000 (Mon to Fri 08.00–18.00) and ask for the Customer Contact team or send an email to enquiries@naturalresourceswales.gov.uk. If you are still dissatisfied you can make a complaint to the Public Services Ombudsman for Wales. For advice on how to complain to the Ombudsman phone their helpline on 0845 607 0987.

Appendix V

Gas Monitoring Data



BRYN-Y-GAER LANDFILL **MONTHLY GAS MONITORING**

BOREHOLE NUMBER	CH4 %	CO2 %	O2 %
1	Overgrown-----		
2	0.0	0.0	20.5
3	0.0	0.4	20.1
4	0.0	1.1	19.5
5	0.0	0.6	19.9
6	0.0	0.2	20.2
7	Destroyed by site works -----		
8	0.1	0.2	20.1
9	Destroyed by site works -----		
10	Destroyed by site works -----		
11	Destroyed by site works -----		
12	Overgrown-----		
13	Destroyed by site works -----		
14	Destroyed by site works -----		
15	Destroyed by site works -----		
16	Destroyed by site works -----		
17	Destroyed by site works -----		
18	0.2	0.2	20.0
19	0.1	0.2	20.1
20	0.0	0.0	20.6

DATE: 12/07/2011 ATMOSPHERIC PRESSURE: 1007 mB

MONITORED BY: Matthew Kirk

Monitored on behalf of
ASH Waste Services
 by ASH Resource Management Ltd
 Broughton Mill Road
 Bretton
 Flintshire
 CH4 0BY

Registered office:
 1 Abbots Quay
 Monks Ferry
 Birkenhead
 Merseyside CH41 5LH
 ASH Waste Services Limited
 Registered in England no 04691923

Instrument GA2000 Plus
 Calibration Due 23/07/2011
 Serial Number GA12182

Weather Dry / Overcast
 Cloud Cover 100%
 Ground Conditions Damp
 Air Temperature 17 degrees C
 Monitored from 0945 - 1030 hrs



BRYN-Y-GAER LANDFILL **MONTHLY GAS MONITORING**

BOREHOLE NUMBER	CH4 %	CO2 %	O2 %
1	Overgrown-----		
2	0.0	0.0	20.4
3	0.0	0.0	20.4
4	0.0	0.8	20.1
5	0.0	0.0	20.2
6	0.0	0.1	20.2
7	Destroyed by site works -----		
8	0.0	0.0	20.4
9	Destroyed by site works -----		
10	Destroyed by site works -----		
11	Destroyed by site works -----		
12	Overgrown-----		
13	Destroyed by site works -----		
14	Destroyed by site works -----		
15	Destroyed by site works -----		
16	Destroyed by site works -----		
17	Destroyed by site works -----		
18	0.0	0.1	20.3
19	0.0	0.0	20.5
20	0.0	0.0	20.5

DATE: 27/12/2011 ATMOSPHERIC PRESSURE: 1027 mB

MONITORED BY: Matthew Kirk

Monitored on behalf of
ASH Waste Services
 by ASH Resource Management Ltd
 Broughton Mill Road
 Bretton
 Flintshire
 CH4 0BY

Registered office:

1 Abbotts Quay
 Monks Ferry
 Birkenhead
 Merseyside CH41 5LH
 ASH Waste Services Limited
 Registered in England no 04691923

Instrument GA2000
 Calibration Due 01/01/2012
 Serial Number GA05929

Weather Dry / Patch Cloud
 Cloud Cover 60%
 Ground Conditions Damp
 Air Temperature 10 degrees C
 Monitored from 1125 - 1215 hrs

Oaktree Environmental Ltd

LANDFILL GAS MONITORING REPORT

Report No. GMBG01

SITE: Bryn Y Gaer

CLIENT: ASH Waste Services Ltd.

Date of monitoring exercise: 15 August 2012

Monitoring carried out by: AC

Instrument used: Geotechnical Instruments GA2000 - Serial No. GA05929

Borehole No.	Time	Water level readings			Gas composition					
		Borehole Depth - metres	Dip to water - metres	Water depth - metres	Methane		Carbon Dioxide	Oxygen	H ₂ S	CO
					% v/v	% LEL	% v/v	% v/v	ppm	ppm
2 (gas)	09:50				0.1	2	2.2	16.2		
3 (gas)	10:00				0.1	2	4.2	12.2		
4 (gas)	10:10	2.4			0.1	2	4.5	10.8		
5 (gas)	10:20				0.1	2	4.9	11.5		
20 (gas)	10:30				0.1	1	0.2	18.1		

Meteorological data		Site condition/notes
Ambient temperature - °C	17	Heavy Rain during sampling. Borehole 1 and 6-19 have either been destroyed by site works or were overgrown with weeds and could not be located.
Atmospheric pressure - mBar	998.98	
Atmospheric pressure trend - previous 24 hours	Falling Rapidly	
Wind speed - kmph	23	
Wind direction	South	
Cloud cover	100%	

Oaktree Environmental Ltd

LANDFILL GAS MONITORING REPORT

Report No. GMBG01

SITE: Bryn Y Gaer, LL12 9SB

CLIENT: ASH Waste Services Ltd.

Date of monitoring exercise: 05 December 2012

Monitoring carried out by: AC

Instrument used: Geotechnical Instruments GA2000 - Serial No. GA05929

Borehole No.	Time	Water level readings			Gas composition					
		Borehole Depth - metres	Dip to water - metres	Water depth - metres	Methane		Carbon Dioxide	Oxygen	H ₂ S	CO
					% v/v	% LEL	% v/v	% v/v	ppm	ppm
2 (gas)	10:35	3	1.7	1.3	00.3	006	00.1	18.3		
3 (gas)	10:40				00.3	005	00.1	18.3		
4 (gas)	10:45	2.2			00.3	005	00.2	18.2		
5 (gas)	10:50		14.8		00.3	005	00.6	17.8		
20 (gas)	11:10	3.8			00.3	005	00.1	18.8		

Meteorological data		Site condition/notes
Ambient temperature - °C	3	Borehole 1 and 6-19 have either been destroyed by site works or were overgrown with weeds and could not be located. Borehole 3 blocked. Boreholes 5 & 20 now at ground level only as pipes are missing.
Atmospheric pressure - mBar	1009	
Atmospheric pressure trend - previous 24 hours	Rising	
Wind speed - kmph	13	
Wind direction	From NW	
Cloud cover	50%	

Oaktree Environmental Ltd

LANDFILL GAS MONITORING REPORT

Report No. GMBG01

SITE: Bryn Y Gaer, LL12 9SB

CLIENT: ASH Waste Services Ltd.

Date of monitoring exercise: 14th March 2014

Monitoring carried out by: JM

Instrument used: Geotechnical Instruments GA5000 - Serial No. G501821

Borehole No.	Time	Water level readings			Gas composition					
		Borehole Depth - metres	Dip to water - metres	Water depth - metres	Methane		Carbon Dioxide	Oxygen	H ₂ S	CO
					% v/v	% LEL	% v/v	% v/v	ppm	ppm
2 (gas)	11:19				0.0	0.0	0.3	21.3	0	1
3 (gas)	10:35				0.0	0.0	0.7	20.5	0	1
4 (gas)	10:44				0.0	0.0	0.6	20.1	0	1
5 (gas)	10:57				0.0	0.0	2.6	17.4	0	1
20 (gas)	11:11				0.0	0.0	0.3	21.2	0	1

Meteorological data		Site condition/notes
Ambient temperature - °C	7	<p>Borehole 1 and 6-19 have either been destroyed by site works or were overgrown with weeds and could not be located.</p> <p>Borehole 3 blocked with a stone/stones.</p> <p>Boreholes 5 & 20 now at ground level only as pipes are missing.</p>
Atmospheric pressure - mBar	1014	
Atmospheric pressure trend - previous 24 hours	Rising	
Wind speed - kmph	7	
Wind direction	From NNW	
Cloud cover	75%	

Oaktree Environmental Ltd

LANDFILL GAS MONITORING REPORT

Report No. GMBG02

SITE: Bryn Y Gaer, LL12 9SB

CLIENT: ASH Waste Services Ltd.

Date of monitoring exercise: 5th Feb 2015

Monitoring carried out by: RS/JE

Instrument used: Geotechnical Instruments GA5000 - Serial No. G501821

Borehole No.	Time	Water level readings			Gas composition					
		Borehole Depth - metres	Dip to water - metres	Water depth - metres	Methane		Carbon Dioxide	Oxygen	H ₂ S	CO
					% v/v	% LEL	% v/v	% v/v	ppm	ppm
4 (gas)	10:38				0.1	0.0	0.1	21.5	0	0

Meteorological data		Site condition/notes
Ambient temperature - °C	6	Borehole 4 was the only borehole that could be located
Atmospheric pressure - mBar	1013	
Atmospheric pressure trend - previous 24 hours	Rising	
Wind speed - kmph	18	
Wind direction	From NNW	
Cloud cover	100%	