

| Scale Bars |    | TO BE USED ONLY AS GUIDANCE |    |
|------------|----|-----------------------------|----|
| 1:500      | mm | 1:1000                      | mm |
| 1:1000     | mm | 1:2000                      | mm |
| 1:1500     | mm | 1:3000                      | mm |
| 1:2000     | mm | 1:4000                      | mm |

#### NOTES

- All dimensions and levels are to be checked on site.
  - Any discrepancies are to be reported to the architect before any work commences.
  - This drawing shall not be scaled to ascertain any dimensions. Work to figured dimensions only.
  - This drawing shall not be reproduced without express written permission from AEW.
  - Title overlay drawings and ownership boundaries are produced using all reasonable endeavours. AEW cannot be responsible for the accuracy or scale discrepancy of base plans supplied to them.
  - All works are to be undertaken in accordance with Building Regulations and the latest British Standards.
  - All proprietary materials and products are to be used strictly in accordance with the manufacturers recommendations.
- This drawing contains the following model files: -
- 12500-AEW-B1-XX-M3-A-0001

#### CDM 2015

Client notified of duties: **YES**

Principal Designer: **ICT**

Unless noted below, all known hazards have been highlighted on the drawing.

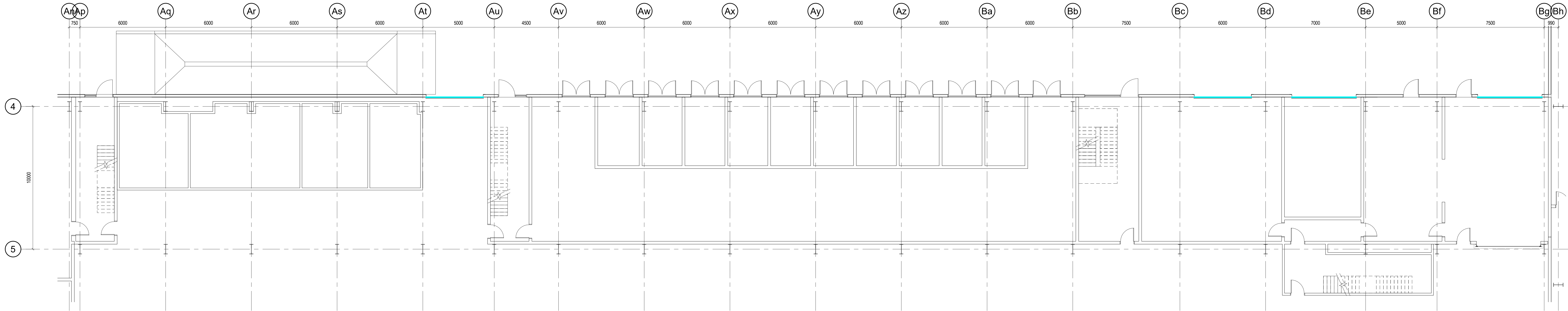

PM Offices & Lockers - Ground Floor

Scale @ 1 : 100

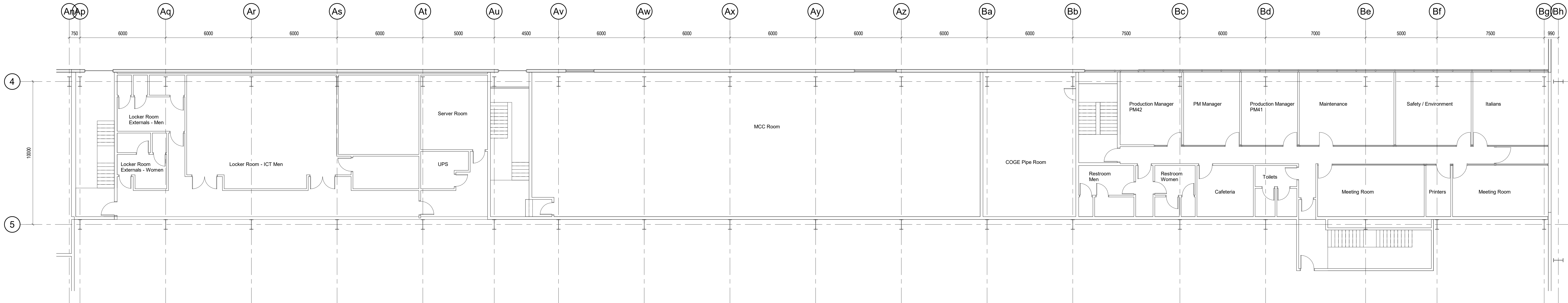

PM Offices & Lockers - First Floor

Scale @ 1 : 100

| P02 |      | 20/09/21     |       | ISSUED FOR APPROVAL |    | MB |    | DOH |    |
|-----|------|--------------|-------|---------------------|----|----|----|-----|----|
| Rev | Date | Description  | Drawn | Checked             | By | By | By | By  | By |
| S2  |      | For Approval |       |                     |    |    |    |     |    |

drawing stage: **Stage 3**

client:

**ICT**

project:

**ICT Paper Mill**

**Deeside**

drawing title:

**Process Zone 3 - PM Offices & Locker**

**Areas Typical Layout**

date: 08/02/21 drawn: TF

scale @ A0: 1 : 100 checked: DOH

Rev

P02

12500-AEW-B1-XX-DR-A-0543

Drawn By

aew architects  
0161 214 4370  
www.aewarchitects.com

aew