

Existing Site Plan - 1:5000@A1

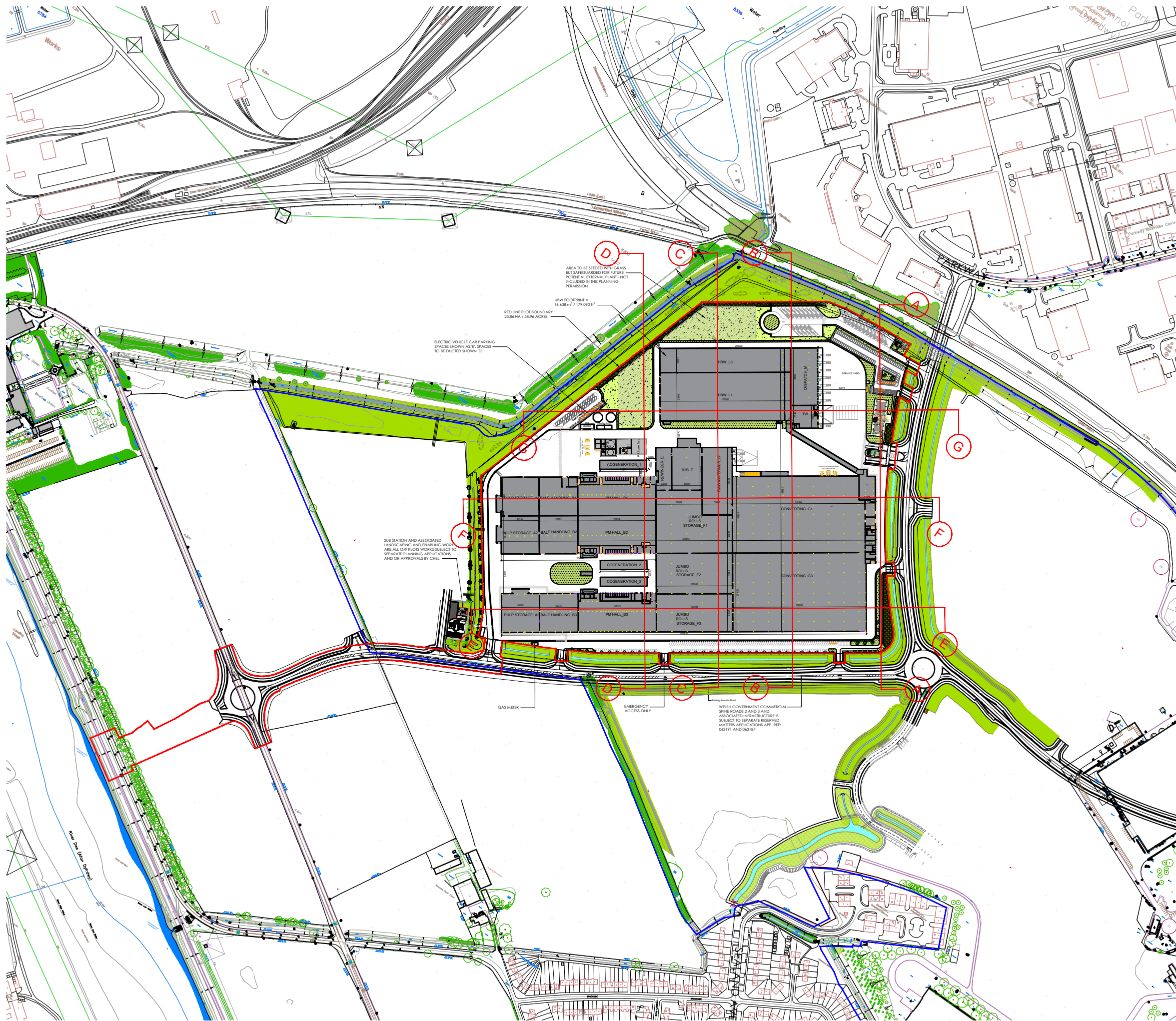

Proposed Site Plan - 1:5000@A1

NOTES AEWTP026C

- All dimensions and levels are to be checked on site.
- Any discrepancies are to be reported to the architect before any work commences
- This drawing shall not be scaled to ascertain any dimensions. Work to figured dimensions only.
- This drawing shall not be reproduced without express written permission from AEW.
- Title overlay drawings and ownership boundaries are produced using all reasonable endeavors. AEW cannot be responsible for the accuracy or scale discrepancy of base plans supplied to them.
- All works are to be undertaken in accordance with Building Regulations and the latest British Standards.
- All proprietary materials and products are to be used strictly in accordance with the manufacturers recommendations.

CDM 2015

Client notified of duties:

Principal Designer:

Unless noted below, all known hazards have been highlighted on the drawing:

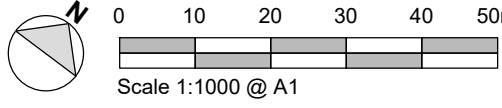

Notes:

Refer to GA Building Sections for detail:

- 12500-AEW-B1-XX-DR-A-0536-P03-Process Buildings - Proposed GA Sections - Phase 1, 2 & 3
- 12500-AEW-B1-XX-DR-A-0571-P02-Process Zone 1 - Proposed GA Sections
- 12500-AEW-B1-XX-DR-A-0572-P02-Process Zone 2 - Proposed GA Sections
- 12500-AEW-B1-XX-DR-A-0573-P02-Process Zone 3 - Proposed GA Sections
- 12500-AEW-B1-XX-DR-A-0574-P02-Process Zone 4 - Proposed GA Sections

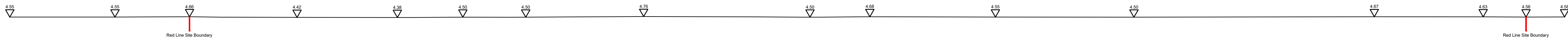

Existing Site Section E - 1:1000@A1

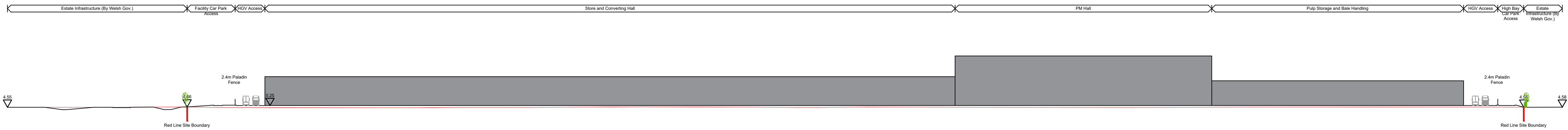

Proposed Site Section E - 1:1000@A1

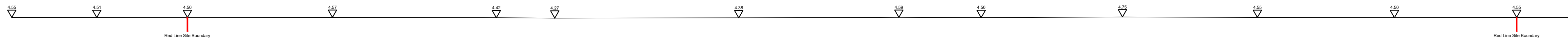

Existing Site Section F - 1:1000@A1

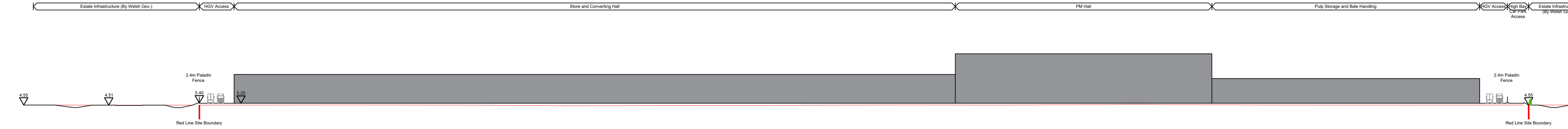

Proposed Site Section F - 1:1000@A1

P2	17/09/2021	MB	DOH
Updated based on Client comments			
P1	03/09/2021	TF/MB	DOH
Initial issue			
REV	Date	Drawn by: -	Checked by: -
Status	Purpose of Issue		
S2	For Information		
drawing stage	Stage 3		
client			

Industrie Cartarie Tronchetti SpA

project

ICT Paper Mill
Deeside

drawing title

Existing and Proposed Site Sections
Sheet 3

date	03/09/2021	drawn	TF
scale@A1	1:1250	checked	DOH

Rev

P2

Job No

12500-AEW-S1-XX-DR-A-0517

project

client

drawn

checked

TF

DOH

ae-w

ae-w architects

0161 214 4370

www.aewarchitects.com