

# EPR/DP3599FS Conditions

## 1 Management

### 1.1 General management

- 1.1.1 The activities shall be managed and operated:
- (a) in accordance with a management system, which identifies and minimises risks of pollution, including those arising from operations, maintenance, accidents, incidents, non-conformances and closure and those drawn to the attention of the operator as a result of complaints; and
  - (b) by sufficient persons who are competent in respect of the responsibilities to be undertaken by them in connection with the operation of the activities.
- 1.1.2 Records demonstrating compliance with condition 1.1.1 shall be maintained.
- 1.1.3 Any person having duties that are or may be affected by the matters set out in this permit shall have convenient access to a copy of it kept at or near the place where those duties are carried out.
- 1.1.4 The operator shall comply with the requirements of an approved competence scheme or shall hold an appropriate certificate of technical competence or other approval issued by the Agency.

### 1.2 Accident management plan

- 1.2.1 The operator shall:
- (a) maintain and implement an accident management plan;
  - (b) review and record at least every 4 years or as soon as practicable after an accident, (whichever is the earlier) whether changes to the plan should be made;
  - (c) make any appropriate changes to the plan identified by a review.

## 2 Operations

### 2.1 Permitted activities

- 2.1.1 The operator is authorised to carry out the activities specified in schedule 1 table S1.1 (the "activities").

### 2.2 The site

- 2.2.1 The activities shall not extend beyond the site, being the land shown edged in green on the site plan at schedule 2 to this permit.

## **2.3 Operating techniques**

- 2.3.1 (a) The activities shall, subject to the conditions of this permit, be operated using the techniques and in the manner described in the documentation specified in schedule 1, table S1.2, unless otherwise agreed in writing by the Agency.
- (b) If notified by the Agency that the activities are giving rise to pollution, the operator shall submit to the Agency for approval within the period specified, a revision of any plan specified in schedule 1, table S1.2 or otherwise required under this permit, and shall implement the approved revised plan in place of the original from the date of approval, unless otherwise agreed in writing by the Agency.
- 2.3.2 Waste shall only be accepted if:
- (a) it is of a type and quantity listed in schedule 3 tables S3.1, S3.2; and
- (b) except for household waste accepted from householders, it conforms to the description in the documentation supplied by the producer and holder.

## **3 Emissions and monitoring**

### **3.1 Fugitive emissions of substances**

- 3.1.1 Fugitive emissions of substances (excluding odour, noise and vibration) shall not cause pollution. The operator shall not be taken to have breached this condition if appropriate measures, including, but not limited to, those specified in any approved fugitive emissions management plan, have been taken to prevent or where that is not practicable, to minimise, those emissions.
- 3.1.2 All liquids, whose emission to water or land could cause pollution, shall be provided with secondary containment, unless the operator has used other appropriate measures to prevent or where that is not practicable, to minimise, leakage and spillage from the primary container.

### **3.2 Odour**

- 3.2.1 Emissions from the activities shall be free from odour at levels likely to cause pollution outside the site, as perceived by an authorised officer of the Agency, unless the operator has used appropriate measures, including, but not limited to, those specified in any approved odour management plan, to prevent or where that is not practicable to minimise the odour.

### **3.3 Noise and vibration**

- 3.3.1 Emissions from the activities shall be free from noise and vibration at levels likely to cause pollution outside the site, as perceived by an authorised officer of the Agency, unless the operator has used appropriate measures, including, but not limited to, those specified in any approved noise and vibration management plan to prevent or where that is not practicable to minimise the noise and vibration.

## **4 Information**

### **4.1 Records**

4.1.1 All records required to be made by this permit shall:

- (a) be legible;
- (b) be made as soon as reasonably practicable;
- (c) if amended, be amended in such a way that the original and any subsequent amendments remain legible, or are capable of retrieval; and
- (d) be retained, unless otherwise agreed in writing by the Agency, for at least 6 years from the date when the records were made, or in the case of the following records until permit surrender:
  - (i) off-site environmental effects; and
  - (ii) matters which affect the condition of the land and groundwater.

4.1.2 All records, plans and the management system required to be maintained by this permit shall be held on the site where practicable, or other location agreed in writing and controlled by the operator.

### **4.2 Reporting**

4.2.1 All reports and notifications required by the permit shall be sent to the Agency using the contact details supplied in writing by the Agency.

4.2.2 Within 1 month of the end of each quarter, the operator shall submit to the Agency using the form made available for the purpose, the information specified on the form relating to the site and the waste accepted and removed from it during the previous quarter.

### **4.3 Notifications**

4.3.1 The Agency shall be notified without delay following the detection of:

- (a) any malfunction, breakdown or failure of equipment or techniques, accident, or fugitive emission which has caused, is causing or may cause significant pollution;
- (b) the breach of a limit specified in the permit; or
- (c) any significant adverse environmental effects.

4.3.2 Any information provided under condition 4.3.1 shall be confirmed by sending the information listed in schedule 6 to this permit within the time period specified in that schedule.

4.3.3 Where the Agency has requested in writing that it shall be notified when the operator is to undertake monitoring and/or spot sampling, the operator shall inform the Agency when the relevant monitoring is to take place. The operator shall provide this information to the Agency at least 14 days before the date the monitoring is to be undertaken.

4.3.4 The Agency shall be notified within 14 days of the occurrence of the following matters, except where such disclosure is prohibited by Stock Exchange rules:

Where the operator is a registered company:

- (a) any change in the operator's trading name, registered name or registered office address; and
- (b) any steps taken with a view to the operator going into administration, entering into a company voluntary arrangement or being wound up.

Where the operator is a corporate body other than a registered company:

- (a) any change in the operator's name or address; and
- (b) any steps taken with a view to the dissolution of the operator.

In any other case:

- (a) the death of any of the named operators (where the operator consists of more than one named individual);
- (b) any change in the operator's name(s) or address (es); and
- (c) any steps taken with a view to the operator, or any one of them, going into bankruptcy, entering into a composition or arrangement with creditors, or, in the case of them being in a partnership, dissolving the partnership.

4.3.5 Where the operator proposes to make a change in the nature or functioning, or an extension of the activities, which may have consequences for the environment and the change is not otherwise the subject of an application for approval under the Regulations or this permit:

- (a) the Agency shall be notified at least 14 days before making the change; and
- (b) the notification shall contain a description of the proposed change in operation.

## **4.4 Interpretation**

4.4.1 In this permit the expressions listed in schedule 7 shall have the meaning given in that schedule.

4.4.2 In this permit references to reports and notifications mean written reports and notifications, except where reference is made to notification being made "without delay", in which case it may be provided by telephone.

# Schedule 1 - Operations

Table S1.1 activities	
Description of activities for waste operations	Limits of activities
<p><b>D15:</b> Storage pending any of the operations numbered D1 to D14 (excluding temporary storage, pending collection, on the site where it is produced)</p> <p><b>D9:</b> Physico-chemical treatment not specified elsewhere in Annex IIA which results in final compounds or mixtures which are discarded by means of any of the operations numbered D1 to D8 and D10 to D12.</p> <p><b>R13:</b> Storage of wastes pending any of the operations numbered R1 to R12 (excluding temporary storage, pending collection, on the site where it is produced)</p> <p><b>R3:</b> Recycling/reclamation or organic substances which are not used as solvents</p> <p><b>R4:</b> Recycling/reclamation of metals and metal compounds</p> <p><b>R5:</b> Recycling/reclamation of other inorganic materials</p>	<p>The maximum quantity of hazardous waste and waste oils (in aggregate) that can be accepted, stored or treated at the site in connection with a disposal operation shall not exceed 10 tonnes per day.</p> <p>Treatment consisting only of manual sorting or manual separation of non-hazardous waste into different components for disposal (no more than 50 tonnes per day) or recovery.</p> <p>There shall be no treatment of asbestos waste.</p> <p>There shall be no treatment of WEEE.</p> <p>No more than a total of 50 tonnes of intact waste vehicle tyres (waste codes 16 01 03 and 19 12 04) shall be stored at the site.</p> <p>All wastes shall be stored and treated on an impermeable surface with sealed drainage system.</p> <p>Lead acid batteries shall be stored in containers with an impermeable, acid resistant base and a cover to prevent ingress of water.</p>

Table S1.2 Operating techniques		
Description	Parts	Date Received
Operational Techniques and Monitoring Plan, dated June 2009 and submitted with Variation Application EPR/DP3599FS/V003	Sections 1, 2, 3, 4, 5, 6 and 7. Excluding all references to the treatment of WEEE.	21/09/09
Odour risk assessment and management plan, dated June 2009 and submitted with Variation Application EPR/DP3599FS/V003	All	21/09/09
Noise risk assessment and management plan, dated June 2009 and submitted with Variation Application EPR/DP3599FS/V003	All	21/09/09
Fugitive emissions risk assessment and management plan, dated June 2009 and submitted with Variation Application EPR/DP3599FS/V003	All	21/09/09
Accident risk assessment and management plan, dated June 2009 and submitted with Variation Application EPR/DP3599FS/V003	All	21/09/09

## Schedule 2 - Site plan

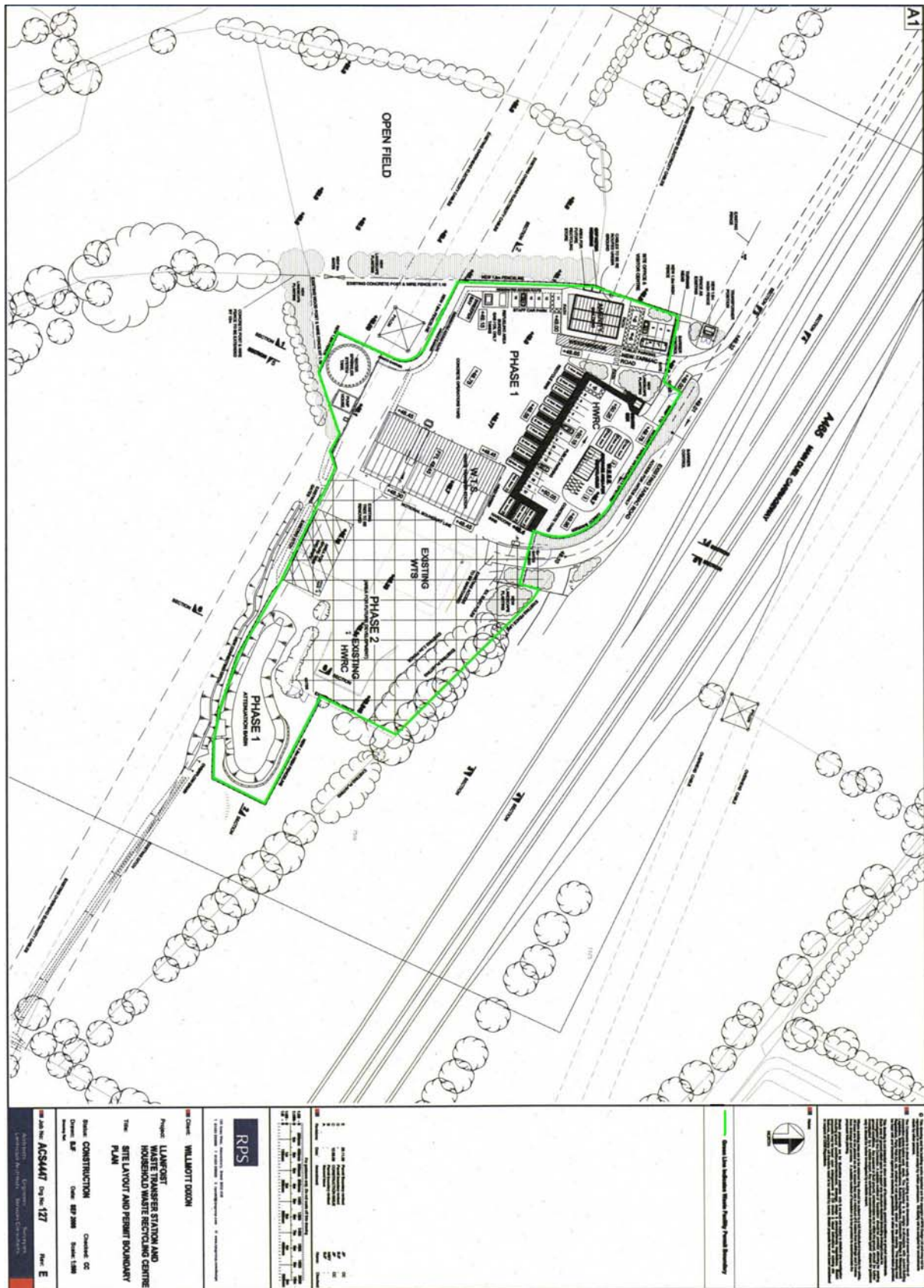

## Schedule 3 - Waste types, raw materials and fuels

<b>Table S3.1 Permitted waste types and quantities for waste transfer station.</b>	
<b>Maximum quantity</b>	30,000 tonnes per annum
<b>Exclusions</b>	Wastes having any of the following characteristics shall not be accepted: <ul style="list-style-type: none"> <li>• Consisting solely or mainly of dusts, powders or loose fibres</li> <li>• Wastes that are in a form which is either sludge or liquid</li> </ul>
<b>Waste code</b>	<b>Description</b>
<b>01</b>	<b>WASTES RESULTING FROM EXPLORATION, MINING, QUARRYING, PHYSICAL AND CHEMICAL TREATMENT OF MINERALS</b>
01 01	wastes from mineral extraction
01 01 01	wastes from mineral metalliferous excavation
01 01 02	wastes from mineral non-metalliferous excavation
01 03	wastes from physical and chemical processing of metalliferous minerals
01 03 06	tailings other than those mentioned in 01 03 04 and 01 03 05
01 03 09	red mud from alumina production other than the wastes mentioned in 01 03 07
01 04	wastes from physical and chemical processing of non-metalliferous minerals
01 04 08	waste gravel and crushed rocks other than those mentioned in 01 04 07
01 04 09	waste sand and clays
01 04 11	wastes from potash and rock salt processing other than those mentioned in 01 04 07
01 04 12	tailings and other wastes from washing and cleaning of minerals other than those mentioned in 01 04 07 and 01 04 11
01 04 13	wastes from stone cutting and sawing other than those mentioned in 01 04 07
<b>02</b>	<b>WASTES FROM AGRICULTURE, HORTICULTURE, AQUACULTURE, FORESTRY, HUNTING AND FISHING, FOOD PREPARATION AND PROCESSING</b>
02 01	wastes from agriculture, horticulture, aquaculture, forestry, hunting and fishing
02 01 03	plant tissue waste
02 01 04	waste plastics (except packaging)
02 01 07	wastes from forestry
02 01 10	waste metal
02 02	wastes from the preparation and processing of meat, fish and other foods of animal origin
02 02 03	materials unsuitable for consumption or processing
02 03	wastes from fruit, vegetables, cereals, edible oils, cocoa, coffee, tea and tobacco preparation and processing; conserve production; yeast and yeast extract production, molasses preparation and fermentation
02 03 04	materials unsuitable for consumption or processing
02 04	wastes from sugar processing
02 04 01	soil from cleaning and washing beet

<b>Table S3.1 Permitted waste types and quantities for waste transfer station.</b>	
<b>Maximum quantity</b>	30,000 tonnes per annum
<b>Exclusions</b>	Wastes having any of the following characteristics shall not be accepted: <ul style="list-style-type: none"> <li>• Consisting solely or mainly of dusts, powders or loose fibres</li> <li>• Wastes that are in a form which is either sludge or liquid</li> </ul>
<b>Waste code</b>	<b>Description</b>
02 04 02	off-specification calcium carbonate
02 05	wastes from the dairy products industry
02 05 01	materials unsuitable for consumption or processing
02 06	wastes from the baking and confectionary industry
02 06 01	materials unsuitable for consumption or processing
02 06 02	wastes from preserving agents
02 07	wastes from the production of alcoholic and non-alcoholic beverages (except coffee, tea and cocoa)
02 07 01	wastes from washing, cleaning and mechanical reduction of raw materials
02 07 02	wastes from spirits distillation
02 07 04	materials unsuitable for consumption or processing
<b>03</b>	<b>WASTES FROM WOOD PROCESSING AND THE PRODUCTION OF PANELS AND FURNITURE, PULP, PAPER AND CARDBOARD</b>
03 01	wastes from wood processing and the production of panels and furniture
03 01 01	waste bark and cork
03 01 05	sawdust, shavings, cuttings, wood, particle board and veneer other than those mentioned in 03 01 04
03 03	wastes from pulp, paper and cardboard production and processing
03 03 01	waste bark and wood
03 03 07	mechanically separated rejects from pulping of waste paper and cardboard
03 03 08	wastes from sorting of paper and cardboard destined for recycling
03 03 10	fibre rejects, fibre-, filler- and coating sludges from mechanical separation
<b>04</b>	<b>WASTES FROM THE LEATHER AND FUR INDUSTRY</b>
04 01	wastes from the leather and fur industry
04 01 08	waste tanned leather (blue sheetings, shavings, cuttings, buffing dust) containing chromium
04 01 09	wastes from dressing and finishing
04 02	wastes from the textile industry
04 02 21	wastes from unprocessed textile fibres
04 02 22	wastes from processed textile fibres
<b>06</b>	<b>WASTES FROM INORGANIC CHEMICAL PROCESSES</b>



<b>Table S3.1 Permitted waste types and quantities for waste transfer station.</b>	
<b>Maximum quantity</b>	30,000 tonnes per annum
<b>Exclusions</b>	Wastes having any of the following characteristics shall not be accepted: <ul style="list-style-type: none"> <li>• Consisting solely or mainly of dusts, powders or loose fibres</li> <li>• Wastes that are in a form which is either sludge or liquid</li> </ul>
<b>Waste code</b>	<b>Description</b>
06 09	wastes from the MSFU of phosphorous chemicals and phosphorous chemical processes
06 09 02	phosphorous slag
06 09 04	calcium-based reaction wastes other than those mentioned in 06 09 03
06 11	wastes from the manufacture of inorganic pigments and opacifiers
06 11 01	calcium-based reaction wastes from titanium dioxide production
<b>07</b>	<b>WASTES FROM ORGANIC CHEMICAL PROCESSES</b>
07 02	wastes from the MFSU of plastics, synthetic rubber and man-made fibres
07 02 13	waste plastic
<b>09</b>	<b>WASTES FROM THE PHOTOGRAPHIC INDUSTRY</b>
09 01	wastes from the photographic industry
09 01 07	photographic film and paper containing silver or silver compounds
09 01 08	photographic film and paper free of silver or silver compounds
09 01 10	single-use cameras without batteries
09 01 11*	single-use cameras containing batteries included in 16 06 01, 16 06 02 or 16 06 03
09 01 12	single-use cameras containing batteries other than those mentioned in 09 01 11
<b>10</b>	<b>WASTES FROM THERMAL PROCESSES</b>
10 01	wastes from power stations and other combustion plants (except 19)
10 01 01	bottom ash, slag and boiler dust (excluding boiler dust mentioned in 10 01 04)
10 01 05	calcium-based reaction wastes from flue-gas desulphurisation in solid form
10 01 07	calcium-based reaction wastes from flue-gas desulphurisation in sludge form
10 01 15	bottom ash, slag and boiler dust from co-incineration other than those mentioned in 10 01 14
10 01 19	wastes from gas cleaning other than those mentioned in 10 01 05, 10 01 07 and 10 01 18
10 01 24	sands from fluidised beds
10 02	wastes from the iron and steel industry
10 02 01	wastes from the processing of slag
10 02 02	unprocessed slag
10 02 08	solid wastes from gas treatment other than those mentioned in 10 02 07

<b>Table S3.1 Permitted waste types and quantities for waste transfer station.</b>	
<b>Maximum quantity</b>	30,000 tonnes per annum
<b>Exclusions</b>	Wastes having any of the following characteristics shall not be accepted: <ul style="list-style-type: none"> <li>• Consisting solely or mainly of dusts, powders or loose fibres</li> <li>• Wastes that are in a form which is either sludge or liquid</li> </ul>
<b>Waste code</b>	<b>Description</b>
10 02 10	mill scales
10 02 14	sludges and filter cakes from gas treatment other than those mentioned in 10 02 13
10 02 15	other sludges and filter cakes
10 03	wastes from aluminium thermal metallurgy
10 03 02	anode scraps
10 03 05	waste alumina
10 03 16	skimmings other than those mentioned in 10 03 15
10 03 18	carbon-containing wastes from anode manufacture other than those mentioned in 10 03 17
10 03 24	solid wastes from gas treatment other than those mentioned in 10 03 23
10 03 26	sludges and filter cakes from gas treatment other than those mentioned in 10 03 25
10 03 28	wastes from cooling-water treatment other than those mentioned in 10 03 27
10 03 30	wastes from treatment of slags and black drosses other than those mentioned in 10 03 29
10 04	wastes from lead metallurgy
10 04 10	wastes from cooling-water treatment other than those mentioned in 10 04 09
10 05	wastes from zinc thermal metallurgy
10 05 01	slags from primary and secondary production
10 05 09	wastes from cooling-water treatment other than those mentioned in 10 05 08
10 05 11	dross and skimmings other than those mentioned in 10 05 10
10 06	wastes from copper thermal metallurgy
10 06 01	slags from primary and secondary production
10 06 02	dross and skimmings from primary and secondary production
10 06 10	wastes from cooling-water other than those mentioned in 10 006 09
10 07	wastes from silver, gold and platinum thermal metallurgy
10 07 01	slags from primary and secondary production
10 07 02	dross and skimmings from primary and secondary production
10 07 03	solid wastes from gas treatment
10 07 05	sludges and filter cakes from gas treatment

<b>Table S3.1 Permitted waste types and quantities for waste transfer station.</b>	
<b>Maximum quantity</b>	30,000 tonnes per annum
<b>Exclusions</b>	Wastes having any of the following characteristics shall not be accepted: <ul style="list-style-type: none"> <li>• Consisting solely or mainly of dusts, powders or loose fibres</li> <li>• Wastes that are in a form which is either sludge or liquid</li> </ul>
<b>Waste code</b>	<b>Description</b>
10 07 08	wastes from cooling-water treatment other than those mentioned in 10 07 07
10 08	wastes from other non-ferrous thermal metallurgy
10 08 09	other slags
10 08 11	dross and skimmings other than those mentioned in 10 08 10
10 08 13	carbon-containing wastes from anode manufacture other than those mentioned in 10 08 12
10 08 14	anode scrap
10 08 18	filter cakes from flue-gas treatment other than those mentioned in 10 08 17
10 08 20	wastes from cooling-water treatment other than those mentioned in 10 08 19
10 09	wastes from casting of ferrous pieces
10 09 03	furnace slag
10 09 06	casting cores and moulds which have not undergone pouring other than those mentioned in 10 09 05
10 09 08	casting cores and moulds which have undergone pouring other than those mentioned in 10 09 07
10 09 14	waste binders other than those mentioned in 10 09 13
10 09 16	waste crack-indicating agent other than those mentioned in 10 09 15
10 10	wastes from casting of non-ferrous pieces
10 10 03	furnace slag
10 10 06	casting cores and moulds which have not undergone pouring, other than those mentioned in
10 10 08	casting cores and moulds which have undergone pouring, other than those mentioned in 10 10 07
10 10 14	waste binders other than those mentioned in 10 10 13
10 10 16	waste crack-indicating agent other than those mentioned in 10 10 15
10 11	wastes from manufacture of glass and glass products
10 11 03	waste glass-based fibrous materials
10 11 10	waste preparation mixture before thermal processing, other than those mentioned in 10 11 09
10 11 12	waste glass other than those mentioned in 10 11 11
10 11 16	solid wastes from flue-gas treatment other than those mentioned in 10 11 15
10 11 18	filter cakes from flue-gas treatment other than those mentioned in 10 11 17
10 12	wastes from manufacture of ceramic goods, bricks, tiles and construction products

<b>Table S3.1 Permitted waste types and quantities for waste transfer station.</b>	
<b>Maximum quantity</b>	30,000 tonnes per annum
<b>Exclusions</b>	Wastes having any of the following characteristics shall not be accepted: <ul style="list-style-type: none"> <li>• Consisting solely or mainly of dusts, powders or loose fibres</li> <li>• Wastes that are in a form which is either sludge or liquid</li> </ul>
<b>Waste code</b>	<b>Description</b>
10 12 01	waste preparation mixture before thermal processing
10 12 05	filter cakes from gas treatment
10 12 06	discarded moulds
10 12 08	waste ceramics, bricks, tiles and construction products (after thermal processing)
10 12 10	solid wastes from gas treatment other than those mentioned in 10.12 09
10 12 12	wastes from glazing other than those mentioned in 10.12.11
10 13	wastes from manufacture of cement, lime and plaster and articles and products made from them
10 13 01	waste preparation mixture before thermal processing
10 13 04	wastes from calcination and hydration of lime
10 13 07	filter cakes from gas treatment
10 13 10	wastes from asbestos-cement manufacture other than those mentioned in 10 13 09
10 13 11	wastes from cement-based composite materials other than those mentioned in 10 13 09 and 10 13 10
10 13 13	solid wastes from gas treatment other than those mentioned in 10 13 12
10 13 14	waste concrete
<b>11</b>	<b>WASTES FROM CHEMICAL SURFACE TREATMENT AND COATING OF METALS AND OTHER MATERIALS; NON-FERROUS HYDRO-METALLURGY</b>
11 01	wastes from chemical surface treatment and coating of metals and other materials (for example galvanic processes, zinc coating processes, pickling processes, etching, phosphatising, alkaline degreasing, anodising)
11 01 10	sludges and filter cakes other than those mentioned in 11 01 09
11 01 14	degreasing wastes other than those mentioned in 11 01 13
11 02	wastes from non-ferrous hydrometallurgical processes
11 02 03	wastes from the production of anodes for aqueous electrolytical processes
11 02 06	wastes from copper hydrometallurgical processes other than those mentioned in 11 02 05
11 05	wastes from hot galvanising processes
11 05 01	hard zinc
11 05 02	zinc ash
<b>12</b>	<b>WASTES FROM SHAPING AND PHYSICAL AND MECHANICAL SURFACE TREATMENT OF METALS AND PLASTICS</b>
12 01	wastes from shaping and physical and mechanical surface treatment of metals and plastics

<b>Table S3.1 Permitted waste types and quantities for waste transfer station.</b>	
<b>Maximum quantity</b>	30,000 tonnes per annum
<b>Exclusions</b>	Wastes having any of the following characteristics shall not be accepted: <ul style="list-style-type: none"> <li>• Consisting solely or mainly of dusts, powders or loose fibres</li> <li>• Wastes that are in a form which is either sludge or liquid</li> </ul>
<b>Waste code</b>	<b>Description</b>
12 01 01	ferrous metal filings and turnings
12 01 03	non-ferrous metal filings and turnings
12 01 05	plastics shavings and turnings
12 01 13	welding wastes
12 01 17	waste blasting materials other than those mentioned in 12 01 16
12 01 21	spent grinding bodies and grinding materials other than those mentioned in 12 01 20
<b>15</b>	<b>WASTE PACKAGING; ABSORBENTS, WIPING CLOTHS, FILTER MATERIALS AND PROTECTIVE CLOTHING NOT OTHERWISE SPECIFIED</b>
15 01	packaging (including separately collected municipal packaging waste)
15 01 01	paper and cardboard packaging
15 01 02	plastic packaging
15 01 03	wooden packaging
15 01 04	metallic packaging
15 01 05	composite packaging
15 01 06	mixed packaging
15 01 07	glass packaging
15 01 09	textile packaging
15 02	
15 02 03	absorbents, filter materials, wiping cloths and protective clothing other than those mentioned in 15 02 02
<b>16</b>	<b>WASTES NOT OTHERWISE SPECIFIED IN THE LIST</b>
16 01	end-of-life vehicles from different means of transport (including off-road machinery) and wastes from dismantling of end-of-life vehicles and vehicle maintenance (except 13, 14, 16 06 and 16 08)
16 01 03	end-of-life tyres
16 02	wastes from electrical and electronic equipment
16 02 09*	transformers and capacitors containing PCBs
16 02 10*	discarded equipment containing or contaminated by PCBs other than those mentioned in 16 02 09
16 02 12*	discarded equipment containing free asbestos
16 02 13*	discarded equipment containing hazardous components other than those mentioned in 16 02 09 to 16 02 12
16 02 14	discarded equipment other than those mentioned in 16 02 09 to 16 02 13

<b>Table S3.1 Permitted waste types and quantities for waste transfer station.</b>	
<b>Maximum quantity</b>	30,000 tonnes per annum
<b>Exclusions</b>	Wastes having any of the following characteristics shall not be accepted: <ul style="list-style-type: none"> <li>• Consisting solely or mainly of dusts, powders or loose fibres</li> <li>• Wastes that are in a form which is either sludge or liquid</li> </ul>
<b>Waste code</b>	<b>Description</b>
16 02 15*	hazardous components removed from discarded equipment
16 02 16	components removed from discarded equipment other than those mentioned in 16 02 15
16 03	off-specification batches and unused products
16 03 04	inorganic wastes other than those mentioned in 16 03 03
16 03 06	organic wastes other than those mentioned in 16 03 05
16 05	gases in pressure containers and discarded chemicals
16 05 05	gases in pressure containers other than those mentioned in 16 05 04
16 06	batteries and accumulators
16 06 01*	lead batteries
16 06 02*	Ni-Cd batteries
16 06 03*	mercury-containing batteries
16 06 04	alkaline batteries (except 16 06 03)
16 06 05	other batteries and accumulators
16 11	waste linings and refractories
16 11 02	carbon-based linings and refractories from metallurgical processes other than those mentioned in 16 11 01
16 11 04	other linings and refractories from metallurgical processes other than those mentioned in 16 11 03
16 11 06	linings and refractories from non-metallurgical processes other than those mentioned in 16 11 05
<b>17</b>	<b>CONSTRUCTION AND DEMOLITION WASTES (INCLUDING EXCAVATED SOIL FROM CONTAMINATED SITES)</b>
17 01	concrete, bricks, tiles and ceramics
17 01 01	concrete
17 01 02	bricks
17 01 03	tiles and ceramics
17 01 07	mixtures of concrete, bricks, tiles and ceramics other than those mentioned in 17 01 06
17 02	wood, glass and plastic
17 02 01	wood
17 02 02	glass
17 02 03	plastic

<b>Table S3.1 Permitted waste types and quantities for waste transfer station.</b>	
<b>Maximum quantity</b>	30,000 tonnes per annum
<b>Exclusions</b>	Wastes having any of the following characteristics shall not be accepted: <ul style="list-style-type: none"> <li>• Consisting solely or mainly of dusts, powders or loose fibres</li> <li>• Wastes that are in a form which is either sludge or liquid</li> </ul>
<b>Waste code</b>	<b>Description</b>
17 03	
17 03 02	bituminous mixtures other than those mentioned in 17 03 01
17 04	metals (including their alloys)
17 04 01	copper, bronze, brass
17 04 02	aluminium
17 04 03	lead
17 04 04	zinc
17 04 05	iron and steel
17 04 06	tin
17 04 07	mixed metals
17 04 11	cables other than those mentioned in 17 04 10
17 05	soil (including excavated soil from contaminated sites), stones and dredging spoil
17 05 04	soil and stones other than those mentioned in 17 05 03
17 05 08	track ballast other than those mentioned in 17 05 07
17 06	insulation materials and asbestos-containing construction materials
17 06 01*	insulation materials containing asbestos
17 06 04	insulation materials other than those mentioned in 17 06 01 and 17 06 03
17 06 05*	construction materials containing asbestos
17 08	gypsum-based construction material
17 08 02	gypsum-based construction materials other than those mentioned in 17 08 01
17 09	other construction and demolition wastes
17 09 04	mixed construction and demolition wastes other than those mentioned in 17 09 01, 17 09 02 and 17 09 03
19	WASTES FROM WASTE MANAGEMENT FACILITIES, OFF-SITE WASTE WATER TREATMENT PLANTS AND THE PREPARATION OF WATER INTENDED FOR HUMAN CONSUMPTION AND WATER FOR INDUSTRIAL USE
19 01	wastes from incineration or pyrolysis of waste
19 01 02	ferrous materials removed from bottom ash
19 01 12	bottom ash and slag other than those mentioned in 19 01 11
19 01 18	pyrolysis wastes other than those mentioned in 19 01 17

<b>Table S3.1 Permitted waste types and quantities for waste transfer station.</b>	
<b>Maximum quantity</b>	30,000 tonnes per annum
<b>Exclusions</b>	Wastes having any of the following characteristics shall not be accepted: <ul style="list-style-type: none"> <li>• Consisting solely or mainly of dusts, powders or loose fibres</li> <li>• Wastes that are in a form which is either sludge or liquid</li> </ul>
<b>Waste code</b>	<b>Description</b>
19 01 19	sands from fluidised beds
19 02	wastes from physico/chemical treatments of waste (including dechromatation, decyanidation, neutralisation)
19 02 03	premixed wastes composed only of non-hazardous wastes
19 02 10	combustible wastes other than those mentioned in 19 02 08 and 19 02 09
19 04	vitrified waste and wastes from vitrification
19 04 01	vitrified waste
19 05	wastes from aerobic treatment of solid wastes
19 05 01	non-composted fraction of municipal and similar wastes
19 05 02	non-composted fraction of animal and vegetable waste
19 05 03	off-specification compost
19 12	wastes from the mechanical treatment of waste (for example sorting, crushing, compacting, pelletising) not otherwise specified
19 12 01	paper and cardboard
19 12 02	ferrous metal
19 12 03	non-ferrous metal
19 12 04	plastic and rubber
19 12 05	glass
19 12 07	wood other than that mentioned in 19 12 06
19 12 08	textiles
19 12 09	mineral (for example sand, stones)
19 12 10	combustible waste (refuse derived fuel)
19 13	wastes from soil and groundwater remediation
19 13 02	solid wastes from soil remediation other than those mentioned in 19 13 01
20	MUNICIPAL WASTES (HOUSEHOLD WASTE AND SIMILAR COMMERCIAL, INDUSTRIAL AND INSTITUTIONAL WASTES) INCLUDING SEPARATELY COLLECTED FRACTIONS
20 01	separately collected fractions (except 15 01)
20 01 01	paper and cardboard
20 01 02	glass
20 01 08	biodegradable kitchen and canteen waste



<b>Table S3.1 Permitted waste types and quantities for waste transfer station.</b>	
<b>Maximum quantity</b>	30,000 tonnes per annum
<b>Exclusions</b>	Wastes having any of the following characteristics shall not be accepted: <ul style="list-style-type: none"> <li>• Consisting solely or mainly of dusts, powders or loose fibres</li> <li>• Wastes that are in a form which is either sludge or liquid</li> </ul>
<b>Waste code</b>	<b>Description</b>
20 01 10	clothes
20 01 11	textiles
20 01 21*	fluorescent tubes and other mercury-containing waste
20 01 25	edible oil and fat
20 01 28	paint, inks, adhesives and resins other than those mentioned in 20 01 27
20 01 30	detergents other than those mentioned in 20 01 29
20 01 34	batteries and accumulators other than those mentioned in 20 01 33
20 01 35*	discarded electrical and electronic equipment other than those mentioned in 20 01 21 and 20 01 23 containing hazardous components
20 01 36	discarded electrical and electronic equipment other than those mentioned in 20 01 21, 20 01 23 and 20 01 35
20 01 38	wood other than that mentioned in 20 01 37
20 01 39	plastics
20 01 40	metals
20 01 41	wastes from chimney sweeping
20 02	garden and park wastes (including cemetery waste)
20 02 01	biodegradable waste
20 02 02	soil and stones
20 02 03	other non-biodegradable wastes
20 03	other municipal wastes
20 03 01	mixed municipal waste
20 03 02	waste from markets
20 03 03	street-cleaning residues
20 03 07	bulky waste

<b>Table S3.2 Permitted waste types and quantities for household waste amenity site.</b>	
<b>Maximum quantity</b>	10,000 tonnes per annum
<b>Exclusions</b>	Wastes having any of the following characteristics shall not be accepted: • Consisting solely or mainly of dusts, powders or loose fibres
<b>Waste code</b>	<b>Description</b>
<b>09</b>	<b>WASTES FROM THE PHOTOGRAPHIC INDUSTRY</b>
09 01	wastes from the photographic industry
09 01 11*	single-use cameras containing batteries included in 16 06 01, 16 06 02 or 16 06 03
<b>13</b>	<b>OIL WASTES AND WASTES OF LIQUID FUELS (EXCEPT EDIBLE OILS, AND THOSE IN CHAPTERS 05, 12 AND 19)</b>
13 02	waste engine, gear and lubricating oils
13 02 05*	mineral-based non-chlorinated engine, gear and lubricating oils
13 02 06*	synthetic engine, gear and lubricating oils
13 02 07*	readily biodegradable engine, gear and lubricating oils
<b>16</b>	<b>WASTES NOT OTHERWISE SPECIFIED IN THE LIST</b>
16 02	wastes from electrical and electronic equipment
16 02 09*	transformers and capacitors containing PCBs
16 02 10*	discarded equipment containing or contaminated by PCBs other than those mentioned in 16 02 09
16 02 12*	discarded equipment containing free asbestos
16 02 13*	discarded equipment containing hazardous components other than those mentioned in 16 02 09 to 16 02 12
16 02 15*	hazardous components removed from discarded equipment
16 05	gases in pressure containers and discarded chemicals
16 05 05	gases in pressure containers other than those mentioned in 16 05 04
16 06	batteries and accumulators
16 06 04	alkaline batteries (except 16 06 03)
<b>17</b>	<b>CONSTRUCTION AND DEMOLITION WASTES (INCLUDING EXCAVATED SOIL FROM CONTAMINATED SITES)</b>
17 01	concrete, bricks, tiles and ceramics
17 01 01	concrete
17 01 02	bricks
17 01 03	tiles and ceramics
17 01 07	mixtures of concrete, bricks, tiles and ceramics other than those mentioned in 17 01 06
17 06	insulation materials and asbestos-containing construction materials
17 06 01*	insulating materials containing asbestos

<b>Table S3.2 Permitted waste types and quantities for household waste amenity site.</b>	
<b>Maximum quantity</b>	10,000 tonnes per annum
<b>Exclusions</b>	Wastes having any of the following characteristics shall not be accepted: • Consisting solely or mainly of dusts, powders or loose fibres
<b>Waste code</b>	<b>Description</b>
17 06 04	insulation materials other than those mentioned in 17 06 01 and 17 06 03
17 06 05*	construction materials containing asbestos
17 08	gypsum-based construction material
17 08 02	gypsum-based construction materials other than those mentioned in 17 08 01
<b>20</b>	<b>MUNICIPAL WASTES (HOUSEHOLD WASTE AND SIMILAR COMMERCIAL, INDUSTRIAL AND INSTITUTIONAL WASTES) INCLUDING SEPARATELY COLLECTED FRACTIONS</b>
20 01	separately collected fractions (except 15 01)
20 01 01	paper and cardboard
20 01 02	glass
20 01 08	biodegradable kitchen and canteen waste
20 01 10	clothes
20 01 11	textiles
20 01 13*	solvents
20 01 14*	acids
20 01 15*	alkalines
20 01 17*	photochemicals
20 01 19*	pesticides
20 01 21*	fluorescent tubes and other mercury-containing waste
20 01 23*	discarded equipment containing chlorofluorocarbons
20 01 25	edible oil and fat
20 01 26*	oil and fat other than those mentioned in 20 01 25
20 01 27*	paint, inks, adhesives and resins containing dangerous substances
20 01 28	paint, inks, adhesives and resins other than those mentioned in 20 01 27
20 01 29*	detergents containing dangerous substances
20 01 30	detergents other than those mentioned in 20 01 29
20 01 33*	batteries and accumulators included in 16 06 01, 16 06 02 or 16 06 03 and unsorted batteries and accumulators containing these batteries
20 01 34	batteries and accumulators other than those mentioned in 20 01 33
20 01 35	discarded electrical and electronic equipment other than those mentioned in 20 01 21 and 20 01 23 containing hazardous components

<b>Table S3.2 Permitted waste types and quantities for household waste amenity site.</b>	
<b>Maximum quantity</b>	10,000 tonnes per annum
<b>Exclusions</b>	Wastes having any of the following characteristics shall not be accepted: • Consisting solely or mainly of dusts, powders or loose fibres
<b>Waste code</b>	<b>Description</b>
20 01 36	discarded electrical and electronic equipment other than those mentioned in 20 01 21, 20 01 23 and 20 01 35
20 01 37*	wood containing dangerous substances
20 01 38	wood other than that mentioned in 20 01 37
20 01 39	plastics
20 01 40	metals
20 01 41	wastes from chimney sweeping
20 02	garden and park wastes (including cemetery waste)
20 02 01	biodegradable waste
20 02 02	soil and stones
20 02 03	other non-biodegradable wastes
20 03	other municipal wastes
20 03 01	mixed municipal waste
20 03 07	Bulky waste

## **Schedule 4 – Emissions and monitoring**

There are no emission limits or associated monitoring requirements.

## **Schedule 5 - Reporting**

There is no reporting under this schedule.

## Schedule 6 - Notification

These pages outline the information that the operator must provide.

Units of measurement used in information supplied under Part A and B requirements shall be appropriate to the circumstances of the emission. Where appropriate, a comparison should be made of actual emissions and authorised emission limits.

If any information is considered commercially confidential, it should be separated from non-confidential information, supplied on a separate sheet and accompanied by an application for commercial confidentiality under the provisions of the EP Regulations.

### Part A

Permit Number	
Name of operator	
Location of Facility	
Time and date of the detection	

#### **(a) Notification requirements for any malfunction, breakdown or failure of equipment or techniques, accident, or fugitive emission which has caused, is causing or may cause significant pollution**

##### **To be notified within 24 hours of detection**

Date and time of the event	
Reference or description of the location of the event	
Description of where any release into the environment took place	
Substances(s) potentially released	
Best estimate of the quantity or rate of release of substances	
Measures taken, or intended to be taken, to stop any emission	
Description of the failure or accident.	

#### **(b) Notification requirements for the breach of a limit**

##### **To be notified within 24 hours of detection unless otherwise specified below**

Emission point reference/ source	
Parameter(s)	
Limit	
Measured value and uncertainty	
Date and time of monitoring	
Measures taken, or intended to be taken, to stop the emission	

Time periods for notification following detection of a breach of a limit	
Parameter	Notification period

(c) Notification requirements for the detection of any significant adverse environmental effect	
To be notified within 24 hours of detection	
Description of where the effect on the environment was detected	
Substances(s) detected	
Concentrations of substances detected	
Date of monitoring/sampling	

## Part B - to be submitted as soon as practicable

Any more accurate information on the matters for notification under Part A.	
Measures taken, or intended to be taken, to prevent a recurrence of the incident	
Measures taken, or intended to be taken, to rectify, limit or prevent any pollution of the environment which has been or may be caused by the emission	
The dates of any unauthorised emissions from the facility in the preceding 24 months.	

<b>Name*</b>	
<b>Post</b>	
<b>Signature</b>	
<b>Date</b>	

\* authorised to sign on behalf of Dragon Waste Limited



## Schedule 7 - Interpretation

"*accident*" means an accident that may result in pollution.

"*Annex IIA*" means Annex IIA to Directive 2006/12/EC of the European Parliament and of the Council of 5 April 2006 on Waste.

"*annually*" means once every year.

"*application*" means the application for this permit, together with any additional information supplied by the operator as part of the application and any response to a notice served under Schedule 5 to the EP Regulations.

"*authorised officer*" means any person authorised by the Agency under section 108(1) of The Environment Act 1995 to exercise, in accordance with the terms of any such authorisation, any power specified in section 108(4) of that Act.

"*best available treatment, recovery and recycling techniques*" shall have the meaning given to it in the document published jointly by the Department for Environment, Food and Rural Affairs, the Welsh Assembly Government and the Scottish Executive on 27th November 2006, entitled "Guidance on Best Available Treatment, Recovery and Recycling Techniques (BATRR) and Treatment of Waste Electrical and Electronic Equipment (WEEE);

"*controlled substances*" means chlorofluorocarbons, other fully halogenated chlorofluorocarbons, halons, carbon tetrachloride, 1,1,1-trichloroethane, methyl bromide, hydrobromofluorocarbons and hydrochlorofluorocarbons listed in Annex I of Regulation (EC) No 2037/2000 of the European Parliament and of the Council of 29 June 2000 on substances that deplete the ozone layer, including their isomers, whether alone or in a mixture, and whether they are virgin, recovered, recycled or reclaimed. This definition shall not cover any controlled substance which is in a manufactured product other than a container used for the transportation or storage of that substance, or insignificant quantities of any controlled substance, originating from inadvertent or coincidental production during a manufacturing process, from unreacted feedstock, or from use as a processing agent which is present in chemical substances as trace impurities, or that is emitted during product manufacture or handling.

"*D*" means a disposal operation provided for in Annex IIA to Directive 2006/12/EC of the European Parliament and of the Council of 5 April 2006 on Waste.

"*emissions to land*", includes emissions to groundwater.

"*End-of-Life Vehicles Directive*" means Directive 2000/53/EC of the European Parliament and Council of 18 September 2000 on end-of-life vehicles.

"*EP Regulations*" means The Environmental Permitting (England and Wales) Regulations SI 2007 No.3538 and words and expressions used in this permit which are also used in the Regulations have the same meanings as in those Regulations.

"*fugitive emission*" means an emission to air, water or land from the activities from a localised or diffuse source which is not controlled by an emission or background concentration limit.

"*groundwater*" means all water, which is below the surface of the ground in the saturation zone and in direct contact with the ground or subsoil.

*"hazardous waste"* has the meaning given in the Hazardous Waste (England and Wales) Regulations 2005 No.894, the Hazardous Waste (Wales) Regulations 2005 No. 1806 (W.138), the List of Wastes (England) Regulations 2005 No.895 and the List of Wastes (Wales) Regulations 2005 No. 1820 (W.148).

*"impermeable surface"* means a surface or pavement constructed and maintained to a standard sufficient to prevent the transmission of liquids beyond the pavement surface, and should be read in conjunction with the term "sealed drainage system" (below).

*"MCERTS"* means the Environment Agency's Monitoring Certification Scheme.

*"pollution"* means emissions as a result of human activity which may—

- (a) be harmful to human health or the quality of the environment,
- (b) cause offence to a human sense,
- (c) result in damage to material property, or
- (d) impair or interfere with amenities and other legitimate uses of the environment.

*"quarter"* means a calendar year quarter commencing on 1 January, 1 April, 1 July or 1 October.

*"R"* means a recovery operation provided for in Annex IIB to Directive 2006/12/EC of the European Parliament and of the Council of 5 April 2006 on Waste.

*"sealed drainage system"* in relation to an impermeable surface, means a drainage system with impermeable components which does not leak and which will ensure that:

- (a) no liquid will run off the surface otherwise than via the system;
- (b) except where they may lawfully be discharged, all liquids entering the system are collected in a sealed sump.

*"Waste code"* means the six digit code referable to a type of waste in accordance with the List of Wastes (England) Regulations 2005, or List of Wastes (Wales) Regulations 2005, as appropriate, and in relation to hazardous waste, includes the asterisk.

*"WEEE"* means waste electrical and electronic equipment.

*"WEEE Directive"* means Directive 2002/96/EC of the European Parliament and of the Council of 27th January 2003 on waste electrical and electronic equipment (WEEE) as amended by Directive 2003/108/EC of the European Parliament and of the Council of 8th December 2003 on waste electrical and electronic equipment (WEEE).

*"year"* means calendar year commencing on 1<sup>st</sup> January.

END OF PERMIT