

EXISTING SLAB PLAN

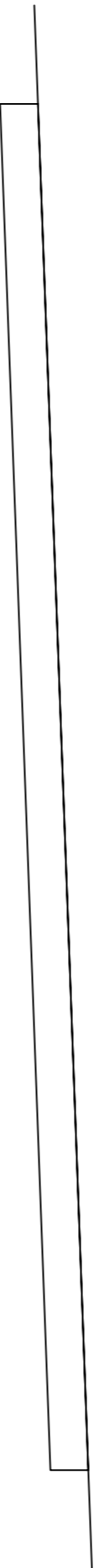

EXISTING TYPICAL SECTION

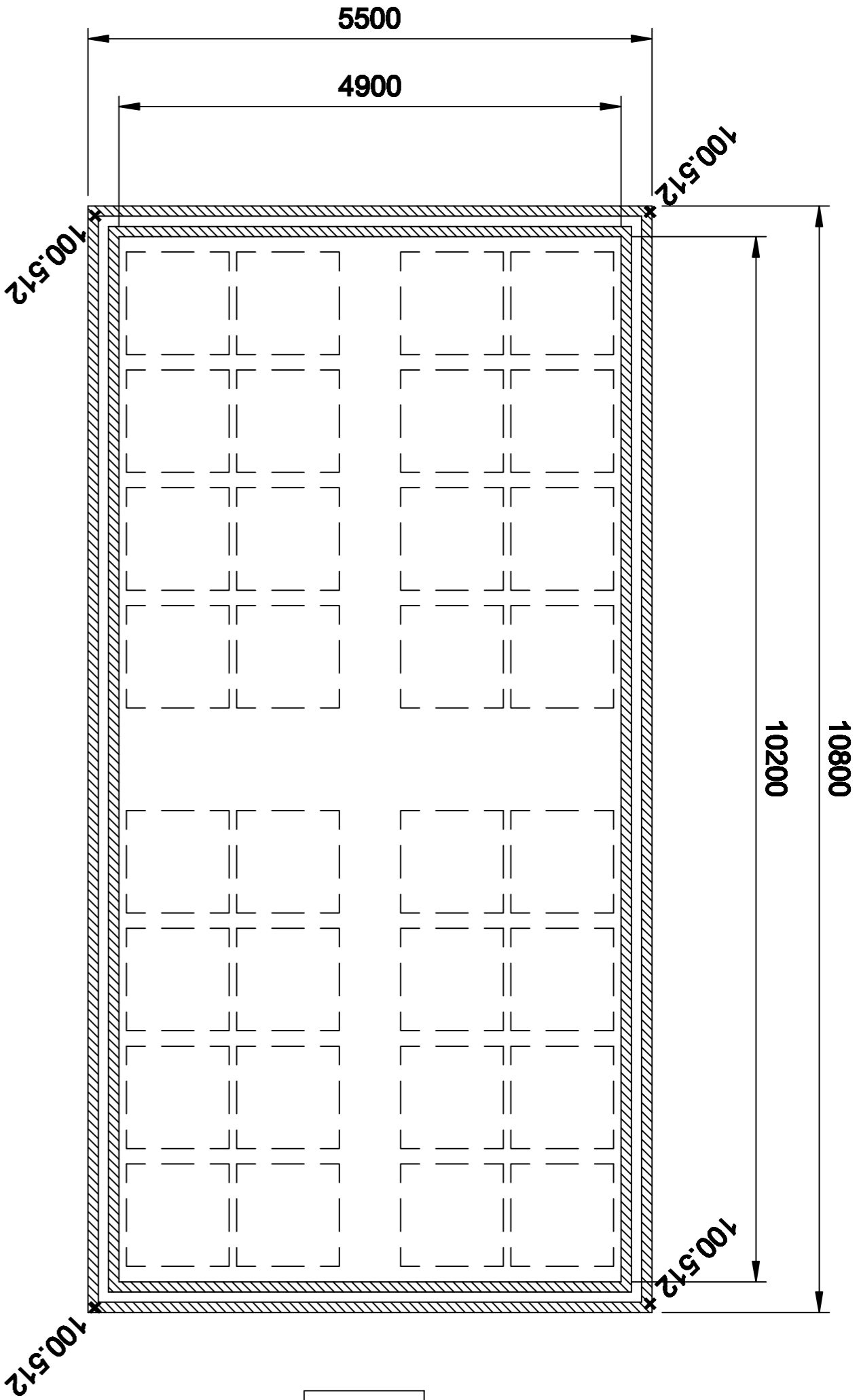

32 Containers at 0.9m3 per container = 28.8m3
Storage Area 4.9 x 10.2m = 49.98m2
Burded Volume 49.98 x 0.712m = 35.59m3

PROPOSED SLAB PLAN

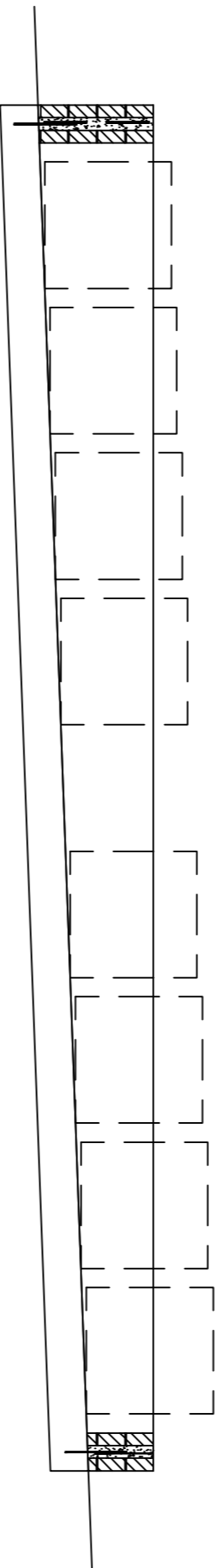

PROPOSED TYPICAL SECTION

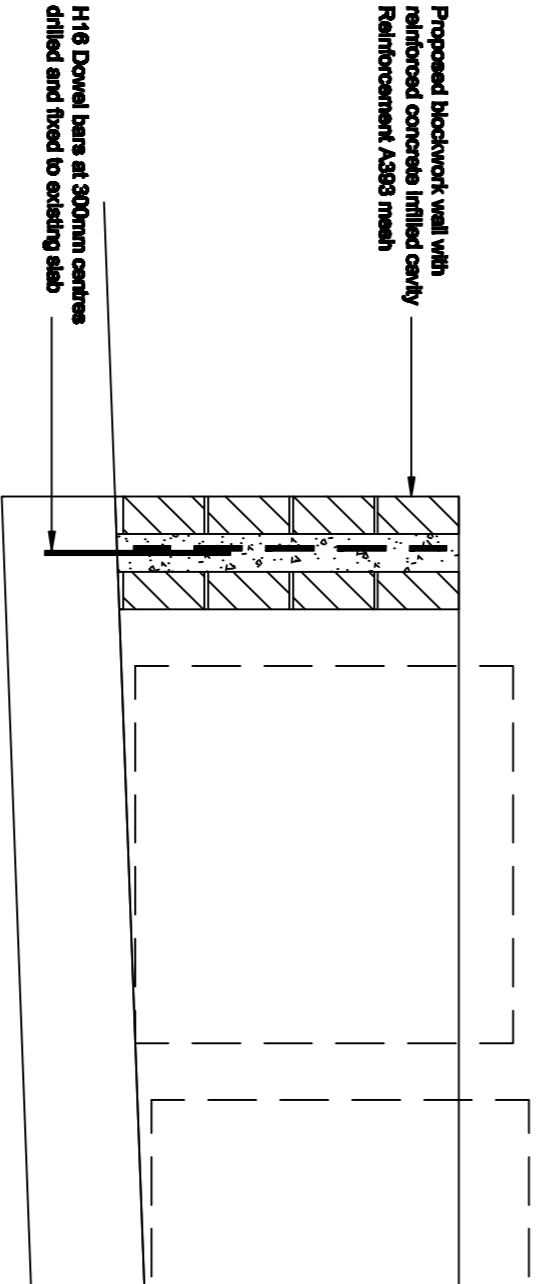

TYPICAL DETAIL