

**DOC REFERENCE**



**white's recycling ltd**

**GROSMONT LAGOON REF DOCS; WRL/GROS/**

**STORAGE LAGOON LOCATED AT:**

WOOD FARM  
GROSMONT  
ABERGAVENNY  
NP7 8LB

NGR: SO 339034 221351

**SUBMITTED BY:**

WHITES RECYCLING LTD  
THE MINE SITE  
SOUTH WITHAM  
GRANTHAM  
LINCOLNSHIRE  
NG33 5QN

**CONTACT:** Rebecca Saywood

**TELEPHONE:** 01572 767177

**EMAIL:** [Rebecca@whitesrecycling.co.uk](mailto:Rebecca@whitesrecycling.co.uk)



## Credit certificate

**This certificate determines credit awarded to:  
James Tarver**

### Units gained:

		Credit Value	Credit Level
Y6021501	Control work activities on a waste management facility	9	3
Y6015875	Monitor procedures to safely control work operations		
M6009712	Manage the environmental impact of work activities		
R6021609	Manage the reception of non hazardous waste		
A6021670	Manage the movement, sorting and storage of waste		
L6021429	Manage the transfer of outputs and disposal of residues from non hazardous waste treatment and recovery operations		

**Awarded:** 21/01/2016

**Serial No.:** 26813/WM12/1

### Authorised

**Ray Burberry**  
Qualifications Manager, WAMITAB

Regulated by

**Ofqual**

For more information see <http://register.ofqual.gov.uk>



The qualifications regulators logos on this certificate indicate that the qualification is accredited only for England, Wales and Northern Ireland.



00093592



## Credit certificate

This certificate determines credit awarded to:  
**James Tarver**

Credit Value    Credit Level

### Units gained:

Y6015875	Monitor procedures to safely control work operations	4	3
M6009712	Manage the environmental impact of work activities	5	4
R6021609	Manage the reception of non hazardous waste	7	4
A6021670	Manage the movement, sorting and storage of waste	7	3
F6021671	Manage site operations for the treatment of non hazardous waste	14	4
L6021429	Manage the transfer of outputs and disposal of residues from non hazardous waste treatment and recovery operations	13	4

**Awarded:** 21/01/2016

**Serial No.:** 26813/HSS3/1

### Authorised

**Ray Burberry**  
Qualifications Manager, WAMITAB

Regulated by

For more information see <http://register.ofqual.gov.uk>



The qualifications regulators logos on this certificate indicate that the qualification is accredited only for England, Wales and Northern Ireland.



00093593



Certificate No. OCC66527

## Operator Competence Certificate

**Title:**

**Non Hazardous transfer/with or without treatment (not otherwise specified) (4MPTNH6)**

**This Certificate is awarded to**

**James Tarver**

**Awarded: 21/01/2016**

**Authorised**

**WAMITAB Chief Executive Officer**

**CIWM Chief Executive Officer**



**The Chartered Institution  
of Wastes Management**

This certificate is jointly awarded by WAMITAB and the Chartered Institution of Wastes Management (CIWM) and provides evidence to meet the Operator Competence requirements of the Environmental Permitting (EP) Regulations, which came into force on 6 April 2008.



00093586



Certificate No. OCC66528

## Operator Competence Certificate

Title:

Mobile Plant for land spreading (land treatment resulting in benefit)  
(4MTMPL6)

This Certificate is awarded to

**James Tarver**

Awarded: 21/01/2016

Authorised

WAMITAB Chief Executive Officer

CIWM Chief Executive Officer



The Chartered Institution  
of Wastes Management

This certificate is jointly awarded by WAMITAB and the Chartered Institution of Wastes Management (CIWM) and provides evidence to meet the Operator Competence requirements of the Environmental Permitting (EP) Regulations, which came into force on 6 April 2008.



00093585



# ISO 14001 REGISTERED

This document certifies that the environmental management systems of  
**WHITES RECYCLING LTD**  
The Mine Site, Mill Lane, South Witham, Grantham NG33 5QN  
have been assessed and approved by QMS International to the  
following environmental management systems, standards and guidelines:-  
ISO 14001 : 2004

The approved environmental management systems apply to the following:-  
PROVISION OF LIQUID WASTE TANKERING, ORGANIC RECYCLING TO LAND AND  
OTHER RELATED SERVICES.

Original Approval: 15 April 2013  
Current Certificate: 15 April 2013  
Certificate Expiry: 14 April 2023  
Certificate Number: 14124484



On behalf of QMS International

This Certificate remains valid while the holder maintains their management system in accordance with the published ISO standard. To check the validity and status of this certificate please visit [www.IRQAO.com](http://www.IRQAO.com) or email [status@qmsplc.com](mailto:status@qmsplc.com)

*This Certificate is the property of QMS Worldwide Ltd and must be returned in the event of cancellation.*



Doc Ree wry/Cros/4

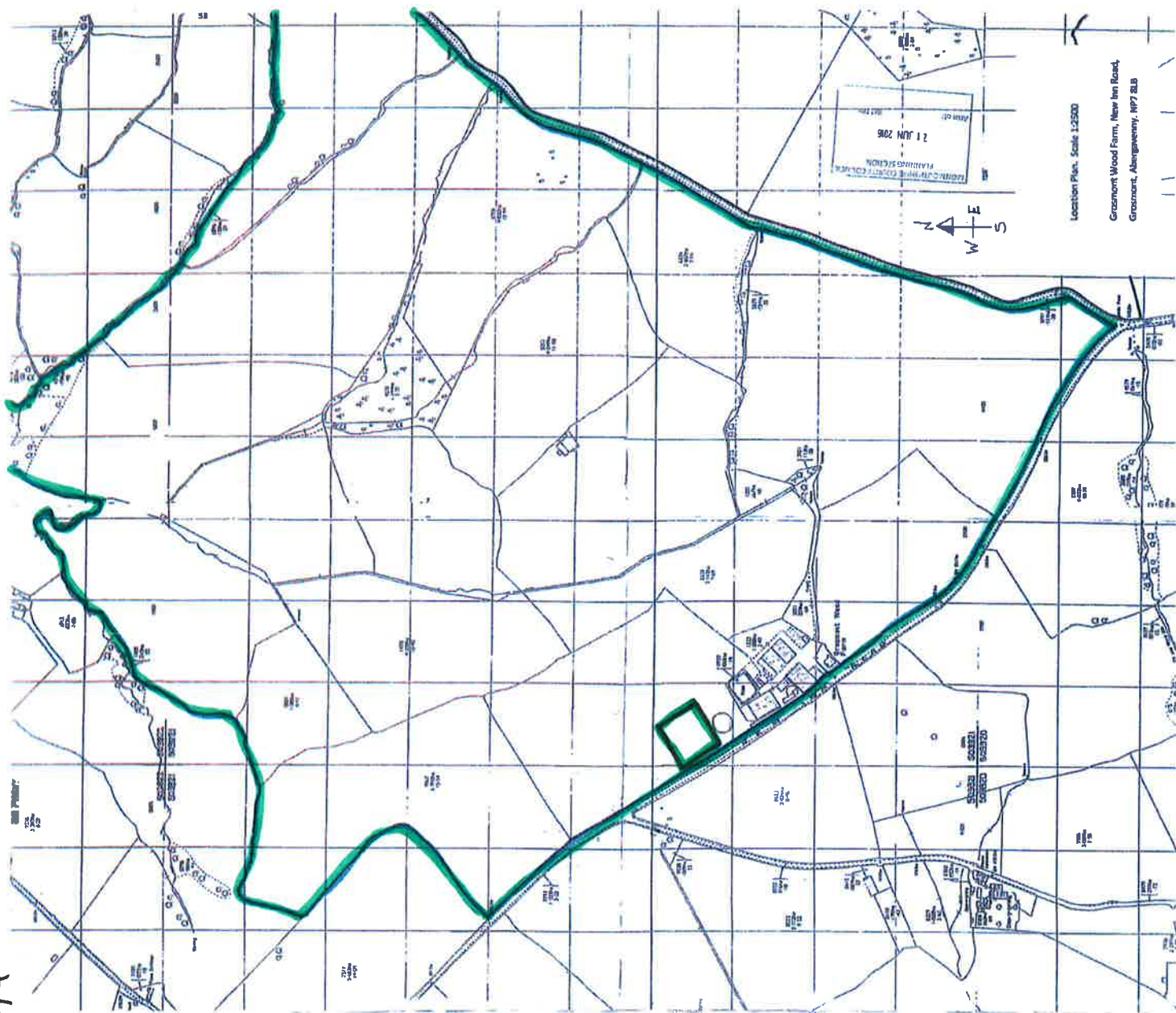

Location Plan. Scale 1:2500

Grassmont Wood Farm, New Inn Road,  
Grassmont, Abingdon, NP7 8LB

PLANNING SECTION  
21 JUN 2006  
AREA OF



AERIAL VIEW OF GROSMONT LAGOON SITE





**GROSMONT LAGOON BASELINE REPORT**

STORAGE LAGOON LOCATED AT:

WOOD FARM  
GROMONT  
ABERGAVENNY  
NP7 8LB

NGR: SO 39034 21351

Liquid organic food waste is produced from the food / drinks production industries. The spreading of these materials on to agricultural land is considered crucial to the food production industry and is recognised as one of the best options for dealing with food chain waste.

The spreading of food waste material onto agricultural land must meet a number of factors in order to adhere to the strict guidelines of an Environment Permit issued by the Natural Resources Wales. These measures ensure that the operation is carried out in a safe manner so as not to have a negative impact on the environment. Lagoon facilities are important for the storage of organic food waste material at particular times throughout the year when it is thought unsuitable to spread. Storage lagoons provide a valuable opportunity to keep the process functioning and allow landowners and sub-contractors to comply with regulations imposed on the farming community.

**1. Location & Site Description**

1.1 The site at Grosmont is located within the countryside approx. 1.6 miles from village of Cross Ash and the village of Bont is 1.9 miles away. The village of llangattock lingoed is 8 miles away

1.2 The topography of the land is typical Welsh countryside, but the proposed site is predominantly flat.

1.3 The site is within easy reach from the main road with an existing farm access available to service the lagoon.

*(1.4 - 1.7 Attached) + WRL/GROS/ 03 – 04 – 05*

1.4

Flood risk

The application site is not located within a flood risk area, as can be seen on the Natural Resources Wales Flood Map below;

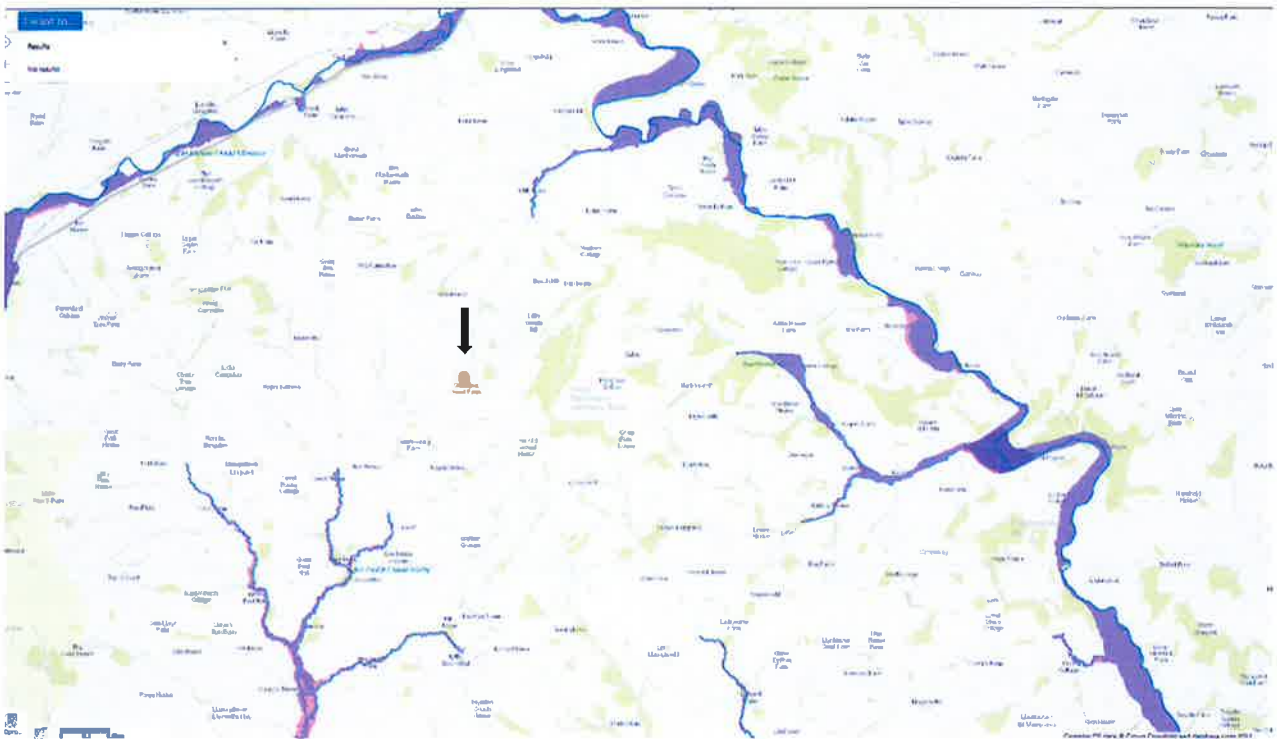

Groundwater

The site is not within a source protection zone 1 or 2.

1.5

The site is potentially within a secondary A aquifer – (Superficial Deposits)



Groundwater (Bedrock Designation)

The site is not within a principle aquifer.

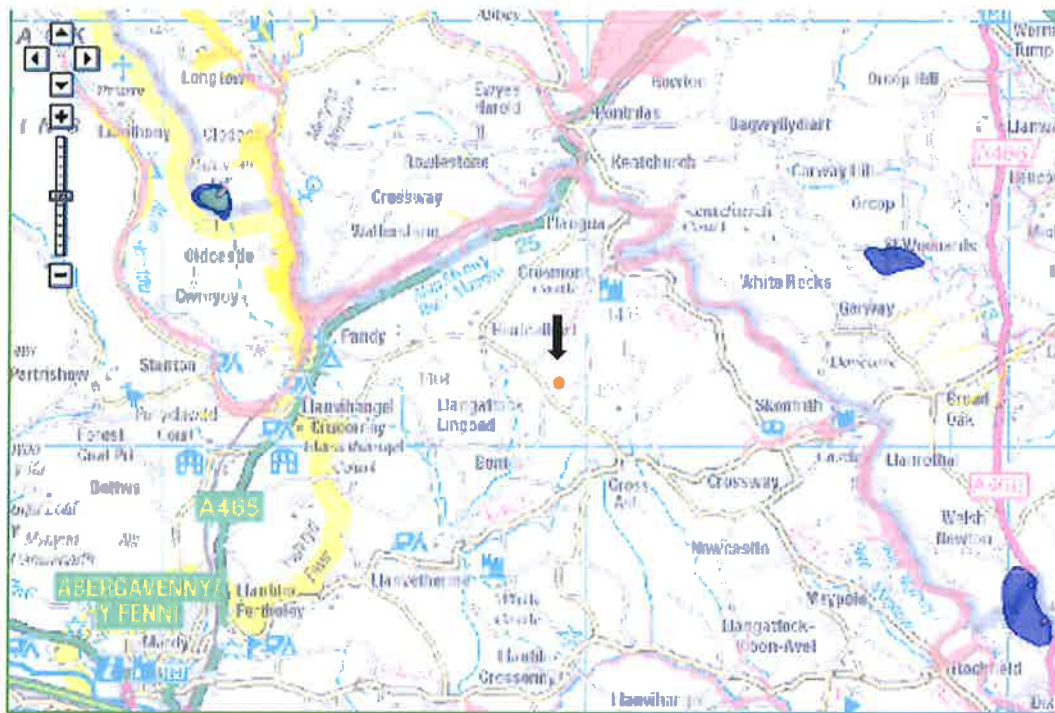

1.7

Soilscape map   Soil descriptions   Help   Search   Contact   About   LandIS

**Search results:**  
NP7 sLB  
[View soil information](#)

**Legend**

Search

**Soil Information**

**Soilscape 8:**  
Slightly acid loamy and clayey soils with impeded drainage

**Texture:**  
Loamy some clayey

**Coverage:**  
England: 10.6%   Wales: 1.9%  
England & Wales: 9.4%

**Selected area:**  
110km<sup>2</sup>

**Drainage:**  
Slightly impeded drainage

**Fertility:**  
Moderate to high

**Habitats:**  
Wide range of pasture and woodland types

**Landcover:**  
Arable and grassland

**Carbon:**  
Low

**Drains to:**  
Stream network

1km  
0.6mi

Adjust transparency

Developed by Cranfield University and sponsored by DEFRA  
For more detailed soil information visit [Soil Site Reporter](#)   For soils education visit [soil-net.com](#)



white's recycling ltd

**GROSMONT LAGOON NON-TECHNICAL SUMMARY**

STORAGE LAGOON LOCATED AT:

WOOD FARM  
GROSMONT  
ABERGAVENNY  
NP7 8LB

NGR: SO 339034 221351

SUBMITTED BY:

WHITES RECYCLING LTD  
THE MINE SITE  
SOUTH WITHAM  
GRANTHAM  
LINCOLNSHIRE  
NG33 5QN

CONTACT: Rebecca Saywood

TELEPHONE: 01572 767177

EMAIL: [Rebecca@whitesrecycling.co.uk](mailto:Rebecca@whitesrecycling.co.uk)

## **1.0 Introduction**

- 1.1 Whites Recycling Ltd is an experienced waste contractor engaged to remove and recycle to land a number of organic wastes derived from food and beverage production. Whites Recycling Ltd have well established operational procedures including the recording of delivery and removal of waste / environmental management / health and safety / waste acceptance criteria and eventual land spreading operations.
- 1.2 During the majority of the year these wastes are spread directly to land, onto appropriately deployed field sites under mobile plant permits in close proximity to the points of production.
- 1.3 At certain times throughout the year it is inadvisable to land spread wastes due to ground/soil/weather conditions and in some circumstances certain wastes may not be spread as this would contravene the 'closed period' as advised by the Natural Resources Wales.
- 1.4 The lagoon at Grosmont will be utilised to store wastes under circumstances of 1.3
- 1.5 The lagoon site will provide a storage facility for food and drinks wastes to allow bulking up and subsequent land spreading to local field sites on surrounding farmland.

## **2.0 Location**

- 2.1 The topography of the area is typical rolling hills but the site is flat with extensive open agricultural land with a hedge fronting the site
- 2.2 The lagoon is not directly overlooked by domestic residences, the closest being some 358m to the South West

## **3.0 Lagoon specification**

- 3.1 The storage capacity is 6782 cubic metres (excluding the freeboard of 750mm)
- 3.2 The measurements of the lagoon are 45m x 47m x4m
- 3.3 The earth banks are formed from materials excavated during the digging of the lagoon with no outside materials brought in for this purpose
- 3.4 The base of the lagoon is a clay subsoil, and a heavy duty butyl liner (impervious layer) is installed
- 3.5 Leak detection is installed
- 3.6 The lagoon is surrounded by a 2m fence. This is positioned at the base of the outer bank to prevent farm animals, wildlife or unauthorised personnel entering the lagoon site
- 3.7 A lockable gate is provided to enable access for maintenance and management of the lagoon

SITE LOCATION AND REFERENCE NUMBER: GROMONT, WOOD FARM, GROMONT, ABERGAVENNY NP7 8LB / NGR:SO 339034 221351										
RISK ASSESSMENT CARRIED OUT BY: James Tarver, Head of Agronomy					Document ref: WRL/GROS/					
DATE COMPLETED:		REVIEW DATE:			CONSEQUENCE		MAGNITUDE		JUSTIFICATION OF MAGNITUDE	
RECEPTOR	SOURCE	HARM	PATHWAY	PROBABILITY	CONSEQUENCE	MAGNITUDE	MAGNITUDE	JUSTIFICATION OF MAGNITUDE	RISK MANAGEMENT	RESIDUAL RISK
Surface Water	Nutrient and organic matter within waste	Eutrophication or de-oxygenation of surface waters	Direct run-off from site access	Low	Medium	Medium	Medium	Distance to ditches, streams & ponds	Clearing up of any spillages immediately, emergency clean up procedures	Low
Surface Water	Failure of Lagoon walls	As above	As above	Low	Medium	Medium	Medium	Distance to surface water	Annual inspection of lagoon walls. Lagoons Lined.	Low
Ground Water	Nutrient within the waste	Deterioration in groundwater quality	Percolation through soil profile	Medium	High	Medium	Medium	Site is not within SPZ1 or SPZ2	Nutrient content is matched to crop requirements	Low
Ground Water	Failure of Lagoon walls	As above	As above	Low	Medium	Medium	Medium	Clay sub soil	Annual inspection of lagoon walls. Lagoons Lined.	Low
Soil	Nutrients and organic matter	Excessive increased in nutrient/OM content	Application of excessive quantities of waste	Medium	Medium	Medium	Medium	Soil type is identified as a clay loam	Mechanical recovery and/or dispersal can be implicated	Low
Soil	Failure of Lagoon walls	As above	As above	Low	Medium	Medium	Medium	Lagoon in existence for 30 years. Strong, secure banks. Lagoons significantly lined.	Mechanical recovery and/or dispersal can be implemented.	Low
Crops on adjacent land	Waste escaping to adjacent land	Amendment of soils, Crop Damage/reduced yield.	Overflowing of Lagoons/Equipment Failure.	Low	Medium	Medium	Medium	Any spillage will be cleaned up immediately	Regular cleaning of roads. Daily monitoring of lagoon levels	Low
Treated Crops	Waste spillage	Crop damage, Reduced Yield	Overflowing of Lagoons. Equipment Failure	Low	Medium	Medium	Medium	Any spillage will be cleaned up immediately	Spillages will be cleaned up immediately following the company emergency spillage procedure doc ref: Freeboard of at least 0.7 metres. Regular monitoring of lagoon levels	Low
Odour	Odorous Emissions	Odour nuisance to localised persons	Inhalation of odour emissions	Medium	Medium	Medium	Medium	Site Loading/discharge procedures adherence. Monitoring of odours and weather conditions and wind direction	Care to be taken when wind direction is towards receptors. Prevailing wind direction is south-westerly which is away from receptors and is out towards open farm land. Nearest receptor is 380 metres away	Low

<b>Noise &amp; Vibration</b>	Vacuum Tanker Operations.	Site Personnel & Local Residents	Loading & discharge of vacuum tankers	Low	Low	Low	Low	Site Loading/discharge procedures.	Nearest receptor is 380metres away. Vehicles & pumps regularly maintained. Daily checks carried out by driver.	Low
<b>Pests &amp; Vermin</b>	Waste Transfer Operations	Localised Environment & Local Residents	Waste Operations	Medium	Medium	Low	Low	Site Operations	Site cleanliness & litter to be continually monitored. Bait boxes to be placed around the site if necessary. Fencing around the site to eliminate vermin.	Low
<b>Mud Dust</b>	Vehicle Movements	Localised Environment	Vehicle Movements	Low	Low	Low	Low	Vehicle movements on and around the site collecting and discharging waste, site visitors etc	Concrete entrance for entry and exit with hardstanding leading up to the lagoons. No mud on site. Road sweeper availability. Monitoring of mud & dust by site operatives.	Low
<b>Flooding</b>	Heavy Rain Fall	Localised Environment	Waste Operations	Low	Medium	Low	Low	Site Operations	Not within a floodplain. Site is reached from a private road so no surface run off water to highways	Low
<b>Local Protected Habitats &amp; Local Wildlife Sites</b>	Local Wildlife Preservation	Localised Environment	Waste Operations	Low	Medium	Low	Low	Site Operations	No Nature reserves within 2 Miles of the site. Well established site. Site operations will not affect any localised wildlife.	Low
<b>Fire</b>	Vacuum Tanker Operations.	Localised Environment	Waste Operations	Low	Medium	Low	Low	Vacuum Tanker Operations	Liquid waste operations products are no combustible and non-ignitable. Fire fighting equipment on site for vacuum tanker pumps. Company emergency procedures. Local Emergency Services.	Low
<b>Vandalism</b>	Site Security	Damage to site equipment, theft	Public Access to site	Medium	High	High	High	Rural Location	Rural location, site security barrier. Fencing surrounding the permitted site. Restricted access to site. No public access.	Low
<b>Lagoon Wall Failure</b>	Pollution of Localised Environment	Lagoon wall failure	Localised Environment	High	High	High	High	Waste Operation	Annual inspection of lagoon walls. Lagoons Lined.	Low

## List of Acceptable E W C Codes

- 02 01 - Wastes from agriculture, horticulture, forestry, hunting and fishing**
- 02 01 01 - Sludges from washing and cleaning produced during food preparation and processing only**
- 02 01 03 - Plant tissue waste**
- 02 01 06 - Farmyard manure and slurry, horse manure and soiled bedding made from plant tissue only**
- 02 02 - Wastes from the preparation and processing of meat, fish and other foods of animal origin**
- 02 02 01 - Untreated wash waters and sludges from washing and cleaning from abattoirs, poultry processing plants, rendering plants or fish preparation plants**
- 02 02 02 - Blood and gut contents from abattoirs, poultry preparation plants, rendering plants or fish preparation plants only**
- 02 02 04 - Sludges from on-site effluent treatment plants from abattoirs, poultry preparation plants, rendering plants or fish preparation plants only**
- 02 03 - Wastes from fruit, vegetables, cereals, edible oils, cocoa, coffee, tea and tobacco preparation and processing; conserve production; yeast and yeast extract production, molasses preparation and fermentation**
- 02 03 01 - Sludges from washing, cleaning, peeling, centrifuging and separation**
- 02 03 02 - Wastes from preserving agents**
- 02 03 03 - Wastes from solvent extraction**
- 02 03 04 - biodegradable materials unsuitable for consumption or processing**
- 02 03 05 - Sludges from on-site effluent treatment**

- 02 04 - Wastes from sugar production**
- 02 04 02 - Off-specification calcium carbonate**
- 02 04 03 - sludges from on-site effluent treatment**
- 02 05 - Wastes from the dairy products industry**
- 02 05 01 - Biodegradable materials unsuitable for consumption or processing**
- 02 05 02 - Sludges from on-site effluent treatment**
- 02 06 - Wastes from the baking and confectionery industry**
- 02 06 01 - Biodegradable materials unsuitable for consumption or processing**
- 02 06 02 - Wastes from preserving agents**
- 02 06 03 - Wastes from on-site effluent treatment**
- 02 07 - Wastes from the production of alcoholic and non-alcoholic beverages (except coffee, tea and cocoa)**
- 02 07 01 - Wastes from washing cleaning and mechanical reduction of raw materials**
- 02 07 02 - Wastes from spirits distillation**
- 02 07 03 - Wastes from chemical treatment**
- 02 07 04 - Materials unsuitable for consumption or processing**
- 02 07 05 - Sludges from on-site effluent treatment**
- 03 03 - Wastes from pulp, paper and cardboard production and processing**
- 03 03 11 - Sludges from on-site effluent treatment other than those mentioned in 03 03 10**

- 04 01 - Wastes from the leather and fur industry**
- 04 01 07 - Sludges from on-site effluent treatment free from chromium**
- 04 02 - Wastes from the textile industry**
- 04 02 15 - Biodegradable wastes from finishing other than those containing organic solvents only**
- 04 02 20 - Sludges from on-site effluent treatment other than those mentioned in 04 02 19**
- 04 02 21 - Wastes from unprocessed textile fibres**
- 05 01 - wastes from petroleum refining**
- 05 01 10 - Activated sludges from on-site oil refinery biological effluent treatment plants other than those mentioned in 05 01 09**
- 07 07 - wastes from the MFSU of fine chemicals and chemical products not otherwise specified**
- 07 07 12 - Sludges from on-site biological effluent treatment plants at chemical manufacturing sites other than those mentioned in 07 07 11 only**
- 10 01 - Wastes from power stations and other combustion plants (except 19)**
- 10 01 07 - Gypsum (sludge) only**
- 10 13 - wastes from manufacture of cement, lime and plaster and articles and products made from them**
- 10 13 04 - Wastes from calcination and hydration of lime**
- 16 03 - Off-specification batches and unused products**
- 16 03 06 - Out of date and out of specification beverages only**
- 16 10 - Aqueous liquid wastes destined for off-site treatment**
- 16 10 02 - Aqueous liquid wastes other than those which are mentioned in 16 10 01**

- 19 02 - Wastes from physio/chemical treatments of waste (including dechromatation, decyanidation and neutralisation)**
- 19 02 03 - Pre-mixed wastes composed only of non-hazardous wastes**
- 19 05 - Wastes from aerobic treatment of solid wastes**
- 19 05 99 - Liquor and digestate from aerobic treatment of source segregated biodegradable waste only**
- 19 06 - Wastes from anaerobic treatment of waste**
- 19 06 05 - Liquor from anaerobic treatment of source segregated biodegradable waste**
- 19 06 06 - Digestate from anaerobic treatment of source segregated biodegradable waste**
- 19 09 - Wastes from the preparation of water intended for human consumption or water for industrial use**
- 19 09 02 - Sludges from water clarification**

Doc Ref  
WRL/Gros/10

All drawings shall be checked on completion of the project for compliance with the requirements of the Planning Act 2008.

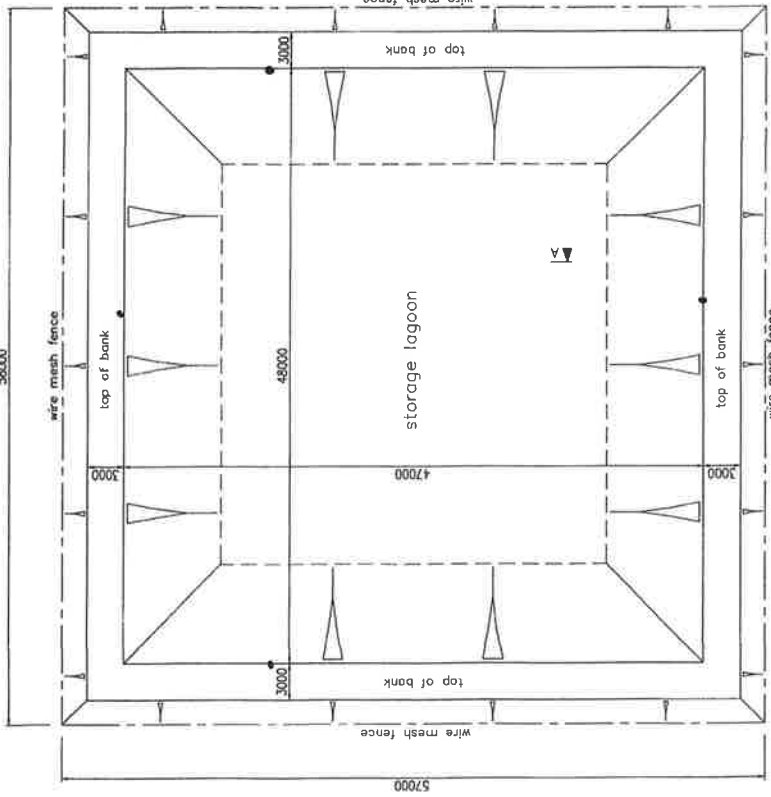

Proposed Plan of Lagoon (1:200)

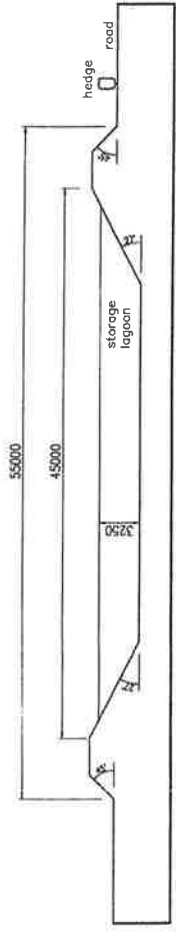
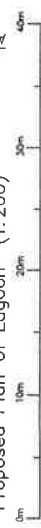

Cross Section Through Lagoon (1:200)

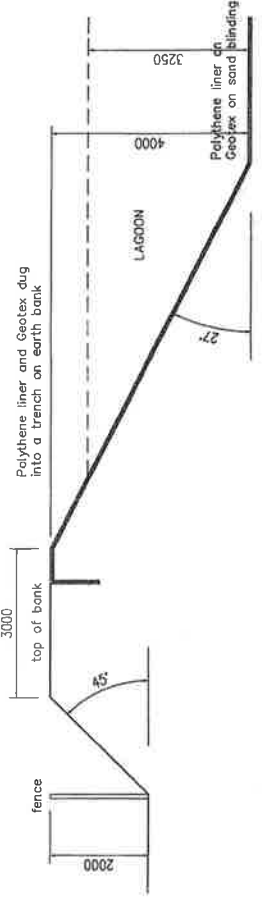

Section A-A: Proposed Lagoon Banking Detail (1:50)

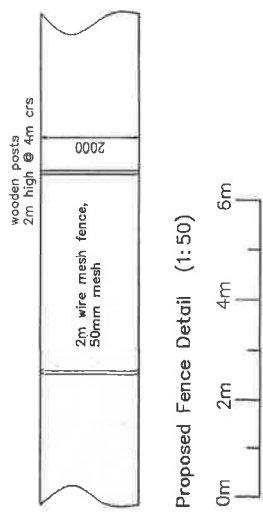

Proposed Fence Detail (1:50)

MONMOUTHSHIRE COUNTY COUNCIL  
PLANNING SECTION  
17 JUN 2016  
Date of:  
Ref No:

Revisions	Date
<b>Robert Farrow (Design) Ltd</b> Architecture : Planning : Construction Topographical Surveys Miller House, 32 Northgate, Hestle, East Riding of Yorkshire, HU13 9AA Tel: 01482 640699 E-mail: rff@farrow.lamo.co.uk	
<b>Client:</b> W. R. Robinson	
<b>Title:</b> Lagoon Plan/Section Proposed Storage Lagoon on land at Grosport Wood Farm, Grosport, Abergavenny, Wales, NP7 5LB	
Scale 1:50 1:250	Drawn by SB
Date 1 Jun 16	Checked by 16060

Geosmont Lagoon Section through Bank (Not to Scale)

user/geos/111

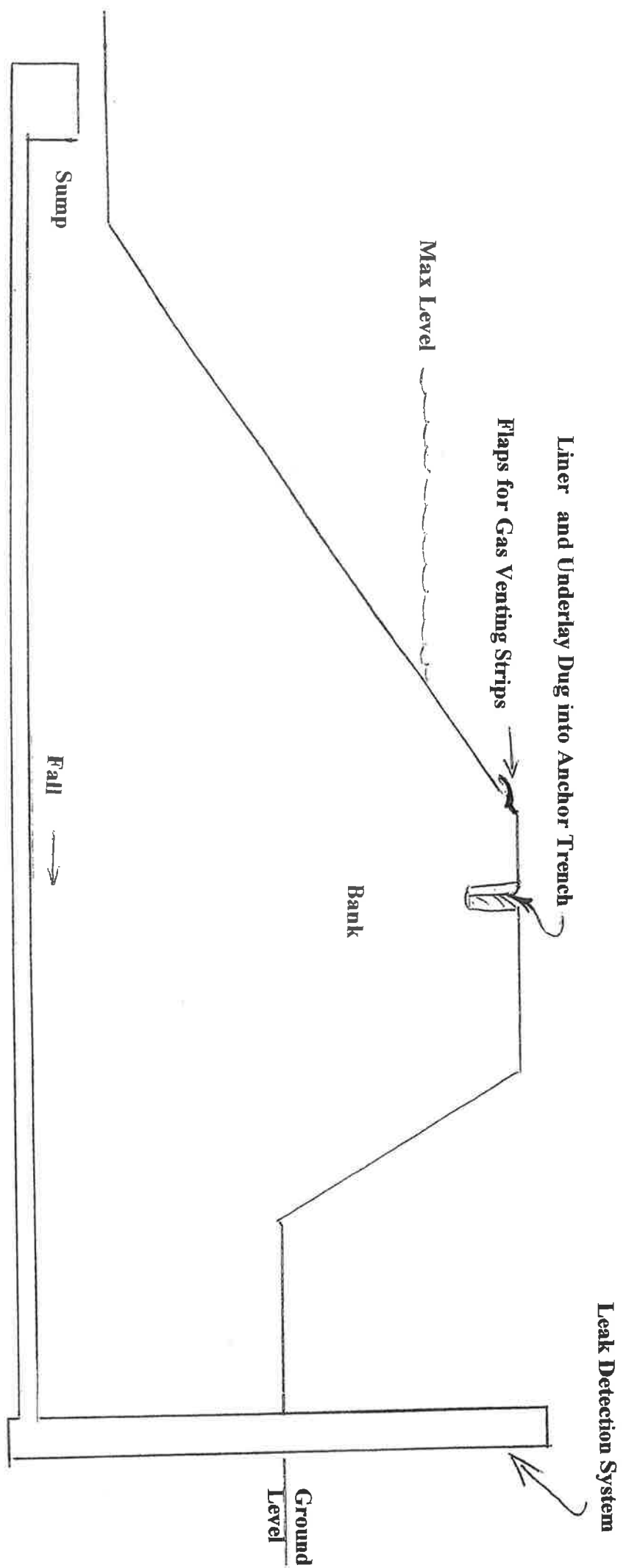

Geosment Lagoon Liner Section (not to scale)

work/2025/12

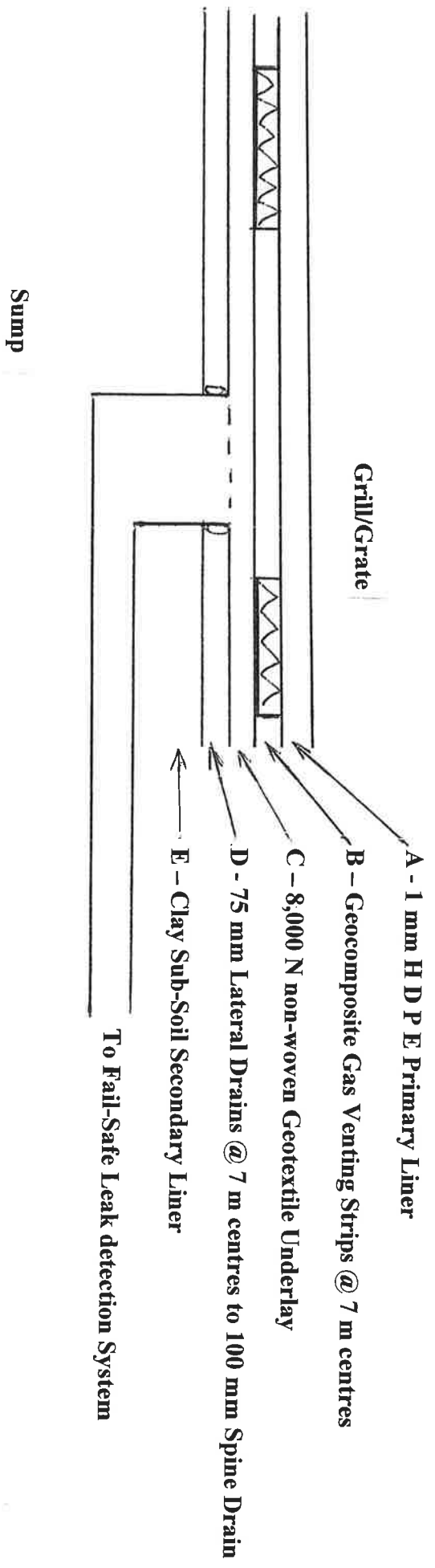



white's recycling ltd

**GROSMONT LAGOON ODOUR MANAGEMENT PLAN**

STORAGE LAGOON LOCATED AT:

WOOD FARM  
GROMONT  
ABERGAVENNY  
NP7 8LB

NGR: SO 339034 221351

SUBMITTED BY:

WHITES RECYCLING LTD  
THE MINE SITE  
SOUTH WITHAM  
GRANTHAM  
LINCOLNSHIRE  
NG33 5QN

CONTACT: STEVE TAYLOR (MANAGING DIRECTOR)

TELEPHONE: 01572 767177

EMAIL: [steve@whitesrecycling.co.uk](mailto:steve@whitesrecycling.co.uk)

# Odour Management Plan for the Storage of Odorous Organic Waste Material at Grosmont Lagoon

## **1. Procedure Objectives**

- 1.1 To prevent or where that it is not practicable, to minimise, the risks of off Lagoon Site odour from Organic Material Storage activities as required by the Environmental Permit.
- 1.2 To ensure relevant persons are aware of the steps which must be taken to reduce the risk of odour from Organic Material Storage activities.
- 1.3 To ensure relevant persons are aware of the records required.

## **2. Scope**

- 2.1 This procedure includes the storage of Organic Materials and is specific to odour management.

## **3. Health & Safety Considerations**

- 3.1 There are no significant Health & Safety considerations to be taken into account.

## **4. Environmental Considerations**

- 4.1 As detailed in the procedure.

## **5. Responsibility**

- 5.1 The Agronomy Manager is responsible for ensuring the records required by these procedures are completed & securely stored.
- 5.2 The Agronomy Manager is responsible for ensuring checks are undertaken and recorded.
- 5.3 The Agronomy Manager undertakes an Audit to assess compliance with these procedures.

## **6. Definitions**

### **6.1 Receptors**

Residents of occupied homes and residential areas  
Employees and Customers at industrial and commercial premises

### **6.2 Substantiated Complaint**

A substantiated complaint is considered to be made when the information obtained indicates that storage operations are causing an odour nuisance.

## **7. Odour Management**

- 7.1 If notified by the Environment Agency that the activities are giving rise to pollution (substantiated complaints/observations) outside the lagoon Site due to odour, the odour management plan will be reviewed.

7.2 To design and implement the plan has:

- \* Identified the likely source of odour
- \* Identified the likely receptors
- \* Determined the control measures to be put in place
- \* Ensured continuing availability of resources and information necessary to achieve the planned results
- \* Establish systems to monitor and measure these processes
- \* Identify the action that will be taken if odour is identified as a problem
- \* Identified who is responsible for taking any required actions

## **8. Identification of Receptors**

8.1 Prior to the application for planning an initial risk assessment was conducted to identify the receptors (please see location map for nearest receptor).

## **9. Control Measures to be Employed**

- 9.1 All accepted wastes are sourced from known and approved producers and no unplanned loads will be accepted. Identification of waste streams will allow any known potential odour issues to be managed.
- 9.2 A 'sniff' test for odours from the Lagoon Site shall be carried out. This shall be recorded.
- 9.3 On detection or notification of odours that are likely to cause nuisance from waste due to be transported to the Lagoon Site, immediate action shall be taken to stop the waste handling operations that are giving rise to the nuisance. The incident and the remedial actions carried out are recorded.
- 9.4 The farm Liaison Manager will take the lead for odour checks. However odour checks will also be undertaken on other occasions by other suitable staff members.
- 9.5 The frequency of the checks will be determined by the likely risk of the exposure which will largely be dictated by the 'actual' weather conditions and distance to the receptors.
- 9.6 Odour checks are carried out by approaching the Lagoon Site from downwind, but if the wind is variable in direction then a wide sweep is carried out to allow a broader area of assessment, prior to making a direct approach to the storage area. It is important for personnel checking odours to allow a period of time (20 minutes or so) away from the storage Lagoon Site to reduce the likelihood of desensitisation. If during these checks an unacceptable level of odour is detected the operation is aborted until the cause of the odour has been ascertained.
- 9.7 The findings of the checks will be recorded on odour check sheet and these sheets are archived.

## 10. Action Plan

- 10.1 Prior to commencement of storage of organic liquids all other integral parts of the Odour Management Plan must be carried out. In the event of a substantiated complaint the operation will be stopped. A Lagoon Site investigation will be carried out by The Farm Liaison Manager.
- 10.2 The Operation will only be recommenced when conditions are suitable or storage has ceased to give off offensive odours.
- 10.3 Authority to recommence will only be given by The Agronomy Manager
- 10.4

### Chain of Command



## 11. Communications

- 11.1 In the event that complaints are received all complaints will be fully investigated and feedback on the findings will be given to the complainant.
- 11.2 In the event that a problem is detected during the routine checks or following odour complaint where Whites Recycling Staff are notified by the Environment Agency that an unacceptable odour has been detected off Lagoon Site, all operations on site will cease until the source is detected and eliminated.

## 12. Incidents and Accidents

- 12.1 All incidents and accidents relating to the injecting of Organic Material will be dealt with in accordance with the 'Emergency Procedures'. The findings of any such incident will be recorded on a non-conformance report.

## 13. Training

- 13.1 All persons involved in storing odorous material will be made aware of the procedures in the odour management plan and their significant responsibilities to ensure compliance.

Date: 19/10/2016

Revision Date (unless revision deemed before): 19/10/2017

# white's recycling ltd



## Odour Monitoring Check Sheet

Assessment Carried out by: \_\_\_\_\_

Lagoon Name \_\_\_\_\_

Location: \_\_\_\_\_  
 \_\_\_\_\_  
 \_\_\_\_\_

Odour Checks Carried out at		Time	Result		Weather Status
			No Odour	Odour Detected	
Date	Day				
	Monday	AM			
		AM			
		PM			
		PM			
	Tuesday	AM			
		AM			
		PM			
		PM			
	Wednesday	AM			
		AM			
		PM			
		PM			
	Thursday	AM			
		AM			
		PM			
		PM			
	Friday	AM			
		AM			
		PM			
		PM			
	Saturday	AM			
		AM			
		PM			
		PM			
	Sunday	AM			
		AM			
		PM			
		PM			

Notes: \_\_\_\_\_  
 \_\_\_\_\_  
 \_\_\_\_\_



white's recycling ltd

## Method Statement for Loading & Discharge of Liquid Tankers

### Scope and objective

To ensure that a consistent, safe and competent method is employed by drivers and operatives required to load or discharge road Tankers

### Responsibilities:

Operations Manager and Supervisors must ensure that this method statement is strictly adhered to.

### Training:

Drivers must have been inducted in the correct use of the vehicle and equipment they use by a competent person authorised by the Operations Manager.

### Operation:

- 1) The Driver must be in possession of the following information before commencing work:-
  - Type and nature of Waste
  - Location of the loading site,
  - Identification of the loading point or name of person to report to,
  - Identification of the discharge point or name of person to report to,
  - Volumes to be loaded or discharged,
  - If any work is required to be carried out in darkness the Driver must be in possession of a torch and all work lights on the vehicle must be working.
- 2) The Driver must then locate the nominated loading / discharge point or nominated person
- 3) Having located the loading / discharge point, the Driver must assess the pipes and fittings required to carry out the task and ensure that the area around the loading point is free of obstruction sufficiently to allow safe operation of the procedure.
- 4) When parking the vehicle at the loading point the driver must ensure that their vehicle is parked in such a way as to avoid causing unnecessary obstructions to other users of the site.
- 5) Connect all pipes and ready to commence the operation.
- 6) During loading the driver must observe all pipes, connections and sight glasses at regular intervals.
- 7) When the required amount has been loaded pumps etc should be switched off, valves closed and pipes disconnected. Any spillage must be cleaned up immediately.
- 8) If for any reason, a Driver is unable to load / discharge the required amount, the Driver must contact their Supervisor / Manager to obtain amended instructions. The Driver must not leave the immediate area of his lorry but wait to be contacted with new or revised instructions.
- 9) If the Driver knows that the load just loaded is the only load to be collected at this time, then pipes should be disconnected and reloaded onto the vehicle.
- 10) If more loads are to be collected/ delivered the pipes must be left in a safe manner for the next vehicle.
- 11) The Drivers must use all necessary Personal Protective Equipment (PPE) at all times.
- 12) In the event that any work tool or personal item should fall into a Wet Well, Septic Tank, Tanker or similar container do not attempt to retrieve it. You should contact your supervisor immediately who will organise personnel with confined space training to assist you.

Date: 03/03/16

Review: 03/03/17

WRL/GRS/16

Whites Recycling Ltd  
 Health & Safety Management  
 Model Task Risk Assessment

		Persons Affected										
Task:	Operating Tanker	Operators		Other Employees inc. Contractors		Review Dates:		Reviewed by:		Risk Rating Score (RRS)	Is RRS Tolerable?	Required Further Action - Timescale
Department/Area:	Transport / Operations	Y	Y	Y	Y	Y	Y	Y	Y	L x S = R	Yes	No
Assessor Name:	Caroline Woodcock	Assessment Date:		Review Dates:		Reviewed by:		CM & MA in place?	Required Monitoring Arrangements (MA)	Required Control Measures (CM)	Hazard	Activity
Assessor Signature:	<i>Caroline Woodcock</i>	09/07/2014		03/03/2015		<i>[Signature]</i>		Yes	No	1 x 2 = 2	✓	
Driving Tanker	RTI							✓		1 x 2 = 2	✓	
Driving Tanker	RTI at collection/disposal site							✓		1 x 2 = 2	✓	
Manual Handling of Pipes to connect to and from tanker	Muscular / Skeletal Injury Trips & Falls							✓		1 x 1 = 1	✓	
Loading & unloading of tanker	Unsuitability of Vehicle Vehicle/ Condition							✓		1 x 1 = 1	✓	

Loading & unloading of tanker	Contact with sewage derived and related products	COSHH Risk Assessment. Usage of correct PPE i.e. Hard hat, goggles, gloves, safety boots, overalls, hand washing facilities	Good Personal Hygiene Practices	✓		1 x 2 = 2	✓		
Loading & unloading of tanker	Objects falling from height	Hard Hats to be worn at all times when on site. This is a site requirement.	Monitoring of conformance.	✓		1 x 2 = 2	✓		
Loading & unloading of tanker	Damage to hearing	Ear Defenders to be worn where necessary	Monitoring of Staff wearing the correct PPE	✓		1 x 1 = 1	✓		
Loading & unloading of tanker	Liquid Splashing into Eyes	Safety Glasses to be worn at all times when loading and discharging this waste	Monitoring of Staff wearing the correct PPE	✓		1 x 1 = 1	✓		
Loading & unloading of tanker	Muscular / Skeletal Injury by operation of bower couplings	Manual Handling Training Induction Training Competency Observations	Staff Competency Monitoring Safe Working Practices	✓		1 x 2 = 2	✓		

### Risk Rating Tool

	Score	Description	Score	Description	Score	Description	Score	Description
Likelihood (L)	1	Very Unlikely	2	Unlikely	3	Likely	4	Very Likely
Severity (S)	1	No Effect or Trivial	2	Minor Injury or Illness	3	Lost Time Injury or Illness	4	Major Injury or Illness
Risk Rating (L x S)	1-5 Low	TOLERABLE no further action required	6-12 Medium	REDUCE introduce further controls and/or monitoring specified above	13-25 High	INTOLERABLE stop process or activity until further controls are implemented		

## Determination of Coefficient of Permeability in the Triaxial Cell

Test performed in accordance with BS1377 : Part 6 : Clause 6 : 1990

### Sample Details:

Sample Location: Robinson.

Sample Details : Remoulded using standard compaction at received water content.

Description : Stiff red - brown friable sandy silty clay.

### Test Details:

Initial diameter mm : 104

Initial height mm : 100

Initial water content % : 32

Initial bulk density  $\text{Mg/m}^3$  : 1.88

Initial dry density  $\text{Mg/m}^3$  : 1.42

### Saturation Stage.

Saturation initially by constant water content, followed by back pressure using 10 kPa differential.

Initial B value: 0.87

Final B value : 0.99

### Consolidation Stage.

Effective cell pressure kPa: 100

Volume change ml : 5.9

### Permeability Stage.

Pressure difference across sample kPa: 50

Mean effective stress kPa: 100

Hydraulic gradient : 51

Coefficient of permeability m/s :  $4.1 \times 10^{-10}$

### Test Durations.

Saturation days: 3

Consolidation days: 2

Flow days: 4

**PROJECT No : GL4105.**

**PROJECT NAME : THE MINE SITE (GRANTHAM NG33 5QB).**